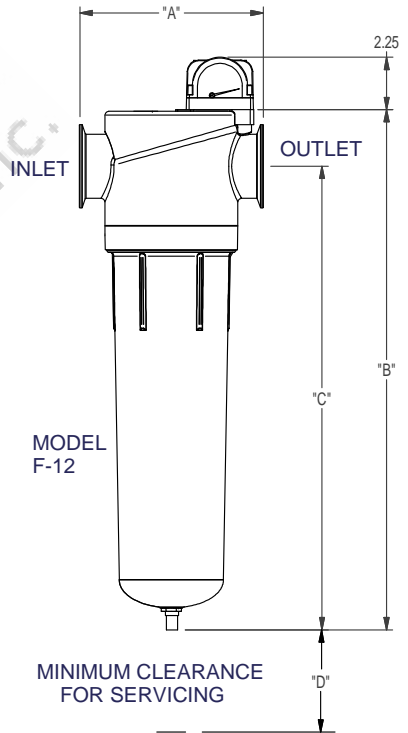
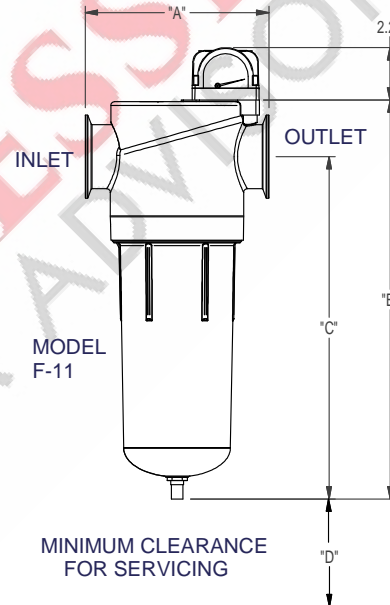
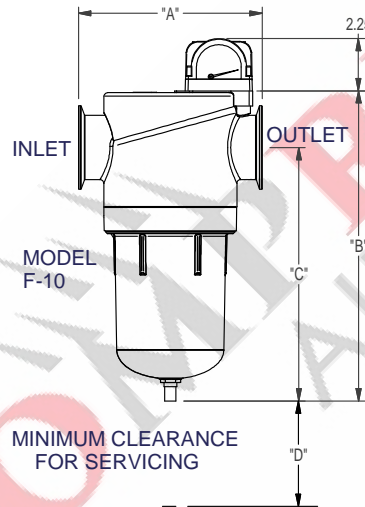
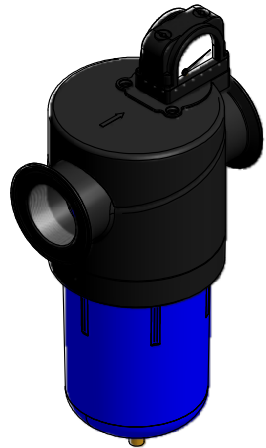

Table			
FILTER TYPE	F-10	F-11	F-12
REPLACEMENT ELEMENT	F(GRADE)-10	F(GRADE)-11	F(GRADE)-12
NOMINAL FLOW	257 (437)	360 (612)	401 (681)
IN/OUT CONN. NPT (BSPT)	1 1/2	1 1/2	2
"A" IN. (mm)	7.87 (200)	7.87 (200)	7.87 (200)
"B" IN. (mm)	13.26 (336.7)	17.08 (433.7)	22.29 (566)
"C" IN. (mm)	10.87 (276.1)	14.69 (373.1)	19.9 (505.4)
"D" IN. (mm)	7 (178)	7 (178)	7(178)
WEIGHT lb. (kg.)	8.4 (3.8)	9.9 (4.5)	11.6 (5.3)
MWP psig. (bar)	250 (17.3)	250 (17.3)	250 (17.3)
MOT F (C)	150 (66)	150 (66)	150 (66)
HEAD MATERIAL	ALUMINUM	ALUMINUM	ALUMINUM
BOWL MATERIAL	ALUMINUM	ALUMINUM	ALUMINUM

- NOTES:
 1. MWP - MAXIMUM WORKING PRESSURE
 2. MOT - MAXIMUM OPERATING TEMPERATURE
 3. FILTER ASSEMBLY WITH DP GAUGE AND AUTOMATIC FLOAT DRAIN SHOWN



COMPRESSED
 AIR ADVISORS
 Inc.
 Compressed Air Advisors, Inc.
 Phone: 877.247.2381
 info@compressedairadvisors.com
 www.compressedairadvisors.com

					UNLESS OTHERWISE SPECIFIED DIMENSIONS ARE IN INCHES TOL. ON FRACTIONS: ±	DRAWN BY: JWB DATE: 6/3/2010			
					TOL. ON DECIMALS: ± (2 PLACE) TOL. ON DECIMALS: ± (3 PLACE) TOL. ON ANGLES: ±	CHECKED BY: JWB DATE: 6/3/2010			TITLE HANKISON GENERAL ARRANGEMENT F-10 F-11 & F-12
REV.	DESCRIPTION	BY	DATE	APPROVED	THIRD ANGLE PROJECTION	APPROVED BY: JWB DATE: 6/3/2010	SIZE B	DWG. NO. GA23HAN-0028	REV.
REVISION HISTORY (△ INDICATES LATEST REVISION)						DATE: 6/3/2010	SCALE: NONE	EST. WT.:	SHEET 1 OF 1