

# COMPRESSED AIR ADVISORS

Inc.

Compressed Air Advisors, Inc.

Phone: 877.247.2381

info@compressedairadvisors.com

www.compressedairadvisors.com

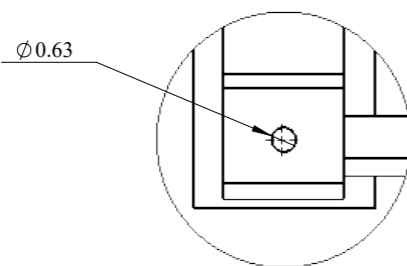

DETAIL A  
SCALE 1 : 5

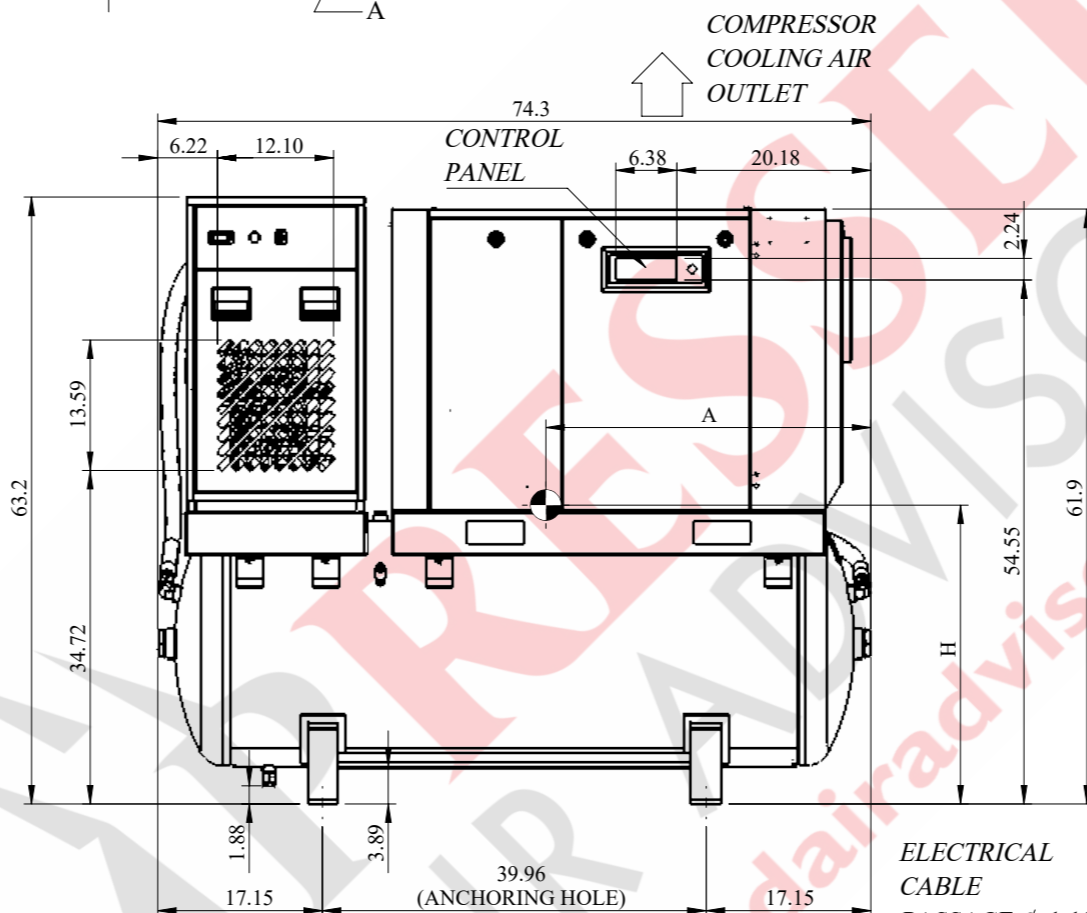
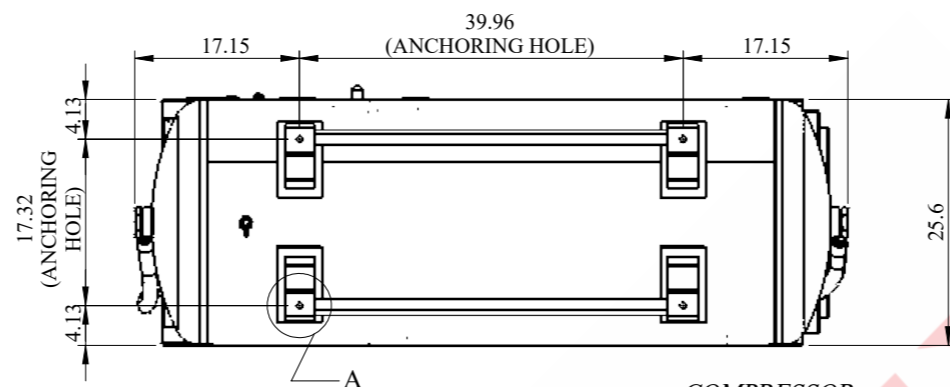
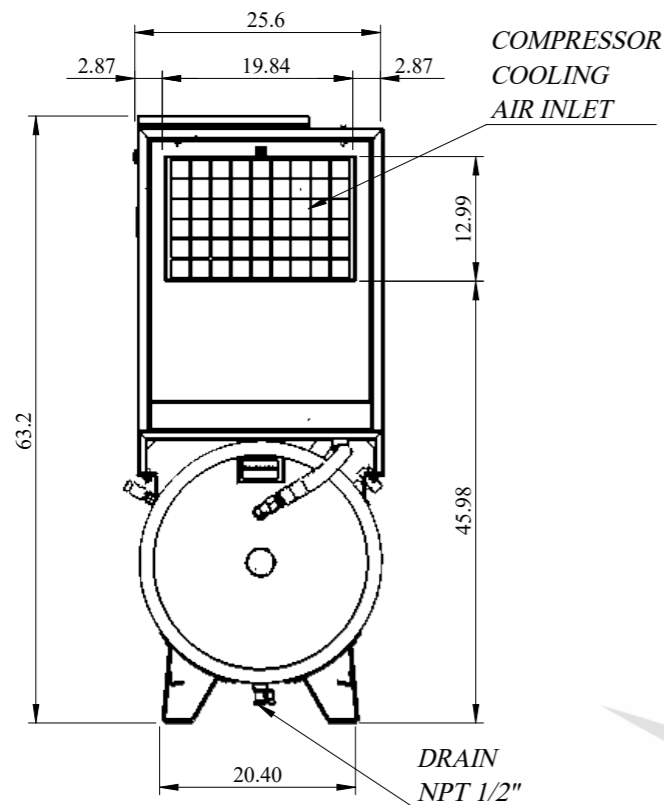

- NOTES:
- 1- All dimension units are inches (mm)
  - 2- All dimension tolerances are  $\pm 0.12"$  ( $\pm 3$  mm)
  - 3- Leave minimum 40" (1016 mm) of space around the machine to provide free circulation and access of air.
  - 4- A foundation or frame which support the weight of the package is required to provide rigidity.
  - 5- Also the compressor frame should be flatted and the frame.
  - 6- Piping loads should not be on the external connections.

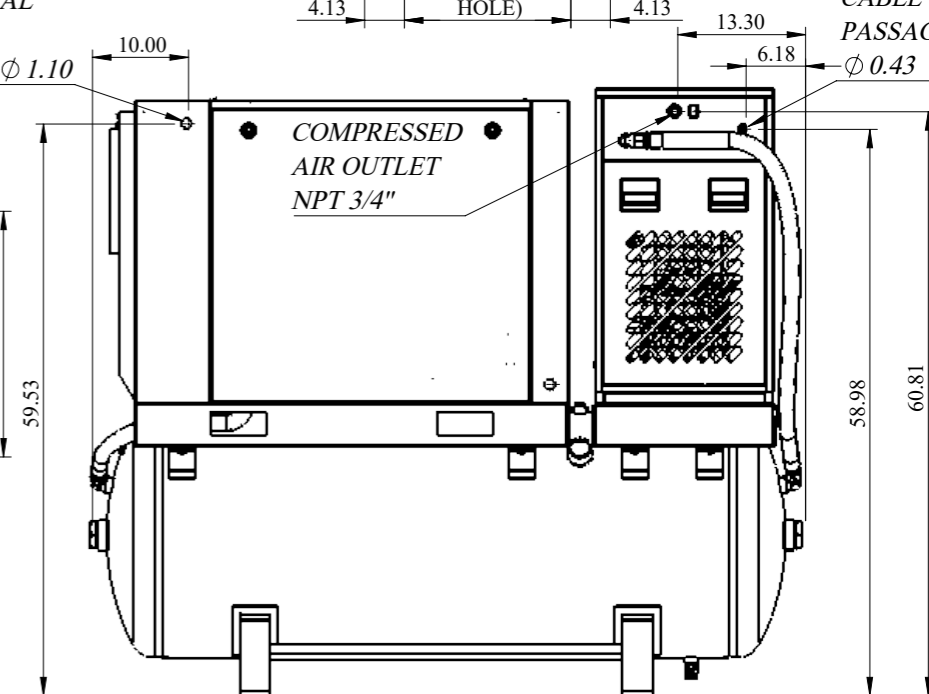
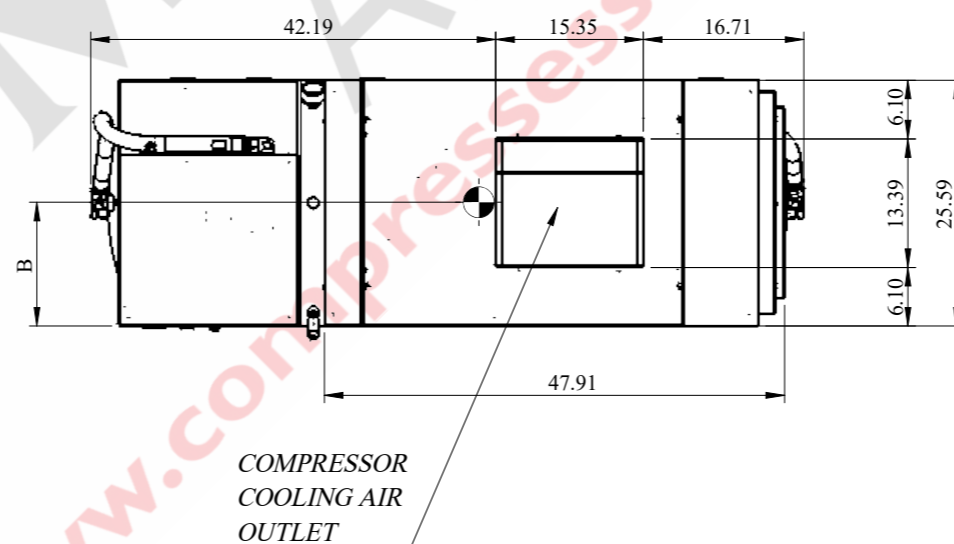
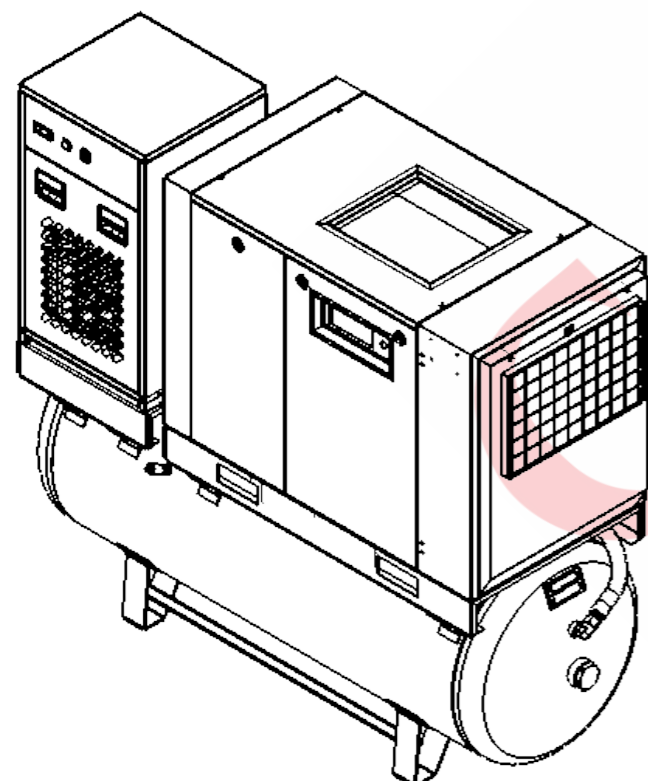
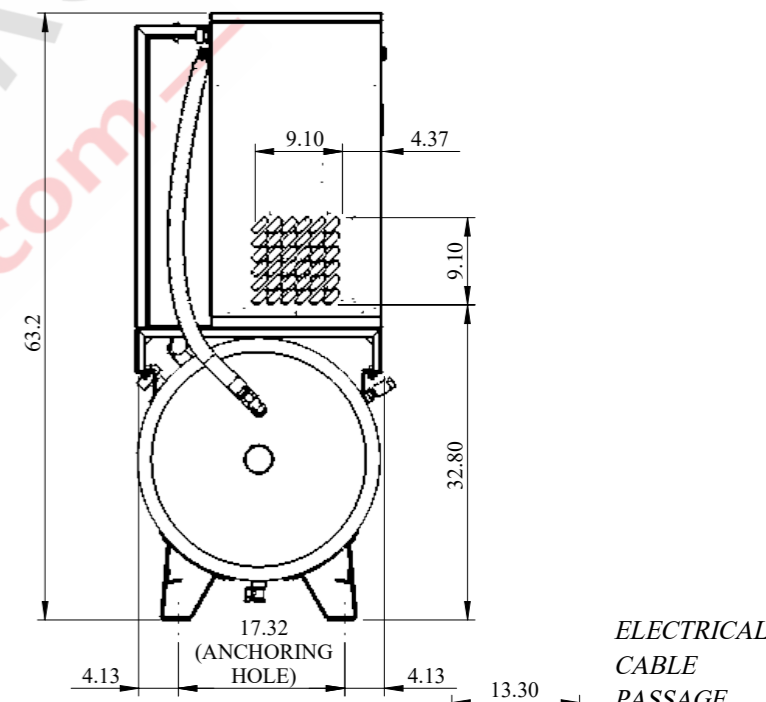

CENTER OF MASS		MODELS	TOTAL COOLING AIR FLOW RATE(cfm)
A	33.84	HBD 11 (TANK AND DRYER MOUNTED)	4265
B	12.89		
H	31.12		



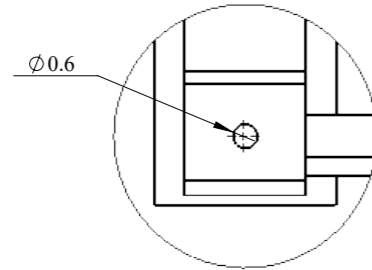

DETAIL A  
SCALE 1 : 5

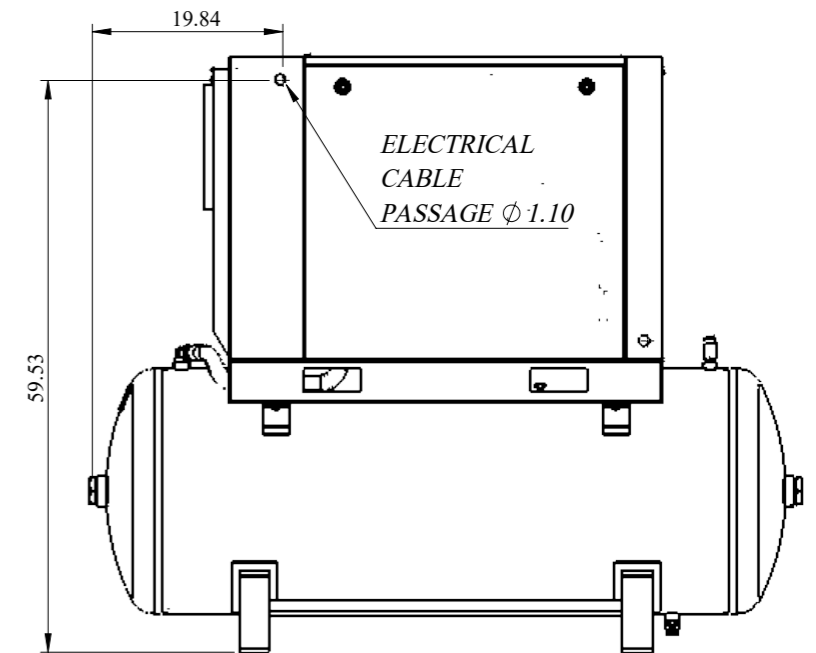
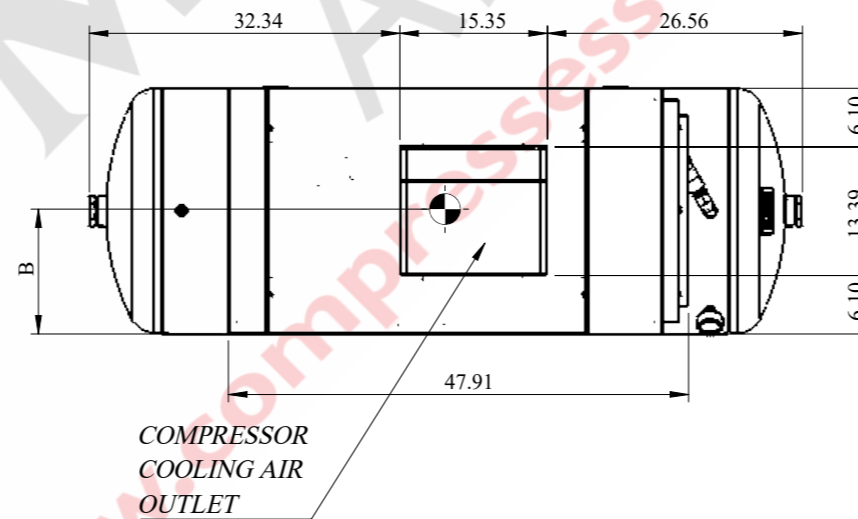
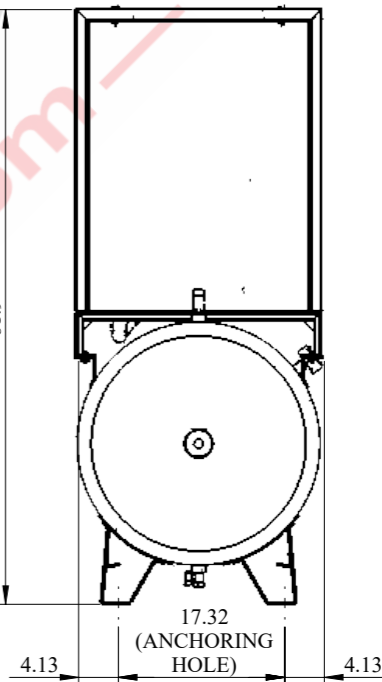
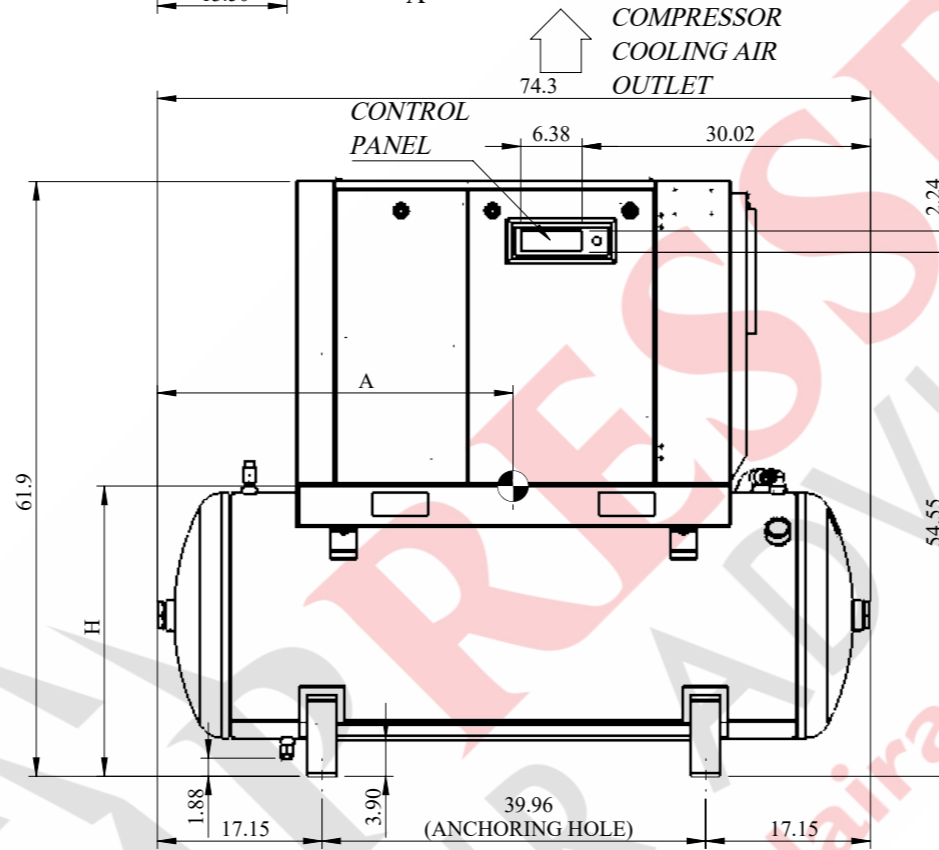
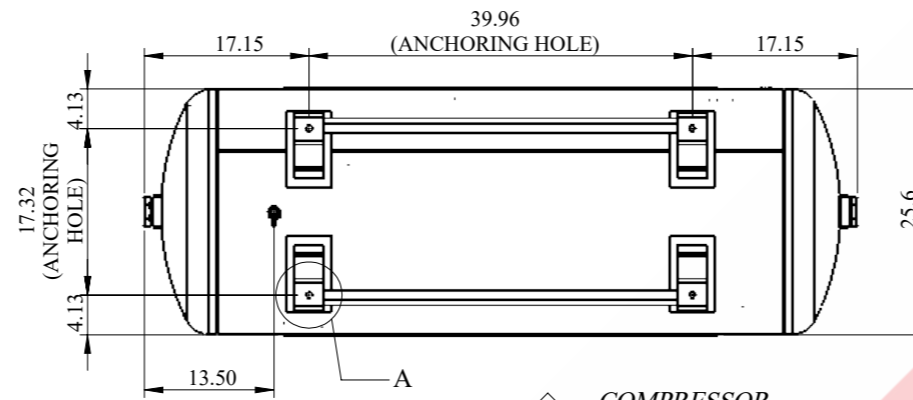
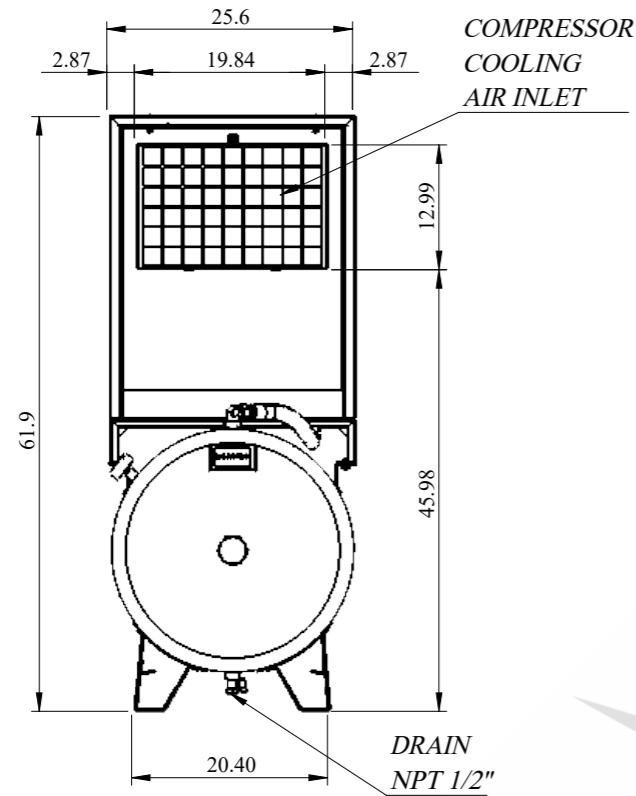

- NOTES:
- 1- All dimension units are inches (mm)
  - 2- All dimension tolerances are  $\pm 0.12"$  ( $\pm 3$  mm)
  - 3- Leave minimum 40" (1016 mm) of space around the machine to provide free circulation and access of air.
  - 4- A foundation or frame which support the weight of the package is required to provide rigidity.
  - 5- Also the compressor frame should be flatted and the frame.
  - 6- Piping loads sholud not be on the external connections.

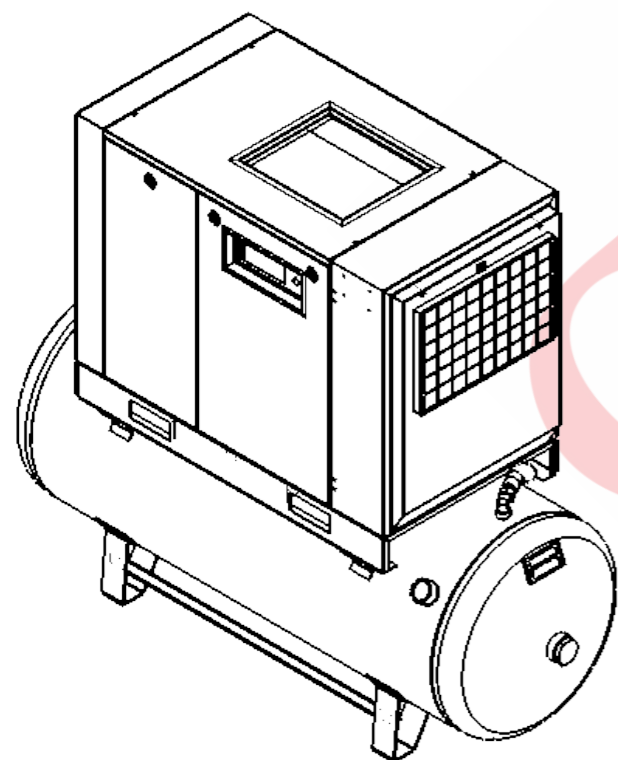

CENTER OF MASS		MODELS	TOTAL COOLING AIR FLOW RATE(cfm)
A	37.04	HBD 11 (TANK MOUNTED)	4265
B	13.01		
H	30.21		



# COMPRESSED AIR ADVISORS

Inc.

Compressed Air Advisors, Inc.

Phone: 877.247.2381

info@compressedairadvisors.com

www.compressedairadvisors.com

**NOTES:**

- 1- All dimension units are inches (mm)
- 2- All dimension tolerances are  $\pm 0.12"$  ( $\pm 3$  mm)
- 3- Leave minimum 40" (1016 mm) of space around the machine to provide free circulation and access of air.
- 4- A foundation or frame which support the weight of the package is required to provide rigidity.
- 5- Also the compressor frame should be flatted and the frame.
- 6- Piping loads should not be on the external connections.

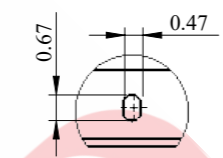
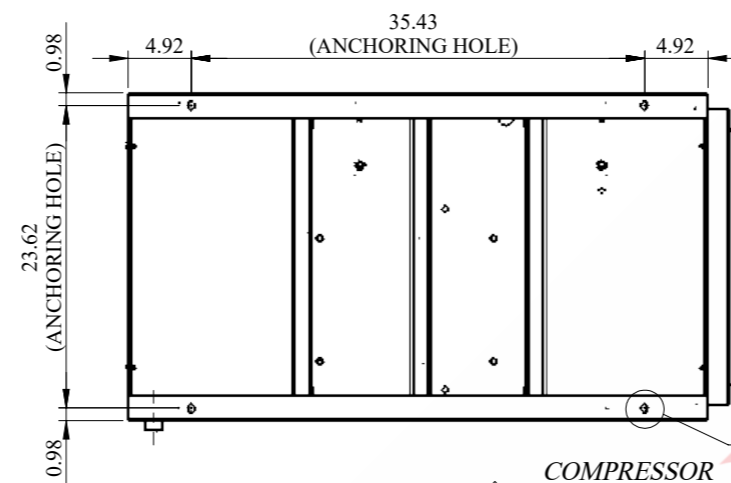

DETAIL A  
SCALE 1 : 5

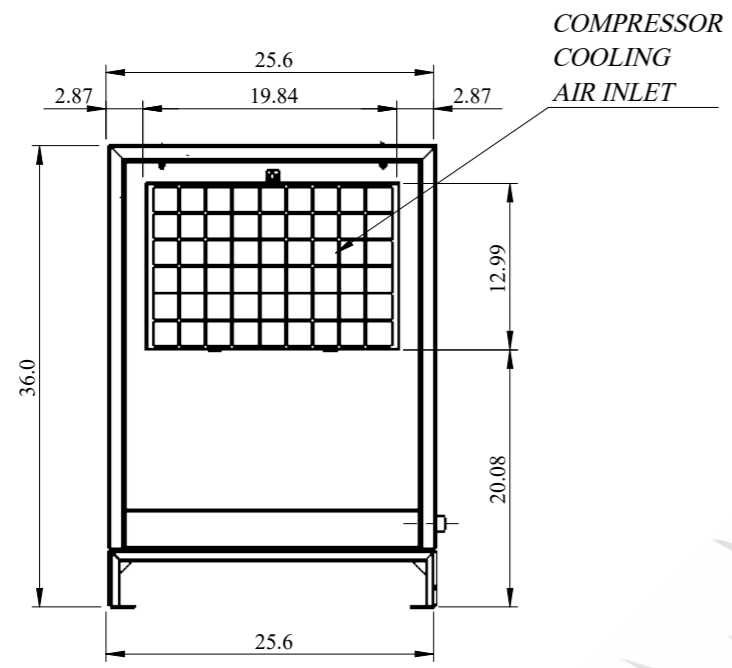

COMPRESSOR COOLING AIR INLET

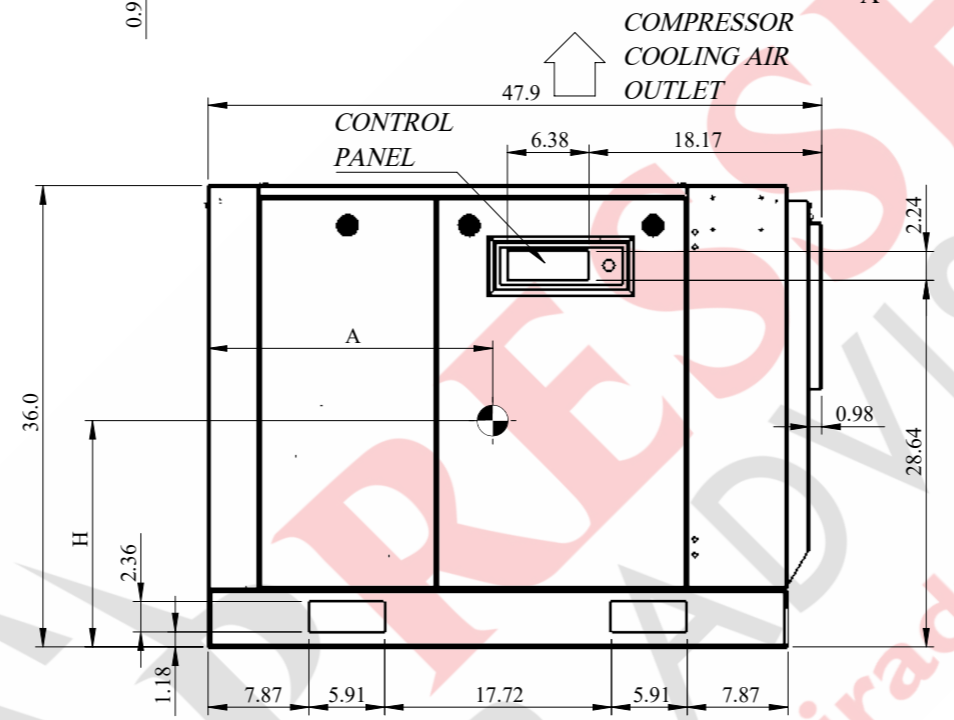

COMPRESSOR COOLING AIR OUTLET

CONTROL PANEL

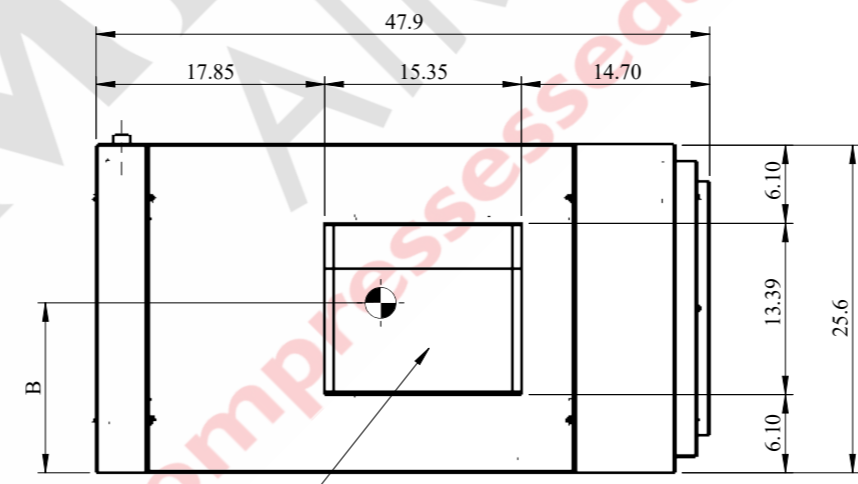
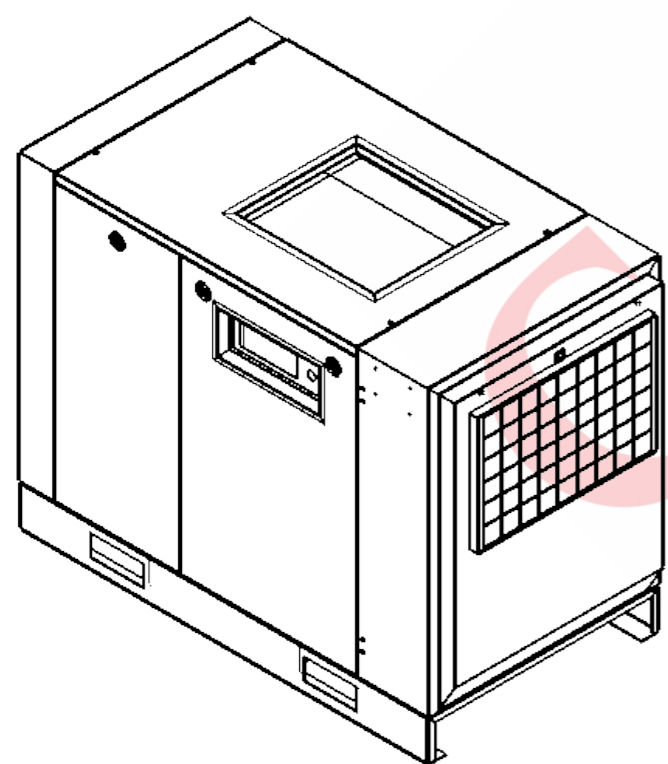
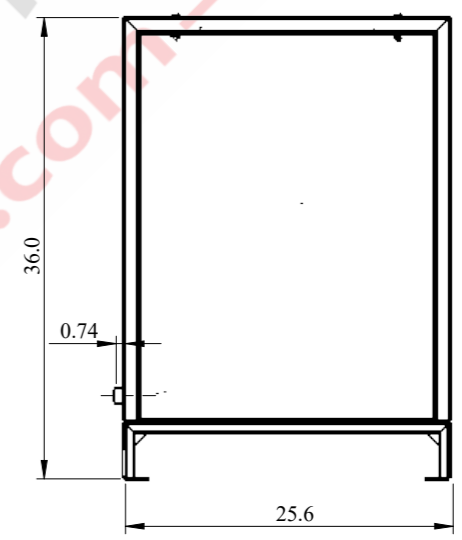

COMPRESSOR COOLING AIR OUTLET

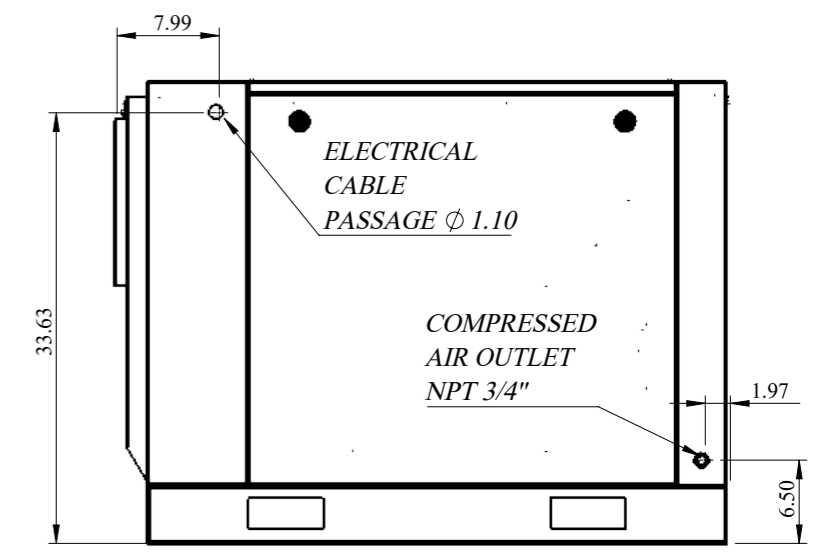

ELECTRICAL CABLE PASSAGE  $\phi$  1.10

COMPRESSED AIR OUTLET NPT 3/4"

CENTER OF MASS		MODELS	TOTAL COOLING AIR FLOW RATE(cfm)
A	22.21	HBD 11	4265
B	13.27		
H	17.63		

