

All materials supplied are in compliance with the requirements of the List of Prohibited Substances

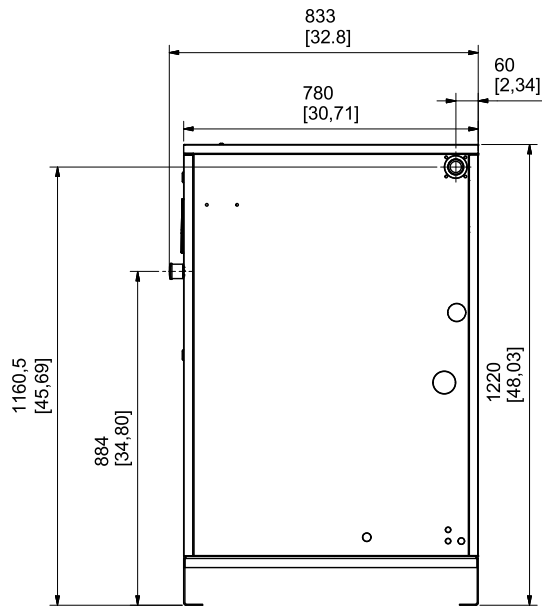

COOLING AIR INLET OF COMPRESSOR AND MOTOR

COOLING AIR OUTLET OF COMPRESSOR AND MOTOR
 COMPRESSED AIR OUTLET G 1" (IF APPLICABLE NPT 1" SUPPLIED LOOSE)

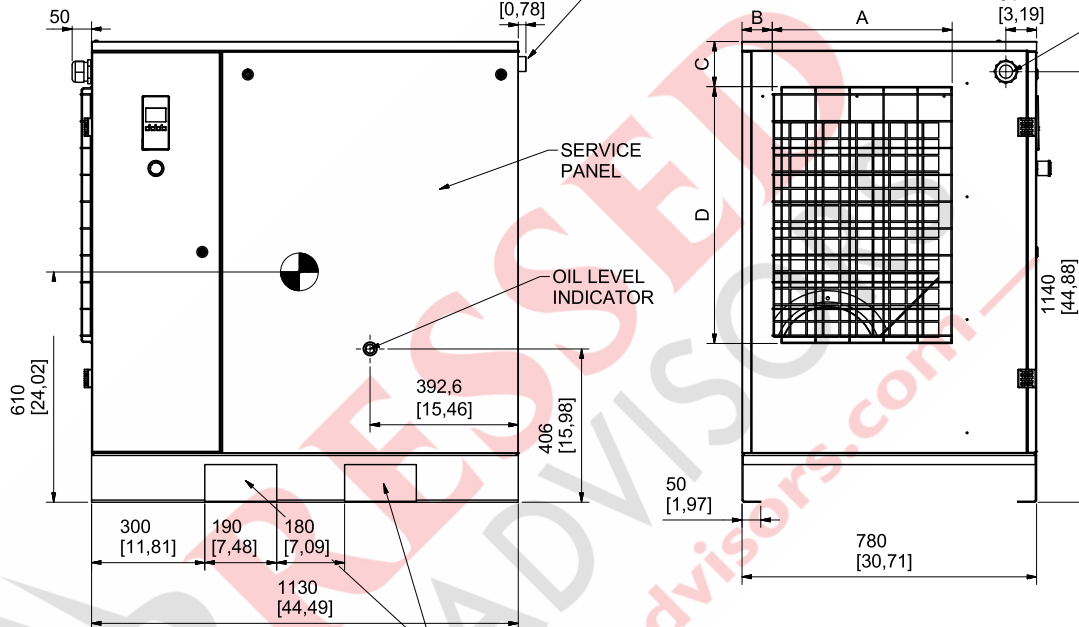

ELECTRICAL CABLE PASSAGE

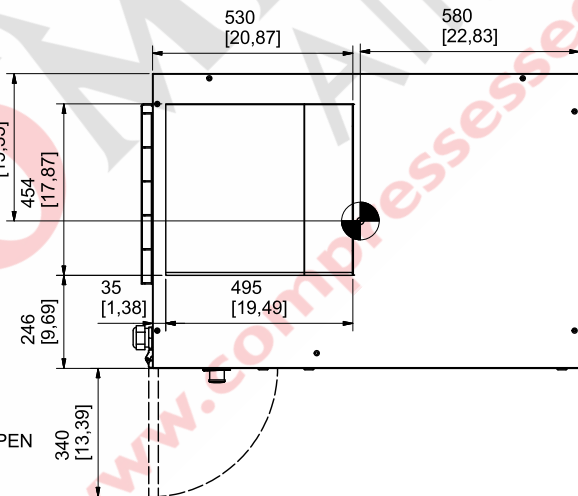
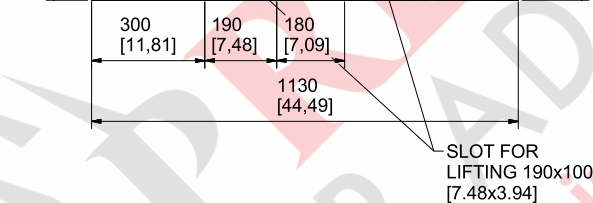

ALL DIMENSIONS: mm [inch]

AIR COOLING INLET GRID DIMENSION [mm]				
	A	C	D	
15 kW / 20HP	476,5	80	1 9,5	680
18,5 kW / 25 HP	476,5	80	1 9,5	680
22 kW / 30 HP	476,5	80	1 9,5	680
30 kW / 40 HP	520	45	270	590

AIR COOLING INLET GRID DIMENSION [in]				
	A	C	D	
15 kW / 20HP	18,8	3,15	4,7	26,77
18,5 kW / 25 HP	18,8	3,15	4,7	26,77
22 kW / 30 HP	18,8	3,15	4,7	26,77
30 kW / 40 HP	20,47	1,77	10,63	23,23

APPROX WEIGHT		
	50 (KG)	± 0 (lbs)
5 kW / 20HP	313	690
8,5 kW / 25 HP	328	723
22 kW / 30 HP	344	758
30 kW / 40 HP	444	979

Compressed Air Advisors, Inc.

Phone: 877.247.2381

info@compressedairadvisors.com

www.compressedairadvisors.com

DOOR FULLY OPEN

- Center of gravity

Tolerances, if not indicated, according to:									
Name		DIMENSION DRAWING C67-C80 BELT PACK FM			Confidentiality Class acc. to 1102 K				
Material		Not Applicable			Confidential				
Treatment		Not Applicable			INV				
Scale		1 : 10	Family		C67-C80 Belt		Compare		Drawing Owner
Drawn by		caladanielt	Blank nr.				Replaces		Transferred from
Drawing format		Blank wt	Kg		Fini wt.		N/A		Designation
STATUS		A2	Des checked.		Prod checked.	Approved.	Date		09/04/2018
Parent 3D model		9828083716	Ed . Version 3D		00.01	Approved		Sheet 1 / 1	
								9828083716	

CONFIDENTIAL

This document is property of Atlas Copco AB and shall not without our permission be altered, copied, used for manufacturing or communicated to any other person or company.

01	ADDED MEASURE FOR 40HP - CID 26917- DN180625 22	09/04/2018	adanielt
Ed	Position	Modified from	Date
		Intr./Appd.	

9828083716	00.01
Parent 3D model	Ed . Version 3D