

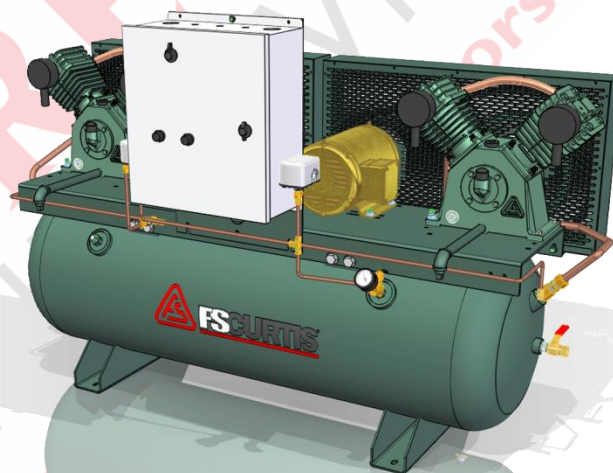

CC Series

CLIMATE CONTROL COMPRESSORS

SUBMITTAL DATA



WARNING

Personal injury and/or equipment damage will result by failing to pay attention to the vital safety information and instructions in this manual. Carefully read, understand, and retain all safety information and instructions before operating this compressor.

CURTIS SIMPLEX SPECIFICATIONS

CURTIS SIMPLEX COMPRESSORS STANDARD EQUIPMENT

- Splash lubricant system
- Horizontal ASME air receiver
- UL approved pressure switch
- OSHA approved totally enclosed belt guard
- ASME approved safety relief valve
- ASME approved discharge air service valve
- Slow V-belt drive
- Oil level sight indicator
- Manual condensate tank drain valve
- Premium Efficiency Motors (3-phase 1HP and up only)
- Large metal intake filter-silencers (Available only from 3HP and up)
- Pressure switch (0.5 and 1HP)
- Magnetic starter included (2HP and above)
- Dial read-out pressure gauge indicator
- Factory filled lubricant

OPTIONAL ACCESSORIES

- Discharge Air Line Filters
- Automatic Condensate Electric Traps
- Isolator Pads
- Spring Isolators
- PRV Station
- ODP Motor 3/60/575V

Refer to Simplex Specification for dimensions and available receiver sizes. Refer to required HP listed under Simplex Specifications for RPM and CFM.

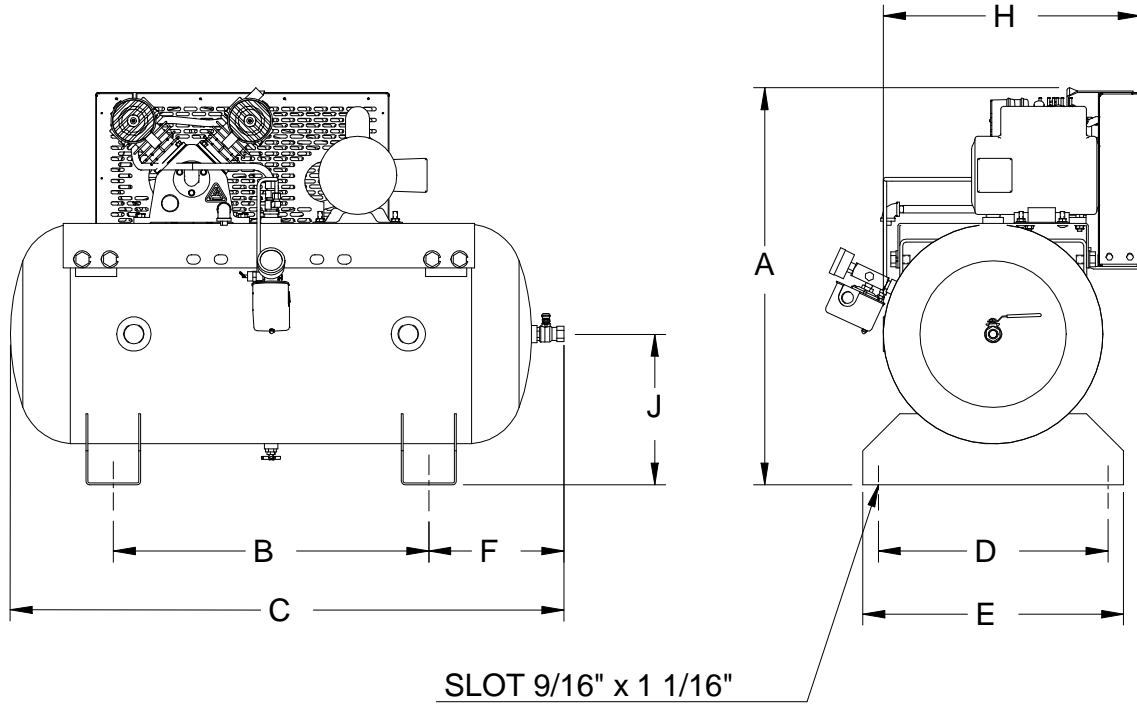

MODEL	MOTOR HP	RPM	CFM AT 80 PSI	TANK SIZE		DIMENSIONS								ESTIMATE WEIGHT (LB)	DISCHARGE NPT
				INCHES	GAL	A	B	C	D	E	F	H	J		
3SA3	0.75	530	2.1	19x39	30	32	23	42	17.375	19.25	11	16	11	165	1/2"
3SG5	1.5	490	4.1	19x39	30	36	23	42	17.375	19.25	11	19	11	220	1/2"
6SJ7	3	490	7.5	24x49	60	41	24	52	17.750	20	14	20	13	350	1/2"
8SN8	3	495	11.3	24x64	80	44	40	67	17.750	20	15	21	13	480	1/2"
8SN9	5	650	15.2	24x64	80	44	40	67	17.750	20	15	21	13	485	1/2"

COMPRESSED
AIR ADVISORS

Inc.

Compressed Air Advisors, Inc.

Phone: 877.247.2381

info@compressedairadvisors.com

www.compressedairadvisors.com

CURTIS DUPLEX SPECIFICATIONS

- When Large Amount of Air is Needed
- Alternating Operation for Greater Efficiency
- Uninterrupted Service During Compressor Maintenance

CURTIS DUPLEX COMPRESSORS STANDARD EQUIPMENT

- Splash lubricant system
- ASME air receiver
- UL approved pressure switch
- OSHA approved totally enclosed belt guard
- ASME approved safety relief valve
- ASME approved discharge air service valve
- Slow V-belt drive
- Oil level sight indicator
- Manual condensate tank drain valve
- Premium Efficiency Motors (3-phase 1HP and up only)
- Large metal intake filter-silencers (Available only from 3HP and up)
- NEMA-1 Alternator control panel
- Standard two power source
- Magnetic motor starters (60Hz)
- Dial read-out pressure gauge indicator
- Factory filled lubricant . 3 Position alternator switch

OPTIONAL ACCESSORIES

- Discharge Air Line Filters
- Automatic Condensate Electric Traps
- Isolator Pads
- Spring Isolators
- PRV Station
- ODP Motor 3/60/575V

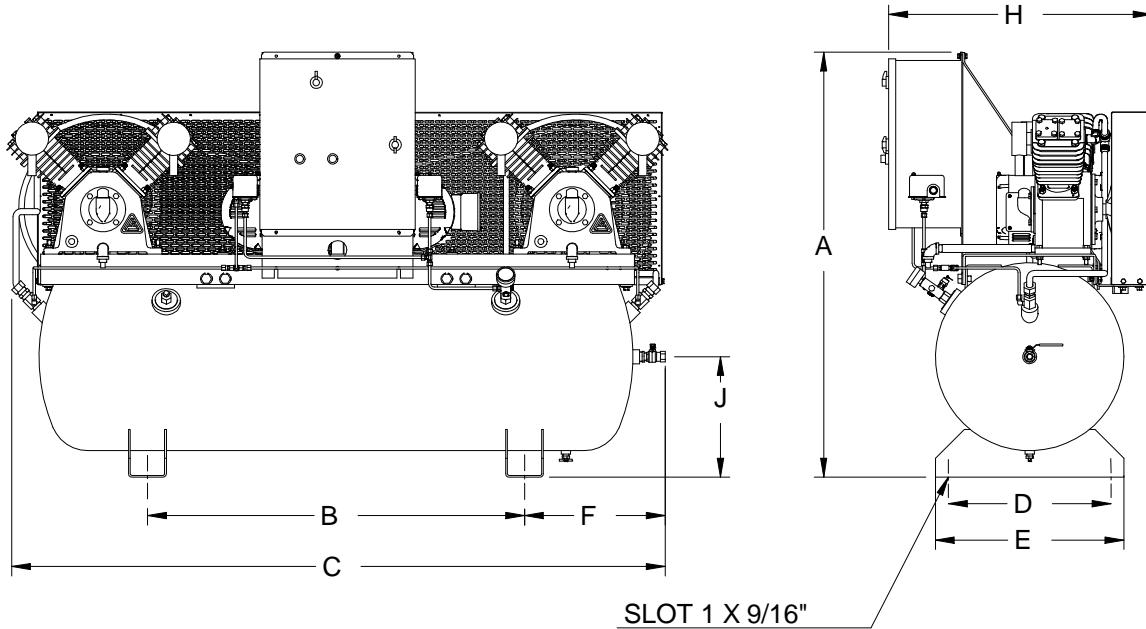

MODEL	MOTOR HP	RPM	CFM AT 80 PSI	TANK SIZE		DIMENSIONS								ESTIMATE WEIGHT (LB)	DISCHARGE NPT
				INCHES	GAL	A	B	C	D	E	F	H	J		
3DA3	0.75	530	4.2	19x39	30	44	23	50	17.375	19.25	11	25	11	255	1/2"
6DG5	1.5	490	8.2	24x49	60	46	28	61	17.750	20	14	23	13	470	1/2"
8DJ7	3	490	15	24x64	80	46	40	70	17.750	20	15	24	13	615	1/2"
8DN8	3	495	22.6	24x64	80	46	40	73	17.750	20	15	24	13	725	1/2"
12DN9	5	650	30.4	29x69	120	51	40	73	22	24	18	26	16	950	1/2"
20DT10	7.5	680	59.4	35x73	200	58	40	83	28	30	20	30	19	1475	1"

COMPRESSED
AIR ADVISORS

Inc.

Compressed Air Advisors, Inc.

Phone: 877.247.2381

info@compressedairadvisors.com

www.compressedairadvisors.com

NOTES

COMPRESSED
AIR ADVISORS
— www.compressedairadvisors.com —

NOTES

COMPRESSED
AIR ADVISORS
— www.compressedairadvisors.com —

COMPRESSED
AIR ADVISORS
www.compressedairadvisors.com



Curtis-Toledo, Inc.

1905 Kienlen Avenue | St. Louis, Missouri 63133

www.fscurtis.com