

HIGH-PRESSURE CNG FILTER SERVICE INSTRUCTIONS Series 175/075 Filters

CAUTION: Vent system pressure to atmospheric level prior to servicing filter. Failure to do so may cause serious injury.

Filter drain interval: 10,000 miles (reduce to 5,000 miles if high volume of oil is found – over 10ml.
 Element replacement: After 4 successful drains, or every 12 month.

When draining oil:

Unscrew drain plug from main housing and let oil drain out.

Replace o-ring on drain plug and torque drain plug to 21 ft lbs. (28 Nm).

Kit Contents: The filter service kit should contain a filter element and three O-rings, one already installed on the element.

The O-rings have been pre-lubricated and do not require additional lubrication prior to installation.

DO NOT RE-USE OLD O-RINGS

NOTE: Avoid introducing contaminants to the housing, housing threads, or the new element.

1. After the system pressure has been vented, remove the filter housing.

2. Remove the filter element by simply pulling it straight out of the bore. Discard the O-rings and the filter.

3. Remove the new O-ring from the bag making sure to keep it clean. Insert the new filter element cartridge. Place the new housing o-ring in the groove. Apply a thread lubricant to the housing threads. Screw the housing into the head being careful not to dislodge the o-ring.

4. Torque the housing to 40 ft lbs. (54 Nm).

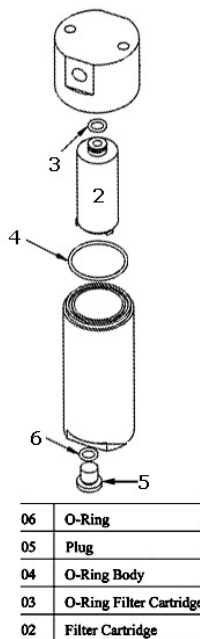

HIGH-PRESSURE CNG FILTER SERVICE INSTRUCTIONS Series 175/075 Filters

CAUTION: Vent system pressure to atmospheric level prior to servicing filter. Failure to do so may cause serious injury.

Filter drain interval: 10,000 miles (reduce to 5,000 miles if high volume of oil is found – over 10ml.
 Element replacement: After 4 successful drains, or every 12 month.

When draining oil:

Unscrew drain plug from main housing and let oil drain out.

Replace o-ring on drain plug and torque drain plug to 21 ft lbs. (28 Nm).

Kit Contents: The filter service kit should contain a filter element and three O-rings, one already installed on the element.

The O-rings have been pre-lubricated and do not require additional lubrication prior to installation.

DO NOT RE-USE OLD O-RINGS

NOTE: Avoid introducing contaminants to the housing, housing threads, or the new element.

1. After the system pressure has been vented, remove the filter housing.

2. Remove the filter element by simply pulling it straight out of the bore. Discard the O-rings and the filter.

3. Remove the new O-ring from the bag making sure to keep it clean. Insert the new filter element cartridge. Place the new housing o-ring in the groove. Apply a thread lubricant to the housing threads. Screw the housing into the head being careful not to dislodge the o-ring.

4. Torque the housing to 40 ft lbs. (54 Nm).

