

# **SEAVIEW**

**ELEVATE YOUR ELECTRONICS**

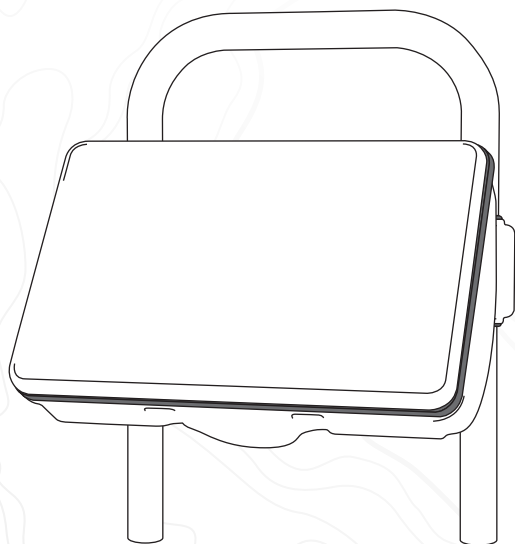

## **INSTALLATION INSTRUCTIONS**

For Seaview Sail Pods (SPOD):

**SP2S, SP3S, SP4S, SP5S**

Refer to website for most up to  
date instructions and videos.

## ***PARTS INCLUDED***

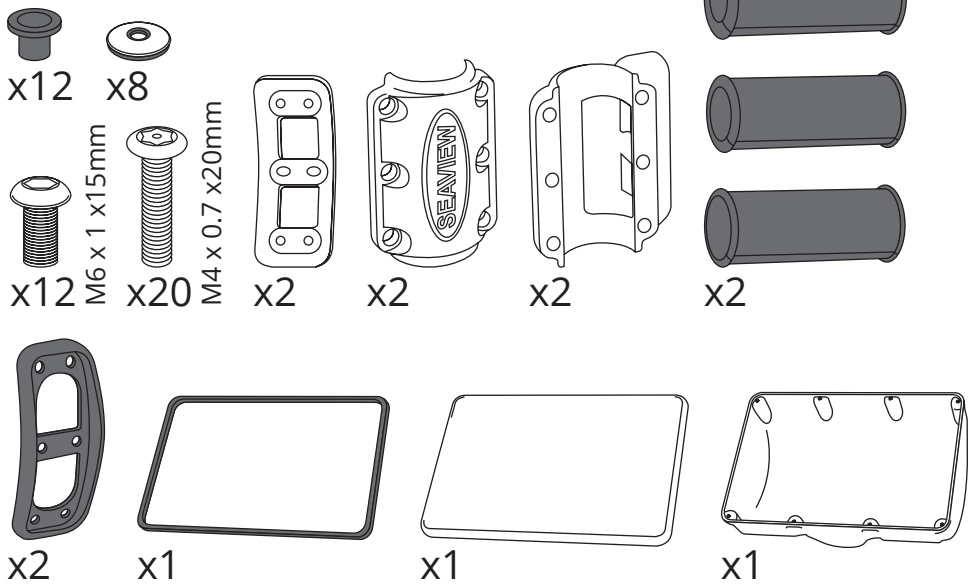

## TOOLS NEEDED

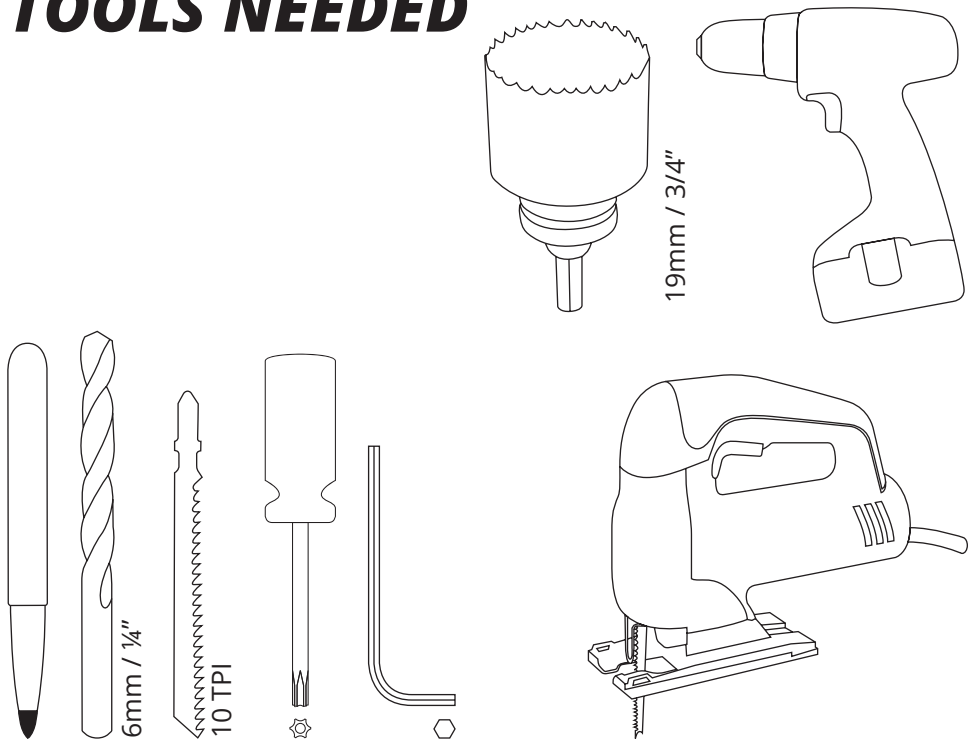

- 1** Install the appropriate rubber gasket for the clamp assembly and stainless steel clamps.

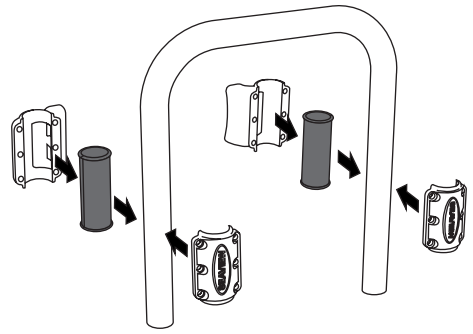

- 2** Make sure that the clamp assembly is level.

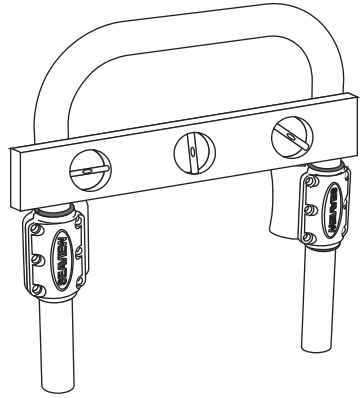

- 3** Secure the clamp assembly with the twelve black nylon shoulder washers and twelve M6x15mm bolts.

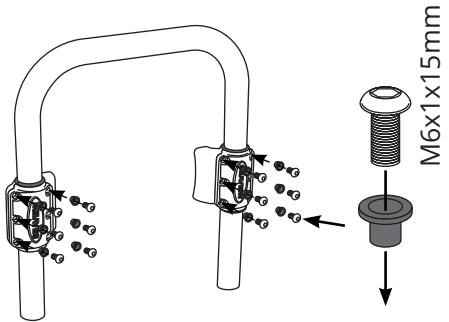

- 4** Apply painters tape to the back of the pod housing and or the drill template provided.

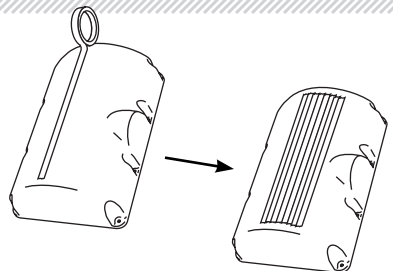

- 5** Place the two rubber gaskets onto the stainless steel clamps. Then place the housing onto the assembly.

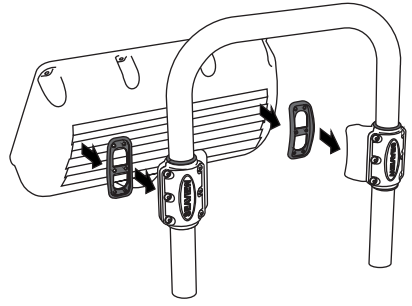

- 6** Adjust the housing for your desired mounting angle.

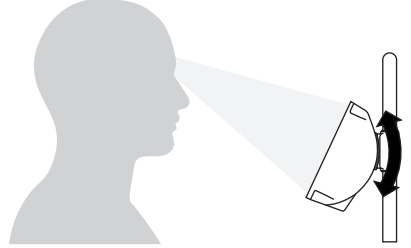

- 7** Once mounting angle is determined, use a pen to draw an outline around the rubber gasket. Then remove the assembly.

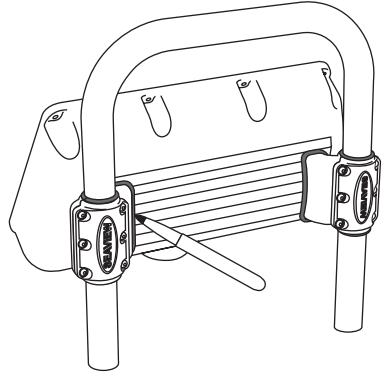

- 8** Place the rubber gaskets onto where you made your outlines.

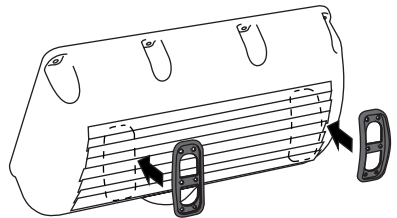

**9** Mark the six bolt holes per clamp with a pen.

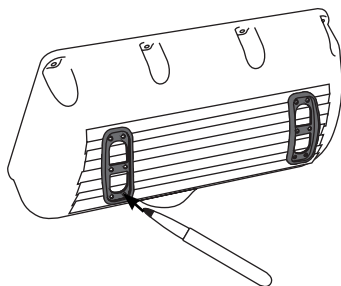

**10** Use a 6mm drill bit to drill out the holes you just marked.

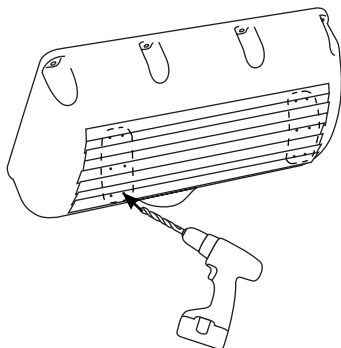

**11** Use a 19mm hole saw as shown to cut a hole for the cables to pass through.

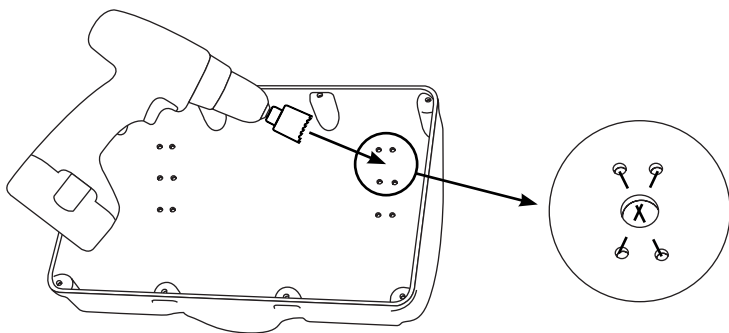

# 12

Remove the stainless steel clamps in order to gain access to the cable hole you are about to drill.

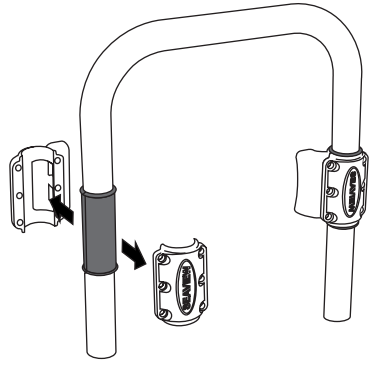

# 13

Orient the rubber grommet so that the opening is where you want the cables to pass through.  
Once aligned to your liking use a 19mm hole saw to drill a hole.

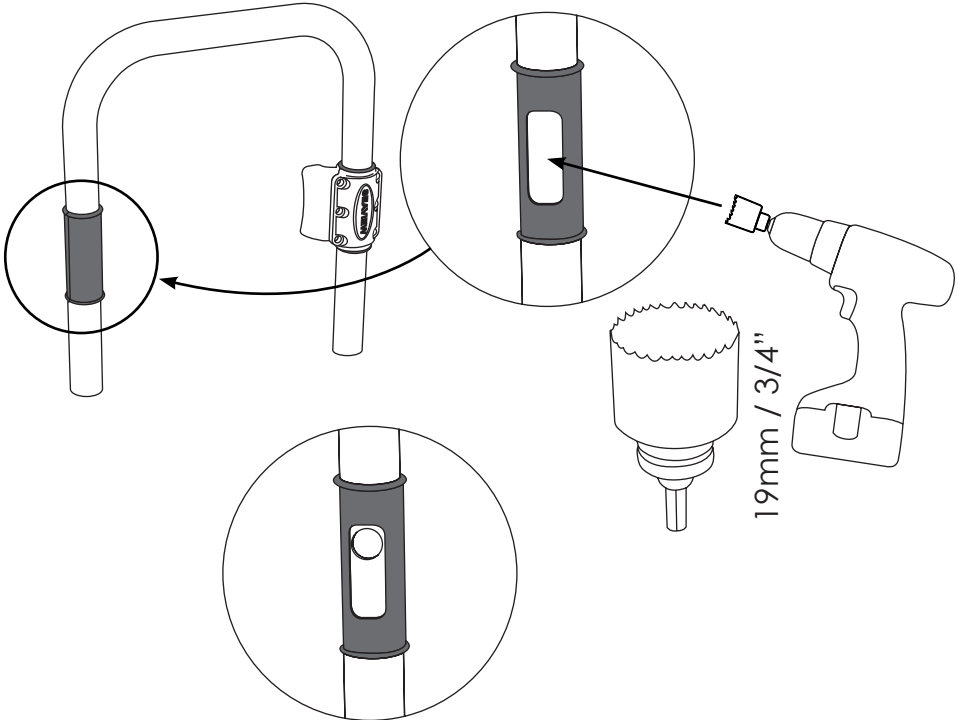

# 14

Install the stainless steel clamps.

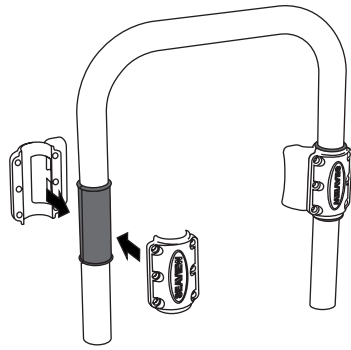

# 15

Secure the clamp assembly with the twelve black nylon shoulder washers and twelve M6x1x15mm bolts.

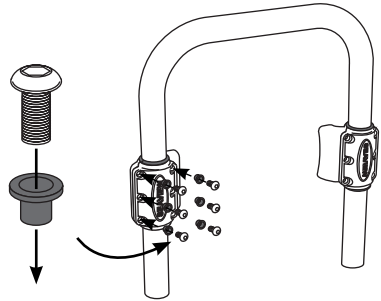

# 16

Place the white plastic backing plate in the SPOD housing as shown.

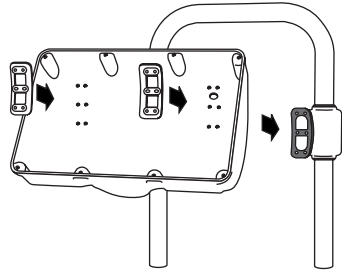

# 17

Secure the backing plate with the M4 x 0.7 x20mm bolts.

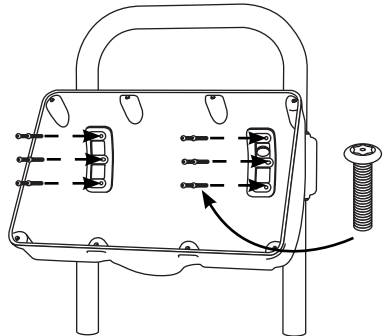

**18** Place the instrument template onto the lid of the SPOD.

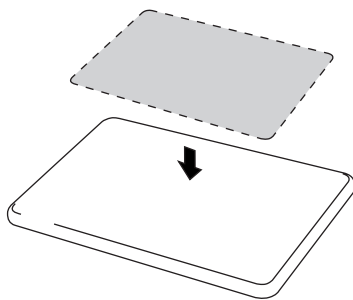

**19** Trace the template with a pen.

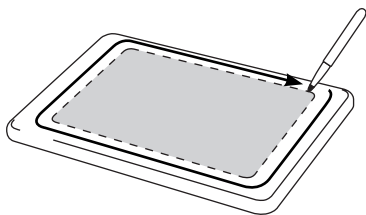

**20** Remove the template from the lid.

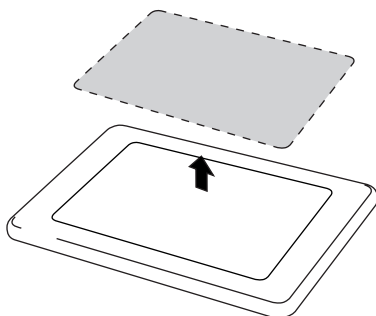

**21** Drill the mounting holes for your instrument. Follow the manufacturers instructions for this.

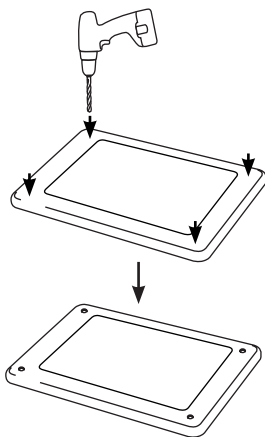

# 22

Use a jigsaw (10 TPI blade is recommended) and cut the line that you marked in step # 19.

Pro Tip: Use masking tape around the area you plan to cut to avoid unwanted marks from the jigsaw.

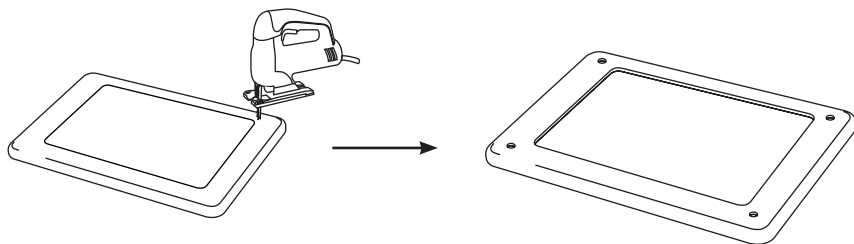

# 23

Install the instrument and cables.

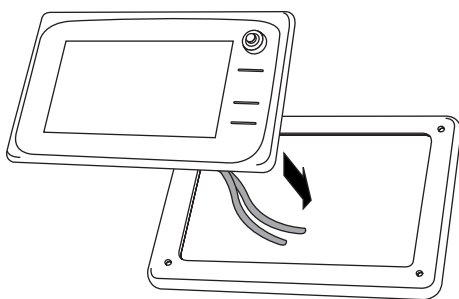

# 24

Pass the cables through the hole you drilled in step #11.

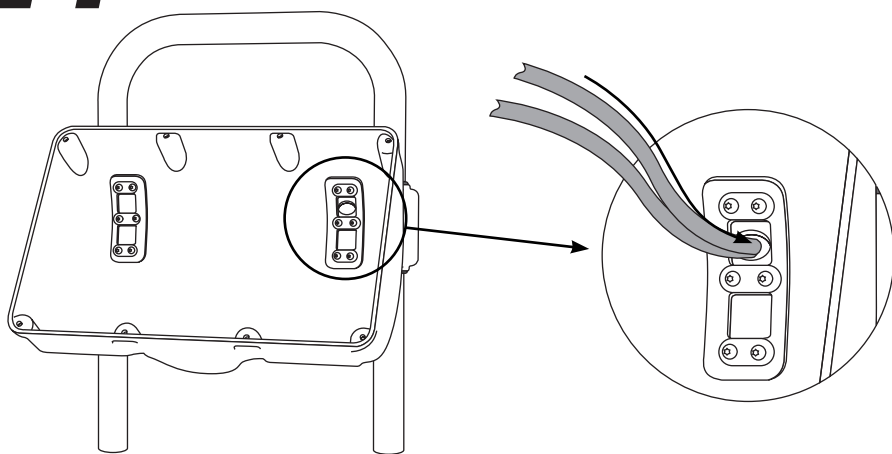

# 25

Install the rubber gasket and lid assembly on to housing. Note that the rubber gasket may already be installed onto the front face plate.

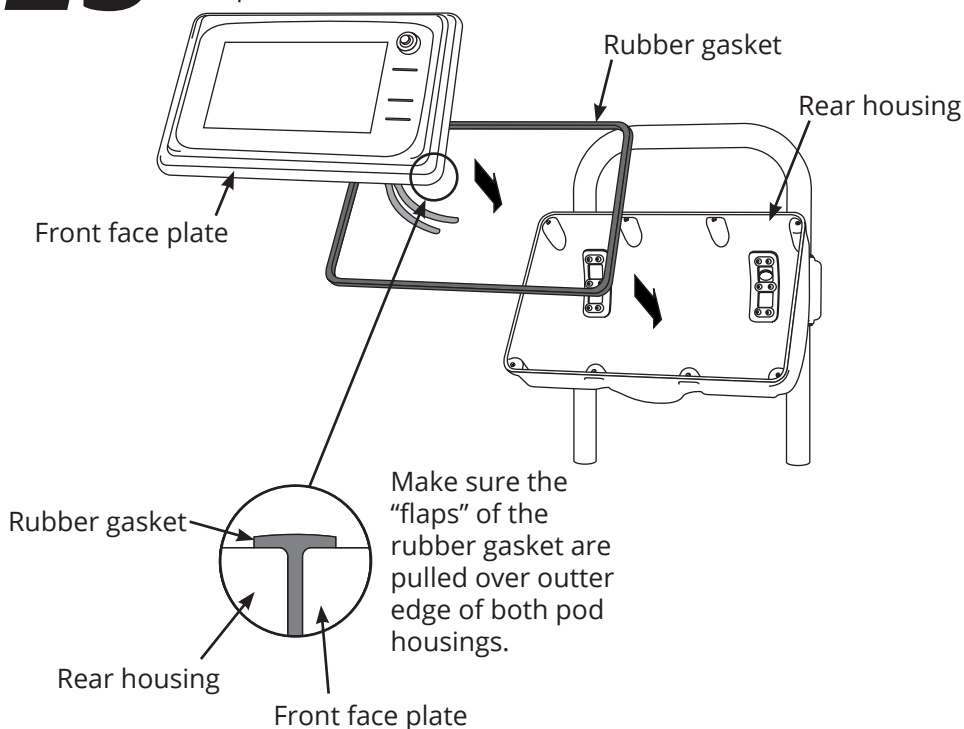

---

# 26

Secure housing assembly with the M4 x 0.7 x20mm and washers.

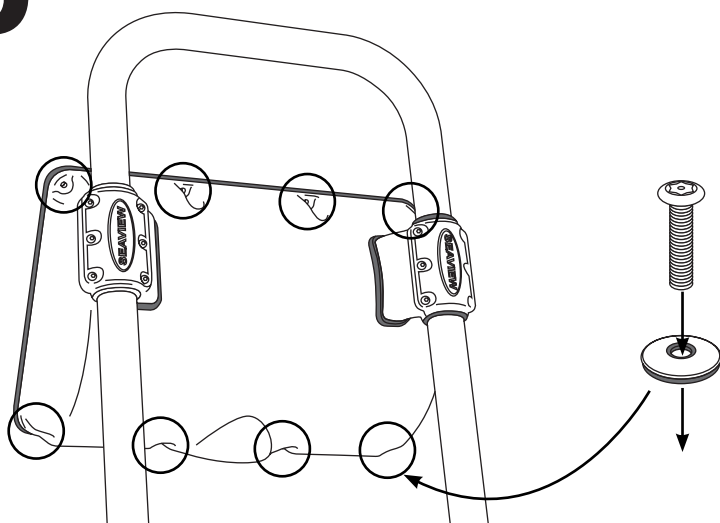

# ***OPTIONAL ACCESSORIES***

Call 800-655-7922 or visit [www.seaviewglobal.com](http://www.seaviewglobal.com) for available accessories.

## **ADD-ON SINGLE ACCESSORY POD**

\*Gives you the flexibility to mount additional instruments to SPOD\*

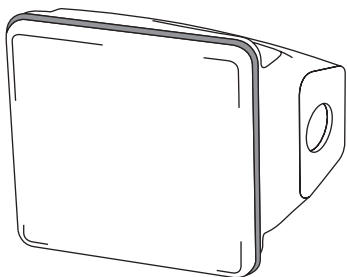

**SP1BOX**  
**(for most single instruments except the B&G Triton 2)**

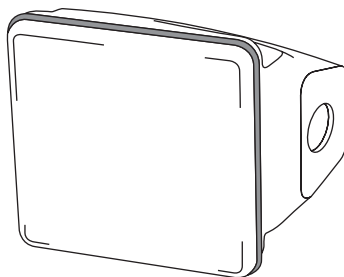

**SP1BOX2**  
**(for B&G Triton2)**

The background of the entire page is a light gray topographic map with white contour lines. The lines are irregular and wavy, creating a sense of depth and movement. The map covers the entire page, with the text elements overlaid on it.

# ***SEAVIEW***///

***ELEVATE YOUR ELECTRONICS***

***SEAVIEW***///

Tel: 800-655-7922  
[www.seaviewglobal.com](http://www.seaviewglobal.com)

***EUROPEAN OFFICE***

Tel: +33 4 94 53 27 70  
[www.seaviewprogress.com](http://www.seaviewprogress.com)

3-07052023