

SEAVIEW///

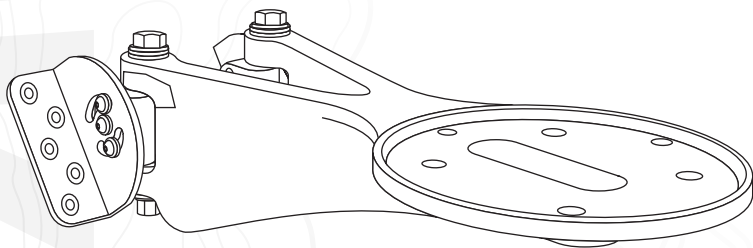

INSTALLATION INSTRUCTIONS

For Seaview Adjustable Flybridge
Mast Mount Adapter:

SMADFB

Refer to website for most up to
date instructions and videos.

WWW.SEAVIEWGLOBAL.COM

NOTE:

It is strongly advised that all installations are carried out by an authorized installer who possesses the necessary expertise and experience in marine equipment installation.

Furthermore, prior to the final installation process, we recommend performing a dry fit assembly of all components. This entails fitting the components in their designated positions on the boat without permanently affixing them. This step allows for careful assessment of compatibility, alignment, and any potential adjustments that may be required before proceeding with the actual installation.

PARTS INCLUDED

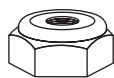

x6

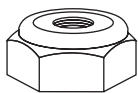

x2



x4

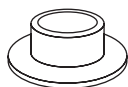

x10

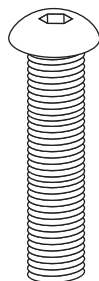

x6

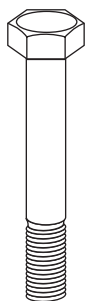

x2

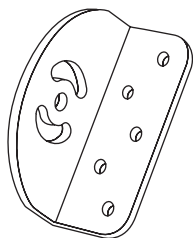

x2

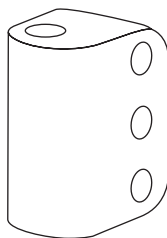

x2



x1 (CG20PG)

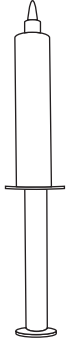

Tef-Gel or equivalent



3/16" = 4.7 mm



Sudbury Elastomeric Marine Sealant is recommended.

To purchase call 800-655-7922 or visit www.seaviewglobal.com

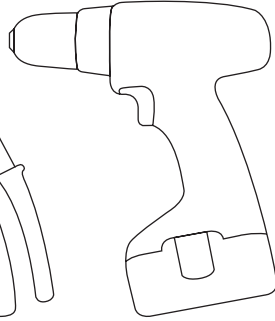
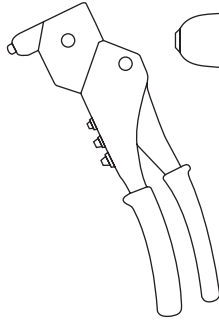
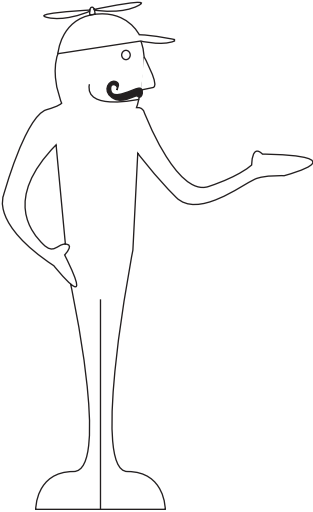

1

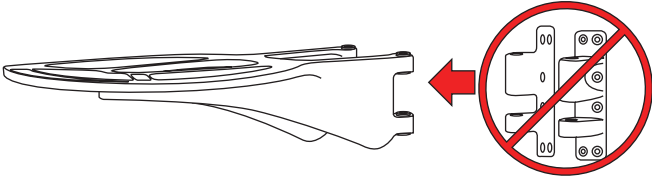

2

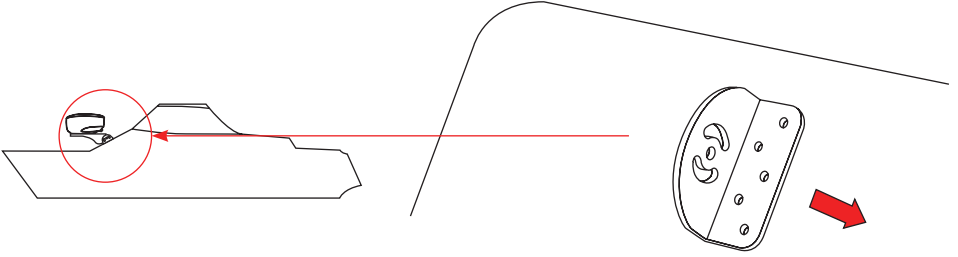

3

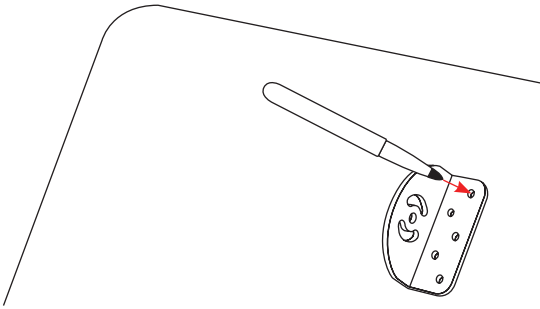

4

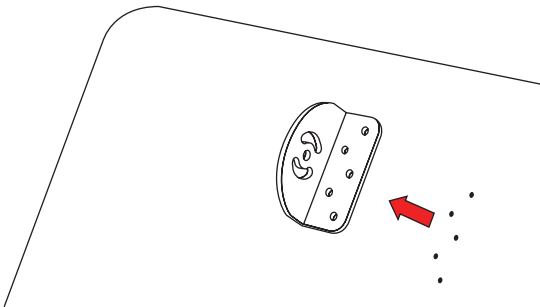

5

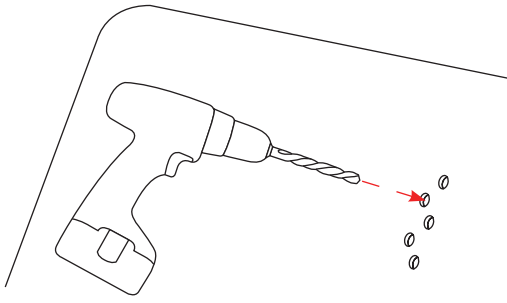

6

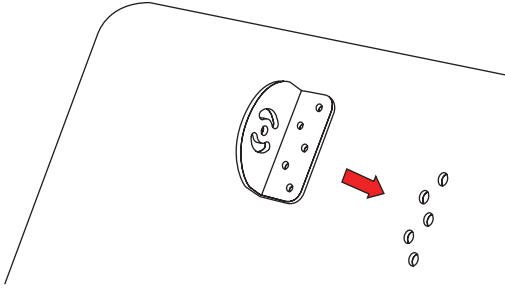

7

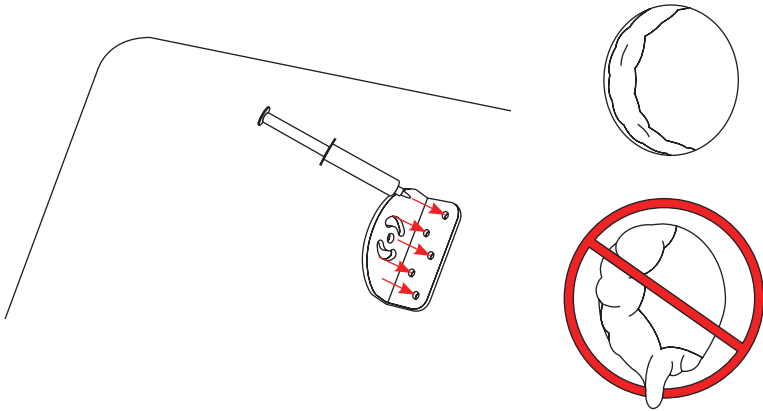

8

Note: Rivet, screw or bolt depending on mounting surface. Hardware not provided for this.

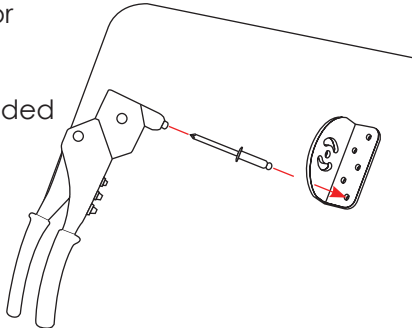

9

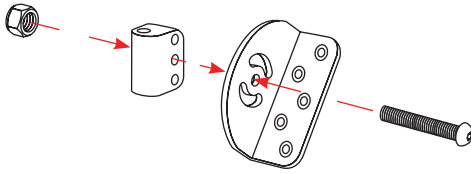

10

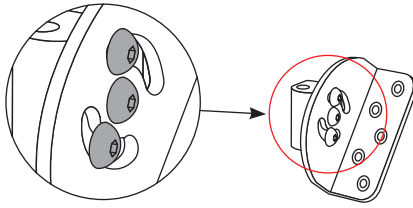

11

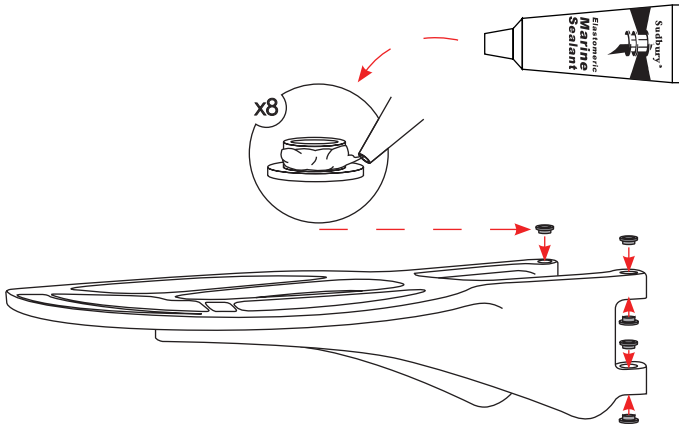

12

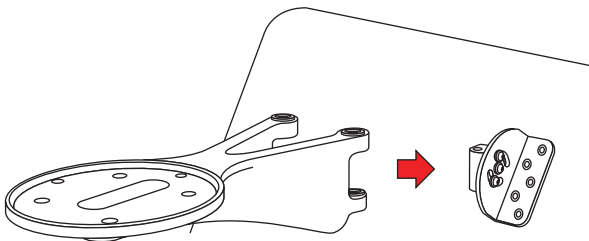

13

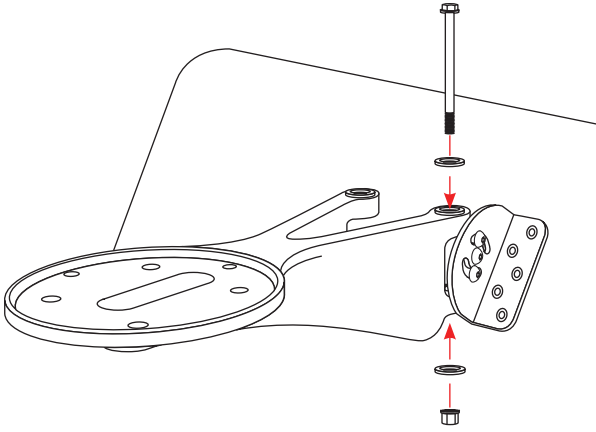

14

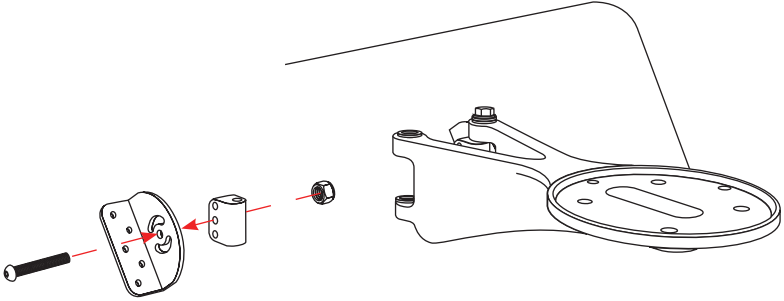

15

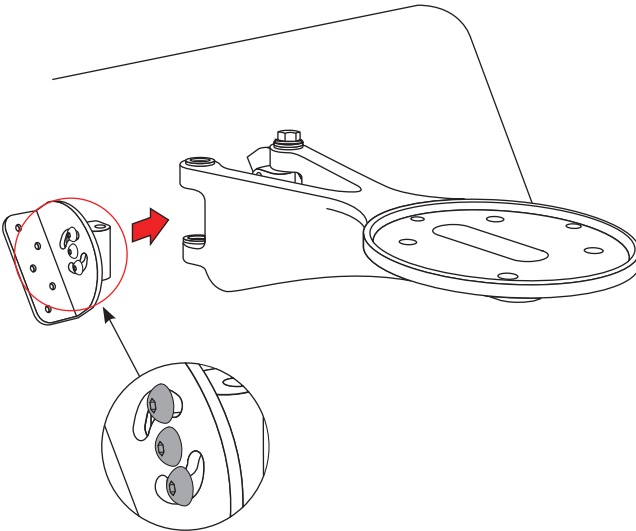

16

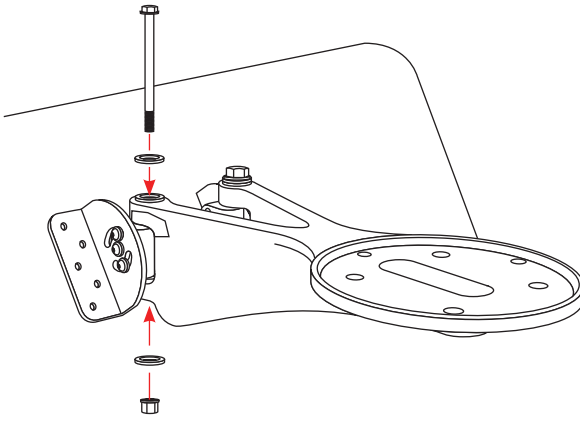

17

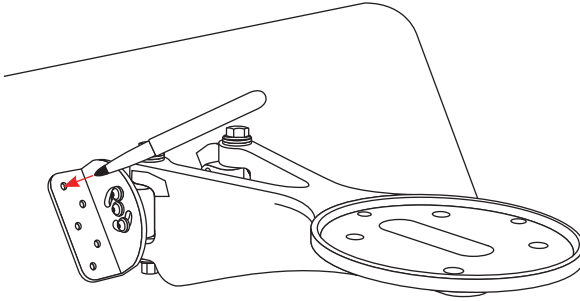

18

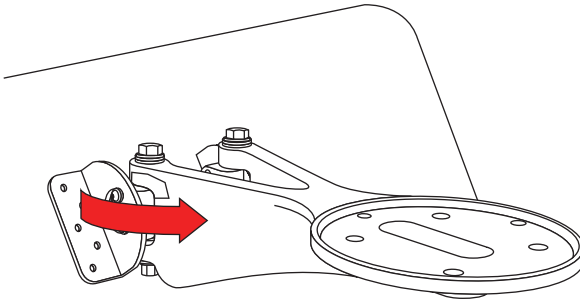

19

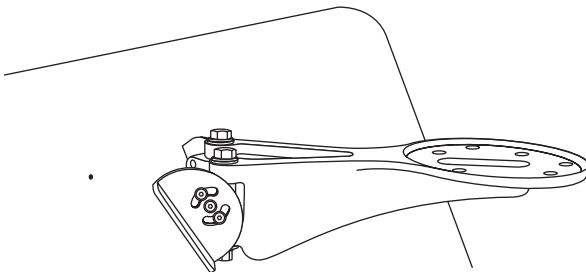

20

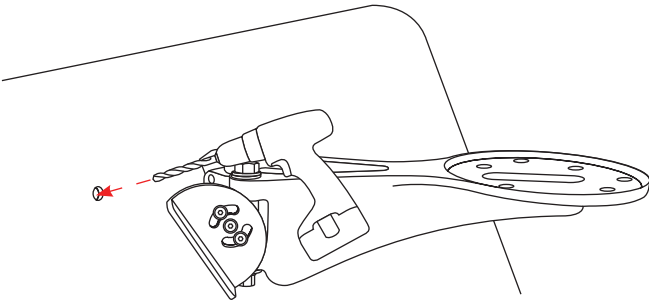

21

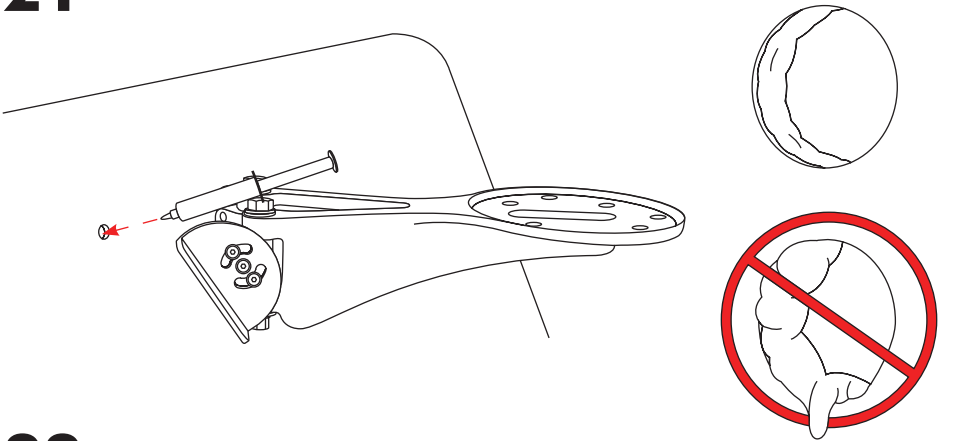

22

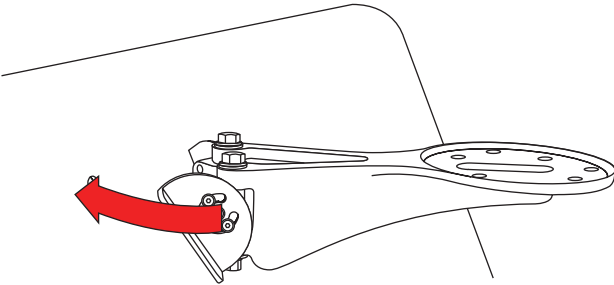

23

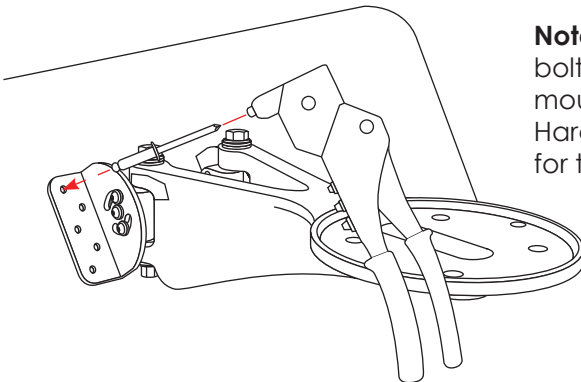

Note: Rivet, screw or bolt depending on mounting surface. Hardware not provided for this.

24

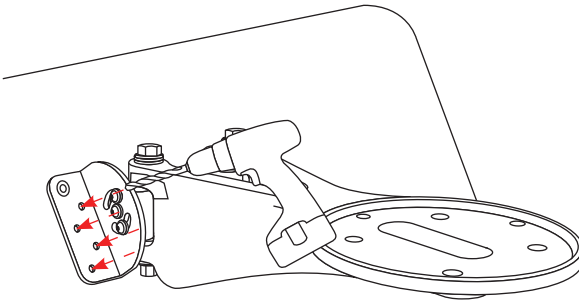

25

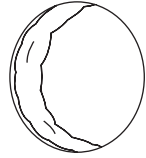
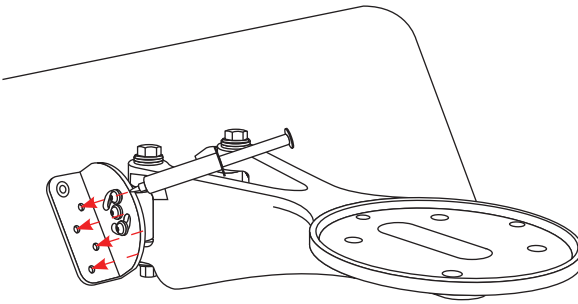

26

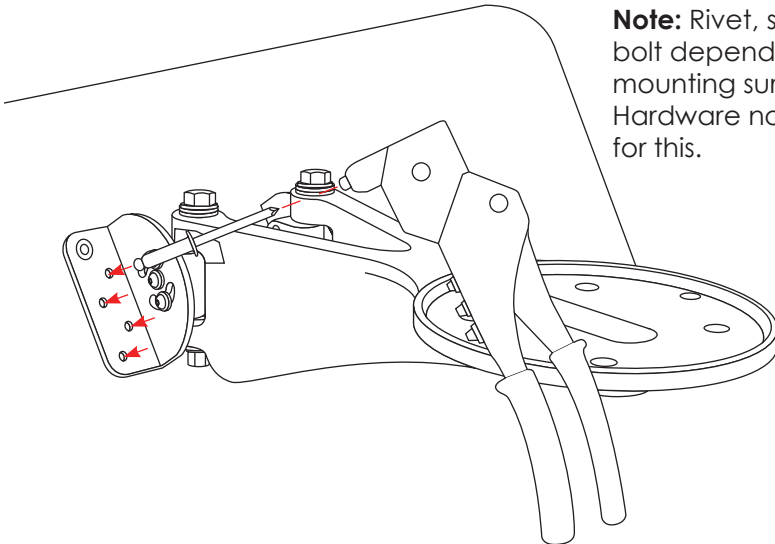

Note: Rivet, screw or bolt depending on mounting surface. Hardware not provided for this.

27

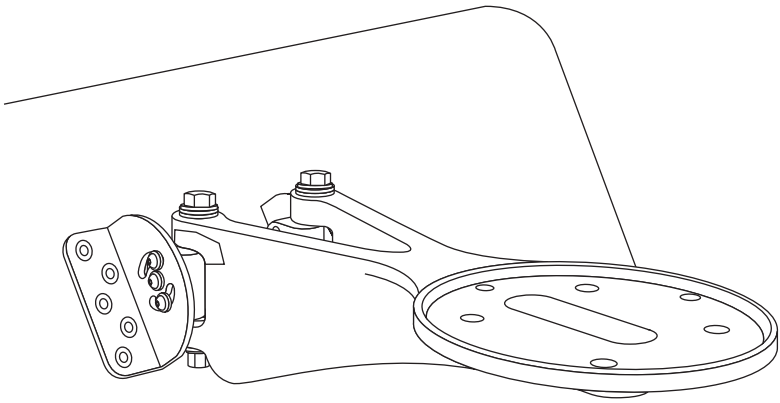

28

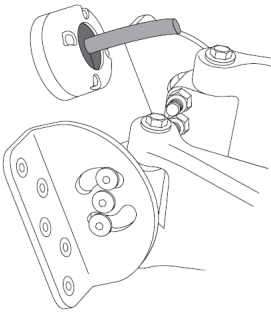

NOTE: Refer to cable gland instructions to follow

29

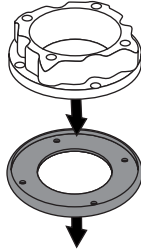

Place the plastic base onto the rubber base gasket. Be sure to line up the four screw holes.

30

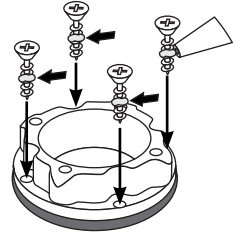

Drill pilot holes and secure the base. Apply marine adhesive sealant to the threads of the screws.

31

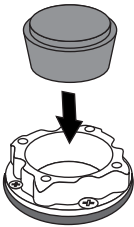

Insert the rubber tapered plug into the base.

32

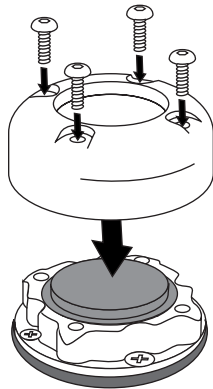

Line up the Cable Gland cover with the four holes in the plastic base and screw the bolts in with a 2.5mm wrench, compressing the rubber grommet.

33

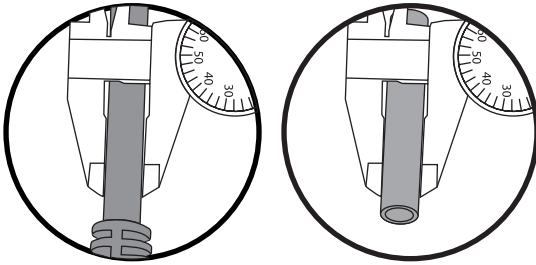

Measure your cable diameter and select the appropriate drill tube provided.

34

1



Take one of the four drill tubes (included with the Cable Gland). Double check to make sure the tube is the right diameter for your installation.

2

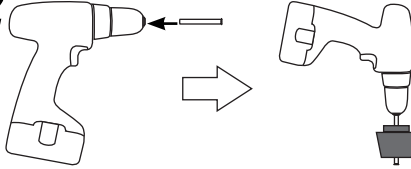

Insert drill tube into drill motor, and leave enough length to get through the tapered plug.

3

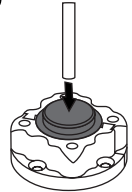

Apply small amount of soapy water to the tube and slowly drill the Cable Gland.

35

TIP#1

1/8"
(3.2mm)

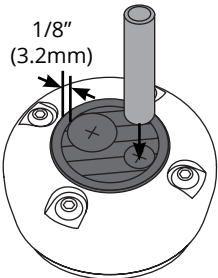

- Make sure that you do not drill within 1/8" (3.2mm) from the edge of the tapered plug.
- A slightly larger drill bit is needed for drilling the rubber.

36

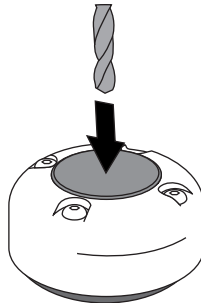

If using a drill bit, the drill should be run repeatedly through the rubber.

37

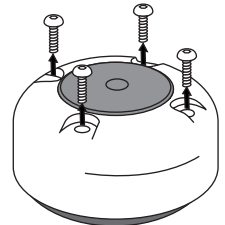

Remove the four screws using a 2.5 mm allen wrench.

38

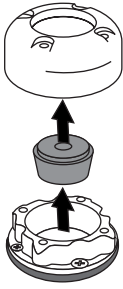

Remove the Cable Gland cover and tapered plug.

39

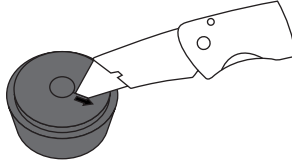

Using a sharp razor blade or knife, cut the tapered plug from the cable hole outward.

40

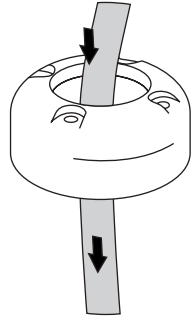

Slide the Cable Gland cover over the electronic cable.

41

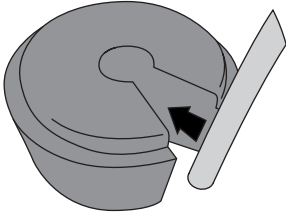

Wrap the tapered plug around the electronic cable.

42

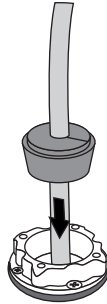

Insert the electronic cable and tapered plug into the plastic base.

43

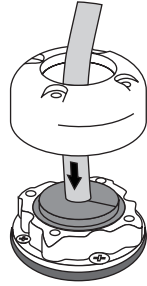

Slide the Cable Gland cover onto the plastic base making sure that all four bolt holes line up.

44

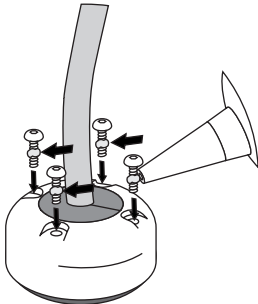

Apply marine adhesive sealant to the four allen head screws and tighten.

The background of the entire page is a light gray topographic map with white contour lines. The lines are irregular and wavy, representing elevation changes. The map covers the entire area, with the text elements overlaid on it.

SEAVIEW///
ELEVATE YOUR ELECTRONICS

SEAVIEW///

Tel: 800-655-7922
www.seaviewglobal.com

EUROPEAN OFFICE

Tel: +33 4 94 53 27 70
www.seaviewprogress.com

6-09072023