

# HORIZONTAL CABLE SEAL INSTRUCTIONS

# SEAVIEW

For Cable Seal Part Numbers  
**CG2090 | CG2090W**

Refer to website for most up to  
date instructions and videos.

[www.seaviewglobal.com](http://www.seaviewglobal.com)

## PARTS INCLUDED



**x4**  
(CGDTKIT)  
1x 6mm  
1x 8mm  
1x 10mm  
1x 12mm

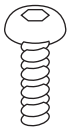

**x1**  
(M4716BHCS)



**x4**  
(6100SMS316)

## SUGGESTED TOOLS

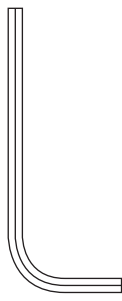

2.5mm

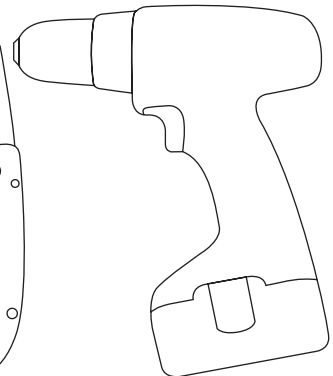
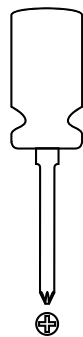

# 1

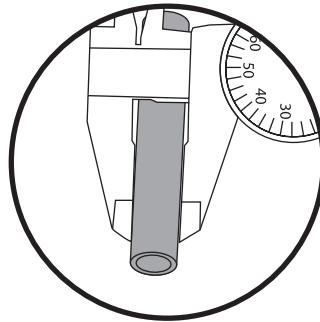
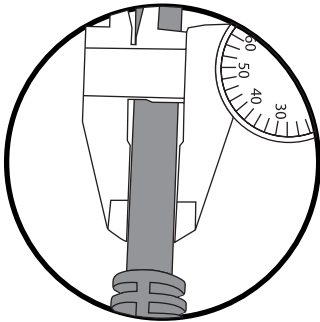

Measure your cable diameter and select the appropriate drill tube provided. Cable diameter  $+0.01/-0.03$

Drill tube is recommended. However, if using a drill bit, a slightly larger drill bit is needed for drilling the rubber.

# 2



Take one of the four drill tubes (included with the Cable Seal). Double check to make sure the tube is the right diameter for your installation.



Insert drill tube into drill motor, and leave enough length to get through the tapered plug.

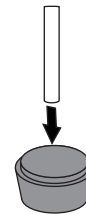
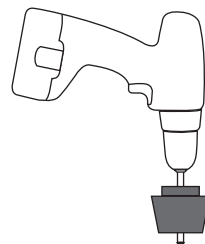
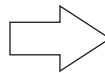

Apply a small amount of soapy water to the drill tube and or the top of the rubber bung. Then drill through the rubber while applying pressure. Make sure that you do not drill within 1/8" (3.2mm) from the edge of the tapered plug.

# 3

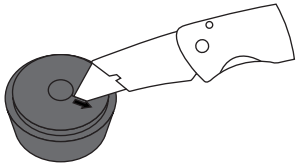

Using a sharp razor blade or knife, cut the tapered plug from the cable hole outward.

# 4

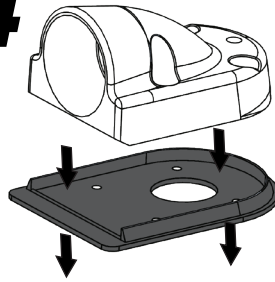

Place the plastic base onto the rubber base gasket. Be sure to line up the four screw holes.

# 5

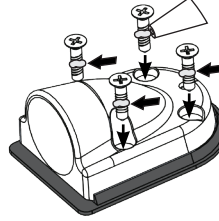

Drill pilot holes and secure the base. Apply marine sealant to the threads of the screws (optional).

# 6

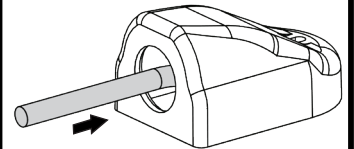

Insert the cable through the hole in the cable seal cover

# 7

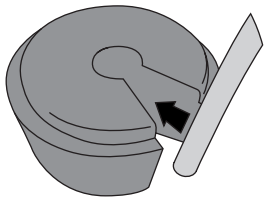

Wrap the tapered plug around the electronic cable.

# 8

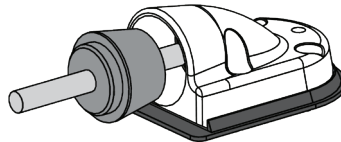

Insert the electronic cable and tapered plug into the plastic base.

# 9

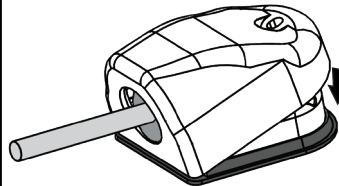

Slide the cover onto the base starting from the side with the cable and rubber bung. Firmly press the cover down so the hole lines up on top.

# 10

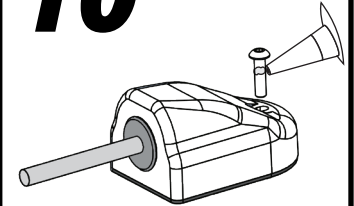

Apply marine sealant (optional) to the Allen Head Screw and tighten.

**SEAVIEW**

800-655-7922

www.seaviewglobal.com

1-12052023