

## Contact Us

If you have any questions, comments, or concerns, please don't hesitate to contact any of our Home Theater Gurus at 503.598.8815 or through a live chat via our website at [www.aperionaudio.com](http://www.aperionaudio.com) - they'll be happy to help you out with anything you might need.

### Email:

[customerservice@aperionaudio.com](mailto:customerservice@aperionaudio.com)

### Phone Number and Mailing Address:

1.503.598.8815

Aperion Audio  
25599 SW 95th Ave, Suite D  
Wilsonville, OR. 97070

## Limited Warranty

Aperion Audio, Inc. ("Aperion") provides to you, the customer, a transferable limited warranty that this Aperion Intimus® product is free from defective materials and workmanship for a period of five (5) years from the original date of purchase, if it is properly used and maintained. If this product proves defective in either material or workmanship, APERION, at its option, will (a) repair the product, or (b) replace the product, at no charge for parts or labor. If the product model is no longer available and cannot be repaired effectively or replaced with an identical model, APERION at its sole option may replace the unit with a current model of equal or greater value. In some cases, modification to the mounting surface may be required where a new model is substituted. APERION assumes no responsibility or liability for such modification.

## Obtaining Warranty Service

To obtain a repair or replacement under the terms of this warranty, please contact us at:

[customerservice@aperionaudio.com](mailto:customerservice@aperionaudio.com).

You will be required to provide your product model and serial number.

Please save the original shipping cartons, as the unit **MUST** be returned in the original carton and packing. (Replacement cartons may be available at a modest charge.) Return shipping for exchanges/repairs is the sole responsibility of the customer.

For the **limitations and your rights under this warranty**, please see:

<http://www.aperionaudio.com/pages/warranty>

® APERION, Intimus and the 3-bars logo are registered trademarks of Aperion Audio, Inc.

 aperionaudio®

# Intimus® Speakers

## Owner's Guide



## Features and Connections

### Intimus® Features

- 1" Audiophile-grade silk-dome tweeters
- Woven fiberglass composite woofers
- 5-Way gold-plated binding posts
- Anti-Resonant, internally braced cabinets
- Acoustically transparent grilles
- Custom Cast Aluminum Bases (towers only)

### Connections

To connect your speaker to your receiver you will need standard 2 conductor, stranded speaker wire. For instructions on installation, please read below.

### Preparing the Wire

- 1) Separate the last 4" of your speaker wire into two pieces.
- 2) Strip 1/2" off the shielding off of the end of each wire (see A below).
- 3) Twist the exposed copper strands with your fingers until they are tightly unified. Be sure there are no "flyaway" strands (see B below).

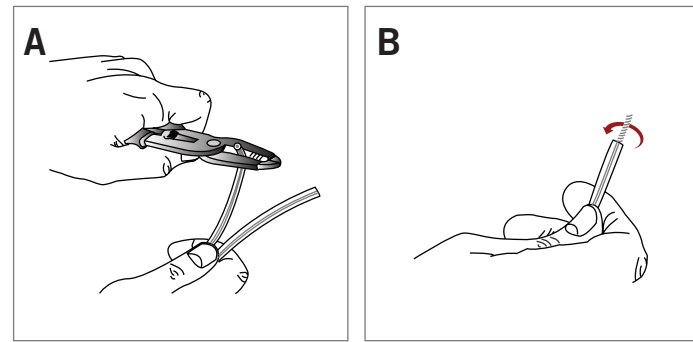

### If You're Using Bare Wire

- 1) Unscrew the binding posts on the back of your speaker by turning counter-clockwise.
- 2) Insert the bare speaker wire into the hole in the binding post and tighten it securely by turning clockwise.

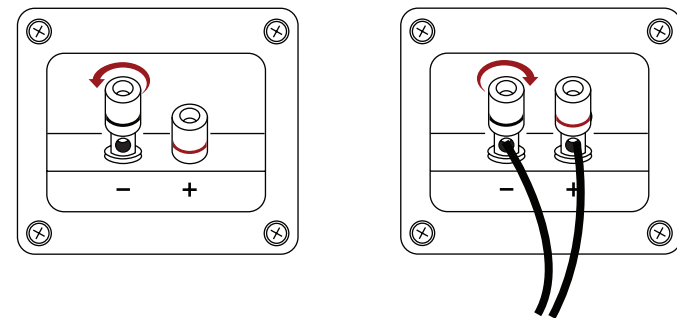

### If You're Using Banana Plugs

- 1) Be sure to follow the instructions on your banana plugs to attach them to the wire.
- 2) Screw the binding posts in completely by turning clockwise.
- 3) Insert them into the open end of the binding post.

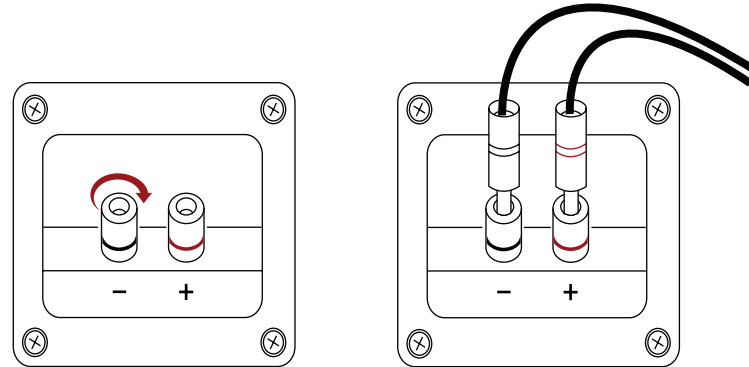

**Note:** As you make your connections, be sure to connect the positive terminals on your receiver to the positive terminals on your speakers. Most two conductor wire has screen printing on one side to help you differentiate between the two strands (see image below).

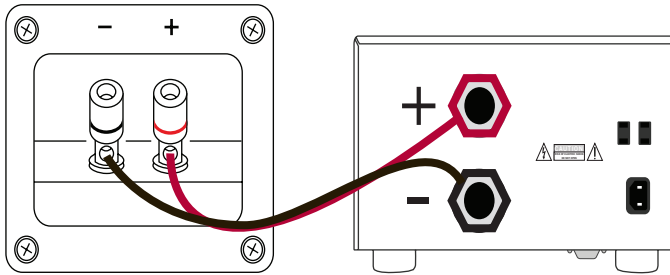

### Placement Recommendations

Each room is unique and unless the room was specifically designed to be a home theater, its acoustic properties will not be perfect. However, the following guidelines will help you get the most out of your speakers. Try to match the placement diagrams below as closely as you can. If you're using them as a surround speakers, they should be placed about two feet above the listeners' ears. Also, don't be afraid to experiment with placement. Often a small difference in placement can yield a big improvement in sound.

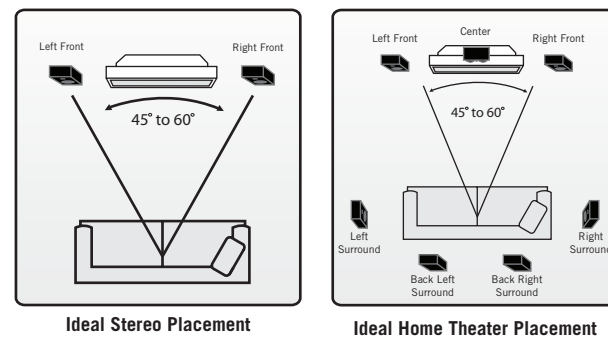

## Receiver Setup & Specifications

### Receiver Setup

Setting up speakers through your multi-channel receiver only requires a few simple steps. You may have a receiver that has an auto calibration microphone, and while these are convenient, they are not always accurate. For best results, we recommend accessing the setup menu of your receiver and manually setting up the speakers. Most modern receivers use an On Screen Display setup menu that makes setup a breeze.

1) In your receiver's setup menu, go to "Speaker Setup" or "Speaker Configuration". The setting for this speaker should be "Small" for bookshelves and centers, and "Large" for tower speakers.

2) Select your crossover point. This varies dramatically between speakers, and you should use the value in the speaker specifications (If your speakers are set to "Large" your receiver should automatically bypass the crossover.)

3) In the speaker distance menu, measure and input the distance between your primary listening position and your speakers and enter it here.

4) In the channel level menu you can set the volume level for each of the speakers in your system. The goal is to adjust each speaker to be the same loudness at your listening position. You can set this by ear, but we recommend using an SPL meter for best results. An SPL meter can be purchased on our website. [www.aperionaudio.com](http://www.aperionaudio.com).

### Intimus® Speaker Specifications

#### 4B Satellite Speaker:

Frequency Response: (+/- 3dB) 120-20,000 Hz  
(+/- 6dB) 100-22,000 Hz

Nominal Impedance: 8 Ohms

Sensitivity: 84 dB

Recommended Power: 50 - 150 Watts

Driver Configuration: 2-Way, Enclosure: Sealed, 15mm MDF

Dimensions: 8.75" H x 5.33" W x 5.5" D

Weight: 6.5 lbs.

Receiver Crossover Point: 100Hz

#### 4C Center Channel Speaker:

Frequency Response: (+/- 3dB) 80-20,000 Hz  
(+/- 6dB) 70-22,000 Hz

Nominal Impedance: 8 Ohms

Sensitivity: 84 dB

Recommended Power: 25 - 150 Watts

Driver Configuration: 2-Way, Enclosure: Sealed, 15mm MDF

Dimensions: 5.33" H x 12.8" W x 5.5" D

Weight: 8 lbs.

Receiver Crossover Point: 100Hz

#### 4BP Bipole Surround Speaker:

Frequency Response: (+/- 3dB) 100-15,000 Hz  
(+/- 6dB) 80-18,000 Hz

Nominal Impedance: 8 Ohms

Sensitivity: 87 dB

Recommended Power: 25 - 200 Watts

Driver Configuration: 2-Way, Enclosure: Sealed, 15mm MDF

Dimensions: 5" H x 12.5" W x 5.8" D

Weight: 8 lbs.

Receiver Crossover Point: 100 Hz

#### 5B Bookshelf Speaker:

Frequency Response: (+/- 3dB) 75-20,000 Hz  
(+/- 6dB) 62-22,000 Hz

Nominal Impedance: 6 Ohms

Sensitivity: 84 dB

Recommended Power: 50 - 150 Watts

Driver Configuration: 2-Way, Enclosure: Ported, 18mm MDF

Dimensions: 12" H x 6.75" W x 8" D

Weight: 14 lbs.

Receiver Crossover Point: 80Hz

#### 5C Center Channel Speaker

Frequency Response: (+/- 3dB) 60-20,000 Hz  
(+/- 6dB) 53-22,000 Hz

Nominal Impedance: 6 Ohms

Sensitivity: 86 dB

Recommended Power: 50 - 150 Watts

Driver Configuration: 3-Way, Enclosure: Sealed, 18mm MDF

Dimensions: 7.33" H x 19.33" W x 8" D

Weight: 22 lbs.

Receiver Crossover Point: 80Hz

#### 4T Tower Speaker

Frequency Response: (+/- 3dB) 55-20,000 Hz  
(+/- 6dB) 45-22,000 Hz

Nominal Impedance: 6 Ohms

Sensitivity: 86 dB

Recommended Power: 50 - 150 Watts

Driver Configuration: 2-Way, Enclosure: Ported, 18mm MDF

Dimensions: 34" H x 5" W x 7.5" D

Weight: 19 lbs.

Receiver Crossover Point: 55-80Hz

#### 5T Tower Speaker

Frequency Response: (+/- 3dB) 55-20,000 Hz  
(+/- 6dB) 45-22,000 Hz

Nominal Impedance: 6 Ohms

Sensitivity: 87 dB

Recommended Power: 50 - 200 Watts

Driver Configuration: 2-Way, Enclosure: Ported, 18mm MDF

Dimensions: 38" H x 6.3" W x 8" D

Weight: 36 lbs.

Receiver Crossover Point: 55-80Hz