

**LOFTEK®**

**Nova Power  
Jump Starter**

[www.loftek.us](http://www.loftek.us)

**Discover a wonderful life!**

 [techsupport@loftek.us](mailto:techsupport@loftek.us)

 [www.facebook.com/loftek.us/](http://www.facebook.com/loftek.us/)



## DANGER



Before using this product, please read and understand all instructions and safety warnings carefully. Failure to follow the instructions may result in ELECTRICAL SHOCK, EXPLOSION, or FIRE, which may result in SERIOUS INJURY, DEATH, DAMAGE TO DEVICE or PROPERTY. Do not discard this information. If the damage is caused by failure to follow the instructions, the warranty does not apply.



## WARNING:

- 1.) Keep the product in a dry place away from moisture, corrosion and flammable objects.
- 2.) Use of an attachment not recommended or sold by us may result in a risk of fire, electric shock, or injury to persons.
- 3.) Do not operate this product if it has received a sharp blow, been dropped, or otherwise damaged in any way. Please take it to a qualified service person.
- 4.) Do not disassemble this product by yourself. Incorrect reassembly may cause a safety accident.
- 5.) To reduce the risk of electric shock, unplug this product before attempting any maintenance or cleaning. Turning off controls will not reduce this risk.
- 6.) If the battery is swollen, leaks liquid or smells bad, stop using it immediately.
- 7.) Make sure the battery connector is clean, and battery clamp and cables are kept intact before using the product.

8.) Please charge the product in the temperature range of  $-10^{\circ}\text{C}$ – $45^{\circ}\text{C}$ , operate and storage it in the temperature range of  $-20^{\circ}\text{C}$ – $45^{\circ}\text{C}$ .

9.) It is forbidden to start the car when the power of the jump starter is less than 10%, otherwise it will cause damage to the product.

## What's In The Box

1

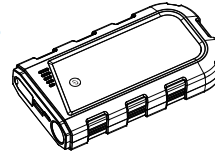

Jump Starter

2

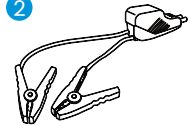

Jumper Clamps

3



USB Cable

4



User Guide

## Contact LOFTEK



Email: [techsupport@loftek.us](mailto:techsupport@loftek.us)



Facebook: [www.facebook.com/loftek.us](https://www.facebook.com/loftek.us)



Website: [www.loftek.us](http://www.loftek.us)

## At A Glance

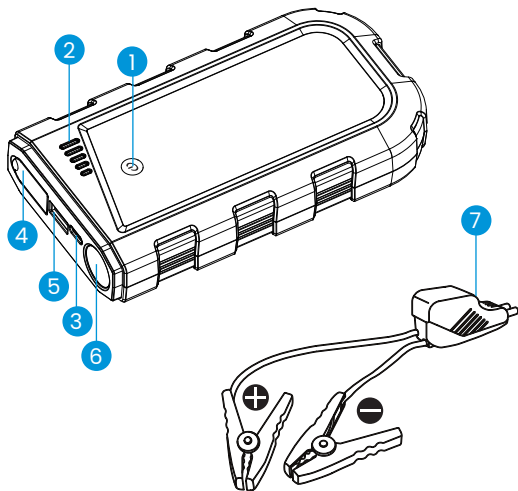

- 1. Function button
- 2. LED Indicators
- 3. USB-C Input
- 4. Jumping Port
- 5. Output 5V/2.1A
- 6. Flashlight
- 7. Indicator light on the clamps

## Jump Starting Your Car

1.) Turn on the function button and make sure it is over 40% charged. If the power is less than 40%, it may not be able to start your engine.

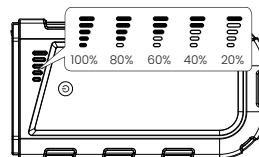

2.) Plug in the jumper cables. The indicator light will flash red and green alternately when it is in standby. Before starting your car, please make sure the indicator light on the clamps is turned to steady green. If you don't connect the clamps with the jump starter and the car well, the indicator light will stay red.

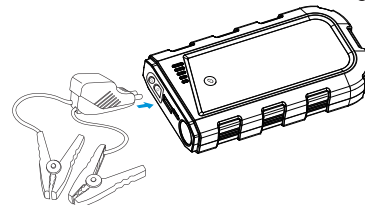

3.) Connect the red clamp to the positive terminal (+) and black clamp to the negative terminal (-) of your car battery. When the indicator light turns to steady green, it means that the clamps are connected well and it's ready to work.

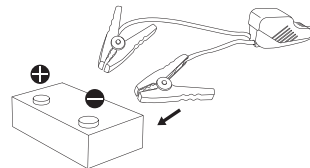

4.) Start your engine.

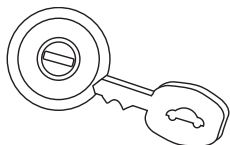

5.) After successfully starting your car, remove clamps and pack away.

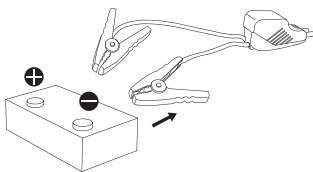

## Operational Warnings



1. To avoid serious injury to a person or damage to the jump starter, never attempt to connect the two clamps together. Connecting the positive and negative poles of the wiring will lead to short-circuiting, which is very dangerous.

2. Important: When using the device, only the original charger and clips that come with it are allowed. Please confirm that the clips of the jump starter clamp the positive and negative poles of the car battery correctly. If

the positive and negative terminals are reversed, it will cause damage to the vehicle.

3. Please fully charge the device before the first time use. And recharge it at least once every three months to prolong its life span if you don't use it for a long time.

4. Avoid overpressure. Please check the car voltage carefully. For example, a 12V jump starter can start a 12V car but not a 24V diesel car.

5. Please don't start the car continuously, between starting twice you should allow an interval of at least 30 seconds to 1 minute.

6. Please don't charge the device immediately after starting the car to avoid damage to the battery.

7. Please turn off unneeded appliances before starting your car with the device, such as car air conditioners, headlights, high-power speakers, and devices on the cigarette lighter. It will help start the car in an easier way.

## Smart Clamps

Smart clamps have multiple protection functions including Short Circuit Protection, Over Discharge Protection, Reverse Connection Protection, Reverse Charge Protection, Input Low / High Voltage Protection, High Temperature Protection and so on.

Function	Details
Short Circuit Protection	The red light is always on when the clamp is short-circuited, the buzzer sounds long, and the protection can be automatically released after the fault is removed.
Reverse Connection Protection	If the clamps are not connected to the correct positive and negative terminals, the light will turn red and the buzzer keeps beeping for a short time. The protection can be automatically released after troubleshooting.
Reverse Charge Protection	The output is automatically disconnected during reverse charge protection, and the traffic lights flash alternately. The protection can be automatically released after the fault is removed.
Input Low / High Voltage Protection	If the clamps are connected to the start port which is higher or lower voltage, the protection function will be triggered and the red light is always on.
High Temperature Protection	The clamps will automatically be disconnected when it is hot ( $\geq 80\text{ }^{\circ}\text{C} \pm 10\text{ }^{\circ}\text{C}$ ), and the light will keep showing red; when the temperature of the clamp is lower than $70\text{ }^{\circ}\text{C}$ , the protection is automatically released.

## How to use LED flashlight?

- 1.) Long press the function button for 3s to turn on the constant light.
- 2.) Then short press the function button, shifting to the SOS mode (Slow flickering).
- 3.) Short press again, shifting to Strobe mode (fast flickering).
- 4.) Long press the function button to turn off the light.

## Charging and Recharging

- 1.) Charge your phone or other devices

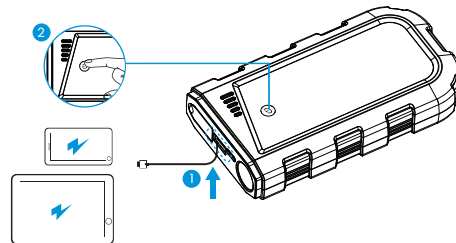

- 2.) Recharge your jump starter

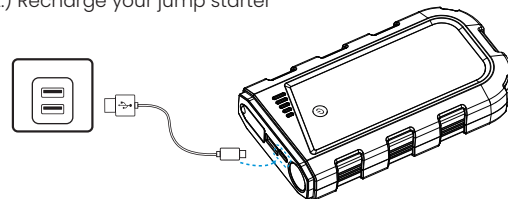



## WARNING



1. Simultaneous charging and recharging is not supported.
2. DO NOT start the car engine while charging the jump starter.

## Specifications

Starting voltage	12V
Input	5V/2A
USB output	5V/2.1A
Starting current	500A
Peak current	1000A

## Warranty and Customer Service

LOFTEK offers a 12-month limited warranty on quality-related issues. **Please register on our website to extend your warranty and view this manual in other languages.**

