

LOFTEK®

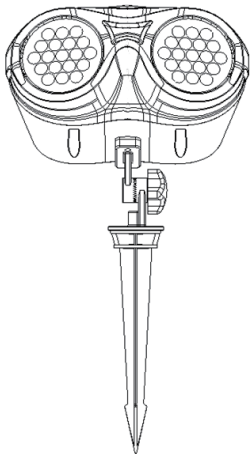

Snowfall LED Projector Light

www.loftek.us

About Us

LOFTEK was founded in 2009, we specialize in the development, design and manufacturing of LED lightings and other consumer electronics, only the brand "LOFTEK" and store LOFTEK Direct is authentic. Many competitors imitate our products with cheap material and fake advertisements, they use extremely low prices to attract customers, it looks the same in the pictures, but different when you received them. Especially in material, number of LEDs (affecting clarity), waterproof function, remote control range, etc.!

General Description

It works well in both indoors and outdoors, such as bedroom, living room, bar, children's room, nursery, corridor, deck, garden, lawn and festivals like birthday, Halloween, Christmas, wedding, new year, stage play, father's day, mother's day, even more, other occasions as decor light, ambience light, or night light, etc.

Specifications

Power Specifications	Power Input	100-240V AC 50/60HZ
	Input Current	0.25A
	Power Output	14V DC
	Output Max Current	0.64A
	Rated Output Power	8.96W
	Waterproof Rate	IP44
Product Specifications	Max Working Current	0.5A
	Application	Indoor and Outdoor
	Shell Material	ABS
	Projection Light Source	LED
	Color Temperature	8000-15000K

Product Specifications	Power Cord LengthWorking	5 Meters
	Temperature	-20~50 C
	Storage Temperature	-50~65 C
	Waterproof Rate	IP65
	Flash Speed Mode	4 Speeds
	Motor Speed Mode	3 Speeds
	Timer Time	2H, 4H, 6H
	Projection Distance	3-10M
Projected Area	Distance 5M	22 Square Meters
	Distance 10M	54 Square Meters
Remote Specifications	Remote Battery	1 X CR2025 Button Cell (included)
	Max Remote Rank	33FT/10M

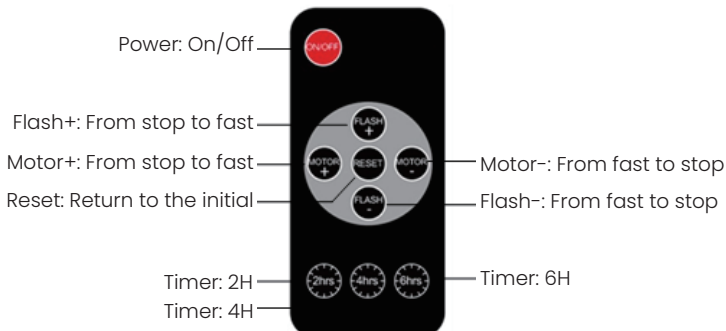

Flash(4 Speeds):

- Click once time: Flash every 2 seconds
- Click twice times: Flash every second
- Click three times: Flash twice per second
- Click four times: Stop flashing

Motor(3 Speeds):

- Click once time: Fast rotating
- Click twice times: Slow rotating
- Click three times: Stop rotating

Note:

The snowflake projection light with a 6-hour automatic shutdown function, it will automatically shut down after 6 hours of work for 18 hours, and then restart, this function will automatically cycle.

Safety information

Legal Declaration

LOFTEK is not responsible for any property damage or personal injury caused by any violation of this manual's safety requirements. Without prior written permission of LOFTEK, reproduction, transfer, distribution or storage of the contents in this document in any form is prohibited. LOFTEK operates a policy of ongoing development. Thus, LOFTEK reserves the right to make changes or improvements to any of the products described in this document without prior notice. The contents of this document are all provided "as is". Except as required by applicable law, no warranties of any kind, either express or implied, are made in relation to the accuracy of this document. For detailed information, please contact LOFTEK. This device may contain commodities and technology subject to export laws and regulations. Diversion contrary to law is prohibited.

* Please read all the safety and health information carefully before using your device to ensure its safe and proper operation.

Safety Notice

ONLY USE SUPPLIED ADAPTER!!!

This product has a polarized plug to reduce the risk of electric shock. It will therefore only fit into a polarized outlet one way. If the plug does not fit, reverse the plug. If it still does not fit, contact a qualified electrician. Do not use with an extension cord unless the plug can be fully inserted. Do not alter the plug.

DO NOT attempt to open the protective housing or operate the device if the aperture windows are damaged. If the unit requires service that involves removing the protective housing, contact the manufacturer. Opening the protective housing voids the warranty.

When the power cord interface of the lamp body is inserted into the power supply, it has a directional orientation. If the direction is not correct, it will damage the power supply or the power cord, the right insert As shown below:

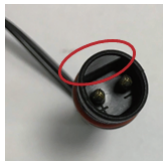

Power cord red circle protruding position



Power supply Red circle in the recessed position

Correct connection method: Insert the power cord protruding position corresponding to the power supply recessed position

Preparation Before Installation

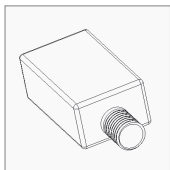

Power Supply
Adapter



Ground Stake

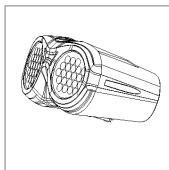

Projector Light

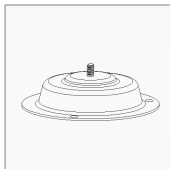

Mounting Plate



Fixed screw

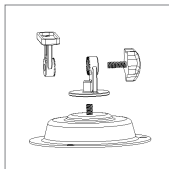

Support frame



Remote Control

Assembly Process

Step 1: To attach the ground stake, remove the screw from the stake.

Step 2: Use the screw to attach the stake to the pivot mount (see fig. 1).

Step 3: Plug the 2-prong adapter into the outlet on the power supply transformer. Screw on the weather-resistant cap tightly to help protect the connection from the weather.

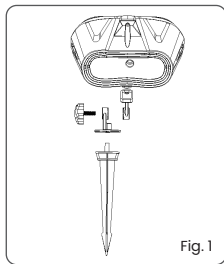

Placing the Projection Light

1. The projection light can be staked into the ground. With the stake removed, it can also be mounted to a structure using a sturdy hanging clamp and safe cable.
2. Place light approximately 10 to 15 feet from the projection surface (see fig. 2). After the light is adjusted angle you may need to adjust the distance to get the best results.

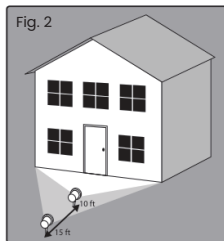

Adjust the Clarity

Position the angle of projection by loosening and tightening the angle adjustment screw (see fig.3). connected to a properly grounded outdoor outlet.

Do not use with dimmers.

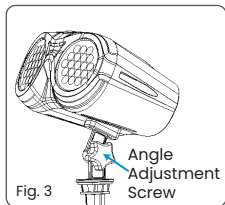

Tips

1. For the longevity of the projector light, it is recommended to work for six hours and rest for half an hour after use;
2. When the projection is not clear, please adjust the clarity by adjusting the distance;
3. When the remote control does not work, please try to replace the remote control battery;
4. Please do not immerse the projector light in water or place it in a place with stagnant water;
5. Please storage should avoid high temperature or humid environment, so as not to damage the film;
6. When not in use for a long time, please turn it on regularly to keep the motor active;
7. The remote control is not waterproof, please do not expose it to water.

LOFTEK 12 months warranty

*30-day free return and quickly unconditional refund;

*Lifetime prompt buyer support and friendly customer service.



Discover a wonderful life!



techsupport@loftek.us



service-eu@loftek.us



<https://www.loftek.us/>



Barksdale pro ctr, Newark DE, United States 19711

EU REP

AMZLAB GmbH
Laubenhof 23, 45326 Essen, Germany

UK REP

THEMIS AR support ltd
85 Great Portland St, London, United Kingdom, W1W 7LT