



# MAYTECH INNOVATIONS CO., LTD.

MTSPF160A-WP32 Maytech 160A 32bit Waterproof ESC Ver.20231211

- **Specs.**

1. IP68 fully waterproof, can directly work in water.
2. Continuous current: 160A
3. Burst Current(at 10S): 180A
4. Working Voltage: 6-14S Lipo cells (Max 58.8V)
5. Net Weight: 180g , including wires 510g ( about 15cm wires for motor, 1-1.15m for battery)
7. Programmable cable(2-core) : Green-RX, Yellow- TX
8. Signal cable(3-core) : to connect receiver, eg. Maytech MTSKR1905WF receiver

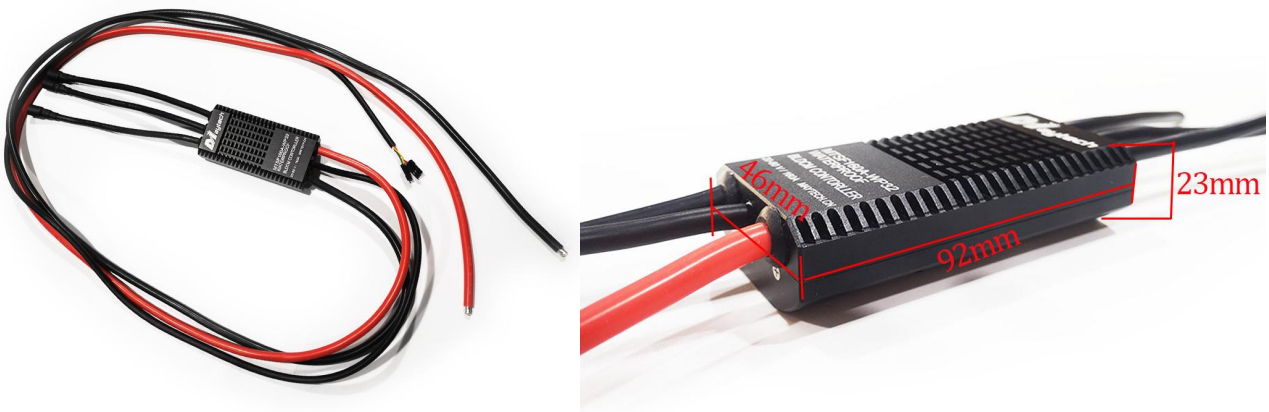

- **Wiring Instruction, signal and programmable cable**

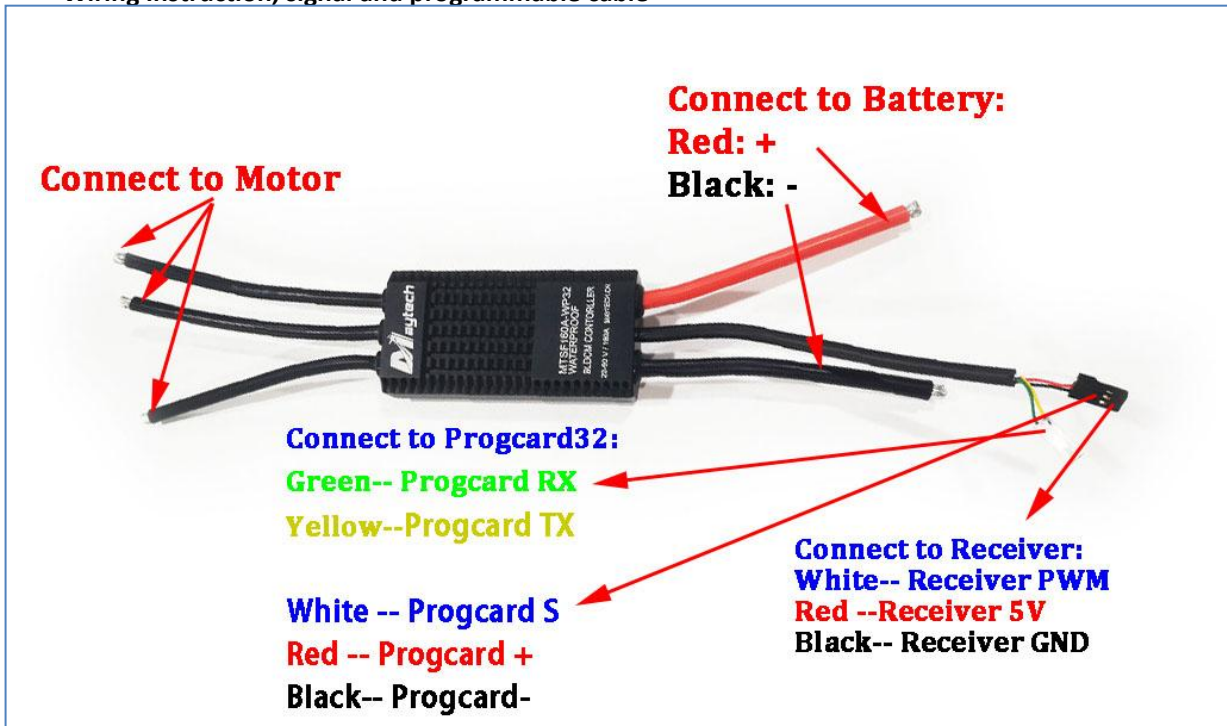



# MAYTECH INNOVATIONS CO., LTD.

To connect MTSKR1905WF receiver :

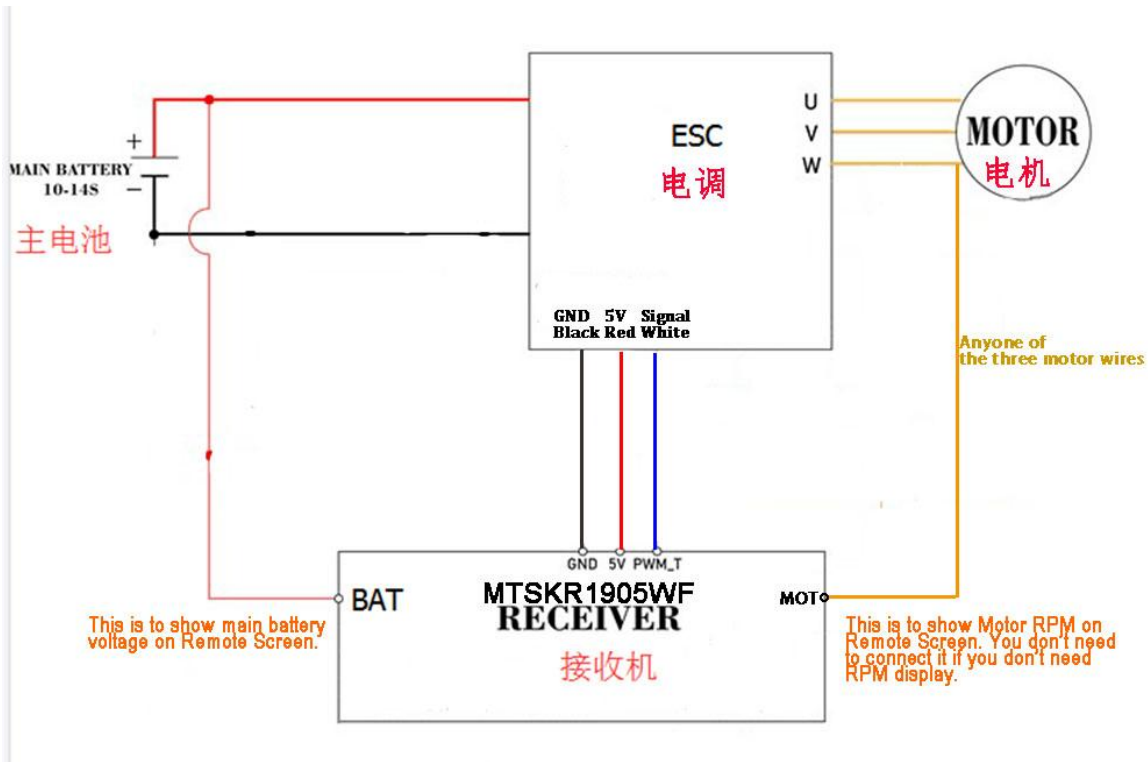

## ● How to do ESC throttle calibration with Remote:

Please Refer to Youtube Video: <https://youtu.be/zYmn57Is144>

Important: Please make the throttle calibration for the first time using ESC.

Throttle calibration by pistol transmitter:

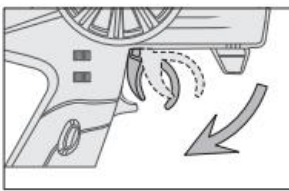

Connect the battery pack to the ESC and wait for about 2 seconds.

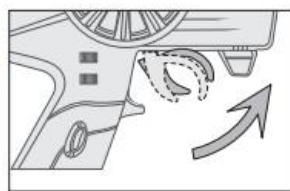

The motor will beep for twice, then release the throttle stick to the neutral position in 3 seconds.

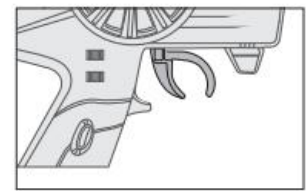

When the motor emits a long "Beep----Beep", means the ESC is ready to work.

## ● Program settings via progcard32

1. Connect progcard: It needs to connect ESC to battery to power on progcard. (Battery voltage needs to be 6S Lipo and above)



2. Program se



## MAYTECH INNOVATIONS CO., LTD.

### 1. SMR Function: **OFF**/ON

This setting is no-use for electric watersports. Please keep it at “OFF”.

### 2. Brake Type: **OFF**/ON

This setting is no-use for electric watersports. Please keep it at “OFF”.

### 3. Motor Timing: **Auto**/5° /10° /15° /20° /25° /30°

Please keep it at Auto.

### 4. Motor Rotation: **CW**/CCW

CW: motor default rotation direction

CCW: Change the direction of motor rotation

### 5. SR Function: **OFF**/ON

This setting is no-use for electric watersports. Please keep it at “OFF”.

### 6. Battery Cells: **Auto**/6S/8S/10S/12S/14S

Auto: Calculate the number of battery cells based on 3.8V of a single battery cell

Manual setting(6-14S): Manual setting according to different voltage ranges.

### 7. LVC: OFF/3.0V/**3.2V**/3.4V/3.6V/NIMH60%

Low voltage protection. For Example: Use a 4s Lipo battery and set it to 3.0V as the low voltage protection value. The low voltage protection value is:  $3.0 \times 4 = 12.0V$ .

### 8. Cutoff Type: **Reduce Power**/Hard Cutoff

Reduce power: When the battery voltage reaches the preset low voltage protection value, the ESC reduces the output power to 70%;

Hard Cutoff: When the battery voltage reaches the preset low voltage protection value, the ESC immediately shuts down the output power.

### 9. BEC Voltage: **6.0V**/7.4/8.4V

This setting is no-use for electric watersports. Please keep it at “6.0V”.

### 10. Acceleratation: **Soft**/Normal

For Maytech Motors, please select “Soft”.

### 11. Startup Power: Low/**Mid**/High

For Maytech Motors, please select “Mid”.

### 12. Restore Default

To set all setttings to defaults.

## 3. Program process

3.1. Turn on the ESC power, pls make sure ESC votlage is over 20V.

3.2. Connect progcard

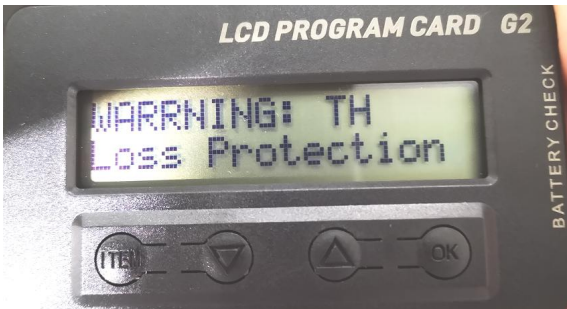

3.3. Press "ITEM" and it will connect progcard to ESC

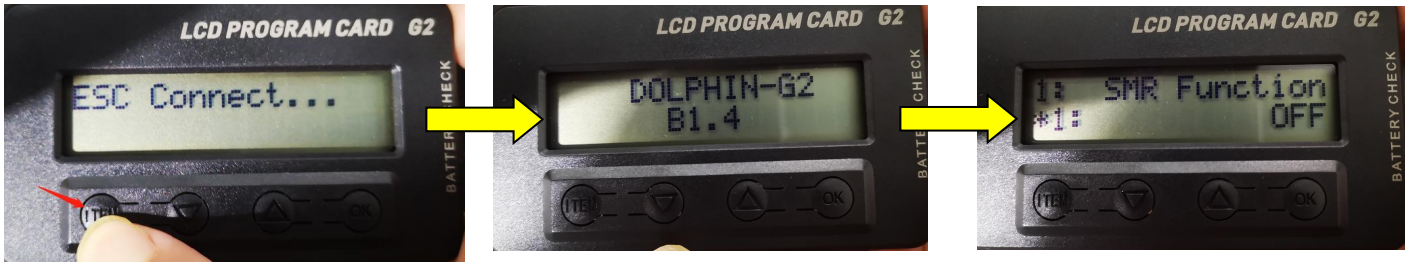

3.4. Then you can press "Item" to change switch different setting items. And press  $\Delta$  and  $\nabla$  to check each item options. And press "OK" to set the parameters you want ( Option with \* is the default setting).

3.5 After programming, you need to turn off ESC and disconnect progcard, reconnect ESC power, then adjusted parameters can be effective.

The users manual will be updated along with further product improvements. Pls contact us if any question when you use our products. You can reach us by whatsapp: 0086-18366153752, or email to [eileen@maytech.cn](mailto:eileen@maytech.cn).

**Contact:**

email: [support@michobby.com](mailto:support@michobby.com)

Web.: <https://michobby.com/>

Aliexpress Store:

<https://brushlesscontrol.aliexpress.com/store/1101457886>