

Brookstone®

SMART WATER SENSOR

USER MANUAL



FCC ID: Z52NAS-WS02W



RoHS



FCC Statement:

1. This device complies with Part 15 of the FCC Rules. Operation is subject to the following two conditions: (1) this device may not cause harmful interference, and (2) this device must accept any interference received, including interference that may cause undesired operation.

Caution: The user is cautioned that changes or modifications not expressly approved by the party responsible for compliance could void the user's authority to operate the equipment.

Note: This equipment has been tested and found to comply with the limits for a Class B digital device, pursuant to part 15 of the FCC Rules. These limits are designed to provide reasonable protection against harmful interference in a residential installation. This equipment generates uses and can radiate radio frequency energy and, if not installed and used in accordance with the instructions, may cause harmful interference to radio communications. However, there is no guarantee that interference will not occur in a particular installation. If this equipment does cause harmful interference to radio or television reception, which can be determined by turning the equipment off and on, the user is encouraged to try to correct the interference by one or more of the following measures:

- Reorient or relocate the receiving antenna.
- Increase the separation between the equipment and receiver.
- Connect the equipment into an outlet on a circuit different from that to which the receiver is connected.
- Consult the dealer or an experienced radio/TV technician for help.

2. This equipment complies with FCC radiation exposure limits set forth for an uncontrolled environment. This equipment should be installed and operated with a minimum distance of 20cm between the radiator and any part of your body.

For more products please visit www.brookstone.com

SPECIFICATIONS

Model: BKSSWS

Battery: CR2-3V x 1

Standby current: 13uA

Working current: 100mA-110mA

Standby time: 5 Years

Working time: 1 year (8 times/day);
2 years (4 times/day)

Wi-Fi Standard: 2.4GHz 802.11b/g/n

Wireless range: 147ft

Operating temperature: 32°F - 104°F

Operating humidity: 20% - 85%

Storage temperature: 32°F - 140°F

Storage humidity: 0% - 90%

System Support: Android/iOS

Size: 67mm x 67mm x 24mm

FEATURES

- Wi-Fi connected
- Sends alerts whenever water is detected
- Long battery life

WARRANTY INFORMATION

One Year Limited Warranty.

Customer Service Number: 732-994-2301

The BROOKSTONE trademark, names and logos are owned by BKST Brand Holdings LLC ©2019. All rights reserved

Manufactured, marketed and distributed by Smartpoint LLC, under license
Google and Google Play are trademarks of Google LLC.

App Store® is a registered trademark of Apple, Inc

All trademarks and registered trademarks are property of their respective owners.

Made in China

©Smartpoint LLC,
250 Liberty Street, Suite 1A
Metuchen, NJ 08840

PRODUCT CONFIGURATION

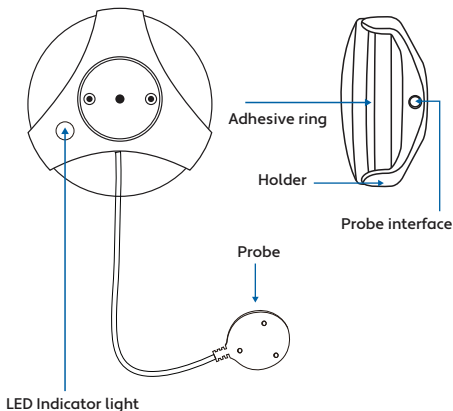

Reset process:

- (1) Press the reset button for 6 seconds, then release, the indicator light will flash rapidly. The device will then be in smart wifi mode.
- (2) Press the reset button again for 6 seconds, then release, the indicator light will flash slowly. The device will then be in AP mode.

DEVICE MODES

Status of LED Light	Definition
Indicator LED light flashes quickly	Wi-Fi Connect Mode (When sensor is ready to connect to Wi-Fi)
Indicator LED light flashes slowly	AP mode (Connects phone's Wi-Fi to sensor's hotspot)
Indicator LED light flashes for a few seconds	Triggered mode (When the sensor detects water)
Indicator LED light is off	Stand by mode (Sensor is waiting to detect water)

DOWNLOAD APP

1. Android: download “Brookstone Smart” app on GooglePlay.
2. iPhone: download “Brookstone Smart” app from the App Store.



Brookstone Smart



REGISTRATION AND LOGIN

1. Run the “Brookstone Smart” app from your smart phone.
2. Register and login.

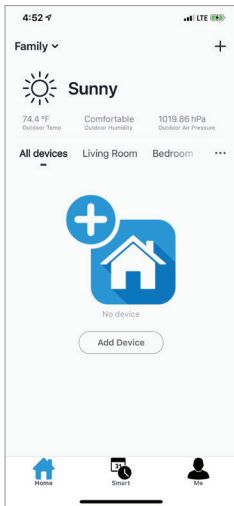
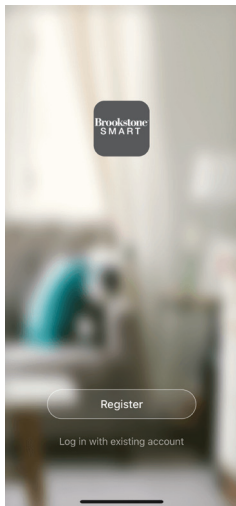

ADD DEVICE

1. Twist the front cover off of the device. Pull the tab from between the battery and the metal connector. If the light is already blinking rapidly, begin the set up process. If not, then press and hold the reset button for 6 seconds, until the indicator light blinks rapidly. The device is now ready to link to your account via the Brookstone Smart app.

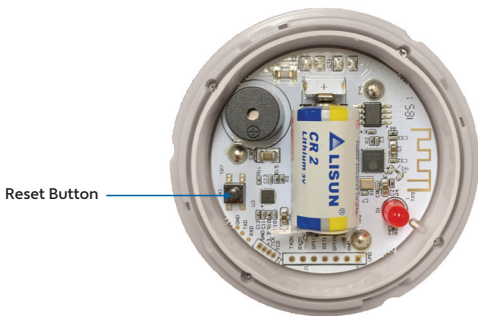

2. Make sure phone is connected to your Wi-Fi network and that it is a 2.4GHz network.
3. Press the (+) symbol in the top right corner of the app and select the Water Sensor from the list of devices to add.

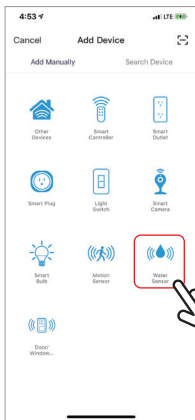

NETWORK CONFIGURATION

4. Confirm indicator light is blinking and press the “confirm indicator rapidly blinks” button to connect in **Smart WiFi Mode**.

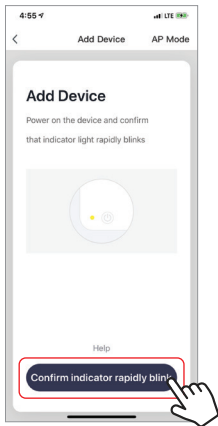

5. Make sure phone is connected to the Wi-Fi network that the device will be connected to. Enter your password for the Wi-Fi network.

6. Connecting process will begin. Do not turn off Water Sensor or phone while connecting. Wait for connection process to complete.
7. Once device has been successfully added, name the device what you would like it to be called in the app. The Water Sensor is ready for use.

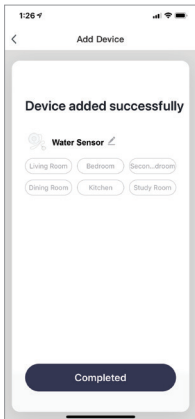
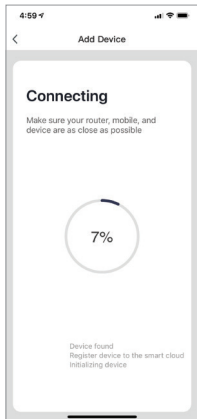

8. Notice: Only follow steps 8-11 if connecting in **AP mode**. From the smart wifi connect page click on “AP Mode” in the top right corner.
9. When light is blinking rapidly hold reset button for 6 seconds and the light should now blink slowly. Click on the “confirm indicator slowly blinks” button.

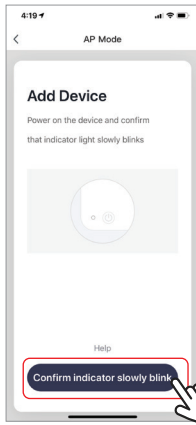
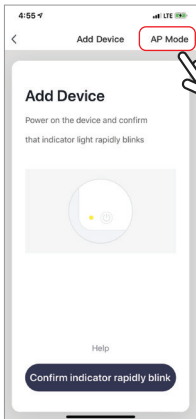

10. Make sure phone is connected to the Wi-Fi network that the device will be connected to. Enter your password for the Wi-Fi network.
11. Follow the on screen instructions. Connecting process will begin. Do not turn off Smart Water Sensor or phone while connecting. Wait for connection process to complete.

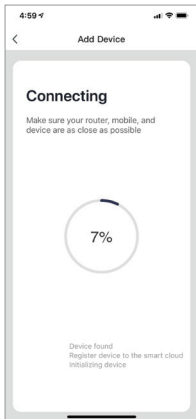
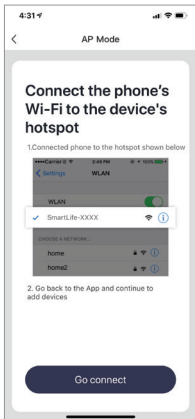

MAIN FUNCTIONS

1. The Water Sensor will detect any water that touches the probe. It will send an alert 3-5 seconds after probe detects water.
2. To view alarm recording history click the “HISTORY” button.
3. To turn off/on push notifications click the “NOTICE” button. From here you are able to turn on/off notifications for leak detection and low battery.

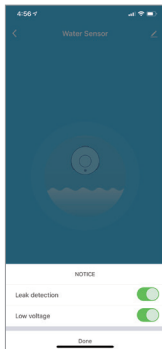
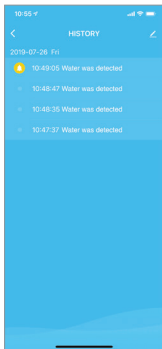
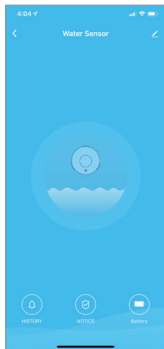

4. To connect two devices via scene click on “Smart” button on the bottom center of the home screen. Then click the (+) symbol at the top right of the screen.
5. Now you can have certain devices carry out actions based on notifications of other devices.

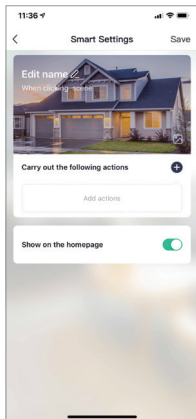
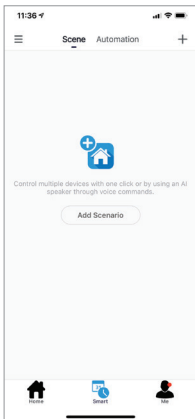

DEVICE SHARING

1. You can allow others in your family to have access to the Water Sensor to receive alerts.
2. Click on the “me” button at the bottom right of the home screen. They click on your family at the top. (If you changed the name of your family in the app it will appear as what you changed it to here).

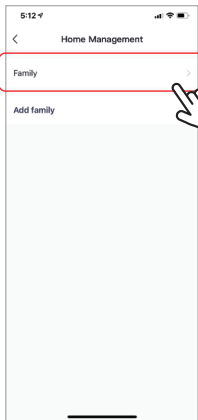
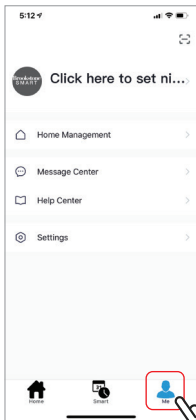

3. Click on “Add Member”.
4. On this screen fill out the information of the family member you would like to give access to. Make sure to use the phone number or email that your family member set up their Brookstone Smart account with.

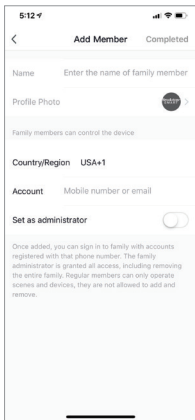
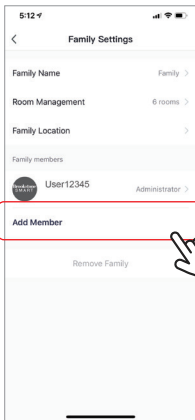

PUSH NOTIFICATIONS

1. You can turn on/off notifications for all devices connected to app by clicking on the “Me” button at the bottom right of the screen.
2. Then click on “Settings” button. From there you can turn on/off all notifications.

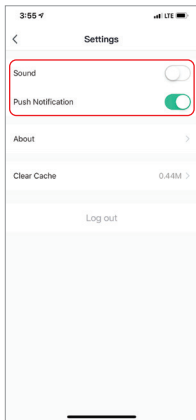
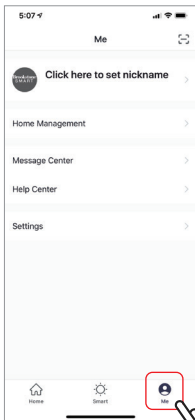

REMOVE A DEVICE

1. From the home screen, click on the device you would like to remove.
2. Then click on the edit symbol on the top right of the screen.
3. From there you would then click the “Remove Device” button at the bottom of the screen.

