



User Manual

Polarity

A. Setting The Time

1. Pull the crown out to position one
2. Turn the crown until the correct time appears
3. Push the crown back into position 0

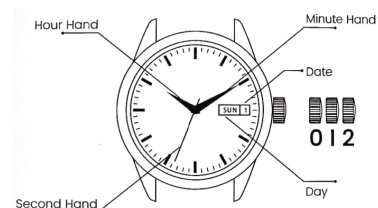

B. Setting The Time And Date

1. Pull the crown out to position 1
2. Turn the crown until you reach the correct date
3. Pull the crown out to position 2
4. Turn the crown until you reach the correct time
5. Push the crown back to position 0

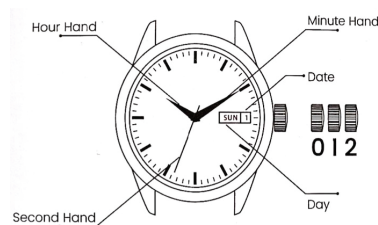

1

C. Setting of the time, day and Date

1. Do not adjust the day/date between 9:00 p.m and 5:00 a.m, other wise it won't change correctly
2. Pull the crown out to position 1
3. Turn the crown clockwise/counterclockwise until you reach the correct day/date
4. Pull the crown to position 2
5. Turn the crown until you reach the correct time
6. Push the crown back into position 0

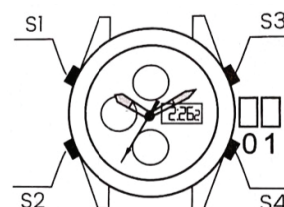

2

II. Digital Chronograph Watch setting Time setting (digital)

Under Normal Time Display Mode:

1. Press S2 until the display screen starts flashing, then press S4 until it switches to the desired parameter
2. Press S3 to adjust the desired item

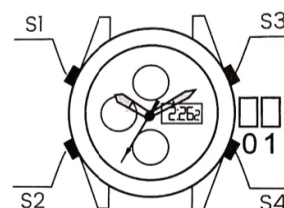

3

Time Setting(Quartz)

1. Pull the crown out to position 1
2. Turn the crown until the correct time appears
3. Push the crown back into position 0

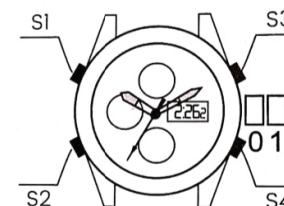

Chronograph:

The display range of the chronograph is 23 hours, 59 minutes and 59.99 seconds

Under Normal Time display Mode:

Press S2 to enter the chronograph modeEvent mode:

S3 to start

S3 to stop

Press S3 to time in/out

S4 is to reset

Split mode: S3 to start

S4 is to split

S4 again to release (Repeat S4 for each split)

S3 to stop

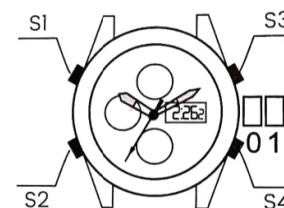

4

Alarm

Under Normal time display mode:

1. Press S2 tow times to enter alarm setting mode
2. Press S4 until it switches to the desired parameter
3. Press S3 to select the desired value
4. Press S4 to finish setting the alarm

Under Alarm setting mode:

Press S3 to turn On/Off the alarm and chime function

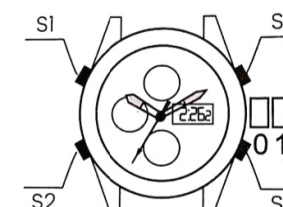

III. Stainless Steel Bracelet Adjustment(2)

1. Follow the arrow sign underneath the band. Use a mini screw driver to push in the direction of the arrow.
2. Push the band cartage out
3. Use a band to take the cartage out

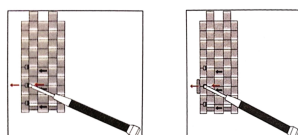

4. Once the band cartage is taken out, you can disassemble the band
5. Take however many band cartages that you need to
6. After you have taken out all the band cartages, place the band back together following the red arrow
7. Use a hammer to make sure the band cartage are properly in the band link
8. Once the cartage is completely inserted the process is complete.

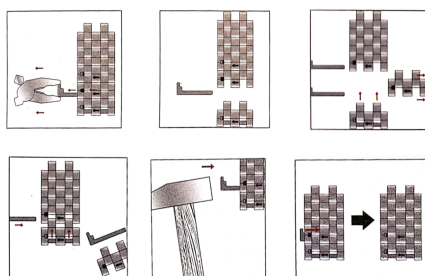

5

CAUTION:

Please make sure the insert tip is aligned to the pin hole to avoid damage of the removal tool tip.

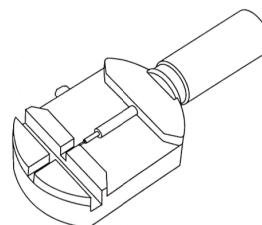

PRODUCT SPECIFICATION:

Operation temperature range	-10C ~ +50C
Water Resistant	3 ATM (about 30 meters)

3ATM- means water resistant to 30 meters. Will withstand water palsies or rain but don't wear while swimming or diving.

Caution:

Exceeding the operation temperature range may result in damaging the movement of the watch.

6

Any issues? Reach out!

✉ info@BoltWatches.com

🌐 www.BoltWatches.com/Pages/Support-Center