

To deodorize the leather

leave the chair in a shady
outside for 1-2 days.



For longer use

Re-tighten bolts every 6 months by using
the enclosed allen-key.
*Using an electric drill can damage the chair.
Please re-tighten bolts manually.

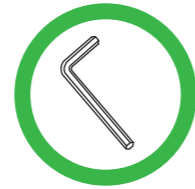

• Cautions

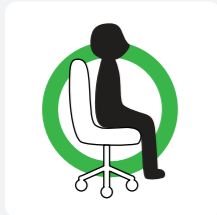

Use this product only for
seating **one person** at a time



DO NOT use the chair
unless all bolts, screws
and knobs are tight



DO NOT use the chair if
only components are
missing or damaged



DO NOT stand on the chair
use as a step stool or ladder

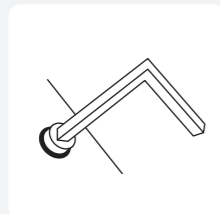

Regularly check all bolts,
screws, and **knobs are tight**

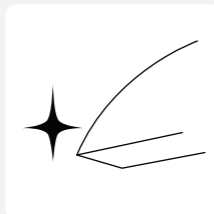

Be careful, some of the part
are **heavy** and has **sharped edge**



Failure to follow these warnings
may cause **serious injury**

If there are any problems, do not hesitate to e-mail us. support@neochair.com

Enjoy your new favorite chair

Our goal is to create a perfect customer experience.
Let us know if you have any feedback.
Your comment motivates us to become a better team.



support@neochair.com

www.neochair.com

[@NEOCHAIR](https://www.facebook.com/NEOCHAIR)

[neochair_office](https://www.instagram.com/neochair_office)

BLC

ASSEMBLY INSTRUCTION



Contents

- Instructions
- User Manual
- Cautions

support@neochair.com

www.neochair.com

※Please make sure all the parts are included.

Missing parts? support@neochair.com

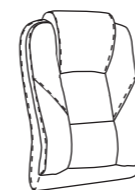

BACK X1



SEAT X1



ARMREST X2

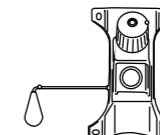

CONTROL
MECHANISM X1



WHEEL X5



CENTRAL BASE X1

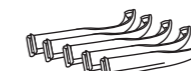

BASE X5



GAS LIFT
CYLINDER X1

- A X8
- B X4
- C X10
- D X8
- E X1

Read the instructions carefully.



Please follow the assembly steps.

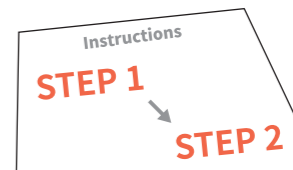

• Instructions

STEP 1 Bottom

1.

2.

3.

4.

STEP 2 Top

5.

6.

7.

8.

⌘ NOTICE

Under-tighten each bolt
make sure bolt holes aligned and tighten!

If there are any problems, do not hesitate to e-mail us. ✉ support@neochair.com

9.

10.

11.

Optional insert

• User Manual

Check

Height

Tilt

Lock