

• Cautions



Use this product only for seating **one person** at a time



DO NOT use the chair unless all bolts, screws and knobs are tight

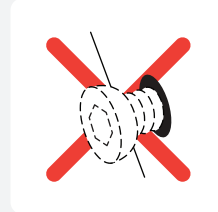

DO NOT use the chair if only components are missing or damaged



DO NOT stand on the chair use as a step stool or ladder

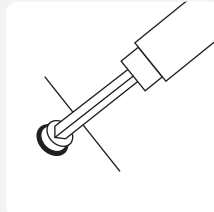

Regularly check all bolts, screws, and **knobs are tight**

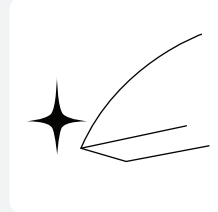

Be careful, some of the part are **heavy** and has **sharped edge**



Failure to follow these warnings may cause **serious injury**



DO NOT use a power drill for tighter assembly, this may cause product damage.

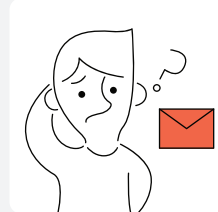

If there is any problem, contact us **cs@hyggeinc.net**

M10 BASIC / HEADREST

ASSEMBLY INSTRUCTION

Contents

- Instructions
- User Manual
- Cautions



✉ **cs@hyggeinc.net**

🌐 **https://www.neochair.net**

✳ Please Make sure all parts are included.

If not, email us **cs@hyggeinc.net**

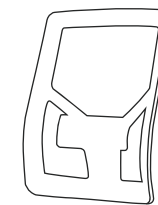

BACK x1

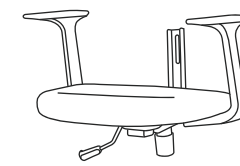

SEAT x1



GAS LIFT x1

BOLT CAP x1



STAR KNOB x1

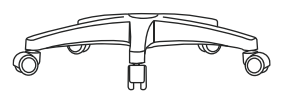

BASE & WHEELS x1

Headrest model comes with below parts.

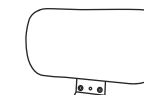

HEADREST x1



BOLT x2

Tip 🗣

Please use screwdriver for easier assembly!



Read the instructions carefully.



Please follow the assembly steps.

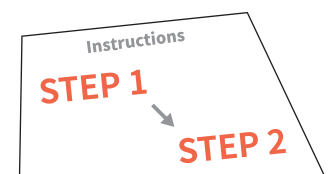

Thank you for your purchase!

Neo Chair is a professional furniture manufacturer and supplier always considering the life of our customers.



✉ **cs@hyggeinc.net**

🌐 **https://www.neochair.net**

📘 **@NEOCHAIR**

📷 **intargram.com/neo_chair**

• Instructions

Before we start,



Packaging box

- Use the packaging box for easier assembly.



- Since the product is heavy, assemble it with caution to avoid injury.

※ Note before assembly

- Please check if there is any problem before assembling. This product is difficult to disassemble after assembly.
- Please note that this product cannot be returned after assembly.

STEP 1 Body

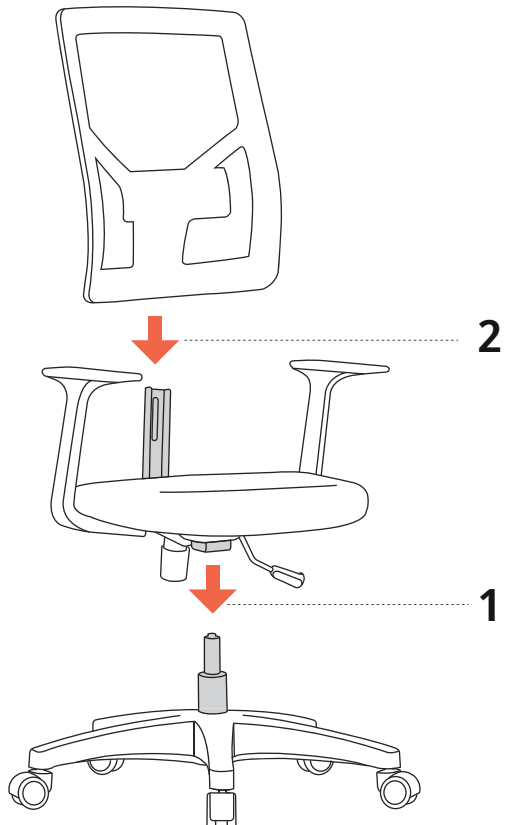

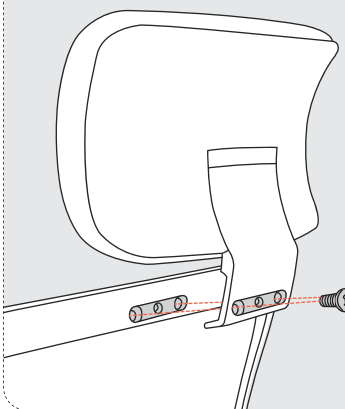

This step is only for a model with headrest

BOLT X 2

HEADREST CAP x1

Caution!!

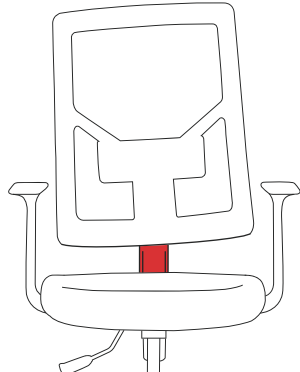

Poorly inserted back might cause a serious back injury.

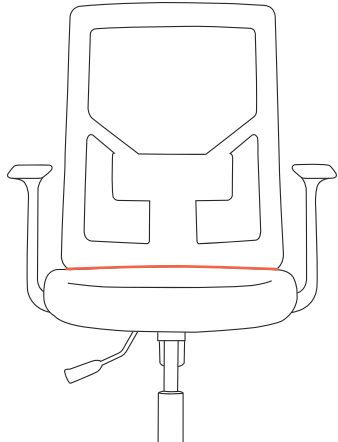

Insert the back correctly.

*If the back does not fit well, rock it carefully to make it easier to insert.

STEP 2 Back

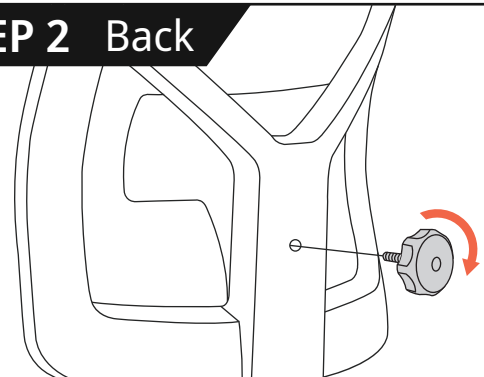

• User Manual

CHECK

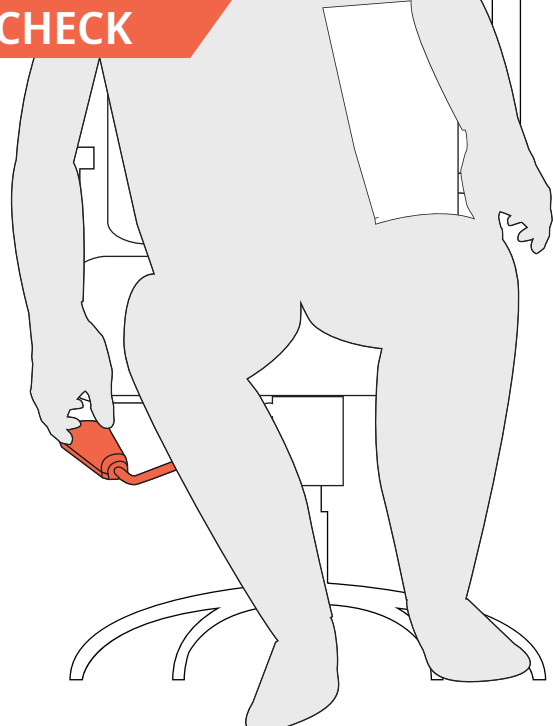

After the assembly,
the seat must be pressed properly for the height adjustment to work. Sit on the center of the chair to make sure the height adjustment lever is working.

BACK HEIGHT

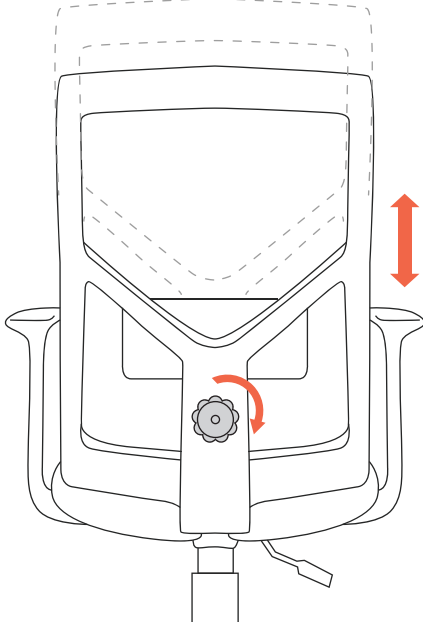

For better back support, you can adjust height by turning the star knob clockwise.

TILT

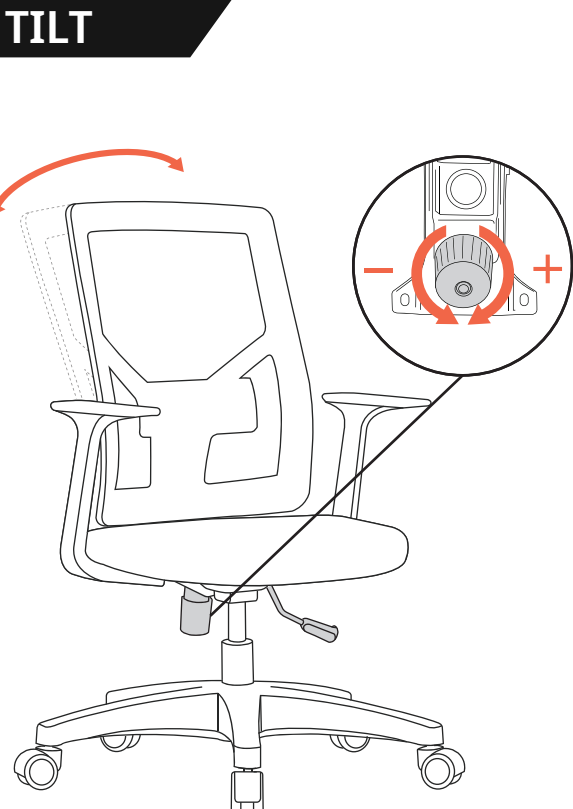

SEAT HEIGHT

