



FESTOOL | MAKITA | TRITON

---

INSTRUCTION MANUAL  
**Paralell Guide**

**BENCHDOGS**



ALLEN KEYS

TRACK ADAPTER

TRACK ADAPTER BAR

3D PRINTED STOP WITH THUMBSCREW

M5 THUMBSCREW

HEX BOLTS

COUNTERSUNK SCREWS

JOINING BARS

**330 KIT 6 X RAILS**  
**445 KIT 4 X RAILS**

### WHAT'S IN THE KIT

- 2 x Track Adapters ◀
- 2 x Track Adapter Bars ◀
- 4 x M5 Thumbscrews ◀
- 4 x Countersunk Screws ◀
- 4 x Hex Bolts ◀
- 6 x Joining Bars ◀
- 2 x 3D Printed stops ◀
- 3 x Allen Keys ◀
- 330 kit 6 x Rails ◀
- 445 kit 4 x Rails ◀

## STEP 1



Join the rails using the joining bars.  
Tighten using the supplied Allen Key.

## STEP 2



Attaching the Track Adaptor to the rail using the a joining bar.  
Place the bar in the rail as per below. Using the Countersunk screws  
tighten the adapter onto the rail.

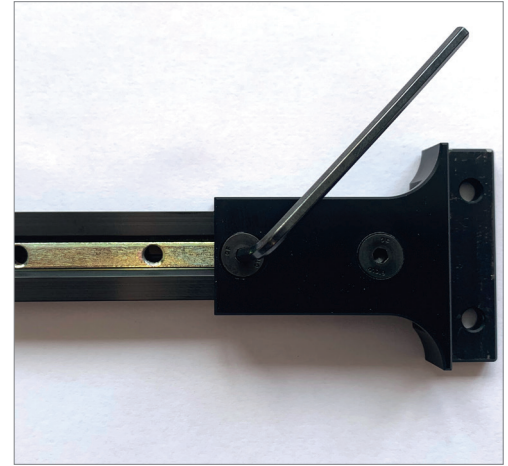

## STEP 3



Attach the track adapter bar to the track adapter using the thumbscrews provided. Leave slightly loose to enable fitment to your rail.

## STEP 4

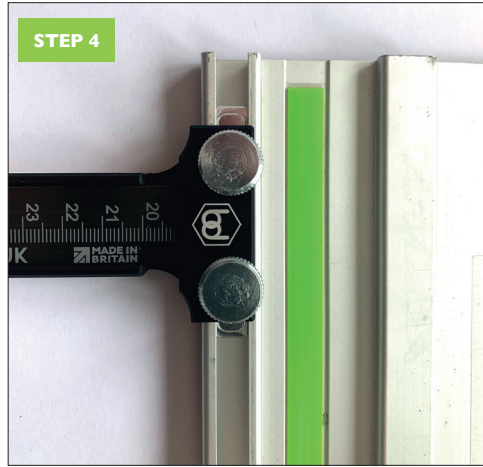

With your thumbscrews loosened, slide your track adapter into the fitment on your rail, when placed at the desired position, tighten the thumbscrews to secure.

## STEP 5



Slide the printed stop to desired measurement and tighten using the thumbscrew.

## NARROW CUT

## STEP 1



Take advantage of this feature, flip your track adapter over and attach to the underside of your guide rail (the side displaying the narrow cut markings) using the provided hex bolts. Leave loosened to adjust

## STEP 2



Attach the track adapter bar to the track adapter using the thumbscrews provided. Leave slightly loose to enable fitment to your rail.

## STEP 3



with your thumbscrews loosened, slide your track adapter into the fitment on your rail, when placed at the desired position, tighten the thumbscrews to secure. Adjust the rail to your desired cut (displayed at the edge of the track adapter) and secure using the hex bolts.



# BENCHDOGS

*Bringing precision to your work*



[WWW.BENCHDOGS.CO.UK](http://WWW.BENCHDOGS.CO.UK)

MADE IN BRITAIN