

SWISS QUARTZ CALIBER 515-24

USER MANUAL

APPLICABLE TO:

THE GLOBETROTTER SERIES GMT

Fromanteel
AMSTERDAM

CONGRATULATIONS

Welcome to the small circle of individuals who, if we are to be absolutely precise, demand slightly more of a watch than absolute precision.

Appreciation of a watch is more than a mere recognition of the correct time. It is enthusiasm for an ingenious idea. For the interplay between precision and imagination. Between time and timelessness. Between boundaries and infinity. Between laws to which the entire world is subject, and taste, which cannot be dictated to anyone.

That's why Fromanteel devotes time to watches that must not only run with absolute precision but which also, with every passing second, exert a fascination with the great achievements of master craftsmanship: a fascination with new inventions of a technical, material or formal nature, even if they are concealed in minute details that are perhaps not even visible.

You are now the owner of a beautiful new example of this Fromanteel tradition, gifted to you by a special someone, or by yourself. Whoever it was, has come to realize that this was the time to credit you for the good you did or achieved. May this watch forever be the reminder of that moment.

Fromanteel. Quality Time you can truly own.

TECHNICAL FUNCTIONS OF THE QUARTZ 515-24 CALIBER

Your Fromanteel watch displays the time in hours, minutes, seconds and a second time zone. The 515-24 Caliber is therefore one of our most advanced and complicated movements.

The Swiss Quartz movement is of the highest quality and manufactured by the renowned Swiss caliber (movement) manufacturer Ronda.

Your watch is protected by a sapphire glass of hardness grade 9 on Mohs' scale. Your watch is water-resistant to 5 ATM.

To ensure that this extraordinary watch continues to perform faultlessly in the future, we present you with a good set of tips on how to operate and maintain it.

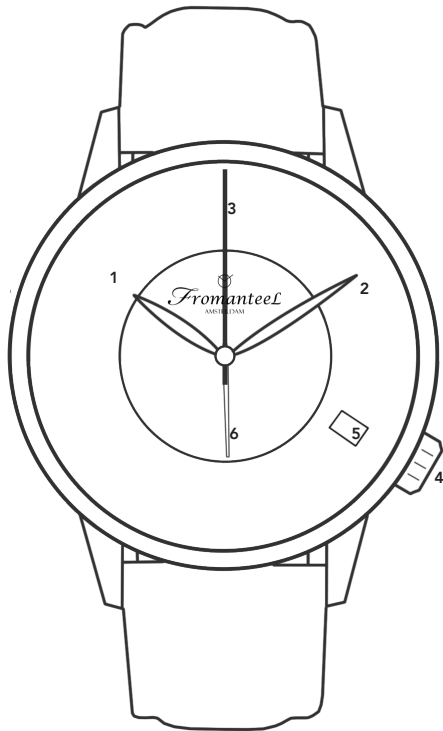

- Hour hand ...1 5 ... Date Indicator
Minute hand ... 2 6 ... 24h Second Time Zone Hand
Second hand ...3
Crown ... 4

FUNCTIONS OF THE CROWN

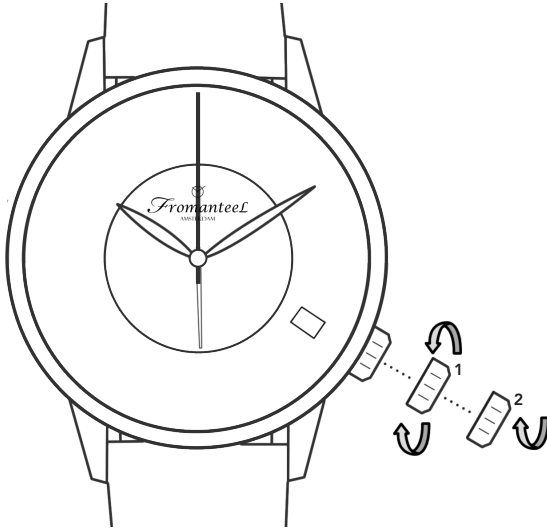

NORMAL POSITION

With the crown in the normal position (0), your watch is 'locked' from an accidental adjustment of your hour, minute, or date. Also, the Quartz movement is activated and draws power from its battery at this position. The crown must always be in position 0 when you are wearing your watch.

DATE SETTING

Pull the crown out to position (1). This will stop the watch. Now, turn the crown clockwise to adjust the date. Once adjusted, push the crown into position (0) to 'lock' the watch and activate the movement.

Please note: *If a month has fewer than 31 days, you will need to set the date manually to the first day of the following month.*

TIME SETTING

Pull out the crown to position (2). This will stop the movement.

Now use the crown to move the minute hand a few minute-strokes beyond the time to be set. Then position the minute hand by moving it gently backward until it is precisely above the correct minute stroke. This ensures that the minute hand begins to run immediately when you restart the movement.

Once set, push the crown in the normal position (0) to 'lock' the watch. This will activate the movement.

READING THE 24 HOUR HAND

With the 24-hour second time zone hand, your watch shows the current time of day in the desired time zone. The 24-hour display is read off the inner scale and allows differentiation between day and night.

SETTING A SECOND TIME ZONE

Your GMT watch enables you to track a second time zone quickly and conveniently. To set the 24h Second Time Zone hand, pull the crown out into position (1). This will stop the watch. Now, turn the crown anti-clockwise to set the 24h Second Time Zone hand to the desired hour.

As a rule, the 24h Second Time Zone hand indicates the time at the a second location, not your current location. We explain the works of this function with the following example:

Imagine you leave our beautiful Amsterdam at noon 12:00h (12PM) for London by airplane. This journey takes you one hour. Once you arrived in London, the time in Amsterdam it should be 13:00h (1PM) . As you know, London differences 1 hour with Amsterdam. As you travelled East, you should deduct this 1 hour difference from your place of departure (Amsterdam). Meaning local London-time at arrival is noon or 12:00h (12PM).

At arrival in London you should adjust your watch as follows:

First, adjust the Hour and Minute hand to the local time. Pull the crown in position (2) and set the time from 13:00h (1PM) to 12:00h (12PM). Second, push the crown into position (1) and move it clockwise to set up the second time zone, which in this case is Amsterdam-time, or 13:00h in our example. Push the crown back into position (0) and with one glance at your watch you will be able to tell both local and home time.

GMT (GREENWICH MEAN TIME)

Greenwich Mean Time (GMT) is the mean solar time at the Royal Observatory in Greenwich, London, reckoned from midnight. GMT is a time zone officially used in some European and African countries. The time can be displayed using both the 24-hour format (0 - 24) or the 12-hour format (1 - 12 am/pm).

UTC (UNIVERSAL TIME COORDINATED)

Regardless of the local time, UTC time is used throughout the world as a uniform reference point for flight schedules. UTC is the time basis for worldwide operational control by the majority of airlines and for air traffic control.

Both GMT and UTC share the same current time in practice.

UTC, GMT & DAYLIGHT SAVING TIME (DST)

Neither GMT nor UTC ever change for Daylight Saving Time (DST). However, some of the countries that use GMT switch to different time zones during their DST period.

INTERNATIONAL DATE LINE

The International Date Line largely coincides with the 180th degree of longitude on the surface of the earth. Yesterday's date applies if this line is crossed in an easterly direction, and you move into the next day if it is crossed in a westerly direction. The same date applies throughout the entire world only once a day, namely at midnight on the International Date Line.

UTC (& GMT) TIME DIFFERENCE – CITIES IN EACH TIME ZONE

- 0 ... *London, Lisbon, Las Palmas, Casablanca, Porto*
- + 1 ... *Amsterdam, Paris, Brussels, Stockholm, Berlin, Warsaw, Vienna, Frankfurt, Milan, Prague, Rome, Madrid, Zurich, Geneva, Barcelona, Copenhagen*
- + 2 ... *Cairo, Helsinki, Athens, Beirut, Johannesburg, Kiev, Istanbul, Tel Aviv, Sofia, Jerusalem*
- + 3 ... *Moscow, Riyadh, Kuwait City, Nairobi*
- + 4 ... *Dubai, Port Louis, Abu Dhabi, Muscat*
- + 5 ... *Karachi, Malé*
- + 6 ... *Dhaka, Almaty, Novosibirsk*
- + 7 ... *Bangkok, Hanoi, Jakarta*
- + 8 ... *Beijing, Hong Kong, Manila, Bandar Seri Begawan, Kuching, Perth, Singapore, Kuala Lumpur, Taipei*
- + 9 ... *Tokyo, Seoul, Sapporo*
- + 10 ... *Sydney, Canberra, Hagåtña, Melbourne*
- + 11 ... *Nouméa, Port Vila*
- + 12 ... *Anadyr, Auckland, Suva, Wellington (Date Line)*
- 11 ... *Samoa, Midway*
- 10 ... *Hawaii, Papeete*
- 9 ... *Anchorage*
- 8 ... *Los Angeles, Vancouver, San Francisco, Seattle*
- 7 ... *Denver, Edmonton, Salt Lake City, El Paso*
- 6 ... *Mexico City, Chicago, Winnipeg, Guatemala City, San Salvador, Managua, Houston, New Orleans*
- 5 ... *New York, Ottawa, Havana, Port-au-Prince, Panama City, Miami, Boston, Atlanta, Bogotá, Lima, Washington D. C.*
- 4 ... *Santiago de Chile, Halifax*
- 3 ... *Rio de Janeiro, Buenos Aires, Montevideo, São Paulo*
- 2 ... *Vila dos Remédios, King Edward Point*
- 1 ... *Mindelo, Ponta Delgada*

PREVENTIVE MAINTENANCE

Dust and dirt tend to collect in gaps in the back of the case or strap. We advise, therefore, to clean your watch occasionally. Use a dry toothbrush to clean your watch-case. Avoid contact with solvents, detergents, perfumes, cosmetic products, since they may damage the leather strap, your watch case or the gaskets between the pushers or crown.

Avoid speakers or refrigerators, since these have strong magnetic fields. Avoid shocks, whether thermal or other. Avoid temperatures above 60°C (140°F), below 0°C (32°F) or extreme temperature changes.

For the Chronograph: do not operate the pushers under water to prevent water from entering the movement. Store your watch in a dry place when not using it.

Replace an empty battery as soon as possible. Fromanteel offers a battery replacement service on its website or in The Fromanteel Store. Each Fromanteel Quartz watch comes with an 'end-of-life' battery indicator. You will notice the second-hand jumping in intervals of 3 to 4 seconds. This means the battery should be changed in the next 2-3 weeks to prevent permanent damage to the watch.

A THING OR TWO ABOUT WATER RESISTANCE

The water-resistance of Fromanteel watches is stated in ATM (atmosphere) instead of in meters. 1 ATM stands for a unit of pressure equal to the air pressure at sea level (or 14.72 pounds of weight per square inch). Meters, which are often used elsewhere in the watch industry to indicate water-resistance, cannot be equated with dive depth because of the test procedures that are frequently used.

Water-resistance shown in meters provides no indication as to actual use of the watch in the presence of moisture and wetness, and in or under water. As body movement caused by swimming or strong water current can also influence the increase in pressure. Depth alone would be inaccurate to address the water-resistance of your watch. All Fromanteel watches are made to resist 5 ATM (or more, if differently indicated).

To ensure that your watch continues to function correctly, you should have it checked by a Fromanteel Service Centre at least once every two years. Your watch should also be tested after exposure to unusually harsh conditions. If the tests are not carried out as stipulated, or if the watch is opened by an unauthorized third party, Fromanteel will accept no warranty or liability claims.

A NOTE: ABOUT THE STRAPS

Most of the Fromanteel straps are made of leather. Fromanteel offers, however, a small selection of textile or rubber with a leather or textile inlay. These straps are carefully made by hand and use natural materials. It is therefore essential to make sure that the high-quality strap does not come into contact with water, oily substances, solvents, cleaning agents, or cosmetic products. This way, you can prevent discoloration and premature aging of the material.

SERVICE YOUR WATCH

Although the parts in this watch are all manufactured from top-quality materials, some components are subject to natural wear and tear. It is particularly important to ensure that the points at which wear occurs are always well lubricated and that oil contaminated by metal abrasion is regularly removed. For this reason, we recommend that you have your watch serviced approximately every 3 to 4 years.

Fromanteel
AMSTERDAM
