

**BESTLITE BL10 // WALL LAMP, HARD WIRED (UNSWITCHED), EU MODEL**  
 Designed by Robert Dudley Best

**PRODUCT**

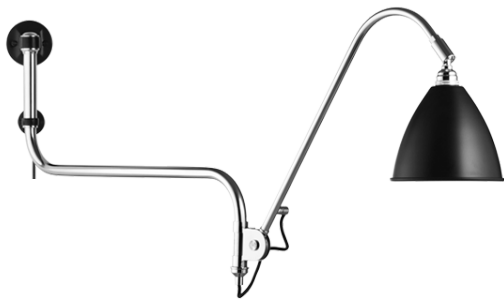

Item no.: 001-1016X  
 + style code

**DESCRIPTION**

Bestlite has been in continuous production since 1930. Robert Dudley Best created Bestlite design. He was highly influenced by the Bauhaus. In the past 80 years, people appreciated the lamps and it decorates many homes, hotels and restaurants worldwide. Loved by architects, designers and design aficionados throughout its 80-year history, today, Bestlite enjoys global iconic status.

**VERSION - BESTLITE WALL LAMP BL10**

Shade and base: Powder coated aluminium  
 Tube and arm: Chromed steel

RAL codes are indicative.

- Fabric wire - Black:
- Black / White inside // RAL 9004 / RAL 9003 // Gloss level 20 / Gloss level 20
- Fabric wire - Off-White:
- Off-White / White inside // RAL 1015 / RAL 9003 // Gloss level 20 / Gloss level 20
- Fabric wire - White:
- White / White inside // RAL 9003 / RAL 9003 // Gloss level 20 / Gloss level 20

Please contact us for other colours or finishes.

**VERSION**

Order item - look for part number in the pricelist.

Series contains the following:

**BL5, BL6, BL7, BL10**

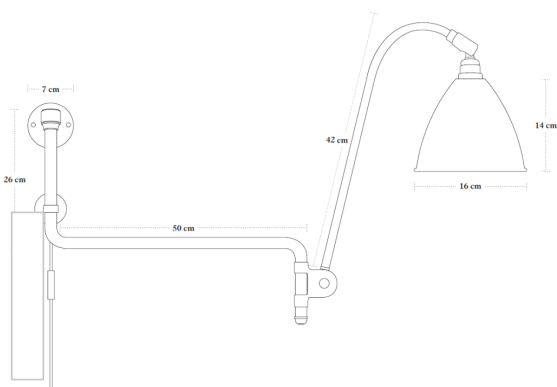

**COLOURS**



// Black / Chrome



// Off-White / Chrome



// White / Chrome

**FACTS**

**MEASUREMENT - L X W X H MM**

Lamp height: 1160 mm  
 Tube length: 620 mm  
 Shade height: 140 mm  
 Shade diameter: Ø160 mm  
 Cord: APP. 2000 mm

**WEIGHT ITEM - LAMP INCL. WIRE**  
 1792 g

**PACKAGING TYPE**

White cardboard box w/ 5ply corrugated

**PACKAGING MEASUREMENT - L X W X H CM**

L:40 x W:73,5 x H:23 cm

**WEIGHT PACKAGING - MATERIAL TYPE**

- Bestlite brochure 120 x 170 mm: 66,5 g
- Paper Egg crate: 1000 g
- Screws: 4,5 g
- PE polybag: 3 g
- Bestlite key: 18 g
- PE polybag: 1 g
- PE polybag: 60 g
- Cardboard outside: 800 g
- Cardboard top: 105 g

**WEIGHT PACKAGING - TOTAL**  
 4000 g

**NUMBER OF PARCELS**

1 pcs.

**LIGHT SOURCE**

- Socket: E14 base
- Recommended light source: *All fluorescens light bulbs*
- Recommended wattage: 9 W = (40 WATT incandescent bulbs)
- Max wattage: 13 W

- Recommended light source: *Halogen light bulb*
- Recommended wattage: 9 W = (40 WATT incandescent bulbs)
- Max wattage: 28 W

- All lamps can be fitted with a dimmer.  
 Please contact your local electrician.

- Lightbulb not included

## BESTLITE BL10 // WALL LAMP, HARD WIRED (UNSWITCHED), EU MODEL

Designed by Robert Dudley Best

### CLEANING AND MAINTENANCE

Use a soft damp cloth when cleaning your Bestlite lamp. Do not use household cleaners.

### ACCESSORIES

### ENVIRONMENT

### TESTS

### CERTIFICATION AND LABELS

CE-CERTIFIED

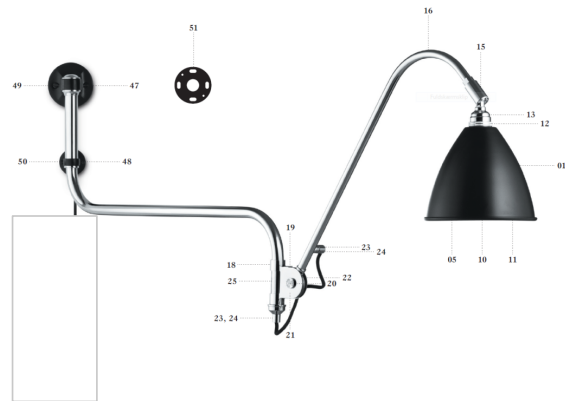

ON DEMAND - (ordered at an additional charge)

ORDERING - BL10 Hard-wired (unswitched):  
No cord, no switch  
(to be mounted directly on electrical outlet)

- Euro voltage: 230 V
- Frequency: 50 Hz
- Supply voltage: AC power ~
- Normally Closed: IP20



Class II / Double insulated



CE-Mark



Luminaires accepted for mounting on a flammable base

### KOMPONENTS

- 01 // Shade Ø16 cm.
- 05 // E14 lamp holder
- 10 // Insulating ring
- 11 // Internal shade ring
- 12 // External shade ring
- 13 // Lamp holder cover
- 15 // Universal joint
- 16 // Bestlite arm
- 18 // Bestlite clip
- 19 // Bestlite nut
- 20 // Bestlite bolt
- 21 // Tension spring
- 22 // Fibre washer
- 23 // Cord grip
- 24 // Cord grip cover
- 25 // Acetate

Item no.: 001-1016X

- 47 // Wall bracket
- 48 // Lower wall bracket.
- 49 // Screw 9x19 mm.
- 50 // Screw 6x36 mm.
- 51 // Mounting plate Ø7 cm

### MATERIAL

Shade and base: Powder coated aluminium  
Tube and arm: Chromed steel

### INSTALLATION INSTRUCTIONS

The Bestlite key:

It's a practical tool that enables you to fasten the lamp arm. Simply use it like a screwdriver in the slot in the Bestlite nut.

**It is suitable for painting!**  
Colour and finish of the lamp can be painted directly on your wall for accurate placement of the hole. Always use the additional label!



#### Technical information:

Light source: E14 E-MW (not included) or E14 halogen bulb.  
Not power of shock, strong lightning.  
The lamp is not approved for outdoor use or use in damp/wet rooms.

#### Some advice on cleaning your Bestlite:

**Powder coated parts - base, bracket and shade:**  
Wipe the parts with a damp cloth wetted in warm water and a bit of mild detergent.

#### Chrome plated parts:

Wipe the lamp with a damp cloth and wipe dry by hand or with a soft cloth.  
If the surface is dirty use a mild glass cleaner available for chrome-plated or other soft metals.

Use only soft cloth for wiping and polishing, never sponge or other material.  
Do not use abrasive household cleaners.  
Do not use acids or volatile cleaning products, glass cleaner or household varnishes.



#### Dear Bestlite customer:

Congratulations on your Bestlite! You have chosen a great design lamp that has been designed and produced in Denmark. The lamp is made of high quality materials and is built to last. On the other side of the globe, you will find a similar lamp. Please do not buy a similar lamp from another manufacturer. We are proud to be the manufacturer of the Bestlite lamp. We are also proud to be the manufacturer of the Bestlite lamp. We are also proud to be the manufacturer of the Bestlite lamp.

#### Bestlite

**BESTLITE**  
SINCE 1930

BESTLITE - GUBI, Skovlundevej 7-9, DK-2100, Copenhagen, Denmark - www.bestlite.com

