

# ACCUF~~FOAM~~AM OC

## APPLICATION GUIDE

---

Accufoam OC High Yield Foam

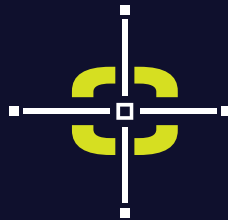

## ACCUFOAM

### LOW-DENSITY -0.45 LB DENSITY OPEN CELL SPRAY POLYURETHANE FOAM

Accufoam OC is a two-component, one-by-one-by-volume spray-applied polyurethane foam. Accufoam OC is a high-yield, low-density, no-mix, spray-applied insulation foam, which contains zero ozone-depleting blowing agents and is designed to provide good thermal performance and a significant control of air infiltration of an air-barrier assembly. Accufoam OC is 100% water blown.

Accufoam OC is an insulation system designed for use in residential, commercial and industrial applications. Typical areas where spray polyurethane foam is applied are: walls, vented and unvented attic assemblies, between floors, and crawlspaces. Accufoam OC is suitable for application on most common construction materials including wood, masonry, concrete, and metal. All surfaces to be sprayed with foam should be clean, dry, and free of dew or frost. All metal to which the foam is applied must be free of oil, grease, etc. Six (6) inches should be the maximum thickness of each pass. Allow ten minutes between each pass to allow for cooling. Multiple layers can be applied to reach the desired thickness and R-value.

### APPLICATION PARAMETERS:

Storage Temperature	60°F – 90°F
Ambient Air Temperature	40°F – 120°F
Substrate Temperature	40°F – 120°F
Moisture Content of Substrate	Less than 19%
Maximum Lift Per Pass	Not to exceed 6 inches
Viscosity at 77°F	320 cps *Resin

### EQUIPMENT SETTINGS:

Pre-Heaters: A Component-ISO	120°F – 140°F
Pre-Heaters: B Component-Resin	120°F – 140°F
Hose Heat	120°F – 140°F
Air Pressure	1100-1400 PSI-Dynamic
Mixing Ratio	1:1 by Volume
Recommended Mix Chamber Size	10-15 LBS/minute (i.e. Graco AR4242)

*\*The values represented in the Equipment Settings chart provides initial optimum settings. Actual operating ranges will vary as ambient air; humidity, moisture, and substrate temperatures vary. Extreme conditions will affect the yield, adhesion and cured physical properties of the foam. Applicator must make adjustments as conditions vary.*

### EQUIPMENT GUIDELINES

Accufoam OC foam system should be processed through commercially available spray equipment designed for that purpose by a qualified professional applicator. The proportioning equipment must be capable of maintaining all designed ratios, temperature settings, etc. as shown in the settings chart. The gun should be of the internal mix type, which provides thorough blending of the two components. The equipment shall be of the heated airless type capable of maintaining 160°F at the gun by use of both primary heaters and heated hose. The use of 2:1 transfer pumps is recommended for supplying the liquid components to the proportioner.

### PROCESSING GUIDELINES

To increase product efficiency and yield. Accufoam OC can be mixed and/or recirculated for 10-15 minutes prior to application. Should not exceed 6 psi with proper agitator mixer.

### STORAGE

- Accufoam OC drums should be stored at 60°F to 90°F.
- Accufoam OC Resin has a six (6) month shelf life when stored properly.
- Recommended to rotate stock by proper batch dates.
- Store in a dry, well-ventilated area.
- Keep drums tightly closed when not in use and do not store in direct sunlight.

## MIXING

**NOTE: ACCUFOAM OC DOES NOT REQUIRE MIXING PRIOR OR DURING APPLICATION.**

Accufoam OC can be mixed or recirculated for 10-15 minutes prior to application to increase yield and efficiency.

## HEATING

- For improved yield, it is recommended to warm the material in the drums.  
The ideal drum temperature for processing Accufoam OC is 70°F.
- If necessary, in cooler weather and while mixing, the proportioner, if equipped with circulation lines, can be used to warm up the drums, not to exceed, 90°F by circulating through the machine back to the drums. The machine heaters should be set no higher than 110°F during this operation.
- If you have a hose circulation block, it is also good practice to circulate the hose for 10 minutes before spraying Accufoam OC.

## PROXIMITY TO HEAT SOURCES

Keep a minimum distance of three (3) inches between Accufoam OC and heat sources such as combustion appliance flues, recessed light fixtures, insulation contact (IC) rated light fixtures, fireplace flues, etc.

## FINISHED FOAM PROTECTION

The finished surface of the sprayed polyurethane foam should be protected from the adverse effects of direct exposure of ultraviolet light from the sun. This exposure will cause dusting and discoloration.

## SPRAY TECHNIQUE

- Always spray with the spray gun at a 90-degree angle to the substrate.
- Maintain a proper distance of 12-18 inches.
- For wall cavities, spray side-to-side from the bottom of the bay to the top while wetting the studs all the way up.
- If spraying a flat wall, maintain gun angle and distance.  
Don't spray more than 2 ft. wide.
- When applying the material in more than one pass, 10 minutes is recommended between passes.

## CHANGEOVER

*\*If you are changing in to Accufoam OC from another product you must not allow the other product to contaminate the Accufoam OC Resin drum.*

- Make sure the drum pump and pump housing are completely free of the previous resin.
- Put the drum pump into the drum of Accufoam OC Resin.
- If you have a recirculation/pressure-relief line, pump the contents to the previous drum or into a waste container with the transfer pumps.
- Connect the recirculation/pressure-relief line to the Accufoam OC drum lid. Remove the gun from the hose manifold and pump the hose contents into the previous drum until you see a color change or until you reach the air pocket in the line.
- Keep the hose heat on at 125°F during changeover.
- There will be some mixture of the two resins in the line which you can run into a container for disposal or spray out as foam for disposal.
- Spray a test pass and watch for good foam with no contamination.
- Make sure recommended settings above are followed before installing Accufoam OC as outlined above.

**BEFORE SPRAYING ACCUFOAM OC FOR THE FIRST TIME, YOU SHOULD CONTACT CREATIVE POLYMER SOLUTIONS TECHNICAL SERVICES FOR INSTALLATION GUIDANCE.**

Do not recirculate or mix Accufoam OC or other manufacturers components into Accufoam OC containers. It is the responsibility of the professional applicator to thoroughly understand all equipment technical information and safe operating procedures that pertain to a spray polyurethane foam application.

This spray system may be applied in passes of uniform thickness from a minimum of half inch (1/2") inch to a maximum of six (6) inches. Accufoam OC must not be applied in a thickness exceeding six inches in a single pass. If this thickness is exceeded, it will adversely affect the quality and physical properties of the finished product and the internal temperature buildup within the foam may cause charring or thermal degradation.

The recommended pass on vertical applications is four (4) inches with a maximum thickness of six (6) inches. Allow ten minutes between each pass to allow for cooling. Multiple layers can be applied to reach the desired thickness and R-value.

## PROPER STORAGE OF RAW MATERIALS

Shelf life is six (6) months from date of manufacture when stored in original unopened containers at 60°F to 90°F. Store in a dry and well-ventilated area. Raw materials must be kept warm. Cold chemicals can cause poor mixing, pump cavitation, or other process problems due to higher viscosity at lower temperatures. Storage temperatures should be 60°F to 90°F for 24 hours before use and should not exceed 90°F. Avoid storing drums on concrete or metal floors in cold (winter) conditions. Do not store in direct sunlight. Keep drums tightly closed when not in use and under dry air or nitrogen of 2-3 psi after they have been opened.

## MATERIAL HANDLING AND SAFETY

Spraying of polyurethane foam results in the atomizing of the components to a fine mist. Inhalation and exposure to the atomized particles must be avoided. Due to the reactive nature of these components, respiratory protection is mandatory. To minimize potential risks from overexposure through inhalation, skin or eye contact, these protective measures are required: adequate ventilation, safety training for installers and other workers, use of appropriate personal protective equipment, and a medical personnel training program should be followed. It is imperative that the applicator become familiar with all available information on proper use and handling of spray polyurethane foam. Resources are available at [spraypolyurethane.org](http://spraypolyurethane.org), [polyurethane.org](http://polyurethane.org) or by contacting Creative Polymer Solutions LLC.

**NOTE: WHEN REMOVING BUNGS FROM CONTAINERS USE CAUTION, CONTENTS MAY BE UNDER PRESSURE.**

Spray polyurethane foam insulation is combustible. High-intensity heat sources such as welding or cutting torches must not be used in close proximity to any polyurethane foam. Large masses of spray polyurethane foam should be removed to an outside safe area, cut into smaller pieces, and allowed to cool before discarding into a trash receptacle. Cleanup Liquids: Nonflammable solvents should be used for cleanup. Consult your solvent manufacturer MSDS for handling precautions.

**CAUTION: EXTREME CARE MUST BE TAKEN WHEN REMOVING AND REINSTALLING DRUM TRANSFER PUMPS AS TO NOT REVERSE THE A-COMPONENT AND B-COMPONENTS.**

## PERSONAL PROTECTION EQUIPMENT

Spraying of polyurethane foam results in the atomizing of the components to a fine mist. Inhalation and exposure to the atomized particles must be avoided. Applicators must use personal protective equipment recommended by the Center of Polyurethanes Industry for use in high-pressure spray foam application. Personal protective equipment includes, but not limited to:

- Full-face mask or hood with fresh air source
- Fabric coveralls
- Non-permeable gloves
- Solvent-resistant gloves when handling materials and cleaning solvents

**NOTE: EXPOSURE MAY OCCUR EVEN WHEN NO NOTICEABLE ODOR IS ENCOUNTERED.**

Please visit [www.spraypolyurethane.org](http://www.spraypolyurethane.org) for additional information on appropriate personal protection equipment selection and use.

## GENERAL

Accufoam OC Foam Insulation can be used in wall cavities, floor assemblies and in attic and crawl spaces as nonstructural thermal insulation material. The spray-applied foam plastic insulation is used in Type V-B construction under the IBC and in dwellings under the IRC. The sprayed product properly installed, results in a seamless, monolithic insulation adhered to the substrate. Accufoam spray systems are technologically advanced materials and should be applied only by trained, qualified, experienced polyurethane spray applicators.

The Spray Foam Insulation shall be spray-applied on the jobsite using a volumetric positive displacement pump. The spray-applied foam plastic insulation shall not be used in electrical outlets or junction boxes or in continuous contact with rain or water. The spray-applied foam plastic insulation shall be sprayed onto a substrate that is protected and clean from any debris or weather-related conditions during application.

## INHALATION

If breathing has stopped, artificial respiration must be promptly applied. If breathing is short, oxygen (if available) should be administered by trained medical personnel. Obtain Medical Attention immediately.

## MECHANICAL VENTILATION REQUIREMENTS

A mechanical ventilation system is required to be utilized in a workplace where spray-applied polyurethane foam is applied. The mechanical ventilation system to be used in workspace needs to be able to exhaust air directly to the exterior of the building.

## REOCCUPANCY

Evacuate the building or establish enclosures to isolate the spray area during application. The application must be properly ventilated during application and for 24 hours post application.

- a. Re-entry time for non-SPF trade workers: 2 hours
- b. Re-entry time for building occupants: 6 hours

## ENVIRONMENTAL CONSIDERATIONS AND SUBSTRATE CONDITIONS

Applicators must recognize and anticipate weather conditions prior to application to ensure highest-quality foam and to maximize yield. Ambient air, substrate temperatures and moisture are all critical factors. Extremes in ambient air and substrate temperature will influence the chemical reaction of the two components, directly affecting the yield, adhesion and the resultant physical properties of the foam insulation.

Proper applications may require adjustments to one or more of the followings: spray techniques, substrate, application or jobsite temperatures. The maximum in-service temperature for all areas shall not exceed 180°F.

Accufoam should be spray-applied to substrates when ambient air and substrate temperatures are within 40°F-120°F. All substrates to be sprayed must be free of dirt, soil, grease, oil and moisture prior to application.

The moisture content of the substrate should not exceed 19%. Polyurethane foam cannot be applied to any substrate that has surface moisture such as rain, condensation, dew, frost, etc. Cold temperatures and high wind speeds slow the exothermic reaction and can lead to poor adhesion, increased density, loss of yield, and thermal shock. Improperly installed foam must be removed and replaced with properly installed spray polyurethane foam. It is the responsibility of the applicator to thoroughly understand all equipment technical information, physical parameters and operating procedures that pertain to a spray polyurethane foam application.

## SKIN EXPOSURE

Immediately remove any contaminated clothing. Immediately wash skin with water and soap and rinse thoroughly. The affected area should immediately be washed with generous amounts of water from a safety shower or other water source.

## EYE EXPOSURE

Immediately rinse opened eye for several minutes under running water. Consult trained medical personnel immediately.

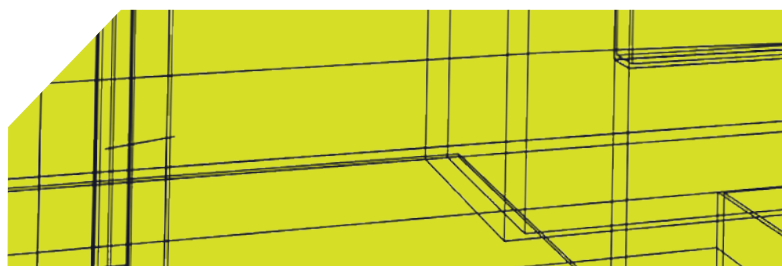

**Disclaimer: The data herein is to assist customers who desire to use our products to determine if the products are safe and suitable for their applications. The data presented herein is not intended for use by non-professional applicators, or those persons who do not purchase or utilize this product in the normal course of their business. Customers further assume full responsibility for quality control, testing and determining whether the products are suitable for each individual application. To the best of Creative Polymers knowledge, all technical data contained herein is true and accurate as of the date of issuance and subject to change without prior notice. NO WARRANTIES OF ANYKIND, EITHER EXPRESSED OR IMPLIED, INCLUDING WARRANTIES OR MERCHANTABILITY OR FITNESS FOR A PARTICULAR PURPOSE, ARE MADE REGARDING PRODUCTS DESCRIBED OR DESIGNS, DATA OR INFORMATION SET FORTH, OR THAT THE PRODUCTS, DESIGNS, DATA OR INFORMATION MAY BE SUED WITHOUT INFRINGING THE INTELLECTUAL PROPERTY RIGHTS OF OTHERS. IN NO CASE SHALL THE DESCRIPTIONS, INFORMATION, DATA OR DESIGNS PROVIDED BE CONSIDERED A PART OF CREATIVE POLYMER'S TERMS AND CONDITIONS OF SALE.**