

ANYKIT

Car Tire Inflator

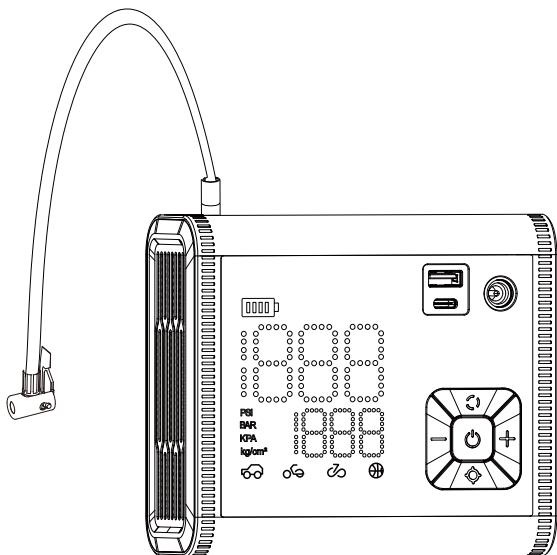

Model : D55

READ BEFORE USE

By using this product, you signify that you have read, understand, and accept the terms and conditions here.

Read the following documents before using.

- (1) Safety Guidelines
- (2) Quick Start Guide
- (3) User Manual

It is recommended to watch all tutorial videos on the official Anykit website and read the safety guidelines before using.

Prepare for your first use by reviewing the quick start guide and refer to this user manual for more information.

Video Tutorials

Scan the QR code to watch the D55 tire inflator tutorial videos, which demonstrates how to use the D55 tire inflator safely.



ONLINE MANUAL

Scan this QR code to get the manual in PDF, which can be enlarged and viewed on your mobile device.



SAFETY INSTRUCTIONS



WARNING!

- The car tire inflator is only suitable for 12V vehicles and car tires with width below 12.4”(315mm).
- To prolong the lifespan of the inflator, it is recommended not to exceed 15 minutes of continuous inflation to prevent excessive wear on the components.
- Do not use this product when the car carries a load that exceeds its capacity. This car tire inflator is not suitable for inflating truck or RV tires.
- This product is not a toy and is recommended for ages 16 and up.
- Keep a safe distance between children and the inflator while inflating.
- There is a built-in lithium battery inside the product. Don't place the product in a fire.
- Overheating, damage, or water may increase the risk of fire or explosion. It's best to keep the product away from heat sources, and not leave it for prolonged periods in a hot car. If the inflator becomes very hot, there is a chance it could explode.
- Please store the product at a temperature ranging from -22~140°F. Extremely hot or cold environments may damage the battery and shorten the lifetime of the inflator.
- Long-term storage of the product may decrease the effectiveness of the battery. Charge the inflator at least once every three months to maintain its performance.
- The product has a built-in DC motor which may generate sparks during operation. Do not use it in an environment with dust or gas that is liable to explode.

SAFETY INSTRUCTIONS

- If there is an unusual noise or the temperature becomes very high during inflating, please turn off the inflator immediately.
- Before setting the inflation pressure value, make sure the pressure unit is correctly selected. Mixing up psi and bar could lead to dangerous overinflation.
- Unit conversion: 1bar = 14.5psi, 1bar = 100kPa.
- Do not leave the inflator unattended while it is in operation.
- Please use the product in a dry and clean environment. The intrusion of sand and dust may cause damage to the product. Don't wash the product with water.
- Please use a certified 5V/3A adapter and the included charging cable to charge this product. Malfunction caused by actions not in accordance with the above requirements is not covered by the warranty.
- After running for a long time, the temperature of the junction between the air tube and the main body can become very high. To avoid burns, avoid touching it.
- This inflator is equipped with short-circuit protection. Do not connect its USB-A port with its USB-C port.
- Caution: To reduce the risk of electric shock, do not expose to rain. Store it indoors.

TABLE OF CONTENTS

ABOUT ANYKIT-----	1
KNOW YOUR PRODUCT-----	2
SPECIFICATIONS-----	3
BATTERY LEVEL INDICATOR & CHARGING-----	4
HOSE CONNECTION-----	5
12V DC POWER-----	6
STARTUP SHUTDOWN-----	7
MODE SWITCHING-----	8
UNIT SWITCHING-----	8
DEFAULT VALUES FOR VARIOUS TIRE PRESSURE MODES--	9
AUTOMATIC SHUT OFF-----	9
LED LIGHT-----	10-11
THE CONNECTION METHOD & USAGE OF NOZZLES-----	12
HOW TO CHANGE THE FUSE-----	12
MAINTENANCE-----	13
TROUBLESHOOTING-----	14-15
WARRANTY-----	16
CUSTOMER SUPPORT-----	17

ABOUT ANYKIT

ANYKIT

Anykit is a contemporary and user-friendly tool brand with a strong commitment to simplicity and convenience. Our portable tire inflators, inspection cameras, and an array of automobile maintenance tools enable DIY enthusiasts, to offer both creativity and practicality in various aspects of life, whether you are at home or on the road.



Follow Anykit on Amazon for More

KNOW YOUR PRODUCT

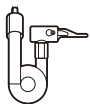
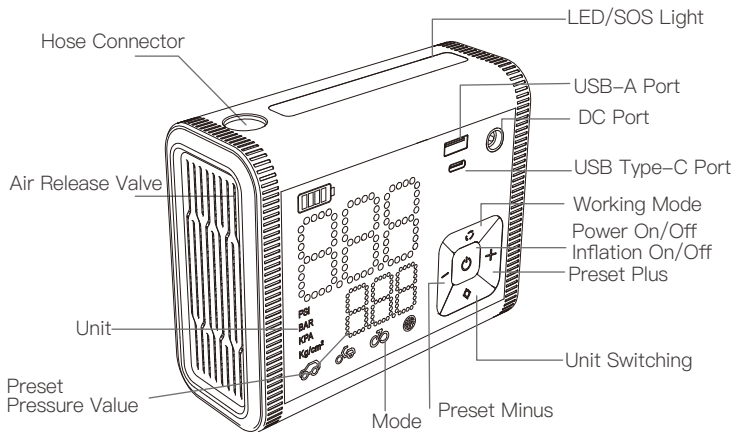

Inflation hose



Car charging cable



USB Type-C cable

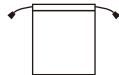

Storage bag



Short adapter



Long adapter



Ball needle



Presta adapter



Cigarette lighter fuse

SPECIFICATIONS

Model	D55
Working Voltage	DC 12V
No Load Flow	44 L/Min
Maximum Working Pressure	150 PSI
Display Units	PSI, BAR,KPA,KG/CM2
Battery Capacity	12000mAh
Charging Time	3.5H(5V/3A)–5H(5V/2A)
Continuous Working Time	15 Mins
Working Noise	Lower than 80dB within 1 meter
Input	5V/3A
Output	5V/2A
Input Port	USB Type–C
Output Port	USB–A
Sensor Accuracy	± 0.15 PSI/ 0.1 Bar
Max. amps	10A
Max. power	120W
Dimensions	5.75x4.65x2.38 inches
AC cable length	10.83 ft (3.3m)
Air tube length	23.6–inch(60 cm)

BATTERY LEVEL INDICATOR & CHARGING

Battery Level Indicator

The battery level is shown by four bars, with each bar representing 25%.



1 bar = under 25%

2 bars = between 25% and 50%

3 bars = between 50% and 75%

4 bars = between 75% and 100%

Note:The battery indicator will flash when the battery level is below 20%.

Charging

Fully charge the inflator before using it for the first time. To charge, connect it to a certified 5.0V/2A USB charger with the charging cable.

While charging:

1 bar flashing = under 25%

1 bar solid, 2nd bar flashing = between 25% and 50%

2 bars solid, 3rd bar flashing = between 50% and 75%

3 bars solid, 4th bar flashing = 75% and 100%

All 4 bars solid = fully charged

The inflator will automatically switch off if left inactive for 5 minutes after being fully charged.

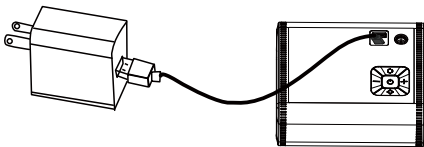

Note:

- Do not use the device while it's charging via USB.
- The USB charger is recommended to use 5V / 3A. Use the type-C charging cable to connect the air pump and power adapter (NOT INCLUDED) for charging
- Charging status: battery indicator flashes
- Full state: the battery indicator light remains steadily lit without blinking.
- DC12V can only be used as a plug-and-play device and cannot be used to charge the battery of an air pump.

HOSE CONNECTION

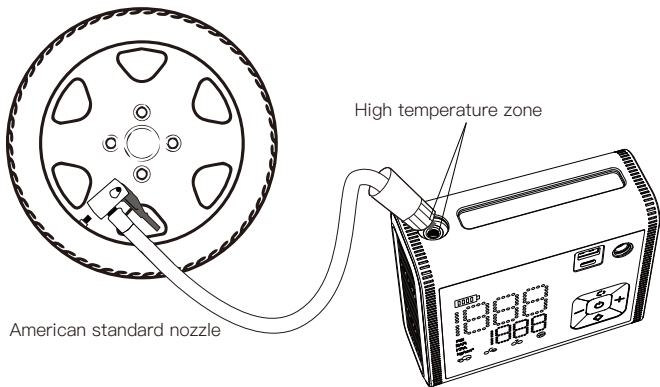

If the tire inflator's battery is running low, you can also use a car's 12V DC cigarette lighter to power your device.

When inflating larger tires like those on pickup trucks, it is advisable to use a cigarette lighter DC 12V power supply as it will provide faster inflation speed.

Note:

Do not use this product when the car carries a load that exceeds its capacity. This car tire inflator is unsuitable for inflating large trucks and RV tires.

12V DC POWER

1. Locate the charging port on the air pump, plug one end of the charging cable into the charging port.

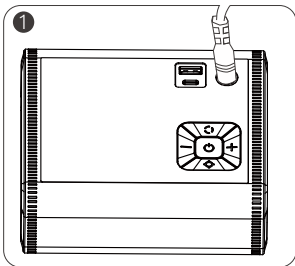

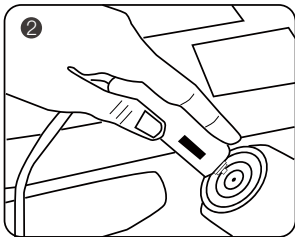

2. Locate the 12V DC cigarette lighter in your vehicle and insert the plug of the air pump's power cord into it.

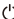

3. Turn on the vehicle's ignition to supply power to the cigarette lighter.

STARTUP SHUTDOWN

Press and hold the power button  for three seconds to turn on the device. The screen will light up.

While the device is turned on, press and hold the power button  for three seconds to turn off the device. The screen will go completely dark.

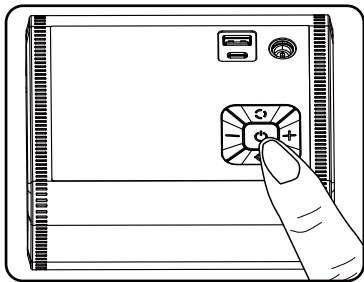

NOTE:

If the device remains idle in the turned-on state for 120 seconds, it will automatically enter a power-saving sleep mode. To wake up the device, simply press the power button briefly.

MODE SWITCHING

It's convenient for you to switch between the five modes – car, motorcycle, bicycle, ball, and custom. You can use the mode button  to switch and select the desired mode, and the default air pressure value will automatically synchronize with the selected mode.

Note: The custom mode does not display a mode icon.

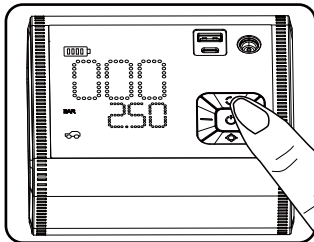

UNIT SWITCHING

You can switch between these four units PSI, BAR, KPA, Kg/cm² as needed. Press the unit button  to switch and select the desired unit, and the preset pressure values will automatically convert and change according to the selected unit.

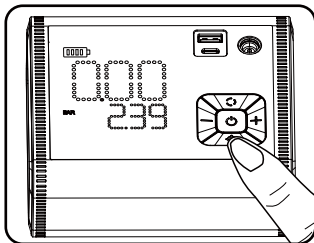

DEFAULT VALUES FOR VARIOUS TIRE PRESSURE MODES



Car mode
36 PSI
(4-65.2 PSI)



Motorcycle mode
34 PSI
(26-44 PSI)



Bicycle mode
30 PSI
(4-150 PSI)



Ball mode
8 PSI
(4-16 PSI)

Custom mode
(4-150 PSI)

PRESET PRESSURE VALUE

Short press +/- button: adjust the preset value +/- 0.1 PSI

Long press +/- button: can quickly adjust the preset value

NOTE:

The default unit upon startup is PSI. If you wish to remember the last set of tire pressure values, please select the custom mode. The car mode, bicycle mode, motorcycle mode, and sports ball mode do not have a tire pressure memory function.

AUTOMATIC SHUT OFF

After selecting the desired inflation mode and preset tire pressure value. Once you press the power button  , the inflation process begins. When the tire pressure reaches the preset value, the air pump automatically stops inflating

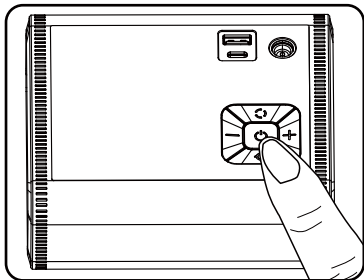

NOTE:



It's important to note that there is a delay of approximately 10 seconds before the inflation process stops after the pressure is displayed as reaching the preset value on the screen.

Why doesn't the inflation process stop immediately when the preset tire pressure is reached?

Our tire inflator is designed to ensure accurate and stable tire pressure. During the inflation process, there may be slight variations and factors that can affect the precision, such as the tightness of the air nozzle or the accuracy of the pressure gauge. To compensate for these potential errors and guarantee that the tire pressure reaches the desired level, our tire inflator has a built-in delay mechanism.

LED LIGHT

First, turn on the power. Then, press and hold the button  for 3 seconds to activate the LED light.

If you want to enter the white light flashing mode, press the button  once. To enter the red-blue light flashing mode, press the button  again. If you want to cycle through the modes, simply press the light button briefly. Finally, to turn off the LED light, press and hold the light button.

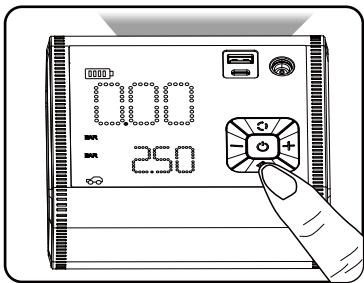

This power bank is capable of providing a 5V/2A output power to charge products with low battery levels.

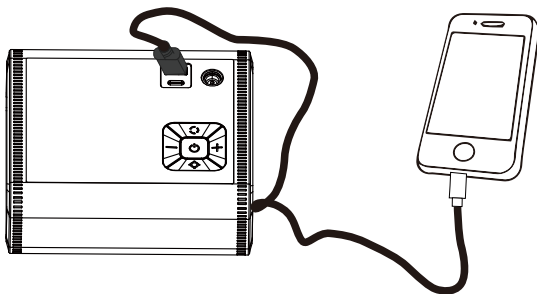

NOTE:

It's important to note that you should not connect a USB cable to the USB-A port of the tire inflator and the other end to the USB-C port of the tire inflator, as this may cause a short circuit.

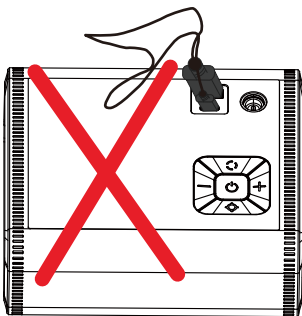

THE CONNECTION METHOD & USAGE OF NOZZLES

How to install the adapter nozzle onto the air pump's nozzle.

Push the adapter nozzle firmly into the air pump's nozzle until it fits securely.

Presta standard nozzle – for high-pressure road style and some mountain bicycles.

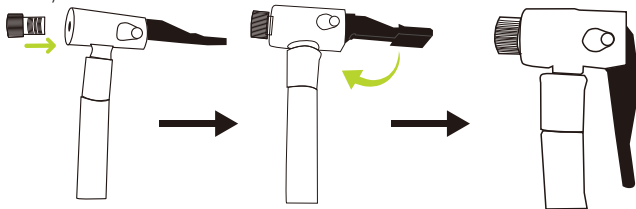

Ball needle nozzle – for sport balls

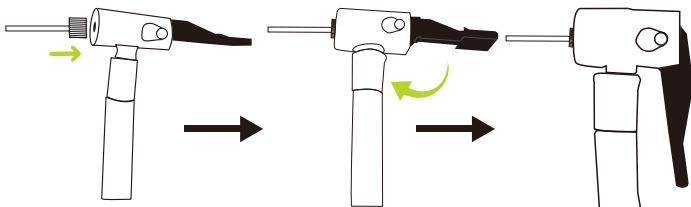

HOW TO CHANGE THE FUSE

If you suspect the fuse in the plug adapter, may have blown, unscrew the tip of the plug adapter, remove the fuse, and inspect (The packaging includes replacement fuses).

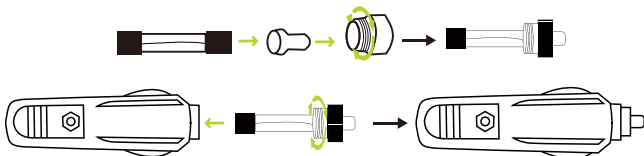

MAINTENANCE

Chemical Contact:

Avoid any contact between plastic parts of the tool and substances like brake fluids, gasoline, petroleum-based products, penetrating oils, or any other chemicals. These chemicals can potentially damage, weaken, or even destroy plastic components, posing a serious risk of personal injury.

Cleaning:

Keep the tool clean to ensure its longevity and optimal performance. Use a soft damp cloth to wipe the tool's surfaces. Ensure that the cloth is damp, but not wet, to prevent water from entering the tool's internal components.

Solvents and Plastics:

Plastic parts are susceptible to damage when exposed to various commercial solvents. Avoid using solvents when cleaning plastic components to prevent any potential harm. Instead, use a clean, dry cloth to remove dirt, dust, oil, grease, and other contaminants.

Battery Maintenance:

To maintain the rechargeable battery's performance and lifespan, take the following precautions:

Protect the battery from overheating, both during charging and storage. Avoid exposing it to extreme temperatures.

Recharge the air pump every three months when not in use. This helps prevent the battery from deep discharging, which can be detrimental to its health.

Regular Inspection:

Periodically inspect the tool for signs of wear, loose components, or damage. If you notice any issues, discontinue use and address them promptly to ensure safety and maintain optimal functionality.

Storage:

When storing the tool, keep it in a clean, dry environment. If possible, store it in a protective case or bag to shield it from dust and debris.

TROUBLESHOOTING

Problem	Possible Reasons and Solutions
The unit will not start.	<ul style="list-style-type: none"> • Check to see if the pre-programmed INFLATE RIGHT digital gauge is set to a lower PSI than your tire currently is reading (i.e., the digital gauge is set to 15psi but your tire is at 20psi; in this scenario, the inflator will not turn on) Refer to the digital gauge operating instructions and set the PSI to the correct tire pressure. • Push the power plug firmly into the receptacle and twist it back and forth. • Check receptacles and plug terminals for dirt, particularly tobacco. (Use a non-conductive probe, not fingers or metal) • Check the vehicle power outlet fuse, it should be 15 amps minimum. • The fuse, located in the plug adaptor, may have blown. Unscrew the tip of the plug adaptor, remove the fuse, and inspect (If the fuse has blown, please replace it with a new one.)
The inflator does not work.	<ul style="list-style-type: none"> • Check if the preset pressure is lower than the current pressure. • Check if the power cord is connected tightly. • Check if the car engine has been started. • Check if the glass fuse is damaged.
The inflation is slow.	<ul style="list-style-type: none"> • Check if the air hose and the inflatable are connected tightly. • Check if the air hose leaks.
Inflation failure.	<ul style="list-style-type: none"> • Check if the device is low on battery, charge it fully, and try again. • Check if the actual pressure is higher than the preset value, switch the inflator to the appropriate mode.

TROUBLESHOOTING

Problem	Possible Reasons and Solutions
There is air leakage.	<ul style="list-style-type: none">• Check if the inflatable leaks• Check if all connecting parts are connected tightly and ensure the nozzle is screwed tightly.
Unchangeable preset pressure value.	Check if the pressure has reached the limit for this mode, change the inflation mode, and try again.
The appliance works normally, but the current pressure shows 0.	<ul style="list-style-type: none">• Check if the hose is damaged.• Check if the pressure of the object being inflated is below the detection range.• Low-pressure inflatables like balloons are not measurable by this appliance.• When the tire is flat, it takes a little time for the tire pressure to be measurable.
The battery level indicator doesn't light up during charging.	Check if the adapter or cable is incorrect; please use the original charging cable for charging.
Accessories are missing or damaged.	Please contact our customer service team.
For any additional problems, please contact us.	

WARRANTY

30-Day Guarantee	We will give you a full refund if you are not satisfied with the product.
One-Year Warranty	We offer a limited warranty that commences from the date of purchase of the product.



Visit anykit.com or scan the QR code for more details.

CUSTOMER SUPPORT

If you have any questions or concerns about your product, please contact our Customer Support Team



1-877-888-7979
Mon.–Fri. 8:00–5:00 PST(US)



support@anykit.com



www.anykit.com



[@anykit](https://twitter.com/anykit)



[@anykit](https://www.youtube.com/anykit)



Facebook Messenger



©ANYKIT D55 C1209 V1.0
3.06.06.002000