



USE AND CARE MANUAL

Electric Gravity Salt & Pepper Mill

 **KITCHEN MAMA**



BE ONE OF THE

**MONTHLY
WINNERS!**

1

Scan this
QR Code



mykitchenmama.com/luckydraw

2

Get the
“YOU'RE IN“
message
&
**follow the
instructions**

3

FOLLOW US ON

 /kitchenmamaus

 /kitchenmamaus

& watch out for our monthly draw!

4

Get the
chance to win one
of these awesome
kitchen gadgets!



To watch a quick instructional video on **How to use** the KM ONE-FLIP, **scan this QR Code!**

[mykitchenmama.com/
KMGravityElectricPepperGrinder3steps](https://mykitchenmama.com/KMGravityElectricPepperGrinder3steps)

Kitchen Mama Electric Gravity Salt & Pepper Mill

**FLAVOR YOUR MEALS WITH ONE-FLIP
KITCHEN MAMA SALT & PEPPER MILL.**

YES, YOU CAN!

- Gravity-powered one-flip trigger
- Battery powered operation
- Adjustable coarseness
- Large condiment container
- LED light automatic turn-on

PARTS

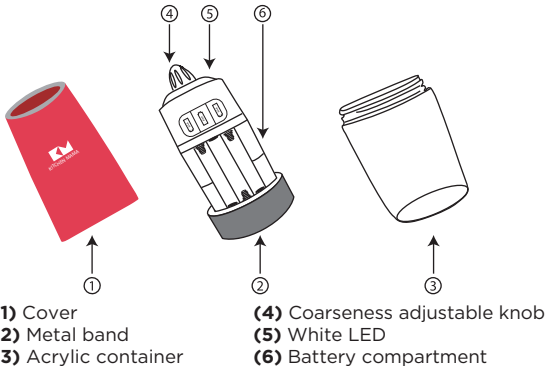

HOW TO USE

STEP 1

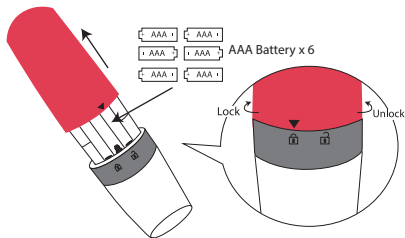

Turn the battery cover clockwise to align the arrow symbol with the unlock mark. Then take off the battery cover to install 6 AAA batteries into the battery compartment.

Note ! After installing the battery and putting on the battery cover, make sure to align the arrow symbol on the cover with the lock mark.

STEP 2

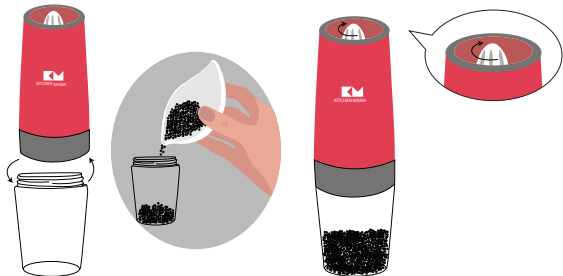

Open the container and fill the peppercorns or sea salt crystals to 80% of the container. Do not overfill.

Note ! The knob located on the top of the grinder can adjust the grinding level. Rotate it clockwise for finer grinding.

STEP 3

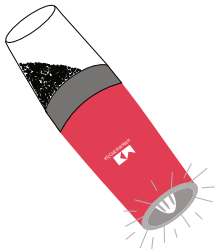

Flip the mill to trigger grinding the salt or pepper automatically. The LED lighting turns on simultaneously.

Suggestion : Make sure the logo on top when flipping the mill.

CARE INSTRUCTIONS

Remove the battery first and simply wipe with a damp towel or brush. DO NOT submerge on water, wash it under running water, or put in the dishwasher.

TROUBLESHOOTING

1. The grinder works fine initially, but stops working somehow. What should I do ?

Check the battery compartment and make sure the batteries are in the right polarity. Alternatively, use new pack of batteries and try again.

2. The mill is working but salt or pepper doesn't come out. Why?

(1) Check if arrow mark in cover indicates to "Lock" icon.

(2) Let KM logo upward when flipping the mill. It's the proper position to make the fillings fall into the inlet in container precisely.

3. The knob falls out. What should I do ?

Just screw the knob into the ceramic grinder.

WARNING

- Read all instructions carefully before use.
- Use **AAA alkaline batteries** only.
- Don't use old and new batteries together. Do not mix alkaline, standard (carbon-zinc), or rechargeable (nickel-cadium) batteries.
- Make sure the batteries are inserted in the correct polarity; if not, it won't operate or may cause battery leakage.
- Do not dispose batteries on fire, they might explode. If disposing batteries in large amounts, contact your trash disposal company or municipal waste disposal department for instructions.
- Remove the batteries when not in use for an extended period of time.
- This product is safe for children to use but it is not a toy.
- Use under adult supervision.



KITCHEN MAMA

Designed by Kitchen Mama LLC