



## **M to S Adapter Bracket Universal** **(White or Black)**

### **Installation Tools:**

- 3/4" Socket with Ratchet
- 3/4" Wrench

### **Hardware:**

- A** (1) M to S Adapter bracket
- B** (1) Adapter bracket Shim

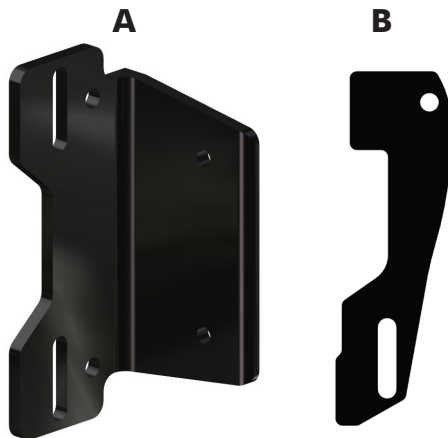

### **Product Quality Assurance**

JL Marine Systems, Inc. assures that this product is made with the finest quality materials and is free from manufacturer defects.

Please inspect this product immediately prior to installation.

If defects are apparent, please contact JL Marine Systems, Inc.

Warranty Department at 813-689-9932 immediately.

Please read all instructions carefully for proper product installation. JL Marine Systems, Inc. is not responsible for improper installation of product.

**Note:** JL Marine Systems, Inc. recommends that adapter plates be installed by an authorized Power-Pole® dealer. To find a dealer near you go to [power-pole.com](http://power-pole.com)

# Installation Instructions

**Step 1** Properly support your outboard motor according to the guide lines in your outboard engines owner's manual. **CAUTION:** For dual install complete installation of M to S adapter bracket on one side at a time.

**NOTICE:** M to S adapter bracket can be mounted on either the port or starboard side of outboard motor, depending on your preference.

**Step 2** On the side that the M to S adapter bracket (A) will be installed, completely remove the bolts that attach the outboard motor to the transom. Next, loosen the bolts on the opposite side about  $\frac{3}{4}$ " of an inch where shim (B) will be installed later.

**Step 3** Install the M to S adapter bracket in between the outboard motor and transom on the side where bolts have been completely removed.

**NOTE:** Be sure not to fully tighten bolts until shim (B) has been installed on the opposite side or an additional M to S adapter bracket installed for a dual application.

**Step 4** Mount the side mount adapter plate to the M to S adapter bracket (B) following the Universal Bolt Set for all Single & Braced Side Mount Plate Kit instructions Section - **Non Jack Plate Mounting Application for Side Mounts.**

**Example:** Starboard side M to S adapter bracket installation diagram

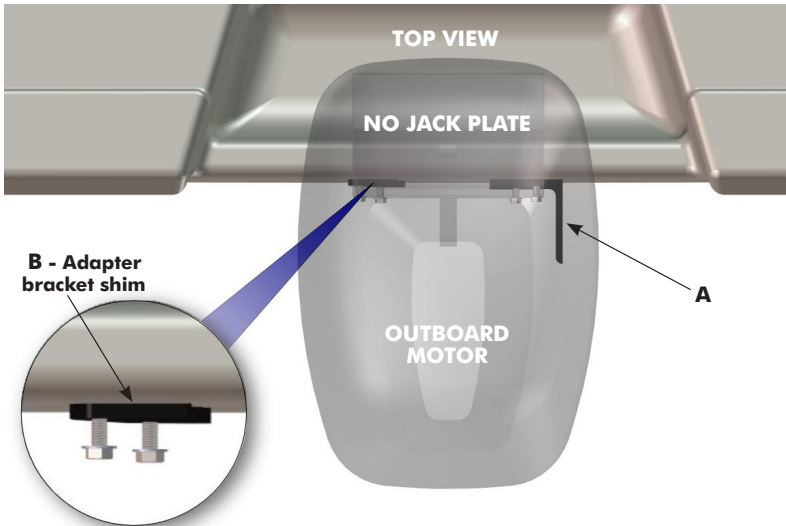

**For Technical Support Call 813-689-9932 opt 2**