



SWIFT. SILENT. SECURE.

CM2 UPGRADE INSTRUCTIONS

MOTOR ASSEMBLY REMOVAL:

STEP 1: Disconnect the **RED (+)** and **BLACK (-)** wires from battery source.

NOTE: For motors like the one in **FIG B**, remove the **RED (+)** and **BLACK (-)** wires from Reversing Relay to battery source. Then, remove Reversing Relay, Dash Switch, Wiring Harness, Remote Receiver Box, and any other wired controls.

STEP 2: Using a Phillips-Head Screwdriver, unscrew the (4) **Phillips-Head Screws** that attach the **Pump Cap** to the **Motor Assembly**. **FIG 1**

NOTE: Cap may look like the one in **FIG A**.

STEP 3: Unscrew the (2) **Phillips-Head Bolts** that hold the **Motor Assembly** to the **Pump Housing**. **FIG 2**

NOTE: For motors like the one in **FIG B**, use an 8mm socket or wrench.

STEP 4: Lift the **Motor Assembly** and **Rubber O-Ring** off of the **Pump Housing**. **FIG 3**

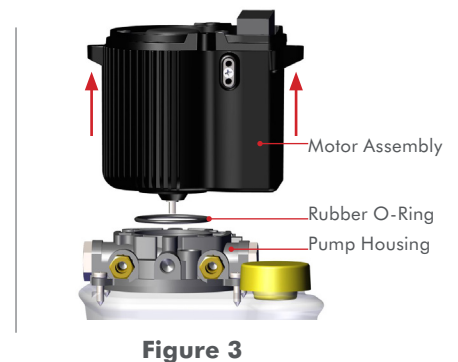
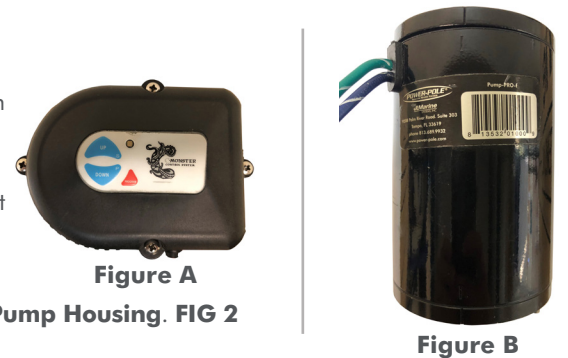
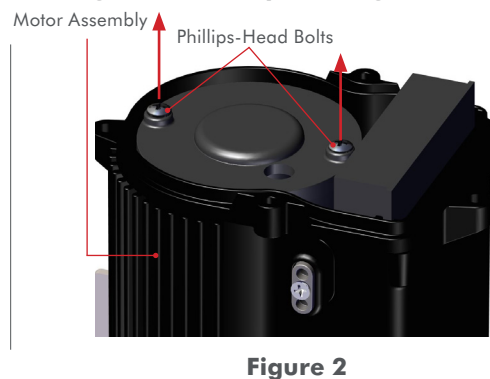
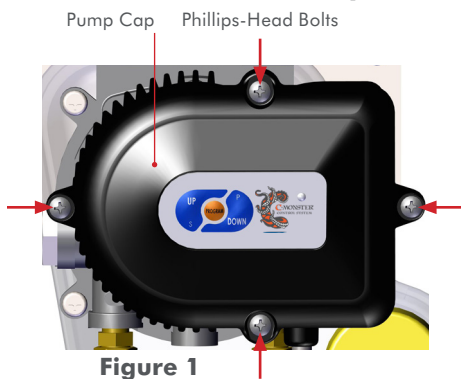

CM2 MOTOR ASSEMBLY INSTALLATION:

STEP 1: Remove the **Pump Cap** by pulling on the **Tab** and lifting up on the **Cap**. **FIG 1**

STEP 2: Remove the **Membrane**. **FIG 2**

STEP 3: Using the **Pump Cap**, pry the front of the **Circuit Board** up and remove it. **FIG 3**

IMPORTANT: DO NOT touch **Antenna**. **FIG 3a**

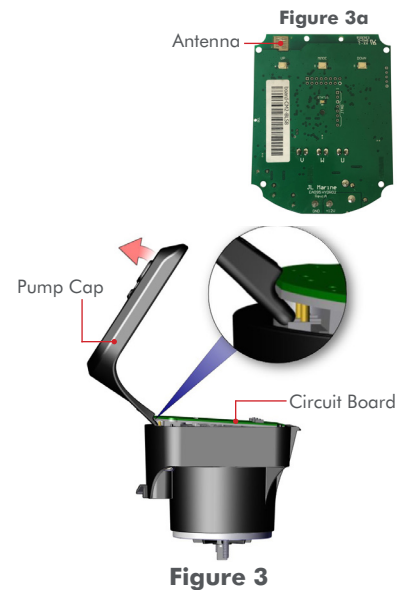
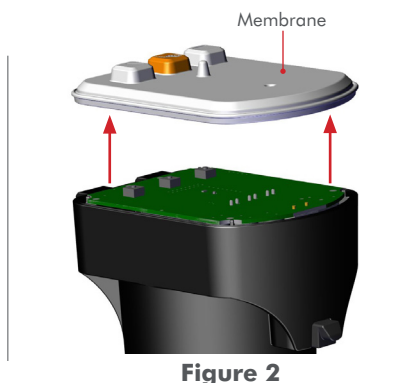
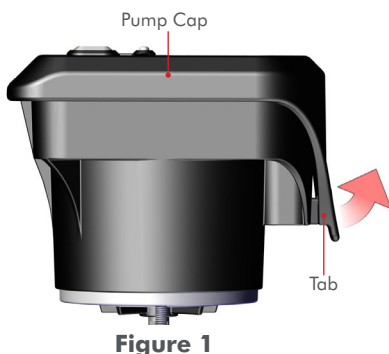

Need help? Contact our Technical Support Team at **1 + 813.689.9932 Option 2**

CM2 UPGRADE INSTRUCTIONS

CM2 MOTOR ASSEMBLY INSTALLATION (Continued) FIG 4-9:

STEP 4: Remove the (2) **Nuts** from the **Motor Bolts** using a **3/8" wrench**. DO NOT remove the **Rubber Gasket**. FIG 4

STEP 5: Position the new **Motor Assembly** on top of the **Pump Housing**, making sure the **Motor Shaft** lines up with the **Coupler Slot**. FIG 5 & 6

IMPORTANT: Add **Marine Grease** to area around **Coupler Slot** if needed.

STEP 6: Tighten the (2) **Motor Bolts** snug using a Phillips-Head Screwdriver.

STEP 7: Install the **Circuit Board**. FIG 7

IMPORTANT: Make sure the **Desi Pak** is on top of the **Motor Assembly**. FIG 7a

STEP 8: Install the **Membrane**. Make sure it seats squarely in the **Motor Casing Groove**. FIG 8

STEP 9: Reinstall the **Pump Cap**. You may need to push up on the **Wire Harness** while pushing down on the **Cap**. FIG. 9

NOTE: If buttons stick, remove the **Pump Cap** and reinstall the **Membrane**.

STEP 10: Connect the **RED (+)** and **BLACK (-)** wires to the battery source. Once both wires are securely fastened, **LED** on top of motor unit will flash **GREEN**, indicating the unit has power.

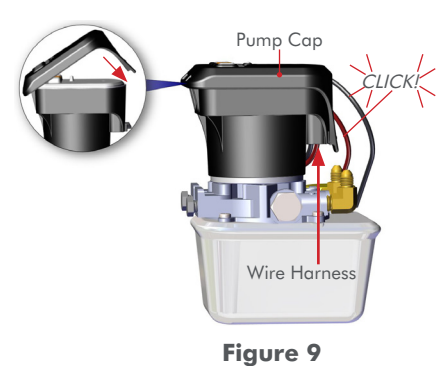
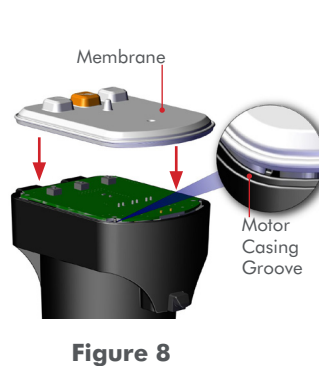
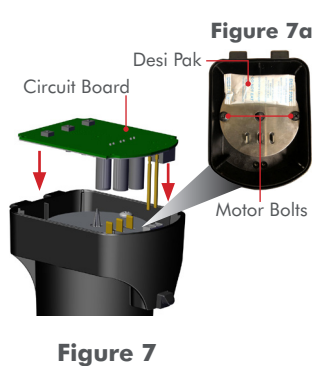
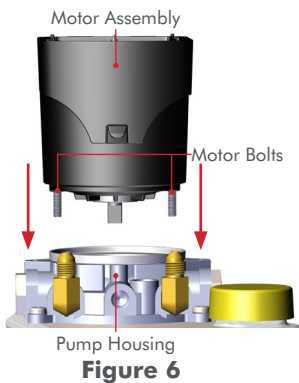
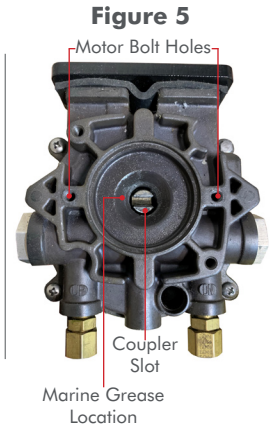
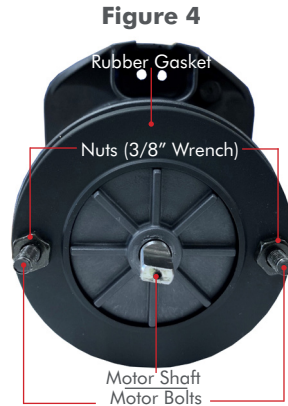

PROGRAMMING INSTRUCTIONS:

CM2 Upgrades come factory set as a single unit. For dual configurations, pumps must be programmed as either a "Port" or "Starboard" unit. Follow the instructions below:

Press and hold the **PROGRAM** button for 6 seconds until the **LED** flashes **RED** and 2 chimes are heard followed by a single beep.

- **Starboard HPU:** Press and release the **UP** Button. **LED** will flash **RED** 1 time with a single beep. Press and release the **PROGRAM** button to save and exit. **LED** will flash **RED** 1 time with a single beep followed by 2 consecutive beeps.
- **Port HPU:** Press and release the **DOWN** button. **LED** will flash **RED** twice with 2 consecutive beeps. Press and release the **PROGRAM** button to save and exit. **LED** will flash **RED** 2 times with a double beep followed by 2 consecutive beeps.
- Programming may also be done via the C-Monster App.

IMPORTANT: When Programming a new Motor Unit, connect it to the C-Monster app to check for a firmware update!



Controller Instructions:

CM1 controllers **WILL NOT** work with your CM2 Upgrade and need to be removed from vessel.

For installation, pairing, and battery replacement instructions for the included **Remote Control Key Fob** and **Wireless Dash Switch**, see **C-Monster 2.0 Controller Instructions** (Included).

Need help? Contact our Technical Support Team at **1 + 813.689.9932 Option 2**