

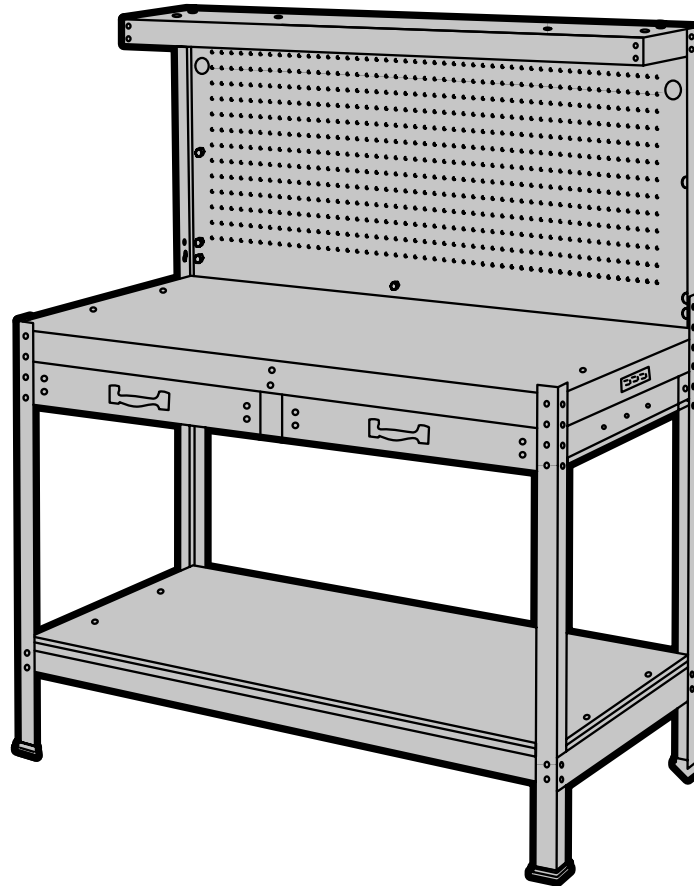

MODEL WB4723, WB4723T

WORK STATION WITH LIGHT

Instruction Manual



NEED HELP? CONTACT US!

Have product questions? Need technical support? Please feel free to contact us:



1-800-232-1195 (M-F 8AM-5PM CST)



TECHSUPPORT@WENPRODUCTS.COM

IMPORTANT: Your new tool has been engineered and manufactured to WEN's highest standards for dependability, ease of operation, and operator safety. When properly cared for, this product will supply you years of rugged, trouble-free performance. Pay close attention to the rules for safe operation, warnings, and cautions. If you use your tool properly and for its intended purpose, you will enjoy years of safe, reliable service.

For replacement parts and the most up-to-date instruction manuals, visit ***WENPRODUCTS.COM***

CONTENTS

WELCOME	3
<hr/>	
Introduction	3
Specifications.....	3
SAFETY	4
<hr/>	
General Safety Rules	4
Electrical Information	6
BEFORE OPERATING	7
<hr/>	
Exploded View & Parts List.....	7
Assembly & Adjustments.....	9
MAINTENANCE	15
<hr/>	
Maintenance.....	15
Warranty Statement	16

INTRODUCTION

Thanks for purchasing the WEN Work Bench. We know you are excited to put your tool to work, but first, please take a moment to read through the manual. Safe operation of this tool requires that you read and understand this operator's manual and all the labels affixed to the tool. This manual provides information regarding potential safety concerns, as well as helpful assembly and operating instructions for your tool.

⚠ SAFETY ALERT SYMBOL: Indicates danger, warning, or caution. The safety symbols and the explanations with them deserve your careful attention and understanding. Always follow the safety precautions to reduce the risk of fire, electric shock or personal injury. However, please note that these instructions and warnings are not substitutes for proper accident prevention measures.

NOTE: The following safety information is not meant to cover all possible conditions and situations that may occur. WEN reserves the right to change this product and specifications at any time without prior notice.

At WEN, we are continuously improving our products. If you find that your tool does not exactly match this manual, please visit wenproducts.com for the most up-to-date manual or contact our customer service at **1-800-232-1195**.

Keep this manual available to all users during the entire life of the tool and review it frequently to maximize safety for both yourself and others.

SPECIFICATIONS

Model Number	WB4723, WB4723T
Total Maximum Weight Capacity	514 lbs (Evenly Distributed)
Table Top Weight Capacity	220 lbs
Bottom Shelf Weight Capacity	220 lbs
Drawer Weight Capacity	25 lbs (Each)
Top Shelf Capacity	44 lbs
Table Top Dimensions	47-1/4 in. x 23-1/2 in. x 5/8 in.
Table Height	35 Inches
Drawer Dimensions	20 in. x 17-3/4 in. x 2-1/2 in.
Power Outlet Rating	3 Outlets, AC 120V, 60 Hz, 13A
Replacement Bulb	14W T5 Fluorescent
Assembled Product Dimensions	47-3/8 in. x 25 in. x 61-3/4 in.
Product Net Weight	88.5 lbs

GENERAL SAFETY RULES

⚠ WARNING! Read all safety warnings and all instructions. Failure to follow the warnings and instructions may result in electric shock, fire and/or serious injury.

Safety is a combination of common sense, staying alert and knowing how your item works. The term “power tool” in the warnings refers to your mains-operated (corded) power tool or battery-operated (cordless) power tool.

SAVE THESE SAFETY INSTRUCTIONS.

WORK AREA SAFETY

- 1. Keep work area clean and well lit.** Cluttered or dark areas invite accidents.
- 2. Do not operate power tools in explosive atmospheres, such as in the presence of flammable liquids, gases or dust.** Power tools create sparks which may ignite the dust or fumes.
- 3. Keep children and bystanders away while operating a power tool.** Distractions can cause you to lose control.

ELECTRICAL SAFETY

- 1. Power tool plugs must match the outlet. Never modify the plug in any way. Do not use any adapter plugs with earthed (grounded) power tools.** Unmodified plugs and matching outlets will reduce risk of electric shock.
- 2. Avoid body contact with earthed or grounded surfaces such as pipes, radiators, ranges and refrigerators.** There is an increased risk of electric shock if your body is earthed or grounded.
- 3. Do not expose power tools to rain or wet conditions.** Water entering a power tool will increase the risk of electric shock.
- 4. Do not abuse the cord. Never use the cord for carrying, pulling or unplugging the power tool. Keep cord away from heat, oil, sharp edges or moving parts.** Damaged or entangled cords increase the risk of electric shock.
- 5. When operating a power tool outdoors, use an extension cord suitable for outdoor use.** Use of a cord suitable for outdoor use reduces the risk of electric shock.

6. If operating a power tool in a damp location is unavoidable, use a ground fault circuit interrupter (GFCI) protected supply. Use of a GFCI reduces the risk of electric shock.

PERSONAL SAFETY

- 1. Stay alert, watch what you are doing and use common sense when operating a power tool. Do not use a power tool while you are tired or under the influence of drugs, alcohol or medication.** A moment of inattention while operating power tools may result in serious personal injury.
- 2. Use personal protective equipment. Always wear eye protection.** Protective equipment such as a respiratory mask, non-skid safety shoes and hearing protection used for appropriate conditions will reduce the risk of personal injury.
- 3. Prevent unintentional starting. Ensure the switch is in the off-position before connecting to power source and/or battery pack, picking up or carrying the tool.** Carrying power tools with your finger on the switch or energizing power tools that have the switch on invites accidents.
- 4. Remove any adjusting key or wrench before turning the power tool on.** A wrench or a key left attached to a rotating part of the power tool may result in personal injury.
- 5. Do not overreach. Keep proper footing and balance at all times.** This enables better control of the power tool in unexpected situations.
- 6. Dress properly. Do not wear loose clothing or jewelry. Keep your hair and clothing away from moving parts.** Loose clothes, jewelry or long hair can be caught in moving parts.

GENERAL SAFETY RULES

⚠ WARNING! Read all safety warnings and all instructions. Failure to follow the warnings and instructions may result in electric shock, fire and/or serious injury.

Safety is a combination of common sense, staying alert and knowing how your item works. The term “power tool” in the warnings refers to your mains-operated (corded) power tool or battery-operated (cordless) power tool.

SAVE THESE SAFETY INSTRUCTIONS.

7. If devices are provided for the connection of dust extraction and collection facilities, ensure these are connected and properly used. Use of dust collection can reduce dust-related hazards.

POWER TOOL USE AND CARE

1. Do not force the power tool. Use the correct power tool for your application. The correct power tool will do the job better and safer at the rate for which it was designed.

2. Do not use the power tool if the switch does not turn it on and off. Any power tool that cannot be controlled with the switch is dangerous and must be repaired.

3. Disconnect the plug from the power source and/or the battery pack from the power tool before making any adjustments, changing accessories, or storing power tools. Such preventive safety measures reduce the risk of starting the power tool accidentally.

4. Store idle power tools out of the reach of children and do not allow persons unfamiliar with the power tool or these instructions to operate the power tool. Power tools are dangerous in the hands of untrained users.

5. Maintain power tools. Check for misalignment or binding of moving parts, breakage of parts and any other condition that may affect the power tool's operation. If damaged, have the power tool repaired before use. Many accidents are caused by poorly maintained power tools.

6. Keep cutting tools sharp and clean. Properly maintained cutting tools with sharp cutting edges are less likely to bind and are easier to control.

7. Use the power tool, accessories and tool bits, etc. in accordance with these instructions, taking into account the working conditions and the work to be performed. Use of the power tool for operations different from those intended could result in a hazardous situation.

8. Use clamps to secure your workpiece to a stable surface. Holding a workpiece by hand or using your body to support it may lead to loss of control.

9. KEEP GUARDS IN PLACE and in working order.

SERVICE

1. Have your power tool serviced by a qualified repair person using only identical replacement parts. This will ensure that the safety of the power tool is maintained.

CALIFORNIA PROPOSITION 65 WARNING

Some dust created by power sanding, sawing, grinding, drilling, and other construction activities may contain chemicals, including lead, known to the State of California to cause cancer, birth defects, or other reproductive harm. Wash hands after handling. Some examples of these chemicals are:

- Lead from lead-based paints.
- Crystalline silica from bricks, cement, and other masonry products.
- Arsenic and chromium from chemically treated lumber.

Your risk from these exposures varies depending on how often you do this type of work. To reduce your exposure to these chemicals, work in a well-ventilated area with approved safety equipment such as dust masks specially designed to filter out microscopic particles.

ELECTRICAL INFORMATION

GROUNDING INSTRUCTIONS

In the event of a malfunction or breakdown, grounding provides the path of least resistance for an electric current and reduces the risk of electric shock. This tool is equipped with an electric cord that has an equipment grounding conductor and a grounding plug. The plug **MUST** be plugged into a matching outlet that is properly installed and grounded in accordance with ALL local codes and ordinances.

1. Do not modify the plug provided. If it will not fit the outlet, have the proper outlet installed by a licensed electrician.

2. Improper connection of the equipment grounding conductor can result in electric shock. The conductor with the green insulation (with or without yellow stripes) is the equipment grounding conductor. If repair or replacement of the electric cord or plug is necessary, **DO NOT** connect the equipment grounding conductor to a live terminal.

3. Check with a licensed electrician or service personnel if you do not completely understand the grounding instructions or whether the tool is properly grounded.

4. Use only three-wire extension cords that have three-pronged plugs and outlets that accept the tool's plug. Repair or replace a damaged or worn cord immediately.

CAUTION! In all cases, make certain the outlet in question is properly grounded. If you are not sure, have a licensed electrician check the outlet.

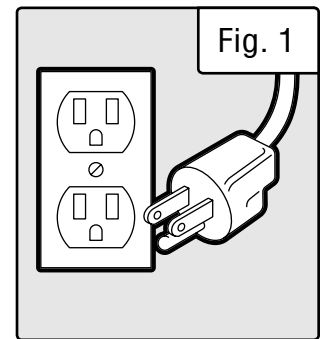

GUIDELINES AND RECOMMENDATIONS FOR EXTENSION CORDS

When using an extension cord, be sure to use one heavy enough to carry the current your product will draw. An undersized cord will cause a drop in line voltage resulting in loss of power and overheating. The table below shows the correct size to be used according to cord length and ampere rating. When in doubt, use a heavier cord. The smaller the gauge number, the heavier the cord.

AMPERAGE	REQUIRED GAUGE FOR EXTENSION CORDS			
	25 ft.	50 ft.	100 ft.	150 ft.
13A	14 gauge	12 gauge	Not Recommended	Not Recommended

1. Examine extension cord before use. Make sure your extension cord is properly wired and in good condition. Always replace a damaged extension cord or have it repaired by a qualified person before using it.

2. Do not abuse extension cord. Do not pull on cord to disconnect from receptacle; always disconnect by pulling on plug. Disconnect the extension cord from the receptacle before disconnecting the product from the extension cord. Protect your extension cords from sharp objects, excessive heat and damp/wet areas.

3. Use a separate electrical circuit for your tool. This circuit must not be less than a 12-gauge wire and should be protected with a 15A time-delayed fuse. Before connecting the motor to the power line, make sure the switch is in the OFF position and the electric current is rated the same as the current stamped on the motor nameplate. Running at a lower voltage will damage the motor.

EXPLODED VIEW & PARTS LIST

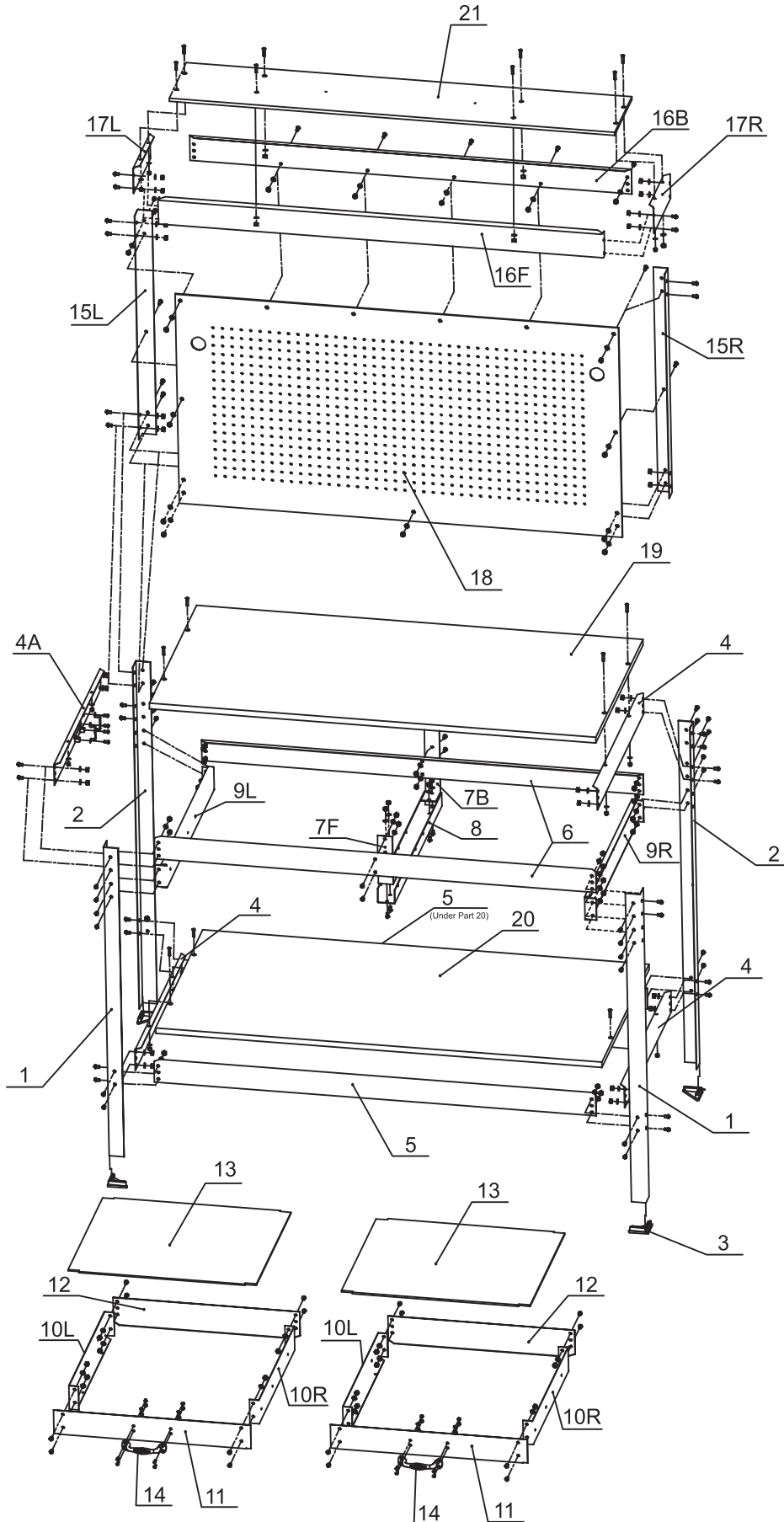

EXPLODED VIEW & PARTS LIST

⚠ WARNING! Do not plug in or turn on the tool until it is fully assembled according to the instructions. Failure to follow the safety instructions may result in serious personal injury.

UNPACKING

With the help of a friend or trustworthy foe, carefully remove the work bench from the packaging. Make sure to take out all contents and accessories. Do not discard the packaging until everything is removed. Check the parts list below to make sure you have all of the parts and accessories. If any part is missing or broken, please contact our customer service at **1-800-232-1195** (M-F 8-5 CST), or email **techsupport@wenproducts.com**.

No.	Part No.	Description	Qty.
1	WB4723-001	Front Post	2
2	WB4723-002	Back Post	2
3	WB4723-003	Rubber Foot	4
4	WB4723-004	Side Beam	3
4A	WB4723-004A	Side Beam with Power Strip Opening	1
5	WB4723-005	Bottom Beam	2
6	WB4723-006	Top Beam	2
7F	WB4723-007F	Front Drawer Bracket	1
7B	WB4723-007B	Back Drawer Bracket	1
8	WB4723-008	Middle Drawer Mount	1
9L	WB4723-009L	Left Drawer Mount	1
9R	WB4723-009R	Right Drawer Mount	1
10L	WB4723-010L	Left Drawer Panel	2
10R	WB4723-010R	Right Drawer Panel	2
11	WB4723-011	Front Drawer Panel	2
12	WB4723-012	Back Drawer Panel	2
13	WB4723-013	Drawer Bottom	2
14	WB4723-014	Drawer Handle	2
15L	WB4723-015L	Left Back Upper Post	1
15R	WB4723-015R	Right Back Upper Post	1
16F	WB4723-016F	Front Shelf Beam	1
16B	WB4723-016B	Back Shelf Beam	1

No.	Part No.	Description	Qty.
17L	WB4723-017L	Left Shelf Beam	1
17R	WB4723-017R	Right Shelf Beam	1
18	WB4723-018	Pegboard	1
19	WB4723-019	Bench Top	1
20	WB4723-020	Bottom Shelf	1
21	WB4723-021	Top Shelf	1
22	WB4723-022	Power Strip (not shown) (pre-installed on part 4A)	1
23	WB4723-023	Light Fixture (not shown)	1
A	WB4723-024	Bolt (M4x10), Washer, Nut (not shown)	8
B	WB4723-025	Bolt (M6x10), Washer, Nut (not shown)	78
C	WB4723-026	Bolt (M6x16), Washer, Nut (not shown)	13
D	WB4723-027	Bolt (M5x25), Washer, Nut (not shown)	12
E	WB4723-028	Screw (ST4x9.5) (not shown) (pre-installed on part 4A)	4
F	WB4723-029	U Bracket (not shown) (pre-installed on part 4A)	2
G	WB4723-030	Bolt (M4x16) (not shown) (included with part 23)	2

ASSEMBLY & ADJUSTMENTS

NOTE: Assembly of the work station requires two people.

NOTE: Extensive assembly required. Assembly time can take 2-4 hours depending on skill level. We suggest taking a break part way through to enjoy a beverage of your choice.

BEFORE ASSEMBLY: Each part is labeled with its corresponding number / letter. Organize all the parts according to the exploded view and parts list, so you can find the parts you need for each step. Allocate sufficient space on a flat, level, hard surface for assembly.

TOOLS REQUIRED (NOT INCLUDED): Phillips head screwdriver, an adjustable wrench or 7mm, 8mm, and 10mm sockets, and a bubble level.

NOTE: Only finger tighten all fasteners during assembly to allow for adjustments. Level all components at the end of the assembly, and then fully tighten all fasteners using the appropriate tools.

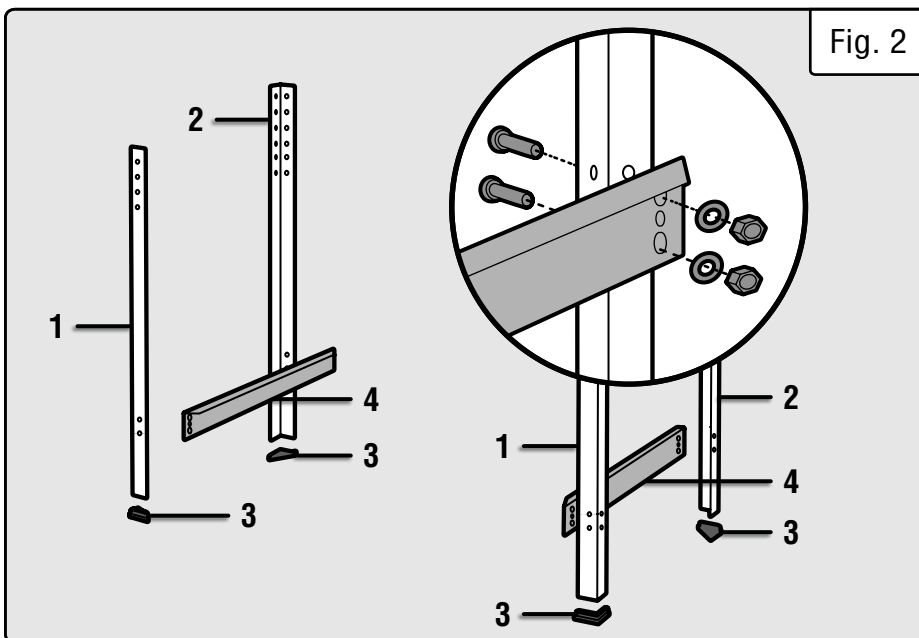

INSTALLING BOTTOM SIDE BEAMS (1, 2, 4)

1. Attach the bottom side beams (Fig. 2 - 4) to the inside of the front (Fig. 2 - 1) and back posts (Fig. 2 - 2), using M6x10 bolts, washers and nuts.

NOTE: All beams should be mounted inside of the post. All flanges on the beams should be on the top.

ATTACHING RUBBER FEET (3)

2. Attach the rubber feet (Fig. 2 - 3) to the bottom of all 4 posts.

INSTALLING BOTTOM FRONT & BACK BEAMS (5)

3. Attach the bottom beams (Fig. 3 - 5) to the inside of the front and back posts, using M6x10 bolts, washers and nuts.

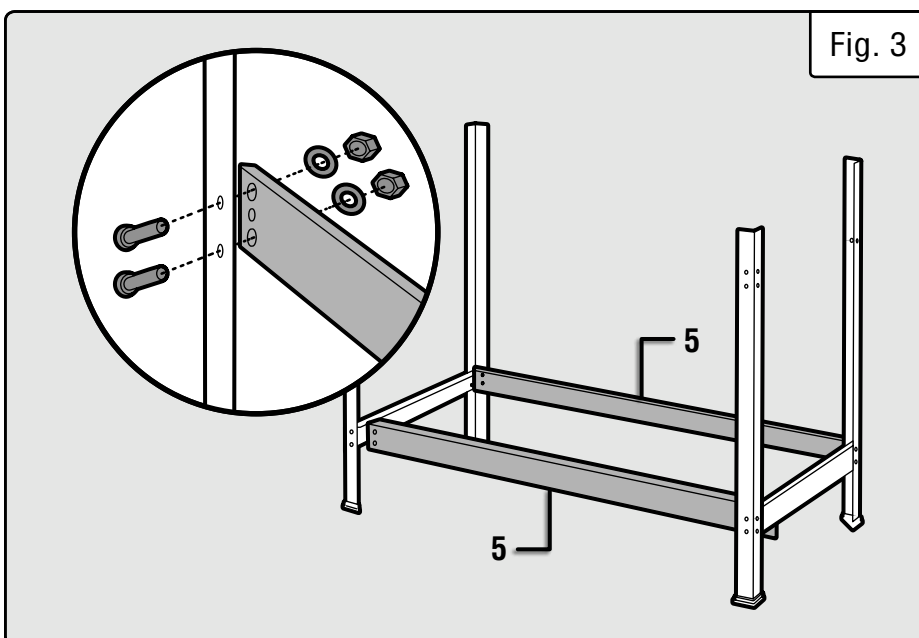

ASSEMBLY & ADJUSTMENTS

Fig. 4

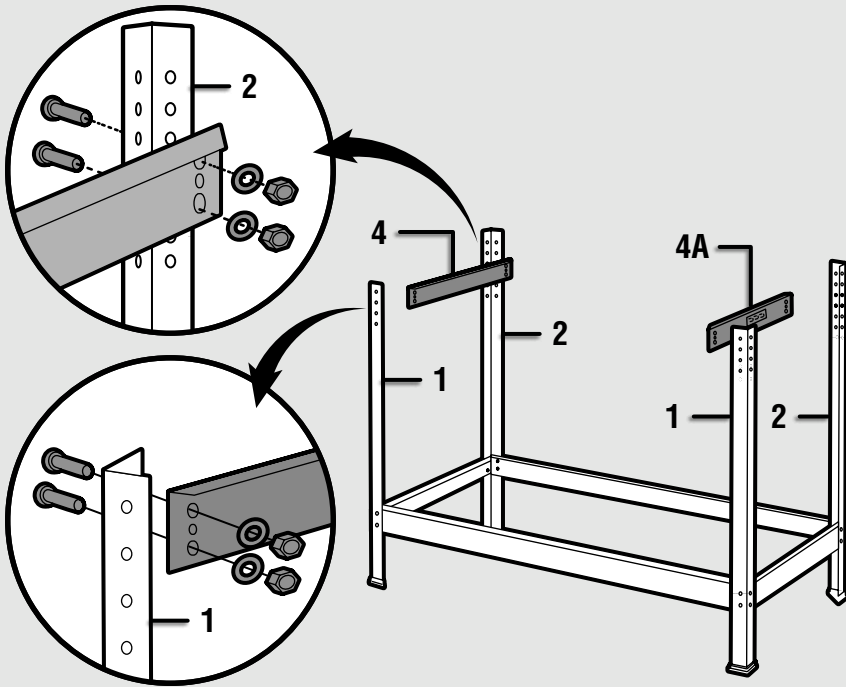

INSTALLING UPPER SIDE BEAMS (4, 4A)

4. Attach one side beam (Fig. 4 - 4) and the side beam with power strip opening (Fig. 4 - 4A) to the top two holes on the front posts (Fig. 4 - 1) and middle two holes on the back posts (Fig. 4 - 2), using M6x10 bolts, washers, and nuts. Assemble the beams with the flanges on the top.

NOTE: The side beam with power strip opening can be attached to either the right or left side.

INSTALLING UPPER FRONT & BACK BEAMS (6)

5. Attach the upper beams (Fig. 5 - 6) to the top two holes on front posts (Fig. 5 - 1) and the middle two holes on the back posts (Fig. 5 - 2), using M6x10 bolt, washer, and nut. One of the beams will have a WEN label, it is recommended to assemble that beam in the front of the unit.

NOTE: All beams should be mounted inside of the posts. All flanges on the beams should be facing upwards.

Fig. 5

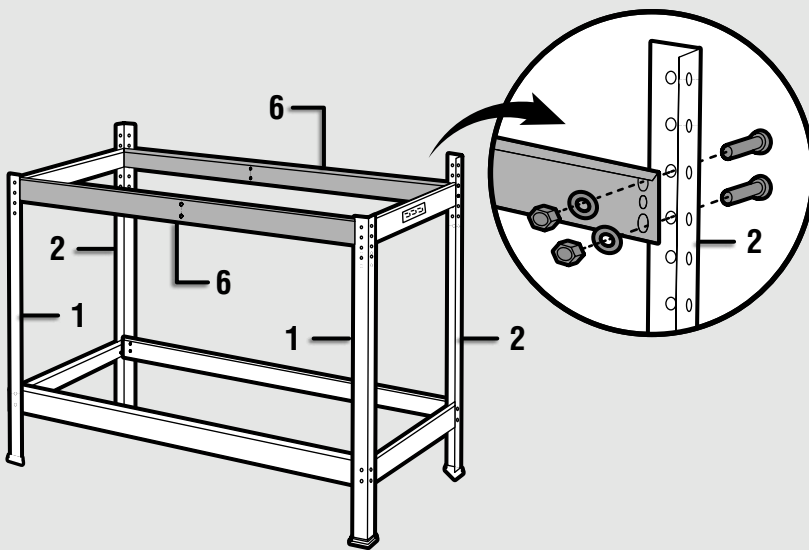

ASSEMBLY & ADJUSTMENTS

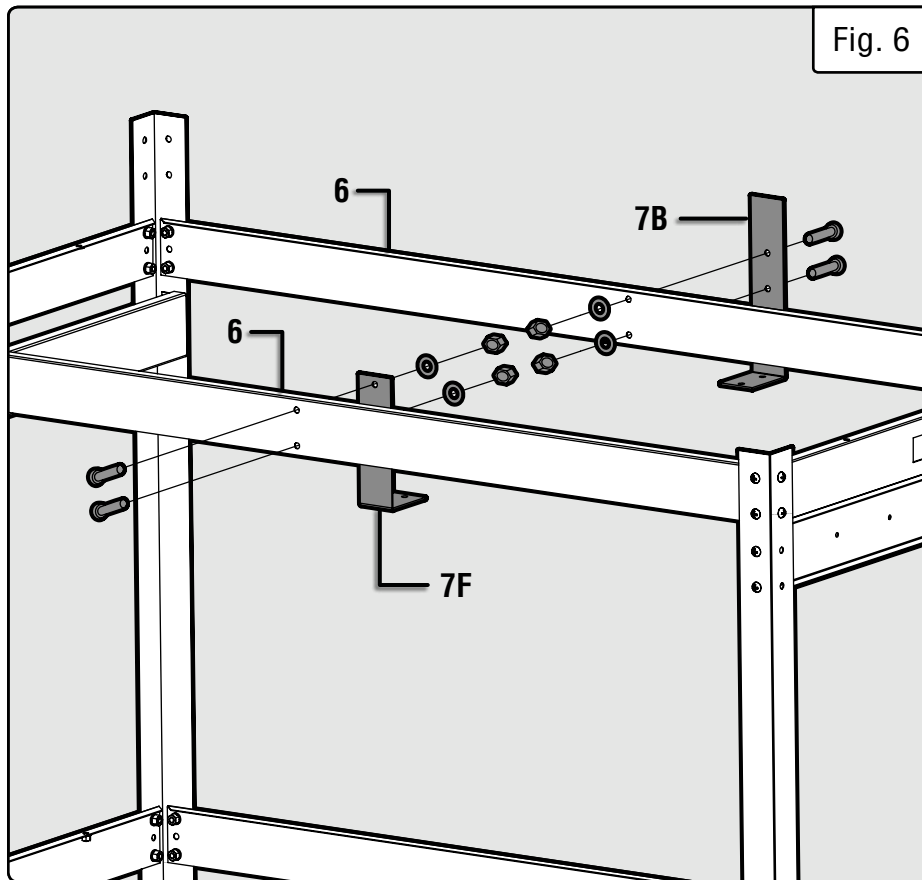

MOUNTING DRAWER BRACKETS (7F, 7B)

6. Attach the front drawer bracket (Fig. 6 - 7F) to the inside of the front top beam (Fig. 6 - 6), and the back drawer bracket (Fig. 6 - 7B) to the outside of the back top beam (Fig. 6 - 6), using M6x10 bolts, washers, and nuts.

ATTACHING MIDDLE DRAWER MOUNT (8)

7. Attach the front drawer bracket (Fig. 6 - 7F) to the inside of the front top beam (Fig. 6 - 6) and the back drawer bracket (Fig. 6 - 7B) to the outside of the back top beam (Fig. 6 - 6), using M6x10 bolts, washers, and nuts.

NOTE: The silver drawer brackets on the middle drawer mount (Fig. 7 - 8) should be assembled towards the front of the workbench so that the drawers can be properly installed later.

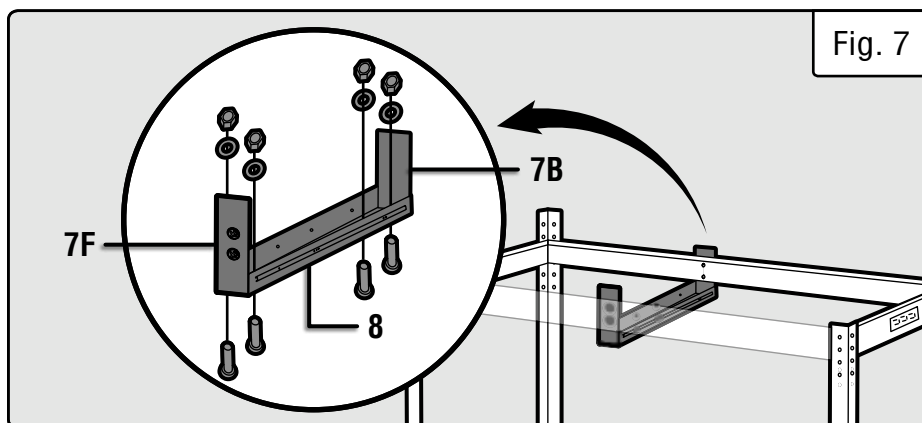

ATTACHING LEFT & RIGHT DRAWER MOUNTS (9L, 9R)

8. Attach the left (Fig. 8 - 9L) and right (Fig. 8 - 9R) drawer mounts to the inside of the front (Fig. 8 - 1) and back (Fig. 8 - 2) posts, using M6x10 bolts, washers, and nuts.

NOTE: The open end of the drawer mounts should be facing towards the front so the drawers can be assembled later.

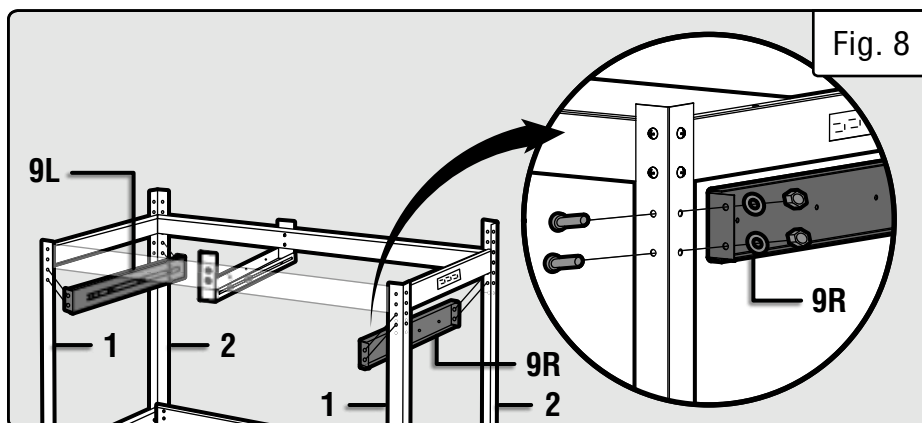

ATTACHING DRAWER HANDLES (14)

9. Attach one drawer handle (Fig. 9 - 14) to the front drawer panel, using M4x10 bolts, washers, and nuts (A). See Figure 9 on the next page.

Repeat step 9 to attach the other handle to the second front drawer panel.

ASSEMBLY & ADJUSTMENTS

ATTACHING DRAWER PANELS (10L, 10R, 11, 12, 13)

10. Lay one drawer bottom (Fig. 9 - 13) down on a flat surface. Attach the right (Fig. 9 - 10R) and left (Fig. 9 - 10L) drawer panels to the inside of the front (Fig. 9 - 11) and back (Fig. 9 - 12) drawer panels using M6x10 bolts, washers, and nuts.

INSTALLING DRAWERS

11. Install the drawers, making sure the runners on the drawers are level with the drawer mounts. Check the drawers' run (you may have to swap the drawers around to get a proper fit. Play with them to see which gives the smoothest feel.)

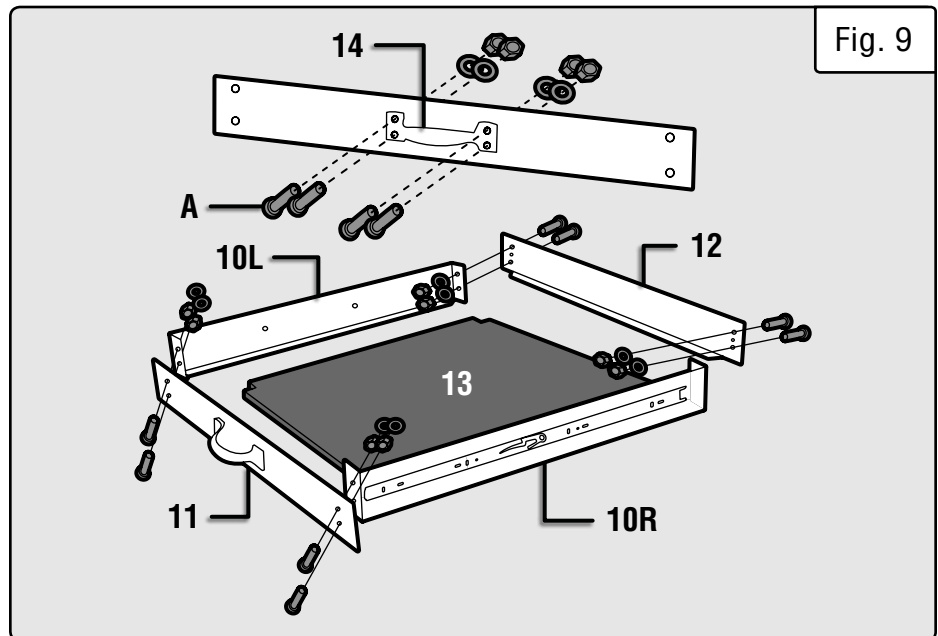

ATTACHING BACK UPPER POSTS (15R, 15L)

12. Attach the left and right back upper posts (Fig. 10 - 15R, 15L) to inside of the left and right back posts (Fig. 10 - 2), at the left and right side mounting holes (not the back mounting holes), using M6x10 bolts, washers, and nuts. Make sure that the middle holes on the back upper posts (Fig. 10 - 15R, 15L) face the back of the unit (not the sides).

ATTACHING BACK SHELF BEAM (16B)

13. Attach the back shelf beam (Fig. 10 - 16B) to the inside of the back upper posts, at the uppermost mounting holes, using M6x10 bolts, washers, and nuts.

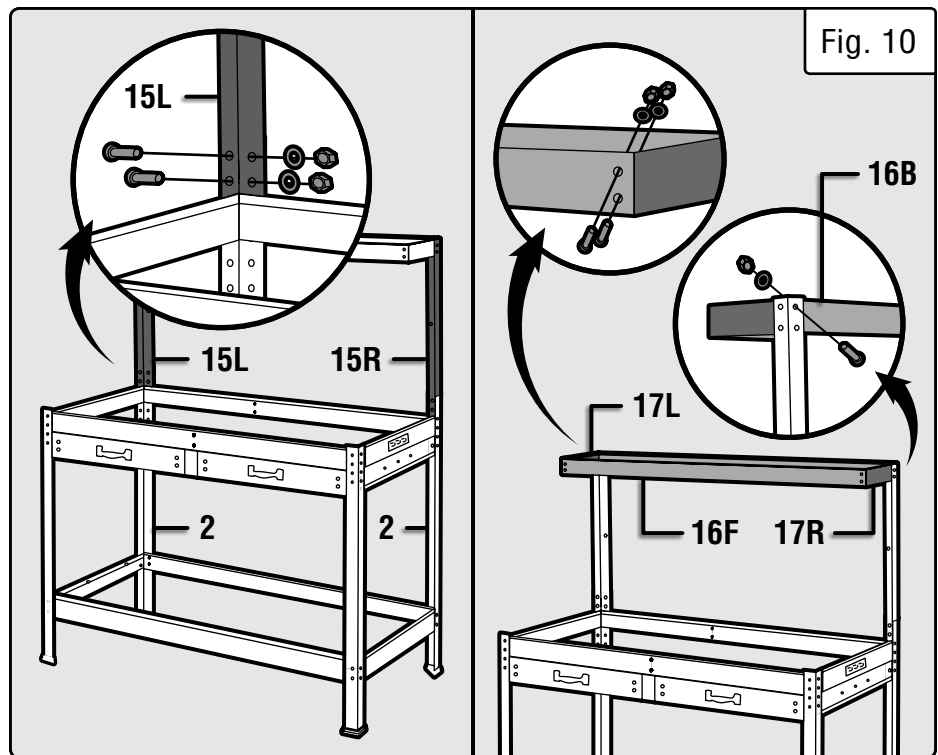

NOTE: Make sure that all beams have flanges on the top when assembling.

LEFT & RIGHT SHELF BEAM (17L, 17R)

14. Attach the left shelf beam (Fig. 10 - 17L) and right shelf beam (Fig. 10 - 17R) to the back upper posts (Fig. 10 - 15R, 15L), using M6x10 bolts, washers, and nuts.

ATTACHING FRONT SHELF BEAM (16F)

15. Attach the front shelf beam (Fig. 10 - 16F) to the inside of the left and right shelf beams, using M6x10 bolts, washers, and nuts.

ASSEMBLY & ADJUSTMENTS

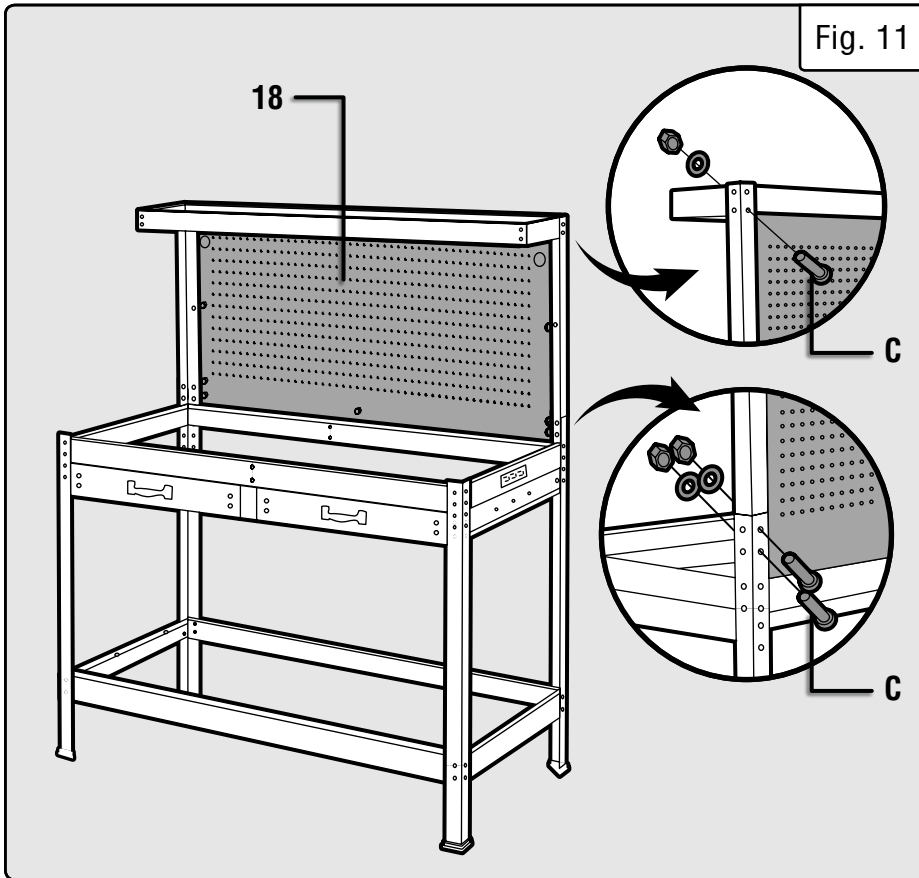

ATTACHING PEGBOARD (18)

16. Attach the pegboard (Fig. 11 - 18) to the back upper posts, using 13 M6x16 bolts, washers, nuts (C).

ATTACHING BENCH TOP & BOTTOM SHELF (19, 20)

17. Attach the bench top (Fig. 12 - 19) to the upper side beams (Fig. 12 - 4, 4A). Attach the bottom shelf (Fig. 12 - 20) to the lower side beams (Fig. 12 - 4), using M5x25 bolts, washers, and nuts (D).

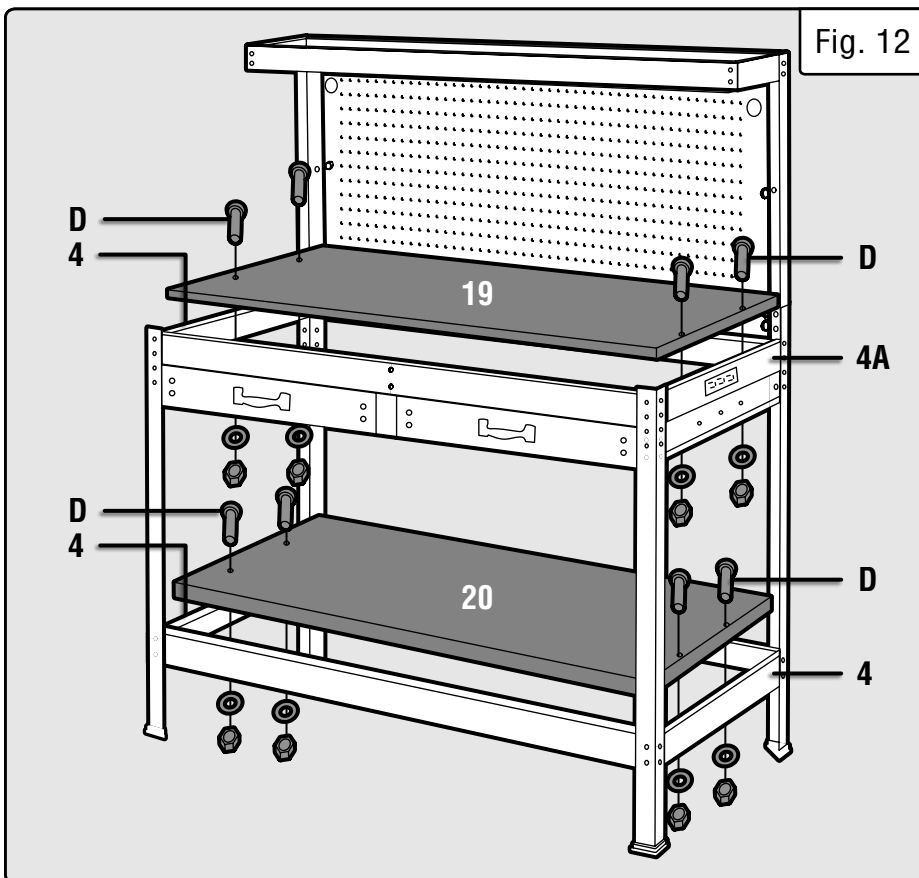

ASSEMBLY & ADJUSTMENTS

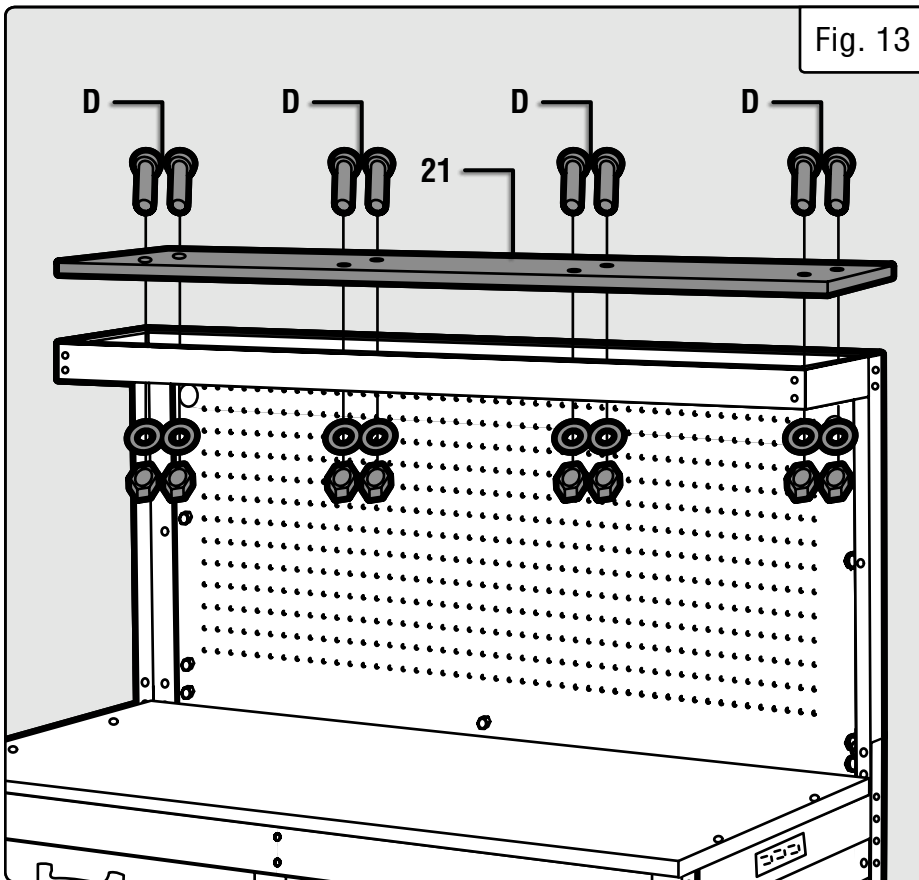

Fig. 13

ATTACHING TOP SHELF (21)

18. Attach the top shelf (Fig. 13 - 21) to the shelf beams using M5x25 bolts, washers, and nuts (D).

ATTACH LIGHT FIXTURE (23)

18. Attach the light fixture (Fig. 14 - 23) to the underside of the top shelf (Fig. 14 - 21) using M4x16 screws (G).

19. Insert a screw through each of the light fixture clips.

20. Thread screws through the holes on the underside of the top shelf (Fig. 14 - 21).

21. Push the light fixture up into the clips until the light fixture snaps into place.

TIGHTEN FASTENERS

22. Make sure all shelves are level and check square. Then, tighten all bolts and screws securely using the appropriate tools, **EXCEPT** the middle drawer brackets.

Check the drawers' run (you may have to swap the drawers side to side to get a better fit).

Once everything runs smoothly, tighten the middle drawer brackets. Check that the work station is stable.

LIGHT FIXTURE POWER CORD

Attach light fixture power cord to receptacle at the end of the fixture. It will only connect one way. Route cord through hole in the pegboard.

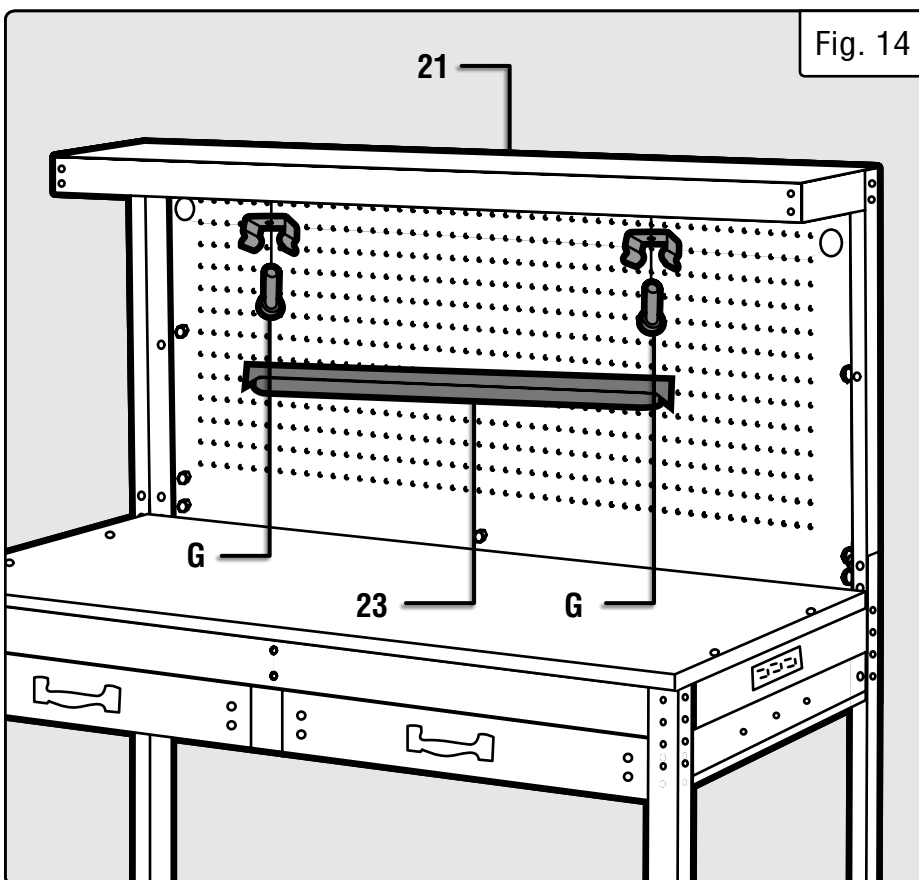



Fig. 14

MAINTENANCE

 **WARNING!** To avoid accidents, make sure the power switch is in the OFF position and unplug the tool from the electrical outlet before assembly, cleaning or performing any maintenance.

1. Before each use, inspect the general condition of the tool. Check for:

- Loose hardware,
- Misalignment or binding of moving parts,
- Damaged cord/electrical wiring,
- Cracked or broken parts, and
- Any other condition that may affect its safe operation.

2. After every use, wipe the external surfaces with a clean cloth. Do not let water enter the electrical system.

PRODUCT DISPOSAL

The tool, accessories and packaging should be sorted for recycling, instead of disposed of with household waste. Please take them to your local recycling facility for responsible disposal and to minimize the environmental impact.

WARRANTY STATEMENT

WEN Products is committed to building tools that are dependable for years. Our warranties are consistent with this commitment and our dedication to quality.

LIMITED WARRANTY OF WEN PRODUCTS FOR HOME USE

GREAT LAKES TECHNOLOGIES, LLC (“Seller”) warrants to the original purchaser only, that all WEN consumer power tools will be free from defects in material or workmanship during personal use for a period of two (2) years from date of purchase or 500 hours of use; whichever comes first. Ninety days for all WEN products if the tool is used for professional or commercial use. Purchaser has 30 days from the date of purchase to report missing or damaged parts.

SELLER’S SOLE OBLIGATION AND YOUR EXCLUSIVE REMEDY under this Limited Warranty and, to the extent permitted by law, any warranty or condition implied by law, shall be the replacement of parts, without charge, which are defective in material or workmanship and which have not been subjected to misuse, alteration, careless handling, misrepair, abuse, neglect, normal wear and tear, improper maintenance, or other conditions adversely affecting the Product or the component of the Product, whether by accident or intentionally, by persons other than Seller. To make a claim under this Limited Warranty, you must make sure to keep a copy of your proof of purchase that clearly defines the Date of Purchase (month and year) and the Place of Purchase. Place of Purchase must be a direct vendor of Great Lakes Technologies, LLC. Purchasing through third party vendors, including but not limited to garage sales, pawn shops, resale shops, or any other secondhand merchant, voids the warranty included with this product. Contact techsupport@wenproducts.com or 1-800-232-1195 with the following information to make arrangements: your shipping address, phone number, serial number, required part numbers, and proof of purchase. Damaged or defective parts and products may need to be sent to WEN before the replacements can be shipped out.

Upon the confirmation of a WEN representative, your product may qualify for repairs and service work. When returning a product for warranty service, the shipping charges must be prepaid by the purchaser. The product must be shipped in its original container (or an equivalent), properly packed to withstand the hazards of shipment. The product must be fully insured with a copy of the proof of purchase enclosed. There must also be a description of the problem in order to help our repairs department diagnose and fix the issue. Repairs will be made and the product will be returned and shipped back to the purchaser at no charge for addresses within the contiguous United States.

THIS LIMITED WARRANTY DOES NOT APPLY TO ITEMS THAT WEAR OUT FROM REGULAR USAGE OVER TIME, INCLUDING BELTS, BRUSHES, BLADES, BATTERIES, ETC. ANY IMPLIED WARRANTIES SHALL BE LIMITED IN DURATION TO TWO (2) YEARS FROM DATE OF PURCHASE. SOME STATES IN THE U.S. AND SOME CANADIAN PROVINCES DO NOT ALLOW LIMITATIONS ON HOW LONG AN IMPLIED WARRANTY LASTS, SO THE ABOVE LIMITATION MAY NOT APPLY TO YOU.

IN NO EVENT SHALL SELLER BE LIABLE FOR ANY INCIDENTAL OR CONSEQUENTIAL DAMAGES (INCLUDING BUT NOT LIMITED TO LIABILITY FOR LOSS OF PROFITS) ARISING FROM THE SALE OR USE OF THIS PRODUCT. SOME STATES IN THE U.S. AND SOME CANADIAN PROVINCES DO NOT ALLOW THE EXCLUSION OR LIMITATION OF INCIDENTAL OR CONSEQUENTIAL DAMAGES, SO THE ABOVE LIMITATION OR EXCLUSION MAY NOT APPLY TO YOU.

THIS LIMITED WARRANTY GIVES YOU SPECIFIC LEGAL RIGHTS, AND YOU MAY ALSO HAVE OTHER RIGHTS WHICH VARY FROM STATE TO STATE IN THE U.S., PROVINCE TO PROVINCE IN CANADA AND FROM COUNTRY TO COUNTRY.

THIS LIMITED WARRANTY APPLIES ONLY TO ITEMS SOLD WITHIN THE UNITED STATES OF AMERICA, CANADA AND THE COMMONWEALTH OF PUERTO RICO. FOR WARRANTY COVERAGE WITHIN OTHER COUNTRIES, CONTACT THE WEN CUSTOMER SUPPORT LINE. FOR WARRANTY PARTS OR PRODUCTS REPAIRED UNDER WARRANTY SHIPPING TO ADDRESSES OUTSIDE OF THE CONTIGUOUS UNITED STATES, ADDITIONAL SHIPPING CHARGES MAY APPLY.