

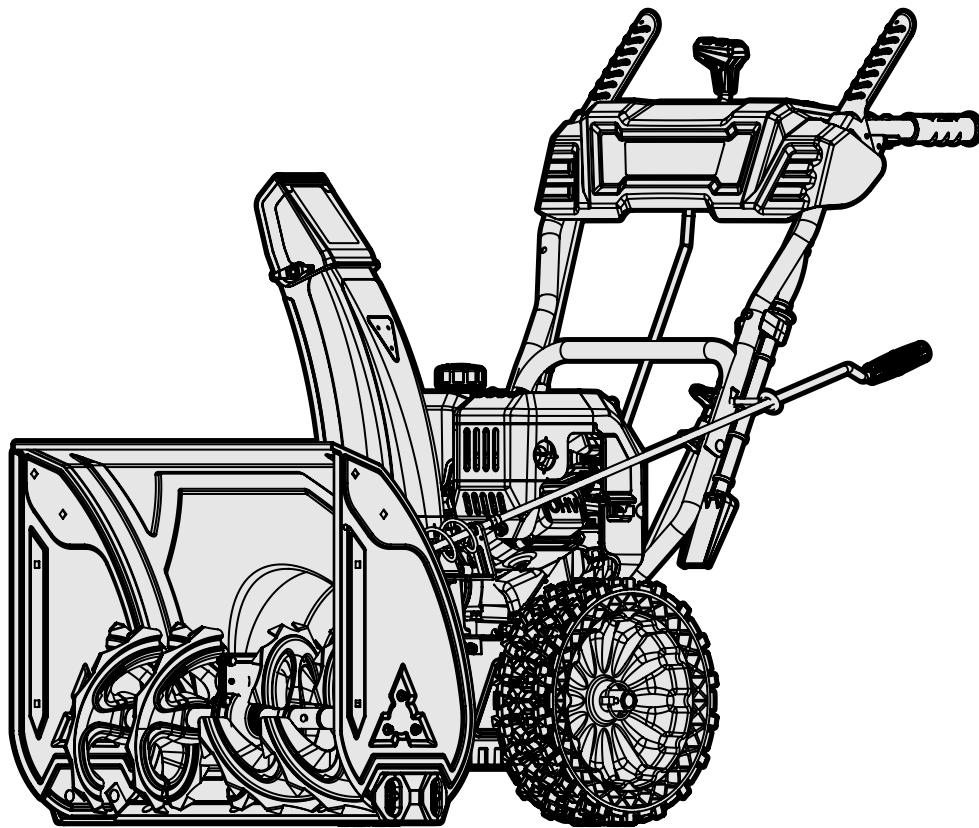

**MODEL SB209E**

# **24-INCH TWO-STAGE SNOW BLOWER**

**Instruction Manual**



## **NEED HELP? CONTACT US!**

Have product questions? Need technical support? Please feel free to contact us:



**1-847-429-9263 (M-F 8AM-5PM CST)**



**TECHSUPPORT@WENPRODUCTS.COM**

**IMPORTANT:** Your new tool has been engineered and manufactured to WEN's highest standards for dependability, ease of operation, and operator safety. When properly cared for, this product will supply you years of rugged, trouble-free performance. Pay close attention to the rules for safe operation, warnings, and cautions. If you use your tool properly and for its intended purpose, you will enjoy years of safe, reliable service.

For replacement parts and the most up-to-date instruction manuals, visit ***WENPRODUCTS.COM***

# CONTENTS

<b>WELCOME</b>	<b>3</b>
Specifications.....	3
Introduction .....	4
<b>SAFETY</b>	<b>5</b>
General Safety Rules .....	5
Snow Blower Safety Warnings.....	8
Electrical Information.....	11
<b>BEFORE OPERATING</b>	<b>11</b>
Unpacking & Packing List.....	11
Know Your Snow Blower.....	13
Assembly & Adjustments.....	14
Snow Blower Preparation.....	19
<b>OPERATION &amp; MAINTENANCE</b>	<b>22</b>
Starting Your Snow Blower .....	22
Operation .....	24
Maintenance.....	26
Troubleshooting Guide.....	31
Exploded View & Parts List.....	33
Warranty Statement.....	44

To purchase accessories and replacement parts for your tool, visit ***WENPRODUCTS.COM***

**Magnetic Oil Dipstick** (Model 55201)

**100-Foot Extension Cord** (Model PC1123)

**50-Foot Extension Cord** (Model PC5124)

**High-Altitude Kit** (Part SB209E-HA36, SB209E-HA68)

# ***SPECIFICATIONS***

## **SNOW BLOWER**

Model Number	SB209E
Stages	2-Stage
Maximum Clearing Width	24 in.
Maximum Clearing Height	20 in.
Throwing Distance	30 feet
Auger Diameter	10 in.
Tires	13 in. x 4.1 in. tubeless
Speed Control	6 speeds forward, 2 speeds backwards
Chute Range of Motion	190 degrees
Weight	144 pounds
Product Dimensions	30.3 in. x 24.6 in. x 24.6 in.

## **ENGINE**

Engine Type	4-stroke, OHV, single-cylinder with forced-air cooling system
Engine Displacement	209cc
Fuel Tank Capacity	0.6 gallons (2.3 L)
Oil Capacity	16.9 fl. oz (0.5 L)
Runtime	up to 2 hours
Lubrication System	Splash lubrication
Spark Plug Type	Torch F6TC (NGK BP6ES)
Spark Plug Gap	0.7mm - 0.8mm (0.028 in. - 0.031 in.)
Spark Plug Torque	14.75 - 19.18 ft-lb (20 - 26 Nm)
Electric Start	120VAC, 10A, Onboard Receptacle

# INTRODUCTION

Thanks for purchasing the WEN snow blower. Refer to the illustration below for the location of the serial number on the control panel label. Record the snow blower information in the spaces provided below. If assistance for information or service is required, please contact customer service by calling **1-847-429-9263**, M-F 8-5 CST; you will be asked to provide the following snow blower information when calling.

**Snow Blower Model Number:** SB209E

**Date of Purchase:** \_\_\_\_\_

**Purchased From:** \_\_\_\_\_

**Serial Number:** \_\_\_\_\_

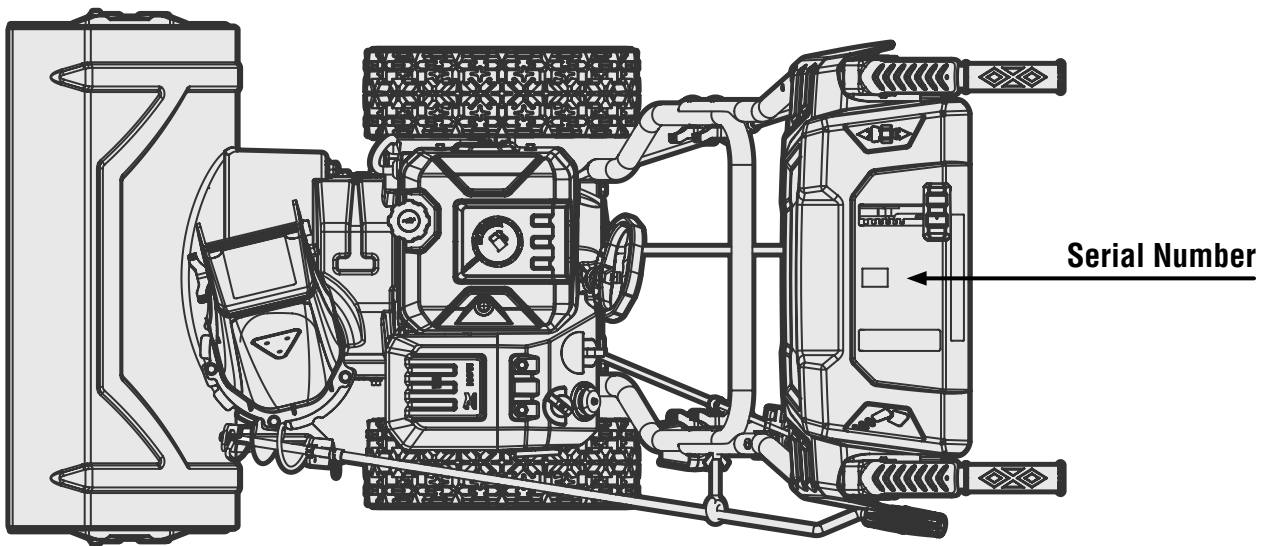

## SERVICE RECORD

Record the service dates of your snow blower in the chart below. Please perform maintenance checks and operations according to this manual. Refer to "MAINTENANCE" on page 26.

Service Record	Date	Date	Date	Date	Date	Date
Change Oil						
Change Spark Plug						
Drain Fuel Tank						
Check Tires						

**TO MAXIMIZE THE LIFESPAN OF YOUR SNOW BLOWER:** We recommend running your snow blower at least once a month for 20 to 30 minutes. Start the snow blower according to the instructions.

# GENERAL SAFETY RULES

 **WARNING:** Before operating the snow blower, make sure to read all safety warnings and all instructions. Failure to follow the warnings and instructions may result in electric shock, fire or serious injury.

## SAFETY INTRODUCTION

Safety is a combination of common sense, staying alert, and knowing how your tool works. This manual contains important information regarding the snow blower's potential safety concerns, as well as preparation, operation, and maintenance instructions. Before operating this snow blower, be sure to read and observe all warnings and instructions both on the snow blower labels and in this instruction manual. Failure to follow all instructions listed below may result in personal injury.

**NOTE:** The following safety information is not meant to cover all possible conditions and situations that may occur. WEN reserves the right to change this product and specifications at any time without prior notice.

At WEN, we are continuously improving our products. If you find that your tool does not exactly match this manual, please visit [wenproducts.com](http://wenproducts.com) for the most up-to-date manual or contact customer service at **1-847-429-9263**, M-F 8-5 CST.

**Keep this manual available to all users during the entire life of the tool and review it frequently to maximize safety for both yourself and others.**

**SAVE THESE SAFETY INSTRUCTIONS.**

## SAFETY SYMBOLS

The purpose of following safety symbols is to attract your attention to possible dangers. The safety symbols, and their explanations, deserve your careful attention and understanding. The safety warnings do not by themselves eliminate any danger. The instructions or warnings they give are not substitutes for proper accident prevention measures.

 **DANGER!** Indicates a hazard, which, if not avoided, will result in death or serious injury.

 **WARNING!** Indicates a hazard, which, if not avoided, could result in death or serious injury.

 **CAUTION!** Indicates a hazard, which, if not avoided, might result in minor or moderate injury.

**CAUTION!** When used without the alert symbol, indicates a situation that could result in damage to the machine.

## NOTICE REGARDING EMISSIONS

Engines that are certified to comply with U.S. EPA emission regulations for SORE (Small Off Road Equipment), are certified to operate on regular unleaded gasoline, and may include the following emission control systems: (EM) Engine Modifications and (TWC) Three-Way Catalyst (if so equipped).

## QUESTIONS? PROBLEMS?

In order to answer questions and solve problems in the most efficient and speedy manner, contact customer service at **1-847-429-9263**, M-F 8-5 CST or email [techsupport@wenproducts.com](mailto:techsupport@wenproducts.com).

# GENERAL SAFETY RULES

 **WARNING!** Read all safety warnings and all instructions. Failure to follow the warnings and instructions may result in electric shock, fire and/or serious injury.

Safety is a combination of common sense, staying alert and knowing how your item works. The term “power tool” in the warnings refers to your mains-operated (corded) power tool or battery-operated (cordless) power tool.

## SAVE THESE SAFETY INSTRUCTIONS.

### WORK AREA SAFETY

- 1. Keep work area clean and well lit.** Cluttered or dark areas invite accidents.
- 2. Do not operate power tools in explosive atmospheres, such as in the presence of flammable liquids, gases or dust.** Power tools create sparks which may ignite the dust or fumes.
- 3. Keep children and bystanders away while operating a power tool.** Distractions can cause you to lose control.

### ELECTRICAL SAFETY

- 1. Power tool plugs must match the outlet. Never modify the plug in any way. Do not use any adapter plugs with earthed (grounded) power tools.** Unmodified plugs and matching outlets will reduce risk of electric shock.
- 2. Avoid body contact with earthed or grounded surfaces such as pipes, radiators, ranges and refrigerators.** There is an increased risk of electric shock if your body is earthed or grounded.
- 3. Do not expose power tools to rain or wet conditions.** Water entering a power tool will increase the risk of electric shock.
- 4. Do not abuse the cord. Never use the cord for carrying, pulling or unplugging the power tool. Keep cord away from heat, oil, sharp edges or moving parts.** Damaged or entangled cords increase the risk of electric shock.
- 5. When operating a power tool outdoors, use an extension cord suitable for outdoor use.** Use of a cord suitable for outdoor use reduces the risk of electric shock.

- 6. If operating a power tool in a damp location is unavoidable, use a ground fault circuit interrupter (GFCI) protected supply.** Use of a GFCI reduces the risk of electric shock.

### PERSONAL SAFETY

- 1. Stay alert, watch what you are doing and use common sense when operating a power tool. Do not use a power tool while you are tired or under the influence of drugs, alcohol or medication.** A moment of inattention while operating power tools may result in serious personal injury.
- 2. Use personal protective equipment. Always wear eye protection.** Protective equipment such as a respiratory mask, non-skid safety shoes and hearing protection used for appropriate conditions will reduce the risk of personal injury.
- 3. Prevent unintentional starting. Ensure the switch is in the off-position before connecting to power source and/or battery pack, picking up or carrying the tool.** Carrying power tools with your finger on the switch or energizing power tools that have the switch on invites accidents.
- 4. Remove any adjusting key or wrench before turning the power tool on.** A wrench or a key left attached to a rotating part of the power tool may result in personal injury.
- 5. Do not overreach. Keep proper footing and balance at all times.** This enables better control of the power tool in unexpected situations.
- 6. Dress properly. Do not wear loose clothing or jewelry. Keep your hair and clothing away from moving parts.** Loose clothes, jewelry or long hair can be caught in moving parts.

# GENERAL SAFETY RULES

 **WARNING!** Read all safety warnings and all instructions. Failure to follow the warnings and instructions may result in electric shock, fire and/or serious injury.

Safety is a combination of common sense, staying alert and knowing how your item works. The term “power tool” in the warnings refers to your mains-operated (corded) power tool or battery-operated (cordless) power tool.

## SAVE THESE SAFETY INSTRUCTIONS.

**7. If devices are provided for the connection of dust extraction and collection facilities, ensure these are connected and properly used.** Use of dust collection can reduce dust-related hazards.

### POWER TOOL USE AND CARE

**1. Do not force the power tool. Use the correct power tool for your application.** The correct power tool will do the job better and safer at the rate for which it was designed.

**2. Do not use the power tool if the switch does not turn it on and off.** Any power tool that cannot be controlled with the switch is dangerous and must be repaired.

**3. Disconnect the plug from the power source and/or the battery pack from the power tool before making any adjustments, changing accessories, or storing power tools.** Such preventive safety measures reduce the risk of starting the power tool accidentally.

**4. Store idle power tools out of the reach of children and do not allow persons unfamiliar with the power tool or these instructions to operate the power tool.** Power tools are dangerous in the hands of untrained users.

**5. Maintain power tools. Check for misalignment or binding of moving parts, breakage of parts and any other condition that may affect the power tool's operation. If damaged, have the power tool repaired before use.** Many accidents are caused by poorly maintained power tools.

**6. Keep cutting tools sharp and clean.** Properly maintained cutting tools with sharp cutting edges are less likely to bind and are easier to control.

**7. Use the power tool, accessories and tool bits, etc. in accordance with these instructions, taking into account the working conditions and the work to be performed.** Use of the power tool for operations different from those intended could result in a hazardous situation.

**8. Use clamps to secure your workpiece to a stable surface.** Holding a workpiece by hand or using your body to support it may lead to loss of control.

**9. KEEP GUARDS IN PLACE** and in working order.

### SERVICE

**1. Have your power tool serviced by a qualified repair person using only identical replacement parts.** This will ensure that the safety of the power tool is maintained.

### CALIFORNIA PROPOSITION 65 WARNING

Some dust created by power sanding, sawing, grinding, drilling, and other construction activities may contain chemicals, including lead, known to the State of California to cause cancer, birth defects, or other reproductive harm. Wash hands after handling. Some examples of these chemicals are:

- Lead from lead-based paints.
- Crystalline silica from bricks, cement, and other masonry products.
- Arsenic and chromium from chemically treated lumber.

Your risk from these exposures varies depending on how often you do this type of work. To reduce your exposure to these chemicals, work in a well-ventilated area with approved safety equipment such as dust masks specially designed to filter out microscopic particles.

## **SNOW BLOWER SAFETY WARNINGS**

### **DANGER! CARBON MONOXIDE**

Using a snow blower indoors **CAN KILL YOU IN MINUTES**. Snow blower exhaust contains carbon monoxide (CO). This is a poison gas you cannot see or smell. If you can smell the snow blower exhaust, you are breathing CO. But even if you cannot smell the exhaust, you could be breathing CO.

**NEVER** use a snow blower inside homes, garages, crawl spaces, or other partially enclosed areas. Deadly levels of carbon monoxide can build up in these areas. Using a fan or opening windows and doors does **NOT** supply enough fresh air. **ONLY** use a snow blower outside and far away from windows, doors, and vents. These openings can pull in snow blower exhaust.

Even if you use a snow blower correctly, CO may leak into the home. **ALWAYS** use a battery-powered or battery-backup CO alarm in the home. If you start to feel sick, dizzy, or weak after the snow blower has been running, move to fresh air **RIGHT AWAY**. See a doctor. You may have carbon monoxide poisoning.

 **WARNING! RISK OF EXPLOSION. HIGHLY FLAMMABLE:** This snow blower may emit highly flammable and explosive gasoline vapors, which can cause severe burns or even death, if ignited. A nearby open flame can lead to explosion even if not directly in contact with gasoline.

- Do not operate near open flame, heat, or any other ignition source. Do not smoke near the snow blower.
- Always operate on a firm, level surface.
- Always turn snow blower off before refueling. Allow the snow blower to cool for at least 2 minutes before removing fuel cap. Loosen cap slowly to relieve pressure in tank.
- Do not overfill fuel tank. Gasoline may expand during operation. Do not fill to the top of the tank. Allow for expansion. Always check for spilled fuel before operating.
- If fuel spills, move the snow blower at least 30 feet away from the spill and wipe clean any spilled fuel before starting the engine.
- Empty fuel tank before storing or transporting the snow blower.

 **CALIFORNIA PROPOSITION 65 WARNING:** This product contains chemicals and produces exhaust known to the State of California to cause cancer, birth defects and other reproductive harm.



# SNOW BLOWER SAFETY WARNINGS

 **WARNING!** Do not let comfort or familiarity with the product replace strict adherence to product safety rules. Failure to follow the safety instructions may result in serious personal injury.

## OPERATING ENVIRONMENT

- 1. Using a snow blower indoors can kill you in minutes.** Only use a snow blower outside and far away from windows, doors and vents.
- 2. Do not smoke near the snow blower.**
- 3. Do not operate near open flame, heat, or flammable materials.** This snow blower may emit highly flammable and explosive gasoline vapors, which can cause severe burns or even death if ignited. A nearby open flame can lead to an explosion even if it isn't directly in contact with gasoline.
- 4. Thoroughly inspect the area where the snow blower is to be used.** Remove all doormats, newspapers, sleds, boards, wires, extension cords, or any other foreign objects. Such objects pose a tripping hazard, or could be thrown by the auger.
- 5. Maintain distance between the snow blower and bystanders.** Keep at least 75 feet away from bystanders, pets, children, etc. Stop the machine if anyone enters this area.
- 6. Thrown objects can cause serious personal injury.** Plan your snow blowing pattern to avoid discharge of material towards roads, bystanders, windows, walls, cars, etc.
- 7. Exercise caution to avoid slipping or falling, especially when operating in reverse.** Wear appropriate footwear.
- 8. Wear appropriate clothing for the weather conditions.** Wear ANSI Z87.1-approved eye protection, with side shields, at all times. Do not wear jewelry, long scarves, or loose clothing – these can become entangled in moving parts. Wear hearing protection.

## TRAINING

- 1. Read, understand, and follow all instructions** on your snow blower's labels, as well as those contained in this manual, before attempting to assemble, operate, maintain, or otherwise use your machine. Keep this manual in a safe place and refer to it regularly. Ensure all users of the machine are properly trained.
- 2. Familiarize yourself with all controls and their proper operation.** Know how to stop the machine and disengage the controls quickly.
- 3. Do not allow children under 14 years old, or any non-qualified person, to operate the machine.** All operators must be properly trained in the safe use of this machine and follow all instructions on the machine and in this manual. Children 14 years or older should be supervised by a trained adult.

## SNOW BLOWER PREPARATION

- 1. Do not overfill fuel tank, as gasoline may expand during operation.** Do not fill to the very top of the tank. Leave room for gasoline expansion. Always check for spilled fuel before operating.
- 2. If any part of the snow blower is broken, damaged, or defective, make sure it is repaired or replaced before operation.** Service should only be performed by a qualified technician.
- 3. Never modify the snow blower in any way.** Modifying or using the machine for any other purpose for which it is not designed may result in serious injuries, machine damage and voiding of the warranty.
- 4. If using the electric start function, ensure the extension cord is rated for outdoor use.** Use only a grounded three-wire extension cord and receptacle. A GFCI outlet is recommended to maximize safety.

**Snow blower safety warnings continue on the next page.**

## SNOW BLOWER SAFETY WARNINGS

 **WARNING!** Do not operate the power tool until you have read and understood the following instructions and the warning labels.

**5. If using the electric start function, ensure the extension cord is of the proper gauge.** Refer to the extension cord chart on p. 11 for the recommended gauge and length of extension cord.

**6. Disengage all control levers before starting the engine.**

**7. Do not make any adjustments to the machine while the engine is running.**

**8. Let the machine warm up for 1 – 2 minutes before starting to clear snow.**

### SNOW BLOWER OPERATION

**1. Only use the snow blower for its intended purposes.** Modifying or using the snow blower for operations for which it was not designed may cause hazards and personal injury.

**2. Do not touch hot parts.** This snow blower produces heat when running. Temperatures near exhaust can exceed 150°F (65°C). Allow snow blower to cool down after use before touching engine or areas of the snow blower that become hot during use.

**3. Snow blowers vibrate in normal use.** During and after the use of the snow blower, inspect the snow blower for damage resulting from vibration.

**4. Always turn snow blower off before refueling.** Allow snow blower to cool for at least 2 minutes before removing fuel cap. Loosen cap slowly to relieve pressure in tank.

**5. Remove the engine key from the engine when the engine is not running.** Store it in a safe place out of the reach of children.

**6. Empty fuel tank before storing or transporting the snow blower.** Do not store snow blower or gasoline near furnaces, water heaters, or any other appliances that produce heat or have automatic ignitions. Store the snow blower and fuel away from sparks, open flames, pilot lights, heat and other sources of ignition.

**7. Do not operate the machine under the influence of alcohol, drugs, or other substances that could cause lack of awareness.**

**8. Always wash hands after handling machine.**

**9. Never direct discharge at anyone,** even if you think it will be really funny.

**10. Never put hands, feet, or other beloved body parts near rotating parts,** inside the auger housing, or into the chute assembly, even if the engine is not running. Use the included clean-out tool to clear out clogs.

**11. Do not modify or bypass any safety devices.** Keep them in good working order.

**12. Exercise extra caution when operating on, or crossing, gravel or crushed-rock surfaces.** Adjust the skid plates and scraper bar appropriately when gravel or crushed-rock surfaces are involved.

**13. Do not operate on steep slopes (exceeding 15° incline).**

**14. Do not overload the machine.** Let it work at the pace for which it was designed.

**15. Disengage the auger lever when transporting the product,** or not clearing snow.

**16. Operate only in good-visibility conditions.** Keep sure footing and a firm grip on the handles. Walk – never run.

**CAUTION:** Misuse of this snow blower can damage it or shorten its lifespan.

**NOTE:** This manual cannot possibly cover all situations that could occur. Always use common sense and good judgment when operating the machine.

## ELECTRICAL INFORMATION

### GUIDELINES AND RECOMMENDATIONS FOR EXTENSION CORDS

When using an extension cord, be sure to use one heavy enough to carry the current your product will draw. An undersized cord will cause a drop in line voltage resulting in loss of power and overheating. The table below shows the correct size to be used according to cord length and ampere rating. When in doubt, use a heavier cord. The smaller the gauge number, the heavier the cord. **NOTE:** "Amperage" below refers to the current that the starter motor draws.

AMPERAGE	REQUIRED GAUGE FOR EXTENSION CORDS			
	25 ft.	50 ft.	100 ft.	150 ft.
10A	16 gauge	16 gauge	14 gauge	12 gauge

**1. Examine extension cord before use.** Make sure your extension cord is properly wired and in good condition. Always replace a damaged extension cord or have it repaired by a qualified person before using it.

**2. Do not abuse extension cord.** Do not pull on cord to disconnect from receptacle; always disconnect by pulling on plug. Disconnect the extension cord from the receptacle before disconnecting the product from the extension cord. Protect your extension cords from sharp objects, excessive heat and damp/wet areas.

**3. Use a separate electrical circuit for your tool.** This circuit must not be less than a 12-gauge wire and should be protected with a 15A time-delayed fuse. Before connecting the motor to the power line, make sure the switch is in the OFF position and the electric current is rated the same as the current stamped on the motor nameplate. Running at a lower voltage will damage the motor.

**TIP:** WEN offers 12-gauge, outdoor-rated, grounded three-wire extension cords in 50-foot and 100-foot lengths (**Model PC1123, PC5012**), available for purchase at [wenproducts.com](http://wenproducts.com).

## UNPACKING & PACKING LIST

 **WARNING!** Do not plug in or turn on the tool until it is fully assembled according to the instructions. Failure to follow the safety instructions may result in serious personal injury.

### UNPACKING

With the help of a friend or trustworthy foe, carefully remove the snow blower from the packaging and place it on a sturdy, flat surface. Make sure to take out all contents and accessories. Do not discard the packaging until everything is removed. Check the packing list on the next page to make sure you have all of the parts and accessories. If any part is missing or broken, please contact our customer service at **1-847-429-9263** (M-F 8-5 CST), or email [techsupport@wenproducts.com](mailto:techsupport@wenproducts.com).

### TRANSPORTING

To prevent fuel spillage when transporting, be sure to perform the following steps:

1. Tighten the fuel cap and turn the fuel valve to the OFF position.
2. Remove the engine key and store it in a safe place.
3. Drain the fuel tank if possible. Refer to the "DRAINING THE FUEL TANK" section.
4. Keep the snow blower upright. Never place the snow blower on its side or upside down - doing so could damage the internal components of the engine and make it difficult to start.

# **UNPACKING & PACKING LIST**

## **PACKING LIST**

<b>Snow Blower Components</b>		<b>Qty.</b>
Snow Blower		1
Engine Keys (hanging on the snow blower)		2
<b>Handle Assembly</b>		<b>Qty.</b>
Lower Handle		1
Upper Handle		1
Cable Clips (pre-installed on the lower handle)		2
M8x16 Bolts (pre-installed on snow blower body)		4
M8x45 Bolts (pre-installed on the lower handle)		3
M8 Lock Knobs (pre-installed on the lower handle)		3
<b>Cleaning Tool Assembly</b>		<b>Qty.</b>
Cleaning Tool		1
M6x25 Bolt (pre-installed on the cleaning tool)		1
<b>Drive Control Rod Assembly</b>		<b>Qty.</b>
Rod		1
Cotter Pin (pre-installed on the rod)		1
<b>Chute Assembly</b>		<b>Qty.</b>
Chute		1
Rotator Disc (pre-installed on the chute)		
M6x20 Bolts (pre-installed on the chute)		4
<b>Chute Rotator Assembly</b>		<b>Qty.</b>
Chute Rotator		1
M8 Nut (pre-installed on the chute rotator)		1
Cotter Pin (pre-installed on the snow blower)		1
<b>Skid Plate Components</b>		<b>Qty.</b>
Skid Plates		2
M8x20 Bolts (pre-installed on the skid plates)		4
M8 Nuts (pre-installed on the skid plates)		4
<b>Wheel Components</b>		<b>Qty.</b>
Wheels		2
Wheel Pins (pre-installed on the axle)		2
<b>Spare Parts &amp; Accessories</b>		<b>Qty.</b>
Shear Pins		2
Bowtie Clips		2
T-Socket		1

# KNOW YOUR SNOW BLOWER

Refer to the following diagrams to become familiarized with all the parts and controls of your snow blower. The components will be referred to later in the manual for assembly and operation instructions.

Speed Control Lever

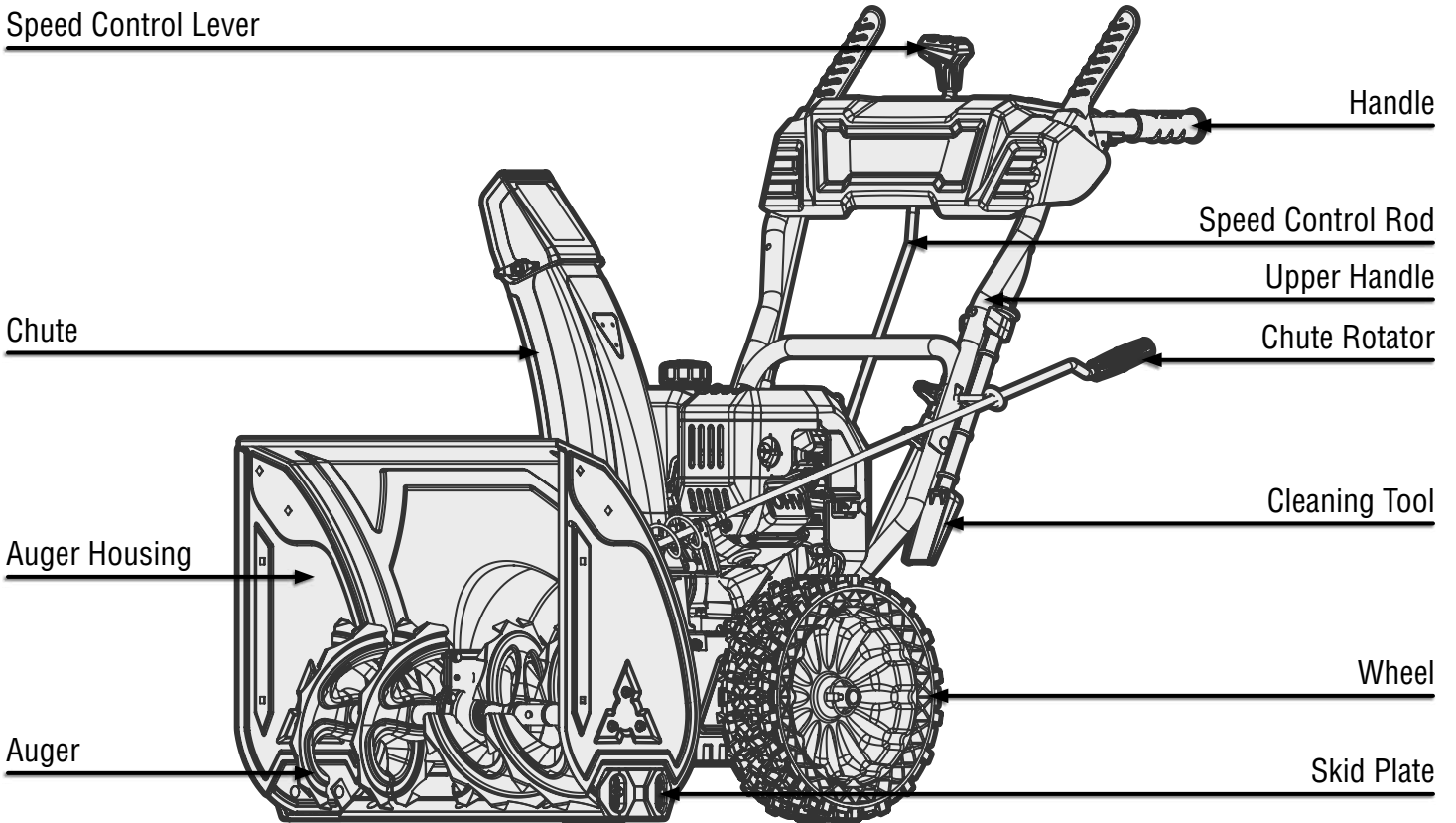

Auger Lever

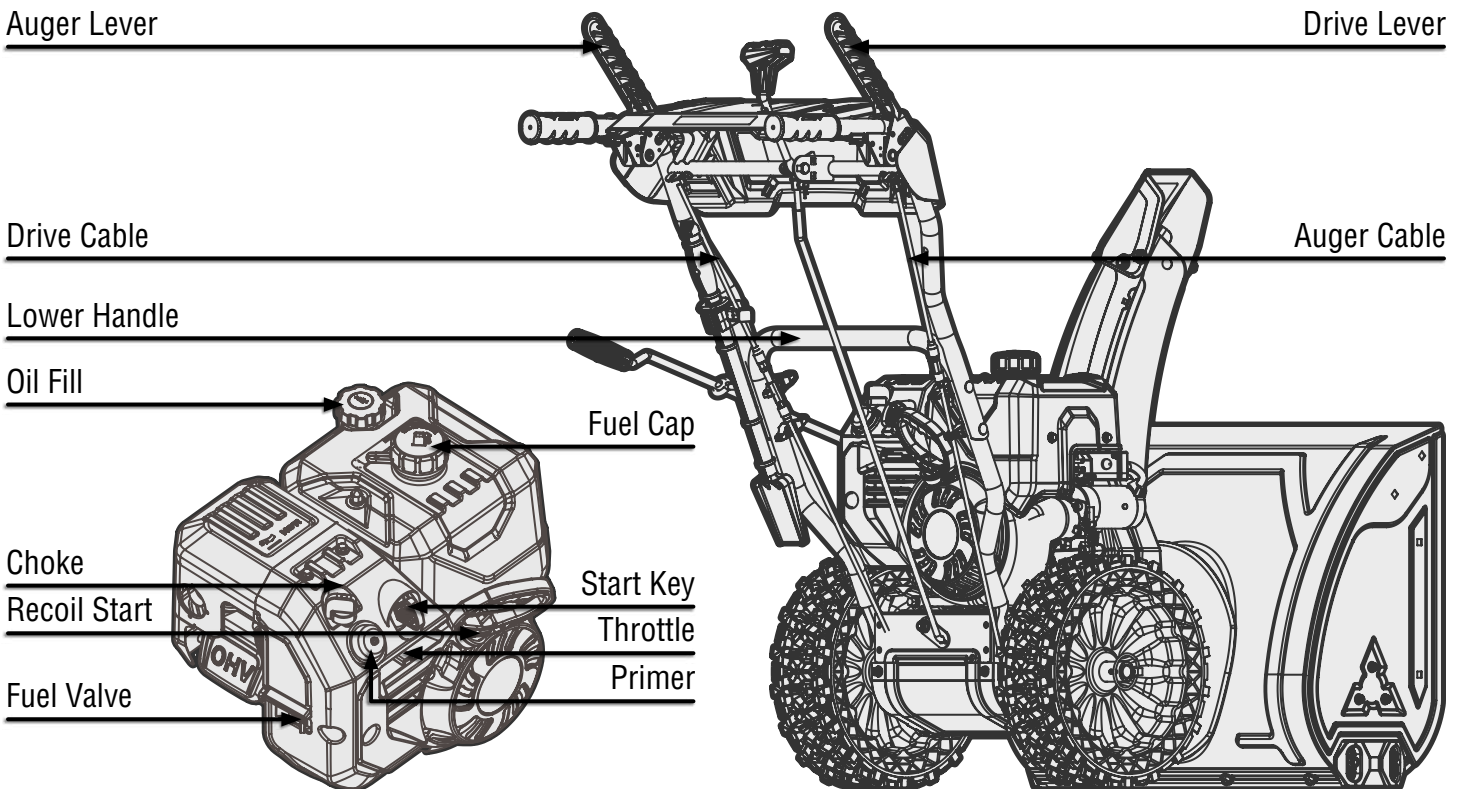

## ASSEMBLY & ADJUSTMENTS

**⚠ WARNING!** Always be sure that the snow blower's engine is OFF and no extension cord is connected before adjusting, adding accessories, or checking a function on the machine.

### INSTALLING THE LOWER HANDLE

1. Install the lower handle (Fig. 1 - 1) on the back of the snow blower body using the four included M8x16 bolts (Fig. 1 - 2) as shown in Fig. 1. **NOTE:** The bolts are pre-installed on the snow blower body.

### INSTALLING THE UPPER HANDLE

1. Remove the three pre-installed M8x45 lock bolts and lock nuts from the lower handle.

2. Install the upper handle (Fig. 2 - 1) on the outside of the lower handle using the three included M8x45 lock bolts (Fig. 2 - 2) and lock knobs (Fig. 2 - 3) as shown in Fig. 2.

3. Install the cleaning tool (Fig. 2 - 4) onto the right side of the upper handle using the included M6x25 bolt (Fig. 2 - 5) as shown in Fig. 2.

**NOTE:** The M6x25 bolt is pre-installed on the cleaning tool's mounting bracket.

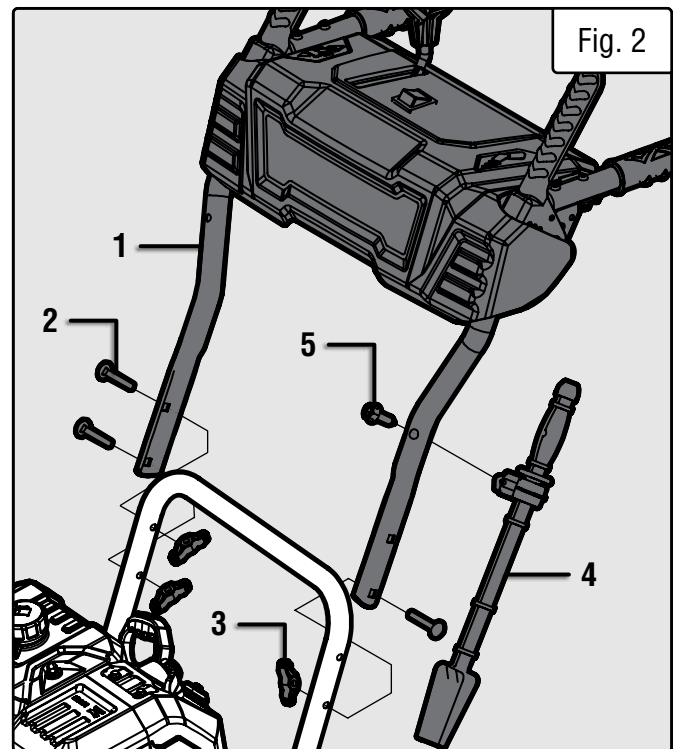
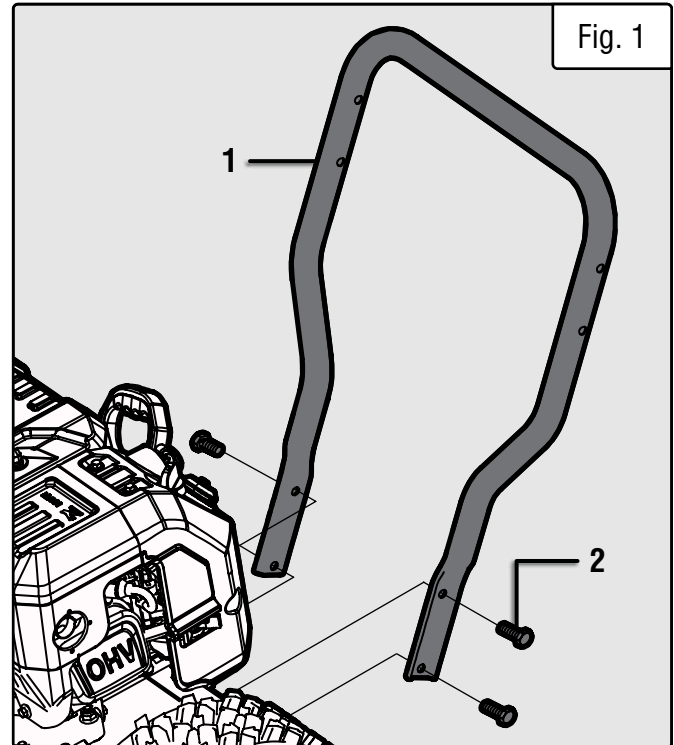

## ASSEMBLY & ADJUSTMENTS

**⚠ WARNING!** Always be sure that the snow blower's engine is OFF and no extension cord is connected before adjusting, adding accessories, or checking a function on the machine.

### INSTALLING THE DRIVE CONTROL ROD

**NOTE:** When assembling for the first time, be sure to cut off the zip ties holding the auger lever and drive lever before installing the rear end of the drive control rod.

1. Install the rear end of the drive control rod (Fig. 3 - 1) into the hole on the shift plate (Fig. 3 - 2). Turn the rod to secure it in place as shown in Fig 3.

2. Install the front end of the drive control rod (Fig. 4 - 1) into the drive control lever hole (Fig. 4 - 2) and secure it in place with a cotter pin (Fig. 4 - 3) as shown in Fig. 4.

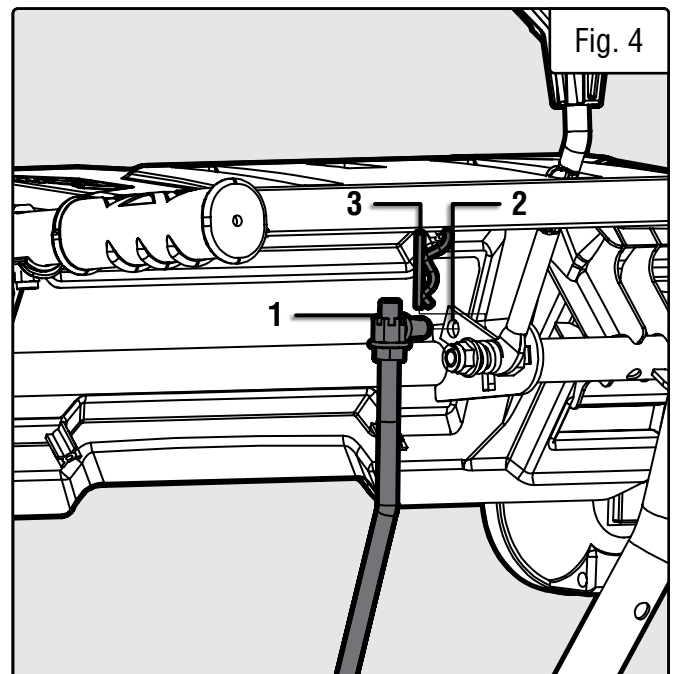
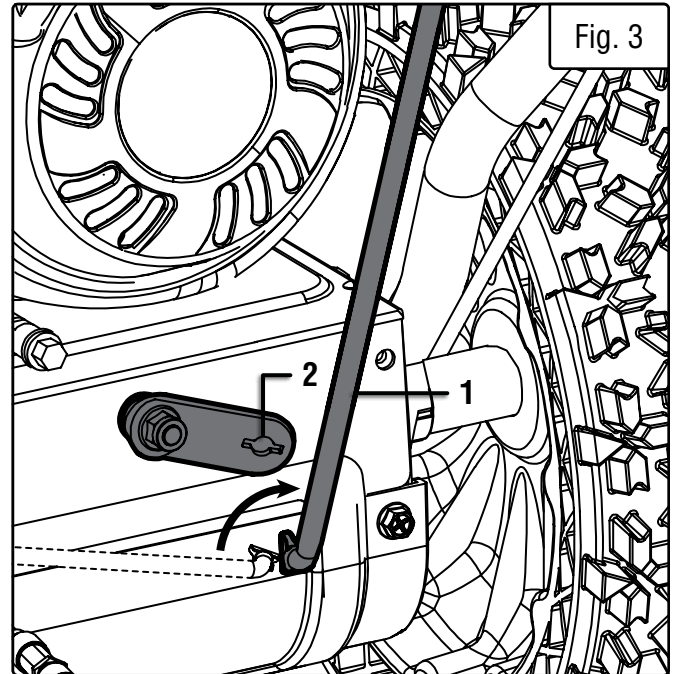

## ASSEMBLY & ADJUSTMENTS

**⚠ WARNING!** Always be sure that the snow blower's engine is OFF and no extension cord is connected before adjusting, adding accessories, or checking a function on the machine.

### INSTALLING THE CHUTE

1. Remove the pre-installed rotator disc (Fig. 5 - 1) and four M6x20 bolts (Fig. 5 - 2) from the chute assembly.

2. Secure the rotator disc and the chute (Fig. 5 - 3) onto the chute base using four M6x20 bolts. The rotator disc sits underneath the neck of the chute base; the chute sits on top of the neck of the chute base. Make sure the spiral vanes on the chute rotator handle rest in the notches in the side of the rotator disc.

**NOTE:** Do not over-tighten or the chute will not be able to rotate. Rotate the chute assembly by hand; if you find that the chute is difficult to rotate, slightly loosen the bolts. Make adjustments as necessary until the chute rotates freely, but does not wobble, on the housing. It should be securely mounted.

### INSTALLING THE CHUTE ROTATOR HANDLE

1. Secure the front end of the chute rotator handle (Fig. 6 - 1) to the chute base using a cotter pin (Fig. 6 - 2) as shown in Fig. 6.

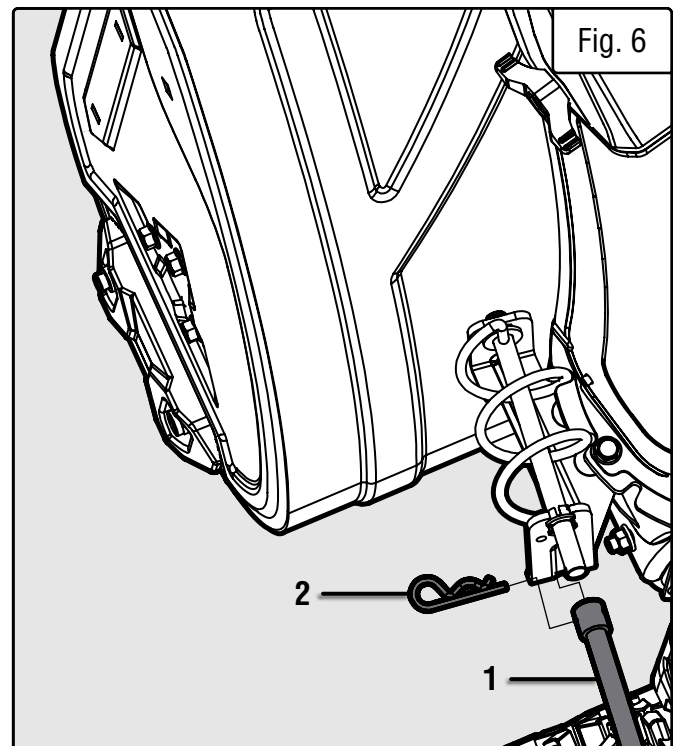
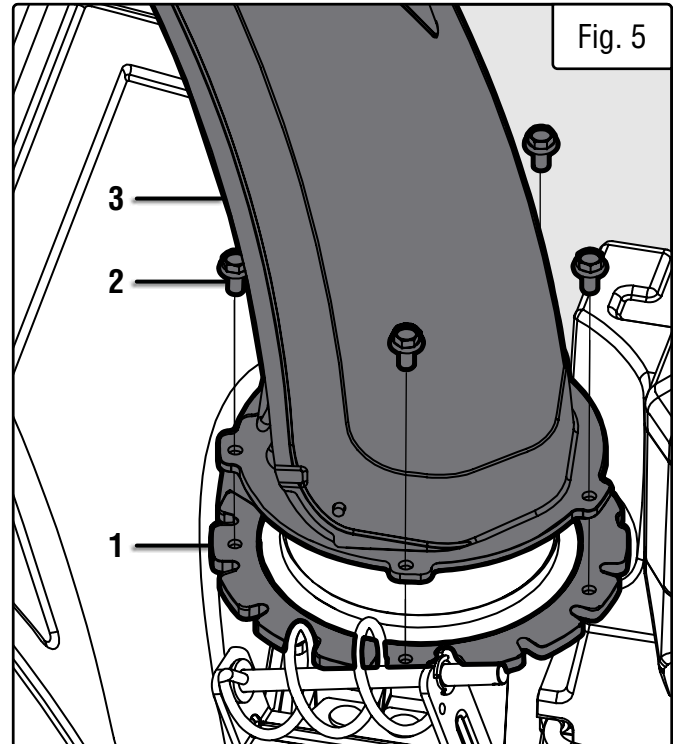



## ASSEMBLY & ADJUSTMENTS

**⚠ WARNING!** Always be sure that the snow blower's engine is OFF and no extension cord is connected before adjusting, adding accessories, or checking a function on the machine.

### INSTALLING THE CHUTE ROTATOR HANDLE (CONT.)

2. Secure the rear end of the chute rotator handle (Fig. 7 - 1) to the upper and lower handle using a M8 lock nut (Fig. 7 - 2) as shown in Fig. 7.

### SECURING THE AUGER AND DRIVE CABLES

1. Secure the auger cable (Fig. 8 - 1) to the left side of the handle and the drive cable (Fig. 8 - 2) to the right side of the handle using the two included cable clips (Fig. 8 - 3).

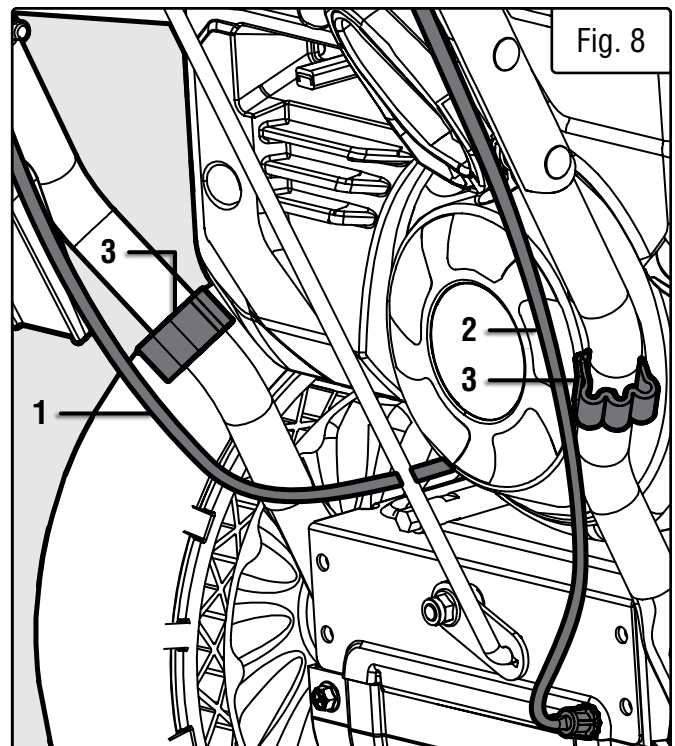
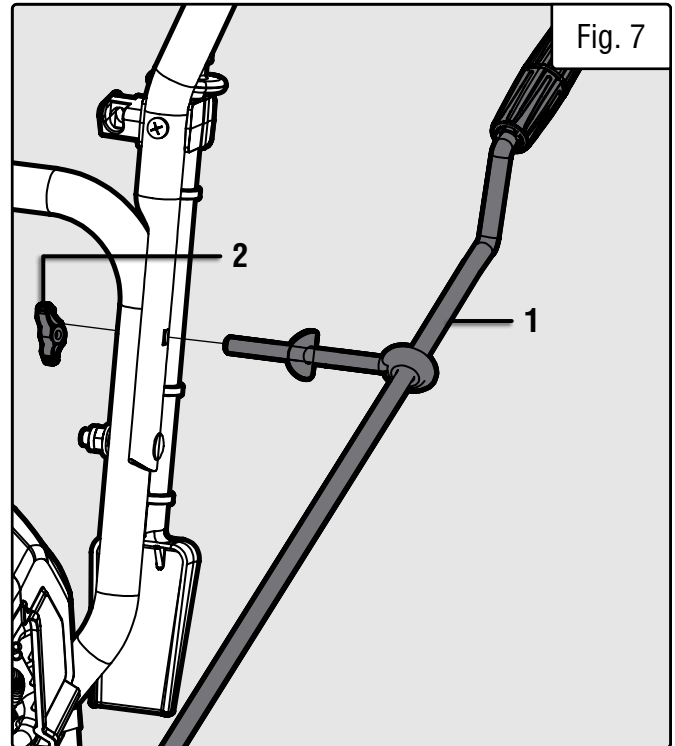

## ASSEMBLY & ADJUSTMENTS

**⚠ WARNING!** Always be sure that the snow blower's engine is OFF and no extension cord is connected before adjusting, adding accessories, or checking a function on the machine.

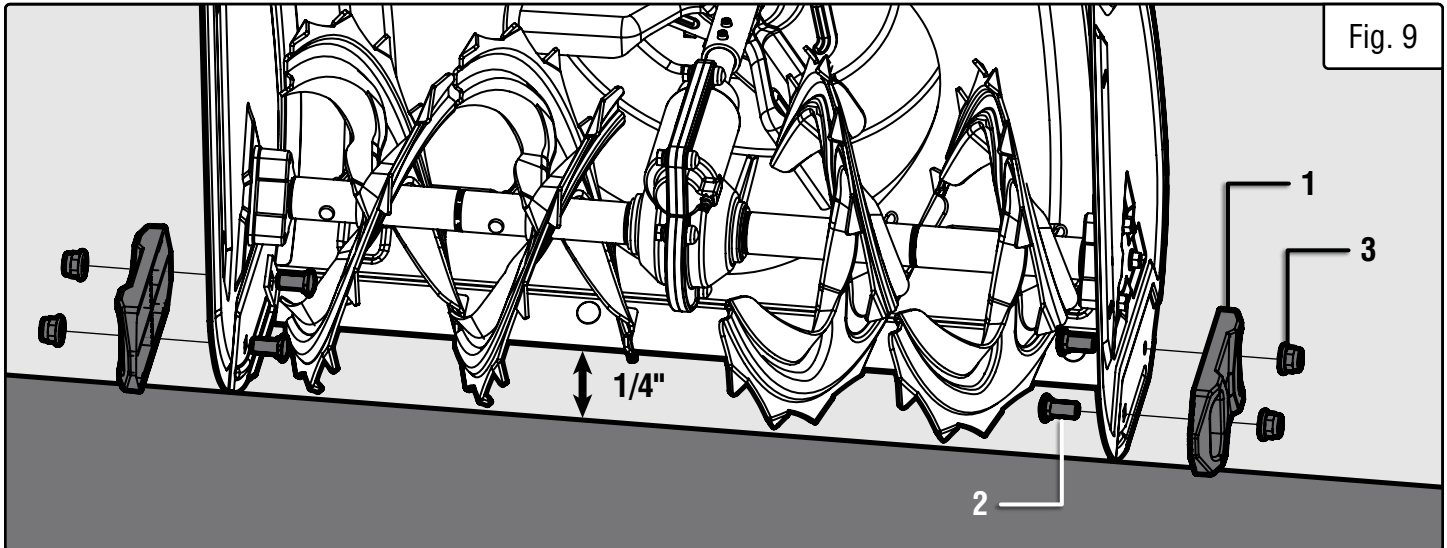

### INSTALLING THE SKID PLATES

1. Secure the skid plate (Fig. 9 - 1) into the two holes on the side of the auger housing using two M8x20 bolt (Fig. 9 - 2) and two M8 nuts (Fig. 9 - 3). Repeat for the other skid plate on the other side of the auger housing. Set the bottom of the scraper bar 6mm (1/4") from the top of the ground.

The skid plate setting controls how far above the ground the scraper bar operates. When operating on concrete, asphalt, or other smooth surfaces, adjust the skid plate so that the bottom of the scraper bar rides along the ground. When operating on gravel, dirt, crushed rock, or other uneven surfaces, adjust the skid plate so that the bottom of the scraper bar rides just above the ground, to prevent debris from entering the auger. Surfaces with larger, coarser debris (e.g. larger pieces of gravel) require a more-raised scraper bar.

### INSTALLING THE WHEELS

1. Install the two wheels on the axle under the engine and secure them in place with the included wheel pins (Fig. 10 - 1).

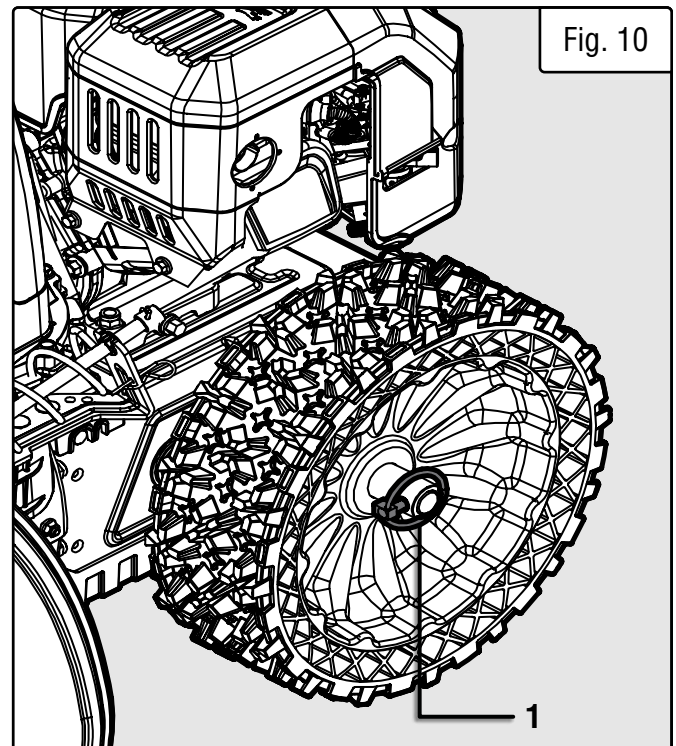

# SNOW BLOWER PREPARATION

The following section describes the necessary steps to prepare the snow blower for use. If you are unsure about how to perform any of the steps please call **1-847-429-9263** (M-F 8-5 CST) for customer service. Failure to perform these steps properly can damage the snow blower or shorten its life.

## STEP 1 - ADD / CHECK OIL

The user must add the proper amount of oil before operating the snow blower for the first time. The oil capacity of the engine crankcase is **16.9 fl. oz (0.5 L)**.

**ENGINE OIL RECOMMENDATIONS** - Select good quality detergent oil bearing the American Petroleum Institute (API) service classifications SJ, SL, or SM (synthetic oils may be used). Select the SAE viscosity grade of oil that matches the expected operating temperature. For general use (above 40° F), we recommend using 30W engine oil.

Fig. 11

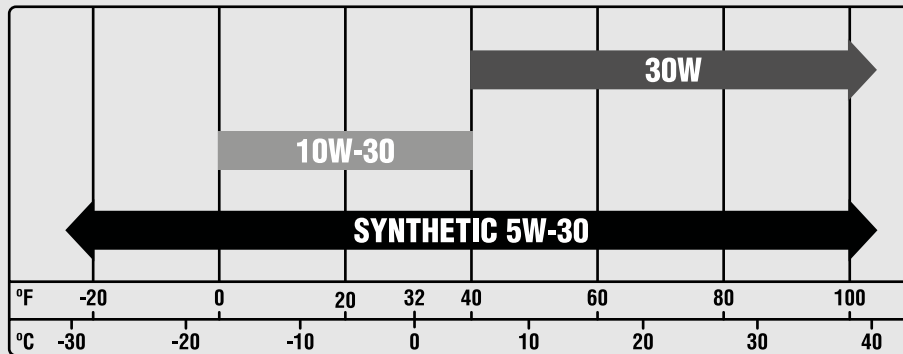

- **30W Engine Oil**  
Temperatures above 40°F.
- **10W-30 Engine Oil**  
Temperatures between 0°F - 40°F.
- **Synthetic 5W-30 Engine Oil**  
All temperature ranges.

### To add oil:

1. Place the snow blower on a level surface. Make sure the engine is off before adding or checking oil.
2. Unscrew the oil dipstick (Fig. 12 - 1) from the engine.

**CAUTION!** Keep the snow blower level. Tilting the snow blower to assist in filling will cause oil to flow into the wrong areas of the engine and cause damage.

3. Using an oil funnel or appropriate dispenser, slowly add oil into the oil fill, being careful not to overfill the unit. Use the dipstick to check the oil level as you fill the tank. The oil should reach the section between the upper (H) and lower (L) level. Reinstall the oil dipstick and firmly tighten it. Wipe clean any spilled oil.

### To check oil level (before every subsequent start):

1. Place the snow blower on a level surface. Make sure the engine is off before adding or checking oil.
2. Remove and wipe the dipstick with a clean rag.
3. Insert the dipstick into the oil fill without screwing it in. Remove the dipstick to check the oil mark.
4. If the oil mark **does not reach the section between the upper (H) and lower (L) mark** on the dipstick, slowly **add oil** until the oil mark reaches this section.

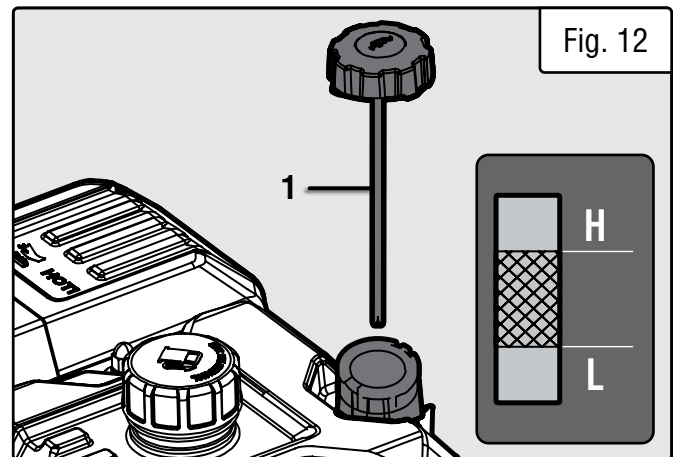

Fig. 12

**CAUTION!** For subsequent operation, the oil level should be checked before each use, or after every 8 hours of operation. Follow the instructions on this page to check the oil level.

**TIP:** Your WEN snow blower is compatible with the **WEN 55201** Magnetic Oil Dipstick (not included), available for purchase at **wenproducts.com**. The dipstick's industrial-strength magnetic tip will collect metal shavings from your snow blower's oil tank to help preserve the engine and extend your snow blower's lifespan.

# SNOW BLOWER PREPARATION

## STEP 2 - ADD / CHECK FUEL

**⚠ WARNING: RISK OF EXPLOSION. HIGHLY FLAMMABLE:** This snow blower may emit highly flammable and explosive gasoline vapors, which can cause severe burns or even death, if ignited. A nearby open flame can lead to explosion even if not directly in contact with gasoline.

- Do not operate near open flame, heat, or any other ignition source. Do not smoke near the snow blower.
- Always operate on a firm, level surface.
- Always turn the snow blower off before refueling. Allow the snow blower to cool for at least 2 minutes before removing fuel cap. Loosen cap slowly to relieve pressure in tank.
- Do not overfill fuel tank. Gasoline may expand during operation. Do not fill to the top of the tank. Allow for expansion. Always check for spilled fuel before operating.
- If fuel spills, move the snow blower at least 30 feet away from the spill and wipe clean any spilled fuel before starting the engine.
- Empty fuel tank before storing or transporting the snow blower.

**ONLY** use fresh (within 30 days from purchase), lead-free gasoline with a **minimum of 87 octane rating**. The snow blower performs best with ethanol-free gasoline. **DO NOT** use gasoline with over 10% ethanol.

The capacity of the fuel tank is **0.6 gallons (2.3 L)**. Do not mix oil with gasoline.

### To add gasoline:

1. Place the snow blower on a level surface. Make sure the engine is off before adding or checking the fuel.
2. Unscrew the fuel cap (Fig. 13 - 1) and set it aside. The fuel cap may be tight and hard to unscrew.
3. Slowly add unleaded gasoline to the fuel tank. Be careful not to overfill. Reinstall fuel cap and wipe clean any spilled gasoline with a dry cloth.

**NOTE:** Do not fill the fuel tank to the very top. If you do so, gasoline will expand and spill during use, even with the fuel cap in place.

### To check gas level (before every subsequent start):

1. Before starting the snow blower, check to see if there is sufficient fuel inside the tank.
2. If the tank is empty or low, add gasoline to the gas tank. See above section, "**To add gasoline**".

### IMPORTANT:

- Avoid getting dirt or water into the fuel tank.
- Keep gasoline away from sparks, open flames, pilot lights, heat, and other sources of ignition.
- Gasoline can age in the tank and make starting difficult. Never store the snow blower for more than 2 months with fuel in the tank.
- Never use an oil/gasoline mixture.
- Never use old gasoline.

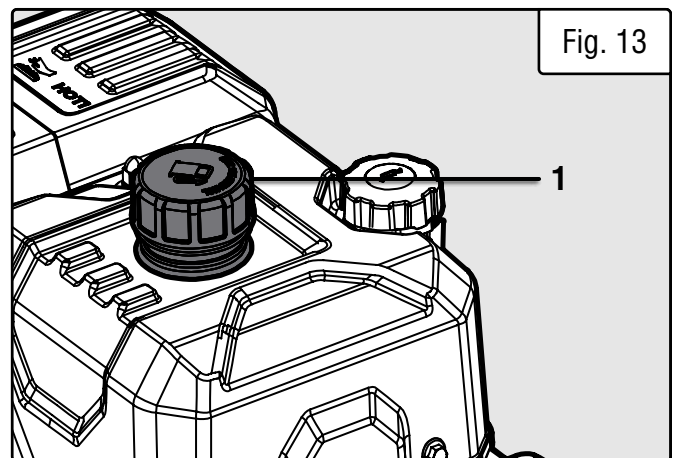

## SNOW BLOWER PREPARATION

### STEP 3 - ADJUST THE CHUTE & DEFLECTOR PLATE

The direction in which snow is ejected is controlled by the chute rotator handle (Fig. 14 - 1). Turn the chute rotator handle to adjust the position of the chute (Fig. 14 - 2).

The angle at which snow is ejected (and therefore how far it is ejected) is controlled by the chute deflector plate (Fig. 15 - 1). Loosen the knob (Fig. 15 - 2) on the side of the deflector plate and adjust the plate's position. Tighten the knob.

### HIGH ALTITUDE OPERATION ABOVE 3000 FEET

The fuel system on this snow blower may be affected by operation at high altitudes. Proper operation can be ensured by installing an altitude kit at altitudes higher than 3000 feet above sea level. At elevations above 8000 feet, the engine may experience a decrease in performance, even with the proper altitude kit. Operating this snow blower without said kit may increase the engine's emissions and decrease both fuel economy and performance.

You can order the kit at [wenproducts.com](http://wenproducts.com) by searching part **SB209E-HA**. This kit should be installed by a qualified mechanic. Refer to the instructions included with your altitude kit for more information about installation.

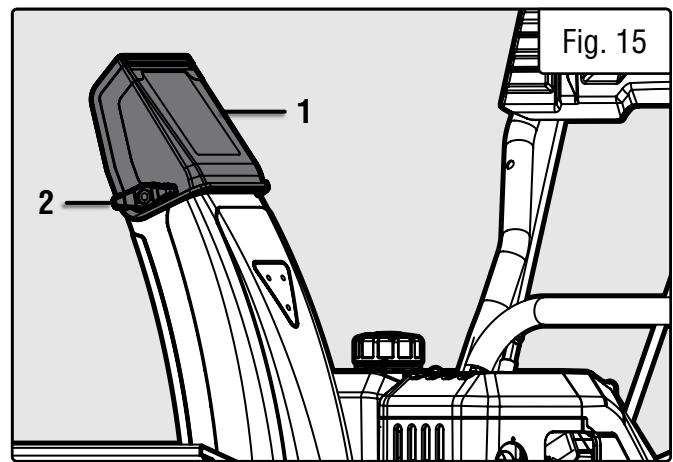
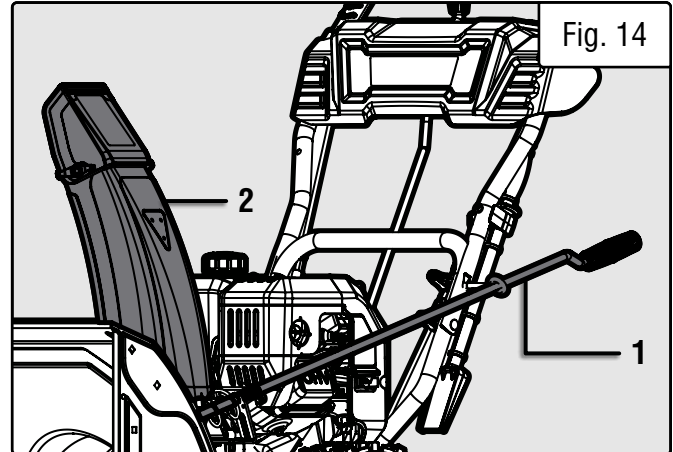

**⚠ WARNING!** To prevent serious injury from fire, follow the kit installation procedures in a well-ventilated area away from ignition sources. If the engine is hot from use, shut the engine off and wait for it to cool before proceeding. Do not smoke near the snow blower. Warranty will be void if adjustments are not made for high altitude use.

**CAUTION!** UNINSTALL the high altitude kit when operating at altitudes below 3000 feet. Engines with the high-altitude kit installed operated at lower altitudes could cause severe engine damage and affect emissions compliance.

**After completing the above preparation, the snow blower is ready to be started.**

## STARTING YOUR SNOW BLOWER

Before starting the snow blower, make sure you have read and performed the steps in the “SNOW BLOWER PREPARATION” section of this manual. If you are unsure about how to perform any of the steps in this manual please call **1-847-429-9263** (M-F 8-5 CST) for customer service.

### **⚠ DANGER: CARBON MONOXIDE**

Using a snow blower indoors **CAN KILL YOU IN MINUTES**. Snow blower exhaust contains carbon monoxide (CO). This is a poison gas you cannot see or smell. If you can smell the snow blower exhaust, you are breathing CO. But even if you cannot smell the exhaust, you could be breathing CO.

**NEVER** use a snow blower inside homes, garages, crawl spaces, or other partially enclosed areas. Deadly levels of carbon monoxide can build up in these areas. Using a fan or opening windows and doors does NOT supply enough fresh air. **ONLY** use a snow blower outside and far away from windows, doors, and vents. These openings can pull in snow blower exhaust.

Even if you use a snow blower correctly, CO may leak into the home. **ALWAYS** use a battery-powered or battery-backup CO alarm in the home. If you start to feel sick, dizzy, or weak after the snow blower has been running, move to fresh air **RIGHT AWAY**. See a doctor. You may have carbon monoxide poisoning.

**⚠ WARNING:** The exhaust from this product contains chemicals known to the State of California to cause cancer, birth defects, or other reproductive harm.

**⚠ WARNING:** Do not operate snow blower near open flame or flammable materials. This snow blower may emit highly flammable and explosive gasoline vapors, which can cause severe burns or even death if ignited. A nearby open flame can lead to explosion even if it isn't directly in contact with gasoline. Do not smoke near the snow blower.

### BEFORE STARTING YOUR SNOW BLOWER

1. Verify that the snow blower is outside on a level surface with at least 2 feet of clearance on all sides.
2. Check that there is a sufficient level of oil in the crankcase. Add oil if necessary, see the “**Step 1 - Add / Check Oil**” section.
3. Check that there is a sufficient level of gasoline in the fuel tank. Add fuel if necessary, see the “**Step 2 - Add / Check Fuel**” section.
4. Check that the chute and deflector plate are pointing in the desired direction. Adjust the chute and deflector if necessary, see the “**Step 3 - Adjust The Chute & Deflector Plate**” section.

### STARTING THE SNOW BLOWER

1. Release the drive lever (Fig. 20 - 2) on the right handle. Put the speed control lever (Fig. 16 - 1) in the low, forward position (F1).
2. Insert the start key (Fig. 17 - 1) into the engine until it clicks into place.

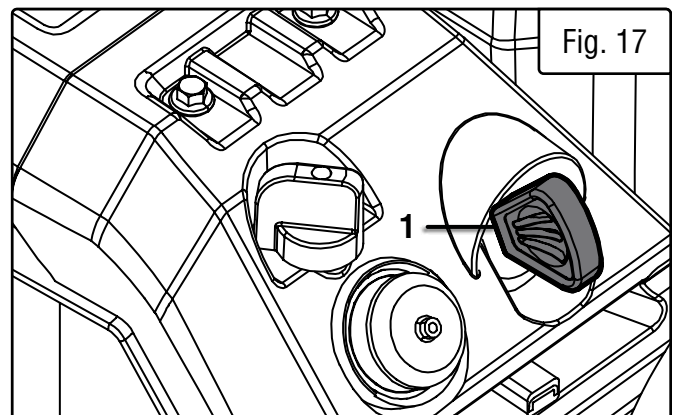
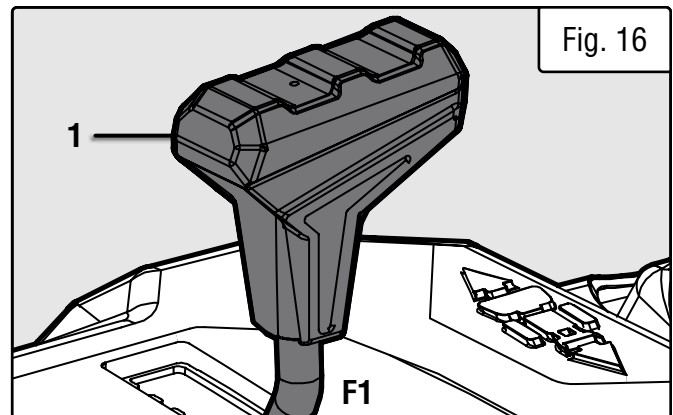

# STARTING YOUR SNOW BLOWER

## STARTING THE SNOW BLOWER (CONT.)

3. Turn the fuel valve (Fig. 18 - 1) to the ON position.
4. Turn the choke knob (Fig. 18 - 2) to the CLOSED/START position.
5. Make sure the throttle (Fig. 18 - 3) is in the FAST (rabbit) position.
6. Push the primer bulb (Fig. 18 - 3) 3 - 5 times. This helps the engine start more easily in lower temperatures.
7. Follow step A for electric start, or B for recoil start.

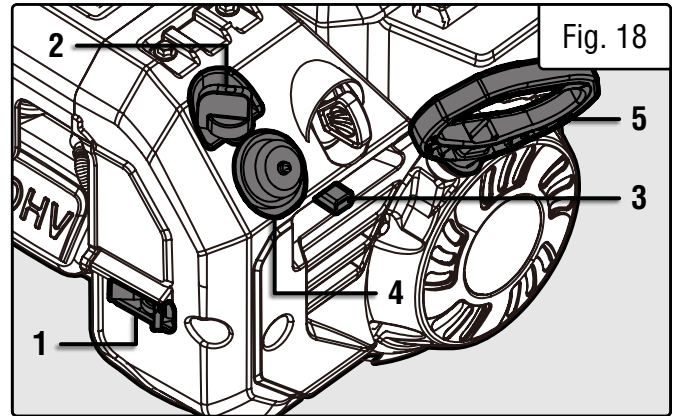

### A. For electric start:

1. Connect an extension cord to the electric start port (Fig. 19 - 1). See the "**Electrical Information**" section for extension cord guidelines.
2. Press and hold the start button (Fig. 19 - 2) on the electric start box for 5 seconds.
3. If the engine does not start, wait 5 - 10 seconds, then try again. Check that the adjustments in steps 1 - 5 have been performed properly.

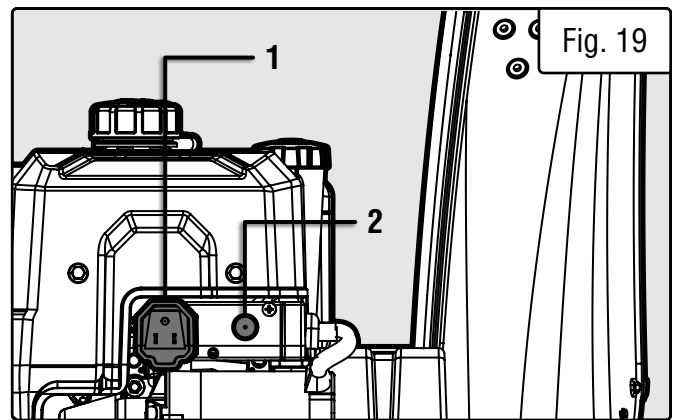

**CAUTION!** Do not try to start the engine more than 10 times. If after 10 times the engine does not start, wait 40 minutes before trying again. If problems persist, consult the troubleshooting guide. If the steps in the guide do not resolve the problem, call customer service at **1-847-429-9263**, M - F, 8 - 5 CST.

4. Once the engine has started, slowly return the choke knob all the way to the OPEN/RUN position.
5. When finished, disconnect the extension cord from the wall receptacle, then from the electric start box.

### B. For recoil start:

1. Pull on the recoil starter handle (Fig. 18 - 5) slowly until a slight resistance is felt, then pull quickly to start the engine. Return cord gently into the recoil starter. Never allow the cord to snap back. If engine fails to start, repeat this step.
2. Once the engine has started, slowly return the choke knob all the way to the OPEN/RUN position.
3. Allow the engine to run for 30 - 60 seconds before beginning to clear snow.

## OPERATION

**⚠ WARNING!** Do not plug in or turn on the tool until it is fully assembled according to the instructions. Read through and become familiarized with the following procedures of handling and adjusting your tool. Failure to follow the safety instructions may result in serious personal injury.

### CONTROLS

1. Squeeze the auger lever (Fig. 20 - 1) to spin the auger and throw snow. To adjust the position of the chute and chute deflector plate, see the "**Step 3 - Adjust The Chute & Deflector Plate**" section.

2. The direction and speed of the snow blower's motion is controlled by the speed control lever (Fig. 21 - 1). There are six speed settings in **forward** and two in **reverse**.

3. Squeeze the drive lever (Fig. 20 - 2) to allow the wheels to spin and move the snow blower.

**CAUTION!** Always disengage the drive lever before changing speeds! Failure to perform this step could lead to clutch or transmission damage and will void the warranty.

### TURNING THE SNOW BLOWER OFF

1. Release the auger and drive levers.
2. Put the speed control lever in the **low, forward** position (F1).
3. Run the auger for 30 - 60 seconds to clear out any remaining snow inside the auger housing or chute, then release the auger lever.
4. Turn the fuel valve (Fig. 18 - 1) to **OFF**. This burns the fuel out of the carburetor and prolongs engine life.

**NOTE:** To shut down the engine immediately, pull the engine key out.

5. Remove the engine key. Store it in a safe place out of the reach of children.

**TIP:** Turn the chute through its full range of motion a couple of times to prevent ice buildup.

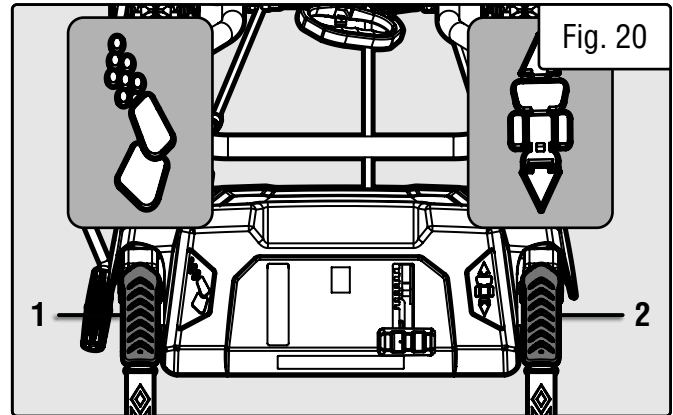

Fig. 20

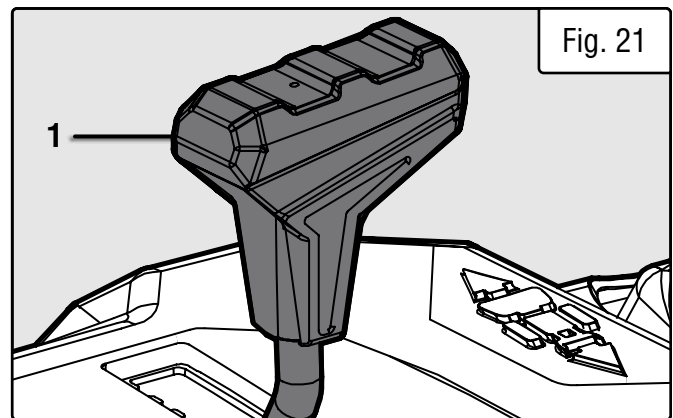



Fig. 21



## OPERATION

 **WARNING!** Do not plug in or turn on the tool until it is fully assembled according to the instructions. Read through and become familiarized with the following procedures of handling and adjusting your tool. Failure to follow the safety instructions may result in serious personal injury.

### TIPS FOR EFFECTIVE SNOW BLOWING

- Always run the engine at full throttle.
- Adjust the drive speed to the situation at hand. Let the machine do the work.
- It is easier and more efficient to remove snow immediately after it falls.
- Throw snow downwind whenever possible.
- Don't use the snow blower early in the morning, if possible. You know how your neighbor Greg is about noise.
- On flat surfaces (such as concrete, asphalt, etc.), adjust the skid plates so that the bottom of the scraper bar runs along the ground.
- On uneven surfaces (such as gravel, crushed rock, etc.) raise the scraper bar slightly above the top of the gravel surface. Ensure that gravel and stones do not enter the auger housing, as they could cause injuries if they are ejected.
- Clear clogs immediately, see "**Clearing Clogs**" below.
- If the auger or drive do not engage when the handle is squeezed, release it immediately and turn the engine OFF.

**NOTE:** The auger blades are mounted to their shaft with shear pins that are designed to break if a foreign object enters the auger housing. This is to prevent machine damage and operator or bystander injury. For information on replacing the shear pins, see the "**Replacing Shear Pins**" section.

### CLEARING CLOGS

A clearing tool is included with your snow blower.

1. Turn the engine OFF and wait for all moving parts (wheels, impeller, auger blades, etc.) to stop moving.
2. Use the clearing tool to clear the clog.
3. Replace the clearing tool in the clasp on the frame.

 **WARNING!** NEVER use your hands to clear a clog! Only use the clearing tool.

4. Run the auger for a few seconds to clear out any remaining snow or ice.

# MAINTENANCE

## RECOMMENDED MAINTENANCE SCHEDULE

Proper routine maintenance of the snow blower will help prolong the life of the machine. Please perform maintenance checks and operations according to the maintenance schedule below, Table 1. If there are any questions about the maintenance procedures listed in this manual, please contact customer service at **1-847-429-9263** (M-F 8-5 CST), or email [techsupport@wenproducts.com](mailto:techsupport@wenproducts.com).

**⚠ WARNING!** Make sure the engine is OFF, the key is removed, all moving parts have stopped, and the snow blower has cooled down before performing any maintenance. Failure to comply may cause serious injury.

Recommended Maintenance Schedule (Snow Blower)		Every 8 Hours or Daily	Every 25 Hours	Every 3 Months or 50 Hours	Every 6 Months or 100 Hours	Before Storage	As Necessary
Tires	Inspect	X					
Impeller & Auger	Inspect	X					
	Clear						X
Shear Pins	Replace						X
Scraper Bar	Replace						X
Skid Plates	Replace						X
Drive & Auger Cables	Inspect	X					
	Adjust Tension						X
Body	Clear Snow/Ice	X				X	
Drive Belts	Inspect		X				
	Replace				X		
Auger Gears	Lubricate			X			
Friction Disc	Replace				X		
Recommended Maintenance Schedule (Engine)		Every 8 Hours or Daily	Every 25 Hours	Every 3 Months or 50 Hours	Every 6 Months or 100 Hours	Before Storage	As Necessary
Engine Oil	Check Level	X					
	Replace		X*				X
Spark Plug	Check/Clean/Regap				X		
Carburetor	Drain	X					X
Fuel	Check Level	X					
	Drain					X	X

\* Clean/change more often under harsh conditions or operating under heavy load.

Table 1 - Recommended Maintenance Schedule

### IMPORTANT SNOW BLOWER MAINTENANCE TIPS:

- Drain your carburetor after each use and before storage to prevent it from clogging.
- Do not store the snow blower with fuel inside the tank for more than 2 months - the fuel will go bad.
- Run the snow blower for 20 to 30 minutes every month to maximize its lifespan.

**NOTE:** Failure to properly maintain the snow blower will void the warranty.

# MAINTENANCE

**⚠ WARNING!** Any attempt to repair or replace electrical parts on this tool may be hazardous. Servicing of the tool must be performed by a qualified technician. When servicing, use only identical WEN replacement parts. Use of other parts may be hazardous or induce product failure.

## TIRE MAINTENANCE

Inspect the tires after each use for wear and tear. Keep the tires away from gasoline, oil, and other chemicals to prevent degradation of the rubber. Avoid running over stumps, stones, ruts, glass, knives, sea urchins, porcupines, and other sharp objects that could damage the tires.

## IMPELLER & AUGER MAINTENANCE

Check the impeller and auger for snow, ice, and debris before and after use. Remove any snow, ice or debris before storing the snow blower, or starting it.

**CAUTION!** NEVER use an open flame (such as a lighter, blowtorch, or flamethrower) to melt snow or ice. Bring the snow blower to a heated area and let the snow or ice melt on its own, or use a hair dryer or heat gun.

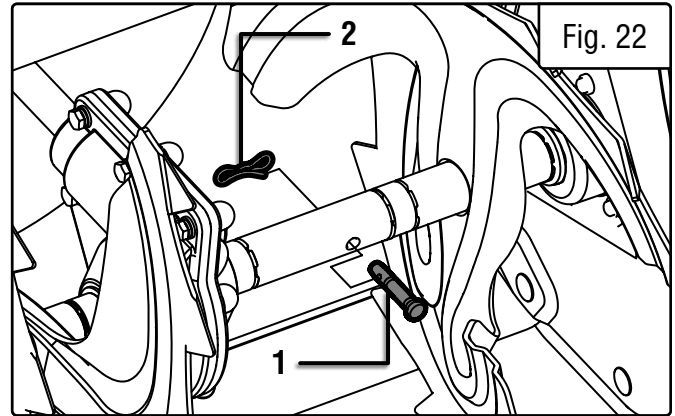

## REPLACING SHEAR PINS

If a shear pin fails, it has done its job in protecting the product from damage. Replacement shear pins and bowtie clips can be ordered from [wenproducts.com](http://wenproducts.com) (Part **SB209E-1620** and **SB209E-1626**). Shear pins and bowtie clips are not covered under the warranty.

To replace the shear pins, stop the engine and wait for the auger blades to come to a complete stop. Install a new shear pin (Fig. 22 - 1) and bowtie clip (Fig. 22 - 2). Your snow blower comes with two spare shear pins and two spare bowtie clips.

## SCRAPER BAR MAINTENANCE

Check the scraper bar for excess wear - if it has begun to exhibit signs of severe wear, it is time to replace it. Replacement scraper bars can be ordered from [wenproducts.com](http://wenproducts.com) (Part **SB209E-1616**). Scraper bars are a wear-out part and are not covered under the warranty.

To replace the scraper bar, remove the four nuts and bolts that secure the scraper bar to the auger housing. Install the new scraper bar and replace the nuts and bolts. Securely tighten the nuts.

## SNOW BLOWER BODY MAINTENANCE

Keep the body of the snow blower clean to prevent improper operation or machine damage from dirt & debris. Inspect all ventilation openings on the snow blower. These must be kept clean and unobstructed. Wipe down the snow blower's housing with a damp cloth and mild detergent. Dry it with a towel.

## SKID PLATE MAINTENANCE

Check the skid plates for excess wear - if they have begun to exhibit signs of severe wear, it is time to replace them. Replacement skid plates can be ordered from [wenproducts.com](http://wenproducts.com) (Part **SB209E-1614**). Skid plates are a wear-out part and are not covered under the warranty.

To replace a skid plate, remove the nuts and bolts that secure the skid plate to the auger housing. Install the new skid plate and replace the nuts and bolts. Securely tighten the nuts.

**NOTE:** Do not clean the snow blower with water alone – it will freeze in low temperatures and cause machine damage. Do not get soap or water inside of your snow blower.

## CHECKING & CHANGING OIL

Check the oil according to the Recommended Maintenance Schedule chart. The oil capacity of the engine is **16.9 fl. oz (0.5 L)**. Add oil when the oil level is low. This is a critical step for proper engine starting. To check the oil level and/or add oil, see "**Step 1 - Add/Check Oil**".

### To change the oil:

1. Run the engine for a few minutes to warm the oil up. Warm oil flows more easily.
2. Remove the wheel pin and the wheel and set them aside.
3. Prepare an approved oil-storage container underneath the oil drain bolt (Fig. 23).

**NOTE:** To avoid spills from the carburetor bowl, drain the carburetor before draining the oil.

4. Unscrew the oil drain bolt and allow oil to drain from the engine completely.
5. Reinstall the oil drain bolt and tighten it securely. Wipe clean any oil spillage.
6. To add new oil, see "Step 1 - Add/Check Oil".

**NOTE:** Never dispose of used engine oil in the trash or down a drain. Please call a local recycling center or auto garage to arrange proper oil disposal.

**CAUTION!** Never run the engine with low oil, or with no oil. Doing so will permanently damage the engine and void the warranty.

**CAUTION!** Let the muffler cool down completely before performing spark plug maintenance.

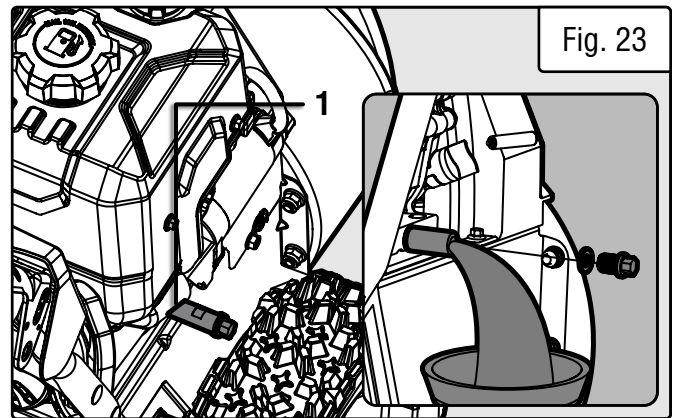

## DRAINING THE CARBURETOR

Drain the carburetor after every use and before storing the snow blower (refer to the Recommended Maintenance Schedule on page 28). Draining the carburetor can help prevent build-up and blockages caused by stagnant fuel inside of the carburetor.

1. Prepare an approved gasoline-storage container under the carburetor to collect the drained fuel. Make sure the fuel valve is turned OFF.
2. The carburetor can be accessed from the left side of the snow blower, next to the cylinder head cover. To drain the carburetor, open up the carburetor drain screw with a Phillips-head screwdriver and drain out any gasoline that has built up inside.
3. Once the fuel has drained, close the drain screw.

**NOTE:** Make sure to drain your carburetor before storing the snow blower for long periods of time.

## SPARK PLUG MAINTENANCE

Inspect and change the spark plug every 100 hours of operation (refer to the Recommended Maintenance Schedule chart). The spark plug is important for proper engine operation. Check the spark plug regularly to maintain proper engine operation. A good spark plug should be intact, free of deposits, and properly gapped.

1. Gently pull on the spark plug boot (Fig. 24 - 1) to remove it. Be careful not to tear insulation or wire.

2. Use a spark plug wrench or socket (not included) to unscrew the spark plug from the engine. Remove the spark plug from the engine.

3. Visually inspect the spark plug. If it is cracked or chipped, or if the electrodes are worn or burned, discard it and replace with a new spark plug. We recommend replacing it with a Torch F6TC (NGK BP6ES) spark plug. These can be purchased from [wenproducts.com](http://wenproducts.com) by searching part number **56310i-0104**.

4. If re-using the spark plug, use a wire brush to clean any dirt from around the spark plug base, then re-gap the spark plug.

5. Measure the plug gap with a spark plug gap gauge. The gap should be 0.7mm - 0.8mm (0.028 in. - 0.031 in.). Carefully adjust the gap if necessary (Fig. 25).

6. Screw the spark plug back into the spark plug hole using the spark plug wrench. Do not over-tighten spark plug. Recommended tightening of the spark plug is  $\frac{1}{2}$  to  $\frac{3}{4}$  of a turn after the spark plug gasket contacts the spark plug hole, or 14.75 - 19.18 ft-lb (20 - 26 Nm).

7. Reinstall the spark plug boot over the spark plug.

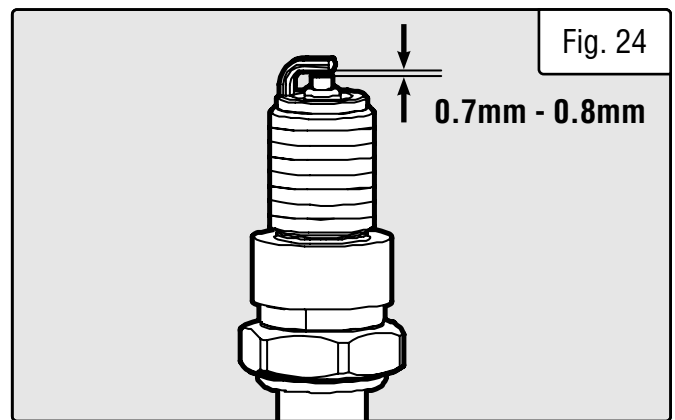
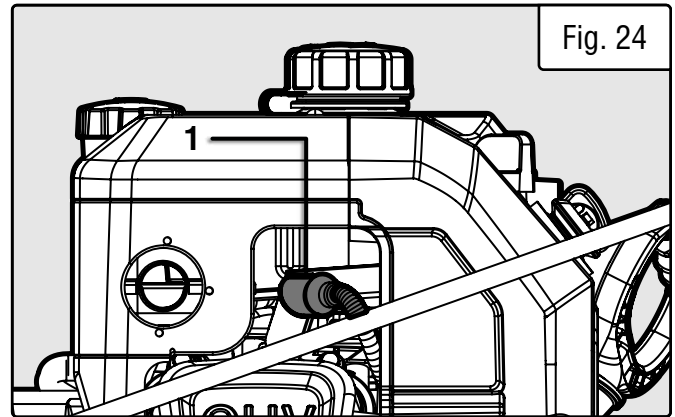

## DRAINING THE FUEL TANK

Drain and clean the fuel tank each year, or before storing the snow blower for longer than two months.

1. Prepare an approved gasoline-storage container under the carburetor. Make sure the fuel valve is turned OFF.

2. Remove the carburetor drain screw. Set it aside.

3. Turn the fuel valve to ON and let the fuel tank drain completely. This may take a while, depending on how much gasoline remains in the tank.

4. Once the fuel has drained, replace the drain screw and turn the fuel valve OFF.

5. Start and run the engine until the fuel runs out. Then, drain the carburetor.

**CAUTION!** Store the emptied gasoline in a suitable place. Never store fuel for more than 2 months.

# MAINTENANCE

## STORAGE

 **WARNING!** Avoid direct sunlight inside a vehicle. If the snow blower is left in an enclosed vehicle for many hours, the high temperature could cause the fuel to vaporize and result in a possible explosion.

Shut off the snow blower and allow the unit to cool to room temperature before storing it. NEVER place any type of storage cover on the snow blower while it is still hot. Do not obstruct any ventilation openings.

Follow the procedures below for properly storing your snow blower. We highly recommend running your snow blower once a month for 20 to 30 minutes, to ensure it is ready when you need it.

### For Short Periods (30 to 60 Days):

- Drain the carburetor. Refer to "Draining The Carburetor".
- **Add fuel stabilizer:** Follow the suggested portions and instructions of your preferred stabilizer. Run the engine for 15 to 20 minutes, allowing the fuel stabilizer to mix with the gasoline and circulate through the carburetor, and then top off with fuel. Filling the fuel tank full reduces the amount of air in the tank and helps fight deterioration of fuel.

### For Extended Periods (Over 60 Days):

- Drain the fuel tank and carburetor. Refer to "Draining The Fuel Tank" and "Draining The Carburetor".
- Never store snow blower with fuel in the tank for more than two months.
- Change the engine oil. Refer to "Checking & Changing Oil".

 **WARNING!** Store the snow blower upright in a cool and dry location, away from sources of heat, open flames, sparks or pilot lights.

## PRODUCT DISPOSAL

Do not dispose of used snow blower or parts with your household waste. This product contains electrical or electronic components that should be recycled. Please take this product to your local recycling facility for responsible disposal to minimize its environmental impact.

Do not dispose of used oil or fuel in the trash or down a drain. Please contact your local recycling center or auto garage to arrange proper oil/fuel disposal.



**Please recycle the packaging and electronic components where facilities exist.**

## **TROUBLESHOOTING GUIDE**

**⚠ WARNING!** Stop using the tool immediately if any of the following problems occur. Repairs and replacements should only be performed by an authorized technician. For any questions, please contact our customer service at **1-847-429-9263**, M-F 8-5 CST or email us at **techsupport@wenproducts.com**.

<b>PROBLEM</b>	<b>POSSIBLE CAUSE</b>	<b>SOLUTION</b>
<b>Engine idles roughly or runs roughly.</b>	1. Choke improperly adjusted.	1. Adjust choke.
	2. Fuel line blocked.	2. Clean fuel line.
	3. Engine is filled with contaminated or old fuel.	3. Drain fuel tank and carburetor. Replace with fresh gasoline (87 octane, 10% ethanol maximum).
	4. Bad carburetor.	4. Contact customer service at 1-847-429-9263 M-F 8-5 CST for assistance.
<b>Excessive vibration.</b>	1. Loose/damaged augers or loose part.	1. Tighten all fasteners. Check that auger shear pins are intact. Replace shear pins if needed.
	2. Engine adjustment problem.	2. Contact customer service at 1-847-429-9263 M-F 8-5 CST for assistance.
<b>Loss of drive traction, or slowing of drive speed.</b>	1. Wheel V-belt is worn, is slipping, or is off the pulley.	1. Check V-belt. Contact customer service at 1-847-429-9263 M-F 8-5 CST for assistance.
	2. Worn friction disc.	3. Contact customer service at 1-847-429-9263 M-F 8-5 CST for assistance.
<b>Loss of snow discharge, or slowing of snow discharge.</b>	1. Chute deflector or chute is clogged.	1. Shut off engine and clear clog.
	2. Auger is blocked.	2. Shut off engine and clear blockage.
	3. Broken shear pin.	3. Replace shear pin.
	4. Worn friction disc.	4. Contact customer service at 1-847-429-9263 M-F 8-5 CST for assistance.
<b>Chute difficult to move.</b>	1. Snow or ice is blocking chute rotation.	1. Clear snow or ice.
	2. Mounting nuts too tight.	2. Loosen mounting nuts.
<b>Product turns to one side or leans to one side.</b>	1. Uneven wheel wear.	1. Check both wheels; replace if needed.
	2. Wheel lock pin disengaged from wheel axle on one side.	2. Ensure both wheel lock pins go through the wheels and the wheel axle.
	3. Uneven skid plate adjustment.	3. Adjust skid plates height.

**Troubleshooting guide continues on the next page.**

## ***TROUBLESHOOTING GUIDE***

<b>PROBLEM</b>	<b>POSSIBLE CAUSE</b>	<b>SOLUTION</b>
<b>Engine will not start.</b>	1. Engine key not inserted.	1. Insert engine key fully.
	2. Not enough gasoline in tank.	2. Fill tank.
	3. Fuel valve is OFF.	3. Turn fuel valve to ON.
	4. Choke is set to OPEN / RUN (cold engine).	4. Set choke to CLOSED / START.
	5. Choke is set to CLOSED / START (warm engine).	5. Set choke to OPEN / RUN.
	6. Primer bulb was not pushed.	6. Push primer bulb.
	7. Engine is flooded.	7. Wait 5 minutes. DO NOT prime engine. Restart engine with choke in CLOSED / START position.
	8. Engine is filled with contaminated or old fuel.	8. Drain fuel tank and carburetor. Replace with fresh gasoline (87 octane, 10% ethanol maximum).
	9. Carburetor is air-locked.	9. Turn fuel valve to OFF. Remove bolt from bottom of carburetor. Remove carburetor bowl and allow float to reset. Replace bowl and re-install bolt.
	10. Spark plug boot disconnected.	10. Connect spark plug boot to spark plug.
	11. Spark plug dirty or broken.	11. Examine spark plug. Clean or replace as needed.
	12. Electric start: power cord not connected.	12. Connect power cord.
	13. Electric start: no line voltage.	13. Check line voltage at power source.
	14. Electric start: power cord gauge too low or power cord too long.	14. Refer to chart on p. 9 for recommended power cord length and gauge.
	15. Faulty ignition coil.	15. Contact customer service at 1-847-429-9263 M-F 8-5 CST for assistance.
	16. Electric start: faulty starter motor or control box.	16. Contact customer service at 1-847-429-9263 M-F 8-5 CST for assistance.
<b>Decreased power.</b>	1. Too much snow being blown.	1. Decrease forward speed. Blow a narrower path through the snow.
	2. Fuel tank cap covered in snow or ice.	2. Clean fuel tank cap.
	3. Muffler dirty or clogged.	3. Shut off engine and wait for it to cool down. Clean muffler.
	4. Improper cable length.	4. Adjust cable length or replace cable.
	5. Carburetor air intake is blocked.	5. Check and clear carburetor.



## EXPLODED VIEW & PARTS LIST

**NOTE:** Not all parts may be available for purchase. Parts and accessories that wear down over the course of normal use are not covered under the warranty.

**FIG. 1. CRANKCASE & GOVERNOR GEAR ASSEMBLY**

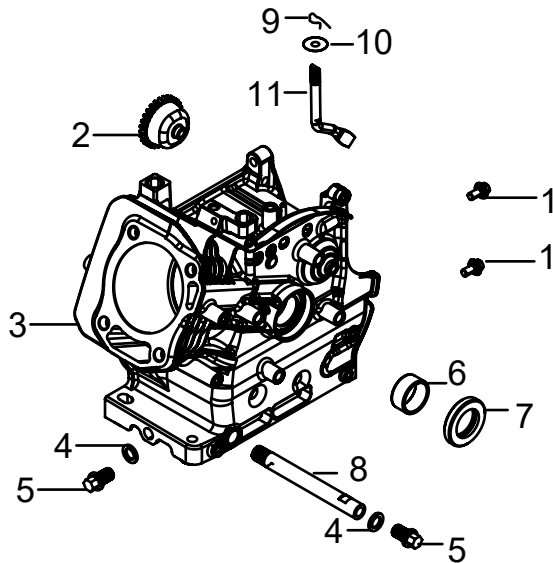

**FIG. 2. CRANKCASE COVER**

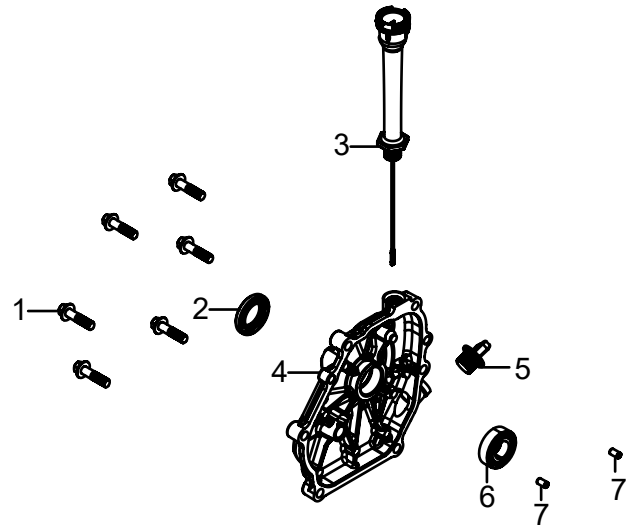

No.	Part No.	Description	Qty.
1-1	SB209E-0101	Bolt, M6x25	2
1-2	SB209E-0102	Governor Gear Assembly	1
1-3	SB209E-0103	Crankcase	1
1-4	56380i-0102	Flat Washer	3
1-5	SB209E-0105	Drain Plug Bolt, M10x15	3
1-6	SB209E-0106	Bushing	1
1-7	SB209E-0107	Oil Seal	1
1-8	SB209E-0108	Oil Drain Tube	1
1-9	SB209E-0109	Cotter Pin	1
1-10	SB209E-0110	Flat Washer	1
1-11	SB209E-0111	Governor Arm	1

No.	Part No.	Description	Qty.
2-1	SB209E-0201	Bolt, M8x32	6
2-2	SB209E-0202	Oil Seal	1
2-3	SB209E-0203	Oil Dipstick Assembly	1
2-4	SB209E-0204	Crankcase Cover	1
2-5	SB209E-0205	Engine Oil Plug	1
2-6	56380i-0203	Bearing, 6205	1
2-7	56200-0803	Pin	2

## EXPLODED VIEW & PARTS LIST

### FIG. 3. CYLINDER HEAD COVER, SPARK PLUG

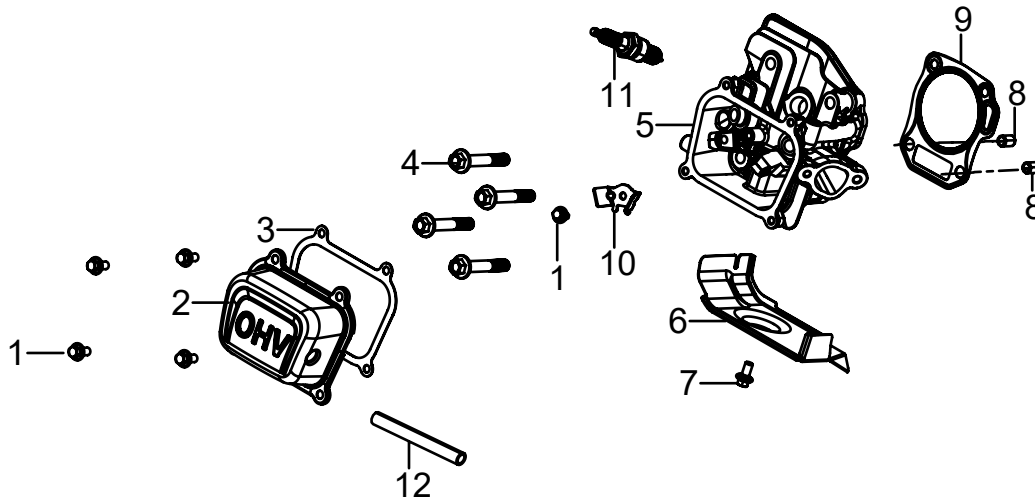

No.	Part No.	Description	Qty.	No.	Part No.	Description	Qty.
3-1	SB209E-0301	Bolt, M6x12	5	3-7	SB209E-0307	Bolt, M6x10	1
3-2	SB209E-0302	Cylinder Head Cover	1	3-8	SB209E-0308	Positioning Pin, Type A	2
3-3	SB209E-0303	Cylinder Head Cover Gasket	1	3-9	SB209E-0309	Cylinder Head Gasket	1
3-4	SB209E-0304	Cylinder Head Bolt, M8x60	4	3-10	56380i-0312	Cylinder Head Cover Pin Limiting Plate	1
3-5	SB209E-0305	Cylinder Head Assembly	1	3-11	56310i-0104	Spark Plug, Torch F6TC (NGK BP6ES)	1
3-6	SB209E-0306	Cylinder Shroud	1	3-12	SB209E-0312	Breather Tube	1

### FIG. 4. CRANKSHAFT

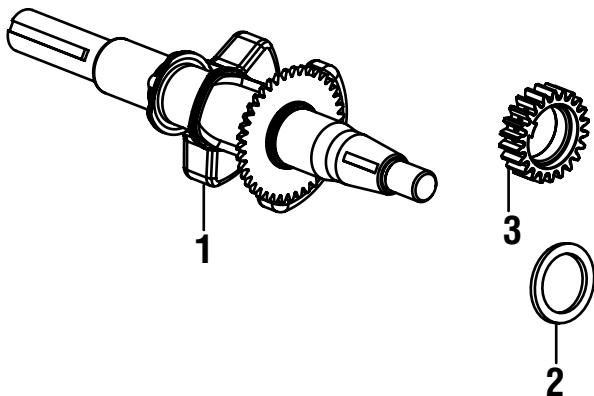

No.	Part No.	Description	Qty.
4-1	SB209E-0401	Crankshat Assembly	1
4-2	SB209E-0402	Flat Washer	1
4-3	SB209E-0403	Timing Drive Gear	1

## EXPLODED VIEW & PARTS LIST

**FIG. 5. PISTON RING SET,  
CONNECTING ROD**

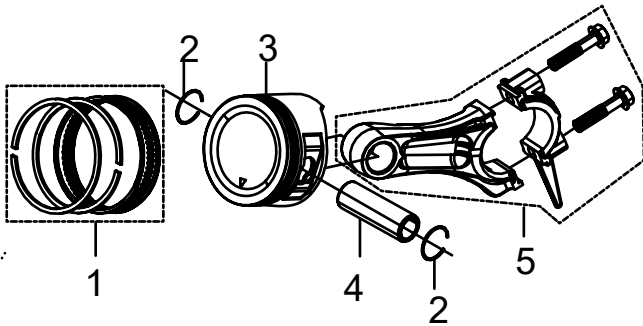

No.	Part No.	Description	Qty.
5-1	SB209E-0501	Piston Ring Set	1
5-2	SB209E-0502	Piston Pin Clip	2
5-3	SB209E-0503	Piston	1
5-4	SB209E-0504	Piston Pin	1
5-5	SB209E-0505	Connecting Rod	1

**FIG. 7. RECOIL STARTER**

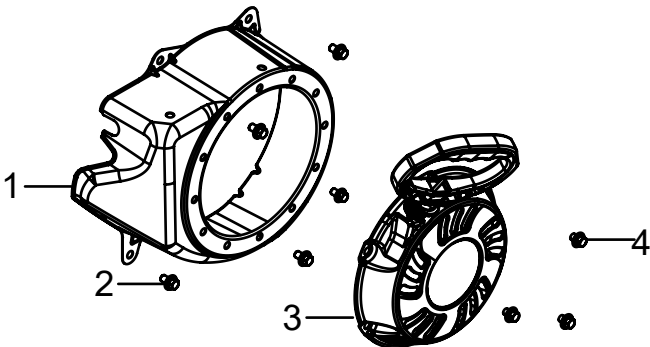

No.	Part No.	Description	Qty.
7-1	SB209E-0701	Shroud	1
7-2	SB209E-0702	Bolt, M6x12	4
7-3	SB209E-0703	Recoil Starter Assembly	1
7-4	SB209E-0704	Bolt, M6x8	3

**FIG. 6. VALVE TRAIN, CAMSHAFT**

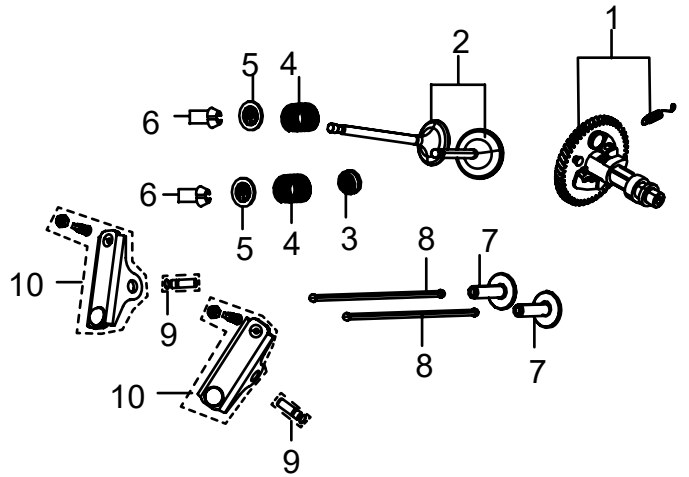

No.	Part No.	Description	Qty.
6-1	SB209E-0601	Camshaft Assembly	1
6-2	SB209E-0602	Valve Set	1
6-3	56310i-0603	Seal Guide	1
6-4	56310i-0604	Valve Spring	2
6-5	SB209E-0605	Valve Spring Seat	2
6-6	56310i-0606	Valve Locking Clamp	4
6-7	SB209E-0607	Valve Tappet	2
6-8	SB209E-0608	Valve Lifter	2
6-9	56380i-0610	Rocker Shaft Subassembly	2
6-10	56380i-0609	Valve Rocker Subassembly	2

# EXPLODED VIEW & PARTS LIST

**FIG. 8. FLYWHEEL, IGNITION COIL**

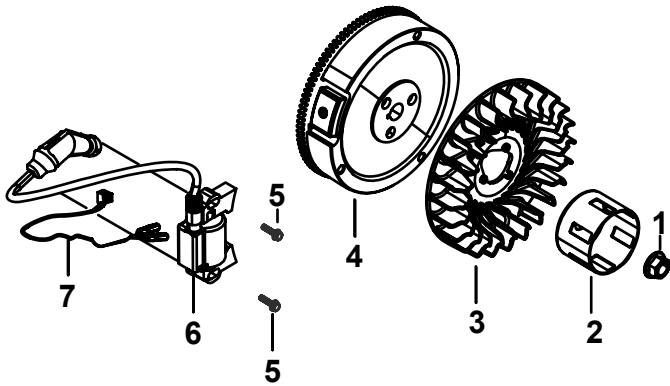

No.	Part No.	Description	Qty.
8-1	56310i-1101	Flywheel Nut, M14-1.5	1
8-2	SB209E-0802	Starter Pulley	1
8-3	SB209E-0803	Impeller	1
8-4	SB209E-0804	Flywheel	1
8-5	SB209E-0805	Bolt, M6x25	2
8-7	SB209E-0806	Ignition Coil	1
8-8	SB209E-0807	Ignition Coil Grounding Wire	1

**FIG. 9. CARBURETOR**

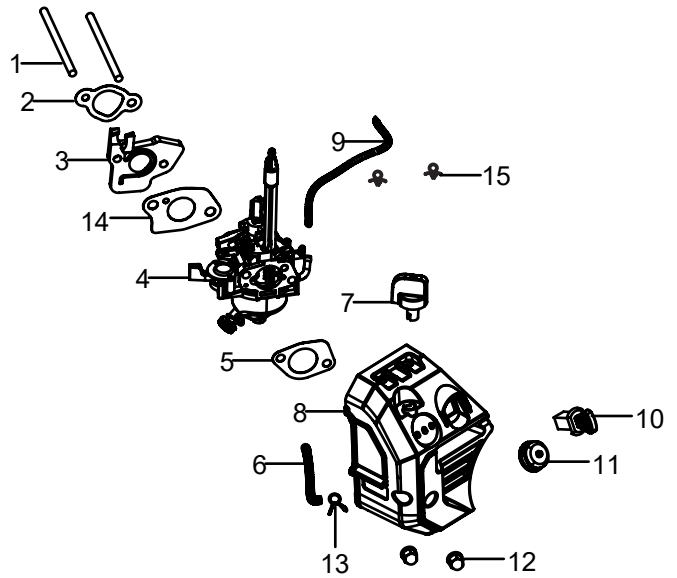

No.	Part No.	Description	Qty.
9-1	SB209E-0901	Stud Bolt, M6x96	2
9-2	56380i-0801	Carburetor Insulator Gasket	1
9-3	SB209E-0903	Carburetor Insulator	1
9-4	SB209E-0904	Carburetor	1
9-5	GN400i-1101	Air Filter Gasket	1
9-6	SB209E-0906	Primer Tube	1
9-7	SB209E-0907	Knob	1
9-8	SB209E-0908	Air Filter	1
9-9	SB209E-0909	Fuel Tube	1
9-10	SB209E-0910	Engine Key	1
9-11	SB209E-0911	Primer Button	1
9-12	SB209E-0912	Nut, M6	2
9-13	SB209E-0913	Hose Clamp	1
9-14	56380i-0803	Carburetor Gasket	1
9-15	SB209E-0915	Hose Clamp	2
N.P.	SB209E-HA36	High-Altitude Kit, 3000 - 6000 ft	N/A
N.P.	SB209E-HA68	High-Altitude Kit, 6000 - 8000 ft	N/A

# EXPLODED VIEW & PARTS LIST

**FIG. 10. THROTTLE ASSEMBLY**

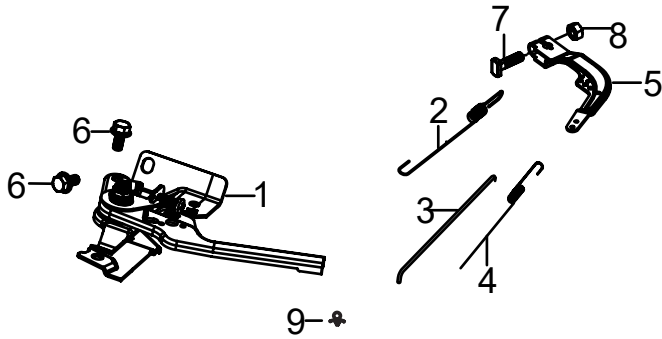

No.	Part No.	Description	Qty.
10-1	SB209E-1001	Throttle Control Assembly	1
10-2	SB209E-1002	Throttle Spring	1
10-3	SB209E-1003	Governor Rod	1
10-4	SB209E-1004	Governor Spring	1
10-5	SB209E-1005	Governor Bracket	1
10-6	SB209E-1006	Bolt M6x10	2
10-7	SB209E-1007	Governor Support Bolt, M6	1
10-8	SB209E-1008	Nut, M6	1
10-9	SB209E-1009	Hose Clamp	2

**FIG. 11. STARTER MOTOR**

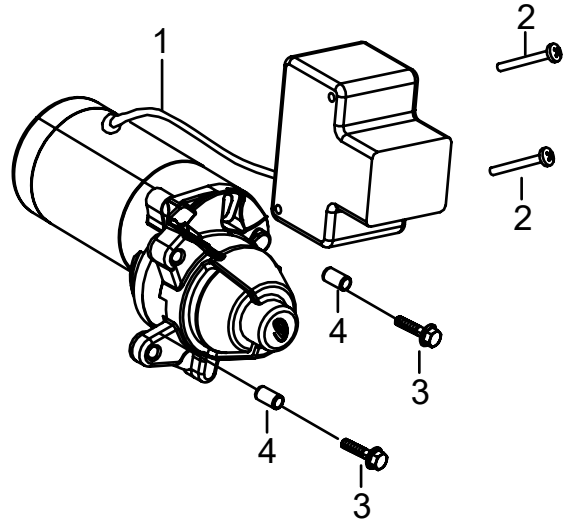

No.	Part No.	Description	Qty.
11-1	SB209E-1101	Starter Motor Assembly	1
11-2	SB209E-1102	Screw, M4x50	2
11-3	SB209E-1103	Bolt, M6x32	2
11-4	SB209E-1104	Positioning Pin	2

**FIG. 12 MUFFLER ASSEMBLY**

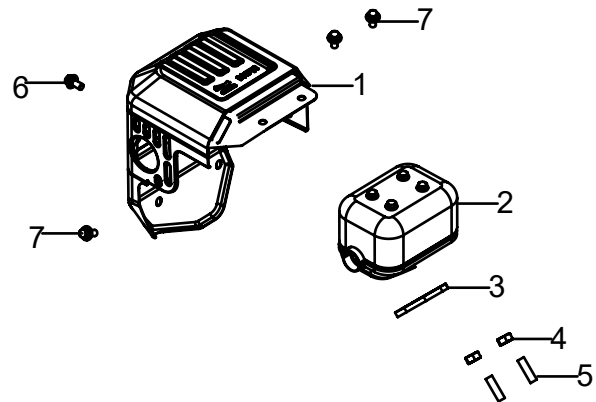

No.	Part No.	Description	Qty.
12-1	SB209E-1201	Muffler Cover	1
12-2	SB209E-1202	Muffler Assembly	1
12-3	56380i-1106	Gasket, Exhaust Outlet	1
12-4	SB209E-1204	Nut M8	2
12-5	SB209E-1205	Stud Bolt (BM=1.5D) M8x34	2
12-6	SB209E-1206	Bolt M6x20	1
12-7	SB209E-1207	Bolt M6x12	3

# EXPLODED VIEW & PARTS LIST

**FIG. 13. FUEL TANK ASSEMBLY**

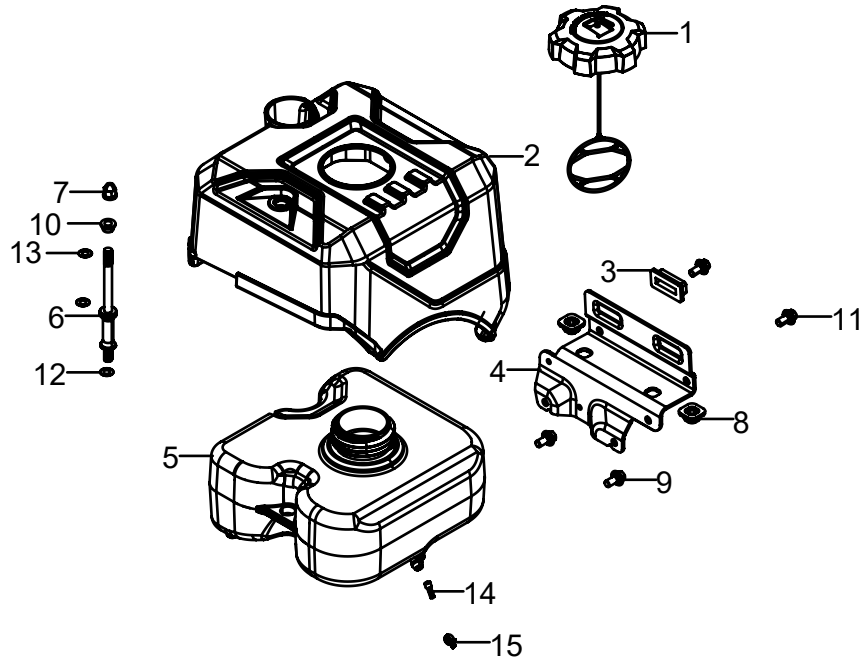

No.	Part No.	Description	Qty.	No.	Part No.	Description	Qty.
13-1	SB209E-1301	Fuel Tank Cap	1	13-9	SB209E-1309	Bolt, M8x16	2
13-2	SB209E-1302	Fuel Tank Cover	1	13-10	SB209E-1310	Bushing	1
13-3	SB209E-1303	Fuel Tank Gasket	2	13-11	SB209E-1311	Bolt, M6x12	2
13-4	SB209E-1304	Fuel Tank Frame	1	13-12	SB209E-1312	Washer	1
13-5	SB209E-1305	Fuel Tank	1	13-13	SB209E-1313	Washer	2
13-6	SB209E-1306	Support Bolt, M6x14	1	13-14	SB209E-1314	Fuel Tank Filter	1
13-7	SB209E-1307	Cap Nut, M6	1	13-15	SB209E-1315	Clamp	1
13-8	SB209E-1308	Bracket Gasket	2				

# EXPLODED VIEW & PARTS LIST

**FIG. 14. DRIVE HOUSING ASSEMBLY**

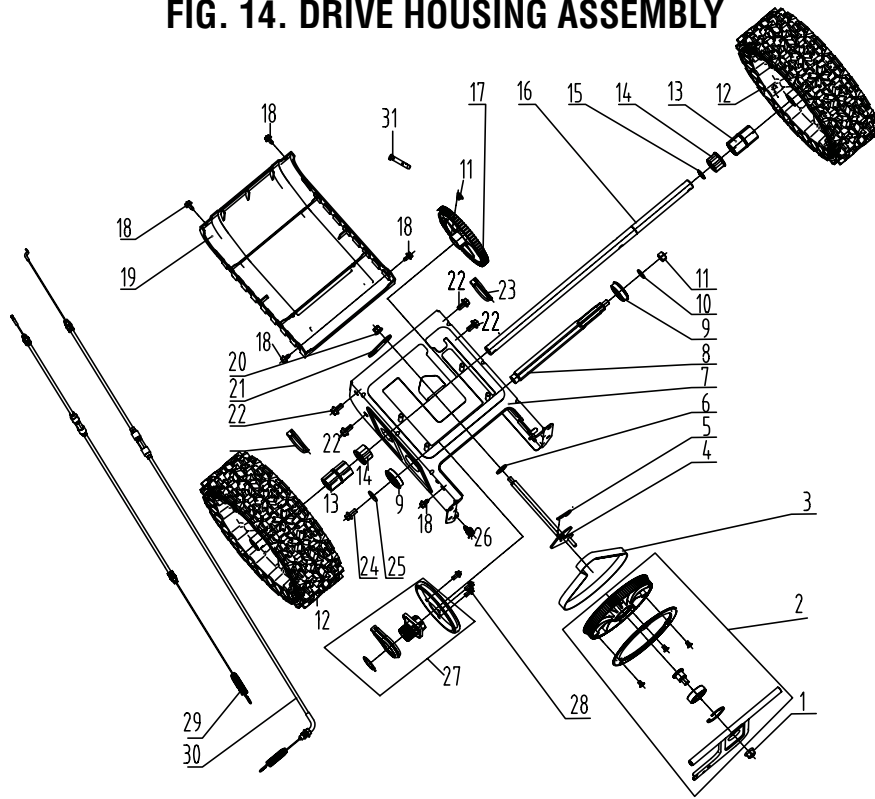

No.	Part No.	Description	Qty.	No.	Part No.	Description	Qty.
14-1	SB209E-1401	Nut, M10	1	14-17	SB209E-1417	Driven Gear	1
14-2	SB209E-1402	Pulley Assembly	1	14-18	SB209E-1418	Locking Screw, M6x12	5
14-3	SB209E-1403	Drive Belt, HTD-740-5M-15	1	14-19	SB209E-1419	Rear Cover	1
14-4	SB209E-1404	Shifting Fork	1	14-20	SB209E-1420	Nut, M8	1
14-5	SB209E-1405	Pin	2	14-21	SB209E-1421	Connecting Plate	1
14-6	SB209E-1406	Washer	1	14-22	SB209E-1422	Locking Screw, M8x16	4
14-7	SB209E-1407	Housing	1	14-23	SB209E-1423	Pin	2
14-8	SB209E-1408	Drive Housing	1	14-24	SB209E-1424	Bolt, M8x16	1
14-9	SB209E-1409	Ball Bearing, 6203 NR-2RS	2	14-25	SB209E-1425	Washer	1
14-10	SB209E-1410	Washer	1	14-26	SB209E-1426	Tension Spring	1
14-11	SB209E-1411	Nut, M10	1	14-27	SB209E-1427	Friction Disc Assembly	1
14-12	SB209E-1412	Wheel	2	14-28	SB209E-1428	Bolt M6x12	3
14-13	SB209E-1413	Wheel Bushing	2	14-29	SB209E-1429	Clutch Cable, Self Propulsion	1
14-14	SB209E-1414	Wheel Axle Bushing	2	14-30	SB209E-1430	Clutch Cable, Auger	1
14-15	SB209E-1415	Circlip	1	14-31	SB209E-1431	Pin Shaft	1
14-16	SB209E-1416	Axle	1				

# EXPLODED VIEW & PARTS LIST

FIG. 15. ENGINE, BELT PULLEY ASSEMBLY

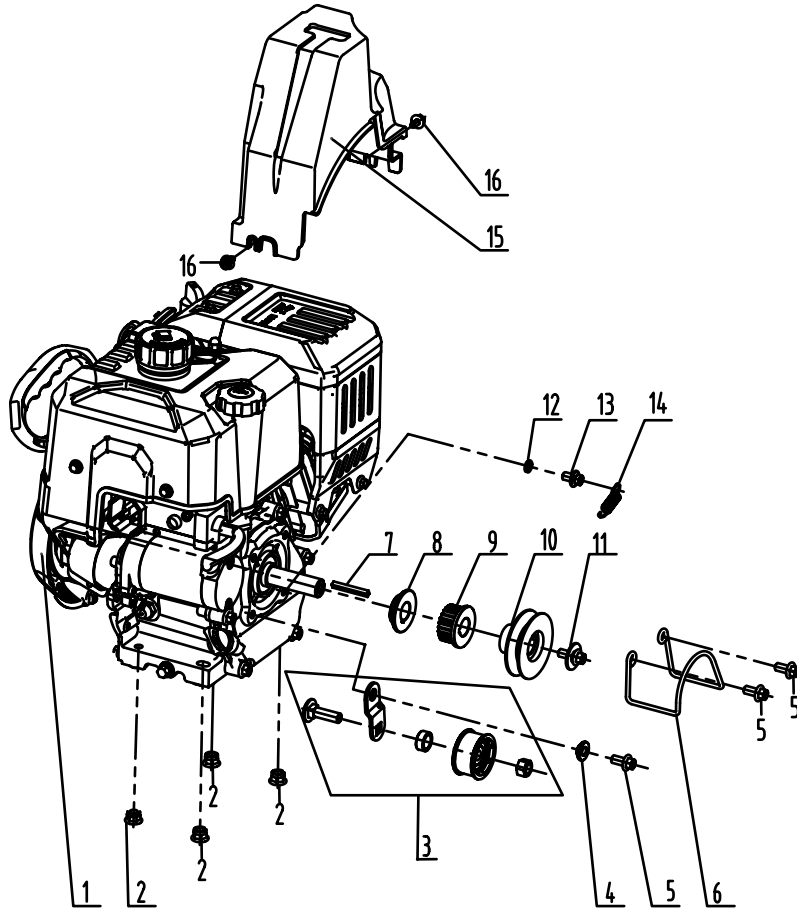

No.	Part No.	Description	Qty.	No.	Part No.	Description	Qty.
15-1	SB209E-1501ASM	Engine Assembly	1	15-9	SB209E-1509	Driving Timing Pulley	1
15-2	SB209E-1502	Nut, M8	4	15-10	SB209E-1510	Driving Auger Pulley	1
15-3	SB209E-1503	Tensioner Pulley Assembly	1	15-11	SB209E-1511	Bolt and Washer Assembly, M8x20	1
15-4	SB209E-1504	Gasket	1	15-12	SB209E-1512	Spring Washer, 8mm	1
15-5	SB209E-1505	Bolt, M8x16	3	15-13	SB209E-1513	Bolt, M8x12	1
15-6	SB209E-1506	Drive Belt Guard	1	15-14	SB209E-1514	Tension Spring	1
15-7	SB209E-1507	Flat Key, 48x4.78x4.78	1	15-15	SB209E-1515	Belt Cover	1
15-8	SB209E-1508	Timing Pulley Adjusting Gasket	1	15-16	SB209E-1516	Locking Screw, M6x12	2



# EXPLODED VIEW & PARTS LIST

**FIG. 16. AUGER HOUSING**

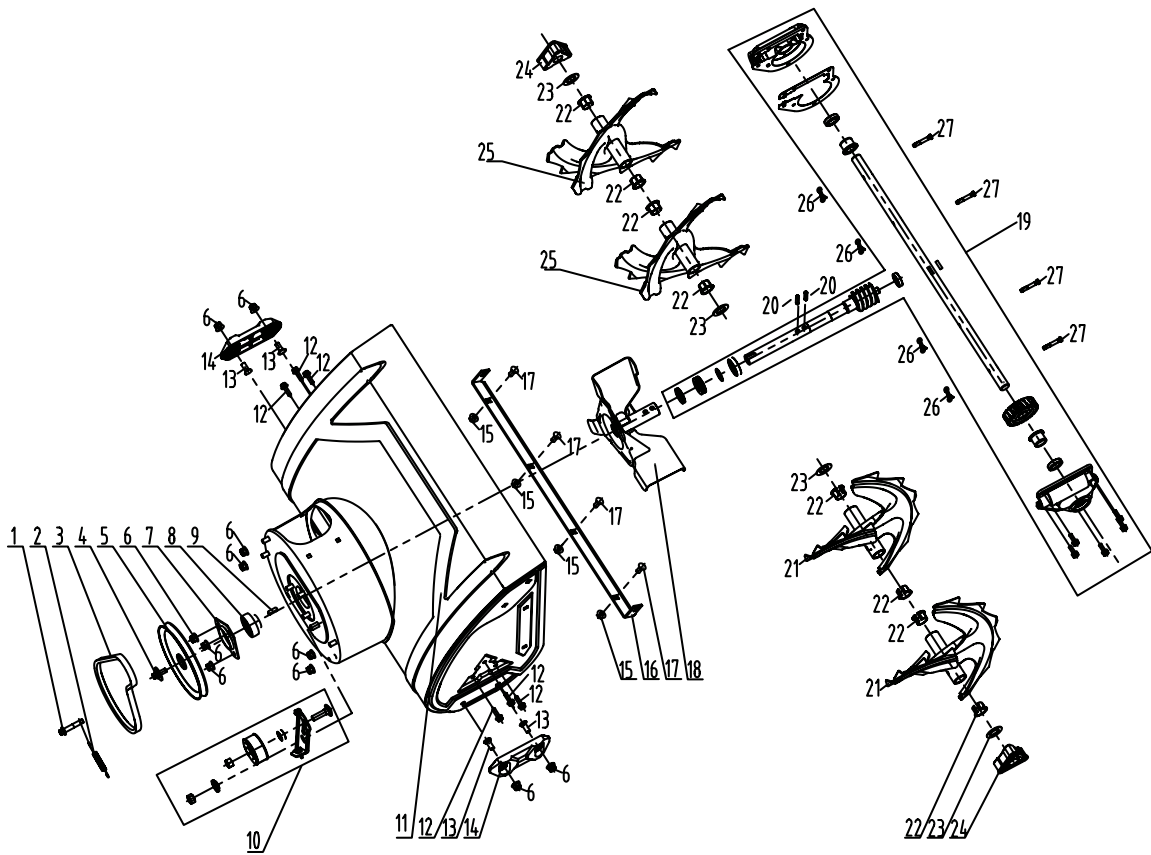

No.	Part No.	Description	Qty.	No.	Part No.	Description	Qty.
16-1	SB209E-1601	Bolt, M8x12	1	16-13	SB209E-1613	Bolt, M8x20	4
16-2	SB209E-1602	Auger Tension Spring	1	16-14	SB209E-1614	Skid	2
16-3	SB209E-1603	Auger Belt, 4LXA727	1	16-15	SB209E-1615	Nut, M8	4
16-4	SB209E-1604	Bolt and Washer Assembly, M8x20	1	16-16	SB209E-1616	Scraper Bar	1
16-5	SB209E-1605	Driven Pulley, Auger	1	16-17	SB209E-1617	Bolt, M8x16	4
16-6	SB209E-1606	Nut, M8	11	16-18	SB209E-1618	Impeller	1
16-7	SB209E-1607	Worm Gear Bearing Seat	1	16-19	SB209E-1619	Gearbox and Auger Axle Assembly	1
16-8	SB209E-1608	Bearing, UC204	1	16-20	SB209E-1620	Shear Pin	2
16-9	SB209E-1609	Flat Key, 20x6x6	1	16-21	SB209E-1621	Right Auger	2
16-10	SB209E-1610	Tension Wheel Assembly, Auger	1	16-22	SB209E-1622	Bushing	8
16-11	SB209E-1611	Auger Housing	1	16-23	SB209E-1623	Washer	4
16-12	SB209E-1612	Self-tapping Screw, ST6.3x25	6	16-24	SB209E-1624	Bearing Seat	2
				16-25	SB209E-1625	Left Auger	2
				16-26	SB209E-1626	Bowtie Clip	4
				16-27	SB209E-1627	Pin Shaft	4

# EXPLODED VIEW & PARTS LIST

FIG. 17. CHUTE ASSEMBLY

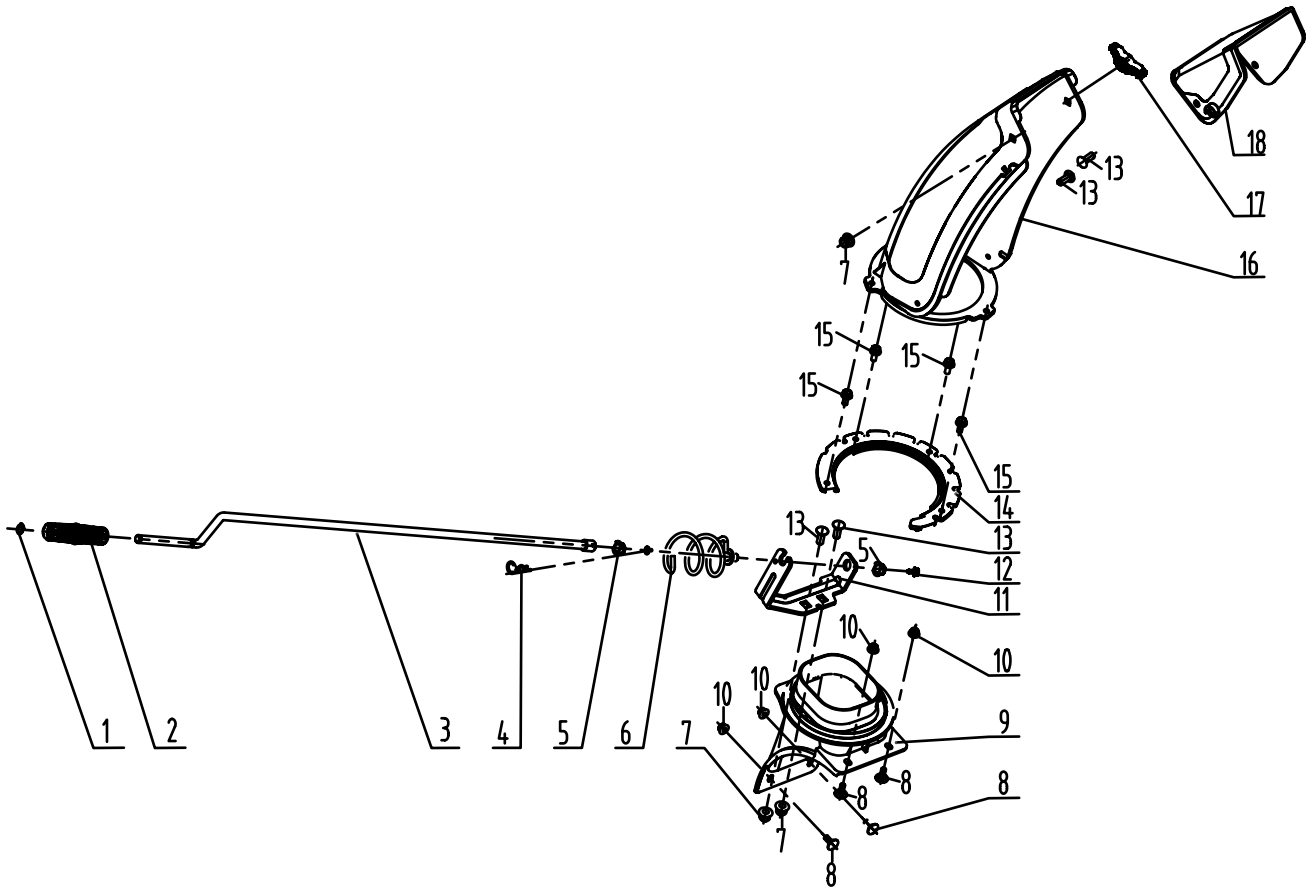

No.	Part No.	Description	Qty.	No.	Part No.	Description	Qty.
17-1	SB209E-1701	Shaft Circlip, 10mm	1	17-10	SB209E-1710	Nut, M6	4
17-2	SB209E-1702	Handle	1	17-11	SB209E-1711	Bracket	1
17-3	SB209E-1703	Rod	1	17-12	SB209E-1712	Locking Screw, M6x12	1
17-4	SB209E-1704	Pin	1	17-13	SB209E-1713	Bolt, M8x20	4
17-5	SB209E-1705	Rotator Bushing	2	17-14	SB209E-1714	Chute Base Plate	1
17-6	SB209E-1706	Rotator Screw	1	17-15	SB209E-1715	Bolt, M6x20	4
17-7	SB209E-1707	Nut, M8	3	17-16	SB209E-1716	Chute	1
17-8	SB209E-1708	Bolt, M6x16	4	17-17	SB209E-1717	Lock Nut, M8	1
17-9	SB209E-1709	Base	1	17-18	SB209E-1718	Chute Deflector Plate	1

# EXPLODED VIEW & PARTS LIST

FIG. 18. HANDLE

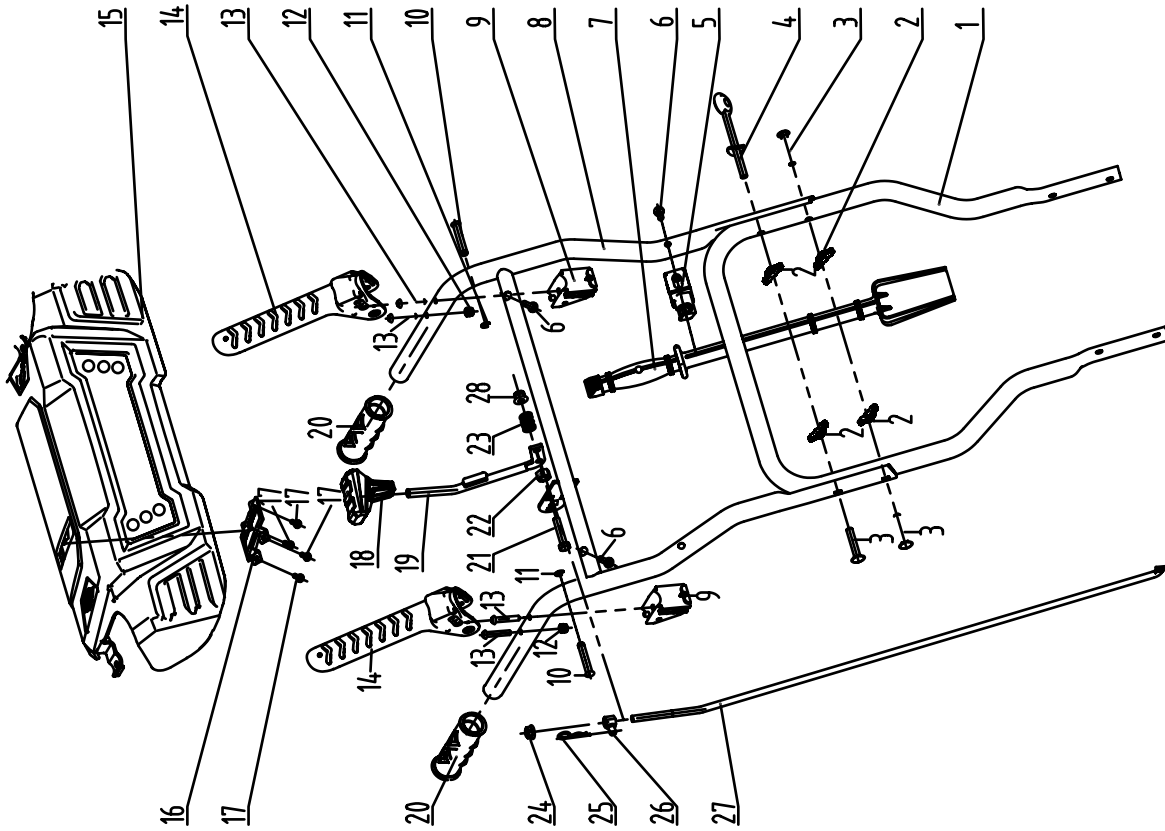

No.	Part No.	Description	Qty.	No.	Part No.	Description	Qty.
18-1	SB209E-1801	Lower Handle	1	18-14	SB209E-1814	Lever	2
18-2	SB209E-1802	Lock Nut, M8	4	18-15	SB209E-1815	Panel	1
18-3	SB209E-1803	Bolt, M8x45	3	18-16	SB209E-1816	Gear Indicator Seat	1
18-4	SB209E-1804	Rotator Mounting Bracket	1	18-17	SB209E-1817	Screw, ST4.8x13	4
18-5	SB209E-1805	Shovel Bracket	1	18-18	SB209E-1818	Shift Lever Grip	1
18-6	SB209E-1806	Self-tapping Screw, ST6.3x25	3	18-19	SB209E-1819	Shift Lever Rod	1
18-7	SB209E-1807	Shovel	1	18-20	SB209E-1820	Handle Grip	2
18-8	SB209E-1808	Upper Handle	1	18-21	SB209E-1821	Bolt, M8x40	1
18-9	SB209E-1809	Lever Mounting Seat	2	18-22	SB209E-1822	Nut, M10	1
18-10	SB209E-1810	Pin Shaft	2	18-23	SB209E-1823	Pressure Spring	1
18-11	SB209E-1811	Circlip, 6mm	2	18-24	SB209E-1824	Nut, M8	1
18-12	SB209E-1812	Nut, M6	2	18-25	SB209E-1825	Pin	1
18-13	SB209E-1813	Bolt, M6x37	4	18-26	SB209E-1826	Adjusting Nut, M8	1
				18-27	SB209E-1827	Shift Lever	1
				18-28	SB209E-1828	Nut, M8	1

# **WARRANTY STATEMENT**

WEN Products is committed to building tools that are dependable for years. Our warranties are consistent with this commitment and our dedication to quality.

## **LIMITED WARRANTY OF WEN PRODUCTS FOR HOME USE**

GREAT LAKES TECHNOLOGIES, LLC (“Seller”) warrants to the original purchaser only, that all WEN consumer power tools will be free from defects in material or workmanship during personal use for a period of two (2) years from date of purchase or 500 hours of use; whichever comes first. Ninety days for all WEN products if the tool is used for professional or commercial use. Purchaser has 30 days from the date of purchase to report missing or damaged parts.

SELLER’S SOLE OBLIGATION AND YOUR EXCLUSIVE REMEDY under this Limited Warranty and, to the extent permitted by law, any warranty or condition implied by law, shall be the replacement of parts, without charge, which are defective in material or workmanship and which have not been subjected to misuse, alteration, careless handling, misrepair, abuse, neglect, normal wear and tear, improper maintenance, or other conditions adversely affecting the Product or the component of the Product, whether by accident or intentionally, by persons other than Seller. To make a claim under this Limited Warranty, you must make sure to keep a copy of your proof of purchase that clearly defines the Date of Purchase (month and year) and the Place of Purchase. Place of Purchase must be a direct vendor of Great Lakes Technologies, LLC. Purchasing through third party vendors, including but not limited to garage sales, pawn shops, resale shops, or any other secondhand merchant, voids the warranty included with this product. Contact [techsupport@wenproducts.com](mailto:techsupport@wenproducts.com) or 1-847-429-9263 with the following information to make arrangements: your shipping address, phone number, serial number, required part numbers, and proof of purchase. Damaged or defective parts and products may need to be sent to WEN before the replacements can be shipped out.

Upon the confirmation of a WEN representative, your product may qualify for repairs and service work. When returning a product for warranty service, the shipping charges must be prepaid by the purchaser. The product must be shipped in its original container (or an equivalent), properly packed to withstand the hazards of shipment. The product must be fully insured with a copy of the proof of purchase enclosed. There must also be a description of the problem in order to help our repairs department diagnose and fix the issue. Repairs will be made and the product will be returned and shipped back to the purchaser at no charge for addresses within the contiguous United States.

THIS LIMITED WARRANTY DOES NOT APPLY TO ITEMS THAT WEAR OUT FROM REGULAR USAGE OVER TIME, INCLUDING BELTS, BRUSHES, BLADES, BATTERIES, ETC. ANY IMPLIED WARRANTIES SHALL BE LIMITED IN DURATION TO TWO (2) YEARS FROM DATE OF PURCHASE. SOME STATES IN THE U.S. AND SOME CANADIAN PROVINCES DO NOT ALLOW LIMITATIONS ON HOW LONG AN IMPLIED WARRANTY LASTS, SO THE ABOVE LIMITATION MAY NOT APPLY TO YOU.

IN NO EVENT SHALL SELLER BE LIABLE FOR ANY INCIDENTAL OR CONSEQUENTIAL DAMAGES (INCLUDING BUT NOT LIMITED TO LIABILITY FOR LOSS OF PROFITS) ARISING FROM THE SALE OR USE OF THIS PRODUCT. SOME STATES IN THE U.S. AND SOME CANADIAN PROVINCES DO NOT ALLOW THE EXCLUSION OR LIMITATION OF INCIDENTAL OR CONSEQUENTIAL DAMAGES, SO THE ABOVE LIMITATION OR EXCLUSION MAY NOT APPLY TO YOU.

THIS LIMITED WARRANTY GIVES YOU SPECIFIC LEGAL RIGHTS, AND YOU MAY ALSO HAVE OTHER RIGHTS WHICH VARY FROM STATE TO STATE IN THE U.S., PROVINCE TO PROVINCE IN CANADA AND FROM COUNTRY TO COUNTRY.

THIS LIMITED WARRANTY APPLIES ONLY TO ITEMS SOLD WITHIN THE UNITED STATES OF AMERICA, CANADA AND THE COMMONWEALTH OF PUERTO RICO. FOR WARRANTY COVERAGE WITHIN OTHER COUNTRIES, CONTACT THE WEN CUSTOMER SUPPORT LINE. FOR WARRANTY PARTS OR PRODUCTS REPAIRED UNDER WARRANTY SHIPPING TO ADDRESSES OUTSIDE OF THE CONTIGUOUS UNITED STATES, ADDITIONAL SHIPPING CHARGES MAY APPLY.