

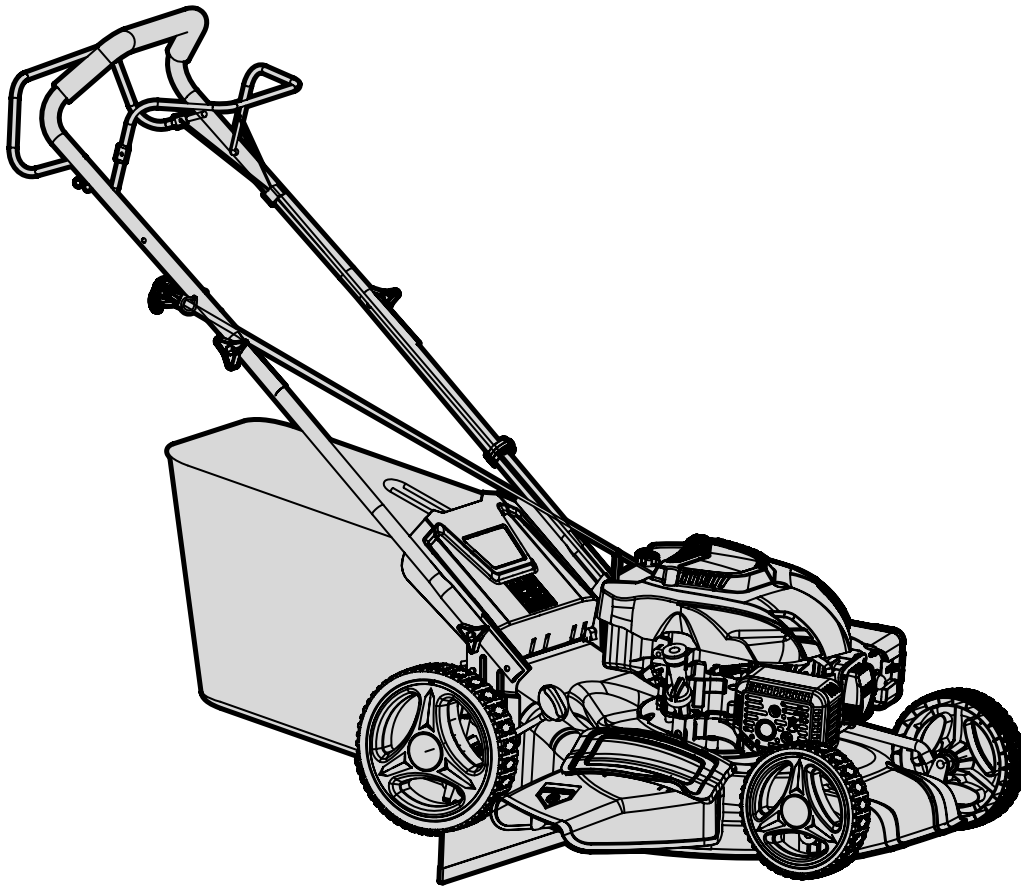

MODEL LM2173

GAS-POWERED LAWN MOWER

Instruction Manual



NEED HELP? CONTACT US!

Have product questions? Need technical support? Please feel free to contact us:



1-800-232-1195 (M-F 8AM-5PM CST)



TECHSUPPORT@WENPRODUCTS.COM

IMPORTANT: Your new tool has been engineered and manufactured to WEN's highest standards for dependability, ease of operation, and operator safety. When properly cared for, this product will supply you years of rugged, trouble-free performance. Pay close attention to the rules for safe operation, warnings, and cautions. If you use your tool properly and for its intended purpose, you will enjoy years of safe, reliable service.

For replacement parts and the most up-to-date instruction manuals, visit ***WENPRODUCTS.COM***

CONTENTS

WELCOME	3
Introduction	3
Specifications.....	3
Service Record.....	4
SAFETY	5
Safety Information	5
Lawn Mower Safety Warnings	7
BEFORE OPERATING	10
Know Your Lawn Mower	10
Assembly & Adjustments.....	11
OPERATION & MAINTENANCE	14
Operation	14
Maintenance & Storage.....	16
Troubleshooting Guide	19
Exploded View & Parts List.....	20
Warranty Statement	26

INTRODUCTION

Thanks for purchasing the WEN Gas-Powered Lawn Mower. We know you are excited to put your tool to work, but first, please take a moment to read through the manual. Safe operation of this tool requires that you read and understand this operator's manual and all the labels affixed to the tool. This manual provides information regarding potential safety concerns, as well as helpful assembly and operating instructions for your tool.

 Indicates danger, warning, or caution. The safety symbols and the explanations with them deserve your careful attention and understanding. Always follow the safety precautions to reduce the risk of fire, electric shock or personal injury. However, please note that these instructions and warnings are not substitutes for proper accident prevention measures.

NOTE: The following safety information is not meant to cover all possible conditions and situations that may occur. WEN reserves the right to change this product and specifications at any time without prior notice.

At WEN, we are continuously improving our products. If you find that your tool does not exactly match this manual, please visit wenproducts.com for the most up-to-date manual or contact our customer service at **1-800-232-1195**.

Keep this manual available to all users during the entire life of the tool and review it frequently to maximize safety for both yourself and others.

SPECIFICATIONS

Model Number	LM2173
Engine Power	3.3 kW
Engine Speed	2800 RPM
Cutting Width	21 Inches (530mm)
Cutting Height	1 - 3 Inches (25 - 75mm)
Front Wheel Diameter	8 Inches
Rear Wheel Diameter	10 Inches
Grass Bag Capacity	16 Gallons (60L)

SERVICE RECORD

Thanks for purchasing the WEN Gas-Powered Lawn Mower. Refer to the illustration below for the location of the serial number on the side of the engine. Record the lawn mower information in the spaces provided below. If assistance for information or service is required, please contact customer service by calling **1-800-232-1195**, M-F 8-5 CST; you will be asked to provide the following lawn mower information when calling.

Lawn Mower Model Number: LM2173

Date of Purchase: _____

Purchased From: _____

Serial Number: _____

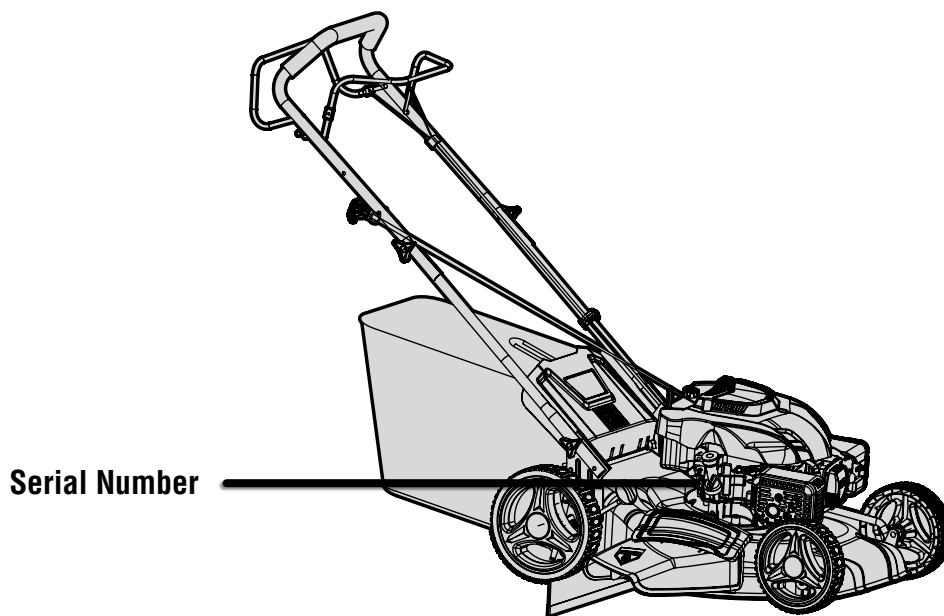

SERVICE RECORD

Record the service dates of your lawn mower in the chart below. Please perform maintenance checks and operations according to the "Maintenance" section of the manual.

Service Record	Date	Date	Date	Date	Date	Date
Change Oil						
Change Spark Plug						
Clean Fuel Tank						
Clean Air Cleaner						
Clean Spark Arrestor						

TO MAXIMIZE THE LIFESPAN OF YOUR LAWN MOWER: We recommend running your lawn mower at least once a month for 20 to 30 minutes and using a fuel stabilizer when not using the lawn mower regularly.

GENERAL SAFETY RULES

 **WARNING!** Read all safety warnings and all instructions. Failure to follow the warnings and instructions may result in electric shock, fire and/or serious injury.

Safety is a combination of common sense, staying alert and knowing how your item works. The term “power tool” in the warnings refers to your mains-operated (corded) power tool or battery-operated (cordless) power tool.

SAVE THESE SAFETY INSTRUCTIONS.

WORK AREA SAFETY

- 1. Keep work area clean and well lit.** Cluttered or dark areas invite accidents.
- 2. Do not operate power tools in explosive atmospheres, such as in the presence of flammable liquids, gases or dust.** Power tools create sparks which may ignite the dust or fumes.
- 3. Keep children and bystanders away while operating a power tool.** Distractions can cause you to lose control.

ELECTRICAL SAFETY

- 1. Power tool plugs must match the outlet. Never modify the plug in any way. Do not use any adapter plugs with earthed (grounded) power tools.** Unmodified plugs and matching outlets will reduce risk of electric shock.
- 2. Avoid body contact with earthed or grounded surfaces such as pipes, radiators, ranges and refrigerators.** There is an increased risk of electric shock if your body is earthed or grounded.
- 3. Do not expose power tools to rain or wet conditions.** Water entering a power tool will increase the risk of electric shock.
- 4. Do not abuse the cord. Never use the cord for carrying, pulling or unplugging the power tool. Keep cord away from heat, oil, sharp edges or moving parts.** Damaged or entangled cords increase the risk of electric shock.
- 5. When operating a power tool outdoors, use an extension cord suitable for outdoor use.** Use of a cord suitable for outdoor use reduces the risk of electric shock.

- 6. If operating a power tool in a damp location is unavoidable, use a ground fault circuit interrupter (GFCI) protected supply.** Use of a GFCI reduces the risk of electric shock.

PERSONAL SAFETY

- 1. Stay alert, watch what you are doing and use common sense when operating a power tool. Do not use a power tool while you are tired or under the influence of drugs, alcohol or medication.** A moment of inattention while operating power tools may result in serious personal injury.
- 2. Use personal protective equipment. Always wear eye protection.** Protective equipment such as a respiratory mask, non-skid safety shoes and hearing protection used for appropriate conditions will reduce the risk of personal injury.
- 3. Prevent unintentional starting. Ensure the switch is in the off-position before connecting to power source and/or battery pack, picking up or carrying the tool.** Carrying power tools with your finger on the switch or energizing power tools that have the switch on invites accidents.
- 4. Remove any adjusting key or wrench before turning the power tool on.** A wrench or a key left attached to a rotating part of the power tool may result in personal injury.
- 5. Do not overreach. Keep proper footing and balance at all times.** This enables better control of the power tool in unexpected situations.
- 6. Dress properly. Do not wear loose clothing or jewelry. Keep your hair and clothing away from moving parts.** Loose clothes, jewelry or long hair can be caught in moving parts.

GENERAL SAFETY RULES

⚠ WARNING! Read all safety warnings and all instructions. Failure to follow the warnings and instructions may result in electric shock, fire and/or serious injury.

Safety is a combination of common sense, staying alert and knowing how your item works. The term “power tool” in the warnings refers to your mains-operated (corded) power tool or battery-operated (cordless) power tool.

SAVE THESE SAFETY INSTRUCTIONS.

7. If devices are provided for the connection of dust extraction and collection facilities, ensure these are connected and properly used. Use of dust collection can reduce dust-related hazards.

POWER TOOL USE AND CARE

1. Do not force the power tool. Use the correct power tool for your application. The correct power tool will do the job better and safer at the rate for which it was designed.

2. Do not use the power tool if the switch does not turn it on and off. Any power tool that cannot be controlled with the switch is dangerous and must be repaired.

3. Disconnect the plug from the power source and/or the battery pack from the power tool before making any adjustments, changing accessories, or storing power tools. Such preventive safety measures reduce the risk of starting the power tool accidentally.

4. Store idle power tools out of the reach of children and do not allow persons unfamiliar with the power tool or these instructions to operate the power tool. Power tools are dangerous in the hands of untrained users.

5. Maintain power tools. Check for misalignment or binding of moving parts, breakage of parts and any other condition that may affect the power tool's operation. If damaged, have the power tool repaired before use. Many accidents are caused by poorly maintained power tools.

6. Keep cutting tools sharp and clean. Properly maintained cutting tools with sharp cutting edges are less likely to bind and are easier to control.

7. Use the power tool, accessories and tool bits, etc. in accordance with these instructions, taking into account the working conditions and the work to be performed. Use of the power tool for operations different from those intended could result in a hazardous situation.

8. Use clamps to secure your workpiece to a stable surface. Holding a workpiece by hand or using your body to support it may lead to loss of control.

9. KEEP GUARDS IN PLACE and in working order.

SERVICE

1. Have your power tool serviced by a qualified repair person using only identical replacement parts. This will ensure that the safety of the power tool is maintained.

CALIFORNIA PROPOSITION 65 WARNING

Some dust created by power sanding, sawing, grinding, drilling, and other construction activities may contain chemicals, including lead, known to the State of California to cause cancer, birth defects, or other reproductive harm. Wash hands after handling. Some examples of these chemicals are:

- Lead from lead-based paints.
- Crystalline silica from bricks, cement, and other masonry products.
- Arsenic and chromium from chemically treated lumber.

Your risk from these exposures varies depending on how often you do this type of work. To reduce your exposure to these chemicals, work in a well-ventilated area with approved safety equipment such as dust masks specially designed to filter out microscopic particles.

LAWN MOWER SAFETY WARNINGS

DANGER! CARBON MONOXIDE

Using a lawn mower indoors **CAN KILL YOU IN MINUTES**. Lawn mower exhaust contains carbon monoxide (CO). This is a poison gas you cannot see or smell. If you can smell the lawn mower exhaust, you are breathing CO. But even if you cannot smell the exhaust, you could be breathing CO.



NEVER use a lawn mower inside homes, garages, crawl spaces, or other partially enclosed areas. Deadly levels of carbon monoxide can build up in these areas. Using a fan or opening windows and doors does **NOT** supply enough fresh air. **ONLY** use a lawn mower outside and far away from windows, doors, and vents. These openings can pull in lawn mower exhaust.

Even if you use a lawn mower correctly, CO may leak into the home. **ALWAYS** use a battery-powered or battery-backup CO alarm in the home. If you start to feel sick, dizzy, or weak after the lawn mower has been running, move to fresh air **RIGHT AWAY**. See a doctor. You may have carbon monoxide poisoning.

 **WARNING! RISK OF EXPLOSION. HIGHLY FLAMMABLE:** This lawn mower may emit highly flammable and explosive gasoline vapors, which can cause severe burns or even death, if ignited. A nearby open flame can lead to explosion even if not directly in contact with gasoline.

- Do not operate near open flame, heat, or any other ignition source. Do not smoke near the lawn mower.
- Always operate on a firm, level surface.
- Always turn lawn mower off before refueling. Allow lawn mower to cool for at least 2 minutes before removing fuel cap. Loosen cap slowly to relieve pressure in tank.
- Do not overfill fuel tank. Gasoline may expand during operation. Do not fill to the top of the tank. Allow for expansion. Always check for spilled fuel before operating.
- If fuel spills, move the lawn mower at least 30 feet away from the spill and wipe clean any spilled fuel before starting the engine.
- Empty fuel tank before storing or transporting the lawn mower.

 **CALIFORNIA PROPOSITION 65 WARNING:** The exhaust from this product contains chemicals known to the State of California to cause cancer, birth defects and other reproductive harm. For more information, visit www.P65Warnings.ca.gov

LAWN MOWER SAFETY WARNINGS

 **WARNING!** Do not operate the power tool until you have read and understood the following instructions and the warning labels.

TRAINING

1. Read the instructions carefully. Be familiar with the controls and the proper use of the equipment.
2. Never allow children or people unfamiliar with these instructions to use the lawn mower. Local regulations can restrict the age of the operator.
3. Never mow while people, especially children, or pets are nearby.
4. Keep in mind that the operator or user is responsible for accidents or hazards occurring to other people or their property.

PREPARATION

1. While mowing, always wear substantial footwear and long trousers. Do not operate the equipment when bare-foot or wearing open-toed footwear.
2. Thoroughly inspect the area where the equipment is to be used and remove all objects which can be thrown by the machine.
3. **WARNING!** Gasoline is highly flammable.
 - Store fuel in containers specifically designed for this purpose.
 - Refuel outdoors only and do not smoke while refueling.
 - Add fuel before starting the engine. Never remove the cap of the fuel tank or add gasoline while the engine is running or when the engine is hot.
 - If gasoline is spilled, do not attempt to start the engine but move the machine away from the area of spillage and avoid creating any source of ignition until gasoline vapor has dissipated.
 - Replace all fuel tank and container caps securely.
4. Replace faulty mufflers.

5. Before using, always visually inspect to see that the blades, blade bolts and cutter assembly are not worn or damaged. Replace worn or damaged blades and bolts in sets to keep machine running properly.

OPERATION

1. Do not operate the engine in a confined space where dangerous carbon monoxide fumes can collect, such as inside the garage or home. That being said, if you are considering running this lawn mower in your living room, you probably already have some personal problems that we are unable to help you with.
2. Mow only in daylight or in good lighting conditions.
3. Avoid operating the equipment in wet grass, when feasible.
4. Always be sure you have proper footing on slopes.
5. Walk, never run with the mower.
6. Mow across the face of slopes, never up and down.
7. Exercise extreme caution when changing direction on slopes.
8. Do not mow excessively steep slopes.
9. Use extreme caution when reversing or pulling the lawnmower towards you.
10. Stop the blade if the lawnmower has to be tilted for transportation, when crossing surfaces other than grass, and when transporting the lawnmower to and from the area to be mowed.
11. Never operate the lawnmower with defective guards, or without safety devices, for example deflectors and/or grass catchers, in place.
12. Do not change the engine governor settings or increase the speed of the engine.
13. Disengage all blade and drive clutches before starting the engine.

LAWN MOWER SAFETY WARNINGS

 **WARNING!** Do not operate the power tool until you have read and understood the following instructions and the warning labels.

14. Start the engine or switch on the motor carefully according to instructions and with feet well away from the blade(s).

15. Do not tilt the lawnmower when starting the engine or switching on the motor, except if the lawnmower has to be tilted for starting. In this case, do not tilt it more than absolutely necessary and lift only the part which is away from the operator.

16. Do not start the engine when standing in front of the discharge chute.

17. Do not put hands or feet near or under rotating parts. Keep clear of the discharge opening at all times.

18. Never pick up or carry a lawnmower while the engine is running.

19. Stop engine, disconnect spark plug boot, and make sure that all moving parts have come to a complete stop:

- Before clearing blockages or unclogging chute.
- Before checking, cleaning, or working on the mower.
- After striking a foreign object. Inspect the lawn mower for damage and make any necessary repairs before re-starting and operating the lawnmower.
- If lawnmower starts to vibrate abnormally (check immediately).

MAINTENANCE & STORAGE

1. Keep all nuts, bolts and screws tight to be sure the equipment is in safe working condition.

2. Never store the equipment with gasoline in the tank inside a building where fumes can reach an open flame or spark.

3. Allow engine to cool before storing in any enclosure.

4. To reduce the risk of fire, keep the engine, muffler, and gasoline storage area free of grass, leaves, or excessive grease.

5. Check the grass catcher frequently for wear or deterioration.

6. Replace worn or damaged parts for safety.

7. Drain the fuel tank outdoors.

KNOW YOUR LAWN MOWER

TOOL PURPOSE

Cut and mulch your lawn or garden to keep it looking fresh. Refer to the following diagrams to become familiarized with all the parts and controls of your lawn mower. The components will be referred to later in the manual for assembly and operation instructions.

LAWN MOWER

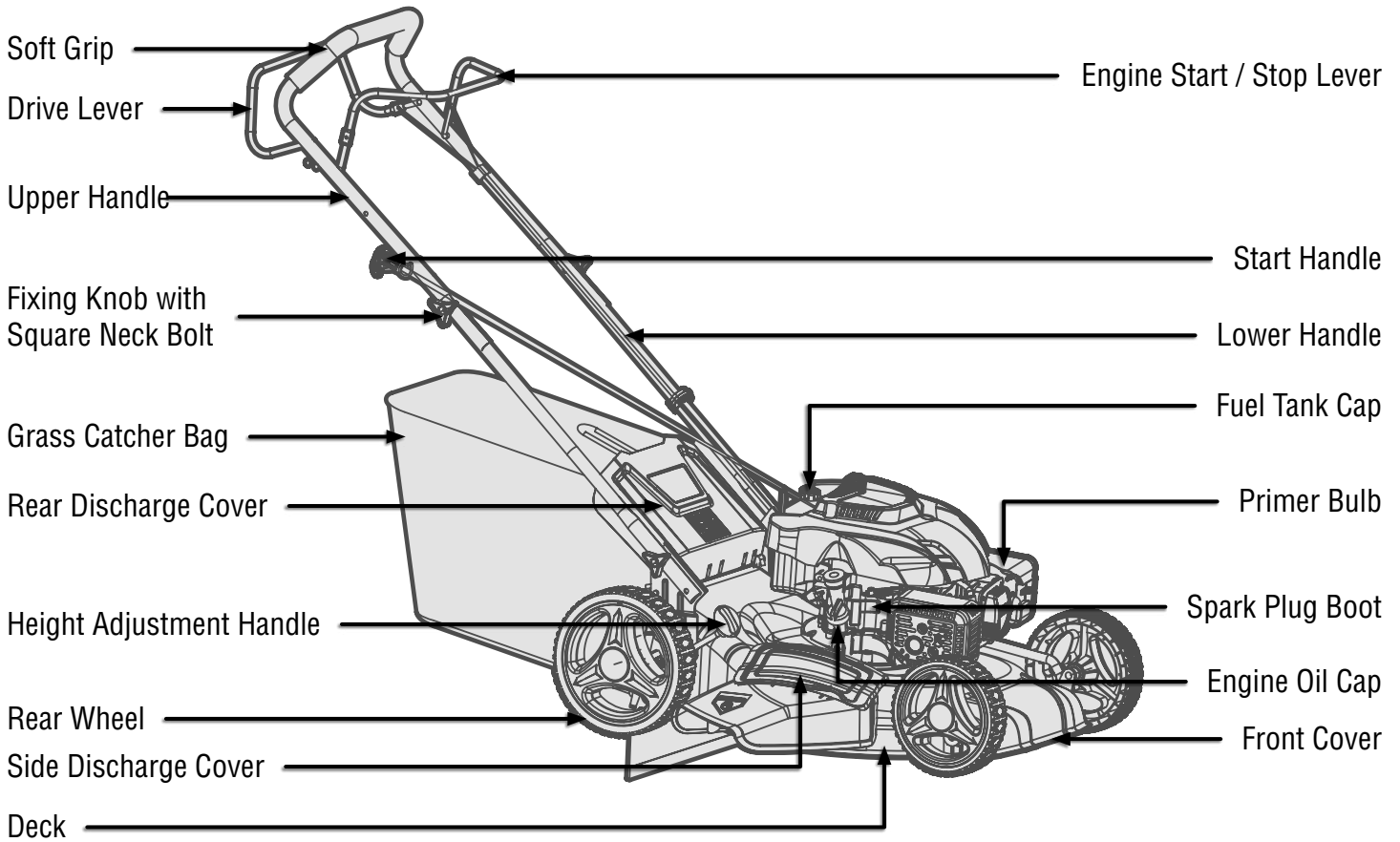

ASSEMBLY & ADJUSTMENTS

ASSEMBLING THE HANDLE

1. Fasten lower handle (Fig. 1 - 1) to unit by using two bolts (Fig. 1 - 2), two washers (Fig. 1 - 3), and two small knobs (Fig. 1 - 4) on each side .

2. Unfold the upper handle (Fig. 2 - 1) and fix it to lower handle by using the two locking knobs (Fig. 2 - 2), two washers (Fig. 2 - 3), and two bolts (Fig. 2 - 4) on each side.

NOTE: Make sure the pull cord guide is on the right side of the upper handle (Fig. 2 - 5).

3. Fix the connection cord to the handle with the included cord clip (Fig. 3 - 1).

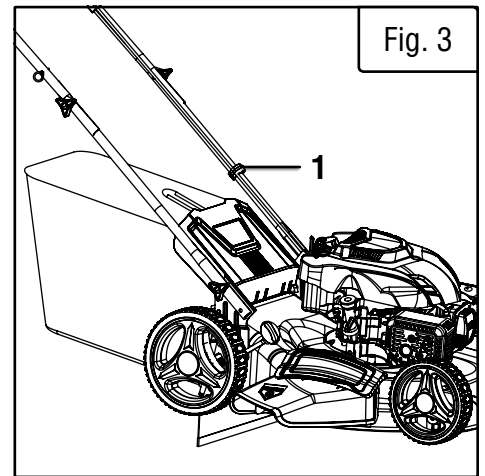
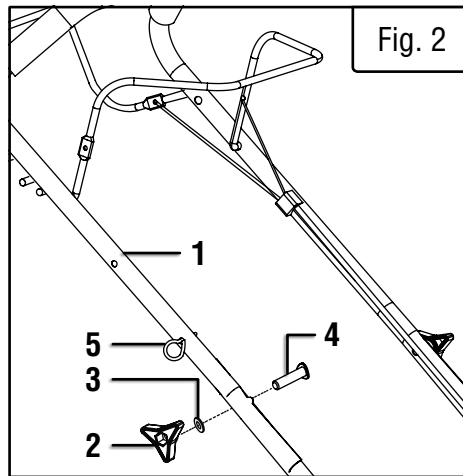
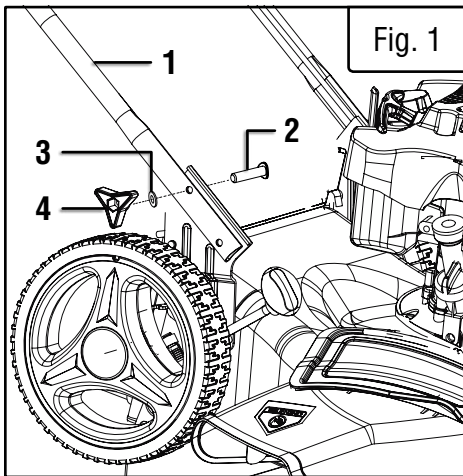

ASSEMBLING THE GRASS BAG

1. Clip the plastic clips over the metal frame. Make sure that these clips are fully secured to the metal frame.

2. Lift the rear discharge cover (Fig. 4 - 1) with one hand and hook in the grass bag (Fig. 4 - 2).

3. Release the rear discharge cover to secure the grass bag in position.

ASSEMBLING THE MULCHING PLUG

1. Remove the grass bag.

2. Push the plastic mulching plug (Fig. 5 - 1) into the discharge chute (Fig. 5 - 2) until it is locked in place.

3. Then release the flap (Fig. 5 - 3). It will close, covering the mulching plug.

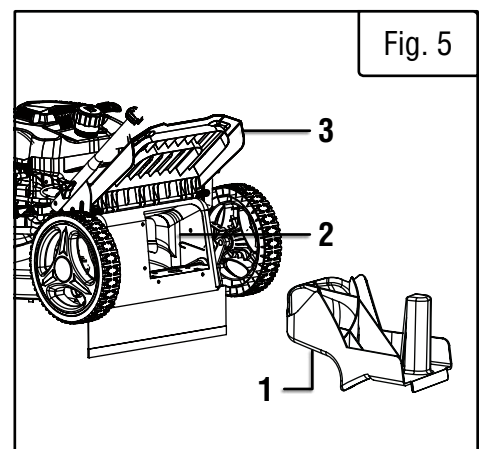
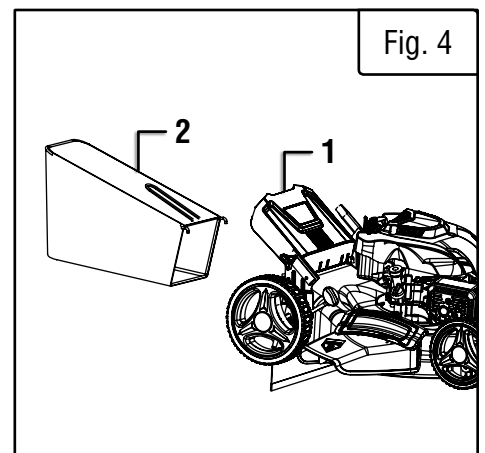

ASSEMBLY & ADJUSTMENTS

ASSEMBLING THE SIDE DISCHARGE CHUTE

NOTE: When using the side discharge function, remove the grass bag and insert the mulching plug into the rear discharge chute.

1. Lift the side discharge cover (Fig. 6 - 1) with one hand and hook in the side discharge duct (Fig. 6 - 2) with the other hand.
2. Release the side discharge cover to secure the duct in position.

The following section describes the necessary steps to prepare the lawn mower for use. If you are unsure about how to perform any of the steps, please call **1-(800) 232-1195** M-F 8-5 CST for customer service. Failure to perform these steps properly can damage the lawn mower or shorten its life.

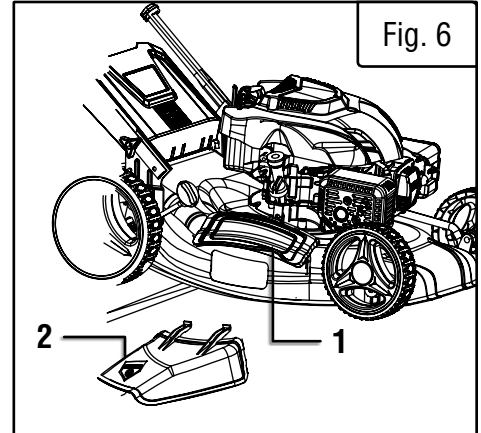

ADD / CHECK OIL

The lawn mower is shipped without oil. User must add the proper amount of oil before operating the lawn mower for the first time. The oil capacity of the engine crankcase is 20.3 fl. oz. (0.6 L).

NOTE: Running engine with low oil level will cause engine damage. It is recommended that high detergent, premium quality 4-stroke engine oil is used.

ENGINE OIL RECOMMENDATIONS

Select good quality detergent oil bearing the American Petroleum Institute (API) service classifications SJ, SL, or SM (synthetic oils may be used). Select the SAE viscosity grade of oil that matches the expected operating temperature.

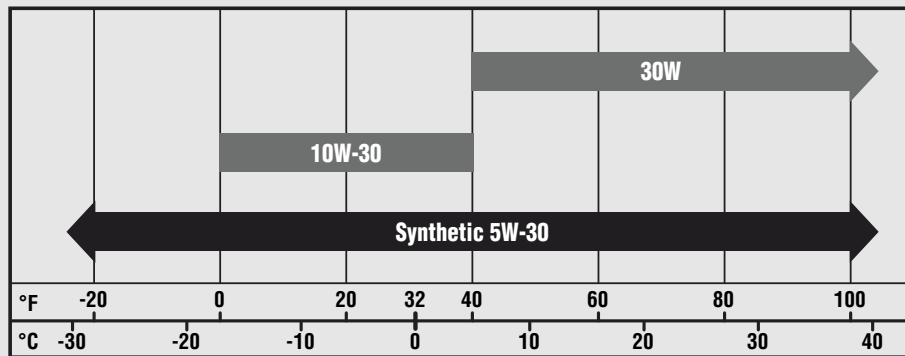

- **30W Engine Oil**
Temperatures above 40°F
- **10W-30 Engine Oil**
Temperatures between 0°F - 40°F
- **Synthetic 5W-30 Engine Oil**
All temperature ranges

1. Place the lawn mower on a level surface. Make sure the engine is off before adding or checking oil.

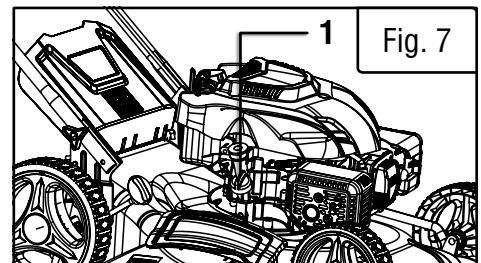

CAUTION! Keep lawn mower level! Tilting mower to assist in filling will cause oil to flow into the wrong areas of the engine and cause damage.

2. Unscrew the oil dipstick (Fig. 7 - 1) from the engine.
3. Using an oil funnel or appropriate dispenser, slowly add oil into the oil fill, being careful not to overfill the unit. Fill the crankcase to the upper fill line so you can visually see the oil coming halfway up the oil fill threads.
4. Reinstall the oil dipstick and firmly tighten it. Wipe clean any spilled oil.

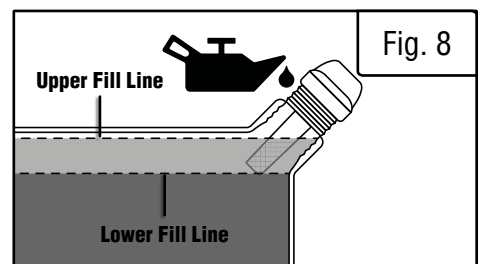

CAUTION! For subsequent operation, oil level should be checked before each use, or after every 8 hours.

ASSEMBLY & ADJUSTMENTS

ADD / CHECK FUEL

⚠ WARNING! RISK OF EXPLOSION. HIGHLY FLAMMABLE: Lawn Mower may emit highly flammable and explosive gasoline vapors, which can cause severe burns or even death, if ignited. A nearby open flame can lead to explosion even if not directly in contact with gasoline.

- Do not operate near open flame, heat, or any other ignition source. Do not smoke near the lawn mower.
- Always operate on a firm, level surface.
- Always turn lawn mower off before refueling. Allow mower to cool for at least 2 minutes before removing fuel cap. Loosen cap slowly to relieve pressure in tank.
- Do not overfill fuel tank. Gasoline may expand during operation. Do not fill to the top of the tank. Allow for expansion. Always check for spilled fuel before operating.
- If fuel spills, move the lawn mower at least 30 feet away from the spill and wipe clean any spilled fuel before starting the engine.
- Empty fuel tank before storing or transporting the lawn mower.

1. Clean the area around the gasoline filler cap (Fig. 9 - 1) before removing the cap. Remove the warning tag, check the fuel level.

2. Refill the tank if the fuel level is low.

3. Refuel carefully to avoid overfilling or spilling fuel. There should be no fuel in the filler neck.

4. Clean up any overflow or splashes of gasoline before starting the engine.

5. Tighten the filler cap after filling.

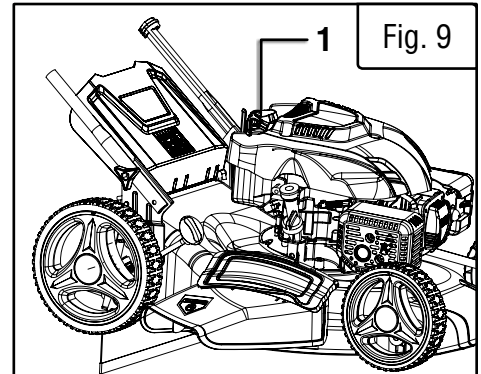

SETTING THE CUTTING HEIGHT

CAUTION! Adjust the cutting height only when the engine has been shut off and the spark plug boot has been removed from the spark plug.

The cutting height is centrally adjusted with the cutting height adjusting handle. Different cutting heights can be selected.

Pull the adjusting handle out and select the desired cutting height. The handle snaps back into the desired position.

Cutting height ranges from 1 - 3 inches, from position 1 to 7, respectively.

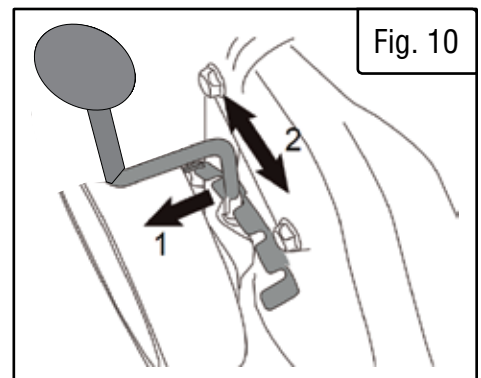

SETTING REQUIRED FUNCTION

This lawn mower has four functions. You can switch between functions by removing or installing different accessories. Please see the following chart for details.

To Convert Mower	Mulching Plug	Grass Bag	Side Discharge
For rear discharging	Removed	Removed	Removed
For rear bagging	Removed	Installed	Removed
For mulching	Installed	Removed	Removed
For side discharging	Installed	Removed	Installed

OPERATION

STARTING & STOPPING THE ENGINE

⚠ WARNING! The blade begins to rotate as soon as the engine is started. Keep hands and feet away!

NOTE: Do not operate the machine in enclosed or poorly ventilated areas, as the exhaust gas contains toxic substances. Keep hands, feet, hair, and clothing away from all moving parts of the machine. The exhaust as well as other parts of the machine will become hot during use. Make sure that the blade is securely fastened before starting the engine.

NOTE: To start the engine make sure that the spark plug boot has been installed on the spark plug, and the machine is filled with sufficient oil and gasoline.

STARTING THE ENGINE

1. When starting a cold engine, press primer pump (Fig. 11 - 1) fully 3 times.

⚠ WARNING! Pressing the primer too many times may cause the engine to flood. When starting a warm engine, the primer does not need to be used. If the engine stops due to a lack of gasoline, refill and press the primer 3-5 times.

2. Stand behind the mower. Pull the engine start / stop lever (Fig. 12 - 1) toward upper handle with one hand and place the other hand on the recoil handle.

3. Pull the starter handle slowly until you feel a resistance and then start the engine with a sharp pull.

NOTE: If the engine fails to start after three pulls, repeat the process.

4. Once engine is running, put the recoil rope into the rope guide (Fig. 13).

STOPPING THE ENGINE

Release the engine start / stop lever. It will return to its initial position and the engine will automatically switch off (Fig. 14).

CLEANING A FLOODED ENGINE

NOTE: If the engine won't start after you have pulled the recoil handle several times, the engine may be flooded with excess fuel. Use the following procedure to clear and start a flooded engine.

1. Release the engine start / stop lever (Fig. 12 - 1) to stop engine.

2. Remove the spark plug, dry it, and then reinstall it.

NOTE: Install the spark plug carefully by hand, to avoid cross-threading. After the plug is seated, tighten 1/8 to 1/4 turn with the included spark plug socket wrench to compress the washer and ensure a tight seal.

3. Pull the engine start / stop lever towards the upper handle.

4. Operate the recoil pull cord as described above.

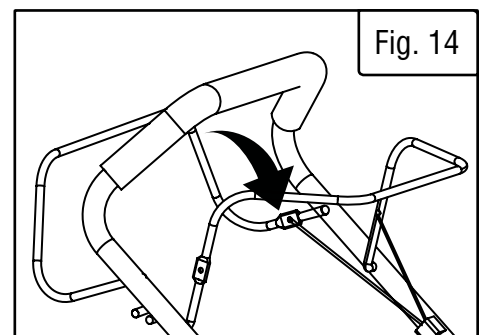
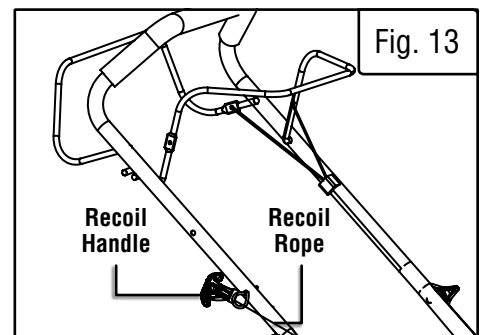
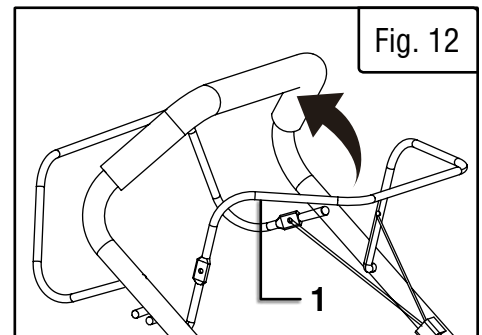
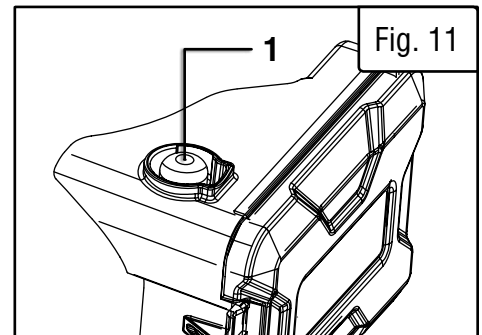

OPERATION

USING THE SELF-PROPELLED FUNCTION

This unit is capable of self-propulsion, unlike your lazy, good-for-nothing son Chet. If you press the drive lever (clutch lever), the clutch will engage and the lawnmower will start to move with the engine running. To stop the lawnmower from self-propelling, simply release the drive lever (Fig. 15 - 1).

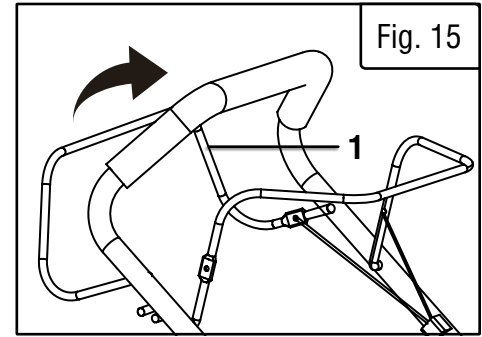

MOWING

⚠ WARNING! Always observe strict safety procedures when using the lawnmower. Carefully read the safety instructions of this manual before using the lawnmower.

⚠ WARNING! Never open the ejector flap when the grass bag has been detached (to be emptied) and the engine is still running. The rotating blade can cause serious injury.

1. Select your desired mowing function and add proper accessories.
2. Start the engine. Allow it to get up to full speed.
3. Keep a firm grip on the upper handle with the engine stop/start lever engaged. Push the lawnmower forward manually, or engage the drive lever (clutch lever) to have the unit be self-propelled.

WORKING ADVICE

1. Walk, never run, with the mower. Be very careful when mowing uneven or rough ground.
2. Mow across slopes, never up and down.
3. Be careful when changing the direction of the mower on a slope.
4. Do not mow excessively steep slopes.
5. The best result will be achieved if grass is dry. Wet grass will tend to clog blade and grass collection systems.
6. Grass grows at different rates at different times of the year. Never use the lowest cutting height for the first cut of the season or in drought conditions.
7. Only about one thirds of the grass height should be cut.
8. When mowing with mulching, to ensure that the cut grass can be scattered efficiently, do not cut very tall or wet grass. Clean the blades and deck intermittently when mowing with the mulching setting.
9. Do not remove grass debris on the mower deck or on the blade by hand or with your feet. Instead, use suitable tools such as a brush or broom.

EMPTYING THE GRASS BAG

As soon as grass clippings start to trail the lawn mower, it is time to empty the grass bag.

NOTE: Before taking off the grass bag, switch off the engine and wait until the blade has come to a complete stop.

1. To take off the grass bag, use one hand to lift up ejector flap and the other to grab the carry handle. Lift the grass bag up and out to remove. The ejector flap automatically falls down after removing the grass bag and closes off the rear chute opening.
2. Empty the grass from the grass bag, and replace grass bag on the mower.

NOTE: If any grass residue is caught in the discharge chute, clean it using a brush. Do not remove grass debris on the mower deck or on the blade by hand or with your feet. Instead, use suitable tools such as a brush or broom. To ensure that cut grass can be collected into the grass bag, the discharge opening and inside of the mower casing must be clear of any blockage.

MAINTENANCE & STORAGE

⚠ WARNING! Before performing any maintenance or cleaning work, switch off the engine and wait until the blade has come to a complete stop.

GENERAL CLEANING

- The lawn mower should be cleaned thoroughly every time after it has been used.
- Do not allow grass cuttings and other debris to harden or dry on any of part of the mower.
- Dried grass debris and dirt may impair mowing operations.
- Check that the grass chute is free of any residual grass. Remove any such residue.
- Check the underside of the lawn mower and the blade mount for any grass remnants. If necessary, tilt the mower slightly onto its left side (opposite the oil dipstick).

NOTE: Before placing the lawn mower on its side, fully drain the fuel tank using a siphon, as well as the carburetor bowl. Do not tilt the lawn mower by more than 90 degrees.

USING THE SELF-PROPELLED FUNCTION

This unit is capable of self-propulsion, unlike your lazy, good-for-nothing son Chet. If you press the drive lever (clutch lever), the clutch will engage and the lawnmower will start to move with the engine running. To stop the lawnmower from self-propelling, simply release the drive lever (Fig. 15 - 1).

SPARK PLUG MAINTENANCE

1. Once engine has cooled, remove spark plug by twisting and pulling it out.
2. Remove the spark plug using a the spark plug wrench
3. Clean the spark plug with a wire brush (not included).
4. Using a feeler gauge, set the gap to 0.75mm (0.03in).
5. Install spark plug carefully by hand to avoid cross-threading until it is seated.
6. Tighten with the wrench about a quarter turn to compress the washer.

SERVICING THE AIR FILTER

Dirty air filters reduce the engine output by supply too little air to the carburetor. If the air contains a lot of dust, the air filter should be checked more frequently.

⚠ WARNING! Never run engine without the air filter element installed.

1. Remove the air cleaner outside cover (Fig. 17 - 1). Be careful to prevent dirt and debris from falling into the air cleaner assembly.
2. Separate the Air Filter from the Air Filter Housing (Fig. 17 - 2).
3. Inspect the air filter. Clean the dirty air filter with warm water and mild soap. Allow the air filter to dry thoroughly before reinstalling.
4. Install the air filter into the housing and secure it with the screws.

NOTE: Do not use pressurized air or solvents to clean the filter. Pressurized air can damage the filter and solvents will dissolve the filter.

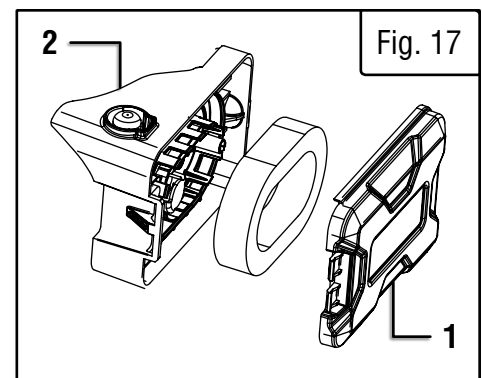
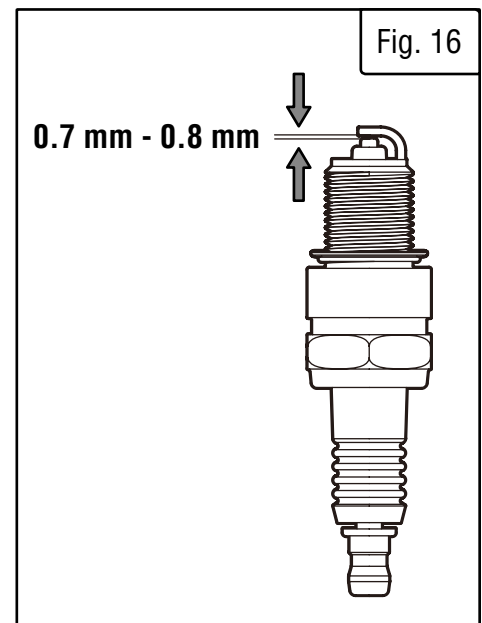

MAINTENANCE & STORAGE

CHANGING THE OIL

1. Remove dipstick and tilt lawn mower towards oil fill hole. Make sure you have a container ready to catch the oil.
2. Once the oil has been emptied, replace the dipstick and clean up any spillages.
3. Refill with 20.3 fl. oz. SAE30 oil or equivalent, i.e. SAE 5W/30, SAE10W/30.
4. When the dipstick is rested on the oil fill hole (i.e. not fully tightened), the oil level must be between the min and max marks on the dipstick. See "Adding / Checking Oil." Start the engine and allow it to run briefly. Stop the engine, wait one minute and check the oil level. Top up if necessary.

REPLACING THE BLADE

For safety reasons, the blade should only be replaced when it is sharpened, balanced, and mounted by an authorized service workshop. For optimal results, it is recommended that the blade should be inspected once a year.

WARNING!

- Before you remove the grass collection bag, stop the engine and wait until the blade stops completely.
- You will need garden gloves (not provided) and a spanner wrench(not provided) to remove the blade.

NOTE: Don't invert the mower. Tip it slightly towards the oil fill hole and reach under the deck.

- Always handle the blade with care, sharp edges could cause injury **USE GLOVES**. Replace your metal blade after 50 hours of mowing or after 2 years, whichever comes first.
- If the blade is cracked or damaged replace it immediately.
- Don't hold the blade directly by hand.

NOTE: Make sure to maintain sharpness of blade. If the blade has worn excessively and become pitted or blunt, it should be replaced or sharpened. The sharpness of the blade will affect the performance of the lawnmower.

For safety reasons we recommend that the blade only be changed by someone qualified and authorized to do so.

Hold the blade and unscrew the blade bolt counterclockwise using a wrench. Remove the washer and the blade.

Fit a new blade or re-sharpen blade. Position the blade on the two studs of the blade flange and then replace the washer and bolt. Make sure the blade is correctly positioned, and then firmly tighten the bolt. Do not over tighten. The end of the bent tips should point up into the motor compartment.

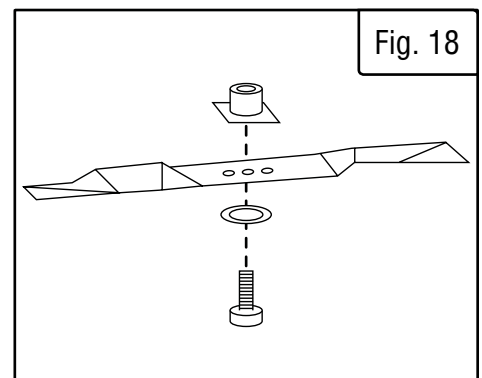

STORING THE LAWN MOWER FOR SHORT PERIODS

The lawn mower can be stored for short periods of time (less than 15 days) without performing any storage maintenance. Before placing the lawn mower into storage always carry out the following:

1. Allow the engine to fully cool.
2. Ensure the grass bag is empty.
3. Clean all debris from under the mower deck.
4. Store the lawnmower on flat and level surface with the mower upright.
5. Store in a safe place, which is out of reach of children or people who are not familiar with operation.

MAINTENANCE & STORAGE

STORING THE LAWN MOWER FOR EXTENDED PERIODS

If the lawnmower will be put into storage for more than 15 days, storage maintenance must be performed on the lawnmower. If the following steps are not carried out, when you next operate the lawnmower it may not start correctly and may need to be serviced.

CAUTION! Do not empty the gasoline tank in enclosed areas, near fire, or when smoking. Gasoline fumes can cause explosions and fire.

1. Empty gasoline tank with a siphon if available. Alternatively, empty gasoline through the carburetor drain screw.
2. Start the engine and let it run until any remaining gasoline has been completely used up.
3. Change oil after every season. To do so, remove used engine oil from a warm engine and refill with fresh oil.
4. Clean the cooling fins of the cylinder and the housing.
5. Be sure to clean the entire machine to protect the paint and mitigate wear.
6. Store the machine in a well-ventilated place.

MAINTENANCE SCHEDULE

Performing routine maintenance correctly on your lawn mower will ensure you get years of trouble-free use. Please keep this manual handy for future reference. It is recommended that the following maintenance schedule is adhered to. This will ensure the lawn mower operated correctly and is safe to use.

	12 Hours of Use	24 Hours of Use	36 Hours of Use
Air Filter	Clean	Clean	Replace
Spark Plug	Check	Clean	Replace
Engine Oil	Check	Replace	Check

The Engine oil should be changed after the first 8 hours.

TRANSPORTATION

- Before transporting the lawn mower, ensure the gas tank is empty.
- Always let engine run until it has used up remainder of gas in the tank. Empty engine oil while engine is warm.
- Remove the spark plug boot from the spark plug.
- Clean the cooling fins of the cylinder and the housing.

TROUBLESHOOTING GUIDE

⚠ WARNING! Stop using the lawn mower immediately if any of the following problems occur or risk serious personal injury. If you have any questions, please contact customer service at **1-800-232-1195** (M-F 8-5 CST), or email techsupport@wenproducts.com.

PROBLEM	POSSIBLE CAUSE	SOLUTION
Unit is excessively loud or excessively vibrating.	1. Screws or fasteners on the unit are loose.	1. Tighten all loose screws and fasteners.
	2. Blade is unbalanced.	2. Replace blade.
Engine does not start.	1. Spark plug is defective.	1. Replace spark plug.
	2. Fuel tank is empty.	2. Refill with fuel.
	3. Engine is flooded.	3. Remove spark plug and dry.
	4. Air filter is dirty.	4. Clean the air filter.
Engine runs unsteadily.	1. Spark plug is too dirty.	1. Clean the spark plug.
	2. Blade is blunt or very worn.	2. Sharpen or replace the blade.
Uneven mowing results.	1. Cutting height is too low.	1. Set correct height.
	2. Blade is worn.	2. Replace the blade.
Grass bag is not filled sufficiently.	1. Grass bag is clogged.	1. Empty the grass bag.
	2. Cutting height is not low enough.	2. Correct the cutting height.
	3. The grass is wet.	3. Allow the lawn to dry before cutting.
	4. Discharge channel or housing is blocked.	4. Clean the discharge channel and housing.
	5. The underside of mower deck is clogged with wet grass, cuttings, or other foreign objects.	5. Clean the underside of the mower deck.

EXPLODED VIEW & PARTS LIST

LAWN MOWER

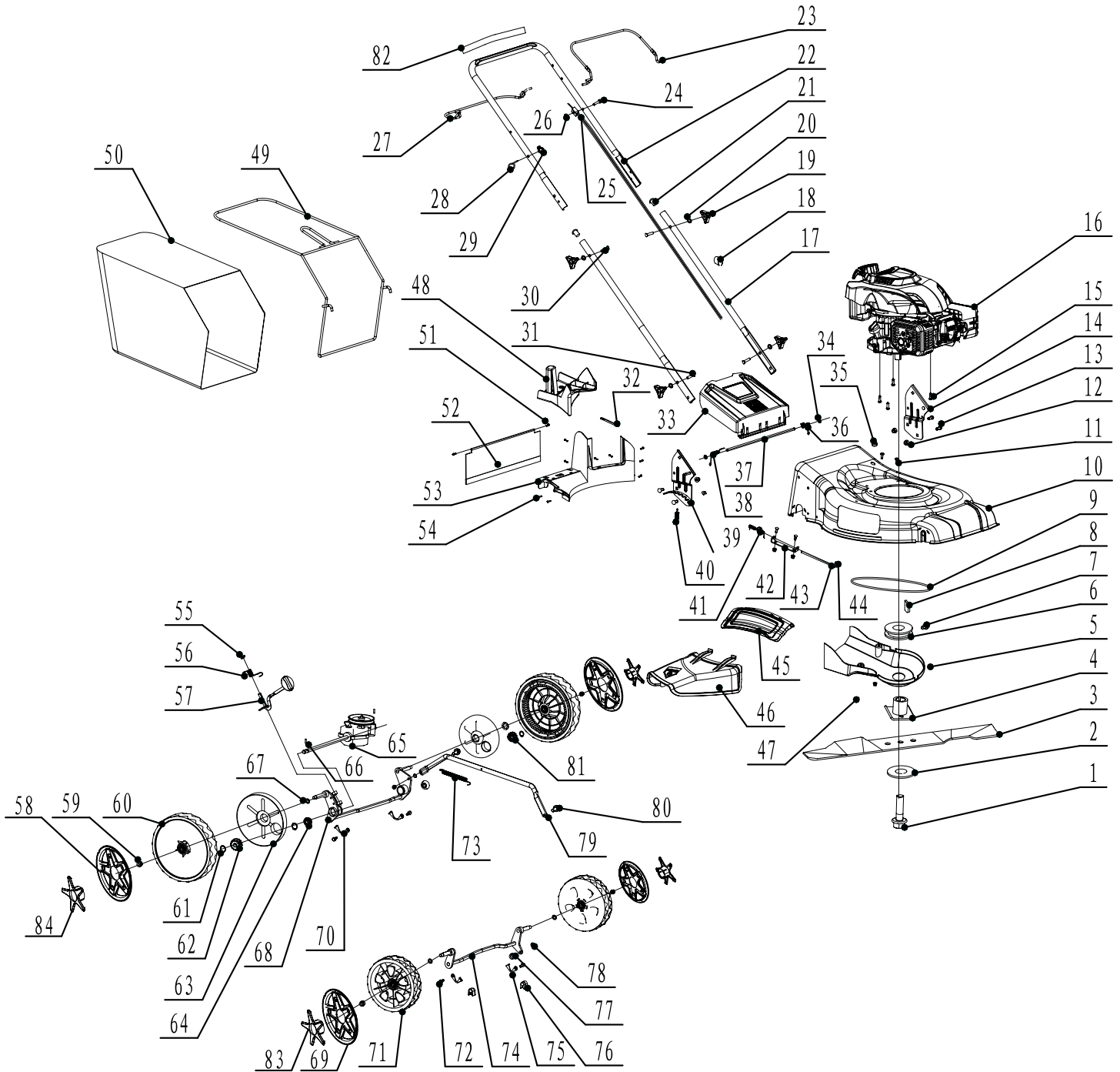

EXPLODED VIEW & PARTS LIST

LAWN MOWER

NO.	PART NO.	DESCRIPTION	QTY.
1	LM2173-001	Bolt 3/8-24 UNFx38	1
2	LM2173-002	Flat Washer Ø45x10.5x2.5	1
3	LM2173-003	Blade	1
4	LM2173-004	Blade Adapter	1
5	LM2173-005	Belt Cover	1
6	LM2173-006	Blade Pulley	1
7	LM2173-007	Bolt M6x8	1
8	LM2173-008	Key	1
9	LM2173-009	Drive Belt	1
10	LM2173-010	Lawn Mower Deck	1
11	LM2173-011	Bolt M6x14	4
12	LM2173-012	Bolt M8	4
13	LM2173-013	Bolt M8x20	4
14	LM2173-014	Left Handle Support	1
15	LM2173-015	Screw 3/8-16 VNCx25	3
16	LM2173-016	Engine	1
17	LM2173-017	Lower Handle	2
18	LM2173-018	Handle Cord Clip	1
19	LM2173-019	Triangle Handle Knob	4
20	LM2173-020	Washer Ø8.4x24x2	4
21	LM2173-021	Handle Cap	2
22	LM2173-022	Upper Handle	1
23	LM2173-023	Engine Break Lever	1
24	LM2173-024	Bolt M6x33	1
25	LM2173-025	Drive Cable	1
26	LM2173-026	Nut M6	1
27	LM2173-027	Drive/Clutch Lever	1
28	LM2173-028	Recoil Starter Hook	1
29	LM2173-029	Recoil Starter Hook Knob	1
30	LM2173-030	Bolt M8x45	2
31	LM2173-031	Bolt M8x38	2
32	LM2173-032	Metal Clip	1
33	LM2173-033	Rear Cover	1
34	LM2173-034	Circlip	2
35	LM2173-035	Cable Protection Pipe	1
36	LM2173-036	Left Torsional Spring	1

NO.	PART NO.	DESCRIPTION	QTY.
37	LM2173-037	Rear Cover Axle	1
38	LM2173-038	Right Torsional Spring	1
39	LM2173-039	Right Handle Support	1
40	LM2173-040	Height Tension Spring	1
41	LM2173-041	Side Discharge Torsional Spring	1
42	LM2173-042	Side Discharge Cover Bracket	1
43	LM2173-043	Side Discharge Cover Axle	1
44	LM2173-044	Circlip	1
45	LM2173-045	Side Discharge Cover	1
46	LM2173-046	Side Discharge Chute	1
47	LM2173-047	Nut M6	4
48	LM2173-048	Mulching Plug	1
49	LM2173-049	Grass Catcher Frame	1
50	LM2173-050	Grass Catcher Bag	1
51	LM2173-051	Screw ST2.9x12	2
52	LM2173-052	Rear Flap	1
53	LM2173-053	Rear Panel	1
54	LM2173-054	Screw KAL50x12	9
55	LM2173-055	Circlip	1
56	LM2173-056	Height Adjustment Tor- sional Spring	1
57	LM2173-057	Height Adjustment Handle	1
58	LM2173-058	Back Wheel Cover	2
59	LM2173-059	Nut M10x1.5	4
60	LM2173-060	Rear Wheel	2
61	LM2173-061	Circlip	4
62	LM2173-062	Right Gear Assembly	1
63	LM2173-063	Inner Wheel Cover	2
64	LM2173-064	Ball Bearing	2
65	LM2173-065	Transmission	1
66	LM2173-066	Transmission Gear Pin	2
67	LM2173-067	Washer	4
68	LM2173-068	Rear Wheel Axle	1

EXPLODED VIEW & PARTS LIST

LAWN MOWER

NO.	PART NO.	DESCRIPTION	QTY.
69	LM2173-069	Front Wheel Cover	2
70	LM2173-070	Rear Axle Plank Plate	2
71	LM2173-071	Front Wheel	2
72	LM2173-072	Bolt M6x12	4
73	LM2173-073	Height Adjustment Spring	1
74	LM2173-074	Front Wheel Axle	1
75	LM2173-075	Front Axle Fixed Plate	2
76	LM2173-076	Wheel Clamp	2

NO.	PART NO.	DESCRIPTION	QTY.
77	LM2173-077	Nut M6	2
78	LM2173-078	Washer	2
79	LM2173-079	Height Adjustment Linkage Bar	1
80	LM2173-080	Fixed Bolt	2
81	LM2173-081	Left Gear Assembly	1
82	LM2173-082	Soft Handle Grip	1
83	LM2173-083	Front Wheel Decal	2
84	LM2173-084	Back Wheel Decal	2

EXPLODED VIEW & PARTS LIST

ENGINE

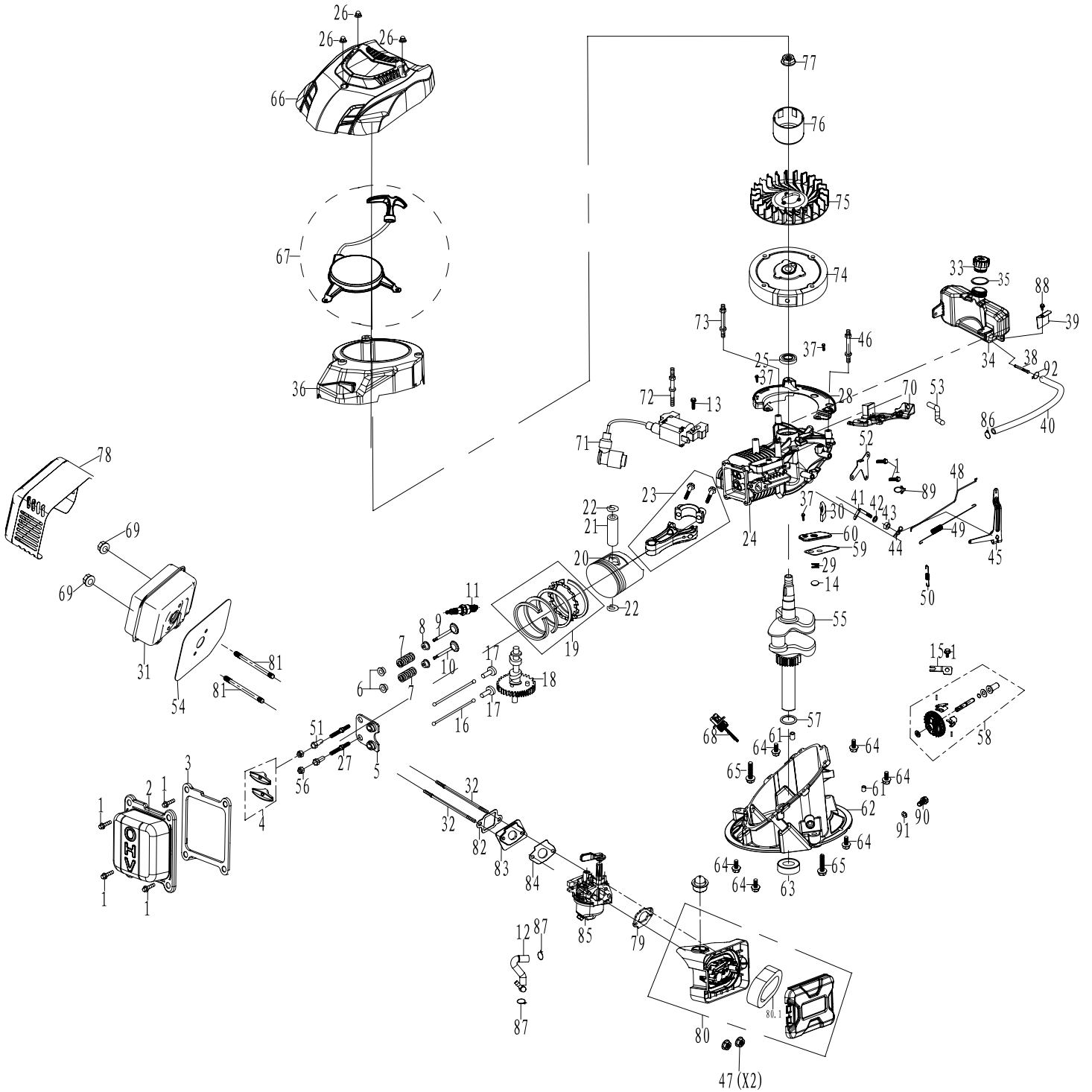

EXPLODED VIEW & PARTS LIST

LAWN MOWER

NO.	PART NO.	DESCRIPTION	QTY.
1	LM2173-101	Bolt M6X12	7
2	LM2173-102	Cylinder Cover	1
3	LM2173-103	Cylinder Gasket	1
4	LM2173-104	Rocker Arm	2
5	LM2173-105	Push Plate	1
6	LM2173-106	Valve Spring Seat	2
7	LM2173-107	Valve Spring	2
8	LM2173-108	Return Intake Valve	2
9	LM2173-109	Intake Valve	1
10	LM2173-110	Exhaust Valve	1
11	LM2173-111	Spark Plug	1
12	LM2173-112	Enriched Air Line	1
13	LM2173-113	Bolt M6X25	1
14	LM2173-114	Circular Plate	1
15	LM2173-115	Governor Plate	1
16	LM2173-116	Push Rod	2
17	LM2173-117	Lifter Valve	2
18	LM2173-118	Camshaft Assembly	1
19	LM2173-119	Piston Scraper Ring Set	1
20	LM2173-120	Piston	1
21	LM2173-121	Piston Pin	1
22	LM2173-122	Piston Clip	2
23	LM2173-123	Connecting Rod Assembly	1
24	LM2173-124	Cylinder	1
25	LM2173-125	Oil Seal	1
26	LM2173-126	Flange Nut M6	3
27	LM2173-127	Adjustable Rocker Arm	2
28	LM2173-128	Shroud	1
29	LM2173-129	Breather Valve Spring	1
30	LM2173-130	Breather Filter	1
31	LM2173-131	Muffler Assembly	1
32	LM2173-132	Stud Bolt	2
33	LM2173-133	Fuel Tank Cap	1
34	LM2173-134	Fuel Tank	1
35	LM2173-135	Fuel Tank Gasket	1
36	LM2173-136	Recoil Starter Housing	1

NO.	PART NO.	DESCRIPTION	QTY.
37	LM2173-137	Bolt M6X16	4
38	LM2173-138	Fuel Filter	1
39	LM2173-139	Wind Deflector	1
40	LM2173-140	Fuel Line	1
41	LM2173-141	Governor Arm Shaft	1
42	LM2173-142	Governor Arm Shaft Washer	1
43	LM2173-143	Governor Arm Shaft Seal	1
44	LM2173-144	Lock Oin	1
45	LM2173-145	Governor Arm	1
46	LM2173-146	Recoil Starter Bolt Stud	1
47	LM2173-147	Disc Nut M6	2
48	LM2173-148	Governor Rod	1
49	LM2173-149	Throttle Return Spring	1
50	LM2173-150	Governor Spring	1
51	LM2173-151	Nut	2
52	LM2173-152	Upper Shroud Assemble	1
53	LM2173-153	Breather Tube	1
54	LM2173-154	Exhaust Gasket	1
55	LM2173-155	Crankshaft	1
56	LM2173-156	Nut	2
57	LM2173-157	Crankshaft Washer	1
58	LM2173-158	Governor Assembly	1
59	LM2173-159	Breather Chamber Gasket	1
60	LM2173-160	Breather Chamber Cap	1
61	LM2173-161	Dowel Pin	2
62	LM2173-162	Crankcase Cover Assembly	1
63	LM2173-163	Oil Seal	1
64	LM2173-164	Bolt M6X18	6
65	LM2173-165	Bolt M6X45	2
66	LM2173-166	Engine Hood	1
67	LM2173-167	Recoil Starter Assembly	1
68	LM2173-168	Dipstick	1
69	LM2173-169	Nut M6	2
70	LM2173-170	Brake Assembly	1
71	LM2173-171	Ignition Coil Assembly	1

EXPLODED VIEW & PARTS LIST

LAWN MOWER

NO.	PART NO.	DESCRIPTION	QTY.
72	LM2173-172	Ignition Coil Bolt Stud	1
73	LM2173-173	Recoil Starter Bolt Stud	1
74	LM2173-174	Flywheel Assembly	1
75	LM2173-175	Recoil Starter Fan	1
76	LM2173-176	Starter Pulley	1
77	LM2173-177	Nut M14	1
78	LM2173-178	Muffler Shield	1
79	LM2173-179	Air Filter Gasket	1
80	LM2173-180	Air Cleaner Assembly	1
80.1	LM2173-180-1	Air Filter Element	1
81	LM2173-181	Stud Bolt	2
82	LM2173-182	Intake Packing	1
83	LM2173-183	Carburetor Insulator Gasket	1

NO.	PART NO.	DESCRIPTION	QTY.
84	LM2173-184	Carburetor Gasket	1
85	LM2173-185	Carburetor Assembly	1
86	LM2173-186	Gas Tank Lower Fuel Line Clip	1
87	LM2173-187	Fuel Line Clip	2
88	LM2173-188	Screw M4X8	1
89	LM2173-189	Q Type Line Card	1
90	LM2173-190	Drain Screw	1
91	LM2173-191	Drain Screw Washer	1
92	LM2173-192	Gas Tank Upper Fuel Line Clip	1

WARRANTY STATEMENT

WEN Products is committed to building tools that are dependable for years. Our warranties are consistent with this commitment and our dedication to quality.

LIMITED WARRANTY OF WEN PRODUCTS FOR HOME USE

GREAT LAKES TECHNOLOGIES, LLC (“Seller”) warrants to the original purchaser only, that all WEN consumer power tools will be free from defects in material or workmanship during personal use for a period of two (2) years from date of purchase or 500 hours of use; whichever comes first. Ninety days for all WEN products if the tool is used for professional or commercial use. Purchaser has 30 days from the date of purchase to report missing or damaged parts.

SELLER’S SOLE OBLIGATION AND YOUR EXCLUSIVE REMEDY under this Limited Warranty and, to the extent permitted by law, any warranty or condition implied by law, shall be the replacement of parts, without charge, which are defective in material or workmanship and which have not been subjected to misuse, alteration, careless handling, misrepair, abuse, neglect, normal wear and tear, improper maintenance, improper storage, incorrect lubricants/fuels, or other conditions adversely affecting the Product or the component of the Product, whether by accident or intentionally, by persons other than Seller. To make a claim under this Limited Warranty, you must make sure to keep a copy of your proof of purchase that clearly defines the Date of Purchase (month and year) and the Place of Purchase. Place of Purchase must be a direct vendor of Great Lakes Technologies, LLC. Purchasing through third party vendors, including but not limited to garage sales, pawn shops, resale shops, or any other secondhand merchant, voids the warranty included with this product. Contact techsupport@wenproducts.com or 1-800-232-1195 with the following information to make arrangements: your shipping address, phone number, serial number, required part numbers, and proof of purchase. Damaged or defective parts and products may need to be sent to WEN before the replacements can be shipped out.

Upon the confirmation of a WEN representative, your product may qualify for repairs and service work. When returning a product for warranty service, the shipping charges must be prepaid by the purchaser. The product must be shipped in its original container (or an equivalent), properly packed to withstand the hazards of shipment. The product must be fully insured with a copy of the proof of purchase enclosed. There must also be a description of the problem in order to help our repairs department diagnose and fix the issue. Repairs will be made and the product will be returned and shipped back to the purchaser at no charge for addresses within the contiguous United States.

THIS LIMITED WARRANTY DOES NOT APPLY TO ITEMS THAT WEAR OUT FROM REGULAR USAGE OVER TIME, INCLUDING FILTERS, SPARK PLUGS, VOLTAGE REGULATORS, BRUSHES, GASKETS, O-RINGS, WHEEL KITS, BATTERIES, RECOIL STARTERS, HIGH PRESSURE HOSES, SPRAY GUNS, ETC. ANY IMPLIED WARRANTIES SHALL BE LIMITED IN DURATION TO TWO (2) YEARS FROM DATE OF PURCHASE. SOME STATES IN THE U.S. AND SOME CANADIAN PROVINCES DO NOT ALLOW LIMITATIONS ON HOW LONG AN IMPLIED WARRANTY LASTS, SO THE ABOVE LIMITATION MAY NOT APPLY TO YOU.

IN NO EVENT SHALL SELLER BE LIABLE FOR ANY INCIDENTAL OR CONSEQUENTIAL DAMAGES (INCLUDING BUT NOT LIMITED TO LIABILITY FOR LOSS OF PROFITS) ARISING FROM THE SALE OR USE OF THIS PRODUCT. SOME STATES IN THE U.S. AND SOME CANADIAN PROVINCES DO NOT ALLOW THE EXCLUSION OR LIMITATION OF INCIDENTAL OR CONSEQUENTIAL DAMAGES, SO THE ABOVE LIMITATION OR EXCLUSION MAY NOT APPLY TO YOU.

THIS LIMITED WARRANTY GIVES YOU SPECIFIC LEGAL RIGHTS, AND YOU MAY ALSO HAVE OTHER RIGHTS WHICH VARY FROM STATE TO STATE IN THE U.S., PROVINCE TO PROVINCE IN CANADA AND FROM COUNTRY TO COUNTRY.

THIS LIMITED WARRANTY APPLIES ONLY TO ITEMS SOLD WITHIN THE UNITED STATES OF AMERICA, CANADA AND THE COMMONWEALTH OF PUERTO RICO. FOR WARRANTY COVERAGE WITHIN OTHER COUNTRIES, CONTACT THE WEN CUSTOMER SUPPORT LINE. FOR WARRANTY PARTS OR PRODUCTS REPAIRED UNDER WARRANTY SHIPPING TO ADDRESSES OUTSIDE OF THE CONTIGUOUS UNITED STATES, ADDITIONAL SHIPPING CHARGES MAY APPLY.

**THANKS FOR
REMEMBERING**

