

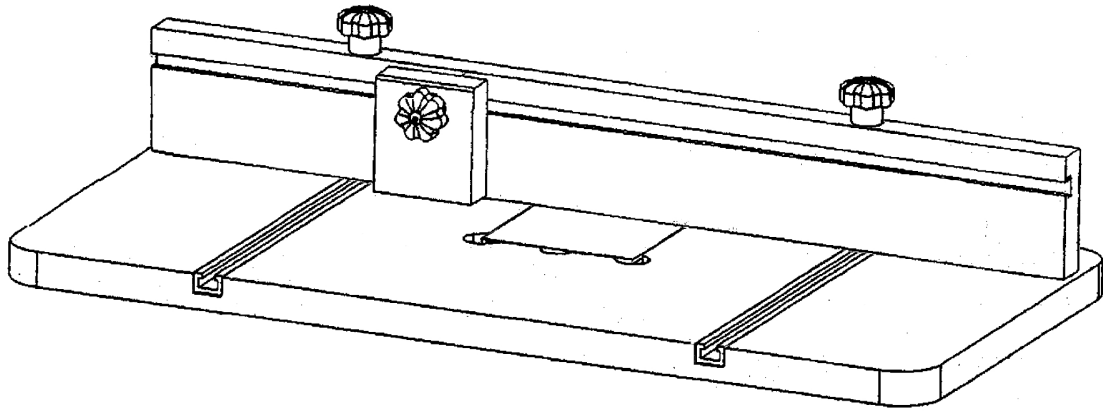

# DRILL PRESS TABLE



For replacement parts visit  
**WENPRODUCTS.COM**

[bit.ly/wenvideo](http://bit.ly/wenvideo)

## IMPORTANT:

Your new tool has been engineered and manufactured to WEN's highest standards for dependability, ease of operation, and operator safety. When properly cared for, this product will supply you years of rugged, trouble-free performance. Pay close attention to the rules for safe operation, warnings, and cautions. If you use your tool properly and for intended purpose, you will enjoy years of safe, reliable service.



## NEED HELP? CONTACT US!

Have product questions? Need technical support?  
Please feel free to contact us at:

 **800-232-1195** (M-F 8AM-5PM CST)

 **techsupport@wenproducts.com**

 **WENPRODUCTS.COM**

**NOTICE: Please refer to [wenproducts.com](http://wenproducts.com) for the most up-to-date instruction manual.**

## TABLE OF CONTENTS

---

Technical Data .....	2
General Safety Rules.....	3
Exploded View & Parts List .....	4
Installation.....	5
Warranty Statement .....	6

## TECHNICAL DATA

---

Model Numbers:	DPA2412, DPA2412T
Drill Press Table Thickness:	1 in.
T-Track Center to Center Distance:	13 in.
Table and Fence Dimensions:	23-7/8 in. x 11-7/8 in. x 4 in.
Overall Dimensions:	23-7/8 in. x 11-7/8 in. x 7-1/2 in.
Weight:	10.5 lbs

Compatible with WEN 4208, 4210, 4212, 4214, 4225 and 4227  
Drill Presses

## GENERAL SAFETY RULES

---

Safety is a combination of common sense, staying alert and knowing how your item works.

### **SAVE THESE SAFETY INSTRUCTIONS.**



**WARNING:** To avoid mistakes and serious injury, **DO NOT** use your item until the following steps have been read and understood. These safety rules cannot address every possible scenario you may encounter, so please use common sense and caution when using the item.

1. **READ** and become familiar with this entire instruction manual. **LEARN** the tool's applications, limitations, and possible hazards.
2. **ALWAYS** keep your work area clean, uncluttered, and well lit. **DO NOT** work on floor surfaces that are slippery with sawdust or wax.
3. **DO NOT ALLOW CHILDREN TO PLAY ON**, stand upon or climb on this item.
4. **DO NOT** operate the tool if you are under the influence of drugs, alcohol, or medication that may affect your ability to properly use the tool.
5. **USE EYE PROTECTION.** Always wear ANSI approved impact safety goggles during assembly.
6. **USE THE RIGHT PRODUCT FOR THE JOB.** There are certain applications for which this item was designed. Do not modify it and do not use it for a purpose for which it was not intended.
7. **ONLY USE ON A FLAT SURFACE** capable of supporting the item.
8. **CHECK FOR DAMAGED PARTS.** Before using any product, check for any broken or damaged parts and any other conditions that may affect its operation. Replace or repair damaged or worn parts immediately.
9. **ALL CONNECTIONS SHOULD BE TIGHT.** Always check hardware and assembled parts after assembling.
10. **STORE IDLE EQUIPMENT.** When not in use, store this item in a dry and clean location. Always secure products and keep out of reach of children.
11. **WHEN SERVICING** use only identical replacement parts and accessories. Using any other parts will void the warranty.

## EXPLODED VIEW AND PARTS LIST

Carefully unpack all items from the box. Check all parts and compare against the exploded view and parts list below. Do not discard the packaging until the tool is completely assembled. If any part is damaged or missing, please contact our customer service at (800) 232-1195, M-F 8-5 CST or email [techsupport@wenproducts.com](mailto:techsupport@wenproducts.com).

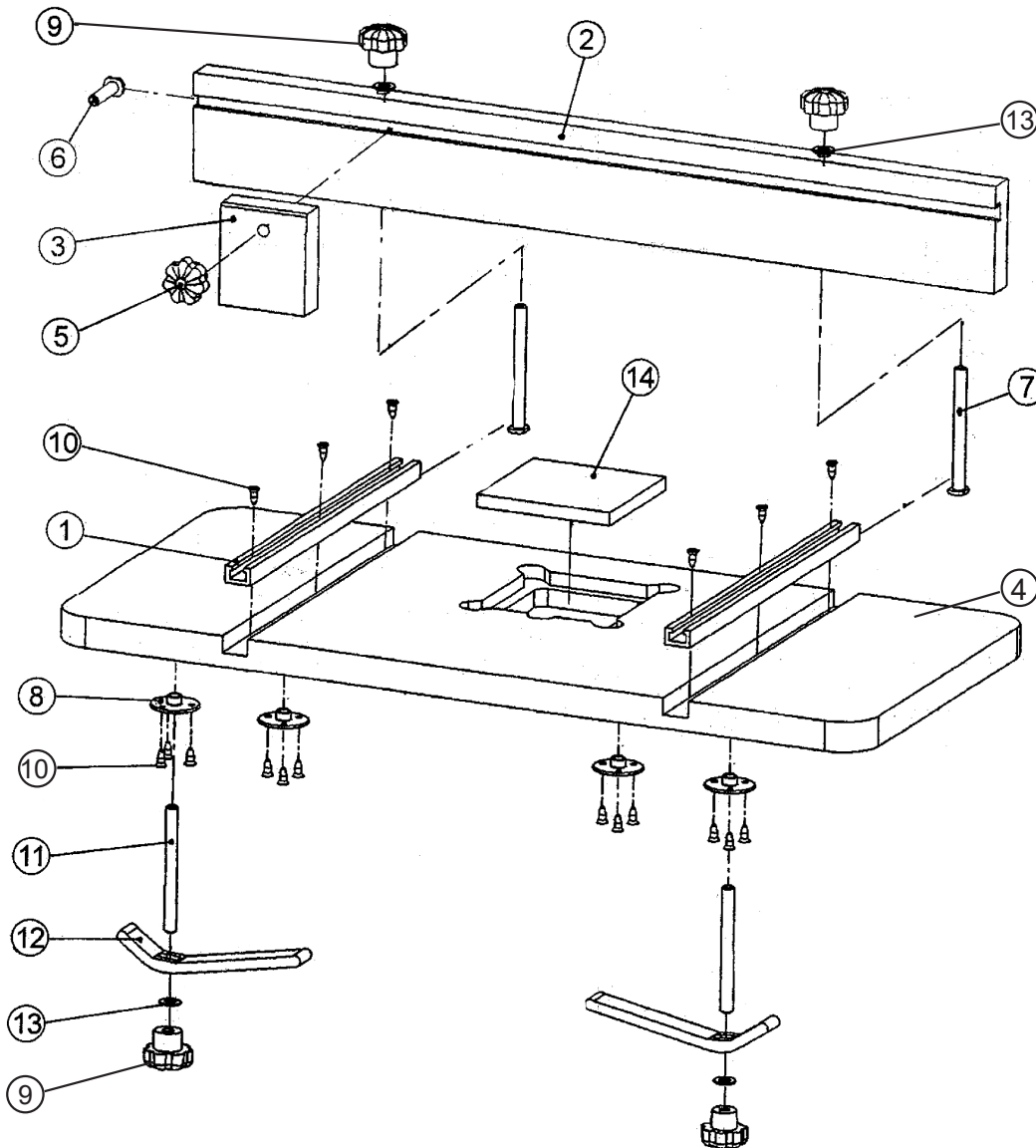

No.	Part No.	Description	Qty.
1	DPA2412-001	Aluminum T-track	2
2	DPA2412-002	Fence	1
3	DPA2412-003	Fence Stop Block	1
4	DPA2412-004	Drill Press Table	1
5	DPA2412-005	Stop Block Knob M6x1	1
6	DPA2412-006	Stop Block Bolt M6x1x40	1
7	DPA2412-007	T-Slot Bolt M8x1.25x90	2

No.	Part No.	Description	Qty.
8	DPA2412-008	Clamp Positioning Flange	4
9	DPA2412-009	Lock Knob	4
10	DPA2412-010	Tapping Screw M8.5x12	18
11	DPA2412-011	Full Thread Rod	2
12	DPA2412-012	Mounting Clamp	2
13	DPA2412-013	Flat Washer 8mm	5
14	DPA2412-014	Insert Block	1

# INSTALLATION

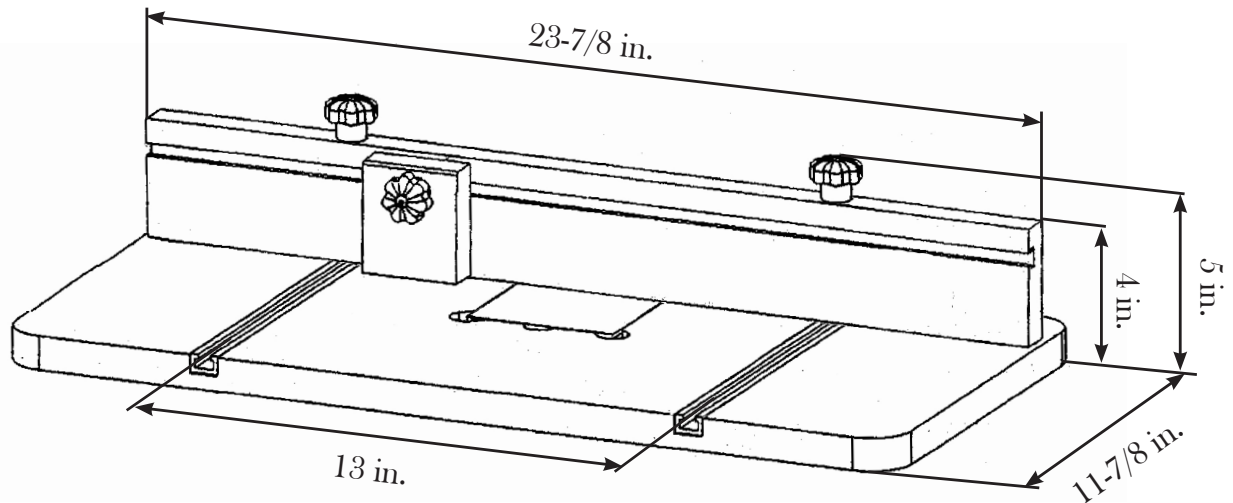

1. Unpack and assemble the drill press table according to the Exploded View and Parts List on page 4. Refer to the dimensions listed above to determine the space and arrangements needed for your drill press table.

2. There are four clamp positioning flanges on the bottom of the drill press table (Fig. 1). Adjust the position of the clamp assemblies to fit the size of your drill press' table.

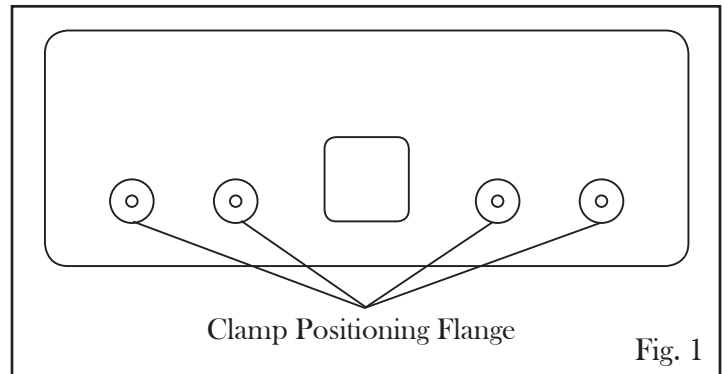

Fig. 1

The clamps can be used in two directions, depending on the size of the table (Fig. 2). Direction A secures the table with the short side of the clamps. Direction B secures the table with the long side of the clamps. To provide maximum stability, choose the direction that ensures the clamps tighten securely on the edge of the table.

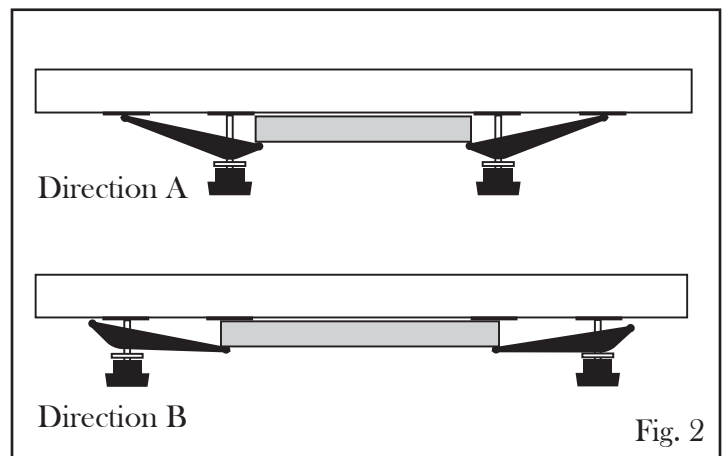

Fig. 2

3. Tighten the clamp lock knobs to secure the drill press table in place. Check that the drill press table will not shift or wobble.

4. Turn the feed handles on the drill press (Fig. 3 - 1) to check if the stop fence will interfere with the handles. **TIP:** One or two of the feed handles may be removed if the stop fence is in the way of the feed handle's travel.

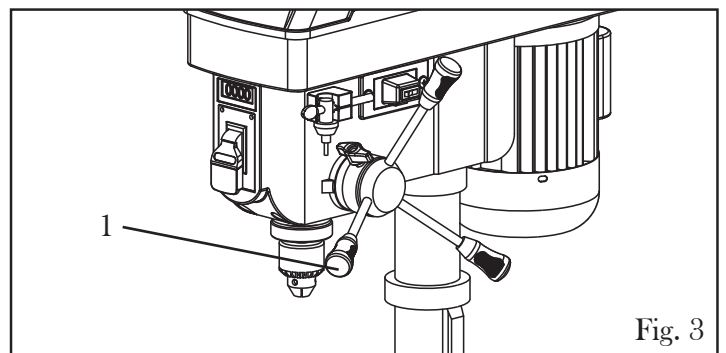

Fig. 3

5. Regularly check that the mounting clamps are secure. After each operation, wipe the drill press table clean and vacuum out the T-slots to keep the tool in good condition. To avoid condensation and rust between the two tables, do not leave the drill press table mounted on the drill press for long periods of time.

## LIMITED TWO YEAR WARRANTY

---

WEN Products is committed to building tools that are dependable for years. Our warranties are consistent with this commitment and our dedication to quality.

### LIMITED WARRANTY OF WEN CONSUMER POWER TOOLS PRODUCTS FOR HOME USE

GREAT LAKES TECHNOLOGIES, LLC (“Seller”) warrants to the original purchaser only, that all WEN consumer power tools will be free from defects in material or workmanship for a period of two (2) years from date of purchase. Ninety days for all WEN products, if the tool is used for professional use.

**SELLER’S SOLE OBLIGATION AND YOUR EXCLUSIVE REMEDY** under this Limited Warranty and, to the extent permitted by law, any warranty or condition implied by law, shall be the repair or replacement of parts, without charge, which are defective in material or workmanship and which have not been misused, carelessly handled, or misrepaired by persons other than Seller or Authorized Service Center. To make a claim under this Limited Warranty, you must make sure to keep a copy of your proof of purchase that clearly defines the Date of Purchase (month and year) and the Place of Purchase. Place of purchase must be a direct vendor of Great Lakes Technologies, LLC. Third party vendors such as garage sales, pawn shops, resale shops, or any other secondhand merchant void the warranty included with this product. Contact [techsupport@wenproducts.com](mailto:techsupport@wenproducts.com) or 1-800-232-1195 to make arrangements for repairs and transportation.

When returning a product for warranty service, the shipping charges must be prepaid by the purchaser. The product must be shipped in its original container (or an equivalent), properly packed to withstand the hazards of shipment. The product must be fully insured with a copy of the warranty card and/or the proof of purchase enclosed. There must also be a description of the problem in order to help our repairs department diagnose and fix the issue. Repairs will be made and the product will be returned and shipped back to the purchaser at no charge.

**THIS LIMITED WARRANTY DOES NOT APPLY TO ACCESSORY ITEMS THAT WEAR OUT FROM REGULAR USAGE OVER TIME INCLUDING BELTS, BRUSHES, BLADES, ETC.**

**ANY IMPLIED WARRANTIES SHALL BE LIMITED IN DURATION TO TWO (2) YEARS FROM DATE OF PURCHASE. SOME STATES IN THE U.S., SOME CANADIAN PROVINCES DO NOT ALLOW LIMITATIONS ON HOW LONG AN IMPLIED WARRANTY LASTS, SO THE ABOVE LIMITATION MAY NOT APPLY TO YOU.**

**IN NO EVENT SHALL SELLER BE LIABLE FOR ANY INCIDENTAL OR CONSEQUENTIAL DAMAGES (INCLUDING BUT NOT LIMITED TO LIABILITY FOR LOSS OF PROFITS) ARISING FROM THE SALE OR USE OF THIS PRODUCT. SOME STATES IN THE U.S. AND SOME CANADIAN PROVINCES DO NOT ALLOW THE EXCLUSION OR LIMITATION OF INCIDENTAL OR CONSEQUENTIAL DAMAGES, SO THE ABOVE LIMITATION OR EXCLUSION MAY NOT APPLY TO YOU.**

**THIS LIMITED WARRANTY GIVES YOU SPECIFIC LEGAL RIGHTS, AND YOU MAY ALSO HAVE OTHER RIGHTS WHICH VARY FROM STATE TO STATE IN THE U.S., PROVINCE TO PROVINCE IN CANADA AND FROM COUNTRY TO COUNTRY.**

**THIS LIMITED WARRANTY APPLIES ONLY TO PORTABLE ELECTRIC TOOLS, BENCH POWER TOOLS, OUTDOOR POWER EQUIPMENT AND PNEUMATIC TOOLS SOLD WITHIN THE UNITED STATES OF AMERICA, CANADA AND THE COMMONWEALTH OF PUERTO RICO. FOR WARRANTY COVERAGE WITHIN OTHER COUNTRIES, CONTACT THE WEN CUSTOMER SUPPORT LINE.**

**THANKS FOR  
REMEMBERING**

