

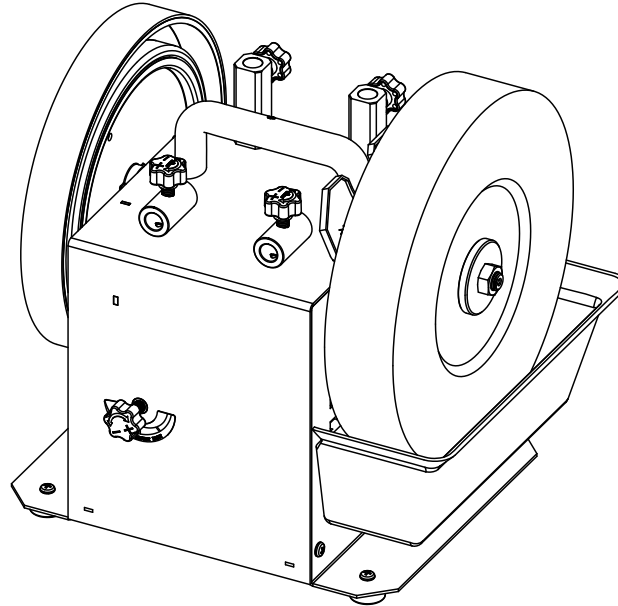

MODEL BG9910

10" WATER-COOLED SHARPENING SYSTEM



For replacement parts visit
WENPRODUCTS.COM

S1E-JS-250



IMPORTANT:

Your new tool has been engineered and manufactured to WEN's highest standards for dependability, ease of operation, and operator safety. When properly cared for, this product will supply you years of rugged, trouble-free performance. Pay close attention to the rules for safe operation, warnings, and cautions. If you use your tool properly and for its intended purpose, you will enjoy years of safe, reliable service.

NEED HELP? CONTACT US!

Have product questions? Need technical support?
Please feel free to contact us at:



800-232-1195 (M-F 8am-5pm CST)



techsupport@wenproducts.com



WENPRODUCTS.COM



NOTICE: Please refer to wenproducts.com for the most up-to-date instruction manual.

TABLE OF CONTENTS

Specifications	2
Introduction	3
General Safety Rules	4
Specific Rules For Sharpeners	5
Electrical Information	8
Know Your Sharpener	9
Assembly & Adjustments	10
Operation	15
Maintenance	17
Exploded View & Parts List	20
Troubleshooting Guide	22
Warranty Statement	23

SPECIFICATIONS

Model Number	BG9910
Motor	120V AC, 60 Hz, 1.25A
Wheel Speed	120 RPM
Sharpening Wheel Size	10 x 2 in. (250 x 50 mm)
Sharpening Wheel Grit	220-Grit
Leather Stropping Wheel Size	9 x 1-3/16 in. (230 x 30 mm)
Arbor Diameter	12 mm
Product Net Weight	31.2 lbs
Assembled Dimensions	13-3/8 x 10-1/2 x 12-7/8 in.

Compatible with the WEN 42704A 4-Piece Sharpening Accessory Kit,
available at wenproducts.com

INTRODUCTION

Thanks for purchasing the WEN Sharpener. We know you are excited to put your tool to work, but first, please take a moment to read through the manual. Safe operation of this tool requires that you read and understand this operator's manual and all the labels affixed to the tool. This manual provides information regarding potential safety concerns, as well as helpful assembly and operating instructions for your tool.



SAFETY ALERT SYMBOL: Indicates danger, warning, or caution. The safety symbols and the explanations with them deserve your careful attention and understanding. Always follow the safety precautions to reduce the risk of fire, electric shock and personal injury. However, please note that these instructions and warnings are not substitutes for proper accident prevention measures.

NOTE: The following safety information is not meant to cover all possible conditions and situations that may occur. WEN reserves the right to change this product and specifications at any time without prior notice.

Keep this manual available to all users during the entire life of the tool and review it frequently to maximize safety for both yourself and others.

GENERAL SAFETY RULES

Safety is a combination of common sense, staying alert and knowing how your item works. SAVE THESE SAFETY INSTRUCTIONS.



WARNING: Read and understand all warnings, cautions and operating instructions before using this tool. Failure to follow all instructions listed below may result in personal injury and tool damage.

WORK AREA SAFETY

1. Keep work area clean and well lit. Cluttered or dark areas invite accidents.
2. Do not operate power tools in explosive atmospheres, such as in the presence of flammable liquids, gases or dust. Power tools create sparks which may ignite the dust or fumes.
3. Do not expose power tools to rain or wet conditions (except for the water reservoir and grinding wheel). Water entering a power tool will increase the risk of electric shock.
4. Keep children and bystanders away while operating a power tool. Distractions can cause you to lose control.

ELECTRICAL SAFETY

1. Power tool plugs must match the outlet. Never modify the plug in any way. Do not use any adapter plugs with earthed (grounded) power tools. Unmodified plugs and matching outlets will reduce risk of electric shock.
2. Avoid body contact with earthed or grounded surfaces such as pipes, radiators, ranges and refrigerators. There is an increased risk of electric shock if your body is earthed or grounded.
3. Do not abuse the cord. Never use the cord for carrying, pulling or unplugging the power tool. Keep cord away from heat, oil, sharp edges or moving parts. Damaged or entangled cords increase the risk of electric shock.
4. If operating a power tool in a damp location is unavoidable, use a ground fault circuit interrupter (GFCI) protected supply. Use of a GFCI reduces the risk of electric shock.

PERSONAL SAFETY

1. Stay alert, watch what you are doing and use common sense when operating a power tool. Do not use a power tool while you are tired or under the influence of drugs, alcohol or medication. A moment of inattention while operating power tools may result in serious personal injury.
2. Use personal protective equipment. Always wear eye protection. Protective equipment such as a dust mask, non-skid safety shoes and hearing protection used for appropriate conditions will reduce the risk of personal injury.
3. Dress properly. Do not wear loose clothing or jewelry. Keep your hair, clothing and gloves away from moving parts. Loose clothes, jewelry or long hair can be caught in moving parts.

GENERAL SAFETY RULES

4. Prevent unintentional starting. Ensure the switch is in the off-position before connecting to power source and/or battery pack, picking up or carrying the tool. Carrying power tools with your finger on the switch or energizing power tools that have the switch on invites accidents.
5. Remove any adjusting key or wrench before turning the power tool on. A wrench or a key left attached to a rotating part of the power tool may result in personal injury.
6. Do not overreach. Keep proper footing and balance at all times. This enables better control of the power tool in unexpected situations.
7. If devices are provided for the connection of dust extraction and collection facilities, ensure these are connected and properly used. Use of dust collection can reduce dust-related hazards.

POWER TOOL USE AND CARE

1. Do not force the power tool. Use the correct power tool for your application. The correct power tool will do the job better and safer at the rate for which it was designed.
2. Do not use the power tool if the switch does not turn it on and off. Any power tool that cannot be controlled with the switch is dangerous and must be repaired.
3. Disconnect the plug from the power source and/or the battery pack from the power tool before making any adjustments, changing accessories, or storing power tools. Such preventive safety measures reduce the risk of starting the power tool accidentally.
4. Store idle power tools out of the reach of children and do not allow persons unfamiliar with the power tool or these instructions to operate the power tool. Power tools are dangerous in the hands of untrained users.
5. Maintain power tools. Check for misalignment or binding of moving parts, breakage of parts and any other condition that may affect the power tool's operation. If damaged, have the power tool repaired before use. Many accidents are caused by poorly maintained power tools.
6. Use the power tool, accessories and tool bits etc. in accordance with these instructions, taking into account the working conditions and the work to be performed. Use of the power tool for operations different from those intended could result in a hazardous situation.

SERVICE

Have your power tool serviced by a qualified repair person using only identical replacement parts. This will ensure that the safety of the power tool is maintained.

SPECIFIC RULES FOR SHARPENERS

 **WARNING:** Do not let comfort or familiarity with the product replace strict adherence to product safety rules. Failure to follow the safety instructions may result in serious personal injury.

1. **TOOL PURPOSE.** This sharpener is designed for sharpening and honing cutting tools, using the appropriate accessories. Using the machine for any other purpose for which it is not designed may result in serious injuries, machine damage and voiding of the warranty.
2. **DANGER: FIRE HAZARD.** Do not grind or polish magnesium or magnesium alloys.
3. **PERSONAL SAFETY.** Always wear ANSI Z87.1-approved glasses with side shields, hearing protection and a dust mask. **DO NOT** wear loose clothing or jewelry as they might get drawn in by the tool. Tie back long hair.
4. **OPERATING ENVIRONMENT.** Never grind near flammable gas or liquids. Sparks may ignite any such substances nearby.
5. **ELECTRIC CORDS.** Keep cords away from heat, oil, sharp edges, and moving parts of the tool. Have an electrician replace or repair damaged or worn cords immediately.
6. **TOOL & ACCESSORIES INSPECTION.** Before operation, check the tool and accessories for any damage or missing parts. Do not use the tool if any part is missing or damaged.
7. **TOOL ASSEMBLY.** Do not operate this tool until it is completely assembled and installed according to the instructions. Make sure all adjustments are correct and all connections are tight. Keep all guards in place.
8. **PREVENTING ACCIDENTAL STARTING.** Make sure the power switch is in the OFF position prior to plugging in the machine. Always make sure the power switch is in the OFF position and the machine is unplugged when doing any cleaning, adjustments, assembly, setup operations, or when not in use.
9. **GRINDING WHEEL SAFETY**
 - Only use grinding wheels rated for a speed higher than 120 RPM (maximum RPM of the tool).
 - Inspect wheels for cracks or fragments before starting the machine. Replace damaged wheels immediately. Never use a questionable grinding wheel, as the RPM of the machine can send broken wheel fragments flying at high speeds.
 - Do not use a wheel that vibrates. If a wheel vibrates, it may be that the bearings of the shaft need replacing .
 - Make sure the grinding wheel is dressed properly and evenly.
 - Check that the grinding stone can rotate smoothly before starting the machine.
 - The grinding wheel is for grinding. Never attempt to cut anything with the grinding wheel.
10. **WATER RESERVOIR.** Make sure the water reservoir is filled with water to the maximum fill line before operation. Check the water level regularly and refill as necessary. Never attempt to sharpen a blade when the grinding stone is dry.

SPECIFIC RULES FOR SHARPENERS

11. **STARTING UP.** Never start the machine with any load already applied to either grinding wheel. Stand to the side of the sharpener during start-up. Switch it ON and let the sharpener reach full speed for roughly one minute to warm up the wheel and to ensure proper operation.

12. **NEVER GRIND ON A COLD WHEEL.** Run the sharpener for one full minute before applying the workpiece. Cold wheels have an increased likelihood of chipping during operation.

13. Only grind on the face of the grinding wheel. Do not grind on the side of the wheel.

14. **KEEP CLEAR OF MOVING PARTS.** Keep arms, hands and other vital appendages away from the grinding and honing wheel. Do not reach behind or beneath the rotating wheel. Avoid awkward operation and hand positions. An accident could easily send the operator's hand into the wheel.

15. **DISCONNECT THE POWER SOURCE** and allow the wheels to come to a complete stop before making any adjustments to either the machine or the grinding wheels.

16. **CLEANING.** Clean the machine thoroughly when changing material types in workpieces. Combining certain materials can increase the chances of an explosion or fire hazard.

17. **SERVICING AND REPLACEMENTS.** Should any component of your sharpener be missing/damaged or fail in any way, shut off the switch and remove the plug from power supply outlet. Have a certified technician replace the missing, damaged, or failed parts using only identical replacement parts before resuming operation.

CALIFORNIA PROPOSITION 65 WARNING

Some dust created by power sanding, sawing, grinding, drilling, and other construction activities may contain chemicals, including lead, known to the State of California to cause cancer, birth defects, or other reproductive harm. Wash hands after handling. Some examples of these chemicals are:

- Lead from lead-based paints.
- Crystalline silica from bricks, cement, and other masonry products.
- Arsenic and chromium from chemically treated lumber.

Your risk from these exposures varies depending on how often you do this type of work. To reduce your exposure to these chemicals, work in a well-ventilated area with approved safety equipment such as dust masks specially designed to filter out microscopic particles.

These safety instructions can't possibly warn of every scenario that may arise with this tool, so always make sure to stay alert and use common sense during operation.

ELECTRICAL INFORMATION

GROUNDING INSTRUCTIONS

This tool is equipped with an electric cord that has an equipment grounding conductor and a grounding plug. In the event of a malfunction or breakdown, grounding provides the path of least resistance for an electric current and reduces the risk of electric shock. The plug must be plugged into a matching outlet that is properly installed and grounded in accordance with all local codes and ordinances (Fig. A).

1. USE ONLY THREE-WIRE EXTENSION CORDS that have three-pronged plugs and outlets that accept the tool's plug as shown in Fig. A. Do not modify the plug provided. If it will not fit the outlet, have the proper outlet installed by a licensed electrician.

2. IMPROPER CONNECTION of the equipment grounding conductor can result in electric shock. The conductor with the green insulation (with or without yellow stripes) is the equipment grounding conductor. If repair or replacement of the electric cord or plug is necessary, do not connect the equipment grounding conductor to a live terminal.

3. Repair or replace a damaged or worn cord immediately. Servicing of electrical components should only be done by a certified electric technician.

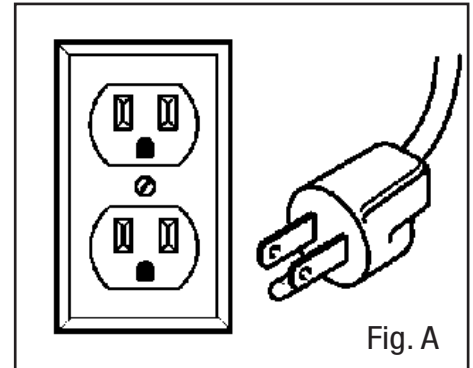

IMPORTANT: Check with a licensed electrician or service personnel if you do not completely understand the grounding instructions or whether the tool is properly grounded.

GUIDELINES AND RECOMMENDATIONS FOR EXTENSION CORDS

When using an extension cord, be sure to use one heavy enough to carry the current your product will draw. An undersized cord will cause a drop in line voltage resulting in loss of power and overheating. The table below shows the correct size to be used according to cord length and ampere rating. When in doubt, use a heavier cord. The smaller the gauge number, the heavier the cord.

AMPERAGE	REQUIRED GAUGE FOR EXTENSION CORDS			
	25 ft.	50 ft.	100 ft.	150 ft.
1.25A	18 gauge	16 gauge	16 gauge	14 gauge

1. EXAMINE EXTENSION CORD BEFORE USE. Make sure your extension cord is properly wired and in good condition. Always replace a damaged extension cord or have it repaired by a qualified person before using it.

2. DO NOT ABUSE EXTENSION CORD. Do not pull on cord to disconnect from receptacle; always disconnect by pulling on plug. Disconnect the extension cord from the receptacle before disconnecting the product from the extension cord. Protect your extension cords from sharp objects, excessive heat and damp/wet areas.

3. USE A SEPARATE ELECTRICAL CIRCUIT FOR YOUR TOOL. This circuit must not be less than a 12-gauge wire and should be protected with a 15A time-delayed fuse. Before connecting the motor to the power line, make sure the switch is in the OFF position and the electric current is rated the same as the current stamped on the motor nameplate. Running at a lower voltage will damage the motor.

KNOW YOUR SHARPENER

UNPACKING

Carefully remove the sharpener from the packaging. Make sure to take out all contents and accessories. Check your packing list against the diagram below. If any part is damaged or missing, please contact our customer service at (800) 232-1195, M-F 8-5 CST or email us at techsupport@wenproducts.com. Do not discard the packaging until the sharpener is completely assembled.

INTENDED USE

This sharpener features a 10-inch grinding wheel and a 9-inch leather stropping wheel for sharpening and polishing dull blades, wood chisels, knives, scissors, carving tools, axes and more. Make sure follow the instructions on the following pages for proper assembly and use the suitable jig for sharpening your tools.

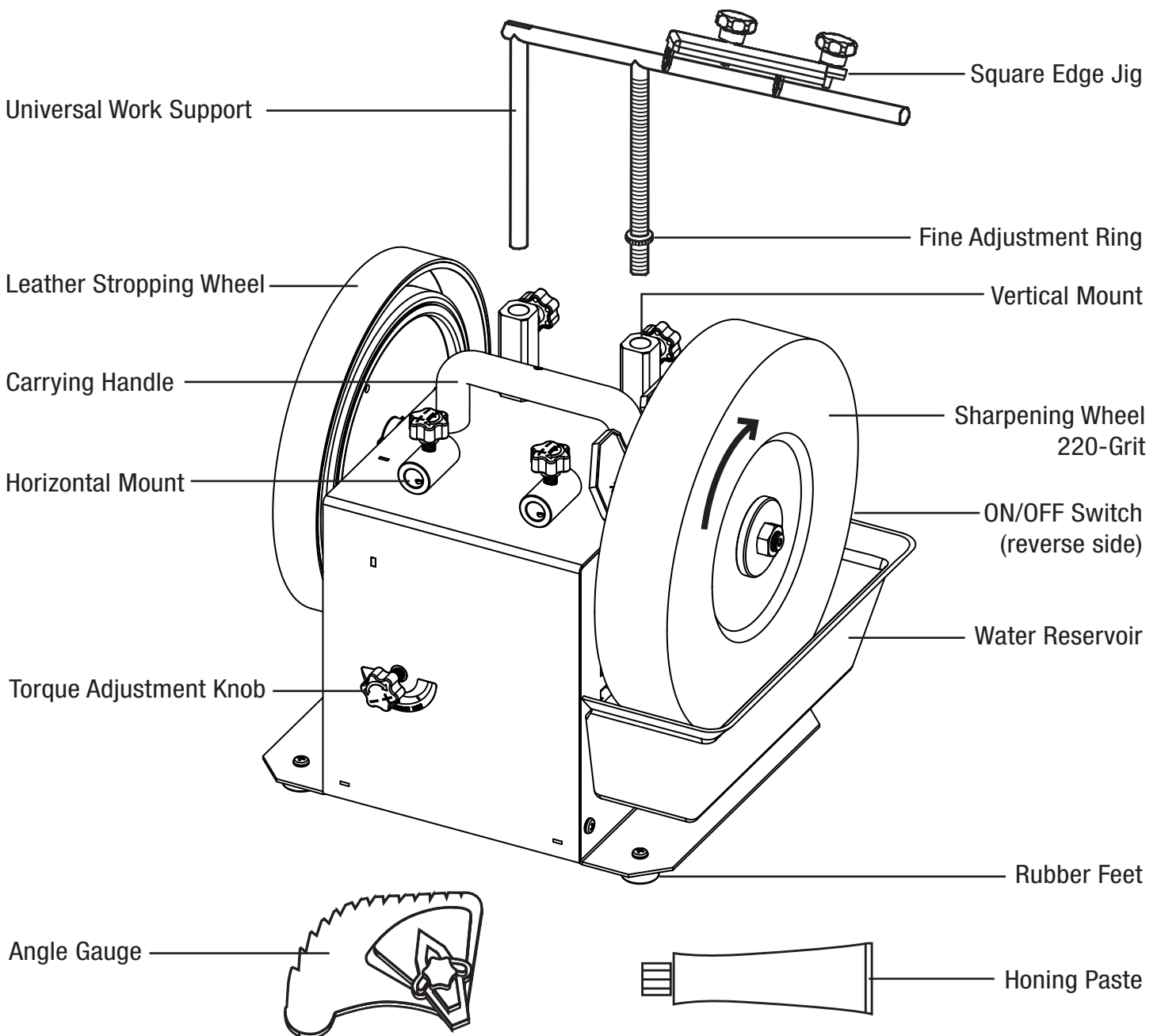

ASSEMBLY & ADJUSTMENTS

⚠ WARNING: To prevent accidental starting, make sure the machine is switched OFF and the power plug is disconnected before assembly, setting up or making adjustments.

POSITIONING THE MACHINE

Place the machine on a stable, flat work surface. The machine has four rubber feet pre-installed to increase stability and reduce vibration. Make sure there is sufficient open space around the machine. Route the power cord so that it will not make contact with the sharpener's moving parts.

INSTALLING THE GRINDING WHEEL

A 220-grit grinding wheel is included with your sharpener, and needs to be installed. Check the grinding wheel regularly to make sure that it is free of damage or cracks.

1. Slide the inner washer (Fig. 1 - 1) onto the spindle, with the washer's flange facing away from the body of the machine.
2. Install the grinding wheel (Fig. 1 - 2) onto the spindle, with the depressed center facing away from the body of the machine.
3. Slide the outer washer (Fig. 1 - 3) onto the spindle, with the flange facing the grinding wheel.
4. Install the locking nut (Fig. 1 - 4). Tighten it using a 19mm wrench or socket.
5. Rotate the grinding wheel by hand a few turns to check that the wheel is balanced and rotates smoothly.

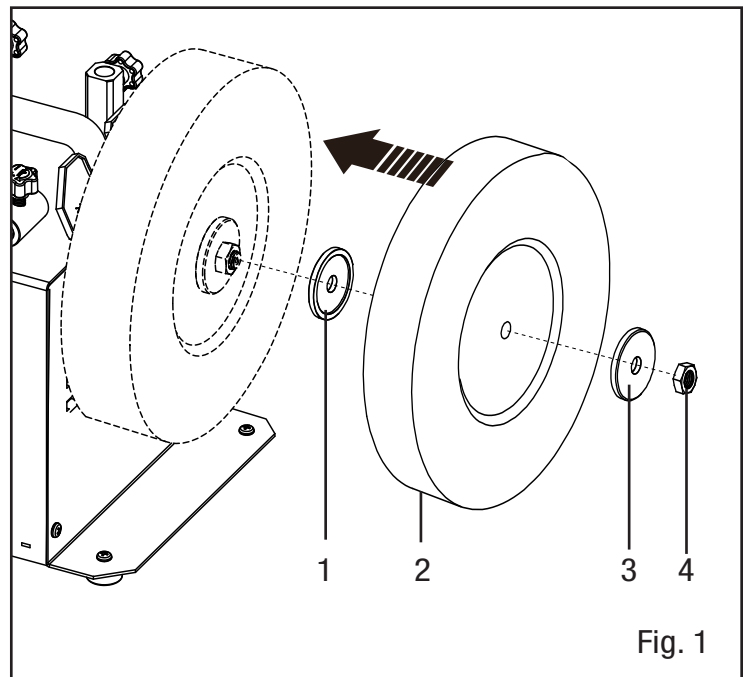

Fig. 1

INSTALLING THE WATER RESERVOIR

There are two mounting positions on the grinding wheel side of the machine for installing the water reservoir (Fig. 2).

With a new 10-inch grinding wheel installed, use the LOWER mounting slots. Place the lips of the container into the two lower mounting slots.

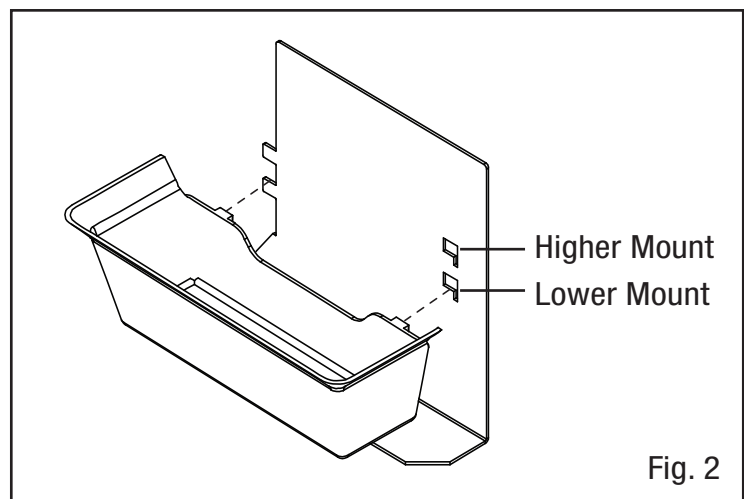

Fig. 2

Once the grinding wheel has been worn down to roughly 8 inches in diameter, move the water reservoir up to the HIGHER mounting slots. This will allow the wheel to make sufficient contact with the water in the reservoir.

ASSEMBLY & ADJUSTMENTS

INSTALLING THE WORK SUPPORT

The universal work support (Fig. 3 - 1) acts as both a work rest and as an attachment arm for various jigs. The work support can be installed either in the vertical (A) or horizontal (B) position. The diameter of the work support bar is 12 mm.

• Against wheel rotation

Working against the rotation of the blade removes larger amounts of material quickly. Use this method for shaping blades or sharpening axes.

To grind AGAINST the direction of the wheel rotation, place the work support in the VERTICAL mounts (A).

• Along wheel rotation

Working along the rotation of the blade is preferable for more precise jobs that require less material removal. For fine sharpening on tools such as knives, scissors, or other carving instruments, grind with the rotation of the wheel.

For grinding and honing ALONG the direction of the wheel rotation, place the work support in the horizontal mounts (B).

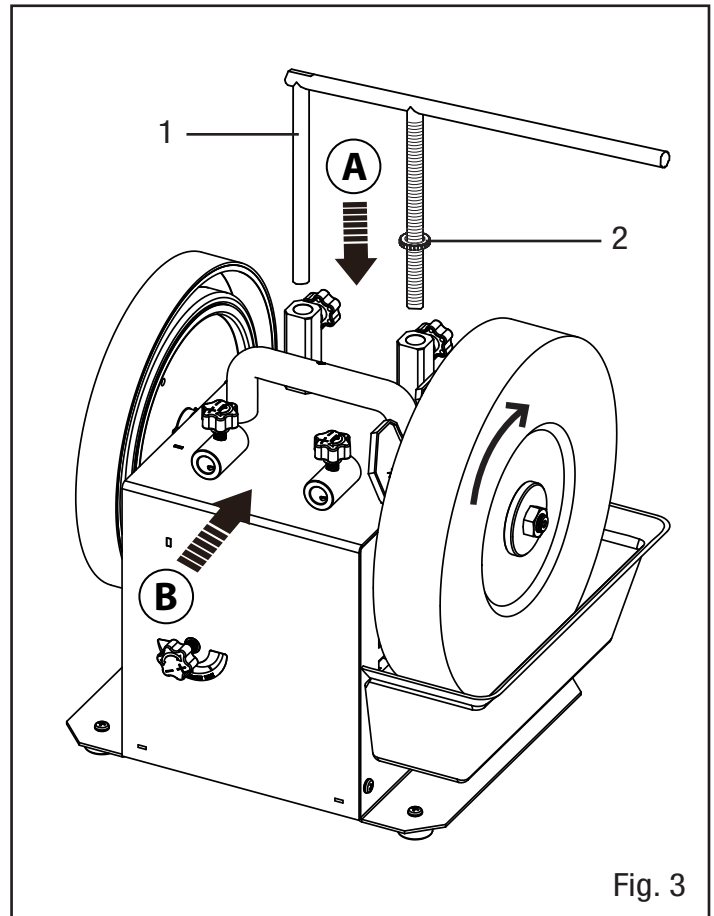

Fig. 3

CAUTION: For honing operations, the work support must be installed in the horizontal mounts (B).

To mount the work support:

1. Select the suitable position for mounting the work support. Orient the work support so that the support arm is extended over the wheel you'll be working with.
2. Loosen the mounting locking knobs and slide the work support into the mount bushings.
3. Adjust the height of the work support to fit your workpiece and operation. Refer to the instructions on page 13 for setting up the work support for your blade's bevel using the angle guide.
4. Use the fine adjustment ring (Fig. 3 - 2) on the threaded bar to make fine adjustments to the work support as necessary. Make sure the support arm is completely parallel and level with the face of the wheel, whether it be in the vertical or the horizontal position.
5. Secure the support in place by tightening both locking knobs.

ASSEMBLY & ADJUSTMENTS

⚠ WARNING: To prevent accidental starting, make sure the machine is switched OFF and the power plug is disconnected before assembly, setting up or making adjustments.

SETTING UP THE SQUARE EDGE JIG

The square edge jig included with your sharpener is designed to assist in sharpening chisels and planer blades.

1. To install the square edge jig, slide the square edge jig onto the work support arm (Fig. 4).
2. Loosen the locking knobs and place the blade in the jig so that one edge of the blade is positioned against the end stop (Fig. 5 - 1).
3. Tighten the lock knobs to secure the blade into position.
4. Follow the instructions on the next page for setting the sharpening angle of the blade using the angle guide.

USING THE WORK SUPPORT ARM AS A WORK REST

If the workpiece is too large to be mounted into the jig, you can rest it directly onto the support arm. This will help you balance the weight of the workpiece and keep it steady.

OTHER SHARPENING JIGS

To sharpen knives, scissors and axes, you'll need the **WEN 42704A** 4-Piece Sharpening Accessory Kit (Fig. 6), sold separately at wenproducts.com.

This kit includes a short knife jig, a long knife jig, a scissors jig, and an axe jig. Follow the instructions included with your accessory jig for assembly and operation.

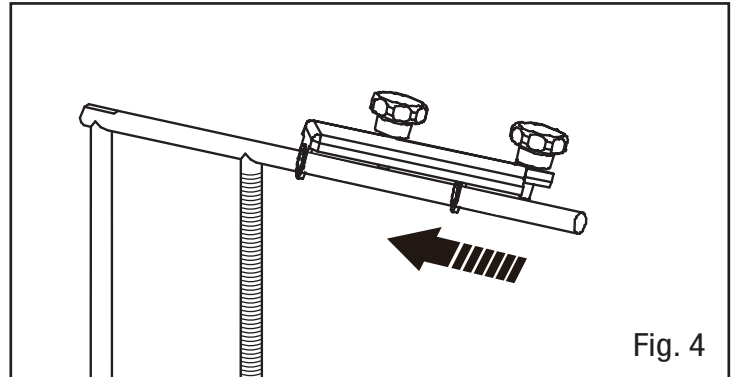

Fig. 4

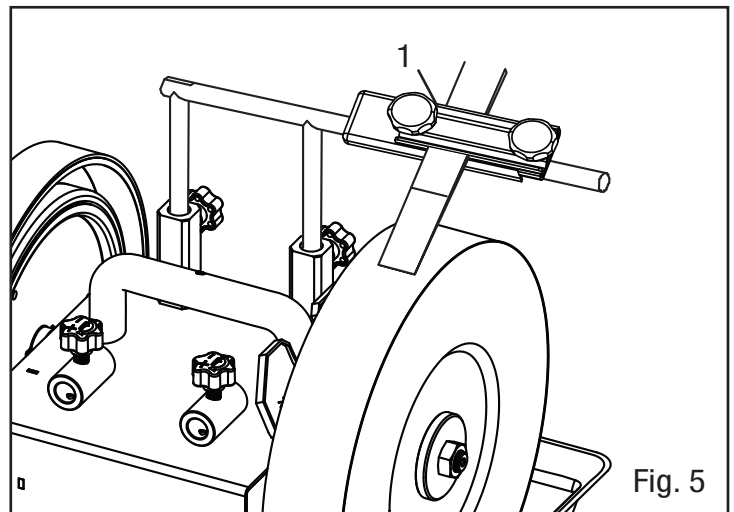

Fig. 5

WEN 42704A 4-Piece Sharpening Accessory Kit

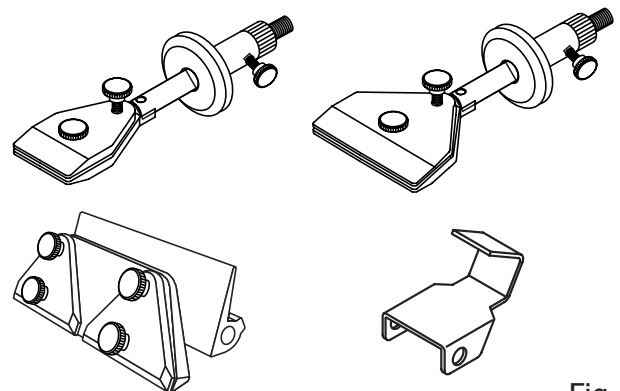
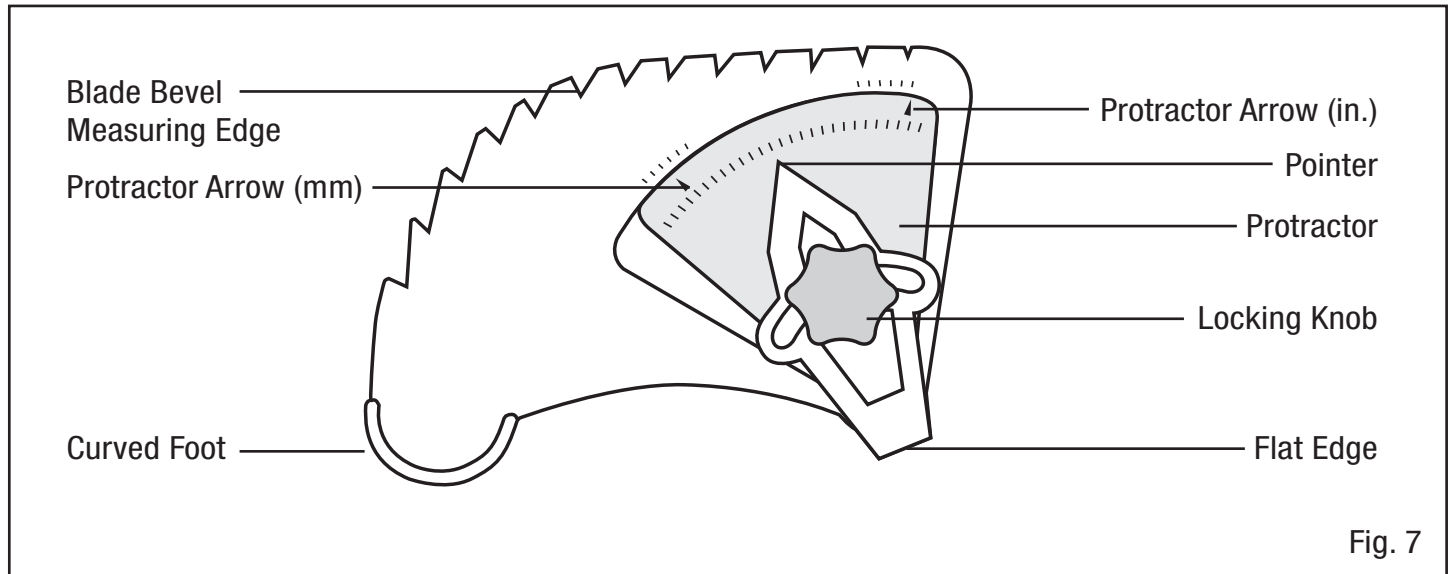

Fig. 6

ASSEMBLY & ADJUSTMENTS

SETTING THE ANGLE USING THE ANGLE GUIDE

Use the included angle guide (Fig. 7) to help set the correct angle for sharpening your tools.



1. Measure the bevel angle of your workpiece using the outside edge of the angle guide. Place the blade into each angle notch along the outside edge to find the notch that best fits the bevel of the blade.

2. Loosen the locking knob on the angle guide.

3. Measure the diameter of your grinding wheel. Adjust the protractor position so that the protractor arrows point to the correct wheel diameter indicated on the angle guide plate.

4. Set the pointer to the required bevel angle, as measured in step 1. Tighten the locking knob to lock the angle guide settings.

5. Mount the blade to be sharpened in the square edge jig, and slide the jig onto the support arm. Let the blade rest on the grinding wheel.

6. Position the curved foot of the angle guide on the grinding wheel. Place the flat edge of the pointer on the blade to be sharpened.

7. Adjust the height of the work support and the positioning of the blade until the flat edge of the angle guide pointer lies perfectly flat on the blade's surface (Fig. 8 - 1). The grinding angle is now correctly set.

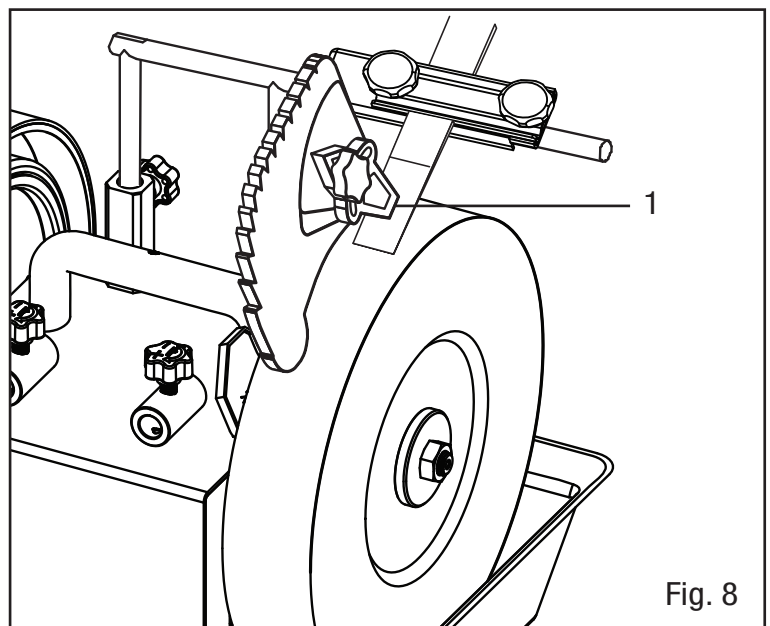

ASSEMBLY & ADJUSTMENTS

⚠ WARNING: To prevent accidental starting, make sure the machine is switched OFF and the power plug is disconnected before assembly, setting up or making adjustments.

FILLING THE WATER RESERVOIR

⚠ WARNING: This sharpener's grinding wheel is designed for wet grinding only. NEVER USE THE GRINDING WHEEL WITHOUT WATER.

1. Fill up the container with clean, cold water up to the "MAX WATER LEVEL" indicated on the inside of the reservoir (Fig. 9).

2. Check the water level before each use. Be sure the wheel is sufficiently wet before beginning any grinding operations.

TIP: Putting a magnet inside of the reservoir can collect metal filings as they fall into the water. This helps to prevent build-up of metal filaments on the grinding wheel.

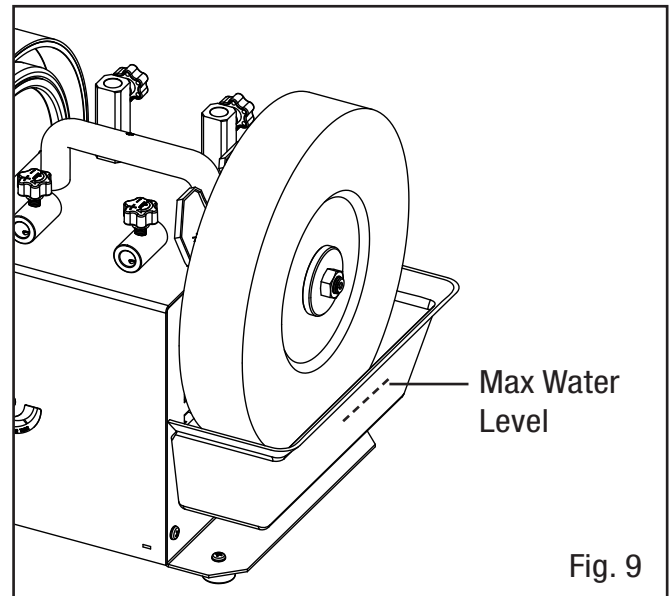

Fig. 9

CAUTION: Never leave the grinding wheel stored in water, as this will damage one side of the wheel, creating a lack of balance. Empty the water reservoir after each operation.

PREPARING THE STROPPING WHEEL

The leather stropping wheel is pre-installed on the machine. Follow the instructions below to prepare the stropping wheel before honing operations.

1. Slightly loosen the locking knob on the side of the stropping wheel. Turn the wheel by hand and apply a light machine oil evenly to the leather stropping wheel. Use enough to provide a thorough and even coat, but not so much as to dampen the wheel to the point of dripping oil.

2. Using a wooden spreader or other similarly purposed accessory (not included), apply the abrasive honing paste to the stropping wheel, covering the face with an even and thin layer.

3. Tighten the locking knob. Make sure the stropping wheel is securely installed.

4. After the initial layer has been placed, turn the machine ON and continue to evenly distribute the paste with the wooden spreader in light circular motions across the wheel. Once an even distribution has been reached, the stropping wheel is ready to hone.

OPERATION

⚠ WARNING: Do not plug in or turn on the tool until it is fully assembled according on the instructions. Failure to follow the safety instructions may result in serious personal injury.

ADJUSTING THE DRIVE SYSTEM TORQUE

1. Before each operation, tighten the torque adjustment knob (Fig. 10) by turning it clockwise until it is tight against the body of the sharpener. This will engage the driver system.

2. After each use, always loose the torque adjustment knob, by turning it counterclockwise. This will allow the drive wheel to retain its correct shape.

ON/OFF SWITCH WITH SAFETY KEY

The keyed ON/OFF switch (Fig. 11) is intended to prevent unauthorized use of the sharpener.

1. To turn the sander ON, insert the safety key into the key slot in the center of the switch. Push switch up to start the sharpener.

3. To turn the sander OFF, push switch down. Remove the safety key when the sharpener has come to a complete stop by gently pulling it out.

⚠ WARNING: Remove the safety key whenever the sander is not in use. Place the key in a safe place and out of the reach of children.

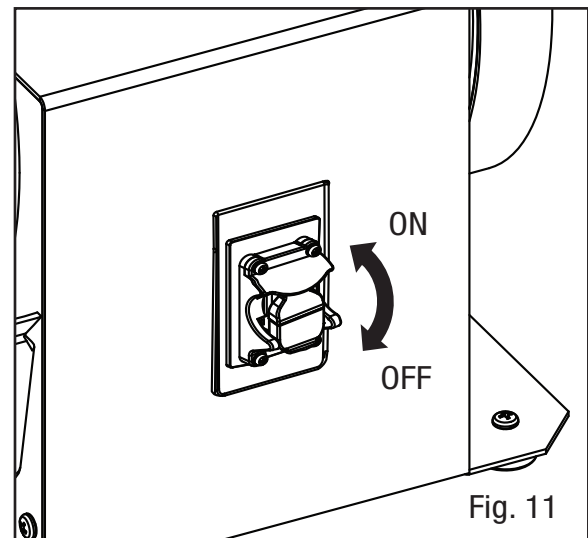
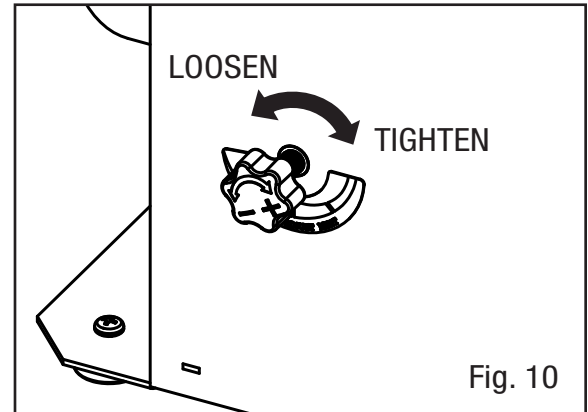

OPERATION CHECKLIST

Prior to starting your sharpener, check that the following requirements have been met:

- **Personal protection** - ANSI Z87.1-approved safety glasses, work-appropriate clothing and dust mask are being worn.
- **Grinding wheel** - the grinding wheel has been properly installed, and can be rotated smoothly by hand. The wheel surface is even. Refer to page 19 for dressing the grinding wheel as needed.
- **Work support set up** - the work support has been installed in the correct orientation, and has been adjusted using the angle guide to match the bevel angle of the blade.
- **Water reservoir** - the water reservoir has been installed in the suitable mounting position, and the water has been filled to the maximum fill line.
- **Tool mounting** - the workpiece is properly mounted in the appropriate jig; for larger workpieces, it can be rested directly onto the work support arm.

OPERATION

SHARPENING A BLADE

1. Stand to one side of the sharpener. Plug in and turn ON the machine. Let the grinding wheel run for about one minute to warm up, making sure it is rotating evenly.
2. Firmly grasp the tool to be sharpened with both hands. Make sure it is properly supported. Feed the blade into the grinding wheel with an even pressure.
3. Slide the tool back and forth along the support arm to ensure even grinding on the blade and even wear on the stone.

NOTE: Do not apply excessive pressure. Guide the blade with light pressure. Let the grinding wheel do the work.

CAUTION: Metal pieces become heated quickly during grinding, so make sure to move the work-piece back and forth to prevent overheating.

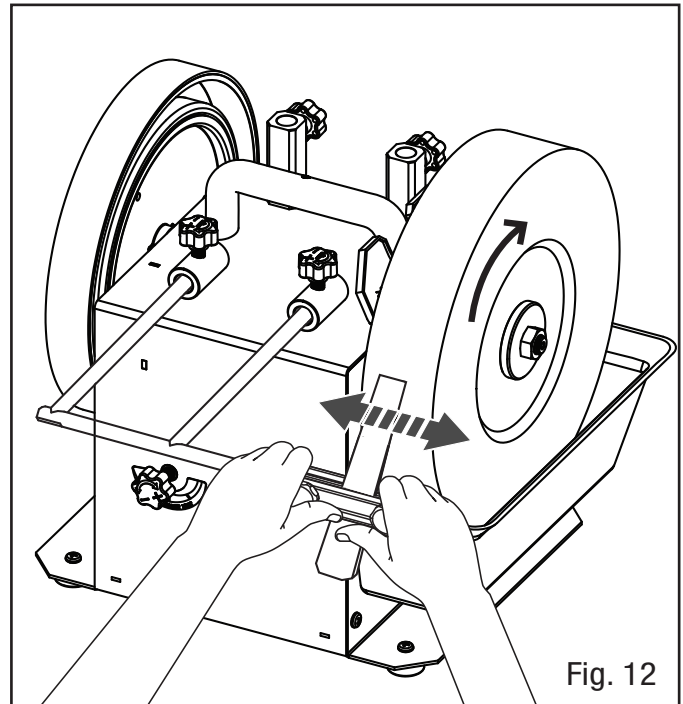

! **DANGER:** FIRE HAZARD. Do not grind or polish magnesium or magnesium alloys.

HONING A BLADE

After sharpening the blade, use the leather stropping wheel to remove burrs from the blade and create a smooth, sharp edge.

CAUTION: Always hone a blade WITH the direction of the wheel rotation. Never hone against the direction of the wheel. The work support must be installed in the horizontal mounts. Attempting the hone the blade against the direction of the wheel rotation will cause severe damage to the honing wheel.

1. Turn OFF and disconnect the tool from the power supply.
2. Set up the work support in the horizontal position. Use the angle guide to check the blade angle and adjust the work support as necessary (see page 13).
3. Make sure the stropping wheel is properly prepared according to the instructions on page 14.
4. Switch on the machine and move the blade back and forth evenly along the leather wheel (Fig. 13). Do not apply excessive force to the workpiece; allow the honing wheel to do the work.

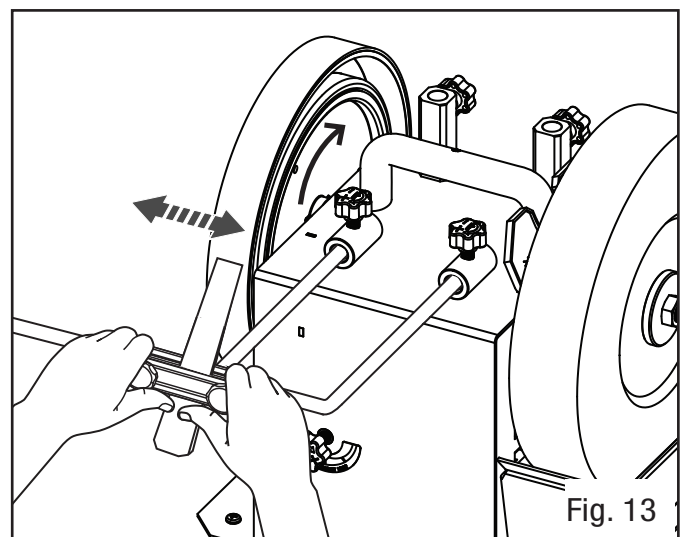

MAINTENANCE

 **WARNING:** To avoid accidents, turn OFF and unplug the tool from the electrical outlet before cleaning, adjusting, or performing any maintenance or lubrication work. Servicing of the tool must be performed by a qualified technician.

ROUTINE INSPECTION

Before each use, inspect the general condition of the tool. If any of these following conditions exist, do not use until parts are replaced or the sharpener is properly repaired.

Check for:

- Loose hardware or improper mounting (screws might come loose from vibration during operation),
- Misalignment or binding of moving parts,
- Damaged cord/electrical wiring,
- Cracked or broken parts, and
- Any other condition that may affect its safe operation

CLEANING

After every operation, wipe the tool surfaces clean with a soft cloth or brush. Make sure water does not get into the tool. Use a vacuum or low-pressure compressed air to remove dust and debris from the tool surfaces, motor housing and work area. Keep the ventilation openings free from dust to prevent the motor from overheating.

CAUTION: Most plastics are susceptible to damage from various types of commercial solvents. Do not use any solvents or cleaning products that could damage the plastic parts. Some of these include but are not limited to: gasoline, carbon tetrachloride, chlorinated cleaning solvents, and household detergents that contain ammonia.

WATER RESERVOIR

Periodically empty out the water reservoir. Rinse it of any metal filaments and refill it with clean water to prevent buildup on the wheel itself. Your cleaning schedule should depend on frequency of use.

Adjust the water reservoir mounting height to make sure water levels are always sufficient to keep the wheel wet during grinding operations.

MAINTENANCE

REPLACING THE GRINDING WHEEL

Grinding wheels should be inspected for any damage or cracking before each use. Store the grinding wheels to prevent them from the potential hazards of moisture, containments and other damage. Replacement 10-inch grinding wheels (**part no. BG9910-050**) can be purchased from wenproducts.com.

To replace a grinding wheel:

1. Turn OFF and disconnect the sharpener from the power supply.
2. Hold the grinding wheel to prevent it from rotating. Remove the arbor locking nut (Fig. 14 - 1) that is holding the wheel in place. The nut is left-hand threaded.
3. Remove the outer washer (Fig. 14 - 2) and then remove the wheel. Set the washer aside.
4. Install the new grinding wheel (Fig. 14 - 3), with the depressed center facing away from the body of the sharpener. Reinstall the washer (flange facing the wheel) and locking nut. Tighten the locking nut using the wrench.
5. Rotate the grinding wheel by hand a few turns to check that the wheel is balanced and rotates smoothly.

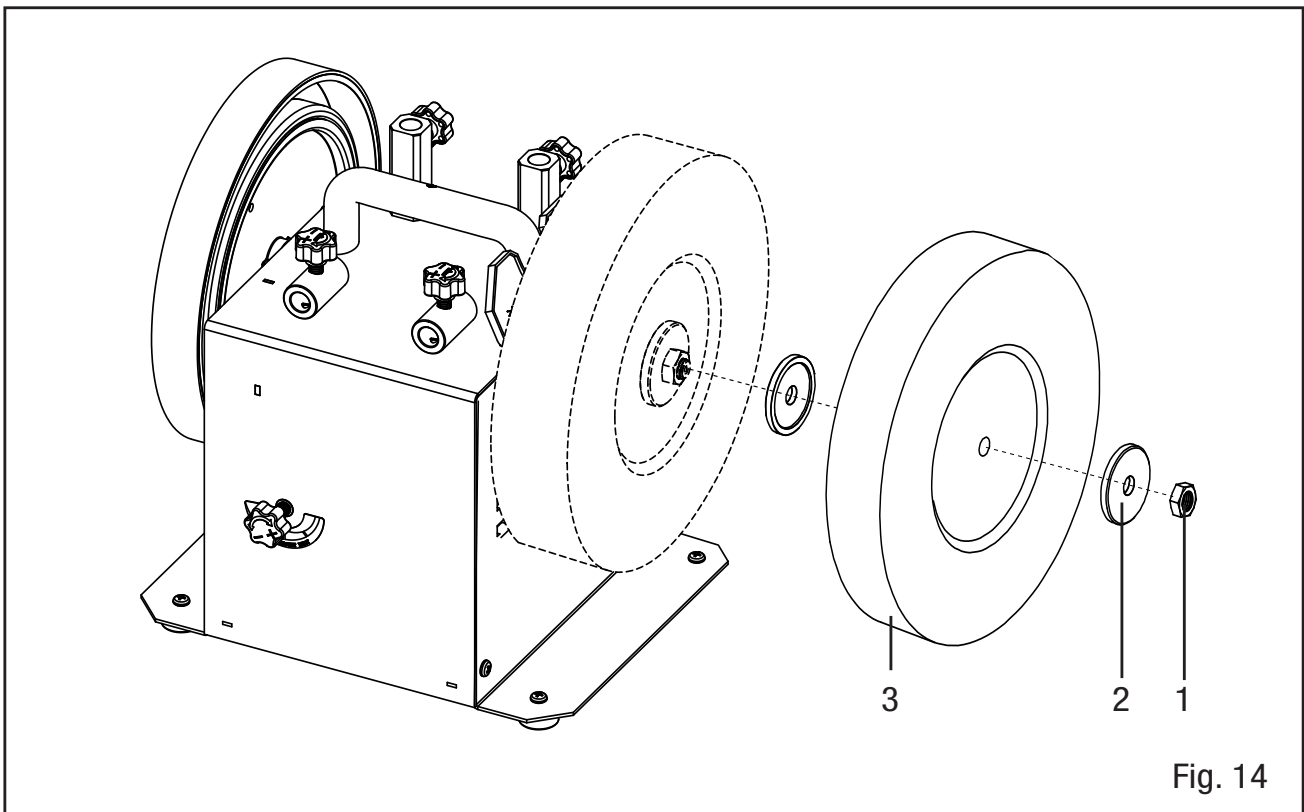

Fig. 14

MAINTENANCE

GRINDING WHEEL DRESSING

Dress the grinding wheel periodically using dressing tools (sold separately) to restore or adjust the wheel's abrasiveness. Follow the instructions that are included with your dressing tools and accessories to properly dress the grinding wheel.

Using a dressing stone with a coarse face and smooth face:

- To remove larger amount of materials quickly, dress the wheel for coarse grinding. Apply the coarse face of the dressing stone to the grinding wheel to roughen the wheel's surface.
- For fine grinding, apply the smooth face of the dressing stone to the grinding wheel to create a finer surface.

REPLACING THE STROPPING WHEEL

Inspect the leather stropping wheel for any damage or wear before each use. If the leather stropping wheel becomes damaged or worn, replace it as follows. Replacement 9-inch leather stropping wheels (**part no. BG9910-034**) can be purchased from wenproducts.com.

1. Unscrew the locking knob (Fig. 15 - 1).
2. Remove the stropping wheel (Fig. 15 - 2) from the spindle. Replace it with a new stropping wheel.
3. Re-install the locking knob and tighten it by hand.

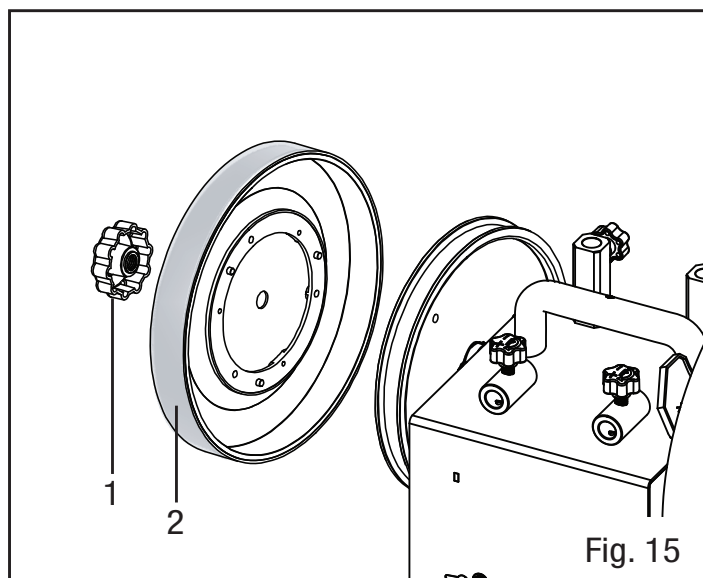

STORAGE

Always empty the water reservoir, clean the machine according to the instructions and wait for the grinding wheel to dry completely before storage. **DO NOT** store the machine with a wet or damp grinding wheel.

Store the tool and accessories in a warm, clean and dry place away from the reach of children.

PRODUCT DISPOSAL

Used power tools should not be disposed of together with household waste. This product contains electronic components that should be recycled. Please take this product to your local recycling facility for responsible disposal and to minimize its environmental impact.

EXPLODED VIEW & PARTS LIST

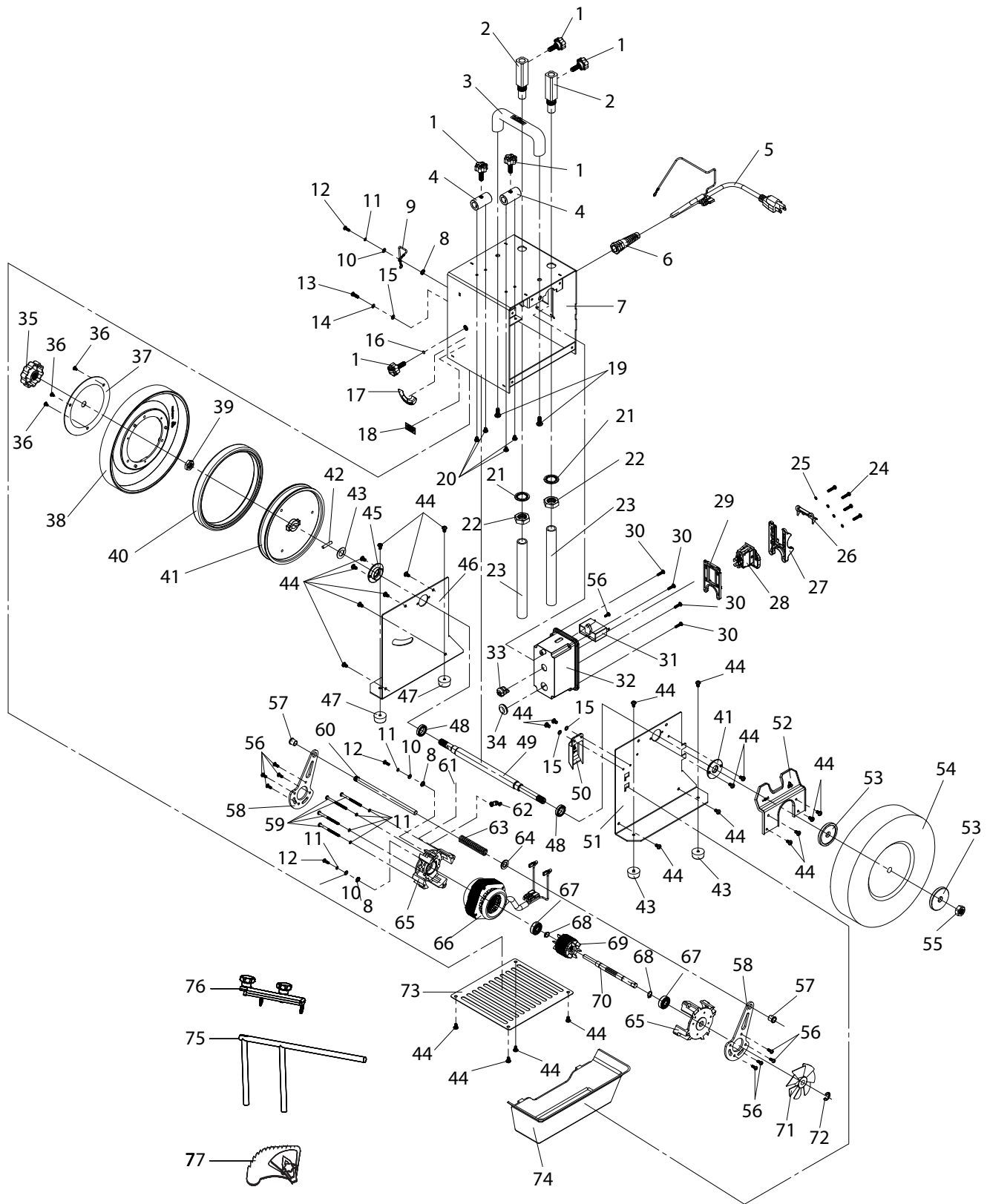

NOTE: Replacement parts can be purchased from wenproducts.com, or by calling our customer service at (800) 232-1195, M-F 8-5 CST. Parts and accessories that wear down over the course of normal use (e.g. grinding wheels, water reservoir, carbon brushes, etc.) are not covered by the two-year warranty.

EXPLODED VIEW & PARTS LIST

No.	Part No.	Description	Qty.
1	BG9910-001	Mount Locking Knob	5
2	BG9910-002	Vertical Mount Bushing	2
3	BG9910-003	Carrying Handle	1
4	BG9910-004	Horizontal Mount Bushing	2
5	BG9910-005	Power Cord & Plug	1
6	BG9910-006	Power Cord Protector	1
7	BG9910-007	Housing	1
8	BG9910-008	External Tooth Lock Washer M5	3
9	BG9910-009	Grounding Wire	1
10	BG9910-010	Flat Washer M4	3
11	BG9910-011	Spring Washer M4	7
12	BG9910-012	Screw M4x12	3
13	BG9910-013	Screw M5x15	1
14	BG9910-014	Spring Washer M5	1
15	BG9910-015	Flat Washer M5	3
16	BG9910-016	Rubber Washer	1
17	BG9910-017	Rotating Direction Label	1
18	BG9910-018	Warning Label	1
19	BG9910-019	Screw M6x16	2
20	BG9910-020	Screw M5x6	4
21	BG9910-021	Internal Tooth Lock Washer M18	2
22	BG9910-022	Thin Nut M18	2
23	BG9910-023	Plastic Tube	2
24	BG9910-024	Screw M4x10	4
25	BG9910-025	Spring Washer M4	4
26	BG9910-026	Switch Plate Cover	1
27	BG9910-027	Switch Plate, Front	1
28	BG9910-028	ON/OFF Switch	1
29	BG9910-029	Switch Plate, Rear	1
30	BG9910-030	Screw ST4.2x16	4
31	BG9910-031	Capacitor	1
32	BG9910-032	Capacitor Box	1
33	BG9910-033	Power Cord Holder	1
34	BG9910-034	Protective Ring	1
35	BG9910-035	Lock Knob	3
36	BG9910-036	Screw ST4.2x6	3
37	BG9910-037	Stropping Wheel Cover	1
38	BG9910-038	Leather Stropping Wheel	1

No.	Part No.	Description	Qty.
39	BG9910-039	Thin Nut M12	1
40	BG9910-040	Stropping Wheel Drive Belt	1
41	BG9910-041	Stropping Wheel Drive Disc	1
42	BG9910-042	Pin, A5x25	1
43	BG9910-043	Flat Washer M12	1
44	BG9910-044	Screw M5x8	22
45	BG9910-045	Bearing Housing Cover	1
46	BG9910-046	Right Cover	1
47	BG9910-047	Rubber Foot	4
48	BG9910-048	Bearing 6802	2
49	BG9910-049	Output Shaft	1
50	BG9910-050	Left Housing Cover	1
51	BG9910-051	Left Board	1
52	BG9910-052	Plastic Baffle	1
53	BG9910-053	Grinding Wheel Washer	2
54	BG9910-054	Grinding Wheel	1
55	BG9910-055	Left-Hand Threaded Nut	1
56	BG9910-056	Screw M4x10	9
57	BG9910-057	Motor Mounting Stem Cap	2
58	BG9910-058	Motor Mounting Guide Plate	2
59	BG9910-059	Screw M4x55	4
60	BG9910-060	Motor Mounting Stem	1
62	BG9910-062	Motor Tension Spring	1
63	BG9910-063	Motor Mounting Spring	1
64	BG9910-064	Flat Washer M10	1
65	BG9910-065	Motor Front Cover	2
66	BG9910-066	Stator	1
67	BG9910-067	Bearing 6000	2
68	BG9910-068	Motor Shaft Circlip	2
69	BG9910-069	Rotor	1
70	BG9910-070	Rotor Spindle	1
71	BG9910-071	Rotor Fan	1
72	BG9910-072	Split Baffle Ring10	1
73	BG9910-073	Base Plate	1
74	BG9910-074	Water Reservoir	1
75	BG9910-075	Universal Support	1
76	BG9910-076	Square Edge Jig	1
77	BG9910-077	Angle Gauge	1
78	BG9910-078	Honing Paste (Not pictured)	1

TROUBLESHOOTING GUIDE

⚠ WARNING: Stop using the tool immediately if any of the following problems occur. Repairs and replacements should only be performed by an authorized technician. For any questions, please contact our customer service at (800) 232-1195, M-F 8-5 CST or email us at techsupport@wenproducts.com.

PROBLEM	CAUSE	SOLUTION
The motor won't start	<ol style="list-style-type: none"> 1. Power cord or extension cord damaged or not properly plugged in. 2. Safety key is removed from power switch. 3. Defective power switch, defective motor or wiring, short circuit or loose connections. 	<ol style="list-style-type: none"> 1. Check the power cord, extension cord, power plug and the power outlet. Make sure the tool is properly plugged in. Do not use the if any cord is damaged. 2. Insert the safety key into the power switch. 3. Stop using the tool and contact customer service at (800) 232-1195, M-F 8-5 CST for assistance. Repairs must be done by a qualified technician.
Motor overheats	<ol style="list-style-type: none"> 1. Motor overloaded. 2. Extension cord too long with an insufficient gauge. 	<ol style="list-style-type: none"> 1. Reduce load on motor - reduce pressure on the workpiece 2. Utilize an extension cord of appropriate gauge and length or plug tool directly into outlet (see page 8).
Grinding Wheel not rotating smoothly or evenly	<ol style="list-style-type: none"> 1. Wheel not installed properly 2. Wheel worn out or not balanced 3. Spindle is not straight 	<ol style="list-style-type: none"> 1. Re-install the wheel according to the instructions on page 18. 2. Replace it with a new wheel. 3. Stop using the tool and contact customer service at (800) 232-1195, M-F 8-5 CST for assistance. Repairs must be done by a qualified technician.
Stropping wheel performance decreases	<ol style="list-style-type: none"> 1. Insufficient wheel preparation (lack of oil and honing paste) 2. Damaged wheel 	<ol style="list-style-type: none"> 1. Prepare the wheel according to the instructions on page 14. 2. Replace the wheel with a new one.
Wavy finish on the surface of a workpiece	<ol style="list-style-type: none"> 1. Machine is vibrating 2. Workpiece isn't held in place firmly 3. Wheel face uneven 	<ol style="list-style-type: none"> 1. Make sure the machine is securely positioned on a level surface. 2. Use a holding device to firmly retain the workpiece. 3. Dress the grinding wheel.

WARRANTY STATEMENT

WEN Products is committed to building tools that are dependable for years. Our warranties are consistent with this commitment and our dedication to quality.

LIMITED WARRANTY OF WEN CONSUMER POWER TOOLS PRODUCTS FOR HOME USE

GREAT LAKES TECHNOLOGIES, LLC (“Seller”) warrants to the original purchaser only, that all WEN consumer power tools will be free from defects in material or workmanship for a period of two (2) years from date of purchase. Ninety days for all WEN products if the tool is used for professional or commercial use.

SELLER’S SOLE OBLIGATION AND YOUR EXCLUSIVE REMEDY under this Limited Warranty and, to the extent permitted by law, any warranty or condition implied by law, shall be the repair or replacement of parts, without charge, which are defective in material or workmanship and which have not been misused, carelessly handled, or misrepaired by persons other than Seller or Authorized Service Center. To make a claim under this Limited Warranty, you must make sure to keep a copy of your proof of purchase that clearly defines the Date of Purchase (month and year) and the Place of Purchase. Place of purchase must be a direct vendor of Great Lakes Technologies, LLC. Third party vendors such as garage sales, pawn shops, resale shops, or any other secondhand merchant void the warranty included with this product. Contact techsupport@wenproducts.com or 1-800-232-1195 to make arrangements for repairs and transportation.

When returning a product for warranty service, the shipping charges must be prepaid by the purchaser. The product must be shipped in its original container (or an equivalent), properly packed to withstand the hazards of shipment. The product must be fully insured with a copy of the warranty card and/or the proof of purchase enclosed. There must also be a description of the problem in order to help our repairs department diagnose and fix the issue. Repairs will be made and the product will be returned and shipped back to the purchaser at no charge.

THIS LIMITED WARRANTY DOES NOT APPLY TO ACCESSORY ITEMS THAT WEAR OUT FROM REGULAR USAGE OVER TIME INCLUDING BELTS, BRUSHES, BLADES, ETC. ANY IMPLIED WARRANTIES SHALL BE LIMITED IN DURATION TO TWO (2) YEARS FROM DATE OF PURCHASE. SOME STATES IN THE U.S., SOME CANADIAN PROVINCES DO NOT ALLOW LIMITATIONS ON HOW LONG AN IMPLIED WARRANTY LASTS, SO THE ABOVE LIMITATION MAY NOT APPLY TO YOU.

IN NO EVENT SHALL SELLER BE LIABLE FOR ANY INCIDENTAL OR CONSEQUENTIAL DAMAGES (INCLUDING BUT NOT LIMITED TO LIABILITY FOR LOSS OF PROFITS) ARISING FROM THE SALE OR USE OF THIS PRODUCT. SOME STATES IN THE U.S. AND SOME CANADIAN PROVINCES DO NOT ALLOW THE EXCLUSION OR LIMITATION OF INCIDENTAL OR CONSEQUENTIAL DAMAGES, SO THE ABOVE LIMITATION OR EXCLUSION MAY NOT APPLY TO YOU.

THIS LIMITED WARRANTY GIVES YOU SPECIFIC LEGAL RIGHTS, AND YOU MAY ALSO HAVE OTHER RIGHTS WHICH VARY FROM STATE TO STATE IN THE U.S., PROVINCE TO PROVINCE IN CANADA AND FROM COUNTRY TO COUNTRY.

THIS LIMITED WARRANTY APPLIES ONLY TO PORTABLE ELECTRIC TOOLS, BENCH POWER TOOLS, OUTDOOR POWER EQUIPMENT AND PNEUMATIC TOOLS SOLD WITHIN THE UNITED STATES OF AMERICA, CANADA AND THE COMMONWEALTH OF PUERTO RICO. FOR WARRANTY COVERAGE WITHIN OTHER COUNTRIES, CONTACT THE WEN CUSTOMER SUPPORT LINE.

**THANKS FOR
REMEMBERING**

