

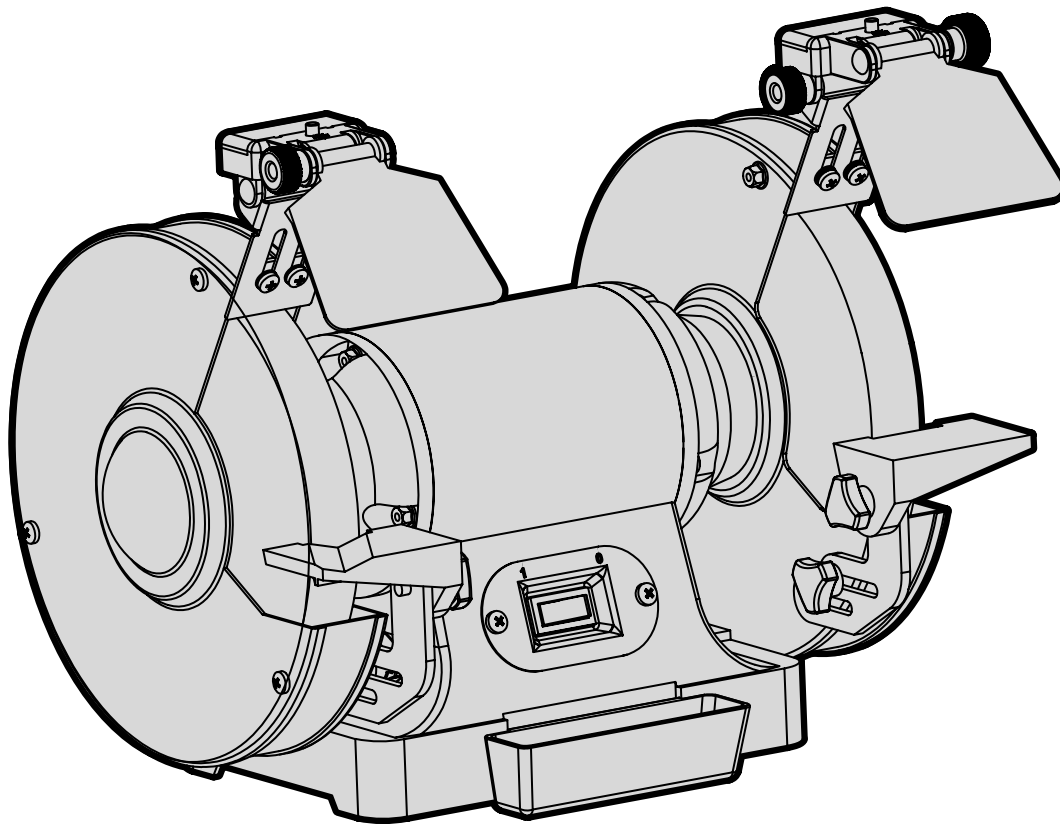

MODEL 4282, BG4282

8-INCH BENCH GRINDER WITH LED LIGHTS

Instruction Manual



NEED HELP? CONTACT US!

Have product questions? Need technical support? Please feel free to contact us:



1-800-232-1195 (M-F 8AM-5PM CST)



TECHSUPPORT@WENPRODUCTS.COM

IMPORTANT: Your new tool has been engineered and manufactured to WEN's highest standards for dependability, ease of operation, and operator safety. When properly cared for, this product will supply you years of rugged, trouble-free performance. Pay close attention to the rules for safe operation, warnings, and cautions. If you use your tool properly and for its intended purpose, you will enjoy years of safe, reliable service.

For replacement parts and the most up-to-date instruction manuals, visit ***WENPRODUCTS.COM***

CONTENTS

WELCOME	3
Introduction	3
Specifications.....	3
SAFETY	4
General Safety Rules	4
Impact Wrench Safety Warnings.....	6
Electrical Information.....	8
BEFORE OPERATING	9
Unpacking & Packing List	9
Know Your Impact Wrench	10
Assembly & Adjustments.....	11
OPERATION & MAINTENANCE	13
Operation	13
Maintenance.....	15
Exploded View & Parts List.....	17
Warranty Statement	19

To purchase accessories and replacement parts for your tool, visit **WENPRODUCTS.COM**

Cast Iron Bench Grinder Stand (Model 4288T)

INTRODUCTION

Thanks for purchasing the WEN Bench Grinder. We know you are excited to put your tool to work, but first, please take a moment to read through the manual. Safe operation of this tool requires that you read and understand this operator's manual and all the labels affixed to the tool. This manual provides information regarding potential safety concerns, as well as helpful assembly and operating instructions for your tool.

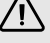
 Indicates danger, warning, or caution. The safety symbols and the explanations with them deserve your careful attention and understanding. Always follow the safety precautions to reduce the risk of fire, electric shock or personal injury. However, please note that these instructions and warnings are not substitutes for proper accident prevention measures.

NOTE: The following safety information is not meant to cover all possible conditions and situations that may occur. WEN reserves the right to change this product and specifications at any time without prior notice.

At WEN, we are continuously improving our products. If you find that your tool does not exactly match this manual, please visit wenproducts.com for the most up-to-date manual or contact our customer service at **1-800-232-1195**.

Keep this manual available to all users during the entire life of the tool and review it frequently to maximize safety for both yourself and others.

SPECIFICATIONS

Model Number	4282, BG4282
Motor	120V, 60 Hz, 4.8A
Wheel Speed	3450 RPM (No Load)
Grinding Wheel Size	8 in. x 1 in.
Arbor Size	5/8 Inch
Arbor Thread	M16-2.0
Wheel Grits	#60 (Medium Grit, Left Wheel) and #36 (Coarse Grit, Right Wheel)
Product Weight	30.5 Pounds
Product Dimensions	14 in. x 10 in. x 11.75 in.

GENERAL SAFETY RULES

 **WARNING!** Read all safety warnings and all instructions. Failure to follow the warnings and instructions may result in electric shock, fire and/or serious injury.

Safety is a combination of common sense, staying alert and knowing how your item works. The term “power tool” in the warnings refers to your mains-operated (corded) power tool or battery-operated (cordless) power tool.

SAVE THESE SAFETY INSTRUCTIONS.

WORK AREA SAFETY

- 1. Keep work area clean and well lit.** Cluttered or dark areas invite accidents.
- 2. Do not operate power tools in explosive atmospheres, such as in the presence of flammable liquids, gases or dust.** Power tools create sparks which may ignite the dust or fumes.
- 3. Keep children and bystanders away while operating a power tool.** Distractions can cause you to lose control.

ELECTRICAL SAFETY

- 1. Power tool plugs must match the outlet. Never modify the plug in any way. Do not use any adapter plugs with earthed (grounded) power tools.** Unmodified plugs and matching outlets will reduce risk of electric shock.
- 2. Avoid body contact with earthed or grounded surfaces such as pipes, radiators, ranges and refrigerators.** There is an increased risk of electric shock if your body is earthed or grounded.
- 3. Do not expose power tools to rain or wet conditions.** Water entering a power tool will increase the risk of electric shock.
- 4. Do not abuse the cord. Never use the cord for carrying, pulling or unplugging the power tool. Keep cord away from heat, oil, sharp edges or moving parts.** Damaged or entangled cords increase the risk of electric shock.
- 5. When operating a power tool outdoors, use an extension cord suitable for outdoor use.** Use of a cord suitable for outdoor use reduces the risk of electric shock.

6. If operating a power tool in a damp location is unavoidable, use a ground fault circuit interrupter (GFCI) protected supply. Use of a GFCI reduces the risk of electric shock.

PERSONAL SAFETY

- 1. Stay alert, watch what you are doing and use common sense when operating a power tool. Do not use a power tool while you are tired or under the influence of drugs, alcohol or medication.** A moment of inattention while operating power tools may result in serious personal injury.
- 2. Use personal protective equipment. Always wear eye protection.** Protective equipment such as a respiratory mask, non-skid safety shoes and hearing protection used for appropriate conditions will reduce the risk of personal injury.
- 3. Prevent unintentional starting. Ensure the switch is in the off-position before connecting to power source and/or battery pack, picking up or carrying the tool.** Carrying power tools with your finger on the switch or energizing power tools that have the switch on invites accidents.
- 4. Remove any adjusting key or wrench before turning the power tool on.** A wrench or a key left attached to a rotating part of the power tool may result in personal injury.
- 5. Do not overreach. Keep proper footing and balance at all times.** This enables better control of the power tool in unexpected situations.
- 6. Dress properly. Do not wear loose clothing or jewelry. Keep your hair and clothing away from moving parts.** Loose clothes, jewelry or long hair can be caught in moving parts.

GENERAL SAFETY RULES

⚠ WARNING! Read all safety warnings and all instructions. Failure to follow the warnings and instructions may result in electric shock, fire and/or serious injury.

Safety is a combination of common sense, staying alert and knowing how your item works. The term “power tool” in the warnings refers to your mains-operated (corded) power tool or battery-operated (cordless) power tool.

SAVE THESE SAFETY INSTRUCTIONS.

7. If devices are provided for the connection of dust extraction and collection facilities, ensure these are connected and properly used. Use of dust collection can reduce dust-related hazards.

POWER TOOL USE AND CARE

1. Do not force the power tool. Use the correct power tool for your application. The correct power tool will do the job better and safer at the rate for which it was designed.

2. Do not use the power tool if the switch does not turn it on and off. Any power tool that cannot be controlled with the switch is dangerous and must be repaired.

3. Disconnect the plug from the power source and/or the battery pack from the power tool before making any adjustments, changing accessories, or storing power tools. Such preventive safety measures reduce the risk of starting the power tool accidentally.

4. Store idle power tools out of the reach of children and do not allow persons unfamiliar with the power tool or these instructions to operate the power tool. Power tools are dangerous in the hands of untrained users.

5. Maintain power tools. Check for misalignment or binding of moving parts, breakage of parts and any other condition that may affect the power tool's operation. If damaged, have the power tool repaired before use. Many accidents are caused by poorly maintained power tools.

6. Keep cutting tools sharp and clean. Properly maintained cutting tools with sharp cutting edges are less likely to bind and are easier to control.

7. Use the power tool, accessories and tool bits, etc. in accordance with these instructions, taking into account the working conditions and the work to be performed. Use of the power tool for operations different from those intended could result in a hazardous situation.

8. Use clamps to secure your workpiece to a stable surface. Holding a workpiece by hand or using your body to support it may lead to loss of control.

9. KEEP GUARDS IN PLACE and in working order.

SERVICE

1. Have your power tool serviced by a qualified repair person using only identical replacement parts. This will ensure that the safety of the power tool is maintained.

CALIFORNIA PROPOSITION 65 WARNING

Some dust created by power sanding, sawing, grinding, drilling, and other construction activities may contain chemicals, including lead, known to the State of California to cause cancer, birth defects, or other reproductive harm. Wash hands after handling. Some examples of these chemicals are:

- Lead from lead-based paints.
- Crystalline silica from bricks, cement, and other masonry products.
- Arsenic and chromium from chemically treated lumber.

Your risk from these exposures varies depending on how often you do this type of work. To reduce your exposure to these chemicals, work in a well-ventilated area with approved safety equipment such as dust masks specially designed to filter out microscopic particles.

BENCH GRINDER SAFETY WARNINGS

 **WARNING!** Do not operate the power tool until you have read and understood the following instructions and the warning labels.

BENCH GRINDER SAFETY

1. This bench grinder is designed for sharpening and honing cutting tools, using the appropriate accessories. Using the machine for any other purpose for which it is not designed may result in serious injuries, machine damage and voiding of the warranty.

2. Grinding wheel safety:

- Only use grinding wheels rated for a speed higher than 3450 RPM (maximum RPM of the tool).
- Inspect wheels for cracks or fragments before starting the machine. Replace damaged wheels immediately. Never use a questionable grinding wheel, as the RPM of the machine can send broken wheel fragments flying at high speeds.
- Do not use a wheel that vibrates. If a wheel vibrates, it may be that the bearings of the shaft need replacing.
- Check that the grinding stone can rotate smoothly before starting the machine.
- The grinding wheel is for grinding. Never attempt to cut anything with the grinding wheel.

3. The use of accessories or attachments not recommended by the manufacturer may result in a risk of personal injury.

4. **DANGER! Fire Hazard.** Do not grind or polish magnesium or magnesium alloys.

5. Preventing accidental starting. Make sure the power switch is in the OFF position prior to plugging in the machine. Always make sure the power switch is in the OFF position and the machine is unplugged when doing any cleaning, adjustments, assembly, setup operations, or when not in use.

PERSONAL SAFETY

1. Operate in a well ventilated area. Keep the floor area around the bench grinder level and free of slippery substances or other tripping hazards.

2. Wear ANSI-approved safety goggles to protect your eyes from sparks and chips. Use hearing protection to protect yourself from hearing loss.

3. DO NOT wear loose clothing or jewelry as they might get drawn in by the tool. Tie back long hair.

4. People with pacemakers should consult their physician(s) before use. Electromagnetic fields in close proximity to pacemakers could cause pacemaker interference or pacemaker failure.

5. Chips are harmful to your health. Use NIOSH-approved dust masks or other respiratory protection during operation and cleaning.

6. Always turn off and unplug the bench grinder before making any adjustments or repair tasks. Never adjust the bench grinder or the workpiece while the tool is running.

PREPARING THE BENCH GRINDER

When transporting the bench grinder, carry it by the base. Never carry the device by its guards or its accessories.

1. Examine the bench grinder for any damaged or missing parts. Replace or repair damaged parts before operation. Periodically check that all nuts, bolts and other fasteners are properly tightened.

2. Do not operate this tool until it is completely assembled and installed according to the instructions. Make sure all adjustments are correct and all connections are tight. Keep all guards in place.

DURING OPERATION

1. Never start the machine with any load already applied to either grinding wheel. Stand to the side of the bench grinder during start-up. Switch it ON and let the bench grinder reach full speed for roughly one minute to warm up the wheel and to ensure proper operation.

2. Never grind on a cold wheel. Run the bench grinder for one full minute before applying the workpiece. Cold wheels have an increased likelihood of chipping during operation.

3. Only grind on the face of the grinding wheel. Do not grind on the side of the wheel.

BENCH GRINDER SAFETY WARNINGS

 **WARNING!** Do not operate the power tool until you have read and understood the following instructions and the warning labels.

DURING OPERATION (CONT.)

4. Keep clear of moving parts. Keep arms, hands and other vital appendages away from the grinding and honing wheel. Do not reach behind or beneath the rotating wheel. Avoid awkward operation and hand positions. An accident could easily send the operator's hand into the wheel.
5. If you are interrupted when operating the bench grinder, complete the process and switch the bench grinder off before looking up.
6. Always hold the workpiece firmly against the tool rest.
7. Never attempt to cut anything with the grinding wheel.
8. Do not use the bench grinder unless all guards are in place. Do not operate with any guard disabled, damaged, or removed. Moving guards must move freely and close instantly.
9. Disconnect the power source and allow the wheels to come to a complete stop before making any adjustments to either the machine or the grinding wheels.
10. Clean the machine thoroughly when changing material types in workpieces. Combining certain materials can increase the chances of an explosion or fire hazard.
11. Should any component of your bench grinder be missing/damaged or fail in any way, shut off the switch and remove the plug from power supply outlet. Have a certified technician replace the missing, damaged, or failed parts using only identical replacement parts before resuming operation.

ELECTRICAL INFORMATION

GROUNDING INSTRUCTIONS

In the event of a malfunction or breakdown, grounding provides the path of least resistance for an electric current and reduces the risk of electric shock. This tool is equipped with an electric cord that has an equipment grounding conductor and a grounding plug. The plug **MUST** be plugged into a matching outlet that is properly installed and grounded in accordance with ALL local codes and ordinances.

1. Do not modify the plug provided. If it will not fit the outlet, have the proper outlet installed by a licensed electrician.

2. Improper connection of the equipment grounding conductor can result in electric shock. The conductor with the green insulation (with or without yellow stripes) is the equipment grounding conductor. If repair or replacement of the electric cord or plug is necessary, **DO NOT** connect the equipment grounding conductor to a live terminal.

3. Check with a licensed electrician or service personnel if you do not completely understand the grounding instructions or whether the tool is properly grounded.

4. Use only three-wire extension cords that have three-pronged plugs and outlets that accept the tool's plug (INSERT CR). Repair or replace a damaged or worn cord immediately.

CAUTION! In all cases, make certain the outlet in question is properly grounded. If you are not sure, have a licensed electrician check the outlet.

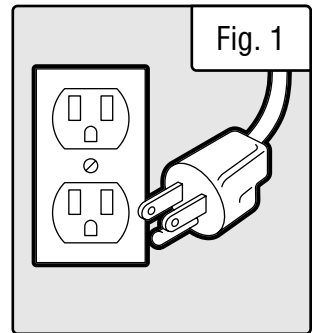

GUIDELINES AND RECOMMENDATIONS FOR EXTENSION CORDS

When using an extension cord, be sure to use one heavy enough to carry the current your product will draw. An undersized cord will cause a drop in line voltage resulting in loss of power and overheating. The table below shows the correct size to be used according to cord length and ampere rating. When in doubt, use a heavier cord. The smaller the gauge number, the heavier the cord.

AMPERAGE	REQUIRED GAUGE FOR EXTENSION CORDS			
	25 ft.	50 ft.	100 ft.	150 ft.
4.8A	18 gauge	16 gauge	16 gauge	14 gauge

1. Examine extension cord before use. Make sure your extension cord is properly wired and in good condition. Always replace a damaged extension cord or have it repaired by a qualified person before using it.

2. Do not abuse extension cord. Do not pull on cord to disconnect from receptacle; always disconnect by pulling on plug. Disconnect the extension cord from the receptacle before disconnecting the product from the extension cord. Protect your extension cords from sharp objects, excessive heat and damp/wet areas.

3. Use a separate electrical circuit for your tool. This circuit must not be less than a 12-gauge wire and should be protected with a 15A time-delayed fuse. Before connecting the motor to the power line, make sure the switch is in the OFF position and the electric current is rated the same as the current stamped on the motor nameplate. Running at a lower voltage will damage the motor.

UNPACKING & PACKING LIST

UNPACKING

Carefully remove the bench grinder from the packaging and place it on a sturdy, flat surface. Make sure to take out all contents and accessories. Do not discard the packaging until everything is removed. Check the packing list below to make sure you have all of the parts and accessories. If any part is missing or broken, please contact customer service at **1-800-232-1195** (M-F 8-5 CST), or email techsupport@wenproducts.com.

Components

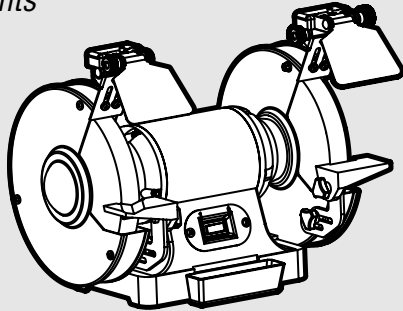

Bench Grinder

Tools Needed but Not Included

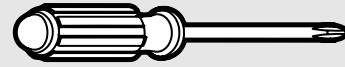

Phillips Screwdriver

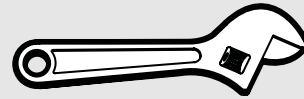

**Adjustable Wrench
or 15/16 (24 mm) Crescent or Socket Wrench**

Accessories & Hardware

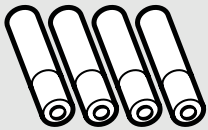

AAA Batteries (4)

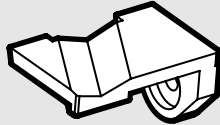

Left Work Rest, Grooved



Left Work Rest Bracket

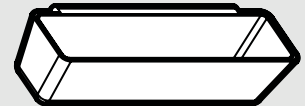

Coolant Tray



Flat Washers (2)

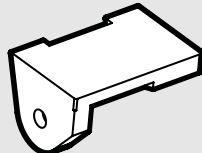

Right Work Rest

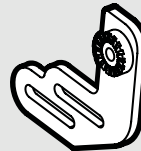

Right Work Rest Bracket



Work Rest Knobs (2)

Pre-Installed Accessories



Spring Washers (2)

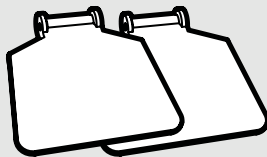

Eye Shields (2)



Phillips Screws with Lock Washers & Flat Washers (4)

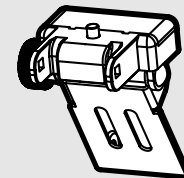

Right Spark Deflector with LED Assembly & Locking Knob



Flat Washers (2)



Eye Shield Lock Knobs (2)

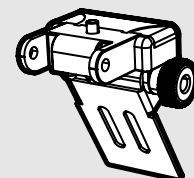

Left Spark Deflector with LED Assembly & Locking Knob



Bracket Bolts (2)

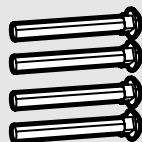

Carriage Bolts (4)



Bracket Knobs (2)

KNOW YOUR BENCH GRINDER

TOOL PURPOSE

Sharpen bits, drill bits, chisels, gouges, and other cutting tools all with your WEN Bench Grinder. Refer to the following diagrams to become familiarized with all the parts and controls of your bench grinder. The components will be referred to later in the manual for assembly and operation instructions.

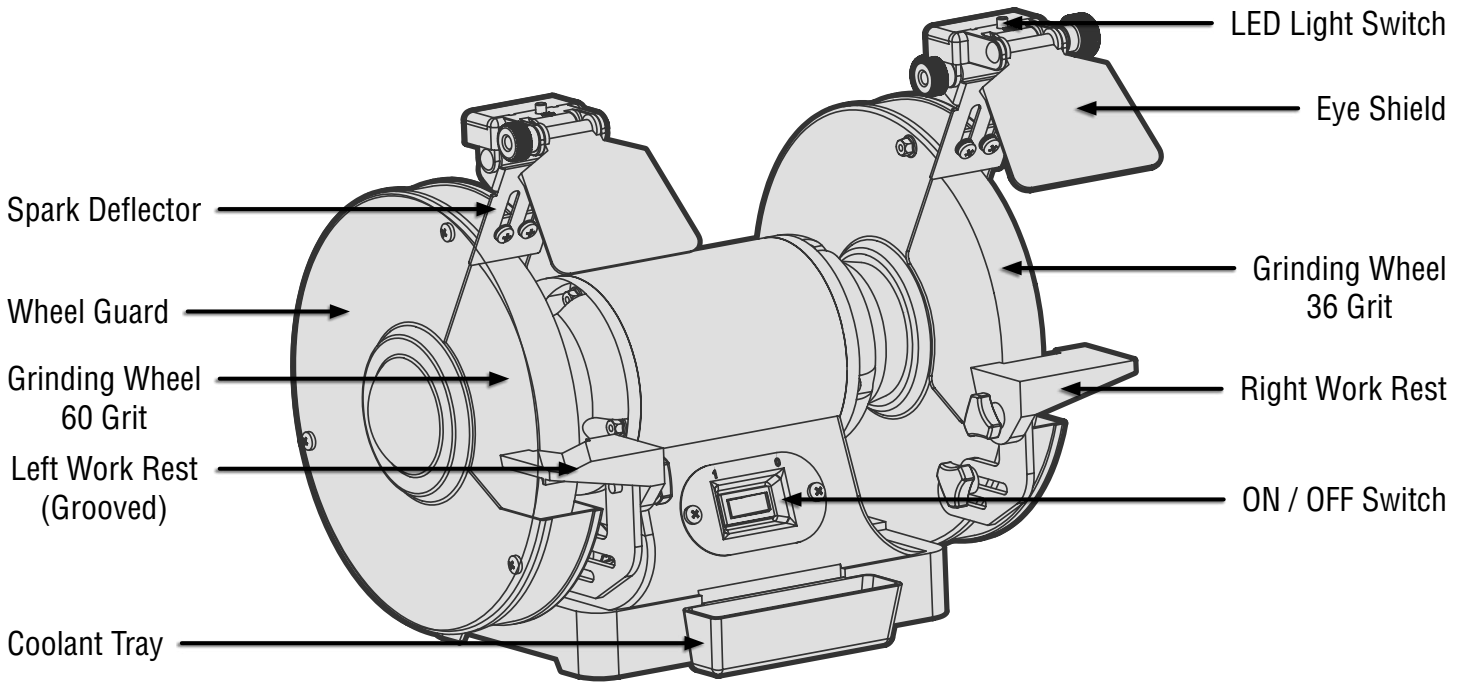

ASSEMBLY & ADJUSTMENTS

⚠ WARNING! Do not connect to power supply until assembly is complete. Failure to comply could result in accidental starting and personal injury.

MOUNTING THE SPARK DEFLECTORS (FIG. 1)

1. Position the spark deflector assembly (F) onto the wheel cover with its lower edge about 1/16 of an inch from the grinding wheel.
2. Mount the spark deflector assembly using two Phillips screws (E), lock washers and flat washers from under the spark deflectors plate. Tighten the screws securely using a Phillips screwdriver.
3. Repeat the steps above for attaching the other spark deflector.

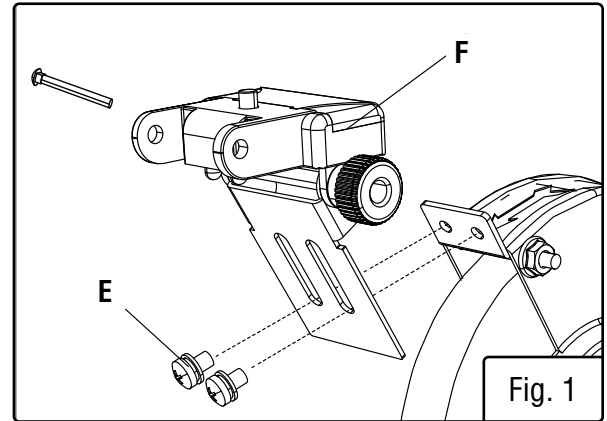

ATTACHING THE EYE SHIELDS (FIG. 2)

NOTE: The carriage bolt and knob used for mounting are pre-installed on the eye shield. Remove them before installing on the spark deflector assembly.

1. Place the eye shield (Fig. 2 - H) onto the spark deflector assembly (Fig. 2 - G) and align the holes.
2. Insert the carriage bolt (Fig. 2 - J) through the holes of the spark deflector (Fig. 2 - G) and eye shield (Fig. 2 - H). Tighten with the eye shield knob (Fig. 2 - I).
3. Repeat the steps above for installing the other eye shield.

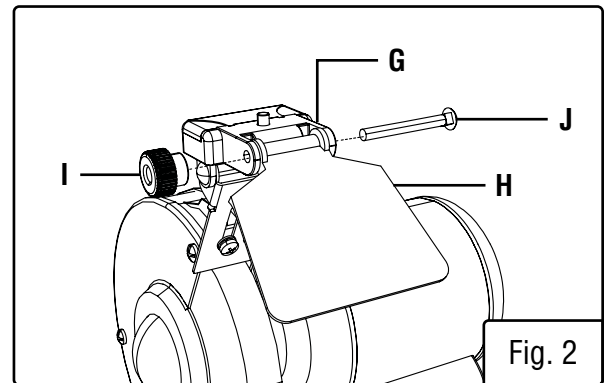

MOUNTING THE WORK RESTS (FIG. 3)

1. Install the wheel bracket (D):

From the outside of the wheel cover, insert the bracket bolt (Fig. 3 - S) through the wheel cover hole and the lower slot of the work rest bracket (Fig. 3 - D). Secure it with the flat washer (Fig. 3 - N), lock washer (Fig. 3 - M) and bracket knob (Fig. 3 - K). Tighten the knob.

2. Install the work rest (Fig. 3 - A):

Install the work rest on the inside of the wheel cover by inserting the work rest screw through the flat washer (Fig. 3 - P), the work rest (Fig. 3 - A), the upper slot of the work rest bracket and the wheel cover. Tighten the knob.

3. Repeat the steps above to install the other work rest.

NOTE: Adjust the distance between the wheel and the work rest to maintain 1/16 in. or less separation as the diameter of the wheel decreases with use.

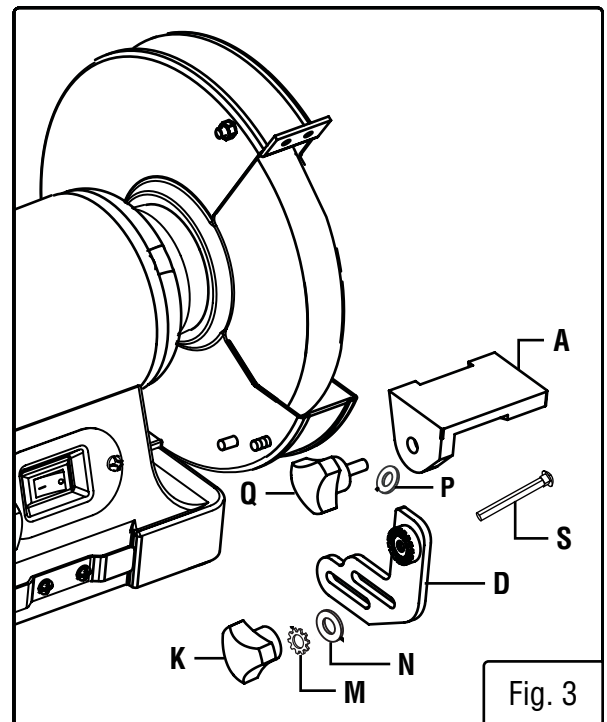

ASSEMBLY & ADJUSTMENTS

INSTALLING THE COOLANT TRAY (FIG. 4)

Place the coolant tray (Fig. 4 - L) over the coolant tray bracket then firmly push tray down onto the bracket to secure it in place.

INSTALLING THE LED BATTERIES (FIG. 5 & 6)

1. The LED light switch is on top of the spark shield assembly. Make sure that the LED button has been pushed to the OFF position when installing batteries.

2. Remove the battery covers from the top of the LED assemblies.

3. Install the AAA batteries (O) inside the battery compartments according to the polarity indicators, then replace the battery covers.

4. Repeat the steps above for the other LED light.

MOUNTING TO THE WORK SURFACE (FIG. 7)

The bench grinder should be firmly attached to a reliable work surface using mounting hardware (not included) installed through the mounting holes on the base of the grinder. This will prevent the bench grinder from vibration, walking or tipping during operation.

NOTE: This bench grinder is compatible with the WEN 4288 Cast Iron Bench Grinder Pedestal Stand.

1. Prepare 1/4 in. bolts, flat washers, lock washers and hex nuts (not included). The bolt length should be 1-1/2 in. longer than the thickness of the workbench.

2. Locate and mark the holes where the grinder is to be mounted onto the work surface.

NOTE: If mounting to a work bench, drill two 3/8 in. diameter holes through the workbench.

3. Place the bench grinder onto the workbench, aligning holes in base with holes in the workbench.

4. Insert two 1/4 in. diameter bolts and washers and attach with nuts securely.

⚠ WARNING! Always make sure your bench grinder is securely mounted to a workbench. Failure to do so could result in an accident resulting in possible serious personal injury.

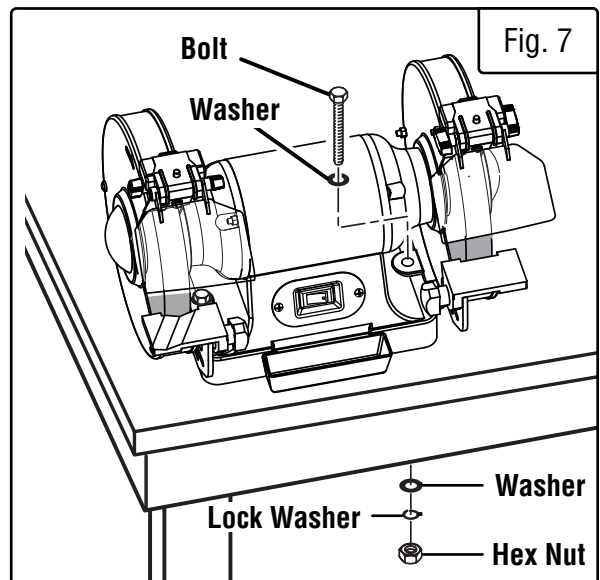
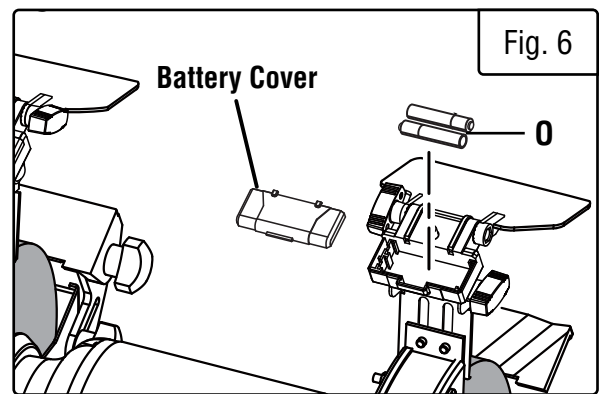
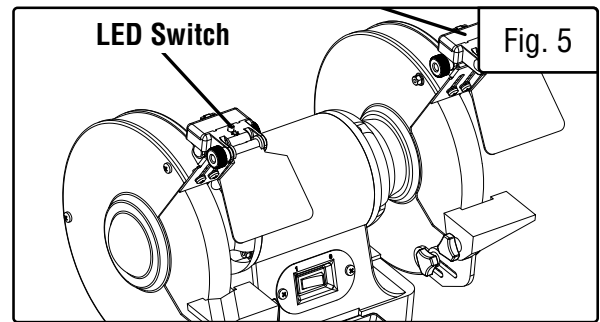
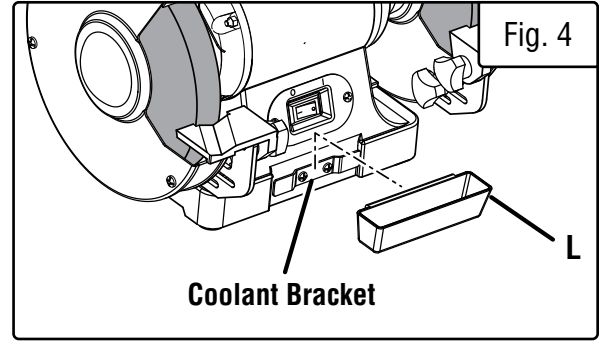

OPERATION

⚠ WARNING! Always wear eye protection with side shields marked to comply with ANSI Z87.1. Failure to do so could result in objects being thrown into your eyes resulting in possible serious injury.

USING THE COOLANT TRAY (FIG. 8)

The coolant tray allows you to cool overheated workpieces. Fill the tray half way with water or appropriate coolant before operation.

Periodically empty out the coolant tray. Rinse it of any metal filaments and refill it with clean water to prevent buildup on the wheel itself. Your cleaning schedule should depend on frequency of use.

BASIC OPERATION

1. To operate the bench grinder, always wear safety glasses and stand to the side of the grinder (as opposed to in front) before turning the tool on.

2. Turn the On/Off switch to “I”. Once the tool is up and running, allow it to reach full speed before grinding. This will take about 15 seconds (Fig. 9).

3. Hold the work piece firmly against the tool rest. Hold very small pieces with pliers or other suitable clamps.

4. Choose the suitable grinding wheel for you operation. The 60-grit wheel is good for small material removal and sharpening. The 36-grit wheel is good for rapid material removal and tool reshaping.

5. Feed the work piece smoothly and evenly into the grinding wheel. Move the workpiece back and forth at an even pace to make for even grinding and prevent burning any one area of the surface.

NOTE: Sparks are normal during grinding operations. Protect yourself and the surrounding environment from flying sparks.

6. Move the work piece slowly and avoid forcing the workpiece against the grinding wheel. If the wheel tends to slow down from excessive force, you should occasionally release the pressure to let the wheel return to full speed.

NOTE: Excessive pressure may damage the tool, cause the motor to overheat, and prematurely wear down the grinding wheel.

7. Grind only on the face of the grinding wheel; never on the side of it.

8. Regularly place the hot end of the workpiece into the coolant tray to cool it off.

9. Turn the ON/OFF switch to “O”. The wheels will take about 3 minutes and 20 seconds to come to a full stop. Avoid contact with the bench grinder’s housing until it has stopped and cooled down completely. Unplug the tool from the power source.

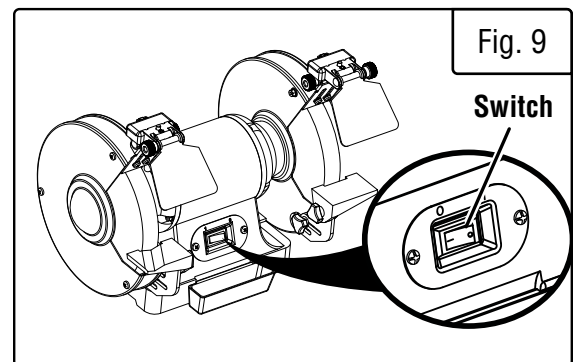
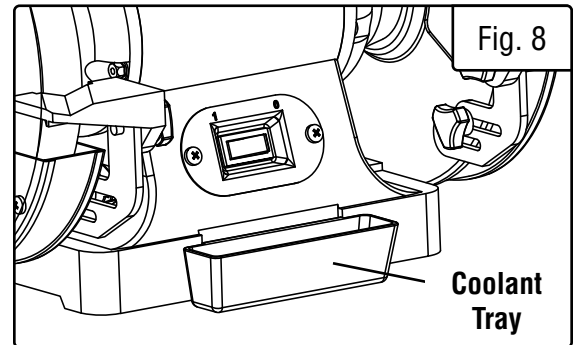

OPERATION

SHARPENING LAWN MOWER BLADES (FIG. 10)

Lawn mower blades are usually sharpened on only one edge and dressed up slightly on the other. Perform this sharpening process on both cutting ends of the blade.

After sharpening, be sure to balance the blade by removing additional material from the heavy end. Unbalanced blades can cause serious crank shaft damage to your lawn mower. There are a number of inexpensive cone balancers on the market for this purpose. Alternatively, you can balance the blade using a screwdriver that is secured onto a vise as shown.

NOTE: Always remove spark plug wires or battery from the mower before servicing the blades to prevent accidental start-ups.

SHARPENING CHISELS & FLATHEAD SCREWDRIVERS (FIG. 11)

The end of a properly sharpened chisel or screwdriver will be a perfectly flat rectangle, perpendicular to the center line of the shank. The two sides and two faces will taper outward from the end. Hold each face of the screwdriver against the wheel to true it up, then ease the end straight into the stone to grind it true.

SHARPENING DRILL BITS (FIG. 12)

Use the grooved work rest to provide angled support to drill bits during grinding operation. The angled groove running through the work rest allows for a cradle for drill bits during sharpening operations.

For better sharpening results, you can use a sharpening jig (available at most hardware stores). Begin on one side of the point at the existing angle, then twist the bit while maintaining contact with the grinding surface. Sharpen only the tip of the drill bit.

SHARPENING KNIVES

Working from the heavy end of the blade towards the tip to remove metal from both faces of the knife.

SHARPENING SCISSORS

If possible, take the scissors apart to make the sharpening operation easier and safer. Remove material only from the outside surface and work from the heavy end of the blade toward the tip.

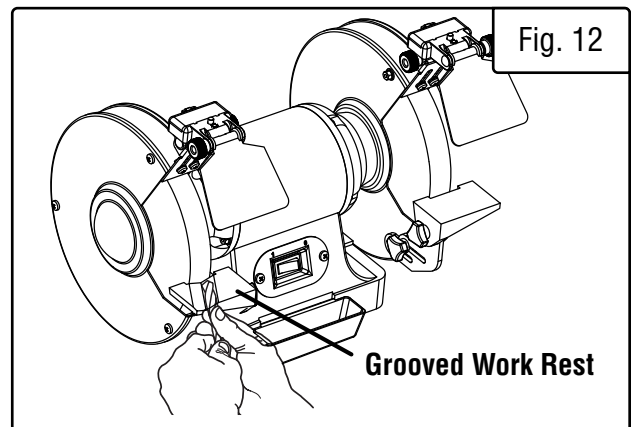
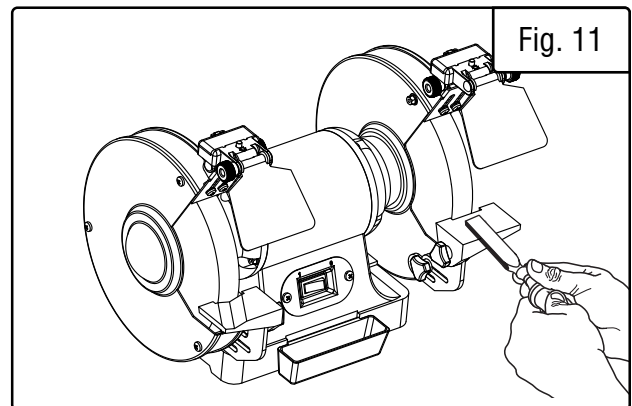
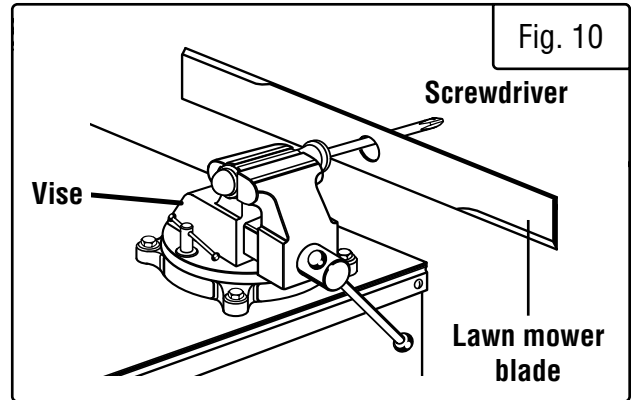

MAINTENANCE

⚠ WARNING! For your own safety, turn the switch OFF and remove the plug from the electrical outlet before adjusting or performing maintenance inspection work on the bench grinder.

GENERAL CLEANING AND MAINTENANCE

1. Regularly check the tool and use a soft brush to remove accumulated dust. Wear safety goggles to protect your eyes while cleaning.
2. If the body of the grinder needs cleaning, wipe it down with a soft, damp cloth. A mild detergent can be used. Do not use alcohol, petrol or other similar cleaning agents. Do not make contact with the grinding wheels with any damp cloth.

⚠ WARNING! Do not at any time let brake fluids, gasoline, petroleum based products, penetrating oils, etc., come in contact with plastic parts. Chemicals can damage, weaken or destroy plastic which could result in serious personal injury.

3. Always make sure the eye shields are transparent and not blocking the view of the grinding wheel.
4. All of the bearings in this tool are lubricated with sufficient amount of high grade lubricant for the life of the unit under normal operating conditions. Therefore, no additional lubrication is required.

POWER CORD REPLACEMENT

If replacement of the power supply cord is necessary, this must be done by an authorized service center in order to avoid a safety hazard.

CHANGING THE GRINDING WHEEL (FIG. 13)

In normal use, grinding wheels may become cracked, grooved, rounded at the edges, chipped, out of true or loaded with foreign material. Grinding wheels should be inspected before each use. Cracked wheels should be replaced immediately. Any of the other conditions can be remedied with a dressing tool (not included).

To replace a grinding wheel:

1. Ensure that the machine is powered off and unplugged.
2. Loosen the bracket knob and remove the work rest bracket assembly from the wheel cover. Repeat for the other side.
3. Using a Phillips head screwdriver, remove the two remaining bolts and nuts from the wheel cover. Repeat for the other side.
4. Using two 24 mm wrenches, loosen the arbor hex nut found on the outside edge of the grinding wheel. The left side hex nut is loosened by using a clockwise wrench rotation while the right side hex nut is loosened with a counterclockwise rotation.

If you are having difficulty with the two-wrench method, you may try holding one wheel while loosening the nut. Wear gloves if you decide to use this method to avoid scraping your hand or fingers. Remove the arbor hex nut and outer wheel flange.

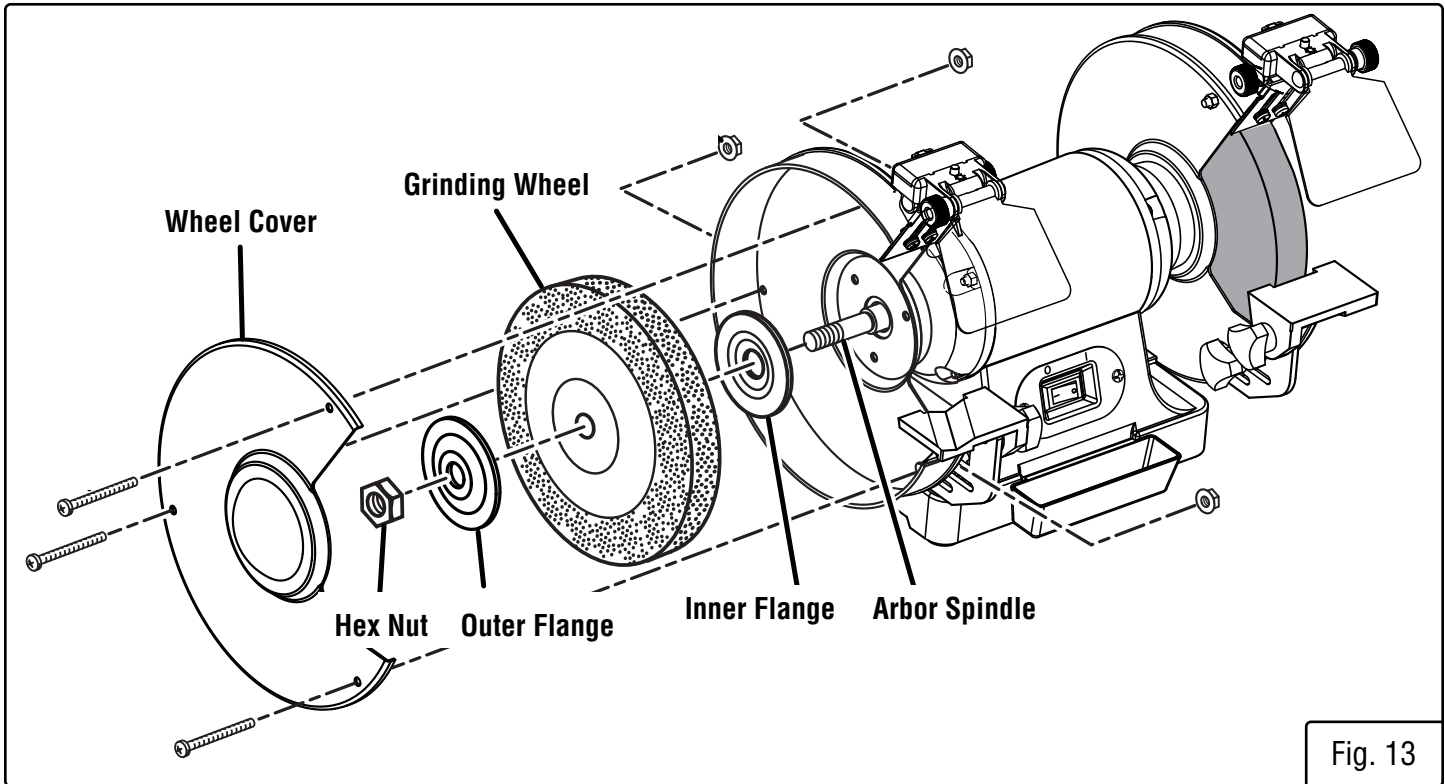

Fig. 13

CHANGING THE GRINDING WHEEL (CONT.) (FIG. 13)

5. Replace the grinding wheel with a new grinding wheel that has a speed rating higher than 3450 RPM. The outer diameter of the wheel should be 8 inches and the arbor size should be 5/8 of an inch. Do not remove labels from the grinding wheels.

6. Once the wheel has been replaced, re-attach the outer flange and the arbor hex nut.

Caution: Do not overtighten the nut, or use an impact driver to tighten. This can cause damage to the grinding wheels, which could cause personal injury.

7. Replace the wheel cover and secure with the bolts and knobs. Replace the work rest assemblies. Make sure all guards, shields and work rests are correctly positioned before operation.

USING A WIRE OR BUFFING WHEEL

A wire or buffing wheel can be installed onto either side of the grinder as needed. The WEN **858WW** 8-Inch Crimped Benchtop Steel Wire Wheel is compatible with your bench grinder. Accessories and replacement parts can be purchased on wenproducts.com.

More spacers may be required when using wire wheels, depending on the wheel's thickness. NOTE: The first spacer should always go onto the arbor shaft, between the innermost wheel flange and the body of the grinder. If needed, a second spacer should go between the outermost wheel flange and the arbor hex nut. Always use the included wheel flanges even if using a wire or a buffing wheel.

STORAGE

Store the bench grinder and the grinding wheels to prevent them from the potential hazards of moisture, contaminants and other damage.

EXPLODED VIEW & PARTS LIST

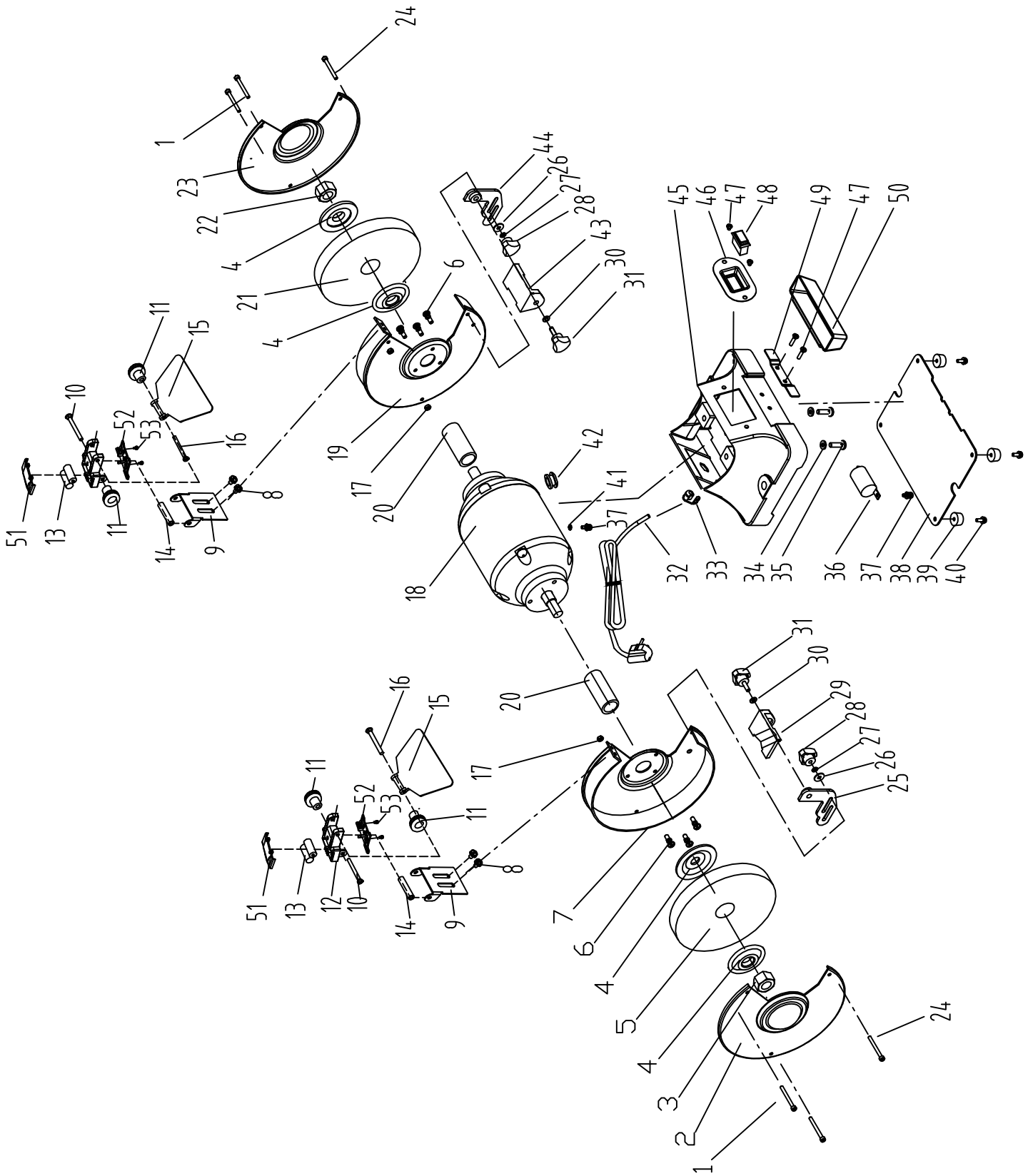

NOTE: Not all parts may be available for purchase. Parts and accessories that wear down over the course of normal use are not covered under the warranty.

EXPLODED VIEW & PARTS LIST

No.	Part No.	Description	Qty.
1	4286-001	M5x48 Screw	4
2	4286-003	Left wheel guard cover	1
3	4286-004	M16 I type hex nut	1
4	4282-004	Flange	4
5	4282-005	60# Grinding Wheel φ200×25×φ15.88	1
6	4276-013	M5x10 Screw	6
7	4282-007	Left wheel guard plate	1
8	4282-008	M5x8 Screw	4
9	4282-009	Eyeshield support	2
10	4282-010	M5x60 Bolt	2
11	4282-011	Locking knob	4
12	4282-012	Lamp assembly	2
13	4282-013	Battery	4
14	4282-014	Washer	2
15	4282-015	Eyeshield	2
16	4282-016	M5x55 Bolt	2
17	4276-008	M5 Hex nut	4
18	4282-018	Motor	1
19	4282-019	Right wheel guard plate	1
20	4282-020	Shaft bushing	1
21	4282-021	36# Grinding wheel φ200×25×φ15.9	1
22	4286-056	M16 I type hex nut	1
23	4286-057	Right wheel guard cover	1
24	4286-002	M5x51 Bolt	2
25	4286-019	Left fixing work rest	1
26	4286-020	φ5 Big flat washer	2

No.	Part No.	Description	Qty.
27	4282-027	φ5 Toothed locking washer	2
28	4282-028	M5 Locking nut	2
29	4286-022	Left movable work rest	1
30	4286-014	φ6 Flat Washer	2
31	4282-031	M6×17 Tool rest locking knob	2
32	4276-043	Power cord with plug	1
33	4276-041	Cord clamp	1
34	4282-034	φ8 Spring washer	2
35	4282-035	M8×20 Hex bolt	2
36	4282-036	25UF/300V Capacitor	1
37	4276-033	M4x8 Screw	2
38	4282-038	Bottom plate	1
39	4286-038	Rubber feet	4
40	4286-039	M5x16 Screw	4
41	4276-024	φ4 Toothed locking washer	2
42	4282-042	Cord bushing	1
43	4286-052	Right movable work rest	1
44	4286-053	Right fixing work rest	1
45	4282-045	Base	1
46	4282-046	Switch plate	1
47	4282-047	M4x8 Screw	4
48	4282-048	Switch	1
49	4282-049	Coolent tray clamp	1
50	4282-050	Coolent tray	1
51	4282-051	Battery cover	2
52	4282-052	Lamp cover	2
53	4282-053	ST2.9X8 Screw	4

NOTE: Not all parts may be available for purchase. Parts and accessories that wear down over the course of normal use are not covered under the warranty.

WARRANTY STATEMENT

WEN Products is committed to building tools that are dependable for years. Our warranties are consistent with this commitment and our dedication to quality.

LIMITED WARRANTY OF WEN PRODUCTS FOR HOME USE

GREAT LAKES TECHNOLOGIES, LLC (“Seller”) warrants to the original purchaser only, that all WEN consumer power tools will be free from defects in material or workmanship during personal use for a period of two (2) years from date of purchase or 500 hours of use; whichever comes first. Ninety days for all WEN products if the tool is used for professional or commercial use. Purchaser has 30 days from the date of purchase to report missing or damaged parts.

SELLER’S SOLE OBLIGATION AND YOUR EXCLUSIVE REMEDY under this Limited Warranty and, to the extent permitted by law, any warranty or condition implied by law, shall be the replacement of parts, without charge, which are defective in material or workmanship and which have not been subjected to misuse, alteration, careless handling, misrepair, abuse, neglect, normal wear and tear, improper maintenance, or other conditions adversely affecting the Product or the component of the Product, whether by accident or intentionally, by persons other than Seller. To make a claim under this Limited Warranty, you must make sure to keep a copy of your proof of purchase that clearly defines the Date of Purchase (month and year) and the Place of Purchase. Place of Purchase must be a direct vendor of Great Lakes Technologies, LLC. Purchasing through third party vendors, including but not limited to garage sales, pawn shops, resale shops, or any other secondhand merchant, voids the warranty included with this product. Contact techsupport@wenproducts.com or 1-800-232-1195 with the following information to make arrangements: your shipping address, phone number, serial number, required part numbers, and proof of purchase. Damaged or defective parts and products may need to be sent to WEN before the replacements can be shipped out.

Upon the confirmation of a WEN representative, your product may qualify for repairs and service work. When returning a product for warranty service, the shipping charges must be prepaid by the purchaser. The product must be shipped in its original container (or an equivalent), properly packed to withstand the hazards of shipment. The product must be fully insured with a copy of the proof of purchase enclosed. There must also be a description of the problem in order to help our repairs department diagnose and fix the issue. Repairs will be made and the product will be returned and shipped back to the purchaser at no charge for addresses within the contiguous United States.

THIS LIMITED WARRANTY DOES NOT APPLY TO ITEMS THAT WEAR OUT FROM REGULAR USAGE OVER TIME, INCLUDING BELTS, BRUSHES, BLADES, BATTERIES, ETC. ANY IMPLIED WARRANTIES SHALL BE LIMITED IN DURATION TO TWO (2) YEARS FROM DATE OF PURCHASE. SOME STATES IN THE U.S. AND SOME CANADIAN PROVINCES DO NOT ALLOW LIMITATIONS ON HOW LONG AN IMPLIED WARRANTY LASTS, SO THE ABOVE LIMITATION MAY NOT APPLY TO YOU.

IN NO EVENT SHALL SELLER BE LIABLE FOR ANY INCIDENTAL OR CONSEQUENTIAL DAMAGES (INCLUDING BUT NOT LIMITED TO LIABILITY FOR LOSS OF PROFITS) ARISING FROM THE SALE OR USE OF THIS PRODUCT. SOME STATES IN THE U.S. AND SOME CANADIAN PROVINCES DO NOT ALLOW THE EXCLUSION OR LIMITATION OF INCIDENTAL OR CONSEQUENTIAL DAMAGES, SO THE ABOVE LIMITATION OR EXCLUSION MAY NOT APPLY TO YOU.

THIS LIMITED WARRANTY GIVES YOU SPECIFIC LEGAL RIGHTS, AND YOU MAY ALSO HAVE OTHER RIGHTS WHICH VARY FROM STATE TO STATE IN THE U.S., PROVINCE TO PROVINCE IN CANADA AND FROM COUNTRY TO COUNTRY.

THIS LIMITED WARRANTY APPLIES ONLY TO ITEMS SOLD WITHIN THE UNITED STATES OF AMERICA, CANADA AND THE COMMONWEALTH OF PUERTO RICO. FOR WARRANTY COVERAGE WITHIN OTHER COUNTRIES, CONTACT THE WEN CUSTOMER SUPPORT LINE. FOR WARRANTY PARTS OR PRODUCTS REPAIRED UNDER WARRANTY SHIPPING TO ADDRESSES OUTSIDE OF THE CONTIGUOUS UNITED STATES, ADDITIONAL SHIPPING CHARGES MAY APPLY.

**THANKS FOR
REMEMBERING**

