

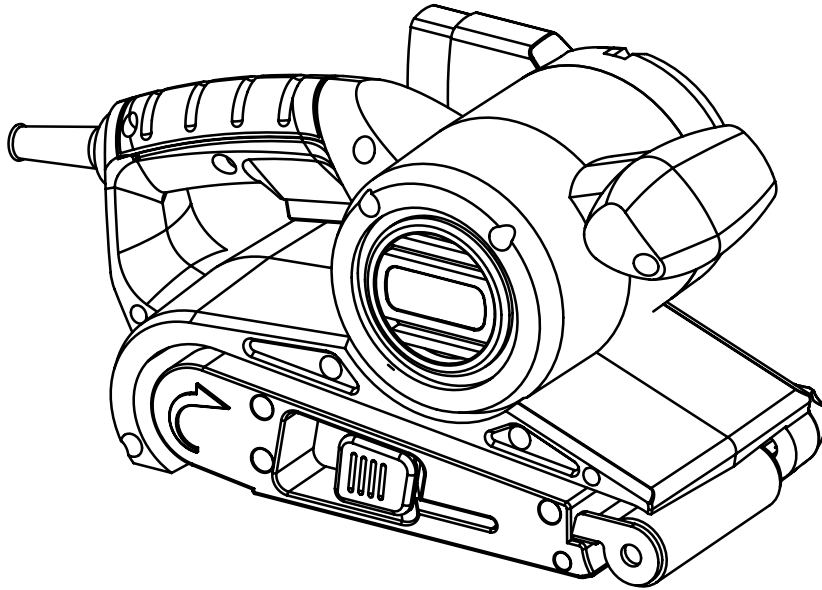

3 X 18 INCH BELT SANDER



Model # 6318
bit.ly/wenvideo



IMPORTANT:

Your new tool has been engineered and manufactured to WEN's highest standards for dependability, ease of operation, and operator safety. When properly cared for, this product will supply you years of rugged, trouble-free performance. Pay close attention to the rules for safe operation, warnings, and cautions. If you use your tool properly and for intended purpose, you will enjoy years of safe, reliable service.

NEED HELP? CONTACT US!

Have product questions? Need technical support?
Please feel free to contact us at:

 **800-232-1195** (M-F 8AM-5PM CST)

 techsupport@wenproducts.com

 WENPRODUCTS.COM



TABLE OF CONTENTS

Technical Data	2
General Safety Rules	3
Specific Safety Rules For Sander	4
Electrical Information	6
Know Your Belt Sander	7
Preparation and Adjustment	8
Operation	9
Exploded View and Parts List	10
Maintenance	12
Warranty	13

TECHNICAL DATA

Model Number:	6318
Motor:	120 V, 60 Hz, 6A
Speed:	820 feet per minute
Belt Size:	3 x 18 in.
Weight:	5.5 lbs
Dimensions:	10 x 6 x 5.5 in.

GENERAL SAFETY RULES

Safety is a combination of common sense, staying alert and knowing how your item works.

SAVE THESE SAFETY INSTRUCTIONS.



WARNING! Read all safety warnings and all instructions. Failure to follow the warnings and instructions may result in electric shock, fire and serious injury. To avoid mistakes and serious injury, do not plug in your tool until the following steps have been read and understood.

WORK AREA SAFETY

1. Keep work area clean and well lit. Cluttered or dark areas invite accidents. Do not work on floor surfaces that are slippery with sawdust or wax.
2. Do not operate power tools in explosive atmospheres, such as in the presence of flammable liquids, gases or dust. Power tools create sparks which may ignite the dust or fumes.
3. Keep bystanders at a safe distance from the work area. Never allow children or pets near the tool.

ELECTRICAL SAFETY

1. Do not expose power tools to rain or wet conditions. Water entering a power tool will increase the risk of electric shock.
2. Power tool plugs must match the outlet. Never modify the plug in any way. Modified plugs with unmatching outlets will increase the risk of electric shock.
3. Do not abuse the cord. Never use the cord for carrying, pulling or unplugging the power tool. Keep cord away from heat, oil, sharp edges or moving parts. Damaged or entangled cords increase the risk of electric shock.

PERSONAL SAFETY

1. Stay alert. Watch what you are doing and use common sense when operating a power tool. Do not use a power tool while you are tired or under the influence of drugs, alcohol or medication. A moment of inattention while operating power tools may result in serious personal injury.
2. Use personal protective equipment. Always wear safety goggles at all times that comply with ANSI Z87.1. Use ear protection such as plugs or muffs during extended periods of operation. Wear a face mask or dust mask to fight the dust produced by sanding operations.



WARNING: Dust generated from certain materials can be hazardous to your health. Always operate the tool in a well-ventilated area and provide for proper dust removal. Use dust collection systems whenever possible.

3. Do not wear loose clothing, gloves, neckties, or jewelry (rings, watches, etc.) when operating the tool. Inappropriate clothing and items can get caught in moving parts and draw you in. Always wear non-slip footwear and tie back long hair.
4. Do not overreach. Keep proper footing and balance at all times. This enables better control of the power tool.

POWER TOOL USE AND CARE

1. Avoid accidental start-ups. Make sure the power switch is in the OFF position before connecting to power source, picking up or carrying the tool.

GENERAL SAFETY RULES

2. Check power tool for damaged parts. Check for misalignment of moving parts, jamming, breakage, improper mounting, or any other conditions that may affect the tool's operation. Do not use the power tool if the switch does not turn ON/OFF. Any part that is damaged should be properly repaired or replaced before use.
3. Do not force the tool to do a job for which it was not designed. Use the correct power tool and accessories and follow the instructions for your application to prevent hazardous situations.
4. Remove adjustment tools. Always make sure all adjustment tools or wrenches are removed from the tool before turning on the power tool. A key left attached to a rotating part of the power tool may result in personal injury.
5. Keep guards in place and in working order before operating the tool.
6. Use dust extraction. If devices are provided for the connection of dust extraction and collection facilities, ensure these are connected and properly used. Use of dust collection is highly recommended to reduce dust-related hazards.
7. Never leave a running tool unattended. Do not leave the tool until it has come to a complete stop.
8. Disconnect the plug from the power source. ALWAYS remove the power cord plug from the electrical outlet when making adjustments, changing parts, or storing power tools. Such preventive safety measures reduce the risk of starting the power tool accidentally.
9. Maintain power tools properly. Safely store power tools out of the reach of children. Always keep tools clean and in good working order. Follow instructions for lubricating and changing accessories.

SPECIFIC RULES FOR THE SANDER

WARNING! EXTREME CAUTION REQUIRED WHEN SANDING PAINT. The dust residue may contain LEAD which is poisonous. Exposure to even low levels of lead can cause irreversible brain and nervous system damage, to which young and unborn children are particularly vulnerable. Any pre-1960s building may have paint containing lead on wood or metal surfaces that has since been covered with additional layers of paint. Lead based paints should only be removed by a professional and should not be removed using a sander. If you suspect that paint on surfaces contains lead please seek professional advice.

WARNING! USE A FACE MASK AND DUST COLLECTION. Some wood and wood type products such as MDF (Medium Density Fiberboard) can produce dust that can be hazardous to your health. We recommend the use of a dust extraction system and an approved face mask with replaceable filters when using this machine.

1. Two-Hand Operation

This machine requires the use of two hands to ensure safe operation.

2. Maintaining a Stable Stance

Ensure proper balance when using the tool. Do not stand on ladders and step ladders during operation. If the machine is to be used on a higher and otherwise unreachable surface, a suitable and stable platform or scaffold tower with hand rails and kick boards should be used.

3. Preparing the Workpiece

Check the workpiece for any protruding nails, screw heads or anything else that could tear or damage the belt.

SPECIFIC RULES FOR THE SANDER

4. Securing the Workpiece

Never hold the workpiece in your hand or across your legs. Small workpieces must be adequately secured so that the rotating belt doesn't pick them up during the forward motion of the sander. Unstable support causes the belt to bind, resulting in a loss of control and possible injury.

5. Checking the Powercord

Make sure that the power cord is prevented from coming into contact with the machine or getting caught up on other objects preventing completion of the sanding pass.

6. Holding the Sander

Keep handles and hands dry, clean and free from oil and grease. Hold the power tool by the insulated gripping surfaces only in case the belt contacts its own cord. Cutting a "live" wire may make exposed metal parts of the tool "live" and could give the operator an electric shock.

7. Sand on Dry Surfaces Only

This machine is to be used for dry sanding only. Do not attempt to use for wet sanding operations, as fatal electric shock may occur.

8. Starting the Sander

Always start the sander before the sanding belt is in contact with the workpiece. Let the sander reach full speed before using the tool. Do not start the machine whilst it is in contact with the workpiece.

9. Sanding the Workpiece

CAUTION: when the machine contacts the workpiece it will have a tendency to grab and pull forward. Resist the forward motion and keep the belt sander moving at an even pace. Never pull the tool backwards over the workpiece. Sand in the direction of the grain whenever possible. Remove the sanding dust between each grade of sanding sheet. Never leave the machine unattended while it is still running.

10. Setting Down the Sander

Wait for the belt to stop before setting the tool down. An exposed rotating belt may engage the surface, leading to possible loss of control and serious injury. Always lay the sander on its side to prevent accidents if the machine is inadvertently started.

11. Unplug Your Sander

Ensure that the sander is disconnected from the main supply before servicing, lubricating, making adjustments, changing accessories, or replacing sanding belts. Accidental start-ups may occur if the tool is plugged in during an accessory change. Before plugging the tool back in, check that the trigger is OFF.

12. Replacing the Sanding Belt

Replace the sanding belt as soon as it becomes worn or torn. Torn sanding belts can cause deep scratches that are difficult to remove. Ensure that the sanding belt is the correct size for the machine. After changing a sanding belt, rotate the belt to make sure it doesn't hit any part of the tool.

13. Cleaning your Sander

Clean and maintain your tool periodically. When cleaning a tool, be careful not to disassemble any portion of the tool. Internal wires may be misplaced or pinched and safety guard return springs may be improperly mounted. Certain cleaning agents such as gasoline, carbon tetrachloride, ammonia, etc. may damage plastic parts.

ELECTRICAL INFORMATION

GROUNDING INSTRUCTIONS

IN THE EVENT OF A MALFUNCTION OR BREAKDOWN, grounding provides the path of least resistance for an electric current and reduces the risk of electric shock. This tool is equipped with an electric cord that has an equipment grounding conductor and a grounding plug. The plug **MUST** be plugged into a matching outlet that is properly installed and grounded in accordance with **ALL** local codes and ordinances.

DO NOT MODIFY THE PLUG PROVIDED. If it will not fit the outlet, have the proper outlet installed by a licensed electrician.

IMPROPER CONNECTION of the equipment grounding conductor can result in electric shock. The conductor with the green insulation (with or without yellow stripes) is the equipment grounding conductor. If repair or replacement of the electric cord or plug is necessary, **DO NOT** connect the equipment grounding conductor to a live terminal.

CHECK with a licensed electrician or service personnel if you do not completely understand the grounding instructions or whether the tool is properly grounded.

CAUTION: In all cases, make certain the outlet in question is properly grounded. If you are not sure, have a licensed electrician check the outlet.



WARNING: This tool is for indoor use only. Do not expose to rain or use in damp locations.

GUIDELINES FOR USING EXTENSION CORDS

AMPERAGE	REQUIRED GAUGE FOR EXTENSION CORDS			
	25 ft.	50 ft.	100 ft.	150 ft.
6A	18 gauge	16 gauge	16 gauge	14 gauge

Make sure your extension cord is in good condition. When using an extension cord, be sure to use one heavy enough to carry the current your product will draw. An undersized cord will cause a drop in line voltage resulting in loss of power and overheating. The table below shows the correct size to be used according to cord length and nameplate ampere rating. When in doubt, use a heavier cord. The smaller the gauge number, the heavier the cord.

Make sure your extension cord is properly wired and in good condition. Always replace a damaged extension cord or have it repaired by a qualified person before using it.

Protect your extension cords from sharp objects, excessive heat and damp/wet areas.

Use a separate electrical circuit for your tools. This circuit must not be less than a #12 wire and should be protected with a 15 A time-delayed fuse. Before connecting the motor to the power line, make sure the switch is in the **OFF** position and the electric current is rated the same as the current stamped on the motor nameplate. Running at a lower voltage will damage the motor.

WARNING: This tool must be grounded while in use to protect the operator from electric shock.

KNOW YOUR BELT SANDER

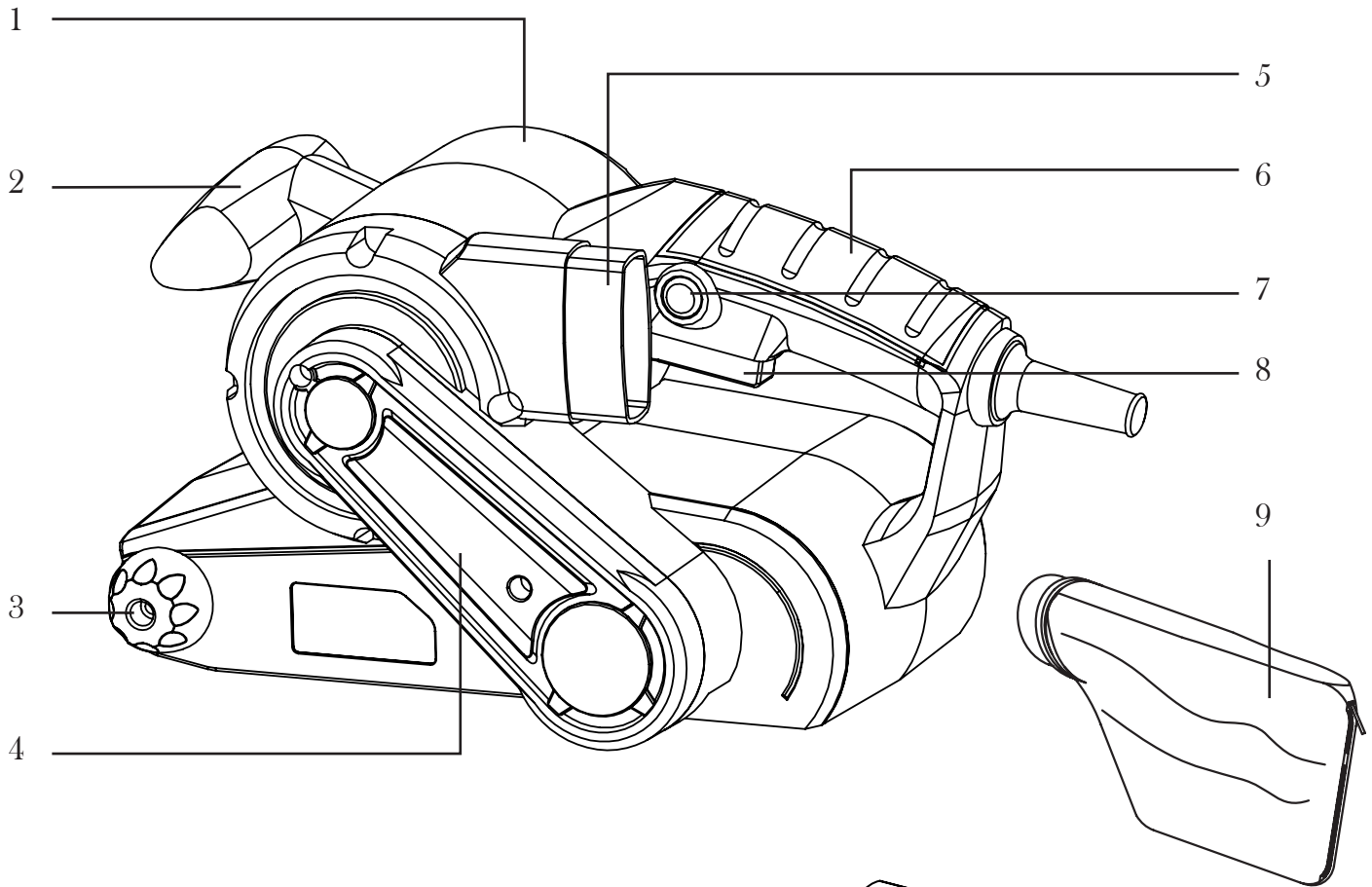

- 1. Belt Sander Casing
- 2. Front Handle
- 3. Tracking Adjustment Knob
- 4. Drive Belt Cover
- 5. Dust Extraction Outlet
- 6. Rear Handle
- 7. Continuous Running Switch
- 8. On/Off Switch
- 9. Sawdust Collector Bag
- 10. Belt Tensioning Lever
- 11. Front Roller

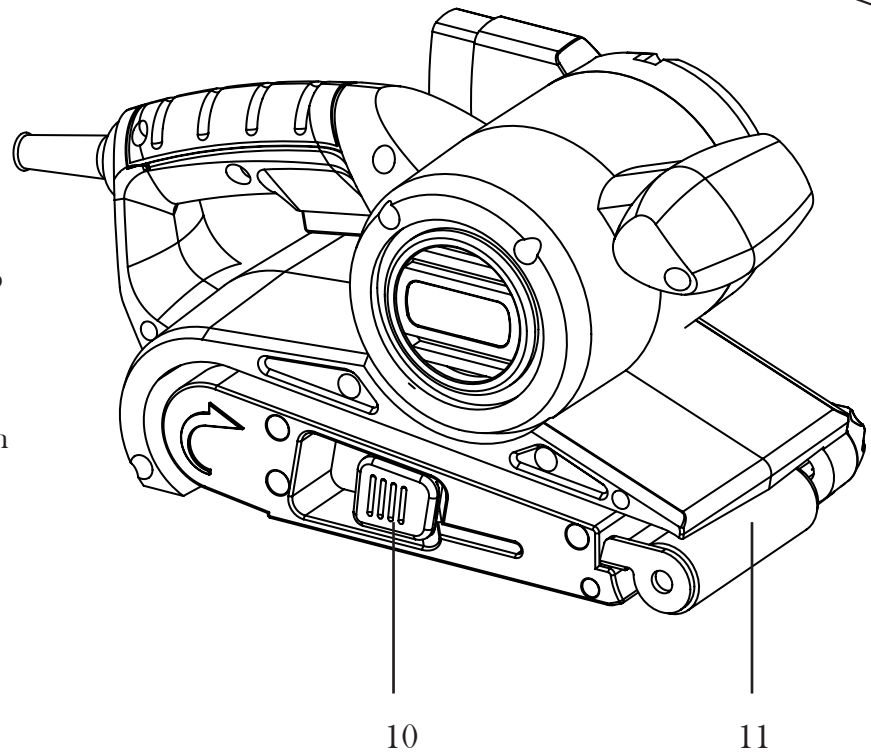

PREPARATION AND ADJUSTMENT

CHOOSING SANDING BELTS

Sanding belts come in different grades from rough through to smooth. Select the grade required for the particular job. Refer to the table below for the type and applications of different grades.

Grit	Type	Applications
Up to 60	Very coarse	Rough work, removing hard paint, shaping wood.
80 to 100	Course	Removing paint, smoothing rough surfaces (e.g. unplanned wood).
120 to 150	Medium Course	Smoothing planed wood.
180 to 220	Fine	Sanding between coats of paint.
240 or Higher	Very Fine	Finishing off.

INSTALLING OR REPLACING THE SANDING BELT

1. Turn the sander upside down and set it on a stable surface.
2. Pull out the belt tension lever (Fig. 1 - 1) to retract the front roller (Fig. 1 - 2) and loosen the belt's tension.
3. Slide the sanding belt off if there is an existing one.
4. Mount a new sanding belt on the rollers. Make sure that the arrow on the inside of the belt is pointing the same direction as indicated on the tool (Fig. 1 - 3). Check to make sure that the sanding belt does not touch the sides of the casing before turning on the machine.
5. Carefully push the tension lever (Fig. 1 - 1) back to the original position, making sure that it has fully closed.
6. Check that the new belt runs on the center of the rollers. Do this by starting the belt sander to watch how the sanding belt runs. If it shifts along the rollers towards the left or the right, it will require adjustments.
7. To adjust the sanding belt, use the tracking adjustment knob (Fig. 2 - 1), turning it either clockwise or counterclockwise to adjust the angle of the front roller. Run the sander for a short period of time and adjust the tracking until the sanding belt is running in the center of the roller.

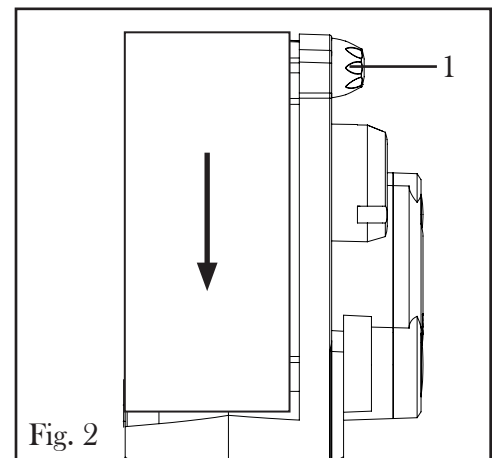
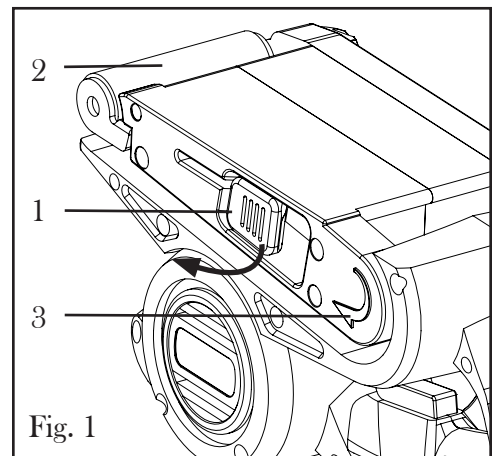

DUST COLLECTION

This sander comes with a dust extraction outlet (Fig. 3 - 1) and collection bag (Fig. 3 - 2). When sanding wood, the dust bag should be used.

CAUTION: When sanding metal, the dust bag should not be used, as there may be a risk of fire due to flying sparks.

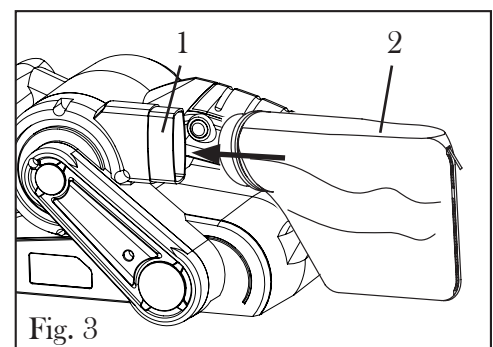

OPERATION



CAUTION: Never cover the air vents. They must always be open for proper motor cooling. Make sure that the work piece is free of nails and other foreign objects that could tear the abrasive belt.

1. Hold the machine firmly with both hands and assume a balanced position.
2. Pull the trigger switch and allow the motor to reach full speed. For continuous operation, press in the power lock-on button located on the side of the handle (Fig. 4 - 1).
3. Hold the machine parallel to the work piece. Gently bring belt into contact with the surface. **CAUTION!** The sander may initially lunge forward. Resist the forward motion and keep the belt sander moving at an even pace.

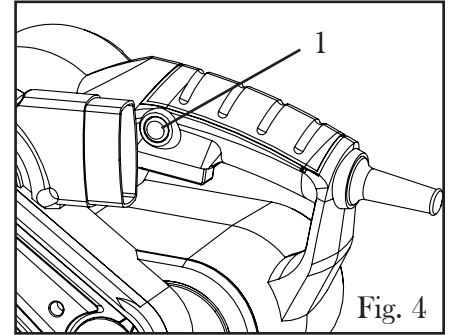

Fig. 4

Never exert excessive pressure on the tool. The weight of the tool applies adequate pressure. Excessive pressure prevents proper sanding, leaving an uneven finish and excess wear to both the tool and the abrasive belt.

4. At the end of the sanding lift the belt sander off the work piece before turning off the switch. Wait until the belt has stopped rotating before setting down the tool on its side.

CAUTION! If the sander makes an unfamiliar sound or vibrates excessively switch it off immediately and disconnect from the power supply. Investigate the cause or consult a service center for advice.

EXPLODED VIEW AND PARTS LIST

Number	Part Number	Description	Qty	
1	6318-001	Power Cord	1	
2	6318-002	Cord Sleeve	1	
3	6318-003	Screw	2	
4	6318-004	Cord Clamp	1	
5	6318-005	Capacitors	1	
6	6318-006	Switch	1	
7	6318-007	Support Bracket	1	
8	6318-008	Screw	10	
9	6318-009	Label	1	
10	6318-010	Right housing	1	
11		Middle Housing	1	
12		Ceramic Block	1	
13	6318-013	Retaining Ring	1	
14	6318-014	Washer	2	
15	6318-015	Adjustment Knob	1	
16	6318-016	Stator	1	
17	6318-017	Screw	2	
18	6318-018	Rotor Guide	1	
19	6318-019	Damper	1	
20	6318-020	Brush Housing	2	
21		Brush Holder	2	
22	6318-022	Brush	2	
23	6318-023	Bearing 626-2Z	1	
24		Rotor	1	
25	6318-025	Spring	1	
26	6318-026	Small Spring	1	
27	6318-027	Belt Latch	1	
28		Washer	1	
29		Washer	2	
30		Bearing 626-2Z	2	
31		Roller	1	
32		Shaft	1	
33		Belt Support	1	
34		Screw	1	
35		6318-035	Base Plate	1

Number	Part Number	Description	Qty
36	6318-036	Belt Housing	1
37	6318-037	Screw	2
38	6318-038	Screw	3
39	6318-039	Bearing Cover	1
40	6318-040	Bearing 608-RS	1
41	6318-041	Left Housing	1
42	6318-042	Screw	4
43	6318-043	Screw	2
44	6318-044	Small Gear	1
45	6318-045	Timing Belt	1
46	6318-046	Belt Cover	1
47	6318-047	Screw	2
48	6318-048	Belt Drive Gear	1
49	6318-049	Spring Washer	1
50	6318-050	Screw	3
51	6318-051	Bearing 627-2z	1
52	6318-052	Axial Gear	1
53	6318-053	Label	1
54	6318-054	Nut	1
55	6318-055	Belt Drum	1
56	6318-056	Washer	1
57	6318-057	Washer	1
58	6318-058	Retaining Ring	1
59	6318-059	Screw	4
60	6318-059	Drum Cover	1
61		Bearing	1
62		Sleeve	1
63		Bearing	2
64	6318-064	Washer	1
65	6318-065	Shaft	1
66		Key	1
67		Gear	1
68	6318-068	Sanding Belt 80 Grit	1
69	6318-069	Dust Bag Assembly	1

EXPLODED VIEW AND PARTS LIST

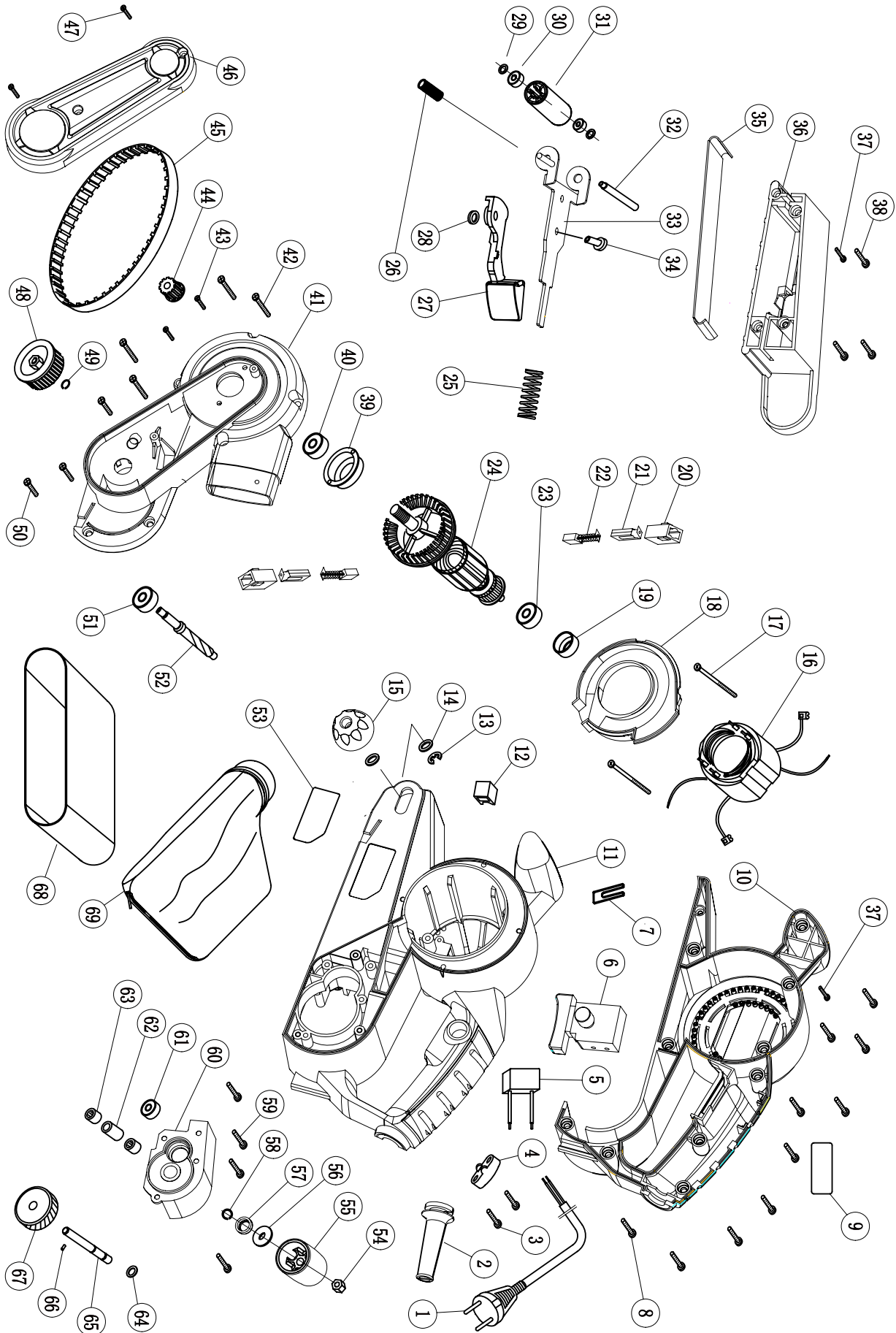

MAINTENANCE

SERVICE: Preventive maintenance performed by unauthorized personnel may result in misplacing of internal wires and components, possibly causing a serious hazard. We recommend that all tool service be performed by an authorized WEN service station.

CLEANING: Ventilation openings and switch levers must be kept clean and free of foreign matter. The tool may be cleaned most effectively with compressed dry air. Do not attempt to clean these components by inserting pointed objects through openings.

Certain cleaning agents and solvents damage plastic parts. Some of these are: gasoline, carbon tetrachloride, chlorinated cleaning solvents, ammonia and household detergents that contain ammonia.

WARNING: To avoid accidents, always disconnect the tool from the power supply before cleaning or performing any maintenance. Always wear safety goggles when cleaning tools with compressed air.

PRODUCT DISPOSAL: In order to minimize adverse environmental impact, please do not dispose of the tool in household waste. Take it to your local waste recycling center or an authorized collection and disposal facility. If in doubt consult your local waste authority for information regarding available recycling and/or disposal options.



WARNING: To avoid accidents, always disconnect the tool from the power supply before cleaning or performing any maintenance. Always wear safety goggles when cleaning tools with compressed air.

REPLACING THE DRIVE BELT

1. Locate the drive belt cover on the side of the machine.

2. Remove the cross head screws (Fig 5 - 1) with a screwdriver and take off the drive belt cover to expose the drive belt.

3. Note the position of the belt in relation to the pulleys. Rotate the large drive pulley (Fig. 6 - 1) and at the same time ease the drive belt from the motor pulley (Fig. 6 - 2).

5. Remove the drive belt and place the new drive belt over the large drive pulley. Rotate the drive pulley and at the same time ease the belt onto the motor pulley.

Ensure that the new drive belt is correctly located onto both pulleys. Make sure the drive belt rotates freely by hand and does not bind or try to jump off the pulleys.

4. Replace the drive belt cover and secure with the cross head screws.

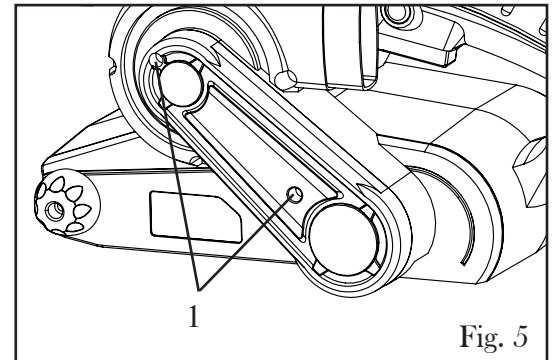

Fig. 5

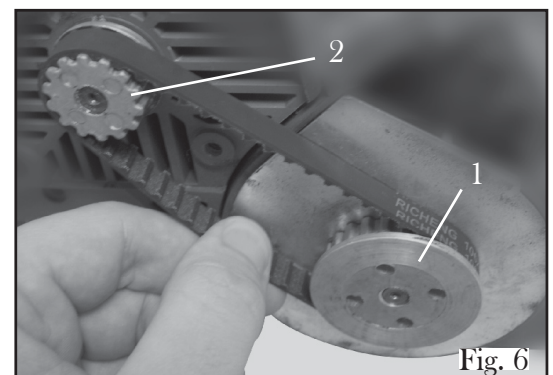

Fig. 6

EMPTYING THE DUST BAG

Although the dust bag has a substantial capacity, it should be emptied frequently. Open the zipper of the dust bag to thoroughly clean the dust bag.

LIMITED TWO YEAR WARRANTY

WEN Products is committed to building tools that are dependable for years. Our warranties are consistent with this commitment and our dedication to quality.

LIMITED WARRANTY OF WEN CONSUMER POWER TOOLS PRODUCTS FOR HOME USE

GREAT LAKES TECHNOLOGIES, LLC (“Seller”) warrants to the original purchaser only, that all WEN consumer power tools will be free from defects in material or workmanship for a period of two (2) years from date of purchase. Ninety days for all WEN products, if the tool is used for professional use.

SELLER’S SOLE OBLIGATION AND YOUR EXCLUSIVE REMEDY under this Limited Warranty and, to the extent permitted by law, any warranty or condition implied by law, shall be the repair or replacement of parts, without charge, which are defective in material or workmanship and which have not been misused, carelessly handled, or misrepaired by persons other than Seller or Authorized Service Center. To make a claim under this Limited Warranty, you must make sure to keep a copy of your proof of purchase that clearly defines the Date of Purchase (month and year) and the Place of Purchase. Place of purchase must be a direct vendor of Great Lakes Technologies, LLC. Third party vendors such as garage sales, pawn shops, resale shops, or any other secondhand merchant void the warranty included with this product. Contact techsupport@wenproducts.com or 1-800-232-1195 to make arrangements for repairs and transportation.

When returning a product for warranty service, the shipping charges must be prepaid by the purchaser. The product must be shipped in its original container (or an equivalent), properly packed to withstand the hazards of shipment. The product must be fully insured with a copy of the warranty card and/or the proof of purchase enclosed. There must also be a description of the problem in order to help our repairs department diagnose and fix the issue. Repairs will be made and the product will be returned and shipped back to the purchaser at no charge.

THIS LIMITED WARRANTY DOES NOT APPLY TO ACCESSORY ITEMS THAT WEAR OUT FROM REGULAR USAGE OVER TIME INCLUDING BELTS, BRUSHES, BLADES, ETC.

ANY IMPLIED WARRANTIES SHALL BE LIMITED IN DURATION TO TWO (2) YEARS FROM DATE OF PURCHASE. SOME STATES IN THE U.S., SOME CANADIAN PROVINCES DO NOT ALLOW LIMITATIONS ON HOW LONG AN IMPLIED WARRANTY LASTS, SO THE ABOVE LIMITATION MAY NOT APPLY TO YOU.

IN NO EVENT SHALL SELLER BE LIABLE FOR ANY INCIDENTAL OR CONSEQUENTIAL DAMAGES (INCLUDING BUT NOT LIMITED TO LIABILITY FOR LOSS OF PROFITS) ARISING FROM THE SALE OR USE OF THIS PRODUCT. SOME STATES IN THE U.S. AND SOME CANADIAN PROVINCES DO NOT ALLOW THE EXCLUSION OR LIMITATION OF INCIDENTAL OR CONSEQUENTIAL DAMAGES, SO THE ABOVE LIMITATION OR EXCLUSION MAY NOT APPLY TO YOU.

THIS LIMITED WARRANTY GIVES YOU SPECIFIC LEGAL RIGHTS, AND YOU MAY ALSO HAVE OTHER RIGHTS WHICH VARY FROM STATE TO STATE IN THE U.S., PROVINCE TO PROVINCE IN CANADA AND FROM COUNTRY TO COUNTRY.

THIS LIMITED WARRANTY APPLIES ONLY TO PORTABLE ELECTRIC TOOLS, BENCH POWER TOOLS, OUTDOOR POWER EQUIPMENT AND PNEUMATIC TOOLS SOLD WITHIN THE UNITED STATES OF AMERICA, CANADA AND THE COMMONWEALTH OF PUERTO RICO. FOR WARRANTY COVERAGE WITHIN OTHER COUNTRIES, CONTACT THE WEN CUSTOMER SUPPORT LINE.

**THANKS FOR
REMEMBERING**

