

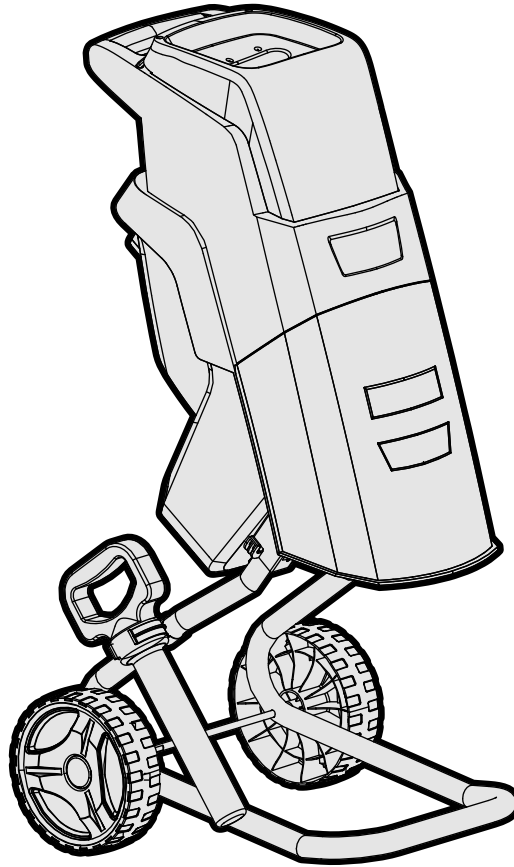

MODEL 41121

ELECTRIC WOOD CHIPPER & SHREDDER

Instruction Manual



NEED HELP? CONTACT US!

Have product questions? Need technical support? Please feel free to contact us:



1-800-232-1195 (M-F 8AM-5PM CST)



TECHSUPPORT@WENPRODUCTS.COM

IMPORTANT: Your new tool has been engineered and manufactured to WEN's highest standards for dependability, ease of operation, and operator safety. When properly cared for, this product will supply you years of rugged, trouble-free performance. Pay close attention to the rules for safe operation, warnings, and cautions. If you use your tool properly and for its intended purpose, you will enjoy years of safe, reliable service.

For replacement parts and the most up-to-date instruction manuals, visit **WENPRODUCTS.COM**

CONTENTS

WELCOME	3
Introduction	3
Specifications.....	3
SAFETY	4
General Safety Rules	4
Specific Rules for Your Shredder	6
Electrical Information.....	7
BEFORE OPERATING	8
Unpacking & Transportation	8
Know Your Shredder	9
Assembly & Adjustments.....	10
OPERATION & MAINTENANCE	11
Operation	11
Troubleshooting Guide	12
Maintenance.....	13
Exploded View & Parts List.....	15
Warranty Statement	17

To purchase accessories for your tool, visit **WENPRODUCTS.COM**

Replacement Blades (Part No. 41121B)

INTRODUCTION

Thanks for purchasing the WEN shredder. We know you are excited to put your tool to work, but first, please take a moment to read through the manual. Safe operation of this tool requires that you read and understand this operator's manual and all the labels affixed to the tool. This manual provides information regarding potential safety concerns, as well as helpful assembly and operating instructions for your tool.

 **SAFETY ALERT SYMBOL:** Indicates danger, warning, or caution. The safety symbols and the explanations with them deserve your careful attention and understanding. Always follow the safety precautions to reduce the risk of fire, electric shock or personal injury. However, please note that these instructions and warnings are not substitutes for proper accident prevention measures.

NOTE: The following safety information is not meant to cover all possible conditions and situations that may occur. WEN reserves the right to change this product and specifications at any time without prior notice.

At WEN, we are continuously improving our products. If you find that your tool does not exactly match this manual, please visit wenproducts.com for the most up-to-date manual or contact our customer service at **1-800-232-1195**.

Keep this manual available to all users during the entire life of the tool and review it frequently to maximize safety for both yourself and others.

SPECIFICATIONS

Model Number	41121
Motor	120V, 60Hz, 15A
Maximum Speed	4000 RPM
Recommended Material Diameter	0 to 1 inches (0 to 25.4 mm)
Maximum Material Diameter	1-1/2 inches (38 mm)
Cutterhead Size	7 inches
Weight	30.3 pounds
Product Dimensions	17.1 x 12.8 x 25.6 inches

GENERAL SAFETY RULES

 **WARNING!** Read all safety warnings and all instructions. Failure to follow the warnings and instructions may result in electric shock, fire and/or serious injury.

Safety is a combination of common sense, staying alert and knowing how your item works. The term “power tool” in the warnings refers to your mains-operated (corded) power tool or battery-operated (cordless) power tool.

SAVE THESE SAFETY INSTRUCTIONS.

WORK AREA SAFETY

1. **Keep work area clean and well lit.** Cluttered or dark areas invite accidents.
2. **Do not operate power tools in explosive atmospheres, such as in the presence of flammable liquids, gases or dust.** Power tools create sparks which may ignite the dust or fumes.
3. **Keep children and bystanders away while operating a power tool.** Distractions can cause you to lose control.

ELECTRICAL SAFETY

1. **Power tool plugs must match the outlet. Never modify the plug in any way. Do not use any adapter plugs with earthed (grounded) power tools.** Unmodified plugs and matching outlets will reduce risk of electric shock.
2. **Avoid body contact with earthed or grounded surfaces such as pipes, radiators, ranges and refrigerators.** There is an increased risk of electric shock if your body is earthed or grounded.
3. **Do not expose power tools to rain or wet conditions.** Water entering a power tool will increase the risk of electric shock.
4. **Do not abuse the cord. Never use the cord for carrying, pulling or unplugging the power tool. Keep cord away from heat, oil, sharp edges or moving parts.** Damaged or entangled cords increase the risk of electric shock.
5. **When operating a power tool outdoors, use an extension cord suitable for outdoor use.** Use of a cord suitable for outdoor use reduces the risk of electric shock.

6. **If operating a power tool in a damp location is unavoidable, use a ground fault circuit interrupter (GFCI) protected supply.** Use of a GFCI reduces the risk of electric shock.

PERSONAL SAFETY

1. **Stay alert, watch what you are doing and use common sense when operating a power tool. Do not use a power tool while you are tired or under the influence of drugs, alcohol or medication.** A moment of inattention while operating power tools may result in serious personal injury.
2. **Use personal protective equipment. Always wear eye protection.** Protective equipment such as a respiratory mask, non-skid safety shoes and hearing protection used for appropriate conditions will reduce the risk of personal injury.
3. **Prevent unintentional starting. Ensure the switch is in the off-position before connecting to power source and/or battery pack, picking up or carrying the tool.** Carrying power tools with your finger on the switch or energizing power tools that have the switch on invites accidents.
4. **Remove any adjusting key or wrench before turning the power tool on.** A wrench or a key left attached to a rotating part of the power tool may result in personal injury.
5. **Do not overreach. Keep proper footing and balance at all times.** This enables better control of the power tool in unexpected situations.
6. **Dress properly. Do not wear loose clothing or jewelry. Keep your hair and clothing away from moving parts.** Loose clothes, jewelry or long hair can be caught in moving parts.

GENERAL SAFETY RULES

 **WARNING!** Read all safety warnings and all instructions. Failure to follow the warnings and instructions may result in electric shock, fire and/or serious injury.

Safety is a combination of common sense, staying alert and knowing how your item works. The term “power tool” in the warnings refers to your mains-operated (corded) power tool or battery-operated (cordless) power tool.

SAVE THESE SAFETY INSTRUCTIONS.

7. If devices are provided for the connection of dust extraction and collection facilities, ensure these are connected and properly used. Use of dust collection can reduce dust-related hazards.

POWER TOOL USE AND CARE

1. **Do not force the power tool. Use the correct power tool for your application.** The correct power tool will do the job better and safer at the rate for which it was designed.

2. **Do not use the power tool if the switch does not turn it on and off.** Any power tool that cannot be controlled with the switch is dangerous and must be repaired.

3. **Disconnect the plug from the power source and/or the battery pack from the power tool before making any adjustments, changing accessories, or storing power tools.** Such preventive safety measures reduce the risk of starting the power tool accidentally.

4. **Store idle power tools out of the reach of children and do not allow persons unfamiliar with the power tool or these instructions to operate the power tool.** Power tools are dangerous in the hands of untrained users.

5. **Maintain power tools. Check for misalignment or binding of moving parts, breakage of parts and any other condition that may affect the power tool's operation. If damaged, have the power tool repaired before use.** Many accidents are caused by poorly maintained power tools.

6. **Keep cutting tools sharp and clean.** Properly maintained cutting tools with sharp cutting edges are less likely to bind and are easier to control.

7. **Use the power tool, accessories and tool bits, etc. in accordance with these instructions, taking into account the working conditions and the work to be performed.** Use of the power tool for operations different from those intended could result in a hazardous situation.

8. **Use clamps to secure your workpiece to a stable surface.** Holding a workpiece by hand or using your body to support it may lead to loss of control.

9. **KEEP GUARDS IN PLACE** and in working order.

SERVICE

1. **Have your power tool serviced by a qualified repair person using only identical replacement parts.** This will ensure that the safety of the power tool is maintained.

CALIFORNIA PROPOSITION 65 WARNING

Some dust created by power sanding, sawing, grinding, drilling, and other construction activities may contain chemicals, including lead, known to the State of California to cause cancer, birth defects, or other reproductive harm. Wash hands after handling. Some examples of these chemicals are:

- Lead from lead-based paints.
- Crystalline silica from bricks, cement, and other masonry products.
- Arsenic and chromium from chemically treated lumber.

Your risk from these exposures varies depending on how often you do this type of work. To reduce your exposure to these chemicals, work in a well-ventilated area with approved safety equipment such as dust masks specially designed to filter out microscopic particles.

SPECIFIC RULES FOR YOUR SHREDDER

 **WARNING!** Do not operate the power tool until you have read and understood the following instructions and the warning labels.

SHREDDER SAFETY

1. This shredder is designed for cutting up small branches, using the appropriate accessories. Using the machine for any other purpose for which it is not designed may result in serious injuries, machine damage and voiding of the warranty.
2. The use of accessories or attachments not recommended by the manufacturer may result in a risk of personal injury.
3. Preventing accidental starting. Make sure the power switch is in the OFF position prior to plugging in the machine. Always make sure the power switch is in the OFF position and the machine is unplugged when doing any cleaning, adjustments, assembly, setup operations, or when not in use.

PERSONAL SAFETY

1. Do not use the shredder in rainy or wet locations. Do not operate in gaseous or explosive atmospheres or near flammable or combustible liquids. The motor may spark and ignite fumes.
2. The shredder must be used in the upright position only. Do not operate the shredder with it lying on its side. Do not tilt the shredder while it is running.
3. Wear ANSI Z87.1-approved safety goggles to protect your eyes. Use hearing protection to protect yourself from hearing loss.
4. DO NOT wear loose clothing or jewelry as they might get drawn in by the tool. Tie back long hair. Wear rubber gloves and non-slip footwear.
5. People with pacemakers should consult their physician(s) before use. Electromagnetic fields in close proximity to pacemakers could cause pacemaker interference or pacemaker failure.
6. Chips are harmful to your health. Use NIOSH-approved dust masks or other respiratory protection during operation and cleaning.

PREPARING THE SHREDDER

1. Use the wheels and handle to transport the shredder. Never carry the device by its guards or its accessories.
2. Examine the shredder for any damaged or missing parts. Replace or repair damaged parts before operation. Periodically check that all nuts, bolts and other fasteners are properly tightened.
3. Do not operate this tool until it is completely assembled and installed according to the instructions. Make sure all adjustments are correct and all connections are tight. Keep all guards in place. Make sure that the hopper inlet is empty before starting the shredder.

DURING OPERATION

1. Examine materials before feeding them into the shredder. Make sure to remove pieces of metal, rocks, bottles, cans or other foreign objects. Before you shred roots, remove any remaining soil and stones from them. Do not shred soft, damp material such as kitchen waste.
2. Feed materials slowly. Always use the paddle supplied with your shredder to push items into the hopper. Do not force materials into the hopper. Do not feed materials larger than the recommended diameter of 1.5 inches, otherwise you may clog the shredder and damage the machine.
3. Keep clear of moving parts and openings. Keep arms, hands and other vital appendages away from the hopper, blades, and discharge chute. Never put your hands into the hopper while the shredder is running. Always stand clear of the discharge zone when operating the shredder. Never reach under the hopper until the shredder has come to a complete stop and has been disconnected from the power supply. Never attempt to cut anything with the grinding wheel.
4. Do not use the shredder unless all guards are in place. Do not operate with any guard disabled, damaged, or removed. Moving guards must move freely and close instantly.

SPECIFIC RULES FOR YOUR SHREDDER

⚠ WARNING! Do not operate the power tool until you have read and understood the following instructions and the warning labels.

5. Regularly turn off the machine and clear processed material from the discharge zone. Buildup near the discharge zone may prevent proper discharge and can result in kickback of material through the hopper.
6. Turn off the shredder and disconnect it from the power supply before you leave the work area. The blades will continue to rotate for a few seconds after the unit is turned off.
7. If the cutting mechanism strikes a foreign object or if the shredder starts making any unusual noise or vibration, turn the unit off and allow it to come to a complete stop. Disconnect from the power supply and inspect the unit for damage. Check for any loose parts and tighten them as necessary.
8. Should any component of your shredder be missing/damaged or fail in any way, shut off the switch and remove the plug from power supply outlet. Have a certified technician replace the missing, damaged, or failed parts using only identical replacement parts before resuming operation.
9. If the shredder becomes clogged, turn off the shredder and disconnect it from power supply. Wait for the blades to come to a complete stop before clearing debris.
10. Maintain the shredder with care. Keep the cutting edges sharp and clean to ensure optimal performance and reduce the risk of injury.

ELECTRICAL INFORMATION

DOUBLE-INSULATED TOOLS

The tool's electrical system is double insulated where two systems of insulation are provided. This eliminates the need for the usual three-wire grounded power cord. Double insulated tools do not need to be grounded, nor should a means for grounding be added to the product. All exposed metal parts are isolated from the internal metal motor components with protecting insulation.

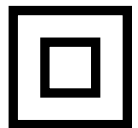

IMPORTANT: Servicing a double-insulated product requires extreme care and knowledge of the system, and should be done only by qualified service personnel using identical replacement parts. Always use original factory replacement parts when servicing.

1. Polarized Plugs. To reduce the risk of electric shock, this equipment has a polarized plug (one blade is wider than the other). This plug will fit in a polarized outlet only one way. If the plug does not fit fully in the outlet, reverse the plug. If it still does not fit, contact a qualified electrician to install a proper outlet. Do not modify the machine plug or the extension cord in any way.
2. Ground fault circuit interrupter protection (GFCI) should be provided on the circuit or outlet used for this power tool to reduce the risk of electric shock.
3. Service and repair. To avoid danger, electrical appliances must only be repaired by qualified service technician using original replacement parts.

ELECTRICAL INFORMATION

GUIDELINES AND RECOMMENDATIONS FOR EXTENSION CORDS

When using an extension cord, be sure to use one heavy enough to carry the current your product will draw. An undersized cord will cause a drop in line voltage resulting in loss of power and overheating. The table below shows the correct size to be used according to cord length and ampere rating. When in doubt, use a heavier cord. The smaller the gauge number, the heavier the cord.

AMPERAGE	REQUIRED GAUGE FOR EXTENSION CORDS			
	25 ft.	50 ft.	100 ft.	150 ft.
15A	14 gauge	12 gauge	Not Recommended by UL	

- 1. Examine extension cord before use.** Make sure your extension cord is properly wired and in good condition. Always replace a damaged extension cord or have it repaired by a qualified person before using it.
- 2. Do not abuse extension cord.** Do not pull on cord to disconnect from receptacle; always disconnect by pulling on plug. Disconnect the extension cord from the receptacle before disconnecting the product from the extension cord. Protect your extension cords from sharp objects, excessive heat and damp/wet areas.
- 3. Use a separate electrical circuit for your tool.** This circuit must not be less than a 12-gauge wire and should be protected with a 15A time-delayed fuse. Before connecting the motor to the power line, make sure the switch is in the OFF position and the electric current is rated the same as the current stamped on the motor nameplate. Running at a lower voltage will damage the motor.

UNPACKING & TRANSPORTATION

⚠ WARNING! Do not plug in or turn on the tool until it is fully assembled according to the instructions. Failure to follow the safety instructions may result in serious personal injury.

UNPACKING

With the help of a friend or trustworthy foe, carefully remove the shredder from the packaging. Make sure to take out all contents and accessories. Do not discard the packaging until everything is removed. Check the packing list below to make sure you have all of the parts and accessories. If any part is missing or broken, please contact our customer service at **1-800-232-1195** (M-F 8-5 CST), or email techsupport@wenproducts.com.

PACKING LIST

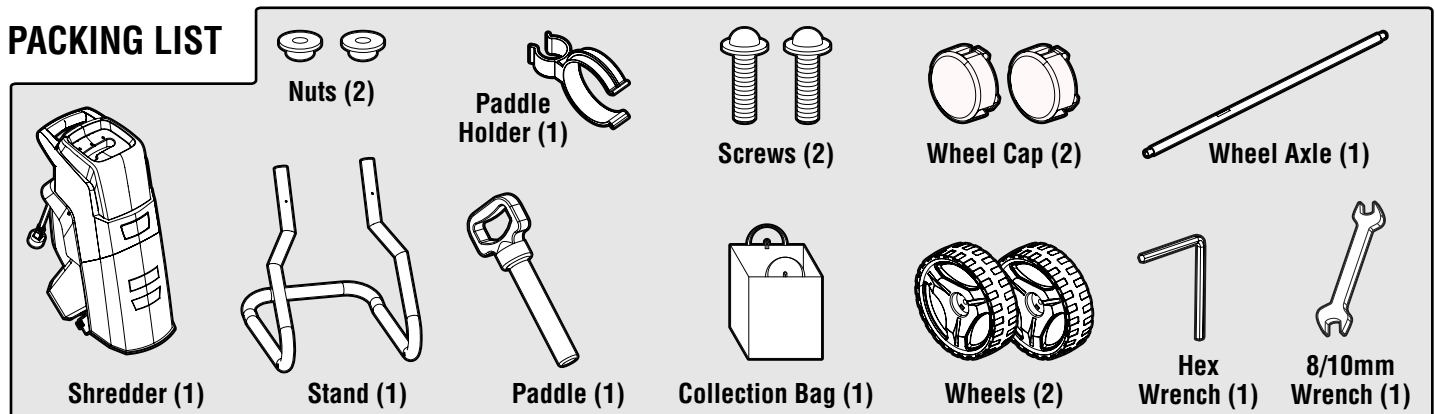

TRANSPORTING

Use the handle and tilt the shredder to pull it with the wheels. Never carry the tool by its guards or its accessories.

KNOW YOUR SHREDDER

TOOL PURPOSE

Your shredder is designed to cut up small branches and yard waste. Refer to the following diagrams to become familiarized with all the parts and controls of your shredder. The components will be referred to later in the manual for assembly and operation instructions.

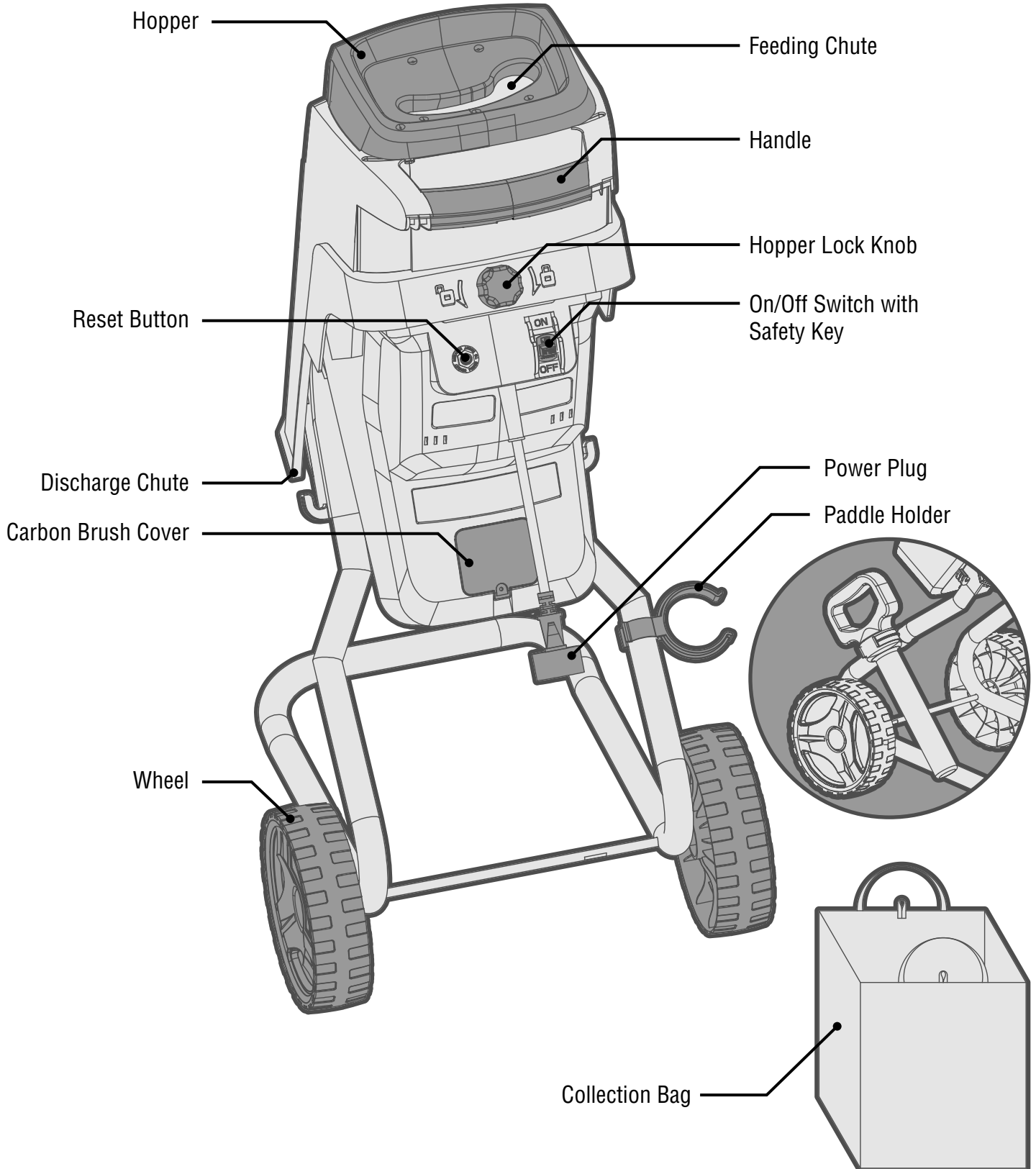

ASSEMBLY & ADJUSTMENTS

⚠ WARNING! Do not plug in or turn on the tool until it is fully assembled according to the instructions. Read through and become familiarized with the following procedures of handling and adjusting your tool. Failure to follow the safety instructions may result in serious personal injury.

ASSEMBLING THE WHEELS & STAND (FIG. 1)

1. Insert the wheel axle (A) through the bottom holes of the stand (B).
2. Slide the wheels (C) onto both ends of the wheel axle. Secure each wheel with a nut (D).
3. Snap the wheel covers (E) into each wheel.
4. Insert the two ends of the stand assembly into the bottom of the shredder housing (F). Align the holes and secure with screws (G).

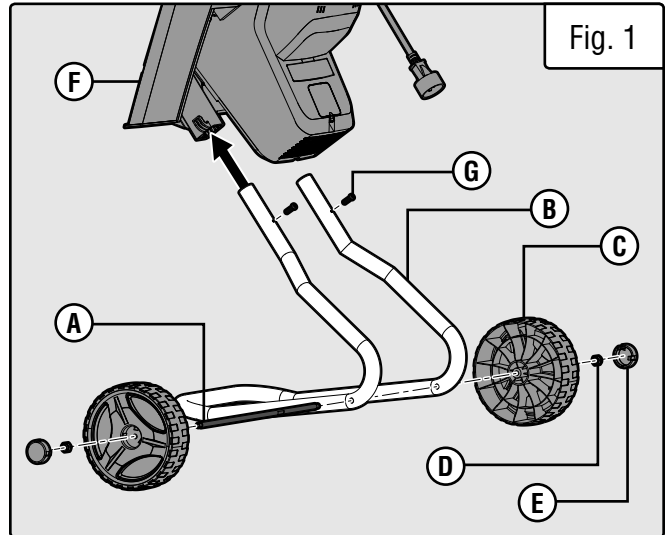

INSTALLING THE PADDLE HOLDER (FIG. 2)

1. Clip the paddle holder (A) onto one side of the stand.
2. Clip the paddle (B) into the paddle holder.

NOTE: Place the paddle back into the paddle holder every time after using.

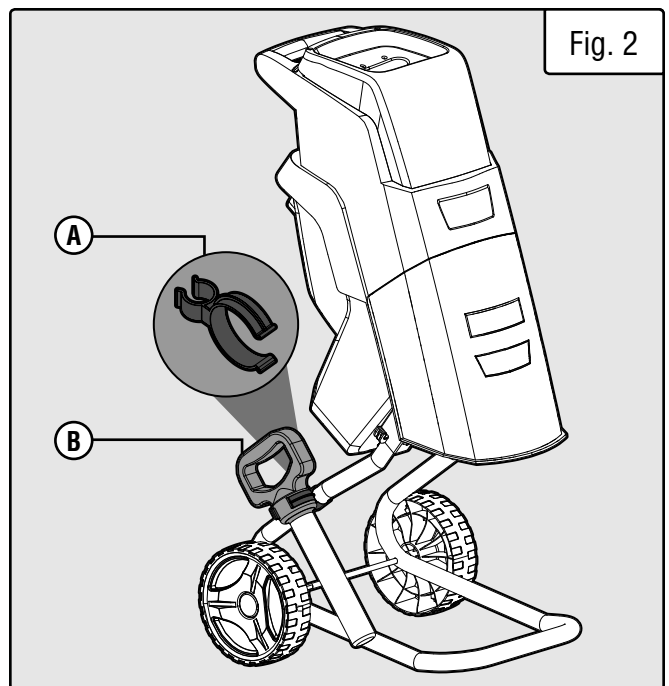

CONNECTING THE EXTENSION CORD (FIG. 3)

1. Make sure the power switch is in the OFF position.
2. Select the correct extension cord according to "Electrical Information" on page 8.
3. Make a knot with the power cord (B) and the extension cord (A).
4. Connect the plug and receptacle.

COLLECTING SHREDDED MATERIAL

Your shredder comes with a collection bag. Place the collection bag under the discharge chute to collect shredded material. See page 9.

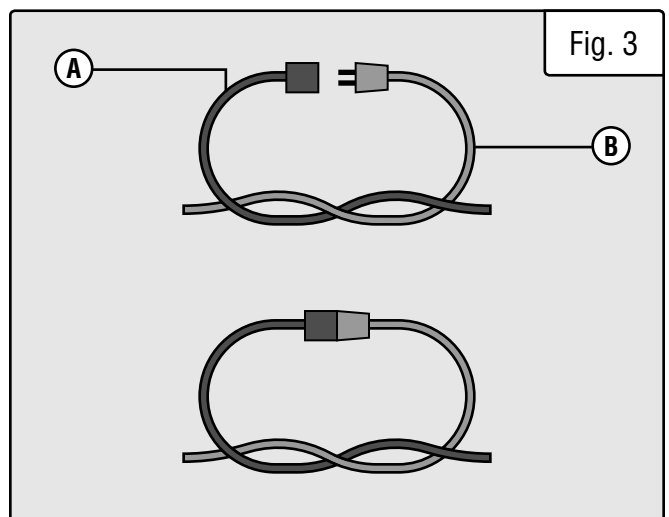

OPERATION

⚠ WARNING! Do not plug in or turn on the tool until it is fully assembled according to the instructions. Read through and become familiarized with the following procedures of handling and adjusting your tool. Failure to follow the safety instructions may result in serious personal injury.

⚠ WARNING! Wear ANSI Z87.1-approved safety glasses, work-appropriate clothing, work gloves, and dust mask. Read through the safety section. Do not allow any part of the body or your clothing near the feeding chute or the discharge chute. Never reach under the hopper until the shredder has come to a complete stop and has been disconnected from the power supply.

BASIC SHREDDING OPERATION (FIG. 4)

1. Place the shredder on a dry, level ground in the upright position. Do not operate the shredder if it is tilted or lying on its side.

2. Check to make sure that the hopper is empty. Close the hopper tightly by turning the hopper lock knob (A) clockwise. The shredder will not run if the hopper is open or not fully closed.

3. Inappropriate materials may damage the machine and cutting blades. Examine all materials before feeding them into the shredder:

- Remove pieces of metal, rocks or other foreign objects that may damage the blades.
- Do not feed wooden sticks with a diameter larger than 1.5 inch.
- Before shredding roots, remove any remaining soil and stones.
- Do not shred soft, damp material such as kitchen waste.

4. Connect the shredder to the power source and turn the power switch to ON (B).

5. Follow the rules below when feeding materials:

- Only insert as much material as needed to prevent blockage of the feeding chute.
- Feed wilted and damp materials alternately with dry branches to prevent cutting blades from blocking up.
- Branches with leaves must be completely processed before new material is fed. Make sure that the chopped material can fall freely from the discharge chute.
- Maintain the working speed of the shredder and do not overload it.
- Keep a few dry branches to be shredded at the end, as they will help clean your shredder.

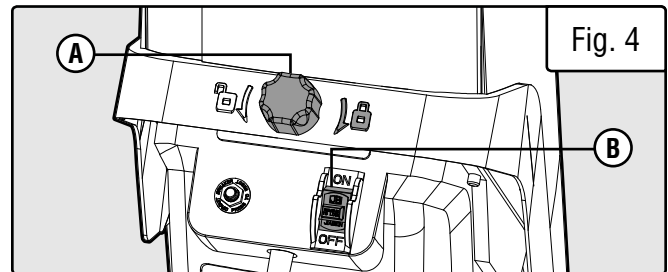

NOTE: For optimal performance, we recommend shredding materials with diameters less than 1".

NOTE: The power switch is equipped with a safety key to prevent children from accidentally starting the machine. Turn off the power switch and remove the safety key to engage the child-safety lock and prevent unwanted start-ups. The switch cannot be turned on when the safety key is removed.

6. Slowly insert the branch into the hopper through the feeding chute (p. 9). Keep hold of the branch at a safe distance from the feeding chute until it is automatically drawn into the shredder.

7. Use the included paddle to push the material inside the hopper, but be careful not to shred the paddle.

8. Only switch off the shredder after all of the shredding materials have passed through the discharge chute. Otherwise, the discharge chute may jam the next time the shredder is turned on.

9. When all shredding work is complete, switch the machine to OFF and unplug the power cord. Wait for the blades to come to a complete stop before leaving the work area.

OPERATION

OVERLOAD PROTECTION (FIG. 5)

Your electric shredder is equipped with overload protection. If the shredder is clogged during shredding, the overload protection will cut the power automatically to protect your shredder. Wait at least 1 minute for the motor to cool down before restarting the unit.

To restart the shredder:

1. Press the reset button (A).
2. Turn the power switch ON (B).

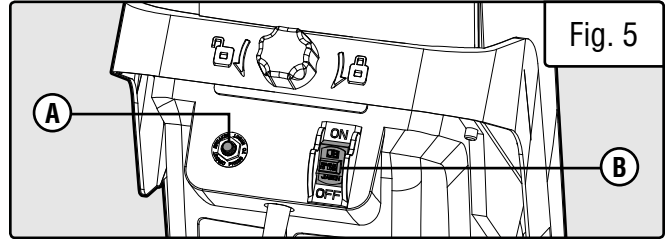

3. If the shredder will not start, it might be jammed inside. Turn the shredder OFF and unplug the power cord. Wait for the blades to come to a complete stop. Clear the clogged materials.

TROUBLESHOOTING GUIDE

⚠ WARNING! Stop using the tool immediately if any of the following problems occur. Repairs and replacements should only be performed by an authorized technician. For any questions, please contact our customer service at (800) 232-1195, M-F 8-5 CST or email us at techsupport@wenproducts.com.

PROBLEM	POSSIBLE CAUSE	SOLUTION
Motor does not start.	1. Power cord or extension cord damaged or not properly plugged in.	1. Check the power cord, extension cord, power plug, and the power outlet. Make sure the tool is properly plugged in. Do not use the tool if any cord is damaged.
	2. Safety key is removed from power switch.	2. Insert the safety key into the power switch.
	3. Motor is overloaded and circuit breaker trips.	3. The material may be too much or too hard for the shredder to handle. Wait for motor to cool down, and press the reset button. Reduce the material load and restart the shredder.
	4. The hopper is open.	4. Check that the hopper is closed and the hopper lock knob is tightened.
Material cannot be fed into the shredder.	1. The material is jammed in the feed inlet.	1. Turn off and unplug the machine. Open the hopper and remove blocked or jammed materials.
	2. The cutting blades are blocked.	2. Turn off and unplug the machine. Open the hopper and blade cover. Remove blocked material from the blade. Close the blade cover and hopper.
	3. The discharge chute is blocked.	3. Turn off and unplug the machine. Open the hopper and the plate of the discharge chute to clear the blocked material. Replace the plate and hopper.
Inefficient cutting.	1. Cutting blade edges are worn.	1. Reverse the blades or replace with new blades.

MAINTENANCE

⚠ WARNING! To avoid accidents, turn OFF and unplug the tool from the electrical outlet before cleaning, adjusting, or performing any maintenance work.

ROUTINE INSPECTION

Before each use, inspect the general condition of the tool. If any of these following conditions exist, do not use until parts are replaced or the tool is properly repaired.

Check for:

- Loose hardware,
- Misalignment or binding of moving parts,
- Damaged cord/electrical wiring,
- Cracked or broken parts, and
- Any other condition that may affect its safe operation.

CLEANING & STORAGE

1. Keep the ventilation openings free from dust and debris to prevent the motor from overheating.
2. Use a vacuum or low-pressure compressed air to remove dust and debris from the tool surfaces, motor housing and work area.
3. Wipe the tool surfaces clean with a soft cloth or brush. Make sure water does not get into the tool.

CAUTION! Most plastics are susceptible to damage from various types of commercial solvents. Do not use any solvents or cleaning products that could damage the plastic parts. Some of these include but are not limited to: gasoline, carbon tetrachloride, chlorinated cleaning solvents, and household detergents that contain ammonia.

To clean the inside of the unit, turn the hopper locking knob counterclockwise, and open the hopper. Clean the cutting blades and the discharge area. Remove wood sticks or objects that may clog the blades. Check the blades for damage and replace if they show signs of wear. Replace the hopper and lock the hopper locking knob by turning it clockwise.

4. Store the tool in a clean and dry place away from the reach of children. Store in temperatures between 41° to 86°F.

5. Cover the tool in order to protect it from dust and moisture. It is preferable to store it in its original packaging with the instruction manual and all accessories.

PRODUCT DISPOSAL

Used power tools should not be disposed of together with household waste. This product contains electronic components that should be recycled. Please take this product to your local recycling facility for responsible disposal and to minimize its environmental impact.



Please recycle the packaging and electronic components where facilities exist.

REPLACING CUTTING BLADES

The shredder comes with two cutting blades pre-installed that can be reversed or replaced to keep the cutting edges sharp. The two blades should always be reversed or replaced as a matched set.

It is recommended to replace/reverse the blades when the wood sticks can not be automatically drawn into the shredder after entering the hopper. One set of sharp edges can cut approximately 400 lbs of materials, depending on the hardness and quality of the sticks. When the cutting capacity is reached, make sure to replace/reverse the shredder blades to maintain optimal performance.

TIP: Replacement blades (Part No. 41121B) can be ordered in 2-packs at **wenproducts.com**. These are wear-out parts and therefore not covered under the warranty.

⚠ WARNING! Wear protective gloves to protect your hands. Cutting blades have sharp edges on both sides and are fragile. Handle the blades carefully to avoid personal injury or damage to the blades.

Instructions continue on the next page.

MAINTENANCE

⚠ WARNING! Wear protective gloves to protect your hands. Cutting blades have sharp edges on both sides and are fragile. Handle the blades carefully to avoid personal injury or damage to the blades.

REPLACING CUTTING BLADES (FIG. 6)

1. Turn off and unplug the machine. Wait for the blades to come to a complete stop.
2. Fully unscrew the hopper lock knob (p. 9) until it springs out. Open the hopper to access the cutting head (A).
3. Clean out all chips or foreign matter sticking to the cutting head and blades (B) using a soft brush.
4. Rotate the cutting head to the configuration shown in Fig. 6. To prevent the cutting head from rotating during blade change, insert a screwdriver through the blade guard hole (C) and the slot in the cutting head.
5. Unscrew the two hex bolts (D) on the top blade. Turn the cutting head 180 degrees to remove the other blade.
6. The blades may be reversed when one of the cutting edges becomes dull or chipped. Reverse the direction of the original blades, or install two new blades. Make sure to reverse or replace both blades at the same time so they are balanced with one another. Align the slots on the blade with the grooves on the cutting head.
7. Secure each blade with two hex bolts, firmly tighten them with a hex wrench. Close the hopper and fully tighten the hopper locking knob.

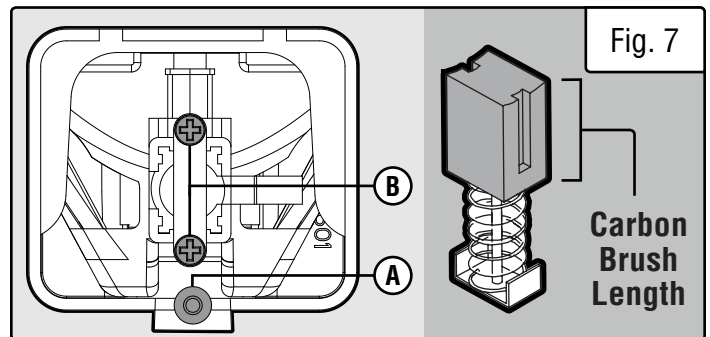
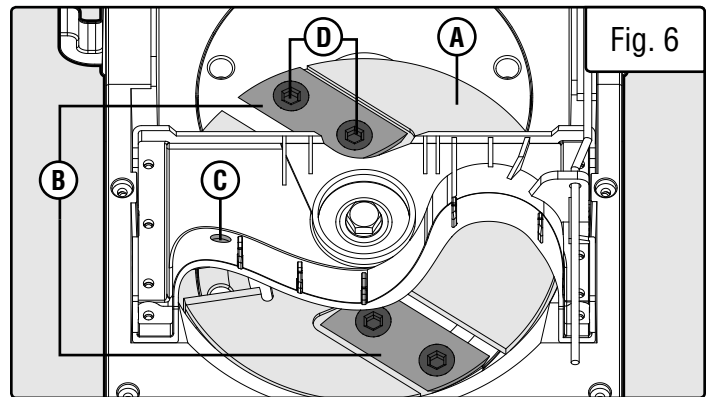

TIP: Replacement carbon brushes can be ordered at wenproducts.com (Part No. 41121-027-18). Only genuine WEN replacement brushes designed specifically for your tool should be used. Carbon brushes are not covered under the two-year warranty.

CARBON BRUSH REPLACEMENT (FIG. 7)

The wear on the carbon brushes depends on how frequently and how heavily the tool is used. To maintain maximum efficiency of the motor, we recommend inspecting the two carbon brushes every 60 hours of operation or when the tool stops working.

1. Turn off and unplug the machine. Wait for the blades to come to a complete stop.
2. The two carbon brushes can be accessed through the front and back carbon brush cover located on the bottom of the shredder body. Unscrew the Phillips head screw from the housing and open the carbon brush cover (A).
3. Unscrew the two small Phillips screws (B) to remove the carbon brush holder. Carefully remove the old carbon brushes using pliers.

NOTE: Keep track of which orientation the old carbon brushes were in to prevent needless wear if they will be reinstalled.

4. Measure the length of the brushes (Fig. 7). Install the new set of carbon brushes if either carbon brush length is worn down to 3/16" or less. Reinstall the old carbon brushes (in their original orientation) if your brushes **are not** worn down to 3/16" or less. Both carbon brushes should be replaced at the same time.

5. Replace the carbon brush holder and cover. Tighten all screws. Repeat the steps above to replace the carbon brush located on the other side of the motor.

NOTE: New carbon brushes tend to spark for a few minutes during the first use as they wear down.

EXPLODED VIEW & PARTS LIST

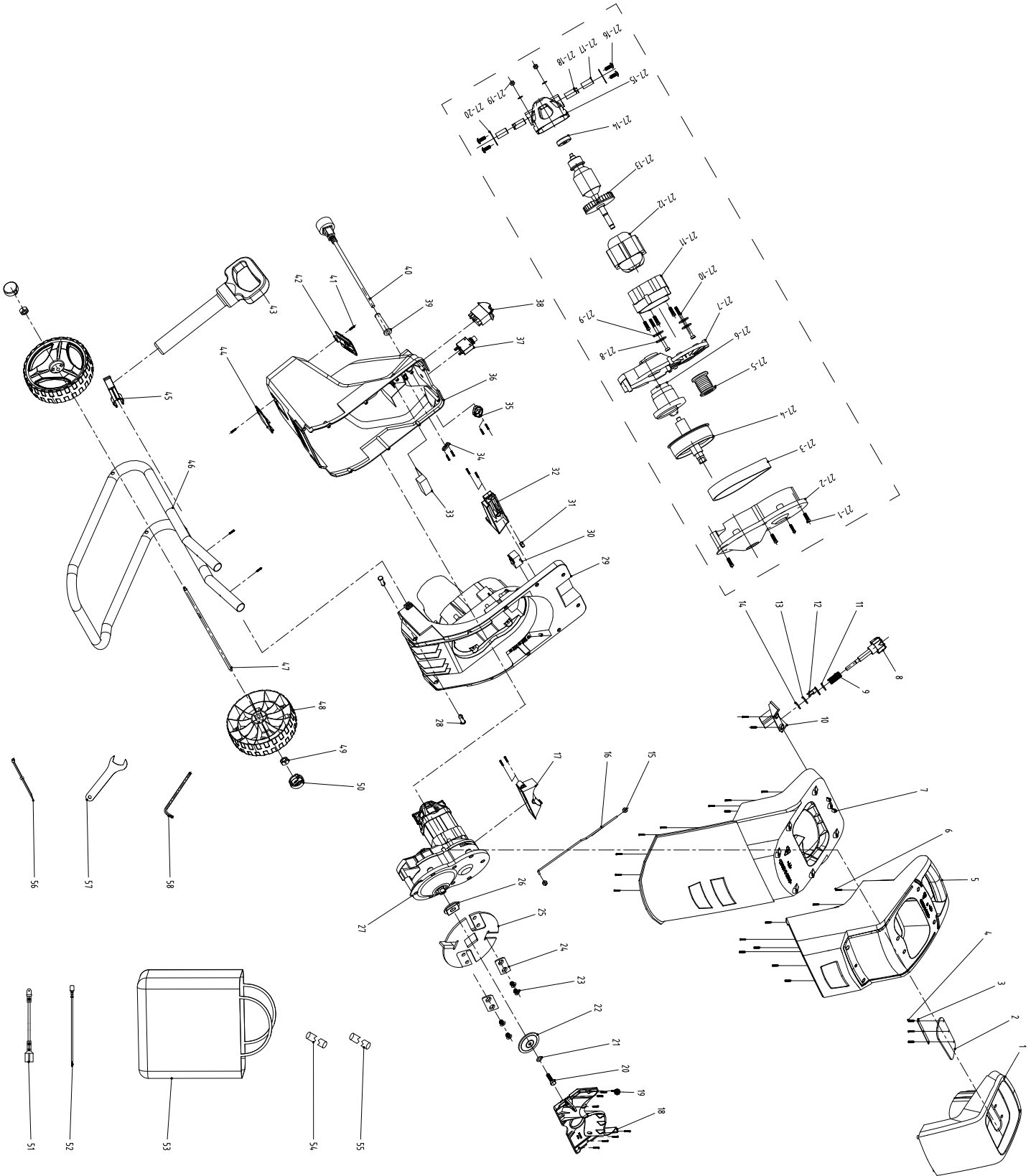

EXPLODED VIEW & PARTS LIST

No.	Part No.	Description	Qty.
1	41121-001	Hopper	1
2	41121-002	Preventer Plate	1
3	41121-003	Press Bar	1
4	41121-004	Self Tapping Screw	15
5	41121-005	Handle	1
6	41121-006	Flange Tapping Screw	17
7	41121-007	Housing	1
8	41121-008	Hopper Locking Knob	1
9	41121-009	Compression Spring	1
10	41121-010	Knob Holder	1
11	41121-011	Washer	1
12	41121-012	Switch Pin	1
13	41121-013	Washer	1
14	41121-014	Axis With Circlips	1
15	41121-015	Type 1 Non-Metallic Hex Nuts	2
16	41121-016	Pull Rod	1
17	41121-017	Air Deflector	1
18	41121-018	Dust Against Plate	1
19	41121-019	Self Tapping Screw	8
20	41121-020	Hexagon Headed Bolt	1
21	41121-021	Internal Washer	1
22	41121-022	Briquet	1
23	41121-023	Hexagon Screw	4
24	41121B	Blade	2
25	41121-025	Static Blade	1
26	41121-026	Transmission Shaft	1
27	41121-027	Motor Assembly	1
27-1	41121-027-1	Tapping Screw	19
27-2	41121-027-2	Reduction Casing Upper Cover	1
27-3	41121-027-3	Belt	1
27-4	41121-027-4	Belt-Wheel 1	1
27-5	41121-027-5	Belt-Wheel 2	1
27-6	41121-027-6	Wobbler	1
27-7	41121-027-7	Reduction Casing Lower Cover	1
27-8	41121-027-8	Spring Washer	2
27-9	41121-027-9	Flat Washer	4
27-10	41121-027-10	Stator Screw	2
27-11	41121-027-11	Motor Front Bracket	1
27-12	41121-027-12	Stator Assembly	1

No.	Part No.	Description	Qty.
27-13	41121-027-13	Rotor Assembly	1
27-14	41121-027-14	627 Bearing	1
27-15	41121-027-15	Motor Rear Bracket	1
27-16	41121-027-16	Tapping Screw	4
27-17	41121-027-17	Carbon Brush Assembly	2
27-18	41121-027-18		2
24-19	41121-027-19	Hexagon Nut	2
27-20	41121-027-20	Plate For Brush Holder	2
28	41121-028	Plastic Pin	2
29	41121-029	Base	1
30	41121-030	Strong Off Switch	1
31	41121-031	Hexagon Nut	1
32	41121-032	Safety Key	1
33	41121-033	Electrical Assembly Components	1
34	41121-034	Cable Clamp	1
35	41121-035	Sleeve Clamp	1
36	41121-036	Housing Assembly	1
37	41121-037	Overload Protector	1
38	41121-038	Dustproof Power Switch	1
39	41121-039	Cable Sleeve	1
40	41121-040	Power Cord	1
41	41121-041	Screw	2
42	41121-042	Carbon Brush Front Cover	1
43	41121-043	Push Stick	1
44	41121-044	Carbon Brush Rear Cover	1
45	41121-045	Fixing Holder	1
46	41121-046	Lower Frame	1
47	41121-047	Axle	1
48	41121-048	Wheel	2
49	41121-049	Lock Nut	2
50	41121-050	Wheel Cover	2
51	41121-051	Connecting Wire	2
52	41121-052	Connecting Wire	1
53	41121-053	Collection Bag	1
54	41121-054	Heat Shrinkable Tube	1
55	41121-055	Heat Shrinkable Tube	1
56	41121-056	Nylon Rope	2
57	41121-057	Wrench	1
58	41121-058	Hex Wrench	1

WARRANTY

WEN Products is committed to building tools that are dependable for years. Our warranties are consistent with this commitment and our dedication to quality.

LIMITED WARRANTY OF WEN PRODUCTS FOR HOME USE

GREAT LAKES TECHNOLOGIES, LLC (“Seller”) warrants to the original purchaser only, that all WEN consumer power tools will be free from defects in material or workmanship during personal use for a period of two (2) years from date of purchase or 500 hours of use; whichever comes first. Ninety days for all WEN products if the tool is used for professional or commercial use. Purchaser has 30 days from the date of purchase to report missing or damaged parts.

SELLER’S SOLE OBLIGATION AND YOUR EXCLUSIVE REMEDY under this Limited Warranty and, to the extent permitted by law, any warranty or condition implied by law, shall be the replacement of parts, without charge, which are defective in material or workmanship and which have not been subjected to misuse, alteration, careless handling, misrepair, abuse, neglect, normal wear and tear, improper maintenance, or other conditions adversely affecting the Product or the component of the Product, whether by accident or intentionally, by persons other than Seller. To make a claim under this Limited Warranty, you must make sure to keep a copy of your proof of purchase that clearly defines the Date of Purchase (month and year) and the Place of Purchase. Place of Purchase must be a direct vendor of Great Lakes Technologies, LLC. Purchasing through third party vendors, including but not limited to garage sales, pawn shops, resale shops, or any other secondhand merchant, voids the warranty included with this product. Contact tech-support@wenproducts.com or 1-800-232-1195 with the following information to make arrangements: your shipping address, phone number, serial number, required part numbers, and proof of purchase. Damaged or defective parts and products may need to be sent to WEN before the replacements can be shipped out.

Upon the confirmation of a WEN representative, your product may qualify for repairs and service work. When returning a product for warranty service, the shipping charges must be prepaid by the purchaser. The product must be shipped in its original container (or an equivalent), properly packed to withstand the hazards of shipment. The product must be fully insured with a copy of the proof of purchase enclosed. There must also be a description of the problem in order to help our repairs department diagnose and fix the issue. Repairs will be made and the product will be returned and shipped back to the purchaser at no charge for addresses within the contiguous United States.

THIS LIMITED WARRANTY DOES NOT APPLY TO ITEMS THAT WEAR OUT FROM REGULAR USAGE OVER TIME, INCLUDING BELTS, BRUSHES, BLADES, BATTERIES, ETC. ANY IMPLIED WARRANTIES SHALL BE LIMITED IN DURATION TO TWO (2) YEARS FROM DATE OF PURCHASE. SOME STATES IN THE U.S. AND SOME CANADIAN PROVINCES DO NOT ALLOW LIMITATIONS ON HOW LONG AN IMPLIED WARRANTY LASTS, SO THE ABOVE LIMITATION MAY NOT APPLY TO YOU.

IN NO EVENT SHALL SELLER BE LIABLE FOR ANY INCIDENTAL OR CONSEQUENTIAL DAMAGES (INCLUDING BUT NOT LIMITED TO LIABILITY FOR LOSS OF PROFITS) ARISING FROM THE SALE OR USE OF THIS PRODUCT. SOME STATES IN THE U.S. AND SOME CANADIAN PROVINCES DO NOT ALLOW THE EXCLUSION OR LIMITATION OF INCIDENTAL OR CONSEQUENTIAL DAMAGES, SO THE ABOVE LIMITATION OR EXCLUSION MAY NOT APPLY TO YOU.

THIS LIMITED WARRANTY GIVES YOU SPECIFIC LEGAL RIGHTS, AND YOU MAY ALSO HAVE OTHER RIGHTS WHICH VARY FROM STATE TO STATE IN THE U.S., PROVINCE TO PROVINCE IN CANADA AND FROM COUNTRY TO COUNTRY.

THIS LIMITED WARRANTY APPLIES ONLY TO ITEMS SOLD WITHIN THE UNITED STATES OF AMERICA, CANADA AND THE COMMONWEALTH OF PUERTO RICO. FOR WARRANTY COVERAGE WITHIN OTHER COUNTRIES, CONTACT THE WEN CUSTOMER SUPPORT LINE. FOR WARRANTY PARTS OR PRODUCTS REPAIRED UNDER WARRANTY SHIPPING TO ADDRESSES OUTSIDE OF THE CONTIGUOUS UNITED STATES, ADDITIONAL SHIPPING CHARGES MAY APPLY.

NOTES

