

# INSTRUCTION MANUAL

## WARRANTY STATEMENT

WEN Products is committed to building tools that are dependable for years. Our warranties are consistent with this commitment and our dedication to quality.

### LIMITED WARRANTY OF WEN CONSUMER POWER TOOLS PRODUCTS FOR HOME USE

GREAT LAKES TECHNOLOGIES, LLC ("Seller") warrants to the original purchaser only, that all WEN consumer power tools will be free from defects in material or workmanship for a period of two (2) years from date of purchase. Ninety days for all WEN products, if the tool is used for professional use.

**SELLER'S SOLE OBLIGATION AND YOUR EXCLUSIVE REMEDY** under this Limited Warranty and, to the extent permitted by law, any warranty or condition implied by law, shall be the repair or replacement of parts, without charge, which are defective in material or workmanship and which have not been misused, carelessly handled, or misrepaired by persons other than Seller or Authorized Service Center. To make a claim under this Limited Warranty, you must make sure to keep a copy of your proof of purchase that clearly defines the Date of Purchase (month and year) and the Place of Purchase. Place of purchase must be a direct vendor of Great Lakes Technologies, LLC. Third party vendors such as garage sales, pawn shops, resale shops, or any other secondhand merchant void the warranty included with this product. Contact techsupport@wenproducts.com or 1-800-232-1195 to make arrangements for repairs and transportation.

When returning a product for warranty service, the shipping charges must be prepaid by the purchaser. The product must be shipped in its original container (or an equivalent), properly packed to withstand the hazards of shipment. The product must be fully insured with a copy of the warranty card and/or the proof of purchase enclosed. There must also be a description of the problem in order to help our repairs department diagnose and fix the issue. Repairs will be made and the product will be returned and shipped back to the purchaser at no charge.

This limited warranty does not apply to accessory items that wear out from regular usage over time including belts, brushes, blades, batteries, etc.

Any implied warranties shall be limited in duration to two (2) years from date of purchase. Some states in the U.S., Some Canadian provinces do not allow limitations on how long an implied warranty lasts, so the above limitation may not apply to you.

In no event shall seller be liable for any incidental or consequential damages (including but not limited to liability for loss of profits) arising from the sale or use of this product. Some states in the U.S. And some Canadian provinces do not allow the exclusion or limitation of incidental or consequential damages, so the above limitation or exclusion may not apply to you.

This limited warranty gives you specific legal rights, and you may also have other rights which vary from state to state in the U.S., Province to province in Canada and from country to country.

This limited warranty applies only to portable electric tools, bench power tools, outdoor power equipment and pneumatic tools sold within the United States of America, Canada and the commonwealth of Puerto Rico. For warranty coverage within other countries, contact the WEN customer support line.

**THANKS FOR REMEMBERING** 



**MODEL 10711**

## MAGNETIC BASE

BASE MAGNÉTIQUE  
Compatible with 10702 (1" Dial Indicator)

## KNOW YOUR MAGNETIC BASE

### FEATURES

The magnetic base is a support for dial indicators, and can be used in multiple measuring positions.

- The device can be mounted horizontally, vertically, or upside down with the magnetic base.
- Mount to flat surfaces using the back or bottom of the base, and mount to cylindrical surfaces with the base v-groove.
- Fine adjustment knob for performing precise adjustments to the measuring device's orientation and zero point. (Fig. 1 - 9).

1. Magnetic Base
2. Lever
3. Pole
4. Support Rod
5. Support Rod Assembly
6. Clamp Knob
7. Dial Indicator Mount Hole
8. Lug Fixture
9. Fine Adjustment Knob
10. Bushing

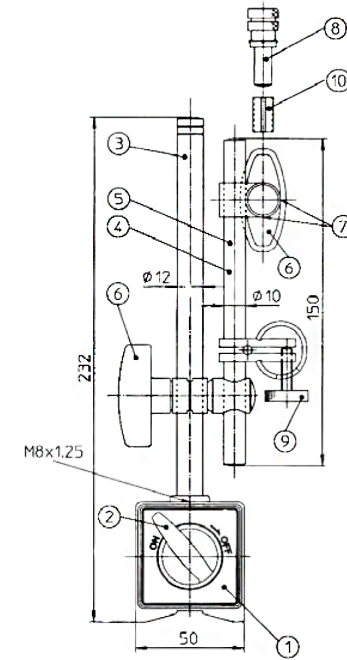

Fig. 1

## WARNING

**⚠ WARNING:** If you use a pacemaker, do not use the magnetic base. The magnetic force on the magnetic base may cause your pacemaker to malfunction.

# INSTRUCTION MANUAL

## INSTRUMENT CARE & SAFETY

**⚠ Follow the safety precautions below to reduce the risk of damaging your instrument.**

- Do not bring the magnetic base near data storage media (hard drives, USB drives, etc.). Due to the magnetic force, stored data may be deleted from these devices.
- Depending on the conditions of the surface that the magnetic base attracts (material, thickness, surface roughness, painting, scratches, rust etc.), the attractive force of the magnetic base may be reduced.
- Dropping or bumping the magnetic base may cause breakage or damage in the instrument.
- Make sure that the magnetic base is securely fastened when being used on thick-coated surfaces to prevent damage to the device or personal injury from the device falling.
- Keep the magnet base switched to OFF (right) when not in use.
- To prevent deterioration in the strength of the magnet, do not use the device near transformers or demagnetizers, as they generate a strong magnetic field which will affect the device's performance.
- Do not disassemble the arm from the magnetic base; this will affect the performance of the device.

## SPECIFICATIONS

Magnetic Force	176 lbf (782 N)
Clamping Hole	3/8" (9.53 mm)
Base	2-1/2" x 2" x 2-1/8"
	63.5 mm x 50.8 mm x 54 mm
Height (Base to top of pole)	9-1/8"

## TROUBLESHOOTING GUIDE

Problem	Possible Cause	Solution
Incorrect measurement	1. Measuring device improperly fastened	1. Refer to the "OPERATION" section for fixing instructions, and read the user's manual of the measuring device being used
Base will not magnetize	1. Surface is not suitable 2. Magnet deteriorated from improper use or storage	1. Clean surface; surface coating is too thick; use surface that can be magnetized 2. Magnet is permanently damaged

## OPERATION

**1. TO FIX A MEASURING TOOL BY THE LUG** (See Fig.2)

- Remove the nut and washer from the lug fixture thread (Fig.3).
  - Insert the threaded end of the lug into the mounting hole in the measuring device. The lug thread can be used with measuring device mounting holes at least 1/4 inch in diameter.
  - Secure the measuring device with the washer and nut.
2. Place the magnetic base in a location from which the support rod (Fig. 1 - 5) can be adjusted to bring the measuring device into contact with the surface to be measured, then turn the base ON (left) to fix the magnetic base to surface.
  3. Slightly loosen the clamp knobs, adjust the inclination and position of the support rod and measuring device, then tighten the clamp knobs to secure the tool.
  4. The fine adjustment knob can be used to precisely change the measuring device orientation and zero point.

**OR**

**1. TO FIX A MEASURING TOOL IN THE DIAL INDICATOR MOUNT HOLE** (See Fig.4)

- Loosen the clamp knob to remove the lug from the dial indicator mount hole, then insert the stem of your desired measuring device in the mount hole and temporarily clamp with the clamp knob.

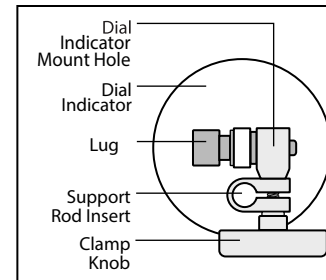

Fig. 2

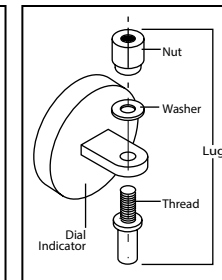

Fig. 3

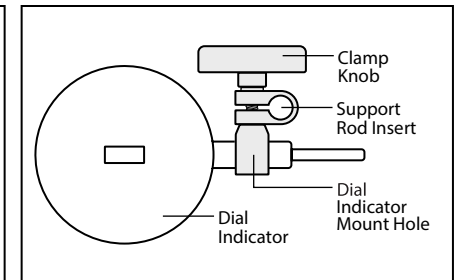

Fig. 4

**NOTE:** If fixing a measuring device with a stem less than 16mm in length, it is recommended that you fix the tool by the lug, rather than using the dial indicator mount hole.

If the instrument fails to work, please contact our customer service at (800) 232-1195, M-F 8-5 CST or email us at [techsupport@wenproducts.com](mailto:techsupport@wenproducts.com).

### NEED HELP? CONTACT US!

Have product questions? Need technical support?  
Please feel free to contact us at:

**800-232-1195 (M-F 8-5 CST)**

**techsupport@wenproducts.com**

**WENPRODUCTS.COM**