

LED 6" DOWNLIGHT CAN - 15W

INSTALL INSTRUCTIONS

PLEASE FIND A QUALIFIED ELECTRICIAN FOR INSTALLATION. Please read the instructions before you install and use the luminaire.

GENERAL: ALL ELECTRICAL CONNECTIONS MUST BE IN ACCORDANCE WITH LOCAL AND NATIONAL ELECTRICAL CODE (N.E.C.) STANDARDS. IF YOU ARE UNFAMILIAR WITH PROPER ELECTRICAL WIRING CONNECTIONS OBTAIN THE SERVICES OF A QUALIFIED ELECTRICIAN. REMOVE THE TRIM FROM THE BOX AND MAKE SURE THAT NO PARTS ARE MISSING.

- WARNING - Risk of fire or electric shock. LED Downlight Kit installation requires knowledge of luminaires electrical systems. If not qualified, do not attempt installation. Contact a qualified electrician.
- WARNING - Risk of fire or electric shock. Install this kit only in luminaires that have the construction features and dimensions shown in the photographs and/or drawings and where the input rating of the downlight kit does not exceed the input rating of the luminaire .
- Do not make or alter any open holes in an enclosure of wiring or electrical components during kit installation.
- WARNING - To prevent wiring damage or abrasion, do not expose wiring to edges of sheet metal or other sharp objects .
- Risk of Electric Shock: Disconnect power or circuit breaker before installing or servicing.
- NOTE: This device complies with part 15 of the FCC Rules. Operation is subject to the following two conditions: 1. This device may not cause harmful interference, and 2. This device must accept any interference received, including interference that may cause undesired operation.
- SUITABLE FOR WET LOCATIONS
- SUITABLE FOR TYPE IC OR SUITABLE FOR TYPE NON-IC
- USE ONLY IN OPEN LUMINAIRES
- THIS DEVICE IS NOT INTENDED FOR USE WITH EMERGENCY EXITS

ASSEMBLY AND INSTALLATION

This IC/AT fixture is intended for use in recessed cavities or suspended ceilings (with or without insulation). Choose the location for the fixture, taking into consideration the location of the joists, and electrical supply.

1. Shut off power before installation.
2. Cut a corresponding whole in ceiling. (FIG. 2)
3. When running the supply wire(s), allow an additional 18 inches of wire at each installation in order to make the electrical connections on the room side of the ceiling hole. (FIG. 2)
4. Remove the Junction Box Screws holding the Junction Box Cover. Pass the supply wire(s) through the appropriate knockout hole on Junction Box. Make the electrical connections to fit inside Junction Box following the ELECTRICAL CONNECTIONS. Make sure all connections are secure, tuck all wires inside Junction Box and reinstall Junction Box Cover being Junction Box Screws. (FIG. 3)
5. Press the top portion of the Remodel Clips against the side of the Housing Assembly. (FIG. 4)
6. Push the Housing Assembly with the top side of the Remodel Clips through the hole until tight. Continue to push the Housing Assembly until the fixture snaps into place with the trim tight against the ceiling. (FIG. 5)

DIMMABLE ONLY AVAILABLE AT 120V

Dimming performance may depend on the dimmer, the dimmer range adjustment setting (for dimmers with brightness range adjustments), the wiring method, and/or the number of LED modules installed onto the dimmer circuit.

- For dimmer selection, Dimming control manufacturers revise their product often; for the latest list of compatible dimmers please visit our website.
- For best results, it is recommended to install a maximum of four LED modules onto one dimmer.
- Before turning on the LED lights, set dimmer position at maximum before adjusting to a lower light level.
- Please follow the dimming control manufacturer's instructions for the installation of all dimming controls.



WARNING DISCONNECT POWER BEFORE INSTALLING OR SERVICING.

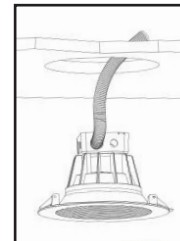

FIG. 2

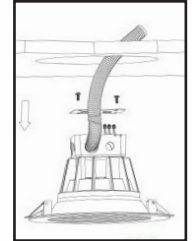

FIG. 3

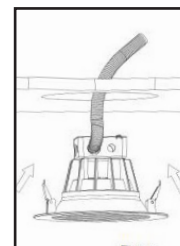

FIG. 4

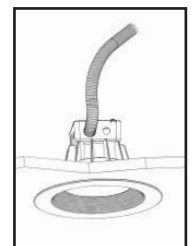

FIG. 5