

LED TROFFER FIXTURE

(New Construction)

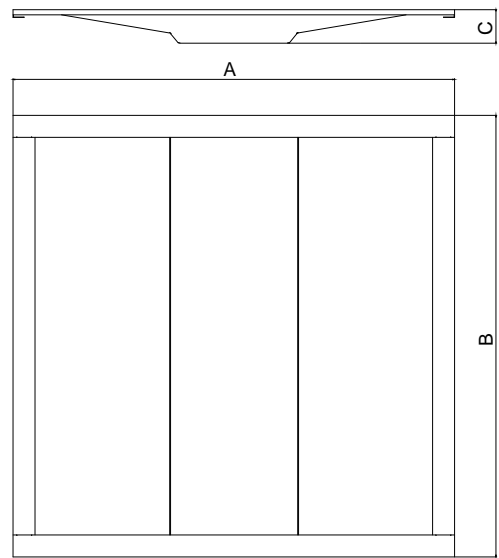

Maximum overall	A	B	C
2*4ft	603mm	1213mm	45mm

FEATURES



Input Voltage: AC120-277V

Operating Frequency: 50/60Hz

Power Factor: > 0.95

Ambient Temperature Range: -4°F ~ 113°F

Color Temperature: 3000/4000/5000K

Dimmable: 3-in-1 dimming

THD: <10%

IP Rating: IP20

CRI: >Ra80

Beam Angle: 120°

- Cloud series led troffer gives 130lm
- Suitable for Damp Location
- Five-year Limited Warranty
- ETL & DLC Premium

PARAMETER

Length	Product Code	Certification	CRI	Wattage	Description Function	Lumens 3000/4000/5000K	Packing/Carton
2x4ft	JN-T4-S60-3050	ETL/cETLus,DLC	>80	40/50/60W	3-in-1 dimming (0-10V;PWM;Rx) CCT Tunable & Power adjustable	5200/6500/7800 LM	1260*260*650mm 4 pieces 1*40HQ Loading=1360pcs

WIRING DIAGRAM

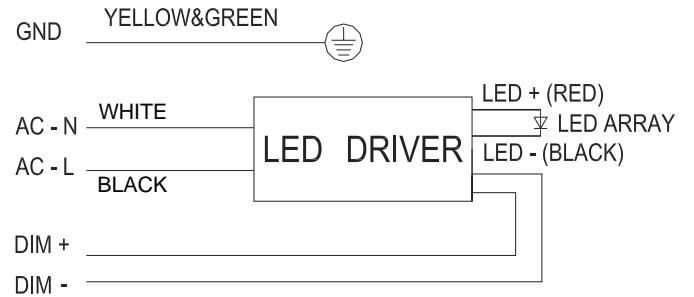
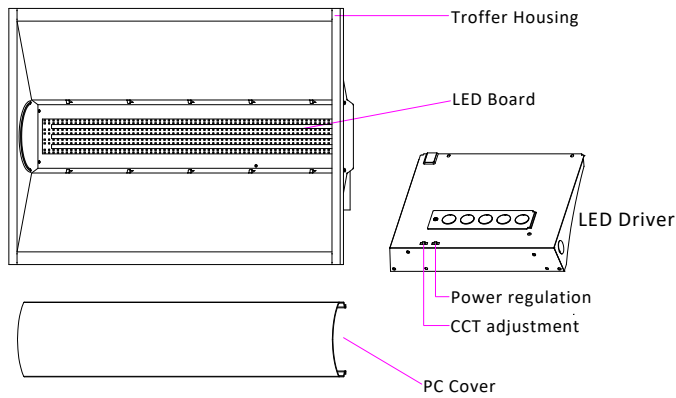

Electric Shock Attention

Ensure the power supply has been cut off before connecting the wire, and all wiring and installation of this product are required to be operated by professionals.

INSTALLATION INSTRUCTION

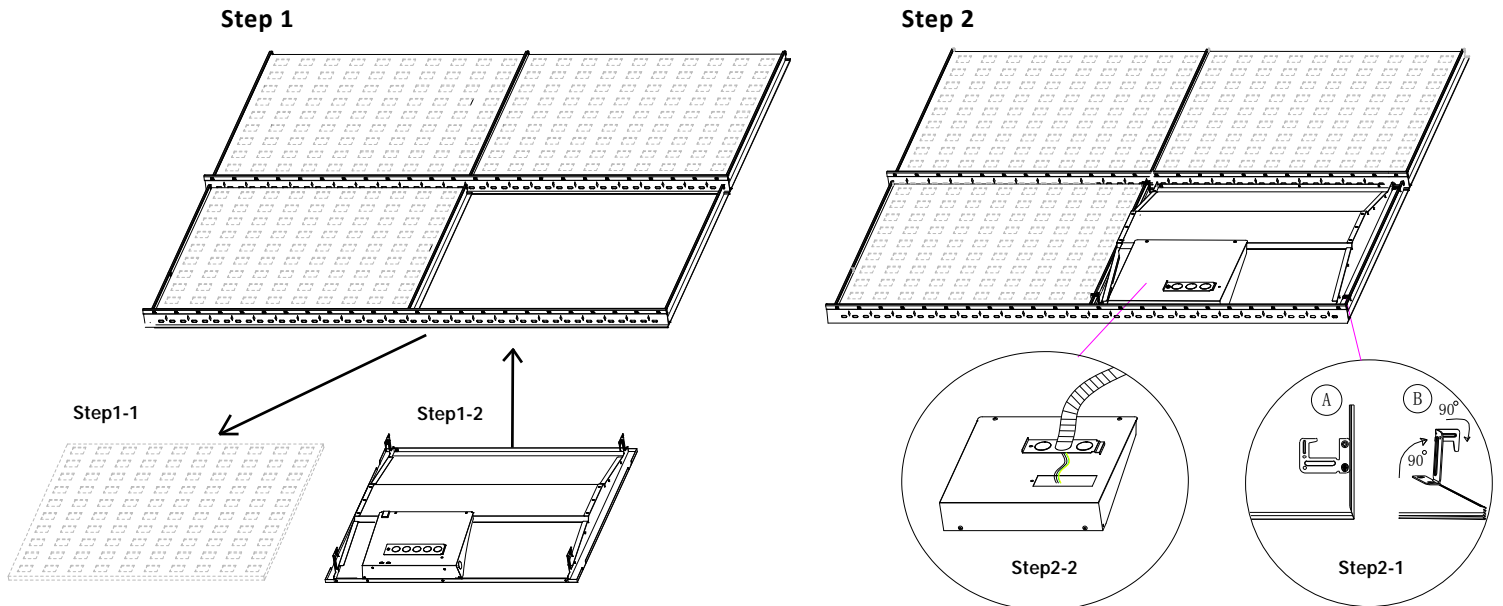

Step 1: Make sure of all the power is off before installing. Remove the one ceiling tile that you need to install light fixture on. Then place the light fixture on the T-bar carefully and make sure it is correctly in place and secure.

Step 2: Lift the 4 buckles on the back of the panel up by 90° then bend the top part of the buckles 90° towards the direction where you can anchor the light fixture to the T-bar.

Step 3: Open the driver's junction box and connect the AC wire to the driver correctly (L=black & N=white).

Warning:

Make sure all the power is off before installation.
All the installations are required to be done by professionals.