

LED DESIGNER SURFACE MOUNT

INSTALL INSTRUCTIONS

PLEASE FIND A QUALIFIED ELECTRICIAN FOR INSTALLATION. Please read the instructions before you install and use the luminaire.

GENERAL: ALL ELECTRICAL CONNECTIONS MUST BE IN ACCORDANCE WITH LOCAL AND NATIONAL ELECTRICAL CODE (N.E.C.) STANDARDS. IF YOU ARE UNFAMILIAR WITH PROPER ELECTRICAL WIRING CONNECTIONS OBTAIN THE SERVICES OF A QUALIFIED ELECTRICIAN. REMOVE THE TRIM FROM THE BOX AND MAKE SURE THAT NO PARTS ARE MISSING.

WARNING, CAUTIONS AND OPERATING INSTRUCTIONS

- Installation requires knowledge of luminaires electrical systems. If not qualified, do not attempt installation. Contact a qualified electrician.
- To prevent wiring damage or abrasion, do not expose wiring to edges of sheet metal or other objects.
- Do not make or alter any holes in an enclosure of wiring or electrical components during kit installation.

WARNING: RISK OF FIRE OR ELECTRICAL SHOCK

- Disconnect or turn off power before installation or servicing.
- Verify that supply voltage is correct by comparing it with the luminaire label information. Use AC 120V - 50/60Hz.
- Make all electrical and grounded connections in accordance with the National Electrical Code and any applicable local code requirements.
- All wiring connections should be capped with UL approved wire connectors.
- No User serviceable parts inside, contact manufacturer for assistance.

CAUTION: RISK OF INJURY

- Wear gloves and safety glasses at all times when removing luminaire from carton, installing, servicing or performing maintenance.
- Avoid direct eye exposure to the light source while it is on.
- Account for small parts and destroy packing material, as these may be hazardous to children.

CAUTION: RISK OF PRODUCT DAMAGE

- Do not exceed fixtures operating temperature: -4°F to 104°F.
- Do not restrict fixture ventilation. Avoid covering LED fixtures with insulation, foam, or other material that will prevent convection or cooling.
- Indoor use only.
- Suitable for damp locations.
- For a list of compatible dimmers please visit our website: www.pqlighting.com

ITEM #	SIZE	WATTAGE	VOLTAGE	DIMENSIONS
66838	7"	12W	120VAC	7.1" DIA x 0.5" H
07838	9"	18W		8.9" DIA x 0.5" H

! WARNING DISCONNECT POWER BEFORE INSTALLING OR SERVICING.

SURFACE MOUNTED

1. Make sure power is turned off.
2. Attach mounting bracket to the J-Box using the 2 provided screws. Note: The tabs on the ends of the mounting bracket should be facing down once installed. (Fig 1)
3. Connect wire ends from the J-Box to the fixture with UL approved wire connectors. (Fig. 2)
4. Push fixture up into the mounting bracket until it lines up with the tabs. Make sure all wires are carefully tucked inside the J-Box and fixture is flush with the ceiling. Insert and tighten fixture mounting screws. (Fig. 3)
5. Installation complete, restore power.

CCT SELECTION

Select CCT prior to installation.

WW = 3000K
NW = 4000K
CW = 5000K

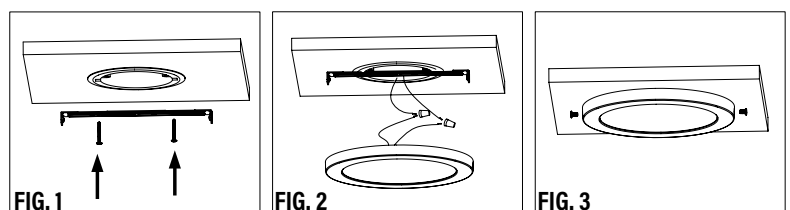
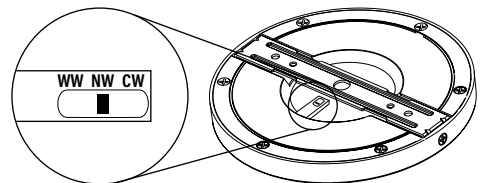

RECESSED CAN - RETROFIT (5"/6")

1. Make sure power is turned off.
2. Remove trim and existing lamp from recessed fixture. (Fig. 4)
3. Thread the E26 socket adapter into the socket. Plug the female connector of the retrofit trim into the male connector of the socket adapter assembly.
4. Using torsion springs, squeeze both torsion springs arms together and insert into the torsion springs slots of the can. (Fig. 5)
5. Tuck all the wires into the can and carefully push the retrofit trim into the can. (Fig. 6)
6. Installation complete, restore power.

5"/6" CAN

