

1912D

Ceiling Fixture

Features

Housing

Die-formed Cold-rolled Steel

Finish Option: -62 Satin Nickel, -05 Black, -30 Oil Rubbed Bronze

Optical

Shade: High Transmission Glass Create Excellent Light Distribution and Uniformity

LED: High Efficiency, High CRI, Binned and Mixed to Reach Uniform Light

Electrical

High Power Factor, Low THD

Lamp

Built-in LED Module (Color Temperature Option – 3000K, 4000K)

Certifications

ETL/cETL Listed, Energy Star Listed

Warranty

5 Years Warranty on Driver and LED Module

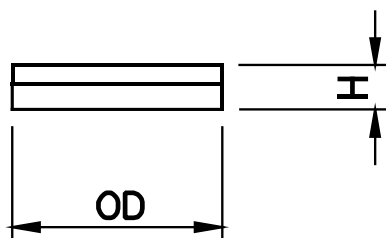

LED Type

Model	Input Voltage	Input Wattage	Lumen (Typ) / CRI	CT	Finish	Shade	Dimension (OD X H)	Energy Star
1912D-62-xxxxK	120V	18W	950 / > 80	3000K or 4000K	Satin Nickel	Frosted Glass	10.9" x 2.3"	Yes