



# SLIM BAFFLE DOWNLIGHT 6"

## Install Guide and Manual

Lightweight, plastic junction box eliminates conductivity and the need for a ground wire. Simply cap your existing ground wire!



### COMPONENTS

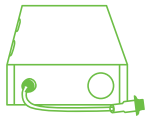

#### IC Rated Junction Box

Located under cardboard at the bottom of the shipping box

### EASY INSTALLATION



1. Turn off circuit breaker that provides power to the light switch for the recessed lights.
2. Cut a hole in the ceiling in the desired location accordingly to the dimension indicated.

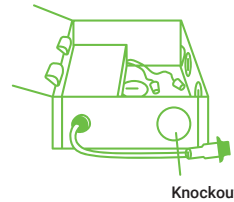

3. Run electrical wire from the power source (switch) through the mounting hole.
4. Open the junction box and remove the appropriate knockout(s) on the side plate.

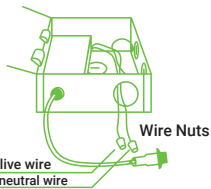

5. Connect the supply wires to the junction box wires using the wire nuts provided.
  - White to white
  - Black to black
  - It is not necessary to ground a plastic junction box. Cap ground wire and tuck into non-conductive junction box.
6. Close the cover.

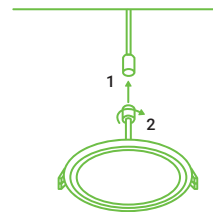

7. Connect the junction box to the slim down light. Tighten the connector by hand.

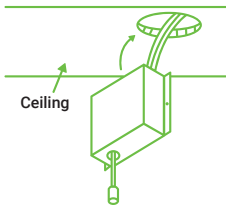

8. Insert junction box through the hole in the ceiling.
  - **New construction applications:** Hardwire box shall be secured to studs, joists, or similar fixed structural units.
  - **Remodel applications:** Do not require the hardwire box to be firmly secured after the mounting plates studs, joists, or structural units have been concealed.

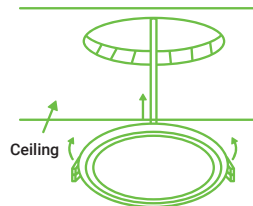

9. Push up the spring clips to insert the luminaire in the opening in the ceiling.
10. Turn on circuit breaker and test the light.

### WARNING

All electrical connections must be in accordance with local and National Electric Code (N.E.C.) standards. Consult a qualified electrician if you are unfamiliar with proper electrical wiring connections. Please review instructions carefully before proceeding.

**WARNING:** Risk of fire or electric shock. Do not alter, relocate or remove wiring during installation.

**WARNING:** Do not make or alter any open holes in an enclosure of wiring or electrical components during kit installation.

**WARNING:** Gloves are required when accessing the junction box for any routine maintenance.

**WARNING:** Not for use in ceilings with polystyrene insulation.

### SPECIFICATIONS

Voltage	120V
Wattage	14W
Usage	Indoor
Housing	Polycarbonate
Weight	0.57lbs
Warranty	7 years