

BAFFLE DOWNLIGHT 5/6"

Install Guide and Manual

COMPONENTS

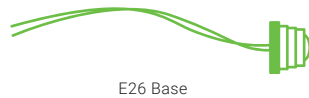

EASY INSTALLATION



Turn Power OFF

1. Turn off circuit breaker that provides power to the light switch for the recessed lights.



2. Locate the housing.

•Remove previous fixture, fixture may be hot so allow time to cool after turning off power.

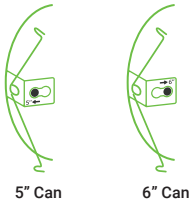

5" Can

6" Can

3. Determine the size of the opening (5" or 6").
4. Adjust the downlight using the screw on the side.

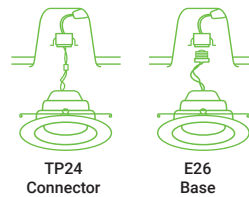

TP24 Connector

E26 Base

5. Determine the type of connector available.

•TP24 Connector
•E26 Base

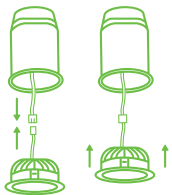

6. Thread the appropriate adapter to make connection in the housing.
•Note: the wires may come lose from the connectors so ensure they are attached.
7. Tuck all wires into the can.
8. Line up trim ring with opening.



9. Hook downlight springs into housing.
10. Push downlight into can until secure.
11. Turn on circuit breaker, test light.

WARNING

All electrical connections must be in accordance with local and National Electric Code (N.E.C.) standards. Consult a qualified electrician if you are unfamiliar with proper electrical wiring connections. Please review these instructions carefully before proceeding.

WARNING: Risk of fire or electric shock. Do not alter, relocate or remove wiring during installation.

WARNING: Do not make or alter any open holes in an enclosure of wiring or electrical components during kit installation

SPECIFICATIONS

Voltage	120V
Wattage	13W
Suitable for Locations Ingress	Damp
Housing	Polycarbonate
Weight	0.45lbs
Warranty	7 years