

# 5/6" RETROFIT SELECTABLE WHITE LED LIGHT

Baffle/Smooth 965LM | Baffle 1050LM

Install Guide and Manual

## COMPONENTS



TP24 Connector



E26 Base



## EASY INSTALLATION

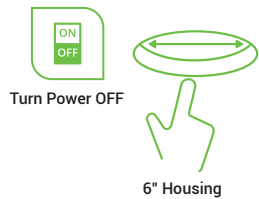

Turn Power OFF

6" Housing

**1. Turn off the circuit breaker that provides power to the light switch for the recessed lights.**

**2. Locate the recessed housing.**

- Remove previous fixture. Fixture may be hot so allow time to cool after turning off power.

**3. Ensure the size of the opening is (5" or 6").**



5" Can



6" Can

### Required Tools:

Ladder, Drywall Saw, Wire Strippers, Screwdriver

**4. Adjust the sizing on the mounting bracket using the screw. Slide the bracket to choose 5" or 6" can size.**

- Tighten screw

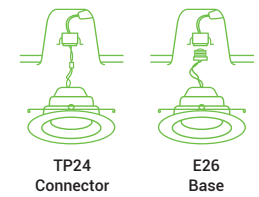

TP24 Connector

E26 Base

**5. Determine the type of power connector available in your recessed can housing.**

- TP24 connector
- E26 Socket

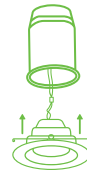
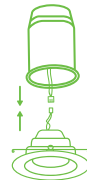

**6. Connect the appropriate adapter (E26 or TP24) to pull power from the housing.**

**NOTE:** The wires may come lose from the connectors. Ensure they are attached.

**7. Turn on power and test light.**

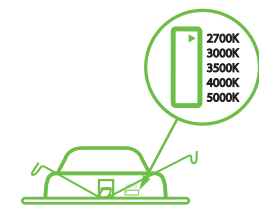

**8. BEFORE PROCEEDING:** On back of retrofit fixture, slide the CCT Selection Switch to choose from five color temperatures (2700K, 3000K, 3500K, 4000K, 5000K). Try each CCT to determine best fit.

- Light will use the preferred setting whenever you turn it on.
- Turn off light switch after selecting your choice and continue install.



Turn Power ON

**9. Hook retrofit's spring clips into housing.**

**10. Tuck all wires into the can.**

**11. Line up trim ring with opening.**

**12. Push downlight into can until secure.**

**13. Turn on circuit breaker and test light.**

## WARNING

To reduce the risk of fire, electric shock or injury to people:

- This product should be installed in accordance with the applicable installation code by a person familiar with the construction and operation of the product and the hazards involved.
- Abide by related regional and local laws or regulations.
- Do not alter, relocate or remove wiring.
- Do not make or alter any open holes in enclosure or electrical components.
- Proper grounding is required to ensure safety.
- Check for damage during shipping prior to install. If the product is damaged, do not use it.
- Turn off the switch and circuit breaker before installing this LED light.
- Use safety precautions. Safety eyeglasses and gloves are recommended.
- Please review instructions carefully before proceeding.

## SPECIFICATIONS

	5/6" Smooth (965LM)	5/6" Baffle (1050LM)	5/6" Baffle (965LM)
Voltage	120V	120V	120V
Wattage	13W	13W	13W
Lumens	965	1050	965
Ingress Location	Damp	Damp	Wet
Housing	Aluminum+PC		
Weight	0.45lbs	0.45lbs	0.45lbs
Warranty	7 years		