

GOOF RING FOR 5/6" RECESSED LIGHTS

Install Guide and Manual

COMPONENTS



Goof Ring



EASY INSTALLATION



Turn Power OFF

1. Turn off power.
 - For new construction install, skip to #3.

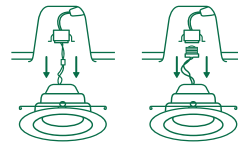

2. Remove existing 5/6" recessed light from can housing and disconnect power (TP24 connector or E26 Adapter, as appropriate).



3. Squeeze clips and slide Goof Ring onto lamp housing on back of 5/6" recessed light.

- Note: Goof Ring will rest on top of the trim and can be repositioned as needed.

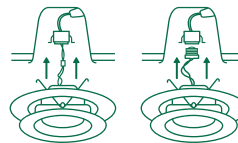

4. Reconnect the power to 5/6" recessed light (using TP24 connector or E26 adapter).

Hook downlight spring clips into can.



6. Push downlight up into can housing until secure.
7. Gently slide the Goof Ring so it is centered and covers uneven ceiling.

- Note: Goof Ring is held in place between recessed light and ceiling.



Turn Power ON

8. Turn on power.

WARNING

- Goof Ring is not a toy.
- This product should be installed in accordance with the applicable installation code by a person familiar with the construction and operation of the product and the hazards involved.
- Abide by related regional and local laws or regulations.
- Check for shipping damage prior to install. If the product is damaged, do not use it.
- Use safety precautions. Safety eyeglasses and gloves are recommended.

SPECIFICATIONS

Color	Matte White
Surface	Paintable
Paint Type	Oil & Water based paints
Housing	Polycarbonate
Weight	0.14lbs
Warranty	1 year
Operating Temperature	4°F to 104°F
Suitable Locations	Ingress Damp

IMPORTANT: The Goof Ring can be painted to match décor; however, this will void the product warranty. Once painted, the Goof Ring cannot be returned for a refund.