

4" GOOF RING

Install Guide and Manual

COMPONENTS



Goof Ring



EASY INSTALLATION

Recessed Can Mounting



Turn Power OFF

1. Turn off power.
- If new recessed light install skip to #3.

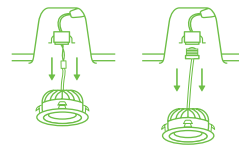

2. Remove existing 4" recessed light from can housing and disconnect power (TP24 connector or E26 Adapter, as appropriate).

- Applications also include ceiling fans and ceiling fixtures.



3. Slide Goof Ring onto lamp housing on back of 4" recessed light (over retention clips).

- Note that Goof Ring will be loose on top of the trim so you can reposition it.

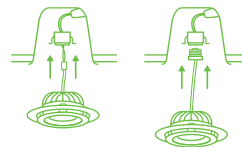

4. Reconnect the power to 4" recessed light (TP24 connector or E26 Adapter).

5. Hook downlight retention clips into can.

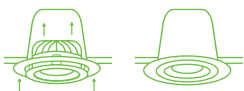

6. Push downlight up into can housing until secure.

7. Gently slide the Goof Ring so it is centered and covers uneven ceiling.

- Note that Goof Ring is held in place between recessed light and ceiling.



Turn Power ON

8. Turn on power.

WARNING

- Goof Ring is not a toy.
- This product should be installed in accordance with the applicable installation code by a person familiar with the construction and operation of the product and the hazards involved.
- Abide by related regional and local laws or regulations.
- Check for damage during shipping prior to install. If the product is damaged, do not use it.
- Use safety precautions. Safety eyeglasses and gloves are recommended.

SPECIFICATIONS

Color	Matte White
Surface	Paintable
Paint Type	Oil & Water based paints
Housing	Polycarbonate
Weight	0.14lbs
Warranty	1 year
Operating Temperature	4°F to 104°F
Suitable Locations Ingress	Damp

IMPORTANT: Although you can paint the surface of the Goof Ring with oil- or water-based paints to match your décor, doing so will void the warranty. A return for refund is no longer an option after painting.