

# Sunco

Lighting made better.

User Manual

## 5/6" LED Retrofit Selectable Smooth Downlight

SKU: DL\_SMDR56-13W-3K\_65K

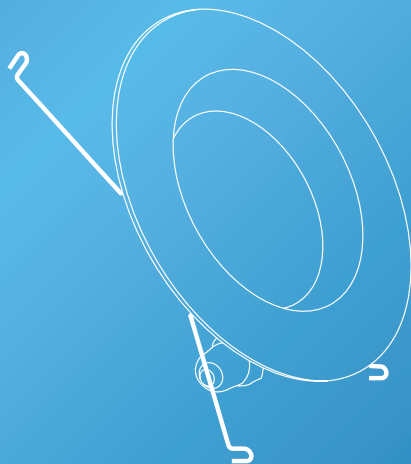

support@sunco.com  
(844) 334-9938



AMERICAN  
COMPANY

# Whats in the Box?

## Retrofit Downlight

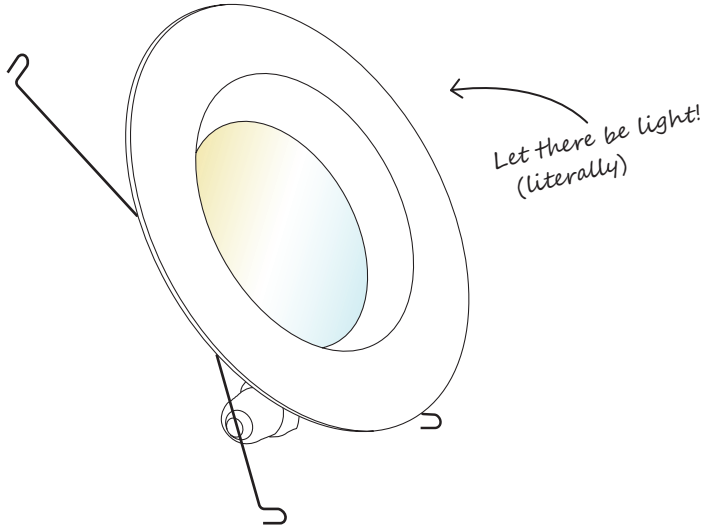

x1

Light Fixture



x1

TP24 Connector

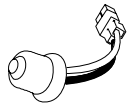

x1

E26 Base

# Before You Start

## Safety Information

To reduce the risk of fire, electric shock, or physical injury:

- Turn off circuit breaker before installing this fixture.
- This product should be installed by a person familiar with the construction and operation of the product the hazards involved. Safety eyeglasses and gloves are recommended.
- Abide by related regional and local laws or regulations.
- Proper grounding is required to ensure safety.
- Do not alter, relocate, or remove wiring during installation.
- Do not make or alter any open holes in wiring enclosure or electrical components during installation.
- Check for shipping damage before installing. If the product is damaged, do not use it.
- Keep fixture away from corrosive substances.
- Suitable for damp locations at temperature ranging from 4°F to 113°F. Not for use where directly exposed to water.
- Clean the fixture regularly to ensure proper operation. Do not clean with harsh solvents.
- Use safety precautions and abide by regional and local laws or regulations.
- This product is not compatible with 3rd party sensors.
- This product is not compatible with photo controls.
- This product is not compatible with occupancy sensors.
- This product is not compatible with timing devices.

### ⚠ WARNING:

Cancer & Reproductive Harm- [www.P65Warnings.ca.gov](http://www.P65Warnings.ca.gov)

This device complies with Part 15 of the FCC rules. Operation is subject to the following two conditions:

1.) This device may not cause harmful interference.

2.) This device must accept any interference that may cause undesired operation. Please review all instructions carefully prior to installation.

## Quickstart Guide

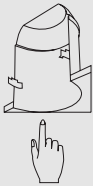

### Step 1

Locate the recessed housing.

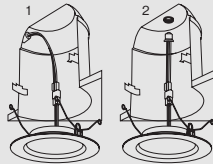

### Step 2

Determine type of connector available.

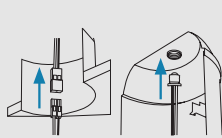

### Step 3

Thread the adapter to make connection.

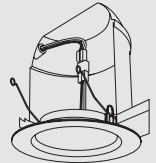

### Step 4

Push downlight into can until secure.

# Installation Guide

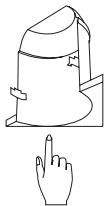

## STEP 1

a. Turn off circuit breaker before installation.

b. Locate the housing.

**NOTE:** Remove previous fixture. Fixture may be hot so allow time to cool after turning off power.

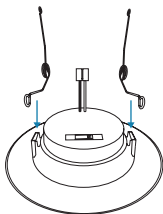

## STEP 2

a. Determine the size of the opening.

b. Secure the clip springs firmly within the retrofit connector.

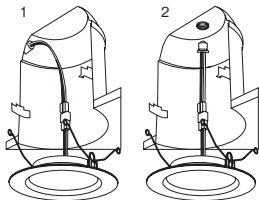

## STEP 3

Determine the type of connector available.

-TP24 Connector(1)

-E26 Base(2)

## Installation Guide (Cont.)

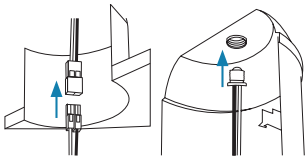

### STEP 4

a. Thread the appropriate adapter to make connection in the housing.

**NOTE:** the wires may come lose from the connectors so ensure they are attached.

b. Tuck all wires into the can.

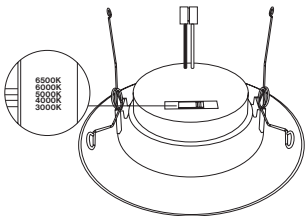

### STEP 5

a. On back of retrofit fixture, slide the CCT Selection Switch to choose from five color temperatures. Try each CCT to determine best fit.

b. Turn off light switch after selecting your choice and continue install.

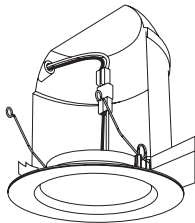

### STEP 6

a. Line up trim ring with opening.

b. Push downlight into can until secure. Compression clips will hold retrofit light in place. Push up spring clips and insert into ceiling.

c. Turn on circuit breaker and test light.

# Product Details

## Recommended Dimmers

Brand	Model
LUTRON	MACL-153M-WH
LUTRON	CTCL-153PDH-WH
LUTRON	DVCL-153PR-WH
LUTRON	DVCL-153P-WH
LUTRON	MACL-153MH-WH
LUTRON	RRD-6CL
LUTRON	SLV-600P
LUTRON	TGCL-153PH

*Scan for the full compatible dimmer list!*



## Specifications

<b>Voltage</b>	120V	<b>Average Lifetime</b>	50,000 hrs
<b>Wattage</b>	13W	<b>Lumens</b>	965LM
<b>Wattage Equivalency</b>	120W	<b>Moisture Rating</b>	Damp
<b>Beam Angle</b>	90°	<b>CRI</b>	80+
<b>Weight</b>	0.45lbs	<b>Usage</b>	Indoor
<b>Housing Material</b>	Polycarbonate	<b>IC Rated</b>	Yes
<b>Dimmable</b>	Yes	<b>Warranty</b>	7 Years

# Common Troubleshooting

Feeling in the dark about an issue with your product? No worries! Our troubleshooting section is here to shed some light and provide you with easy-to-follow solutions for any problem.

If you still need some assistance, please feel free to contact us with any questions. Our team of lighting experts are happy to help brighten your day.

## Installation

Light isn't turning on.

Double check if fixture is properly connected and circuit breaker hasn't been tripped.

Light unexpectedly fails.

For further assistance, contact our customer support.

## Dimming

Light not dimming to lowest setting.

Ensure minimum dimmer load requirement is met.

Light not dimming smoothly.

Verify dimmer compatibility with fixture.

Light not compatible with dimmer switch.

Check light-dimmer compatibility. Consider purchasing compatible switch if necessary.

## Flickering

Light is flickering when turning on.

Check that fixture wiring connections are secure.

Light flickering with other lights on the same circuit.

Check that the lights on the same circuit are not overloading the circuit.

Light flickering when turned on.

Verify fixture compatibility.

Light flickering when dimmed.

Verify dimmer switch compatibility.

## Buzzing

Fixture buzzing with power outages.

Verify light is connected to surge protector securely.

Fixture buzzing with appliances or electronic devices.

Look for nearby interferences that can cause buzzing. Such as televisions, radios, computers, etc.

Fixture buzzing when dimmed.

Verify dimmer switch compatibility.

# Light Distribution Angle

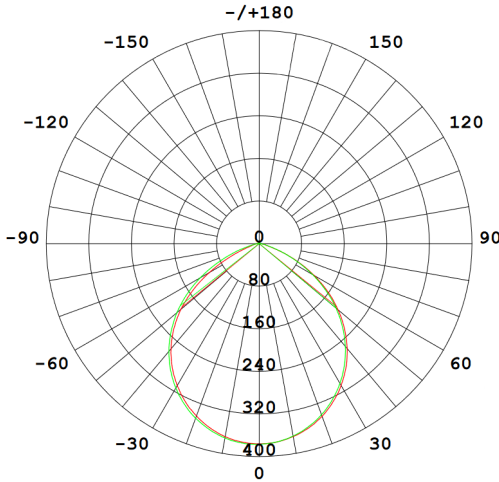

←  
*Not a lighting nerd?  
No worries, you can skip this page*

AVERAGE BEAM ANGLE (50%): 101.6 DEG

<span style="color: red;">—</span>	C0/180	101.3°
<span style="color: green;">—</span>	C90/270	101.8°

UNIT:cd Luminous Intensity Distribution 1

Lighting distribution angle refers to the spread of light emitted from a light source. It is an important factor to consider when selecting a fixture or bulb, as it affects the way it will illuminate an area. There are two main types of lighting distribution angles:

A symmetric lighting distribution emits light evenly in all directions, creating a cone-shaped pattern that provides a pool of light. This type of lighting is ideal for general lighting and illuminating large areas. Common applications for symmetric lighting include general area illumination, security lighting, and perimeter lighting. Symmetric lighting is also used to a certain degree in up-lighting.

An asymmetric lighting distribution angle, also known as beam angle, creates a pattern that focuses light in a specific direction. This type of lighting is ideal for task lighting as it reduces glare and light spill in other areas. Common applications include task lighting in spaces such as landscape settings, retail stores, museums, and much more.

It is important to note that the lighting distribution angle can also be affected by other factors such as the reflector design of the light source, the type of lens used, and the distance between the light source and the surface being illuminated.



## Warranty Policy

This product is covered by our industry leading 7 year warranty.

It gets even better - scan the QR code for 2 extra years of protection!



*Scan me for two extra years!*

## 30 Day Return Policy

At Sunco, we value our customers and stand by the quality and performance of our products.

If you are not completely satisfied with your purchase, we accept returns within 30 days of your purchase date.

## Customer Service

Our Los Angeles team of lighting experts is here to assist you with all your needs! Contact us at:

Email: [support@sunco.com](mailto:support@sunco.com)

Call or Text: (844) 334-9938

# Sunco

Lighting made better.

[support@sunco.com](mailto:support@sunco.com)  
(844) 334-9938

REV11



AMERICAN  
COMPANY