

HYPERLITE
www.hi-hyperlite.com

Use hyperlite LED down light
enjoy brighter life now

If you need more information about our lights,
please contact us by email or phone call

Email: info@hi-hyperlite.com
Toll-free number: +1(855) 688 7879

HYPERLITE
LED LIGHTING
www.hi-hyperlite.com

LEARN MORE
Instruction manual



Thanks for your purchase!

LED LINEAR HIGH BAY LIGHT

HALO Series



FEATURES & SPECIFICATIONS

Performance Data		6HV15-XXLR
Specification	Power	15W
	Lumens	1050LM
	Efficacy	70 lm/w
	CCT	3000K / 4000K / 5000K
	CRI	>90
	Beam Angle	100°
	Input Voltage	120V, 50/60Hz
	Power Factor	>0.9
	Housing Material	Aluminum
	Finish	Architectural White
	Mounting	Recessed Downlight Retrofit
	Dim	Triac dimmable
	Base	E26
	L70@25°C	>50,000 hours
Options	Listings	Energy Star and ETL
	IP Rating	IP 40
	Warranty	5 years

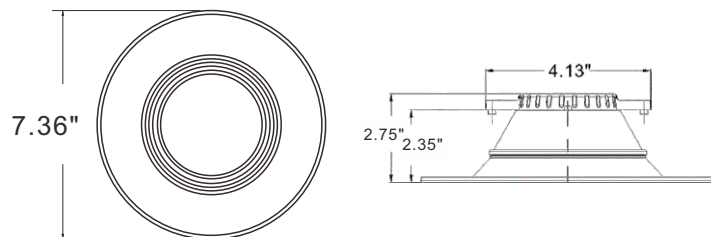

PACKAGING INFORMATION

Model	Power	Lumens	Luminaire Efficacy	Input Voltage	Qty/Ctn	Net Weight	Cross Weight	CTN Size
6HV15-XXLR	15W	1050LM	70lm/w	120V, 50/60Hz	2	0.8 ± 0.1 lb	1.0 ± 0.1 lb	11.2"*3.5"*7.7"
					4	1.7 ± 0.1 lb	2.0 ± 0.1 lb	11.2"*7.0"*7.7"
					12	5.0 ± 0.1 lb	6.0 ± 0.1 lb	15.9"*12.8"*7.7"

ATTENTION

BEFORE YOU INSTALL
Read these instructions completely and carefully.

Read and follow the instructions,
 Risk of fire, **MINIMUM 90C SUPPLY CONDUCTORS**
 Risk for Fire or Electric Shock: Please consult an electrician for installation if uncertain of housing electrical systems.
 Risk of electric shock.
 To avoid possible electrical shock, be sure that power supply is turned off at fuse box or circuit breaker before installing or servicing fixture
 To prevent wiring damage or abrasion, do not expose wiring to edges of sheet metal or other sharp objects

This device complies with Part 15 of the FCC Rules Operation is subject to the following two conditions
 (1) this device may not cause harmful interference
 (2) this device must accept any interference received, including interference that may cause undesired operation
 Do not make or alter any open holes in an enclosure of wiring or electrical components during kit installation.

DIMMING

The Down Light is designed for dimming with many 120 Leading Edge(LE) and Trailing Edge(TE) phase control dimmers.
 Dimming capability may be enhanced with select dimmers that feature low end trim adjustment (Consult dimmer manufacturer for specific load compatibility and application information)
 (Note: some dimmers require a neutral in the wall box.)

MODULE INSTALLATION INTO E26 EDISON SCREW BASE RECESSED HOUSINGS

NOTE: Confirm luminaire is compatible with the Down Light module series. A listing of the most common housings is provided in the HOUSINGS section of these instructions

1. Remove mounting bracket and plate form inside existing recessed housing (if installed)
 - 1a. Ensure bottom edge of housing is flush with ceiling. Adjust height if necessary to ensure a tight finish
2. Release socket form the housing plate(if installed)
3. Screw Edison base adapter into existing Edison base socket in housing
4. Plug orange connector on the Down Light LED module series into the orange connector on supply wire adapter
5. Squeeze the torsion springs together as shown and install into torsion spring brackets inside recessed housing
 - 5a. If using friction clips, while wearing gloves squeeze opposing Clips together until clips fit inside housing then carefully insert the Down light into housing allowing springs to expand to hold the Down Light LED module in housing
6. Carefully route wires into fixture and push LED module up to ceiling surface.

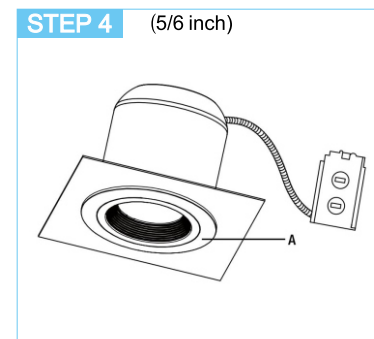
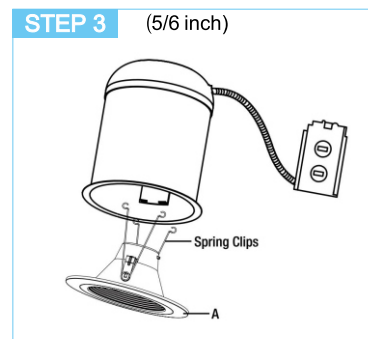
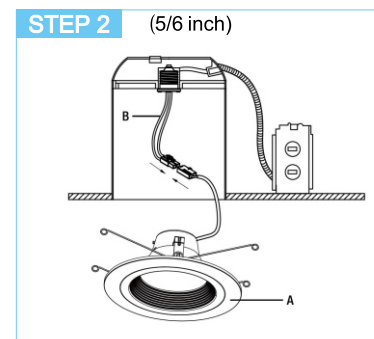
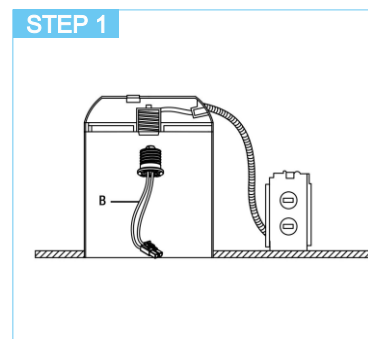

WARNING

Risk of electric shock. Disconnect power at fuse or circuit breaker before installing Servicing

REPLACING THE DOWN LIGHT RECESSEN HOUSING

1. With fingertips, pull down firmly on trim ring until module is removed from the housing.
2. Squeeze torsion springs together to remove LED module. If using friction blades pull LED Module out of housing slowly
3. Disconnect LED module wiring from recessed housing(LED connector or screw-in Edison base)

More products...

Linear High Bay

WILL Series



- Downy light, no glare, simple design
- High light efficiency, up to 130lm/w
- High Quality PMMA Lens, Non-flicker, protect your eyes
- Super bright LM80 LED 2835SMD, Ra>80
- 5 years warranty



FLOOD Light

GUARDER Series



- Architecturally attractive and modern design
- Ideal for indoor or outdoor applications
- Finished with UV resistant powder coat, excellent corrosion protection
- Optional installation of knuckle, Wall mount
- 5 years Warranty



CANOPY Light

VEGA Series



- Hinged design for quick installation
- Efficiency up to 130LPW
- Optional internal sensor and photocell
- 1-10V Dimming
- 5 years Warranty



Area Light

ARES Series



- Maximum power up to 300w, up to 150lm/w
- Optimized mount kit allows single person installation
- Demountable design, easy for maintenance
- Up-to-date design, with vertical lens and gather 4 LED in one bulb
- 5 years warranty



www.hi-hyperlite.com

