

DMD-LED3-105



0-10V Decorator Dimmer
Dimming Control:
120VAC 6A
277VAC 3A



Users can change the cover by themselves.

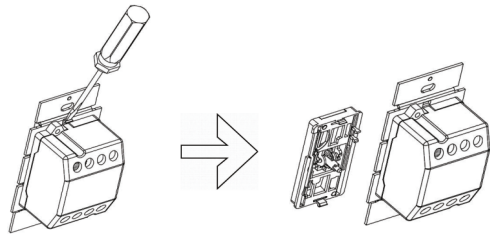

FEATURES AND BENEFITS

1. Tough impact-resistant thermoplastic housing.
2. Broad product offering to meet a wide variety of applications.
3. Full-range dimming, lighting fade up and down smoothly allowing your eyes to adjust to changing light levels.
4. Smooth-action slide control for easy precise operation.

DIMENSION:

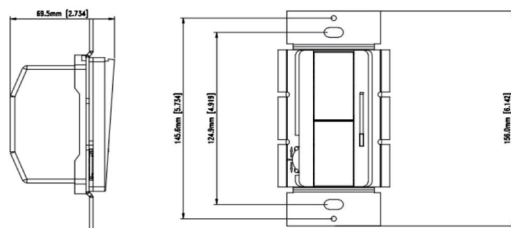

0-10V Preset Dimmer

For use with: 0-10V Lighting Control Devices

Operation

The 0-10 volt low-voltage lighting control provides dimming control for 0-10 volt compatible LED drivers, fluorescent ballast and HID ballast. Minimum light level (low-end) shall be adjusted to optimize performance.

Important Notes

Please read before installing

1. Turn off power at circuit breaker or fuse before wiring.
2. Only one dimmer can be used per 3-way circuit.
3. It is normal for the dimmer to feel warm to the touch during operation.
4. **FOR SUPPLY CONNECTOR, USE WIRES RATED FOR AT LEAST 75°C and USE COPPER WIRE ONLY.**

CAUTION - To Reduce The Risk of Overheating and Possible Damage to Other Equipment, Do Not Install to Control a Receptacle, a Motor-Operated Appliance or a Fluorescent Lighting Fixture or a Transformer Supplied Appliance.

Warranty Information

If within one(1) year from the date of purchase, this product fails due to a defect in material or workmanship, we will repair or replace it, at its sole option, free of charge. This warranty does not apply to: (a) damage units caused by accident, dropping or abuse in handline, acts of God or any negligent use; (b) units which have been subject to unauthorized repair, opened, taken apart or otherwise modified; (c) unit not used in accordance with instructions; (d) damages exceeding the cost of the products. This warranty service is available by returning the products with proof of purchase date and a description of the problem to dealer from whom the unit was purchase.

Dimming Range Adjustment

1. Push dimmer on and move slider down to the bottom.
2. Turn knob down until lowest light level is achieved and light output is stable for all bulbs.
3. Turn dimmer off, then back on to verify bulbs.
4. Turn knob up lightly and do step 3 again if all bulbs do not turn on.

LIGHTS DO NOT OPERATE AT FULL BRIGHTNESS:

Push slide up. Turn high-end knob clockwise with a screwdriver to achieve maximum light intensity.

LIGHTS DO NOT DIM LOW ENOUGH:

Push slide down. Turn the low-end knob counter-clockwise to achieve minimum light intensity.

Sensitivity Knob

Slider: Controls light level.

Up increases light level, down decreases light level.

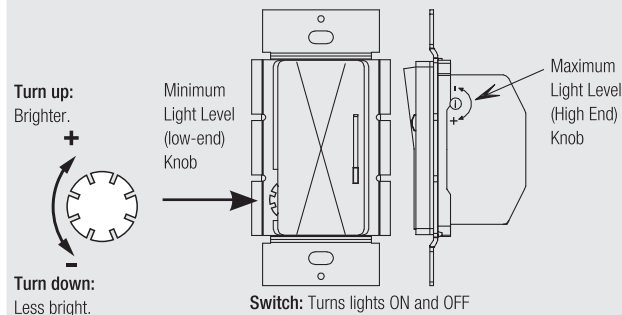

IMPORTANT: To avoid lights turn off or flicker at low end: Push slide down. Turn the low-end knob clockwise until the lights remain on without flickering.

Multi-gang Installation Sheet (Without Power Pack):

Cat. No.	Device Rating	Single-Gang Rating	Double-Gang Rating	Triple-Gang Rating
DMD-LED3-105	277V AC, 50-60Hz, 3A	277V AC, 50-60Hz, 3A	277V AC, 50-60Hz, 3A	277V AC, 50-60Hz, 3A

Installation

1. Turning power OFF.

- Turn power OFF.

2. Wiring the Dimmer.

A. Dimming Only Wiring

Power wiring not shown see lighting device for wiring

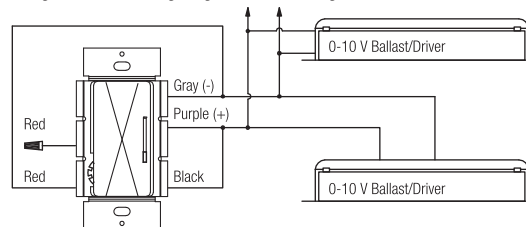

Dimming Only Wallbox Wiring

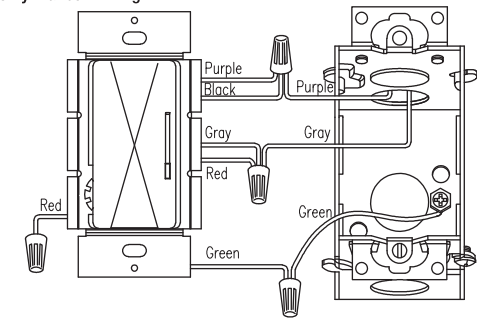

Note: Wire locations will vary. Reference wires by color not location

B. Dimming With ON/OFF Control

Wiring Diagram Using Power Pack

Dimming With ON/OFF Control Wallbox Wiring

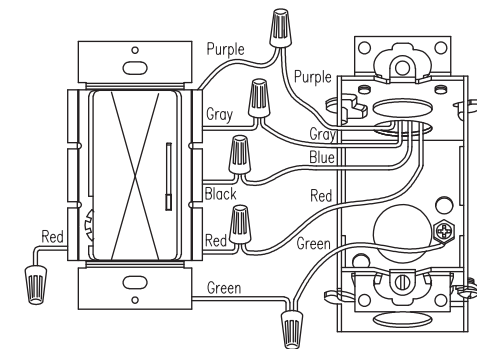

Note: Wire locations will vary. Reference wires by color not location.

C. Dimming With ON/OFF Control Without Power Pack

120/277 V~ 50 / 60 Hz

Connect the 0-10 V Control

Wire the controls according to the appropriate wiring diagram shown below and on the ballast/driver.

C1. Single Pole Wiring

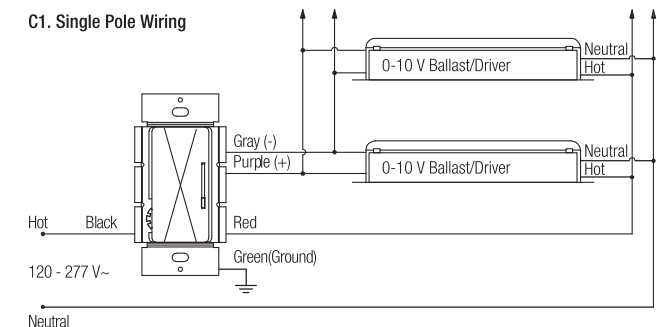

3. Mounting dimmer to wallbox.

Push wires carefully into the wallbox. Install wallplate.

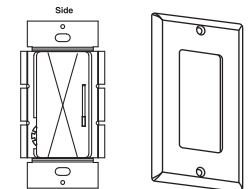

4. Turning power ON.

Turn power ON.