

PULSAR
ENJOY HIGHER CULTURE™



PulsarVaporizers.com

PU-0212-20

LIMITED WARRANTY

Pulsar Range™ is guaranteed from manufacturer defects or malfunction from the original date of purchase for a period of 1 year. This limited warranty protects against manufacturer defects under normal use and does not apply to normal wear and tear, improper use, and accidental damage from dropping or submerging in liquid, improper cleaning, neglect, or any other damage that is not the result of defective materials or workmanship. If your Pulsar Range qualifies for servicing, we will repair or replace, at our discretion and expense, any defective parts or materials. Purchaser must provide a copy of the original dated sales receipt and may be required to provide shipping to return defective parts or materials. We intend to complete all repairs/replacements within 7 business days, although this timeframe may vary depending on shipping, replacement part availability, or other related factors. The lawful and proper use of this device is a condition of sale. Any improper use of the Pulsar Range will void the warranty. Warranty is nontransferable. This warranty gives you specific legal rights, and you may also have other rights, which vary from state to state.

SAFETY WARNINGS

Failure to follow any of these instructions could result in product damage, property damage, or personal injury.

- ⚠ Do not expose to extreme temperatures or direct sunlight.
- ⚠ Do not drop the vape or attachments.
- ⚠ Do not submerge in any liquid.
- ⚠ Do not modify the electronics in any way.
- ⚠ Please allow adequate cool down between cycles whenever possible.
- ⚠ Keep fingers away from blades when cleaning.
- ⚠ Always have a jar attached to the grinder while storing.
- ⚠ Only charge using Pulsar™ brand charging cables.
- ⚠ Intended for adults only.
- ⚠ Do not sell or provide to minors. Keep away from children and pets.

PULSAR
RANGE™

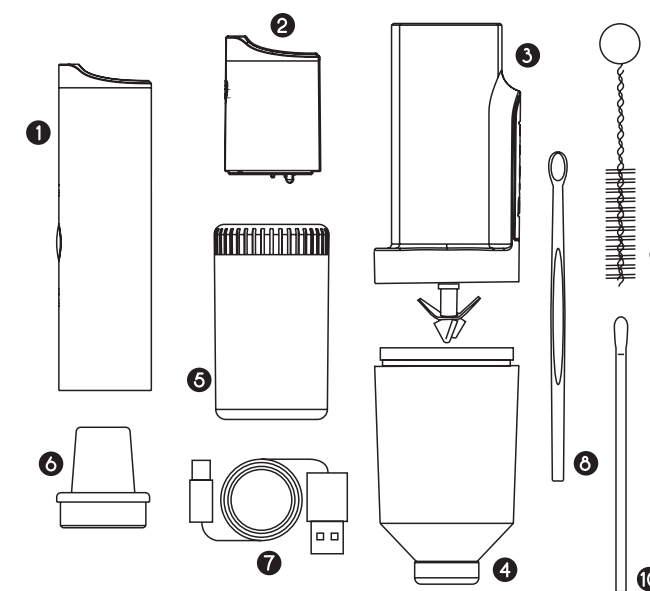

KIT INCLUDES

- | | |
|----------------------------|---------------------|
| 1 Vape (with Herb Chamber) | 6 Waterpipe Adapter |
| 2 Wax Atomizer | 7 USB Cable |
| 3 Grinder Attachment | 8 Dab Tool |
| 4 Funnel Jar | 9 Brush |
| 5 Storage Jar | 10 Cotton Swab |

ENJOY
HIGHER
CULTURE™

PULSAR
RANGE™



GETTING STARTED

Thank you for purchasing the Pulsar Range™! In order to ensure safe use, please read all instructions and safety warnings before operating. Failure to follow instructions may result in injury and may void your warranty.

IMPORTANT: You will need to fully charge your Pulsar Range before use. Insert the micro USB plug of the included cable into the unit and the other end into a USB port. Set Pulsar Range on its side. Do not let the unit dangle from the charge cord. This puts pressure on the charging port that can result in the unit not charging correctly, and damaging the unit.

- Battery Level Display (LED Dot) - With the unit powered on, press the button 1 time and the LED Dot will display the power level. Green 100%-50%, Yellow 50%-20%, Red 20%-0%
- LED Dot will display RED while charging, then change to GREEN once fully charged.
- Battery Charge Time - Allow approximately 3 hours for the first full charge. Do not charge for more than 24 hours. Additional charges time: Approximately 1.5-2 hours.
- Low Battery - The LED Dot will flash RED and will not heat.

The Pulsar Range battery will deliver approximately 4 hours of continuous power, depending on use. The battery is designed to prevent overcharging. **ONLY USE THE INCLUDED CHARGING CABLE!** Failure to do so can damage the battery, which can result in property damage or personal injury and may void the warranty.

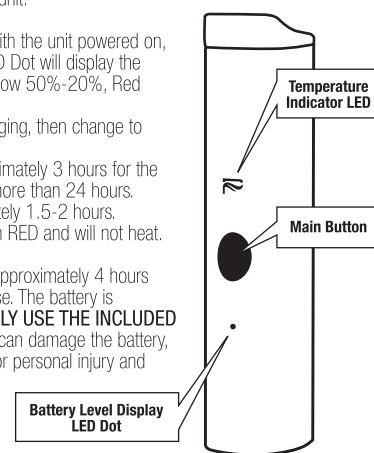

GRINDER

Grinder operates at the maximum voltage. LED Dot will flash to confirm the connection and will reflect the current battery charge level. The following applies to both the funnel jar and storage jar, but for loading the vape, start with the funnel jar.

- Remove large stems from the dry herb and place in jar, fill the jar so the blades are not pressing down against the dry herb.
- Attach the jar to the grinder. To avoid spilling keep the jar opening upright until secure. **NOTE: Grinder will not operate without a jar attached.**

USING PULSAR RANGE GRINDER ATTACHMENT

- Once the jar is loaded and screwed onto the grinder, attach the magnetic grinder attachment to the bottom of the vape body. The LED Dot will flash the battery level indicating a successful connection. **NOTE: LED Dot will not flash without a jar attached.**
- Turn the unit on by pressing the button rapidly 5 times.
- Holding the unit with the grinder attached upside down, press and hold the button to start grinding. Once the grinder has started, turn the grinder upright (while continuing to hold the button in) and gently shake the grinder until it reaches an even grind.
- **NOTE: If the grinder does not start immediately the jar is overfilled, detach the grinder, and remove some contents.**
- Detach the grinder attachment, turn the grinder upside down, gently tapping the ground material to the bottom of the jar before removing it from the grinder and placing the lid on.

CLEANING THE GRINDER ATTACHMENT

- Use the included brush to wipe off any build up on the blades and grinder base.
- If needed a small amount of 91% isopropyl alcohol on a cotton-tipped swab can be used to loosen any build-up.
- Wash the storage jars by hand with water and a mild detergent. Allow to fully air dry before using again.

TIPS:

- Place the other jar back on the grinder to keep the grinder safe and you safe from the grinder.
- The funnel jar can be used to quickly pack your vape, bowl, or help you fill a cone on the go.
- The storage jar allows you to grind and store more for later.

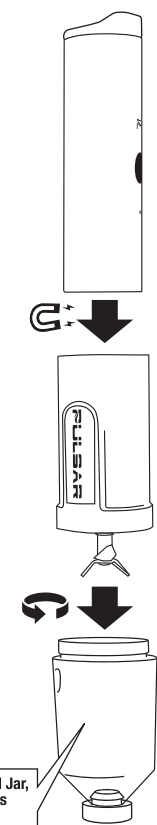

When filling Funnel Jar, do not let blades touch herb.

HERB MODE

PURE CERAMIC CHAMBER
Heating time - 40 seconds

TEMPERATURE RANGE
Green 375° F/190° C
Yellow 400° F/204° C
Red 428° F/220° C

TEMPERATURE INDICATOR

- LED will flash the set temperature color while heating.
- LED will be solid when the device is ready.

LOADING THE HERB CHAMBER

- Remove the silicone mouthpiece from the body.
- Load ground herbs loosely into the ceramic chamber and pack lightly.
- Place the mouthpiece back on the body. You may orient the mouthpiece in either direction to your liking.

OPERATING IN HERB MODE

- Turn the unit on pressing the button rapidly 5 times.
- Select your preferred temperature by pressing the button 3 times. The LED will change to the next temperature and flash 3 times to confirm.
- Start the heating process by pressing the button 2 times once you have selected your desired temp and the device will start heating. The LED will flash while heating and turn solid once ready.
- Cancel the heating at any time by pressing the button 1 time.

NOTE: To change the heat setting during use, press the button 3 times to select the desired new temperature. The Pulsar Range will re-adjust to the new temp, and then continue vaping. This will also extend your session.

FOR USE WITH WATER PIPE

To use the vape with a water pipe simply swap the mouthpiece for the Water Pipe Adapter accessory. Place the unit into the water pipe's joint, and operate in normal Herb Vape Mode.

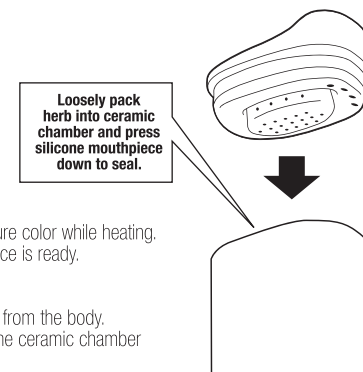

Loosely pack herb into ceramic chamber and press silicone mouthpiece down to seal.

TIPS:

- For best results, fill the herb chamber full, but do not pack tightly. This allows for even heat distribution and room to stir your herb if necessary throughout usage.
- The metal screen in the mouthpiece helps provide a smoother vaping experience, please be sure to clean it periodically.
- The Herb Mode Temperature is independent of the Wax Mode voltage setting. When switching from Wax Mode to Herb Mode, the unit remembers your last temperature setting and vice versa.
- Your Pulsar Range is equipped with a 4-minute auto-shutoff timer to prevent waste and overheating.
- Always allow the unit to cool 5 minutes between cycles whenever possible. You may turn the unit back on immediately to finish any herb left in the chamber.
- Pulsar Range will automatically power on to the last temperature setting selected.
- Occasionally stir herbs and allow the chamber to reheat for 5 seconds between each inhale.
- The Water Pipe Adapter can also be used as a mouthpiece. **Not compatible with the wax attachment.**

CLEANING THE HERB CHAMBER

- Remove the mouthpiece and dispose of the spent material.
- Remove the metal screen from the mouthpiece and clean in 91% isopropyl alcohol.
- Using a cotton-tip swab and 91% alcohol clean any residue off the mouthpiece.
- Use the provided brush to remove any material left in the chamber.
- Once the screen and mouthpiece have dried they can be put back together.

WAX MODE

QUARTZ LINED COIL-LESS WAX ATOMIZER

VOLTAGE SETTINGS
Green 2.8v
Yellow 3.2v
Red 3.6v

VOLTAGE INDICATOR

- LED will show the selected voltage color.

LOADING THE WAX ATOMIZER

- Remove the silicone mouthpiece from the wax atomizer.
- Using the provided tool, load a small amount into the quartz chamber. The maximum recommended is 0.1 grams.
- Place the mouthpiece back on the atomizer.

Load max 0.1 grams of product into quartz chamber and press silicone mouthpiece down to seal.

OPERATING IN WAX MODE

- Attach the magnetic Wax Atomizer to the bottom of the vape body. The LED Dot will flash the battery level indicating a successful connection.
- Turn the unit on by pressing the button rapidly 5 times.
- Select your preferred voltage by pressing the button 3 times - the LED will change to the next voltage and flash 3 times.
- With the quartz chamber loaded press and hold the button for a few seconds until the product has fully melted, and then, start the session.
- Press and hold the button while inhaling. You can hold the button in for up to 25 seconds before shutting off.
- To activate the Session Mode press the button 2 times and the device will continuously heat at the determined voltage setting for 12 seconds.

TIPS:

- The Wax Mode Voltage is independent of the Herb Mode Temperature setting. When switching from Herb Mode to Wax Mode, the unit remembers your last voltage setting and vice versa.
- Allow 5 minutes between sessions for the atomizer to cool in order to avoid damaging the atomizer.

- Be careful not to overfill the atomizer.
- It is highly recommended to wipe out any excess wax with a cotton-tip swab after each session.

CLEANING THE WAX ATOMIZER

- Remove the silicone mouthpiece from the atomizer.
- Use a cotton-tip swab and 91% isopropyl alcohol to wipe off any residue on the mouthpiece and inside the quartz bucket.
- Allow the atomizer to fully air dry before using it again.

BATTERY SPECIFICATIONS

27.43mm x 21.34mm x 97.28mm
1500mAh Li-Polymer Battery
Input - DC 5v, 1A
Micro USB Charging Port
5 Minute Auto-Shutoff