



LED Installation Manual H7

Copyright©2017 XENTRONIC, Inc. All rights reserved.

Kit Content

- LED bulb x 2
- Driver x 2
- Factory Harness x 2

Optional Components

- 2x Warning Cancellation Units (for Non-Canbus units) (Sold separately)
- 1x Battery Power Relay connection (Sold separately)
- Adapters for mounting the bulb (applies to H1 and H7)

Getting Started

- As a safety precaution, make sure that the car has had time to cool down before starting the installation process.
- Put the vehicle into "park" and make sure it will not move during installation. Make sure to have the ignition is in the off position and the keys removed.
- Leave the protective plastic covering on the HID bulb until you install the HID bulbs.
- It is recommended to use safety glasses and gloves during installation, if substances or dirt come in contact with the LED bulb, it will greatly reduce the bulb's lifespan.
- You may be required to drill or cut a 40mm hole into the back of the resin or rubber headlight or plastic dust cap.
- Before installation, carefully examine each component for possible cracks, loose wiring, bent frames, or anything else that may appear less than new. It is recommended to install one bulb at a time, starting battery side first.



Step 1 Removing the Headlight Housing Cover

Open the hood and examine the headlight assembly for your vehicle, Depending on how much space is available to work, you may or may not need to remove the entire headlight from the vehicle.

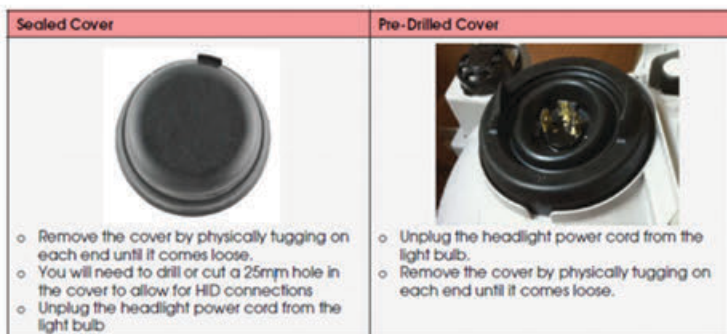

Step 2 Removing the Headlight Housing Cover

- The power cords or the bulb itself will be held by one of 4 different method or latch.
- Twist Lock with Plastic Catch: Has a small lever at the top, push down on it while pulling the plug out, once the plug is out twist 1/8 of a turn to get the bulb out. Do not apply too much force as you might damage the bulb. (Applies to the following applications: H10, 9005, 9006, H11, H9, H8, 9012, 880, H13, PSX26W)

- Metal Clip: Push down and unhook, pull up and away, hold onto the clip as you pull. (Applies to most of the following applications: H1, H3, H7, H4)
- Screw Cap: Will have a small lever at the top, push down on it while pulling the plug out. Unscrew the retaining ring by turning it counter-clockwise. You can pull the bulb straight out. (Applies to most of the following applications: 9007, 9004)



- Plastic Catch: Will have a small lever at the top, push down on it while pulling the plug out. Squeeze the bulb on both sides on the latch and pull. (Applies to most of the following applications: 5202/PSX24W/H16W)
- KEEP YOUR ORIGINAL HALOGEN BULB: Spare or backup parts are always a good thing to have.

Step 3 Mounting the LED Bulb

- For all bulb sizes, remove the bulb from the boxed foam, DO NOT ALLOW ANY DUST OR OIL TO GET ONTO THE SURFACE OF THE LED BULB.

- H7, before proceeding with the H7 installation, observe the method of which the factory mount the H7 halogen bulb, if the halogen bulb sits on an adapter and the back of the two prongs is not connected directly to the power connection, it cannot be installed. Please contact us for adapter information and we may have the adapter to work with your headlight.

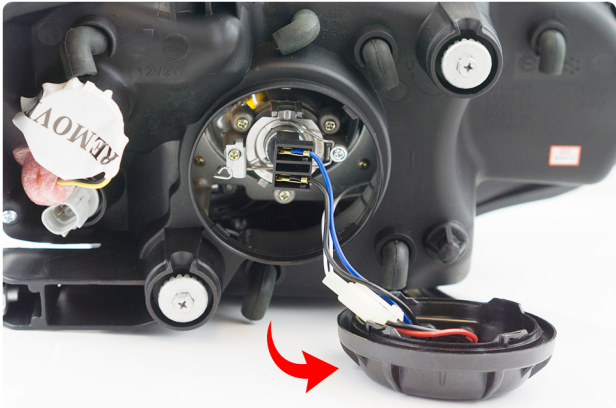

Remove the dust cover and unclip the factory H7 OEM halogen bulb. Note: This is the H7 application only which it will be a plug and play install. *This is the only H7 application that is plug and play install. *This is the only H7 application that is plug and play install. Contact us if your H7 application differs and we might have the adapter to accommodate for your application.



Once the bulb is removed, unplug and remove the bulb.

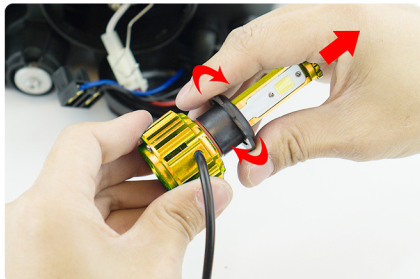

Twist off the base from the LED bulb

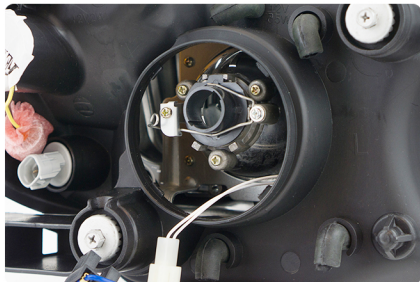

Mount the LED base onto the housing and secure it with the retaining spring clip

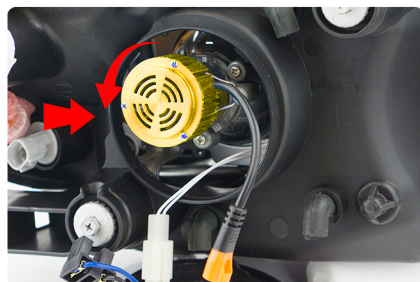

Push and twist to lock the LED bulb

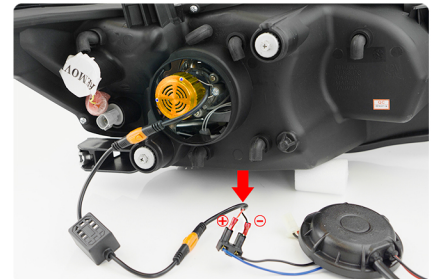

- For some sizes, modification to the back cover/dust cover may be needed to accommodate the heat sink. If the LED heat sink sticks out too much, you will need to bore out a 40mm hole. Place the cover back over the headlight housing opening.
- Once the LED bulb is mounted and secured, connect the harness to the factory plug (the plug that connected to the OEM bulb)