

Valve Actuators Installation Instructions

IMPORTANT SAFETY INSTRUCTIONS *READ AND FOLLOW ALL INSTRUCTIONS* SAVE THESE INSTRUCTIONS

⚠ WARNING

Before installing this product, read and follow all warning notices and instructions accompanying this pump. Failure to follow safety warnings and instructions can result in severe injury, death, or property damage. Call (800) 831-7133 for additional free copies of these instructions.

APPLICATION

For automatic operation of a Compool® 2-way or 3-way valve.

INSTALLATION

1. Remove Knob, Handle and four Screws from the Valve Cover.
2. Align splines of Actuator shaft over shaft of Valve.
3. If Actuator is not aligned with mounting holes on Valve Cover, rotate Actuator (while still attached to Valve) until Actuator is positioned correctly over Valve.
4. Use the 4 mounting Screws provided to mount Actuator to Valve Cover, USE SELF TAPPING SCREWS WHEN REQUIRED.
5. Mount Valve Handle and Knob to Actuator.
6. Connect cord into Power Center circuit board at appropriate Valve Actuator socket.



STAGING OF VALVE

If the Valve rotates to the wrong position, adjust the switch on the back of the Actuator between ON1 and ON2 positions. This will rotate the Valve to the correct position.

SPECIFICATIONS

Voltage	: 24 VAC
Amps	: 0.65
Torque	: 250 inch pounds
Size	: L 7.5", H 4.75", W 4.25"
Material	: Housing - Noryl; Gears - steel
Grease	: MoS2 Lubricant
Cord Length	: 15'
Rated	: Outdoor use

REPLACEMENT PARTS

CVA-CORD	REPLACEMENT CABLE for Actuator
CVA-GEAR	GEAR SET for Actuator; 3 GEARS
CVA-SCR	MOUNTING SCREW for Actuator (qty. 4)
CVA-SWITCH	MICRO-SWITCH for Actuator

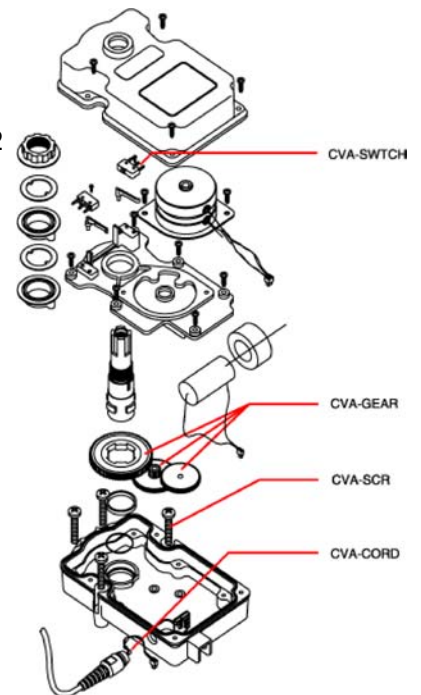

ADJUSTING VALVE ACTUATOR

Most installations do not require adjusting the valve actuator. However, if a bypass is desired, follow the steps below:

1. Remove Valve Actuator Cover.
2. Loosen Lock Nut with a pair of pliers (this allows moving the Adjustment Cams).
3. Rotate Upper Cam to change clockwise rotation stop point. Rotate Lower Cam to change counter-clockwise rotation stop point.
4. The toggle switch on the back of the valve Actuator can be used to verify if the new adjustments is correct (flip between ON1 & ON2).
5. Tighten Lock Nut and replace Cover.

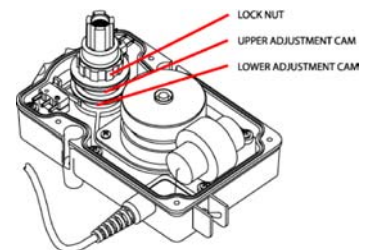
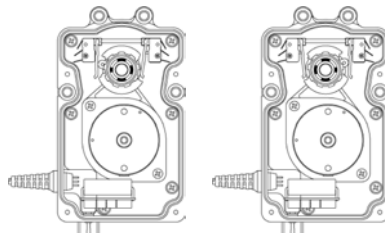

Pentair Pool Products, Inc.

1620 Hawkins Ave., Sanford, NC 27330 • (919) 774-4151

10951 W. Los Angeles Ave., Moorpark, CA 93021 • (805) 523-2400

 **Pentair**
Pool Products®