

## CBIT150L1C20 - 150L SOLAR WATER TANK WITH ONE LOWER INDIRECT COIL

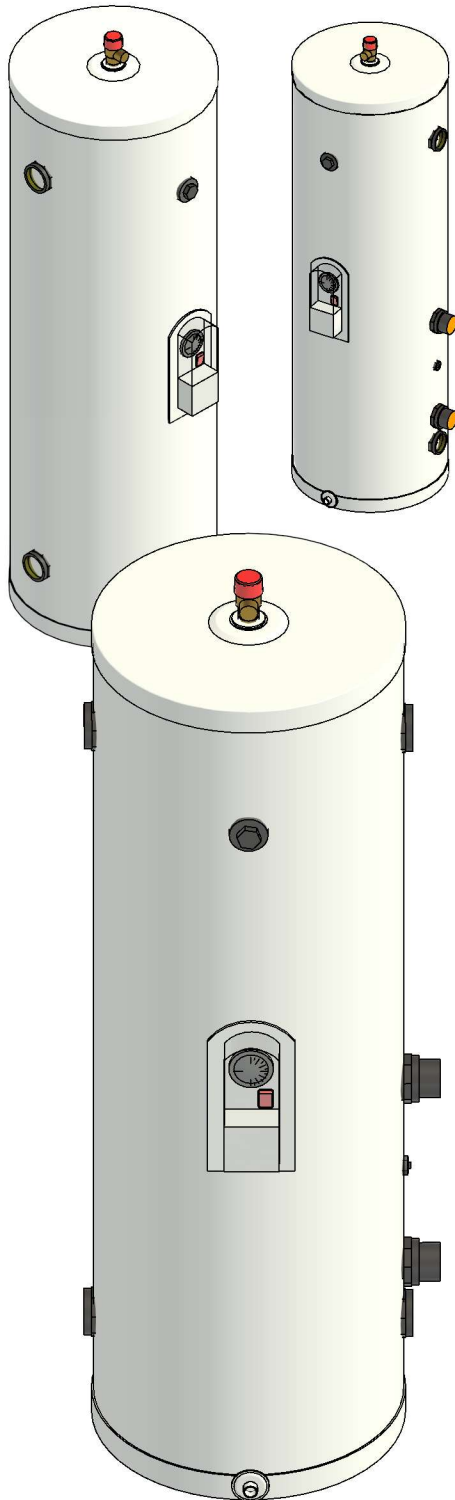

### TECHNICAL SPECIFICATIONS :

**Inner Tank Materials:** Food Grade Stainless steel SUS 304-2B 1.5mm (0.05") thickness.

**Outer Tank Cover Material:** White Color Galvanized Steel 0.55mm thickness.

**Thermal Insulation Layer:** 50 mm (1.96") of High Pressure Automatic Polyurethane Foaming Layer, Density of 36 Kg/m<sup>3</sup> (2.24 Lb/ft<sup>3</sup>).

**In Tank Heat Exchangers (Coils) Specifications:** TU1 Copper (Red Copper), Thickness = 1mm (0.04").

**Immersed Coil Outer Diameter :** 20mm ( $\frac{3}{4}$ " ), Coil Inlet / Outlet Connection: 20mm ( $\frac{3}{4}$ " ) Male NPT.

**Bottom Coil Heat Exchange Area:** 1.55 m<sup>2</sup> (16.68 ft<sup>2</sup>).

**Water Purification:** Magnesium Rod Installed

**Backup Heat:** Standard 1" Female threaded port for inserting heating element.

**Accessories:** Tank Feet, Screws, Safety T/P Valve and Drain Valve Port Plugged.

**HSE Limited Warranty:** 5 Years against manufacturing defects.

## CBIT 150 L1C20 - 150L SOLAR WATER TANK WITH ONE LOWER INDIRECT WIL

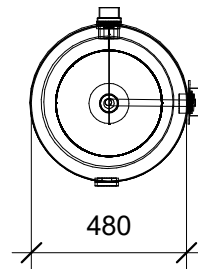
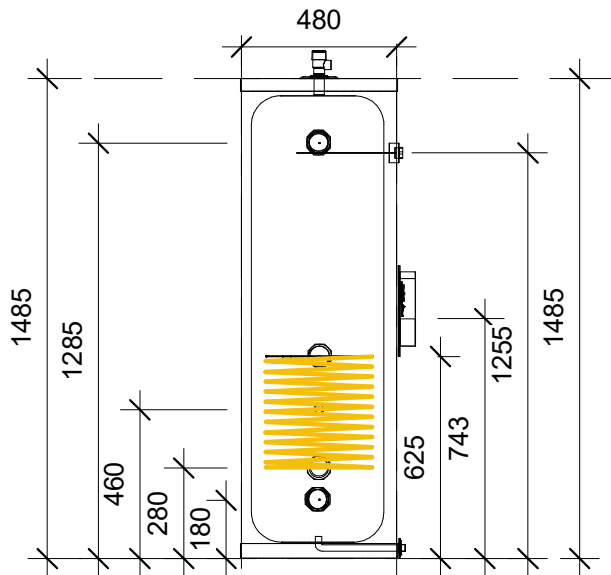
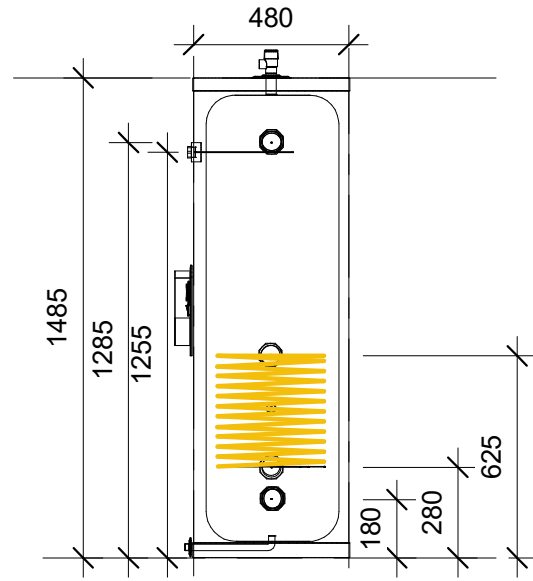
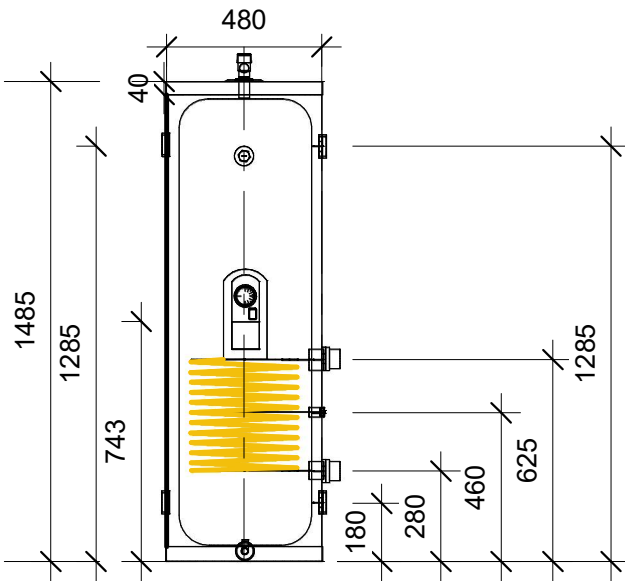

## CBIT150L1C20 - 150L SOLAR WATER TANK WITH ONE LOWER INDIRECT COIL

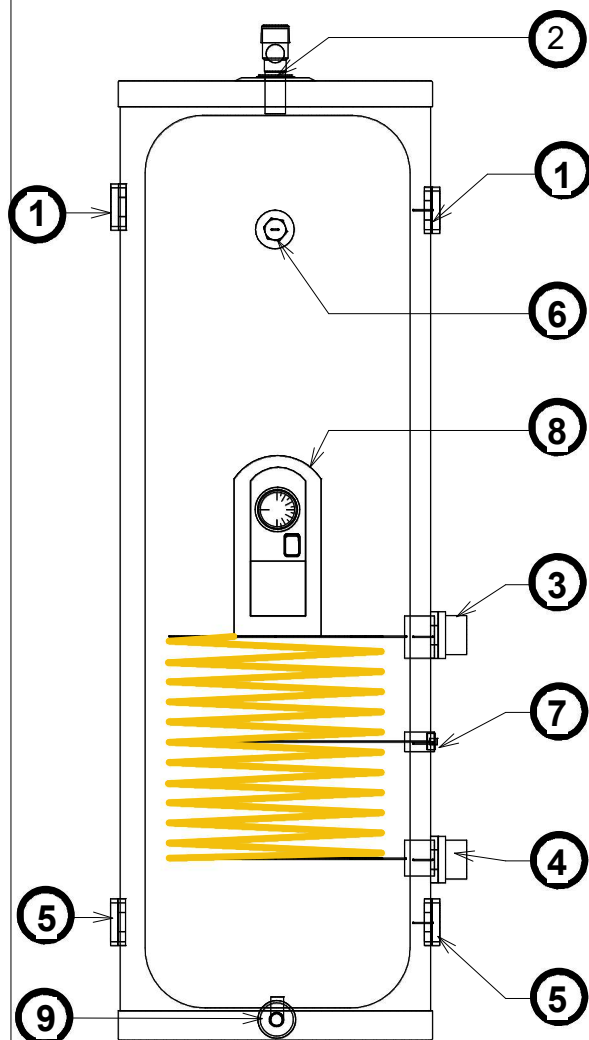

<b>1</b>	WATER TANK INLET/OUTLET FEMALE 1 1/4" NPT
<b>2</b>	T/P SAFETY VALVE PORT 3/4" FEMALE (SAFETY VALVE PACKED INSIDE SHIPPING BOX)
<b>3</b>	IMMERSED COIL 3/4" MALE NPT OUTLET
<b>4</b>	IMMERSED COIL 3/4" MALE NPT INLET
<b>5</b>	WATER TANK INLET/OUTLET FEMALE 1 1/4" NPT
<b>6</b>	MAGNESIUM ROD 3/4" BSPT FEMALE
<b>7</b>	TANK TEMPERATURE SENSOR PORT 1/2"-3/4" BSPT FEMALE
<b>8</b>	ELECTRIC HEATING ELEMENT 1" FEMALE PORT
<b>9</b>	DRAINAGE VALVE 3/4" NPT FEMALE THREADED PORT WITH MALE 3/4" NPT END CAP

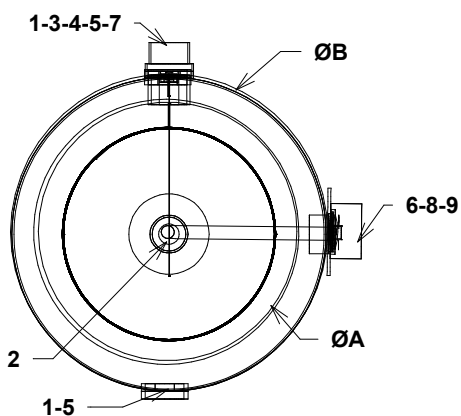

**GROSS WEIGHT: 48 KG (105.82 LB)**