



# KOMOS

## RESIDENTIAL KEGERATORS

**INSTRUCTION MANUAL**



## TABLE OF CONTENTS

<b>INCLUDED FEATURES.....</b>	<b>2</b>
<b>ASSEMBLY INSTRUCTIONS.....</b>	<b>3–10</b>
<b>GENERAL INSTRUCTIONS.....</b>	<b>11–12</b>
• Safety	
• Installation	
• Operation	
• Care/Maintenance	
<b>KEGGING OPTIONS.....</b>	<b>13–14</b>
• Configurations	
• Couplers/Connections	
<b>TROUBLESHOOTING.....</b>	<b>15</b>

### **⚠ SAFETY NOTICE ⚠**

CO<sub>2</sub> may be dangerous if not used in a well ventilated area. It is important to always check for gas leaks after setting up the unit as well as when kegs are replaced.

### **⚠ WARNING ⚠**

If the unit has just been moved (or tilted at more than a 45 degree angle) **DO NOT PLUG IN OR TURN ON** until the unit has been upright for 24 hours.

# INCLUDED FEATURES

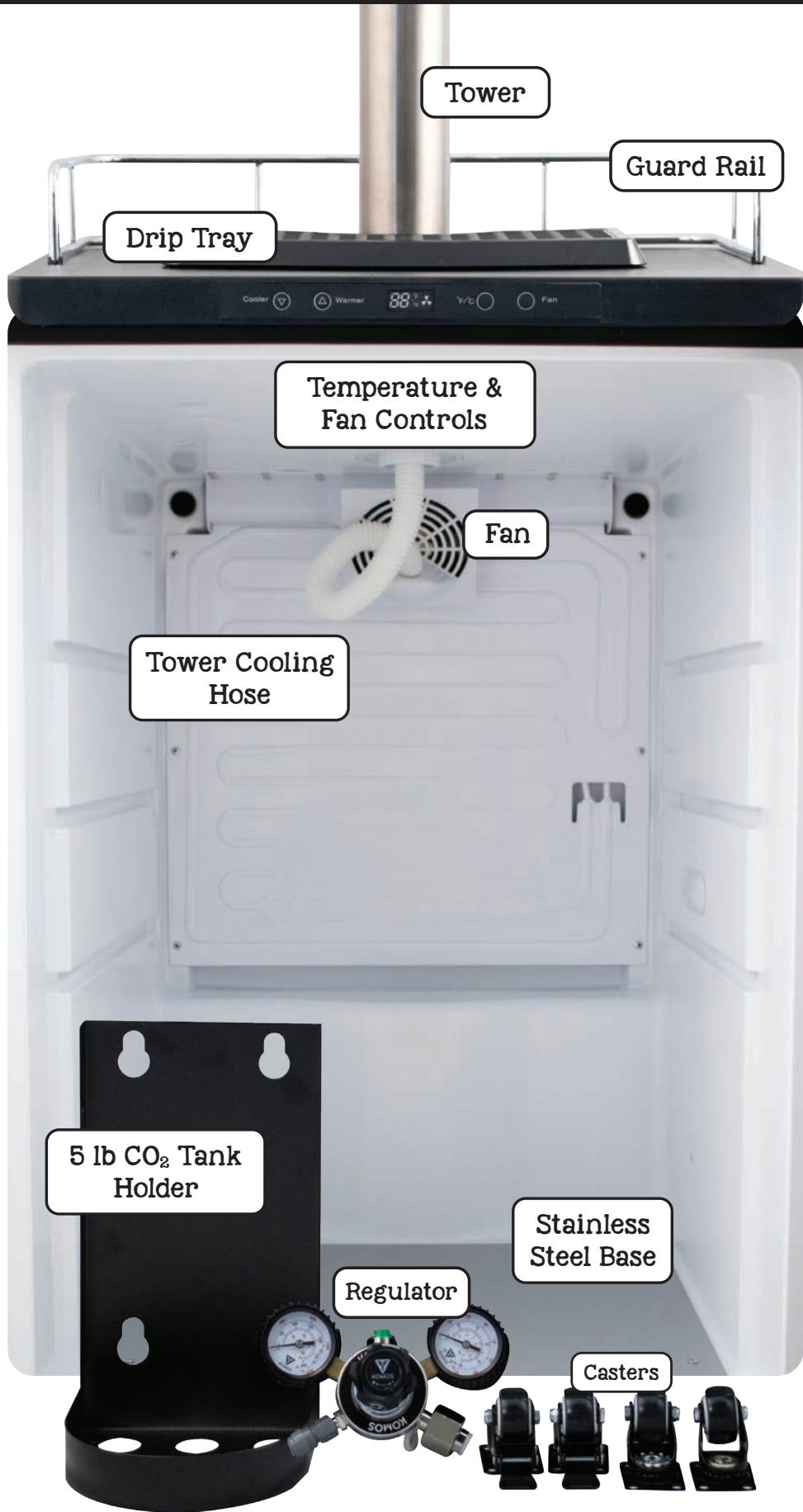

# ASSEMBLY INSTRUCTIONS

It is recommended that you assemble the kegerator prior to installing/plugging in the unit.

First things first ... to assist in assembly we suggest having the following tools on hand:

- Multipurpose wrench (included)
- #1 Phillips head screwdriver
- Tubing cutter or scissors

If Using Stepless Clamps Instead of Duotight:

- Needle-nose pliers
- Pinch clamp pliers (preferred)
- If you don't have pinch clamp pliers, regular wire cutters will work

Second ... take stock of what comes with the kegerator. Remove all the items from inside the unit as well as unpack the tower box and line kits. You should have:

- A. Guard rail
- B. Drip tray
- C. Faucet(s) with black tap handle
- D. Duotight tower shank
- E. Tower collar (1–3 tap towers only)
- F. Tower with cap
- G. Tower gasket & screws
- H. Screws for casters (installed under unit)
- I. Casters (4)
- J. Adjustable feet (2)
- K. Dual gauge CO<sub>2</sub> regulator
- L. Duotight fitting 1/4" Flare
- M. Multipurpose wrench
- N. Stepless clamps
- O. Beer line tubing
- P. CO<sub>2</sub> tubing
- Q. CO<sub>2</sub> tank holder



## ATTACH THE CASTERS/ADJUSTABLE FEET:

Depending on where you plan to place your kegerator, attaching casters is optional. If you would like to use the casters, then it is recommended to attach the casters prior to attaching the tower/CO<sub>2</sub> tank. This step is simple, however you will need to place the unit either on its side or upside down. For this reason you will want to **WAIT 24 HOURS** after attaching the casters before plugging in the unit.

**NOTE** - there are two pairs of casters - 1 pair with a lock & 1 without. We suggest placing the non-locking casters in the back part of the unit.

- 1 Lineup & screw in the non-locking casters with the pre-drilled holes in the back of the kegerator. You'll notice that one set of pre-drilled holes are horizontal. This is due to the placement of the compressor and will have zero effect on how the unit moves.

- 2 Lineup & screw in the locking casters to the front part of the kegerator.

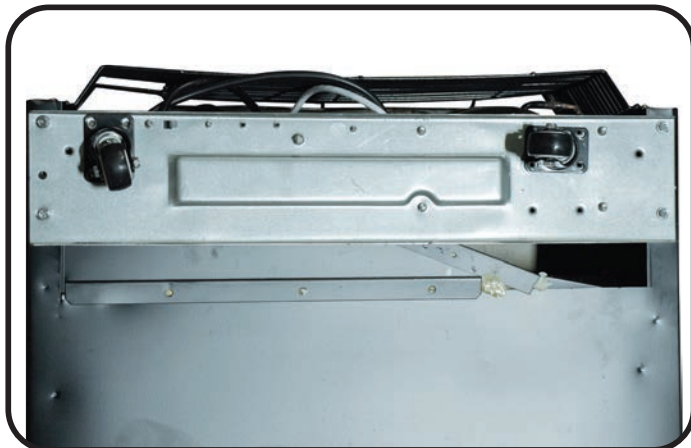

**TIP** - if there is some foam covering a pre-drilled hole or inside it (this may occur due to the manufacturing process) then simply dig out the foam or screw directly into it.

If you choose to not use the casters then attach the included large adjustable feet to the brass inserts in the back corners of the unit. Screw down completely. These will be fixed while the front pre-installed adjustable feet will be used to balance/level the unit.

## ASSEMBLE/ATTACH THE TOWER:

The process is the same for the single, double, and triple faucet tower. For the quad faucet tower, see the following page.

**TIP:** If setting up a triple faucet tower, start with the lowest faucet.

- 1 Set the tower's collar sleeve onto tower.
- 2 Feed the beverage line tubing up through the bottom of the tower so tubing comes out both the top and the bottom of the tower.
- 3 Attach the Duotight fitting to the beverage line coming from the top end of the tower. Feed the Duotight fitting and tubing through the tap hole. To attach the Duotight fitting, push the fitting onto the tubing then pull back slightly to lock in place. **NOTE:** repeat this step for each additional faucet your tower has.
- 4 Locate the tower shank and remove the nut and white convex collar and set them aside. From the outside of the tower, attach the Duotight fitting to the tower shank. Slide the shank and tubing into the faucet hole.
- 5 Turn the tower upside down. Slip the white convex collar and shank nut onto the beverage line with the white convex collar first and the shank nut second.
- 6 Using your finger to hold the tower shank in place, align shank with convex collar first and then the shank nut and tighten by hand.
- 7 Next tighten the shank nut with the included multipurpose wrench.
- 8 Attach the faucet to the shank; tighten with the included multipurpose wrench. Attach the tap handle and tower cap.

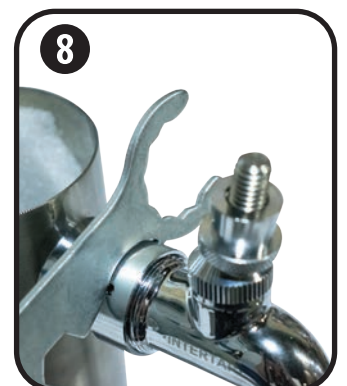
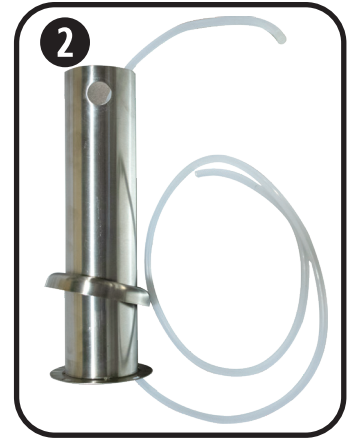

## ASSEMBLE/ATTACH QUAD TOWER:

**TIP:** When attaching faucets, start with the lower faucets first.

- 1** Attach the tower to the kegerator with the included screws. The quad tap tower mounting holes are located on the inside of the tower, and it does not include a tower collar like the 1-3 tap towers. You may need an extra-long Philips screwdriver or bit extension driver to more easily reach the mounting holes.
- 2** Attach the tower shanks starting with the lower left hole location. Remove the nut and white convex collar from the shank. Attach the Duotight fitting to the tailpiece and then attach one of the precut lengths of beverage line to the Duotight fitting. Push the tubing into the Duotight fitting and then pull back slightly to lock in place.
- 3** Feed the line through the tap hole and then slip the white convex collar and shank nut onto the beverage line with the white convex collar first and the shank nut second.
- 4** Pull the line through until the shank meets the tower, then align the white convex collar on the inside of the tower and secure in place with the shank nut. Feed the line down through the tower and into the kegerator.
- 5** Next tighten the shank nut with the included multipurpose wrench. Repeat steps 1-5 for the remaining tower shank locations, starting with the lower right hole location and working upwards.
- 6** Attach the faucets to the shanks; tighten with the included multipurpose wrench. Attach the tap handles and tower cap.

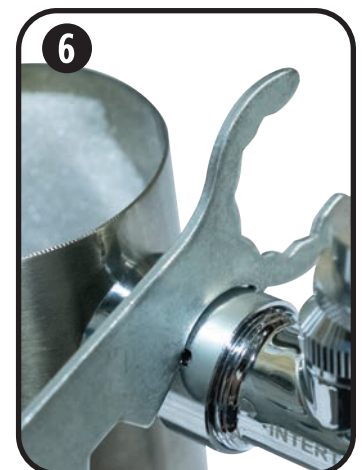
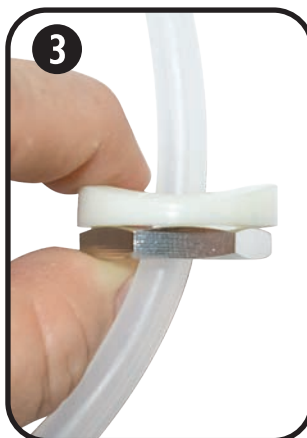

## COMPLETE THE TOP OF THE UNIT:

- 1 Snap the guard rail into place.
- 2 Place the drip tray under the tower.



## ATTACH THE CO<sub>2</sub> TANK HOLDER:

Depending on your preferred setup you can keep the CO<sub>2</sub> tank inside the kegerator or have it mounted outside with the included CO<sub>2</sub> Tank Holder. Assuming you will have the tank outside the unit ...

- 1 Attach the nylon strap to the holder



- 2 Use the screws provided and attach to the back of the kegerator



## CONNECT THE CO<sub>2</sub> REGULATOR TO TANK:

Attach the tubing to the regulator prior to connecting it to the tank.

- 1 Remove barbed tail piece from the regulator and replace with included Duotight push fitting. Push gas line into Duotight fitting. (See Photo To The Right)
- 2 Attach the regulator to the tank using the included multipurpose wrench. Tighten firmly, but be careful not to over tighten.

**NOTE** — there must be a regulator gasket between the regulator and tank. Some regulators come with a gasket already attached to the regulator.

- 3 Place CO<sub>2</sub> tank in the holder and strap securely into place.
- 4 Remove the cap from either the left- or right-hand gas line inlet, then feed the gas line through the hole.



## INSIDE THE KEGERATOR:

Before we get to attaching the beer and gas lines let's look at what's now inside the unit. If you removed everything at the beginning, you should only see (a) the beer line tubing coming down from the faucet + (b) the gas line coming in from the back of the unit + (c) the large tower cooling hose attached to the back fan. Next steps include inserting the tower cooling hose as well as connecting the beer and gas tubing to your keg coupler/fittings...

## INSERT THE TOWER COOLING HOSE:

The Tower Cooling Hose is the large diameter corrugated hose coming off the back fan. To cool the tower effectively we want to fit the cooling hose into the tower and have it reach the top.

The hose is intentionally long because some may choose to install the tower onto a raised counter rather than directly onto the kegerator.

- 1 The easiest way to measure the tubing is to insert it into the tower until it reaches the top. Once fully inserted (with the extra tubing from the beer lines this can be snug) make an estimate of how many inches need to be cut off. Don't worry, a best guess will work just fine.
- 2 Pull the hose out, and with scissors or a knife cut the tubing at an angle – we don't want the hose to push flush against the top of the tower which will restrict airflow.
- 3 Re-insert the hose into the tower. Don't worry if the tubing is a little short or long, it will properly cool the tower.





# CONNECTING THE BEER LINE AND GAS TUBING:

Your Komos Kegerator includes very high quality EVABarrier tubing that is designed to work best with Duotight connectors. Compared to standard PVC tubing, EVABarrier is a double lined tubing that is BPA free and greatly reduces CO<sub>2</sub> loss. It can be used with traditional barb fittings, but because of the double layer it is more difficult to fit over barbs.

## CO<sub>2</sub> GAS TUBING (Larger inner diameter tubing)

The length of your gas tubing won't affect serving the beer. Extra gas line is included to accommodate different set-ups. We suggest you cut to length for your set up or roll up the extra and zip tie it. If you have a 2, 3 or 4 faucet tower you will need to cut your gas line and install the Duotight tees to split the gas line.



## BEER LINE (Smaller inner diameter tubing)

Beer line/tubing is more than just a way to get your beer from the keg to your glass. It works as a flow restrictor, and when properly sized it will ensure your beer is served just right. Note that having the correct beer line internal dimension, length, CO<sub>2</sub> pressure, and beer temperature is critical to serving your beer properly.

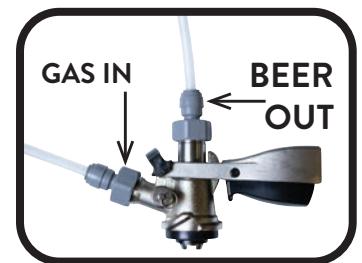

## Attaching Duotight Fittings To Couplers Or Quick Disconnects:

Attach the correct Duotight fittings to the keg coupler or quick disconnects you are using. Duotight fittings should be threaded on as tight as possible by hand and then turned an additional 180 degrees with a wrench. For pictures of additional styles of couplers or quick disconnects see page 15.



## Using Stepless Clamps:

If you did not purchase Duotight fittings and have couplers or quick disconnects with traditional barbs, we have included some stepless clamps. Because the EVABarrier tubing is an advanced two layer tubing it is difficult to fit over barbs. Follow these steps:

- 1 Boil a cup of water and dip the end of tubing for 15 seconds to soften.
- 2 Place stepless clamp onto tubing.
- 3 Insert needle-nose pliers into tubing and expand the pliers to increase the size of the opening.
- 4 Push tubing onto the barb fitting and crimp the clamp securely with pinch clamp pliers or wire cutter pliers.

## **CRITICAL FINAL STEP – CO<sub>2</sub> PRESSURE CHECK:**

Before we start serving the beer we want to confirm that the regulator and all attached hoses are properly sealed so there are no CO<sub>2</sub> leaks in the system. Pressure leaks need to be fixed ASAP because if left unchecked they will cause the CO<sub>2</sub> tank to drain, which can be potentially dangerous if located in a closed area. Testing is relatively straightforward:

Once your system is fully set up:

- Open the CO<sub>2</sub> tank valve.
- Turn up the pressure through the regulator to 20 PSI.
- Turn off the CO<sub>2</sub> tank valve.
- Wait a couple hours then check the pressure on the regulator.

If it has not dropped, then there are no leaks. Release the pressure and reset the regulator to your desired serving pressure.

If there was a drop in pressure, then spray/wipe soapy water on all the points where there may be a leak. Such as:

- All tubing connections.
- Where the regulator attaches to the CO<sub>2</sub> tank.

When gas escapes and hits the soapy water it will create bubbles. Wherever you find these bubbles tighten the connection.

---

# GENERAL INSTRUCTIONS

To ensure the kegerator is properly used please review and follow the safety and installation notices below.

---

## SAFETY:

- Plug into a grounded 3-prong outlet.
- The fuse for the outlet where the unit will be plugged in should be at least 15 amps.
- The kegerator should not be installed in an area where it will be exposed to water.
- Never allow children to climb inside the appliance. If no longer in use - remove the door or secure shut so children cannot become trapped inside the unit.
- **California Proposition 65 Warning:** This product contains a chemical or chemicals known to the State of California to cause cancer and birth defects or other reproductive harm.

---

## INSTALLATION:

- After moving the unit it is best to allow it to stand upright for 24 hours prior to plugging in to the power source.
- Do not pinch/kink the power supply cord.
- For proper heat dissipation a minimum of 4 inches of clearance on either side is required. This will allow the heat to escape quickly enough to ensure consistent cooling. Not installing properly may cause the kegerator to fail prematurely and void the warranty.
- Place the unit out of direct sunlight and other sources of heat. The best room temperature range is from 65°F – 80°F.
- After placing the unit in its desired location, level it by adjusting the casters on the bottom.
- Clean the interior with a soft damp washcloth.
- And finally, after plugging in the kegerator allow it to cool down for 4 hours prior to putting kegs inside.

## OPERATION:

**Our kegerator's digital control board makes it very easy for you to control temperature.**

- The °F/°C button allows you to set the display to read in either Fahrenheit or Celsius.
- You can adjust temperature up or down with the Cooler or Warmer buttons.
- Use the Fan button to cool the tower.

### SAFETY NOTICE

- If the unit loses power (unplugged, moved, turned off) you will need to wait 3 to 5 minutes before restarting otherwise the unit may not properly turn on.
- When turning on for the first time, or after being off for a few days, the temperature read-out will be off by a few degrees for 3-4 hours. Once the temperature normalizes it will read correctly. You may test this by placing a thermometer in a glass of water inside the unit for 2-3 hours then compare the unit's temperature read-out to the thermometer.

A good target temperature for most beers is in the 32°F–38°F range. However, you will find that certain types will be better served at warmer temperatures.

At this point the next question on most minds is ... how long will it take to get the keg to serving temperature?! In general, if the keg is at room temperature it can take anywhere from 2-4 days to chill to proper serving temp, depending on the keg volume. Fortunately most kegs are stored cold so it shouldn't take that long. Still, a keg at 48°F will take roughly 10 hours to cool down to 38°F.

**Bottom line – plan ahead and give the beer as long as possible to chill prior to serving.**

---

## CLEANING/MAINTENANCE:

Common sense cleaning rules apply. Do not use any solvent-based cleansers or abrasive pads on the kegerator. Two tablespoons of baking soda to a quart of warm water makes a good cleaning solution for the inside. Wiping the outside using warm water and a mild liquid detergent with a soft cloth will do the job.

And finally, about every 6 months it is good practice to clean both the front grill and back of the unit (turn the power off first). This will help maximize the life of the compressor.

---

# KEGGING OPTIONS

In this section we will focus on keggling/serving options (keg configurations, CO<sub>2</sub> balancing) with this kegerator.

---

## KEG CONFIGURATIONS:

You'll find a myriad of ways to utilize the large interior of the kegerator, but here are a few options for you to consider ....



---

Of course, if you're homebrewer you'll find a way to utilize the kegerator for aging or fermentation! And if you get creative you may even opt for the 1.5 gal Torpedo keg to be able to make use of the removable shelf.

---



### One More Option:

Although the assembly instructions discuss storing the 5 Pound CO<sub>2</sub> tank outside the kegerator, you may choose to bring it inside. This will limit your keggling options, however if you plan to serve a single keg at a time, then it might save you valuable space outside the unit.

# KEG COUPLERS/CONNECTORS:

By now you most likely know which types of kegs you'll be serving through your kegerator - commercial, homebrew, or maybe both (!?). Below is the list of the coupler options. When purchasing a commercial keg it is best to confirm the Coupler Type with the liquor store/distributor.

## COMMERCIAL COUPLERS BY TYPE/SYSTEM (SUBJECT TO CHANGE):



**D TYPE**  
Most US breweries



**S TYPE**  
Newcastle, Becks,  
Heineken



**U TYPE**  
Guinness, Harp



**A TYPE**  
Paulaner, Spaten



**G TYPE**  
Anchor, Boddington

## HOMEBREW DISCONNECTS FOR CORNY/SODA KEGS:

### BALL LOCK FITTINGS:

aka Pepsi-style

GRAY = Gas Fittings

BLACK = Liquid Fittings



### PIN LOCK FITTINGS:

aka Coke-style

GRAY = Gas Fittings

BLACK = Liquid Fittings

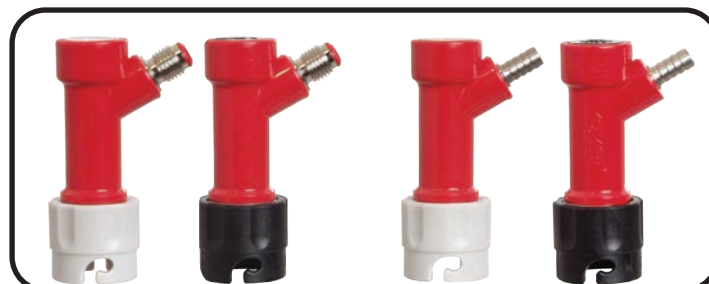

## TROUBLESHOOTING

<b>Kegeator does not turn on</b>	Check circuit breaker, fuse and power socket.
<b>Kegeator does not seem cold enough</b>	Check temperature setting by placing a cup of water with a thermometer inside the fridge. Check after 2 hours & compare against set kegeator temperature. Kegeator may need to cool longer or the door gasket may not be sealing correctly.
<b>Kegeator shuts off/on too often</b>	Check to see if the door gasket is sealing correctly. The ambient room temperature may be too high so the unit is working harder to cool to the set temperature.
<b>Kegeator seems to make too much noise</b>	Humming is normal. Gurgling sounds are caused by cooling liquid used by the kegeator. Check to make sure unit is level.